

United States Department of the Interior  
National Park Service

**NATIONAL REGISTER OF HISTORIC PLACES  
REGISTRATION FORM**

This form is for use in nominating or requesting determinations for individual properties and districts. See instructions in How to Complete the National Register of Historic Places Registration Form (National Register Bulletin 16A). Complete each item by marking "x" in the appropriate box or by entering the information requested. If any item does not apply to the property being documented, enter "N/A" for "not applicable." For functions, architectural classification, materials, and areas of significance, enter only categories and subcategories from the instructions. Place additional entries and narrative items on continuation sheets (NPS Form 10-900a). Use a typewriter, word processor, or computer, to complete all items.

**1. Name of Property**

historical name Lueddemann, Max and Ollie, House

other names/site number Endicott House; McCaulou House

**2. Location**

street & number 96 SE 9th Street not for publication N/A  
city or town Madras vicinity N/A  
state Oregon code OR county Jefferson code 031 zip code 97741

**3. State/Federal Agency Certification**

As the designated authority under the National Historic Preservation Act of 1986, as amended, I hereby certify that this  nomination  request for determination of eligibility meets the documentation standards for registering properties in the National Register of Historic Places and meets the procedural and professional requirements set forth in 36 CFR Part 60. In my opinion, the property  meets  does not meet the National Register Criteria. I recommend that this property be considered significant  nationally  statewide  locally. ( See continuation sheet for additional comments.)

*James Smith*  
Signature of certifying official Deputy SHPO Date April 22, 1996

Oregon State Historic Preservation Office  
State or Federal agency and bureau

In my opinion, the property  meets  does not meet the National Register criteria. ( See continuation sheet for additional comments.)

\_\_\_\_\_  
Signature of commenting or other official Date

\_\_\_\_\_  
State or Federal agency and bureau

**United States Department of the Interior  
National Park Service**

**National Register of Historic Places  
Continuation Sheet**

Section number   3   Page   1  

---

**LUEDDEMANN, MAX AND OLLIE, HOUSE (1906)**

96 SE Ninth Street

Madras, Jefferson County, Oregon

**COMMENTS OF THE STATE HISTORIC PRESERVATION OFFICE**

The-story bungalow which occupies the northwest corner of the intersection of Ninth and C Streets in the ranching-country trading community of Madras, on Oregon's arid high plateau, was built for Max and Ollie Lueddeman. It was completed in 1906. It is locally significant under National Register Criterion C as "one of the most substantially built and best preserved examples" of vernacular housing which typified the town's initial growth period. The house also meets Criterion B as the place most importantly associated with Max Lueddemann, newspaper publisher and town promoter whose presence in Madras was brief but significant at a critical time in the town's upbuilding.

The application provides a clear picture of the origins of Madras, the principal settlement in the drainage area of Willow Creek, a major Deschutes River tributary which rises in the Ochocho Mountains to the east. It began as the speculative venture of rancher/land claimant John A. Palmehn, who platted the town in 1902 in anticipation of a proposed extension of the Columbia Southern Railroad up the Deschutes canyon from the rail head at Shaniko and south to Bend. The prospective advantage of a rail link to main line shipping on the Columbia River to livestock ranchers and timber manufacturers was obvious. By 1905, town proprietor Palmehn transferred his unsold lots to the Madras Townsite Company in expectation of vigorous action. Not until 1911, however, did the Oregon Trunk Railroad extend to Madras and beyond. The town never boomed in the early years of the century, but it experienced moderate growth.

Playing an influential role in promotion of Madras in the years before the railroad was Max Lueddemann (1873-1954), a native of Alabama who had come West for his health in 1898 and entered into an aggressively acquisitive newspaper publishing career in the small towns of central Oregon. In 1905, he acquired the *Madras Pioneer* and relocated to the town to concentrate on the newspaper and real estate. His wife was the former Olive ("Ollie") McConnell, whose father and brother-in-law were prominent in Oregon and Idaho politics. After acquiring his home site, Lueddemann opened a realty business in partnership with the secretary of the Madras Townsite Company. In his newspaper, he advertised properties, both town lots and outlying dryland farm tracts. He was an advocate of the development of irrigation projects,

**United States Department of the Interior  
National Park Service****National Register of Historic Places  
Continuation Sheet**Section number   3   Page   2  

Lueddemann House, Jefferson Co. OR

and he initiated the original, but unsuccessful petition campaign to incorporate Madras for purposes of securing municipal water and sewer systems. Incorporation came in 1910, a year after his departure for Portland. Irrigation was delayed until 1946, when a canal was extended from a reservoir on Willow Creek. Clearly, Lueddeman's vision for Madras was ahead of the times. While it cannot be said that he stayed long enough to see his vision implemented, he had prepared the ground for others. His boosterism helped to stabilize the local population base which numbered 500 in his day and, today, stands at 4,290.

The house is briefly characterized as a Craftsman Bungalow, a single-story, hip-roofed, rectilinear volume of frame [platform] construction having a footprint of 27 x 46 feet. It has a full-width front porch on the east end and a substantial cross-gabled dining room window bay section on the south. The present roof cover is composition shingles. The front porch is supported by square columns on a solid railing. The exterior has been stucco-clad since before the Second World War. Window openings are fitted with double-hung sash with one-over-one lights. The craftsmanship which distinguishes this simple house from those of like kind remaining in town is evident on the exterior in variegated imbricated shingles of gable peaks on the front and south sides, and in a modest classical cornice assembly made up of a frieze board and simple modillions, or consoles. Architrave molding for doors and windows is good quality stock millwork. Interior frames are of the channeled and beaded variety with bull's-eye corner blocks. Interior walls are covered with wallboard at present.

The interior plan is typical of its scale in that it has no entry stairhall. Access is gained into the living room, where space flows directly to the dining area through an archway that probably was modified as a curvilinear arch in the late 1930s or early '40s. A massive chimneypiece, diagonally mounted in the angle of the living room's northwest corner, is in keeping with Craftsman principles, which celebrated the hearth as the focal point of a home. The fireplace is vented by a brick chimney but its front is native lava rock, randomly coursed with wide mortar joints which point up its rustic quality. Whether or not the chimney front is original is questionable. The mantelpiece certainly is not of the historic period. In any case, the fireplace, along with indoor plumbing, was extraordinary in a town where wood stoves were the norm in the developing years.

The application shows that a shed and a water well with a free-standing windmill on a steel structural framework completed the original lot development. These features are no longer present. The arid sagebrush country prevented conventional landscape development, such as shade trees, lawn and garden beds, before the advent of irrigation. A Craftsman style garage

**United States Department of the Interior  
National Park Service**

**National Register of Historic Places  
Continuation Sheet**

Section number   3   Page   3  

Lueddemann House, Jefferson Co. OR

---

standing at the northwest corner of the lot is counted a non-contributing feature of the property, even though it is compatible, because it post dates the period of significance.

In the long succession of owners of the Lueddemann House after 1909, the name of Forrest Cooper stands out to those familiar with the history of the State Parks and Recreation Department's former parent agency, the Oregon State Highway Department. Cooper rose from the field crews to become State Highway Engineer, the ranking official of the Highway Department, in 1961. His was a long and distinguished tenure. In the opening years of the statewide historic preservation program authorized by the National Historic Preservation Act of 1966, Forrest Cooper was Oregon's State Historic Preservation Officer since he was the ultimate administrator of the Parks and Recreation Branch, which managed the program. He occupied the Lueddemann House from 1934 to 1941 while he was a resident engineer stationed in central Oregon. This information is offered as a matter of interest rather than further significance under Criterion B.

United States Department of the Interior  
National Park Service

National Register of Historic Places  
Continuation Sheet

Section number 3 Page 4

---

LUEDEMANN, MAX AND OLLIE, HOUSE (1905-1906)  
96 SE Ninth Street  
Madras, Jefferson County, Oregon

NRIS #96000620 Listing date: 6-03-96

Comments of the State Historic Preservation Office

The purpose of this continuation sheet is to correct a paragraph in the SHPO's comments which contains 1) a topographic name misspelling and 2) a misleading statement concerning the route of a projected extension of the Columbia Southern Railroad between Shaniko and Madras. As corrected in *Italics*, the second paragraph of Section 3, page 1 should read as follows.

-----

The application provides a clear picture of the origins of Madras, the principal settlement in the drainage area of Willow Creek, a major Deschutes River tributary which rises in the *Ochoco* Mountains to the east. It began as the speculative venture of rancher/land claimant John A. Palmehn, who platted the town in 1902 in anticipation of a proposed extension of the Columbia Southern Railroad *from the rail head at Shaniko south to Bend via the Deschutes River drainage*. The prospective advantage of a rail link to main line shipping on the Columbia River to livestock ranchers and timber manufacturers was obvious. By 1905, town proprietor Palmehn transferred his unsold lots to the Madras Townsite Company in expectation of vigorous action. Not until 1911, however, did *a distinct railroad enterprise*, the Oregon Trunk Railroad, extend to Madras and beyond. The town never boomed in the early years of the century, but it experienced moderate growth.

-----

To make clear the distinction between the two railroad enterprises, it may be pointed out, beginning in 1897, the Columbia Southern Railroad was constructed south from Biggs, on the Columbia River, via Wasco and Moro across the Sherman County uplands to Shaniko, which was the shipping point for an enormous wool clip collected from sheep ranches of the plateau country. As a route extending the interior, however, this short line was eclipsed by the Oregon Trunk Railway, which between 1908 and 1916 was constructed through central Oregon from Wishram, Washington, on the north bank of the Columbia River, to Bieber, California. The Oregon Trunk Railway, the result of an intense road-building competition, was built and operated variously by the Great Northern, Union Pacific, and Spokane, Portland and Seattle Railway. The railroad ascended the Deschutes River canyon, crossed the plateau, and dropped back to the Deschutes River corridor south of Madras and Metolius. Construction was complete to Bend in 1911.

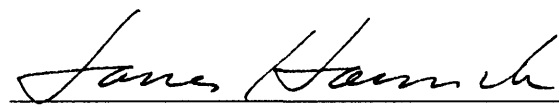
  
Deputy State Historic Preservation Officer

Date: August 17, 1998

# OREGON RAILROADS

1884

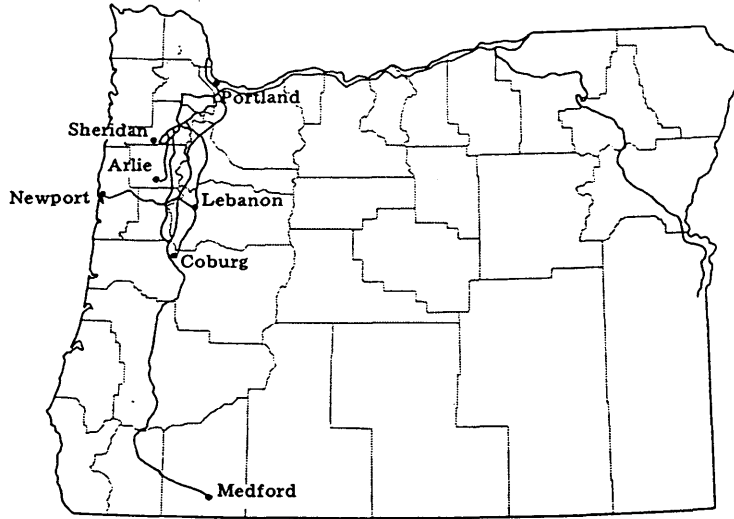

1911

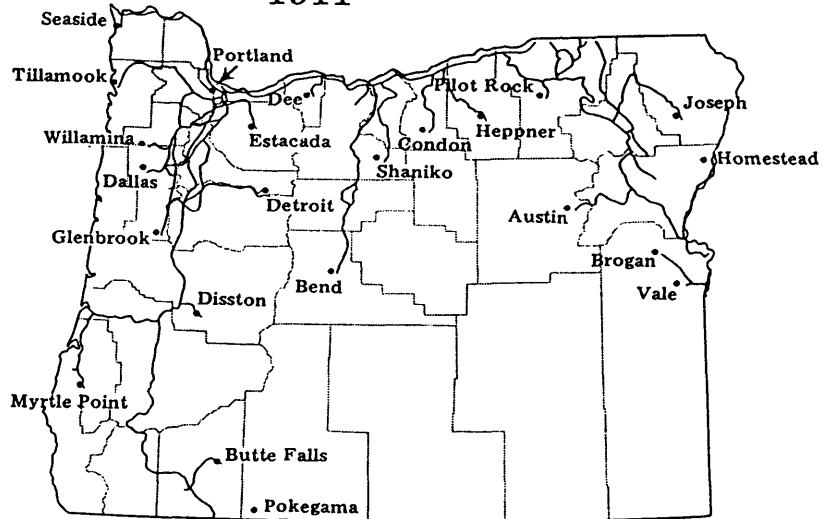

1930

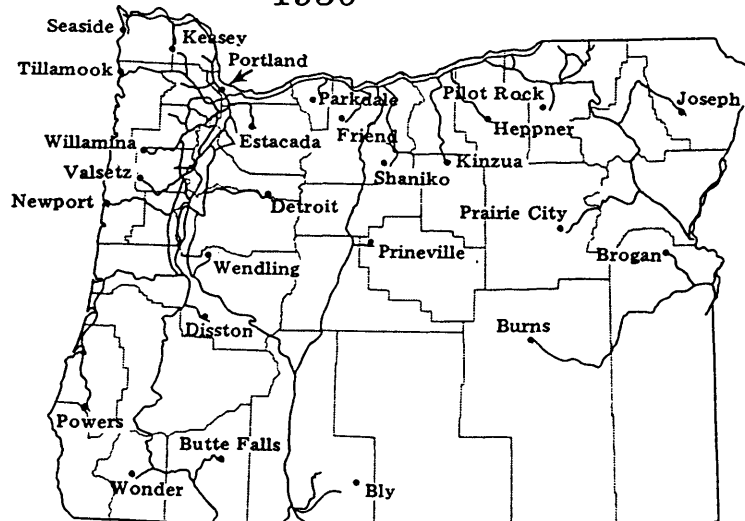

Source: William Loy, *Atlas of Oregon*

**Lueddemann House**

Name of Property

**Jefferson County, OR**

County and State

**4. National Park Service Certification**

I, hereby certify that this property is:

Edson A. Beall

6/3/96

entered in the National Register

See continuation sheet.

determined eligible for the

National Register

See continuation sheet.

determined not eligible for the

National Register

removed from the National Register

other (explain):

Entered in the  
National Register

Beall

Signature of Keeper

Date of Action

**5. Classification**

Ownership of Property (Check as many boxes as apply)

- private
- public-local
- public-State
- public-Federal

Category of Property (Check only one box)

- building(s)
- district
- site
- structure
- object

Number of Resources within Property

Contributing	Noncontributing	
<u>1</u>	<u>1</u>	buildings
<u>    </u>	<u>    </u>	sites
<u>    </u>	<u>    </u>	structures
<u>    </u>	<u>    </u>	objects
<u>1</u>	<u>1</u>	Total

Number of contributing resources previously listed in the National Register NA

Name of related multiple property listing (Enter "N/A" if property is not part of a multiple property listing.)

NA

**6. Function or Use**

Historic Functions (Enter categories from instructions)

Cat: Domestic  
Domestic

Sub: Single Dwelling  
Secondary Structure

Current Functions (Enter categories from instructions)

Cat: Domestic  
Domestic

Sub: Single Dwelling  
Secondary Structure

**Lueddemann House**

**Jefferson County, OR**

Name of Property

County and State

**7. Description**

Architectural Classification (Enter categories from instructions)

Materials (Enter categories from instructions)

Craftsman Bungalow

foundation brick faced with concrete;  
post and pier

walls stucco

roof composition shingles

other wood shingles

Narrative Description (Describe the historic and current condition of the property on one or more continuation sheets.)

The Lueddemann House, located on its original corner-lot site in what is now a residential neighborhood, is a simple vernacular one-story Craftsman Bungalow style house with Late Victorian, Queen Anne-style decorative elements. The house fronts east on 9th Street, and stands on a block with only one other structure, a single-family dwelling on the adjoining lot to the north. (See attached site map.) Residences of mixed ages and eclectic styles are across 9th Street to the east and C Street to the south. The Lueddemann House was constructed between October 1905 and May 1906. This balloon-frame dwelling has a modified rectangular shape, measuring approximately 46' x 27', with an eight-foot deep porch extending across the main (east) facade. The medium-pitch gable roof has hip-roof sections over the front porch and also at the rear (west) end of the house. An intersecting gable-roof section projects slightly from the south side wall. The exterior walls are surfaced with stucco. Window openings are predominantly one-over-one, double-hung sash, surrounded by plain wood trim with a narrow cornice across the top; they have retained their original placement, size, and design. The house rests on posts and piers, as well as a coursed brick foundation wall, surfaced with concrete. The house is in good physical condition. A small (approximately 16' x 18') wood-frame, gable-roof garage, built by the mid-1920s and considered a compatible "noncontributing" structure, stands at the northwest corner of the tax lot. The Lueddemann House retains considerable historic integrity; its location, setting, overall dimensions and proportions, roof pitch, window and door openings, floor plan, and exterior and interior decorative details remain unaltered.

Exterior. The Lueddemann House roof is sheathed with composition shingles. Two brick chimneys project from the ridge of the gable roof, one near the center of the house and at the west wall of the living room, the other toward the rear of the house alongside a kitchen wall. The roof has a boxed cornice with a plain frieze and decorative painted wood brackets all around, an uncommon architectural feature in Madras historically and today. Also unusual in this early twentieth-century pioneering trade center are the decorative imbricated wood shingles, believed to be original, found in the small front (east) gable end and the much larger projecting pent-roof enclosed gable end on the south side of the house. The main facade of the Lueddemann House is three bays wide with a central door, framed by a window on either side. The living room window to the left (south) of the door is a two-light fixed casement with an upper light of decorative patterned glass. Three one-over-one, double-hung sash windows are grouped together and centered in the projecting south side wall. One-over-one, double hung sash windows of various sizes, all framed with original plain painted wood trim, are irregularly spaced on the two side (north and south) walls. A back door is located near the south side of the rear (west) wall.



**Lueddemann House**

Name of Property

**Jefferson County, OR**

County and State

NPS Form 10-900-a  
(8-86)

OMB No. 1024-0018

United States Department of the Interior  
National Park Service

**NATIONAL REGISTER OF HISTORIC PLACES  
CONTINUATION SHEET**

Section 7 Page 1

Description (continued)

Interior. The Lueddemann House floor plan is believed to be unaltered since the building was constructed.<sup>1</sup> The house has seven rooms: a living room, dining room, kitchen, three bedrooms, and a bathroom, plus a small back hall entered through the rear door. (See attached floor plan.) A distinctive feature in the living room is the broad angled fireplace, occupying much of one wall, faced with volcanic lava rock, native to central Oregon. Although the mantel may not be original, the size and unique angle of the fireplace date from the house's construction.<sup>2</sup> Carpeting now covers original wood flooring in the living room. A wide, semi-elliptical archway separates the living and dining rooms. Symmetrical, painted wood moldings with corner blocks frame the other door openings. Most of the doors are painted wood with five horizontal panels and their original hardware. The walls are covered with wallboard and painted throughout. Beneath the kitchen there is a small (approximately 15' x 15') shallow, concrete-lined basement (probably once a food storage cellar with dirt floor and walls), reached by descending a short flight of narrow stairs from the back entry hall.

Evolutionary Changes. Since the Lueddemann House was constructed ninety years ago, the house site and setting have experienced some evolutionary changes. Shortly after the house was built in 1905-1906, the Lueddemann's erected a steel windmill and small, gable-roof, board and batten shed a few feet directly behind their house. (Both structures no longer exist.) Since the Lueddemann property was then near the edge of the built-up section of Madras, there were no other structures on the block. There were no trees, and vegetation generally was sparse on the Lueddemann property and throughout Madras.<sup>3</sup> The existing wood-frame garage is believed to have been built between the mid-1910s and the mid-1920s. The wood-frame residence that now stands on land just north of the Lueddemann property was probably moved to or constructed on its present site in the 1930s. In the early 1940s, when Madras became

---

<sup>1</sup> Gilma Endicott Greenhoot, Springfield, Oregon, telephone interview with Gail Evans, November 7, 1995. Gilma Greenhoot resided in the Lueddemann House with her parents and brother from 1925 to 1933.

<sup>2</sup> An inspection of the Lueddemann House attic, made by Gail Evans on November 4, 1995, revealed that the house's brick and mortar central chimney, that is visible in early photographs of Madras, is twisted diagonally just above the ceiling joists to accommodate the angled fireplace in the living room.

<sup>3</sup> Pre-railroad era photographic views of Madras, photograph collection, Jefferson County Historical Society, 34 SE D Street, Madras, Oregon.

**Lueddemann House**

Name of Property

**Jefferson County, OR**

County and State

NPS Form 10-900-a  
(8-86)

OMB No. 1024-0018

United States Department of the Interior  
National Park Service

**NATIONAL REGISTER OF HISTORIC PLACES  
CONTINUATION SHEET**

Section 7 Page 2

Description (continued)

home to a World War II military base, two long, single-story barracks were constructed north of and on the same block as the Lueddemann House. These have since been removed, leaving the northern two-thirds of the block without any structures. Since 1940, trees have been planted in various places near the Lueddemann House and along the north property line.<sup>4</sup>

The Lueddemann House itself has experienced some changes over the years. Stucco was most likely applied to the exterior walls, thought to have been sheathed originally with horizontal wood siding,<sup>5</sup> between 1925 and 1933 and definitely before 1941. Probably around the same time, the brick foundation wall was faced with concrete, and concrete poured in the small, shallow basement under the kitchen. Inside, the semi-elliptical arch between the living and dining rooms may have been a wide, square-cornered opening, framed with wood molding, prior to 1933. Wainscoting that once existed on the dining room walls<sup>6</sup> may have been removed around the same time the archway was altered, possibly in the late 1930s or early 1940s. Over the years, the kitchen and bathroom have been modernized, although the arrangement of facilities has remained roughly the same since at least the late 1920s.<sup>7</sup> More recently, ceilings in the three bedrooms have been slightly lowered (beneath the original board ceilings that remain in place) and carpeting laid over original wood floor boards in the living room.

---

<sup>4</sup> Deed Records, Vol. 15, p. 617, Clerk's Office, Jefferson County Courthouse, Madras, Oregon. All of lot 8, and the south portion of lot 7 in block 8, on which the Lueddemann House stands, was, in 1941, sold separately from the lots to the north, suggesting that another structure existed by then to the north of the Lueddemann House. Historic photograph of the Lueddemann House in the 1950s, Lura McCaulou Collection, Madras, Oregon.

<sup>5</sup> Long-time resident Helen Hering recalls that the Lueddemann House once had wood siding. Gilma Endicott Greenhoot believes that her father, a carpenter who did a "lot of stucco work" around town, may possibly have stuccoed their own house. Lura McCaulou, who lived in the house from the early 1940s to 1976, clearly remembers that the house was clad with stucco. Only general views of Madras, taken before the 1940s, have been located, and these do not clearly show the house's exterior siding. Helen Hering and Lura McCaulou, both of Madras, Oregon, telephones interviews with Gail Evans, both on November 3, 1995; and Gilma Endicott Greenhoot, interview with G. Evans.

<sup>6</sup> Gilma Endicott Greenhoot, telephone interview with G. Evans.

<sup>7</sup> Ibid. Gilma Endicott Greenhoot remembers that her father, William Endicott, enclosed the bathroom's clawfoot bathtub in wood.

**United States Department of the Interior  
National Park Service**

# **National Register of Historic Places Continuation Sheet**

Section number 7 Page 3

Lueddemann House, Jefferson County OR

---

Description (continued)

The present occupant of the Lueddemann House, a daughter of the house's owners, is contemplating making changes that would recover some of the original interior features. She tentatively plans to remove the living room carpeting and refinish the wood floors, as well as return the bedroom ceilings to their original height.

**Lueddemann House**

Name of Property

**Jefferson County, OR**

County and State

**8. Statement of Significance**

Applicable National Register Criteria (Mark "x" in one or more boxes for the criteria qualifying the property for National Register listing)

- A Property is associated with events that have made a significant contribution to the broad patterns of our history.
- B Property is associated with the lives of persons significant in our past.
- C Property embodies the distinctive characteristics of a type, period, or method of construction or represents the work of a master, or possesses high artistic values, or represents a significant and distinguishable entity whose components lack individual distinction.
- D Property has yielded, or is likely to yield information important in prehistory or history.

Criteria Considerations (Mark "X" in all the boxes that apply.)

- A owned by a religious institution or used for religious purposes.
- B removed from its original location.
- C a birthplace or a grave.
- D a cemetery.
- E a reconstructed building, object, or structure.
- F a commemorative property.
- G less than 50 years of age or achieved significance within the past 50 years.

Areas of Significance (Enter categories from instructions)

Architecture

Commerce (Commercial Upbuilding)

Period of Significance 1905-1909

Significant Dates 1905-06

Significant Person (Complete if Criterion B is marked above)

Lueddemann, Max

Cultural Affiliation N/A

Architect/Builder Unknown

Narrative Statement of Significance (Explain the significance of the property on one or more continuation sheets.)

The Ollie and Max Lueddemann House is locally significant under National Register criteria B and C. Max Lueddemann, who built and first lived in the house with his wife, Ollie, between 1906 and late 1909, is associated with the early Euroamerican commercial upbuilding of Madras, Oregon (platted in 1902), located in the three-mile long, semi-arid and once treeless Willow Creek Basin (in the Deschutes River drainage). As the publisher of Madras's infant newspaper and promoter of land sales in and around Madras, Max Lueddemann left a lasting legacy on the commercial development of the community. There is no other extant structure in Madras associated with his activities in the community. Several subsequent owner-occupants of the

United States Department of the Interior  
National Park Service

National Register of Historic Places  
Continuation Sheet

Section number 8 Page 3

Lueddemann House, Jefferson County OR

---

Significance (continued)

house, between 1909 and 1941, likewise aided in the slow but progressive commercial development of Madras as, first, an isolated pioneer trading center and, after 1916, as the seat of government and largest town in Jefferson County. Moreover, the substantial Lueddemann House, with locally notably decorative design features, has retained a high degree of architectural integrity. Unlike the dozen or so extant, pre-1911, vernacular houses with a similar one-story, gable- and hip-roof design, which have been destroyed or significantly altered, the Lueddemann House is unchanged in its overall form and design, as well as its interior plan and decorative elements. As it now stands, the Lueddemann House is one of Madras's few historically authentic residential structures and, as such, is a unique visual reminder of the town's founding years and pre-World War II past.

Architecture

This one-story, balloon-frame dwelling, constructed in 1905-1906 for Max and Ollie Lueddemann is significant locally as one of Madras's few remaining substantial, least altered, vernacular Bungalow-style residences built during this community's early twentieth-century pioneering years as a trading center in sparsely settled central Oregon's farming region east of the Cascade Mountains. As suggested by photographs taken of Madras around the time of railroad construction (1910-1911), as well as by long-time residents, the town's first houses were often of single-wall construction and without all but the most elemental decorative details and amenities. As a consequence, many Madras houses built before 1920 that managed to escape destruction by one of the town's several fires, were either subsequently removed to make way for the town's later post-World War II growth or substantially altered. Typically, the oldest residences in town have been upgraded and modernized inside, and have undergone major exterior changes, such as additions to the main structure, the loss or alteration of original porches, dormers, and window openings, and the application of new exterior sheathing.<sup>8</sup>

---

<sup>8</sup> "Living History," Madras Pioneer, September 27, 1995.

**Lueddemann House**

Name of Property

**Jefferson County, OR**

County and State

NPS Form 10-900-a  
(8-86)

OMB No. 1024-0018

United States Department of the Interior  
National Park Service

**NATIONAL REGISTER OF HISTORIC PLACES  
CONTINUATION SHEET**

Section 8 Page 4

Significance (cont.)

In contrast, local builders used sturdy balloon-frame construction methods to erect the Lueddemann House, and added decorative finish details (including imbricated shingles, cornice brackets, and interior door moldings with corner blocks) that were uncommon design features of early Madras dwellings. Additionally, few if any other vintage Madras home were probably built with interior fireplaces (relying instead on wood stoves for heat). Also, according to local folklore, the Lueddemann House was the first residence in the community to have indoor plumbing, a feature that very possibly dated from the time of construction. (Early photographs depicting overall views of Madras show the liberal scattering of outhouses behind dwellings, yet none is visible behind the Lueddemann House.) Veteran Madras residents have long considered the Lueddemann House a show place of sturdy construction and fashionable "modern" comforts.<sup>9</sup>

These aspects of the house's design and construction may help explain why the Lueddemann House has experienced comparatively few exterior and interior alterations (as detailed in Section 7). Although the stucco treatment on the exterior walls is probably not original, it had occurred by 1933, quite early in the house's ninety-year history. In 1995 the Lueddemann House remains one of the most substantially built and best preserved examples of its type and age in Madras.

Commerce

Like many other small towns in the semi-arid, sage and bluebunch wheatgrass country of central Oregon's Deschutes-Umatilla Plateau, Madras's founding occurred late in the history of settlement in Oregon and the Far West.<sup>10</sup> The town's intermittent growth during its pioneering years are testimony of numerous environmental, geographic, and economic obstacles that confronted early Madras residents and challenged the efforts of local boosters. Madras began as neither a railroad nor an irrigation town, but as a speculative venture of donation land claim owner and rancher John A. Palmehn. Convinced of the need for a trade center for sheep and cattle ranchers in and around the Willow Creek Basin, he filed a plat for a new town, known as "Palmain" (presumably a misspelling of Palmehn) in July 1902. Over the next two years,

---

<sup>9</sup> "Historic Madras Homes within Easy Walking Distance," Madras Pioneer, October 11, 1995; Howard Hillis, Madras, Oregon, interview by Gail Evans, November 4, 1995.

<sup>10</sup> Kathryn Anne Toepel, William F. Willingham, Rick Minor, "Cultural Resource Overview of BLM Lands in North-Central Oregon: Archaeology, Ethnography, History" (Eugene: University of Oregon, 1980), 146-58.

**Lueddemann House**

Name of Property

**Jefferson County, OR**

County and State

NPS Form 10-900-a  
(8-86)

OMB No. 1024-0018

United States Department of the Interior  
National Park Service

**NATIONAL REGISTER OF HISTORIC PLACES  
CONTINUATION SHEET**

Section 8 Page 5

Significance (continued)

several entrepreneurial business-minded new arrivals bought lots and erected false-fronted, wood-frame commercial buildings and modest, single-story dwellings. The first issue of the weekly Madras Pioneer, published on August 25, 1904, assuredly announced the newspapers intention to assist in the upbuilding of Madras, and boasted of the town's many advantages as a trading center: its proximity to the nearby Hay Creek sheep and cattle ranch empire to the east, to 800 Native American farmers and stock growers living on the Warm Springs Reservation to the northwest, and to the stands of yellow and ponderosa pine covering the western slopes of the Ochoco Mountains to the southeast.<sup>11</sup>

Most importantly, according to the Pioneer, Madras was located on the proposed extension of the Columbia Southern Railroad, from Shaniko south to Prineville and Bend. Great expectations of Madras's future prosperity as a railroad trading center, no doubt, encouraged John Palmehn to transfer his unsold lots to the Madras Townsite Company in late 1904 and 1905, and prompted vigorous real estate activity. During the next six years, as railroad empire-builders James J. Hill and Edward H. Harriman waged an infamous bitter battle for control over a railroad right-of-way through the narrow rugged Deschutes River canyon, the Pioneer regularly featured optimistic front-page articles about railroad progress, promotional advertisements for residential lots and farm land for sale in and around the Willow Creek Basin, and legal notices of land claims being proved. To the disappointment of many, however, it was not until early 1911, one year after the town incorporated, that the first train steamed into Madras over James Hill's Oregon Trunk Railroad tracks. In mid-February that year, out-of-town celebrities and Madras residents greeted the train under a high-arched sign proclaiming that Madras was the "Gateway to Central Oregon." Despite all the boosterism aimed at building confidence in Madras's future, this frontier town never boomed during its first decade but, instead, experienced only moderate growth.<sup>12</sup>

---

<sup>11</sup> Phil F. Brogan, East of the Cascades (Portland, Oreg.: Binfords & Mort, Publishers, 1964), 202-204.

<sup>12</sup> Ibid., 203, 234-47; "Index to Deeds, Vol. A," Clerk's Office, Jefferson County Courthouse; Howard Turner, "Madras," in Many Hands, Jefferson County Reminiscences (Portland, Oreg.: Binfords & Mort, Publishers, 1957), 114-15; Randall V. Mills, "A History of Transportation in the Pacific Northwest," Oregon Historical Quarterly 47:2 (June 1946), 297-98; Carlos A. Schwantes, ed., "Problems of Empire Building," Oregon Historical Quarterly 83: 4 (Winter 1982), 371-90; Carlos A. Schwantes, Railroad Signatures across the Pacific Northwest (Seattle: University of Washington Press, 1993), 142-49.

**Lueddemann House**

Name of Property

**Jefferson County, OR**

County and State

NPS Form 10-900-a  
(8-86)

OMB No. 1024-0018

United States Department of the Interior  
National Park Service

**NATIONAL REGISTER OF HISTORIC PLACES  
CONTINUATION SHEET**

Section 8 Page 6

Significance (continued)

Max Lueddemann played an important role in the promotion and gradual commercial upbuilding of Madras in its pre-railroad years. Born in Tuscumbia, Alabama, in 1873, Lueddemann graduated from the University of Alabama, received a law degree from Cumberland University in Tennessee, and practiced law in Alabama for two years before moving to Oregon for health reasons in 1898. That year Lueddemann settled in the central Oregon ranching and mining supply town of Antelope, where he began investing in land and also bought the Antelope Herald newspaper (founded in 1892). In 1901 he acquired the rival Antelope Republican. Lueddemann's publishing experiences in Antelope soon led to other newspaper ventures. Between the late 1890s and 1905, he founded and/or bought newspapers in the infant central Oregon towns of Shaniko, Ashwood (the Prospector), and Bend (the Bulletin). (He later acquired newspapers in Silver Lake, Lakeview, and Ashland, in southcentral and southwestern Oregon.) In the spring of 1905, Lueddemann purchased his fifth newspaper, the Madras Pioneer. Attracted to the pioneer town by the promise of railroad development and the prospect of profiting from land investments, the Pioneer, in early June that year, announced that Max Lueddemann would soon move from his home in Antelope to Madras, where he planned "to devote his time to the upbuilding of this vicinity."<sup>13</sup> Later that month, he moved to Madras. Accompanying him was his wife of two years, Olive (known as "Ollie"), daughter of former Oregon Senate president (1882) and Idaho governor (1892-1896), W. J. McConnell, and sister-in-law of future Idaho senator (1907-1940) and 1936 Republican presidential nominee, William E. Borah.<sup>14</sup>

Over the next few weeks, both Max and Ollie Lueddemann busied themselves with establishing their new home in Madras. In early August 1905, a load of the couple's household goods was transported from Antelope. On August 24th, Ollie Lueddemann paid the Madras Townsite Company \$175. for three 50' x 100' lots, four blocks from the town's main street and then on the outskirts of the town's built-up section, that soon

---

<sup>13</sup> Madras Pioneer, June 3, 1905, 2.

<sup>14</sup> Brogan, East of the Cascades, 134-36; F. A. Shaver, et al., An Illustrated History of Central Oregon (Spokane, Wash.: Western Historical Publishing Company, Publishers, 1905), 410, 1059, 1065; History of the Columbia River Valley: From The Dalles to the Sea, Vol. II (Chicago: S. J. Clarke Publishing Company, 1928), 795-96; George S. Turnbull, History of Oregon Newspapers (Portland, Oreg.: Binford & Mort, Publishers, 1939), 289-90, 441, 446; "Max Lueddemann, Age 88, Succumbs at Home Here," Oregonian, January 24, 1954; "Death Takes Early Owner of Pioneer," Madras Pioneer, January 28, 1954; "Mrs. Lueddemann Succumbs at 95," Oregon Journal, February 29, 1972; Madras Pioneer, June 22, 1905.



**Lueddemann House**

Name of Property

**Jefferson County, OR**

County and State

NPS Form 10-900-a  
(8-86)

OMB No. 1024-0018

United States Department of the Interior  
National Park Service

**NATIONAL REGISTER OF HISTORIC PLACES  
CONTINUATION SHEET**

Section 8 Page 7

Significance (continued)

became the site of the Lueddemann's new residence. Presumably, construction of the substantial, balloon-frame Lueddemann House, with a distinctive corner fireplace in the living room, commenced before the cold winter months of 1905-06, when the Willow Creek Basin typically experiences several months of below-freezing temperatures. The Cowles and Derham Sawmill, located in 1905 on the Deschutes River near Warm Springs and regularly advertised in the Madras Pioneer, reportedly supplied the lumber for the house; local carpenters completed its construction.<sup>15</sup> In mid-May 1906, the Madras Pioneer announced that Max Lueddemann had recently received and "placed in position on his residence property a new steel windmill, to pump water for household use and yard irrigation."<sup>16</sup> Early panoramic views of Madras, photographed before the arrival of the railroad, clearly depict this windmill, standing near a gable-roof shed at the rear (west side) of the Lueddemann House. Few other modern windmills existed in town at that time; many of the town's residents obtained water from a public well. The Lueddemann's access to water for their own personal use was probably an uncommon luxury. It is possible that water was even piped into the house at that early date.<sup>17</sup>

As the Lueddemanns worked to complete and then settled in to their new house, Max Lueddemann became fully immersed in the business and civic affairs of Madras, then with a population of around 500. In late June 1905, he opened the Madras Realty Company (with Don Rea, secretary of John Palmehn's Townsite Company), on Madras's main street. Lueddemann's Pioneer newspaper often displayed large bold-type Madras Realty advertisements for "bargains" in extensive pasture and plough acreage near Madras, as well as commercial and residential lots in town. Lueddemann also used the Pioneer to regularly promote his services as a local agent for the Norwich Union Fire Insurance Company. In between his frequent business trips to Antelope, Prineville (the seat of government of Crook County, in which Madras was located prior to the creation of Jefferson County in 1914), The Dalles, and Portland, Lueddemann, in late 1905, led a petition campaign to incorporate Madras, a movement that was initiated by concern over the sanitary conditions of the city's water supply. (This effort failed,

---

<sup>15</sup> Madras Pioneer, June 22, 1905 and October 5, 1905; Hands, Jefferson County Reminiscences, 46; Kathleen Hillis, Madras, Oregon, information communicated from Howard Hillis to Gail Evans, October 1995.

<sup>16</sup> Madras Pioneer, May 17, 1906.

<sup>17</sup> Madras Pioneer, August 10, 1905; "Index to Deeds, Vol. C," p. 208-209, Clerk's Office, Jefferson County Courthouse; photograph collection, Jefferson County Historical Society, Madras, Oregon.

**Lueddemann House**

Name of Property

**Jefferson County, OR**

County and State

NPS Form 10-900-a  
(8-86)

OMB No. 1024-0018

United States Department of the Interior  
National Park Service**NATIONAL REGISTER OF HISTORIC PLACES  
CONTINUATION SHEET**Section 8 Page 8

## Significance (continued)

and Madras did not become incorporated until 1910.) Lueddemann was not only concerned about the quality of drinking water in Madras but also the limited quantity that existed for both town residents and farmers in the basin. Beginning in early 1905 and continuing for more than a year, the Willow Creek Basin experienced a long drought that severely handicapped growth in the area. No doubt hopeful of learning how Madras's water problem might be solved, Lueddemann attended the National Irrigation Congress in Boise in the fall of 1906.<sup>18</sup> Known among his contemporaries as a "thorough, wide-awake young business man,"<sup>19</sup> as well as a "capable newspaper man and very worthy citizen,"<sup>20</sup> Max Lueddemann contributed to early local efforts to build up Madras as a commercial center in the Deschutes Plateau of central Oregon.

For Ollie Lueddemann life in Madras seemed to be far less absorbing than it was for her husband. The Pioneer often noted her frequent and sometimes extended trips to visit family and friends in Moscow, Idaho, The Dalles, the Portland area, and Seaside on the Oregon coast. It may have been her discontent with Madras's isolation and harsh climate, coupled with the town's sluggish pre-railroad economy and the prospects of more promising real estate opportunities elsewhere for her husband that prompted Max to sell the Madras Pioneer in late August 1909. At the same time, he and Ollie sold their residential property for \$2,500. In early September, the Lueddemanns moved from Madras and soon after became established in Portland, where Max continued to pursue journalism activities and formed a real estate firm with his brother Ernst, a former resident of The Dalles, Oregon. (Max Lueddemann continued to own considerable property in Madras until the mid-1910s.) For many years, he served as a director on the Portland Realty Board. Max Lueddemann also bought a pear orchard and packing plant in Medford, Oregon, which he frequently visited in the 1910s and 1920s. Both Max and Ollie Lueddemann made Portland their permanent residence until their deaths in

---

<sup>18</sup> Madras Pioneer, June 29, July 6, September 21, October 5, November 9, 1905; and January 18, February 22, April 26, September 6, 1906.

<sup>19</sup> Madras Pioneer, June 3, 1905.

<sup>20</sup> Shaver, et al., An Illustrated History of Central Oregon, 410.

**Lueddemann House**

Name of Property

**Jefferson County, OR**

County and State

NPS Form 10-900-a  
(8-86)

OMB No. 1024-0018

United States Department of the Interior  
National Park Service

**NATIONAL REGISTER OF HISTORIC PLACES  
CONTINUATION SHEET**

Section 8 Page 9

Significance (continued)

1954 and 1972, respectively.<sup>21</sup> Although Max Lueddemann had been gone from Madras for forty-five years at the time of his death, the Pioneer newspaper printed an obituary which acknowledged his contribution to the upbuilding of the community as a pioneer Madras and central Oregon newspaper publisher.<sup>22</sup>

After the Lueddemann's left Madras in 1909 and the railroad reached Madras in 1911, the community continued its struggle to develop as a trading center and achieve its proclaimed destiny as the "Gateway to Central Oregon." Limited railroad traffic and freight tonnage and the uneven success of much-acclaimed dryland grain (wheat, oat, and barley) farming methods failed to bring the anticipated prosperity to residents in and around the Willow Creek Basin. Throughout the 1920s and 1930s, Madras languished. Dust storms as well as a depressed national economy plagued central Oregon residents in the 1930s. Many people who came to this arid region with high hopes moved away. Between 1909 and 1941, the Lueddemann House changed hands five times. Only one family owned the house for more than a decade. Some relief came to Madras during World War II. In late 1942, the Army Air Corps began constructing an airbase to train pilots for B-17 and B-24 fighter planes; the town's population jumped from 402 to 1,800 in two months. Although Madras's wartime boom was short-lived, it was soon replaced by one reminiscent of the early railroad days. In May 1946, forty years after Max Lueddemann and others had acknowledged the need for Willow Creek Basin irrigation in the Madras Pioneer,<sup>23</sup> water arrived in the Madras area through a canal, known as the "fabulous furrow," from seventy-mile distant Wickup Reservoir. With water came modern-day pioneers and the beginning of a vital new era in the

---

<sup>21</sup> Madras Pioneer, August 3 & 10, September 21 & 28, December 28, 1905, January 25, May 17 & 24, September, November 4 & 15 1906, August 26, September 16, 1909; William H. McNeal, History of Wasco County, Oregon (The Dalles, Oreg.: William H. McNeal, n.d. [early 1950s?]), 271; History of the Columbia River Valley, 795-96; "Max Lueddemann," Oregonian, January 24, 1954; "Index to Deeds, Vols. A-L" and "Vol. E," pp. 134-35, Clerk's Office, Jefferson County Courthouse.

<sup>22</sup> "Death Takes Early Owner of Pioneer," Madras Pioneer, February 28, 1954.

<sup>23</sup> According to the Madras Pioneer in early 1906, "the most serious problem which confronts the town at this time, and one upon which its future largely rests, is that of an abundant water supply." Similar sentiments were often repeated during Lueddemann's tenure as the newspaper's publisher. Madras Pioneer, February 22, 1906.

**Lueddemann House**

Name of Property

**Jefferson County, OR**

County and State

NPS Form 10-900-a  
(8-86)

OMB No. 1024-0018

United States Department of the Interior  
National Park Service

**NATIONAL REGISTER OF HISTORIC PLACES  
CONTINUATION SHEET**

Section 8 Page 10

Significance (continued)

upbuilding of Madras.<sup>24</sup>

Several Lueddemann House occupants aided in efforts to sustain Madras's commercial life before World War II. James C. Robinson, who moved from Ashwood, Oregon, with his wife, Bridgie, and young daughter more than three years before buying and moving into the Lueddemann House in September 1909, became one the town's early merchants. Robinson remained in the Lueddemann House only four years, however, before he and his family moved to Medford, Oregon, where, in 1920, James worked as an auto mechanic and Bridgie as a dressmaker.<sup>25</sup>

Between 1913 and 1925, Charles P. and Mary U'Ren owned and occupied the Lueddemann House. For many decades in the early twentieth century, the U'Ren's operated an extensive cattle ranch, first, in the Shaniko area (at Ridgeway) and, later, at South Junction on the Deschutes River. While maintaining a home in Madras, C. P. U'Ren reportedly built and operated the first garage in Madras and, later, became mayor of the town. Both U'Rens were actively involved in religious and civic activities during their twelve-year tenure in Madras.<sup>26</sup>

William ("Bill") Endicott and his wife, Mollie, and two children owned and occupied the Lueddemann House for eight years, from 1925 to 1933. Before moving to Madras the Endicotts struggled to make a living from dryland wheat farming at three different homestead ranches on the Agency Plains southwest of Madras. Bill Endicott's skill as a carpenter, exercised between harvests on his ranches, was put to use after the family moved to Madras. During a period of halting growth in Madras, Endicott

---

<sup>24</sup> "When the Land Is in Bloom," Oregonian, May 21, 1946; "Population Gain Seen at Madras," Oregonian, November 9, 1946; Susan Metheny, "Lack of Summer Rain Forces Move," in "Growing Up in Madras," Special Section, Madras Pioneer, April 17, 1986; Brogan, East of the Cascades, 204-205; History of Jefferson County, Oregon, 5; Writer's Program of the WPA, Oregon, 391.

<sup>25</sup> Turner, "Madras," 148; Madras Pioneer, April 12, 1906 and September 16, 1909; Deed Records, Vol. E, p. 134; Bureau of the Census, Fourteenth Census of the United States, 1920 (Washington, D.C.: Bureau of the Census, 1920).

<sup>26</sup> Turner, "Madras," 166; McNeal, History of Wasco County, Oregon, 264; "Saloons and Other Places Figure in Cecil Moore Tale," Madras Pioneer March 12, 1970; "Funeral Set for Pioneer," Oregonian, August 3, 1957; Hering, interview by Gail Evans, November 3, 1995.

**Lueddemann House**

Name of Property

**Jefferson County, OR**

County and State

NPS Form 10-900-a  
(8-86)

OMB No. 1024-0018

United States Department of the Interior  
National Park Service

**NATIONAL REGISTER OF HISTORIC PLACES  
CONTINUATION SHEET**

Section 8 Page 11

Significance (continued)

managed to construct and remodel several homes and commercial and public buildings in the area, including the high school gym in Culver (southwest of Madras) and a restaurant (called the "Oasis") that Mollie operated for about two years. In the early 1930s, he turned to road work, and began contracting with the Oregon Highway Department to improve and expand the state road system in central and western Oregon.<sup>27</sup>

Little more than a decade after the railroad reached Madras, road building became an activity in central Oregon with important consequences. During the Great Depression federal money allocated by the Public Works Administration for road work around Madras gave work relief to some of the area's unemployed. In the long term, new and improved surfaced roads, providing better access to the region for residents and visitors alike, eventually encouraged greater travel and tourism in Madras. Forrest Cooper, who purchased the Lueddemann House in 1934 (after Ida and W. J. Wesserling owned the house for just a year), was intimately involved in highway construction throughout his entire working career. Born in 1902, Cooper joined the Oregon State Highway Department at age nineteen in 1922 as a survey crew chainman. From there he worked his way up to transitman, and became a resident engineer four years before moving to the Lueddemann House in 1934. A year before leaving Madras in 1941, Cooper received a promotion to district maintenance superintendent and headquartered in Redmond, Oregon. While living in Madras, Cooper oversaw the location and construction of the Warm Springs (between the Warm Springs Reservation and Madras) and the Madras-Prineville highways, two projects that greatly improved north-south travel through Madras and somewhat improved downtown commerce. Twenty years later, in 1961, Cooper was elevated to the position of Oregon State Highway Department engineer. One of Cooper's most lasting tangible legacies in the

---

<sup>27</sup> Before moving from Madras to Corvallis in the mid-1930s, Bill Endicott also owned and operated the Blue Ridge Cinnabar Mine near Big Summit Prairie. Gilma Endicott Greenhoot, Rattlesnake Homestead (Springfield, Oreg.: Gilma Endicott Greenhoot, 1988; Greenhoot, interview by Gail Evans, November 7, 1995; History of Jefferson County, Oregon, 1914-1983 (Madras, Oreg.: Jefferson County Historical Society, 1984), 81; Echoes from Old Crook County, Vol. 1 (Prineville, Oreg.: Crook County Historical Society and A. R. Bowman Memorial Museum, 1991), 105-107; Madras Pioneer, ? , 1968 and January 11, 1979.

Lueddemann House

Name of Property

Jefferson County, OR

County and State

NPS Form 10-900-a  
(8-86)

OMB No. 1024-0018

United States Department of the Interior  
National Park Service

**NATIONAL REGISTER OF HISTORIC PLACES  
CONTINUATION SHEET**

Section 8 Page 12

Significance (continued)

history of Oregon highway construction is the highway rest stop.<sup>28</sup>

---

<sup>28</sup> "State Names Cooper as Highway Engineer," Oregonian, December 9, 1961; "Cooper Names Highway Chief," Oregon Statesman, December 9, 1961.

In 1967 as a nominee to receive a national award as one of the top ten public works men-of-the year, Forrest Cooper's many accomplishments as Oregon's State Highway Department engineer were noted. Known as an innovative administrator, he initiated the interstate highway safety rest area program and encouraged the expansion of the state park system, he fostered aesthetic highway landscaping and beautification, he completed the widening of 308-mile long Interstate 5 to four lanes and opened Interstate 405 around Portland, he undertook the construction of several non-interstate road projects, and he oversaw the construction of the Marquam Bridge across the Willamette Bridge in Portland (1966) and the Astoria Bridge at the mouth of the Columbia River (1967). Cooper retired from the department in 1970 after nearly fifty years with the state highway department. "Supporting Data Form for Nominees to the Top Ten Public Works Men-of-the-Year," Chicago, Ill.; February 1967; "News Release," Public Information Office, Oregon State Highway Department, June 4, 1970; Forrest Cooper, "A Bit of Highway's History" [transcribed notes from a taped interview with Forrest Cooper], July 9, 1975; "State Highway Engineer Forest Cooper," n.d.; Michael Gerald, "Rest Stop Pioneer," Road Rider, May 1984: all in Technical Library, Oregon State Highway, Salem, Oregon; "Forrest B. Cooper," Statesman-Journal, January 20, 1983.

Lueddemann House

Name of Property

Jefferson County, OR

County and State

-----  
**9. Major Bibliographical References**  
-----

(Cite the books, articles, and other sources used in preparing this form on one or more continuation sheets.)

Previous documentation on file (NPS)

preliminary determination of individual listing (36 CFR 67) has been requested.

previously listed in the National Register

previously determined eligible by the National Register

designated a National Historic Landmark

recorded by Historic American Buildings Survey # \_\_\_\_\_

recorded by Historic American Engineering Record # \_\_\_\_\_

Primary Location of Additional Data

State Historic Preservation Office

Other State agency

Federal agency

Local government

University

Other

Name of repository: Jefferson County Library, Madras, Oregon

Brogan, Phil F., L. K. Phillips, ed., East of the Cascades. Portland, Oreg.: Binfords & Mort, 1964.

Echoes from Old Crook County, Vol. 1. Prineville, Oreg.: Crook County Historical Society and A. R. Bowman Memorial Museum, 1991.

Greenhoot, Gilma Endicott. Rattlesnake Homestead: A Story About Bill and Millie Endicott and Their Homesteading Experience in Central Oregon, 1911-1921. Springfield, Oreg.: Gilma Endicott Greenhoot, c. 1988.

Hands, Many. Jefferson County Reminiscences. Portland, Oreg.: Binfords & Mort, 1957.

History of Jefferson County, Oregon, 1914-1983. Madras, Oreg.: Jefferson County Historical Society, 1984.

"Index to Deeds, Vols. A-K," Clerk's Office, Jefferson County Courthouse, 75 SE C Street, Madras, Oregon.

Madras Pioneer newspaper. Several issues dating from June 1905--September 1909 and later.

McNeal, William H. History of Wasco County, Oregon. The Dalles, Oreg.: William H. McNeal, n.d. [early 1950s?].

Shaver, F. A., Arthur P. Rose, R. F. Steele, A. E. Adams. An Illustrated History of Central Oregon. Spokane, Wash.: Western Historical Publishing Company, Publishers, 1905.

**Lueddemann House**

Name of Property

**Jefferson County, OR**

County and State

=====
**10. Geographical Data**
=====

Acreeage of Property .44 acres (8,143 sq. ft.)

Madras East, Oregon 1:24000

UTM References (Place additional UTM references on a continuation sheet)

Table with 4 columns: Zone, Easting, Northing, Zone, Easting, Northing. Row 1: 10, 648750, 4943900. Row 2: 4. Includes 'See continuation sheet.'

Verbal Boundary Description (Describe the boundaries of the property on a continuation sheet.)

The Lueddemann House is located in the NW 1/4 of the NW 1/4 of Section 12, Township 11 South, Range 13 East of the Willamette Meridian in Jefferson County, Oregon. The nominated property includes all of Tax Lot 901 in Madras, Oregon. The boundaries of the property include all of lot 8 in block 8 and that portion of lot 7 in block 8, described as follows: beginning at the southeast corner of lot 7; thence west along the south line of lot 7, for 100 feet to the southwest corner of lot 7; thence north along the west line of lot 7, for 38 feet; thence east at right angles, for 27 feet; thence south at right angles, for 9 feet; thence east at right angles, for 73 feet; thence south, for 29 feet, to the point of beginning.

Boundary Justification (Explain why the boundaries were selected on a continuation sheet.)

The nominated property encompasses all of tax lot 901 occupied by the Lueddemann House, built in 1905-1906, and the nearby wood-frame garage, presumably built in the 1920s.

=====
**11. Form Prepared By**
=====

name/title Gail E. H. Evans

organization N/A date November 24, 1995

street & number 427 Grant Street telephone (503) 873-4131

city or town Silverton state OR zip code 97381

=====
**Property Owner**
=====

name Howard and Dorothy Hillis

street & number 96 SE 9th Street; P.O. Box 5 telephone \_\_\_\_\_

city or town Madras state OR zip code 97741



MADRAS

**LUEDDEMANN HOUSE**

NW 1/4 of NW 1/4, Sec. 12, T. 11 S, R. 13 E

Madras, Jefferson County, Oregon

CANCELLED T.L. 7901  
 6204  
 10600  
 4500  
 4501  
 2500  
 2600  
 5201  
 2800  
 2900  
 1200  
 8101  
 9090  
 9001  
 2800U-1  
 2800U-2  
 2900U-1  
 2900U-2  
 8802

1" = 100'

SEE MAP 11 13 ICC

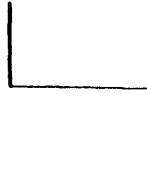
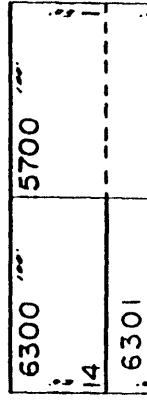
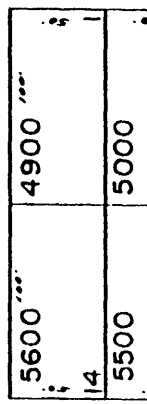
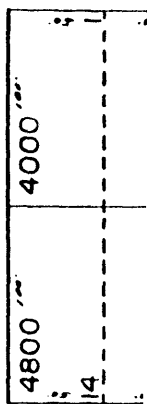
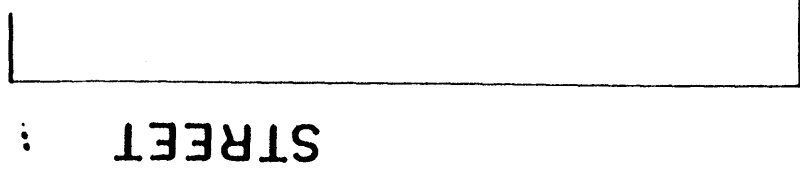
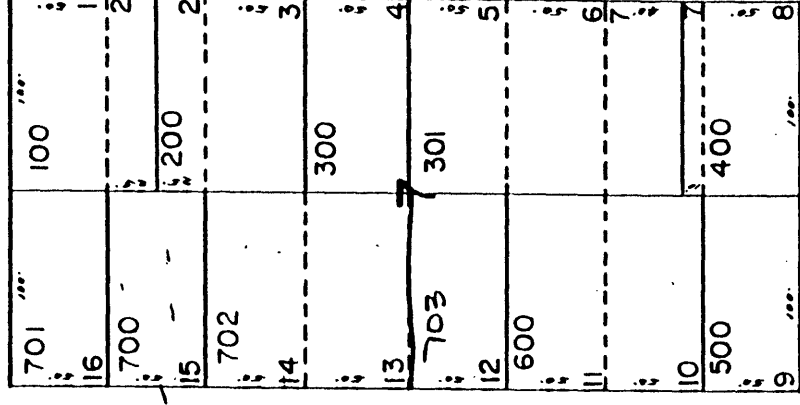
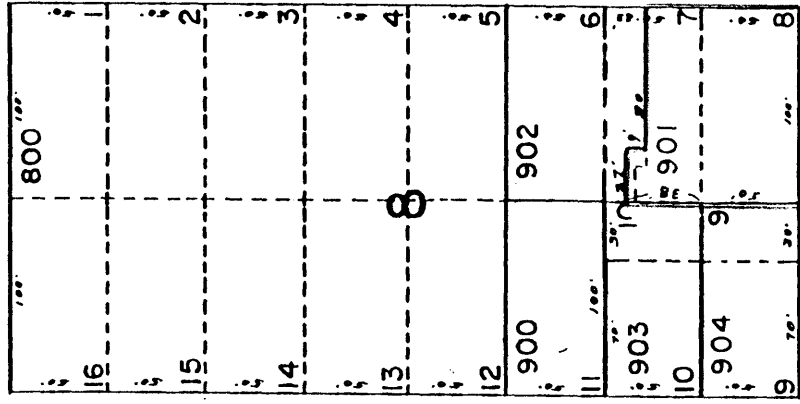
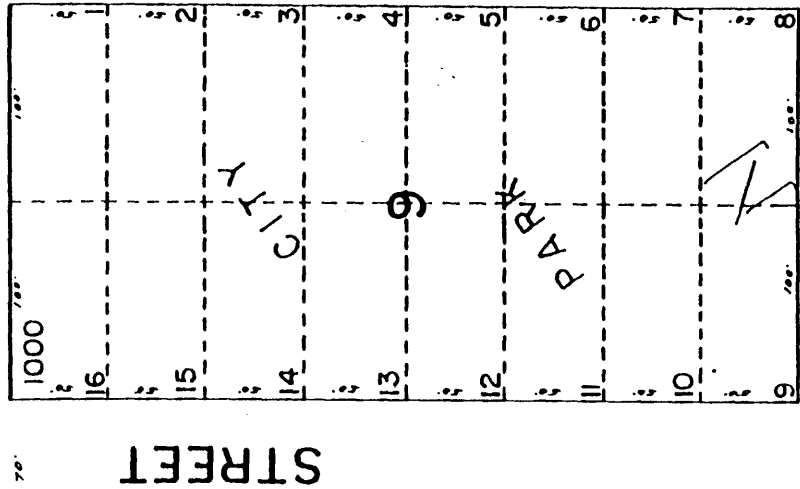
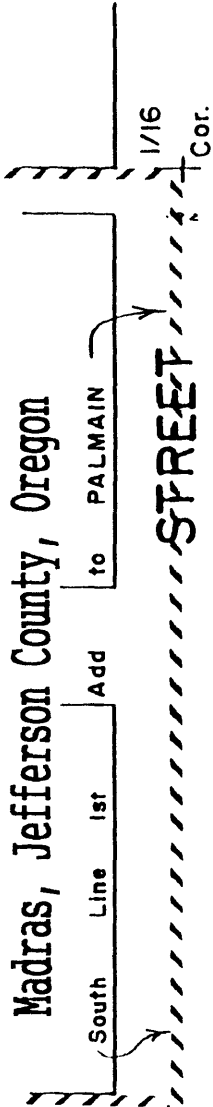

11 " C "

# LUEDDEMANN HOUSE

Madras, Jefferson County, Oregon

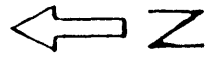

9TH STREET

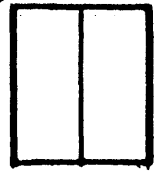
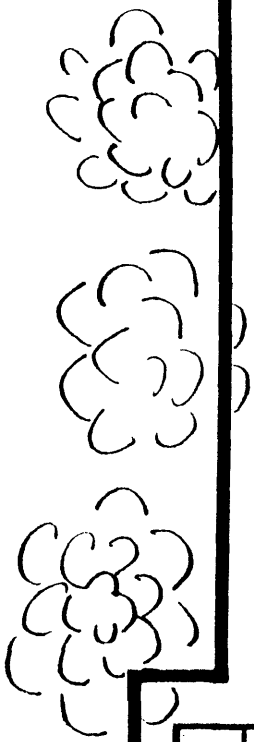

**GARAGE**  
(1910s-20s)

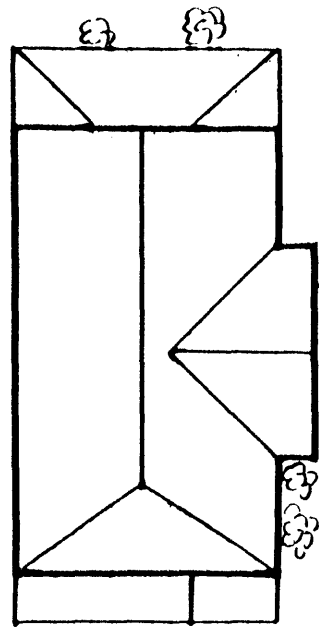

**HOUSE**  
(1905-1906)

C STREET

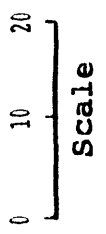

# LUEDDEMANN HOUSE

Madras, Jefferson County, Oregon

