

United States Department of the Interior
National Park Service

National Register of Historic Places Registration Form

This form is for use in nominating or requesting determinations for individual properties and districts. See instructions in *How to Complete the National Register of Historic Places Registration Form* (National Register Bulletin 16A). Complete each item by marking "x" in the appropriate box or by entering the information requested. If any item does not apply to the property being documented, enter "N/A" for "not applicable." For functions, architectural classification, materials, and areas of significance, enter only categories and subcategories from the instructions. Place additional entries and narrative items on continuation sheets (NPS Form 10-900a). Use a typewriter, word processor, or computer, to complete all items.

1. Name of Property

historic name Beckman, Andrew and Johanna M., Farm
other names/site number Beckman, John, Farm

2. Location

street & number 1/2 mile west of junction SR20 and New Sweden Road n/a not for publication
city or town Idaho Falls X vicinity
state Idaho code ID county Bonneville code 019 zip code 83401

3. State/Federal Agency Certification

As the designated authority under the National Historic Preservation Act of 1986, as amended, I hereby certify that this nomination request for determination of eligibility meets the documentation standards for registering properties in the National Register of Historic Places and meets the procedural and professional requirements set forth in 36 CFR Part 60. In my opinion, the property meets does not meet the National Register criteria. I recommend that this property be considered significant nationally statewide locally. (See continuation sheet for additional comments.)

[Signature] Sept. 18, 1992
Signature of certifying official Date
IDAHO STATE HISTORIC PRESERVATION OFFICER
State or Federal agency and bureau

In my opinion, the property meets does not meet the National Register criteria. (See continuation sheet for additional comments.)

Signature of commenting or other official Date

State or Federal agency and bureau

4. National Park Service Certification

I, hereby, certify that this property is:
 entered in the National Register. Patrick Andrews 11/6/92
 See continuation sheet
 determined eligible for the National Register. See continuation sheet
 determined not eligible for the National Register.
 removed from the National Register.
 other, (explain:)

[Signature] _____
Signature of Keeper Date of Action

Property Name Beckman, Andrew and Johanna M., Farm

County and State Bonneville County, Idaho

Page 2

5. Classification

Ownership of Property	Category of Property	No. of Resources within Property	
		contributing	noncontributing
<input checked="" type="checkbox"/> private	<input checked="" type="checkbox"/> building(s)		
<input type="checkbox"/> public-local	<input type="checkbox"/> district	<u>13</u>	<u>1</u> buildings
<input type="checkbox"/> public-State	<input type="checkbox"/> site	<u>2</u>	<input type="checkbox"/> sites
<input type="checkbox"/> public-Federal	<input type="checkbox"/> structure	<u>5</u>	<input type="checkbox"/> structures
	<input type="checkbox"/> object	<u>0</u>	<input type="checkbox"/> objects
		<u>20</u>	<u>1</u> Total

Name of related multiple property listing: _____ No. of contributing resources previously listed in the National Register: 0

New Sweden and Riverview Farmsteads and Institutional Buildings, 1894-1941

6. Functions or Use

Historic Functions (Enter categories from instructions.)

Cat: DOMESTIC Sub: agriculture/subsistence

Current Functions (Enter categories from instructions.)

Cat: DOMESTIC Sub: agriculture/subsistence

7. Description

Architectural Classification (Enter categories from instructions.)

Queen Anne

Materials (Enter categories from instructions.)

foundation earth, stone, concrete

walls wood, metal

roof wood

other _____

Narrative Description (Describe the historic and current condition of the property on one or more continuation sheets.)

Property Name Beckman, Andrew and Johanna M., Farm

County and State Bonneville County, Idaho

8. Statement of Significance

Applicable National Register Criteria (Mark "x" in one or more boxes for the criteria qualifying the property for National Register listing.)

- A Property is associated with events that have made a significant contribution to the broad patterns of our history.
- B Property is associated with the lives of persons significant in our past.
- C Property embodies the distinctive characteristics of a type, period, or method of construction or represents the work of a master, or possesses high artistic values, or represents a significant and distinguishable entity whose components lack individual distinction.
- D Property has yielded, or is likely to yield, information important in prehistory or history.

Criteria Considerations (Mark "x" in all the boxes that apply.) N/A

- A owned by a religious institution or used for religious purposes.
- B removed from its original location.
- C a birthplace or a grave.
- D a cemetery.
- E a reconstructed building, object, or structure.
- F a commemorative property.
- G less than 50 years of age or achieved significance within the past 50 years.

Areas of Significance

(Enter categories from instructions.)

Areas of Significance	Period of Significance	Significant Dates
<u>ARCHITECTURE</u>	<u>1894-1941</u>	<u>1894, 1906,</u>
<u>ETHNIC HERITAGE</u>	<u></u>	<u>1907, 1912</u>
<u>EXPLORATION/SETTLEMENT</u>	<u></u>	<u></u>
<u></u>	<u></u>	<u></u>
<u></u>	<u></u>	<u></u>
<u></u>	<u></u>	<u></u>
<u></u>	<u></u>	<u></u>
<u></u>	<u></u>	<u></u>

Cultural Affiliation

N/A

Significant Person

N/A

Architect/Builder

P.A. Lundblade (house), Jacob Severin Adolphson (barn),
John Beckman (machine shed), Simon & Axel Stoneberg,
(stone wall)

Narrative Statement of Significance (Explain the significance of the property on one or more continuation sheets.)

Property Name Beckman, Andrew and Johanna M., Farm

County and State Bonneville County, Idaho

Page 4

9. Major Bibliographical References

(Cite the books, articles, and other sources used in preparing this form on one or more continuation sheets.)

Previous documentation on file (NPS): N/A
___ preliminary determination of individual listing (36 CFR 67) has been requested
___ previously listed in the National Register
___ previously determined eligible by the National Register
___ designated a National Historic Landmark
___ recorded by Historic American Buildings Survey # _____
___ recorded by Historic American Engineering Record # _____

Primary location of additional data:
 State Historic Preservation Office
___ Other State agency
___ Federal agency
___ Local government
___ University
___ Other
Specify repository: _____

10. Geographical Data

Acreage of property 160

UTM References

1	<u>1/2</u>	<u>4/0/7/7/0/0</u>	<u>4/8/1/6/4/5/0</u>	3	<u>1/2</u>	<u>4/0/8/5/1/0</u>	<u>4/8/1/5/6/5/0</u>
	Zone	Easting	Northing		Zone	Easting	Northing
2	<u>1/2</u>	<u>4/0/8/5/1/0</u>	<u>4/8/1/6/4/5/0</u>	4	<u>1/2</u>	<u>4/0/7/7/0/0</u>	<u>4/8/1/5/6/5/0</u>

___ See continuation sheet

Verbal Boundary Description (Describe the boundaries of the property on a continuation sheet.)

Boundary Justification (Explain why the boundaries were selected on a continuation sheet.)

11. Form Prepared By

name/title Jennifer Eastman Attebery, Architectural Historian
organization Idaho State Historical Society date July 27, 1992
street & number 210 Main Street telephone (208) 334-3861
city or town Boise state Idaho zip code 83702

Additional Documentation

Submit the following items with the completed form:

Continuation Sheets

Maps

- A USGS map (7.5 or 15 minute series) indicating the property's location.
- A sketch map for historic districts and properties having large acreage or numerous resources.

Photographs

Representative black and white photographs of the property.

Additional items (Check with the SHPO or FPO for any additional items.)

Property Owner

(Complete this item at the request of the SHPO or FPO.)

name _____
street & number _____ telephone _____
city or town _____ state _____ zip code _____

United States Department of the Interior
National Park Service

National Register of Historic Places Continuation Sheet

Section number 7 Page 1 Name of Property Beckman, Andrew and Johanna M., Farm
County and State Bonneville County, Idaho

The Andrew and Johanna M. Beckman Farm is located on a private lane leading south off of U.S. Highway 20 one-half mile west of the intersection of Highway 20 and New Sweden-Shelley Road. The farmstead plan is a scattered one in which there are two main groupings of buildings and structures that lie on two levels. The first--upper--group is domestic and includes the house, tenant house, automobile garage/shop, and granary. The second group lies below a bluff that is stabilized with a stone wall and consists of agricultural buildings and structures. Five of these properties take advantage of the bluff either by having upper and lower levels (buildings 7 and 8) or by being dug into the bluff (buildings 11, 12, 15). Access to the domestic part of the farmstead is via a lane off of Highway 20. Access to the agricultural part of the farmstead is via several lanes branching off of the domestic lane south of the tenant house.

The agricultural group of buildings is separated from the domestic grouping by landscaping, the domestic area having lawn and flower beds, as well as through topography. The main house and tenant house are further distinguished from the red-painted outbuildings by their white paint. The property includes the remnants of two orchards, one between buildings 9 and 17, and one northeast of the house. Mature trees surrounding the house and lining the lane into the property contribute to the property's historic associations.

Inventory:

1. house (building) contributory
built 1907
carpenter: P. A. Lundblade

A one and one-half story Queen Anne-style house with a shingled gabled roof, gabled wall dormer centered on the front wall, decorative gable ornaments, and decoratively cut bargeboards. The gable ornament on the north incorporates the date 1907. These decorative treatments and details such as round molding set at the building's corners are evidence of careful craftsmanship. The building is frame with shiplap siding. It sits on a basalt foundation. The front is three-bays wide, with the central bay occupied by the front door. The interior has a double-pile four-room plan reminiscent of the Swedish four-room farmhouses of the late 1800's. More recent alterations include an addition to the south side in 1954 and another in 1989. Although these are large, they are compatible and they leave the original structure as an entirely separate section. Other alterations in 1954 include replacing a few windows, enclosing the front porch, converting the heating system from coal to oil, replastering on the interior, lowering ceilings in the two front rooms, and adding a main-floor bathroom in closet space.

United States Department of the Interior
National Park ServiceNational Register of Historic Places
Continuation Sheet

Section number 7 Page 2 Name of Property Beckman, Andrew and Johanna M., Farm
County and State Bonneville County, Idaho

2. tenant house (building) contributory
built before 1923
moved from field 2 in early 1940's

A one-story wood frame house with a shingled gabled roof. The building has a three-room plan similar to the Swedish enkelstuga. A rear lean-to ell was added to create a bathroom when the building was moved. The building is painted white.

3. automobile garage/shop (building) contributory
built before 1923

A one-story wood frame building with shiplap siding, a dirt floor, and a shingled gabled roof. The building is painted red.

4. granary (building) contributory
built before 1923

A one-story wood frame building with a concrete floor and a shingled gabled roof. On the interior bins are of horizontal milled lumber. The building is painted red.

5. scale shed (building) contributory
built before 1923

A one-story wood-braced frame building with a shingled gabled roof and a dirt floor. On the interior the scales are still intact. The building is painted red.

6. barn (building) contributory
built ca. 1912
carpenter: Jacob Severin Adolphson

A wood-stud frame barn with a loft and pointed hay hood. The building has shiplap siding and a dirt floor. The gabled roof and pyramidal-roofed cupola are shingled. The building is painted red.

United States Department of the Interior
National Park ServiceNational Register of Historic Places
Continuation SheetSection number 7 Page 3 Name of Property Beckman, Andrew and Johanna M., Farm
County and State Bonneville County, Idaho

7. machine shed/loafing shed (building) non-contributory
built 1949
carpenter: John Beckman

A wood-frame building with shiplap siding painted red. The building has a dirt floor and a shingled gabled roof. The loafing shed opens onto the building's lower level, and the machine shed onto its upper level.

8. barn (building) contributory
built ca. 1910-20

This building has been used variously as a hog house (1923), cow barn, and sheep barn (1930s). Hay was put up with a sling in the second level. The stone wall (19) is continuous with the foundation of this building. The building has a basalt and concrete foundation, wood flooring, and braced frame walls with shiplap siding painted red. Attached to the rear wall is a wood-stud frame ell used as a chicken house. The gabled roof and pyramidal-roofed cupola are shingled.

9. hog house (building) contributory
built before 1915

A one-story wood frame building with red-painted shiplap siding. The roof is gabled and shingled. The foundation is concrete.

10. shed (building) contributory

A one-story building that is box-constructed with a stud-frame end wall on the southern exposure. The gabled roof is shingled. The building is painted red.

11. spud cellar (building) contributory
built late 1920s

A spud cellar dug into the bluff with post and beam supports and a basalt masonry front wall. Supports are a combination of wood timbers, lumber, and poles. The roof is made of wire, sticks, straws, and dirt.

United States Department of the Interior
National Park Service

National Register of Historic Places Continuation Sheet

Section number 7 Page 4 Name of Property Beckman, Andrew and Johanna M., Farm

County and State Bonneville County, Idaho

12. spud cellar (building) contributory
built late 1920s

A spud cellar dug into the bluff with post and beam supports and a frame front wall. Supports are wood poles, timbers, and lumber.

13. blacksmith shop (building) contributory
built before 1907

A one-story, box-constructed building with a gabled roof. The building still has its concrete forge. The building appears never to have been painted.

14. spud cellar (site) contributory
built before 1920

Ruins of a potato cellar

15. dugout house (site) contributory
ca. 1894

Ruins of a one-room house with separate pantry, still evidenced by a depression with lumber and poles.

16. windmill (object) contributory
1906

A prefabricated metal windmill.

17. swathing shed (building) contributory
late 1930s-early 1940s

A one-story wood-frame building, unpainted.

United States Department of the Interior
National Park Service

National Register of Historic Places Continuation Sheet

Section number 7 Page 5 Name of Property Beckman, Andrew and Johanna M., Farm
County and State Bonneville County, Idaho

18. cistern (object) contributory
 before 1924

An elevated metal cistern with gravity delivery system. It held water for stock.

19. stone wall (structure) contributory
 constructed by Simon and Axel Stoneberg

A basalt masonry retaining wall.

20. irrigation system (structure)
 1890s

The irrigation system delivers water by gravity from the Beckman and Sinkhole canals.

21. field system (site)
 before 1928

The field system consists of thirteen fields (see map) with an irregular configuration. With the exception of a few areas not broken out of sagebrush, fields are graded to allow the irrigation system to deliver water by gravity from the Sinkhole and Beckman canals. Field grading is original with the exception of areas in fields 1 and 10 where high spots had to be leveled in the 1940s. The west part of field 8 is the earliest area cleared and cultivated; it has later been used as pasture. The strip between Sinkhole Canal and Faust Road and the south portion of field 7 are left in sagebrush but irrigated and used as pasture. The remainder of field 7 is broken out of sagebrush and used as pasture. On all other fields a rotation of potatoes, peas, grain, and alfalfa were grown. Fences are original cedar post and barbed wire, with some post replacement.

United States Department of the Interior
National Park Service

National Register of Historic Places Continuation Sheet

Section number 8 Page 1 Name of Property Beckman, Andrew and Johanna M., Farm
County and State Bonneville County, Idaho

The Andrew and Johanna M. Beckman Farm is historically significant for its association with the settlement and development of the rural ethnic community of New Sweden (criteria A). The farm reflects the ethnic heritage of its builders and their creative adaptation of ethnic heritage to American lifeways. The farm is architecturally significant for its display of Swedish and American farm layout, architectural styles, house plans, and construction materials and techniques as they were used by Swedish-American builders (criteria C).

The Andrew and Johanna M. Beckman Farm represents all three eras of settlement and development in New Sweden. In its current configuration, the farm includes 21 buildings, structures, and sites, 20 of which date from the period 1894 to 1941 and survive with good integrity. No significant buildings have been lost from the assemblage, and the one building that has been moved was moved into the complex within the period of significance. The farm also retains its original rural settings. Individual buildings retain their architectural character sufficient to represent the styles, types, layouts, materials, and construction techniques from the period of significance. The house is the most compromised of the buildings, but it retains its essential stylistic and typological features sufficient to convey the association with its period of construction. In the context of other extant New Sweden farms, this farm as a whole possesses excellent integrity of location, design, setting, materials, workmanship, feeling, and association.

The majority of the farm's buildings date from the period of community building (1905-1920). In particular, the farm includes a 1907 farmhouse that reflects the use of Queen Anne style and the adaptation of a four-room Swedish plan, a tenant house that reflects the adaptation of the Swedish *enkelstuga* plan, distinct domestic and farmyard building groupings, and a variety of outbuildings, typically painted red. In addition the farm has its historic field system and irrigation system intact. The farmhouse, outbuildings, field and irrigation systems and their arrangement exhibit the cultural choices of the Beckmans and two of the area's skillful Swedish-American farmer-carpenters, P.A. Lundblade and Jacob Severin Adolphson. As discussed at some length in the New Sweden and Riverview MPL, these cultural choices represent a creative blending of American and Swedish heritages and a dramatic adaptation to new farming conditions in the arid West.

Andrew Beckman was among the earliest New Sweden immigrants. Beckman emigrated from Sweden in May 1888 at the age of 24. He was born Anders Johansson in Humla, Vaestergoetland, where his family had a farm, Beckagaarden. Andrew was the oldest and the first of four brothers who came to the United States, the others being Oscar and Gust Beckman and Charles Holmer. The eldest three brothers took the name Beckman after the family farm in Sweden. Charles took the name Holmer, which according to the family was the name he adopted when joining the Swedish military.

United States Department of the Interior
National Park Service

National Register of Historic Places Continuation Sheet

Section number 8 Page 2 Name of Property Beckman, Andrew and Johanna M., Farm
County and State Bonneville County, Idaho

Before emigrating Beckman worked on the family farm at Humla. In the United States he traveled first to relatives at Wakefield, Nebraska. He settled for six years at Oakland, Nebraska, where he worked on a farm. He moved to New Sweden, Idaho, in August 1894. In 1899 he became a naturalized United States citizen. In New Sweden, Beckman was among those early settlers who organized the New Sweden Irrigation District, the New Sweden Mission Church, the New Sweden Cemetery, the Bingham County Farmers Mutual Insurance Company, and the New Sweden Pioneer Association. He served as irrigation district director (1903-11 and 1917-18), church board trustee and chairman/treasurer, and first president of the pioneer association. Beckman was one of the early church chairmen, an incorporator of the church in 1906, and the last chairman of the church. During his tenure as church board chairman and treasurer he oversaw dissolution of the church and distribution of its assets in 1930-31. Beckman also assisted his neighboring Swedish-Americans in an unofficial capacity as an advisor and co-signer in matters such as farm loans and recording of official documents.

Johanna Mathilda Beckman (nee Johnson) emigrated from Sweden in April 1892 at the age of 20. Johanna was known as Hannah and appears as such in most local records. She was born in Rumskulla, Kalmar laen. In the United States she lived in Oakland, Nebraska, where she worked on a farm, until February 1895, when she came to New Sweden. She and Andrew Beckman were married in New Sweden in August 1895. The Beckmans joined the newly established New Sweden Mission Church in 1896, pledging monthly donations to support the church in its efforts to construct a building and hire a pastor. They raised three children--John, Hanna, and Ruth. John took over the family farm.

Andrew and Johanna Beckman established their farm in New Sweden through a combination of homesteading and purchasing of land, eventually consolidating their ownership of 160 acres by the mid-1910s. The Beckman's presence in New Sweden encouraged at least four other families to come to the area. Andrew's brothers followed to establish farms close by. (In 1928 their brother Werner Johansson, who had stayed in Sweden, purchased Beckagaarden from them.) Johanna's brother August J. Johnson lived with the family for a time before establishing his own farm in New Sweden.

The Beckmans' land was irrigated by the Beckman and Sinkhole canals on the Great Western Canal system. By the mid-1920s, 106 acres were under irrigation and the west half of the farm was leased to John Fransen, who used the tenant house there (building 2). The Beckmans raised potatoes, peas, grain (wheat, barley, oats), and alfalfa in rotation, with potatoes serving as the real cash crop. They kept a few chickens, cows, hogs, and work and stock horses, keeping work horses into the late 1920s even though their first tractor was purchased around 1925. In the early 1930s they added sheep to the farm, purchasing a number of American Hampshire ewes.

United States Department of the Interior
National Park Service

National Register of Historic Places Continuation Sheet

Section number 9 Page 1 Name of Property Beckman, Andrew and Johanna M., Farm
County and State Bonneville County, Idaho

Anderson, Charles E., et. al. After Fifty Years. Caldwell, Idaho: Caxton Printers, 1941. Pp. 42, 43, 45, 53, 61, 62, 64, 84, 87, 89.

Beckman, John. Interview with Jennifer Eastman Attebery, 20 April 1992; letter to same, 23 April 1991.

Bonneville County deed records.

Documents relating to farm insurance, farm leases, real estate taxes, personal collection of Muriel Lough, Idaho Falls, Idaho.

Metsker. Bonneville County map. 1940.

Membership book and minute book, New Sweden Mission church records. On file at Swenson Swedish Immigration Center, Augustana College, Rock Island, Illinois.

U.S. Census. 1900, 1910.

United States Department of the Interior
National Park Service

National Register of Historic Places Continuation Sheet

Section number 10 Page 1 Name of Property Beckman, Andrew and Johanna M., Farm

County and State Bonneville County, Idaho

VERBAL BOUNDARY DESCRIPTION

The nomination includes the Andrew and Johanna M. Beckman Farm and the property on which it is located, the NW4 section 20 T2N R37E, Boise Meridian.



United States Department of the Interior
National Park Service

National Register of Historic Places

Continuation Sheet

Section number 10 Page 2 Name of Property Beckman, Andrew and Johanna M., Farm
County and State Bonneville County, Idaho

BOUNDARY JUSTIFICATION

Boundaries for the nomination are identical to boundaries for the Andrew and Johanna M. Beckman Farm as it was acquired and developed by the Beckmans during the period of significance.

State Highway 20

Andrew and Johanna M.
Beckman Farm
Bonnerville County, Idaho
Site Plan

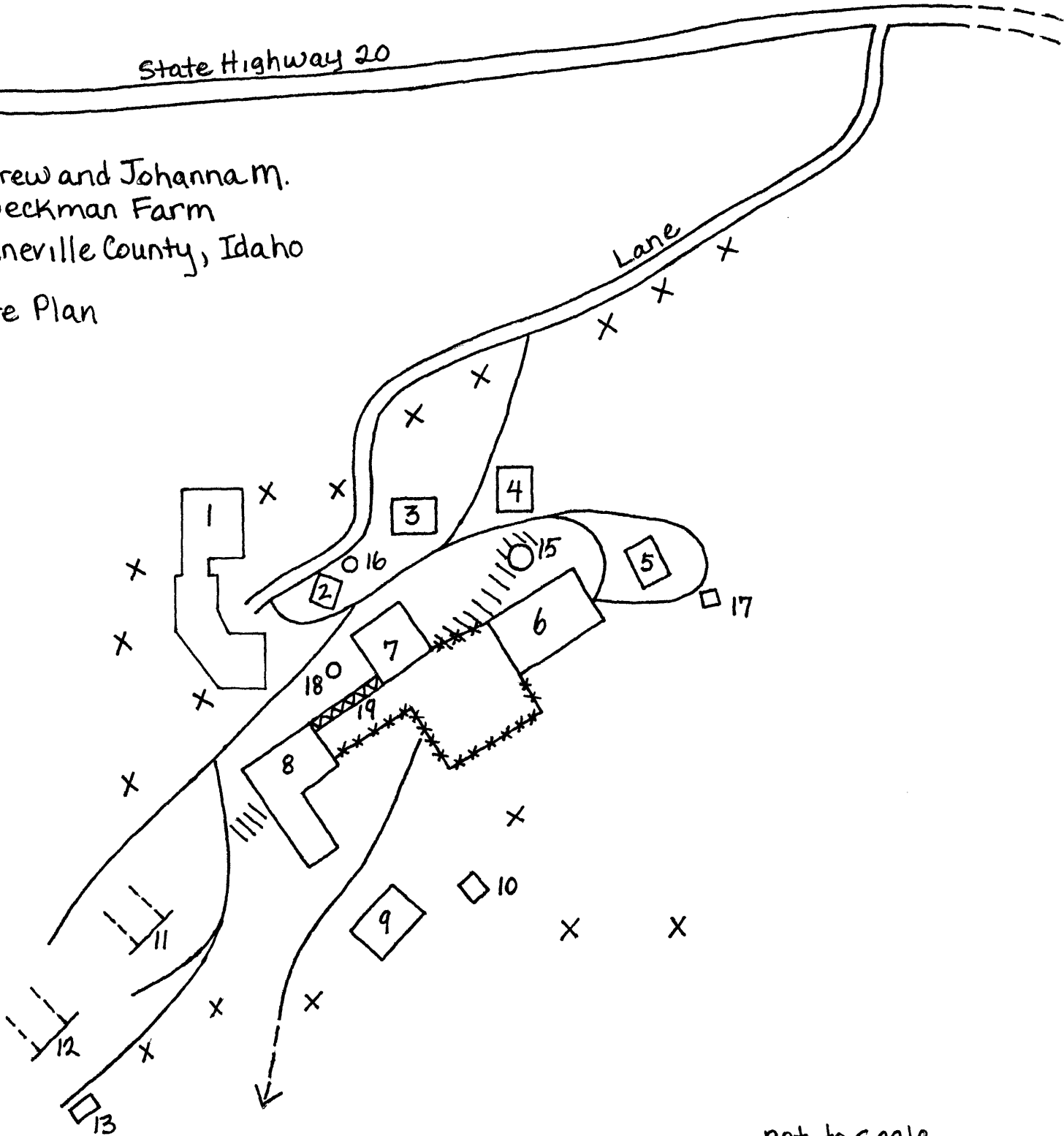

not to scale
Map 1 of 2

- **** fence
- ||||| bluff
- x trees
- ▲▲▲▲ stone fence (19)
- lanes



State Highway 20

State Highway 20 To Idaho Falls

Faust Road

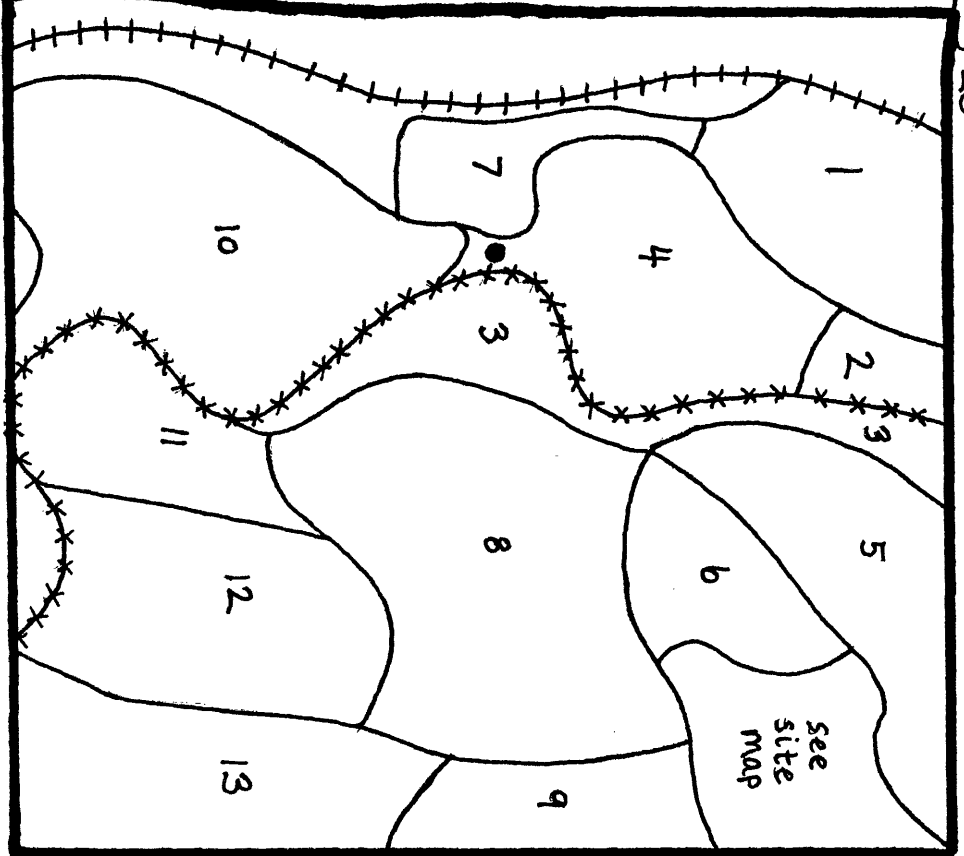

Andrew and Johanna M.
 Beckman Farm
 Bonneville County, Idaho
 Field System
 Inventory Item No. 21

- +++++ Sinkhole Lateral
- ***** Oakland Waste
- Spud Cellar (Inventory Item No. 14)
- # Cultivated Fields
- National Register Boundary

not to scale
 Map 2 of 2
 ↑ N

United States Department of the Interior
National Park Service

National Register of Historic Places
Continuation Sheet

Section number _____ Page _____

SUPPLEMENTARY LISTING RECORD

NRIS Reference Number: 92001414

Date Listed: 11/6/92

Beckman, Andrew and Johanna M., Farm
Property Name

Bonneville
County

ID
State

New Sweden and Riverview Farmsteads and Institutional Buildings
Multiple Name

This property is listed in the National Register of Historic Places in accordance with the attached nomination documentation subject to the following exceptions, exclusions, or amendments, notwithstanding the National Park Service certification included in the nomination documentation.

for Patrick Andrus
Signature of the Keeper

11/24/92
Date of Action

=====
Amended Items in Nomination:

Function or Use: Both the historic and current functions are amended to read: Domestic/single dwelling, Domestic/secondary structure, Agriculture/subsistence/animal facility, agricultural outbuilding, storage, agricultural field, and irrigation facility.

Classification: The total count of resources is amended to read:

	contributing	noncontributing	
	<u>13</u>	<u>1</u>	buildings
	<u>3</u>	<u>0</u>	sites
	<u>4</u>	<u>0</u>	structures
	<u>0</u>	<u>0</u>	objects
	<u>20</u>	<u>1</u>	Total

(continued)

**United States Department of the Interior
National Park Service**

**National Register of Historic Places
Continuation Sheet**

Section number _____ Page _____

SUPPLEMENTARY LISTING RECORD

NRIS Reference Number: 92001414 Date Listed: 11/6/92

Beckman, Andrew and Johanna M., Farm
Property Name

Bonneville **ID**
County **State**

New Sweden and Riverview Farmsteads and Institutional Buildings
Multiple Name

=====

Description: The proper resource type for the windmill and cistern noted on pages 7-4 and 7-5 respectively is amended to read structure.

Verbal Boundary Description:
The verbal boundary description has been amended to include the entire NW quarter of section 20 T2N R37E. The new boundary is also delineated on the sketch map and USGS map attached as part of the nomination documentation.

UTM: The UTM reference numbers have been amended to read:
1. 12 407700 4816450
2. 12 408510 4816450
3. 12 408510 4815650
4. 12 407700 4815650

This information was confirmed with Ann Swanson of the Idaho State Historic Preservation Office.

DISTRIBUTION:
National Register property file
Nominating Authority (without nomination attachment)