

**United States Department of the Interior
Heritage Conservation and Recreation Service**



**National Register of Historic Places
Inventory—Nomination Form**

See instructions in *How to Complete National Register Forms*
Type all entries—complete applicable sections

1. Name

historic Rectory, Catholic Church of the Assumption

and/or common Old Catholic Rectory

2. Location

street & number 563 Ocean Avenue _____ not for publication

city, town Ferndale _____ vicinity of congressional district Second

state Calif. code 06 county Humboldt code 023

3. Classification

Category	Ownership	Status	Present Use
<input type="checkbox"/> district	<input type="checkbox"/> public	<input checked="" type="checkbox"/> occupied	<input type="checkbox"/> agriculture
<input checked="" type="checkbox"/> building(s)	<input checked="" type="checkbox"/> private	<input type="checkbox"/> unoccupied	<input type="checkbox"/> commercial
<input type="checkbox"/> structure	<input type="checkbox"/> both	<input type="checkbox"/> work in progress	<input type="checkbox"/> educational
<input type="checkbox"/> site	Public Acquisition	Accessible	<input type="checkbox"/> entertainment
<input type="checkbox"/> object	<input type="checkbox"/> in process	<input checked="" type="checkbox"/> yes: restricted	<input type="checkbox"/> government
	<input type="checkbox"/> being considered	<input type="checkbox"/> yes: unrestricted	<input type="checkbox"/> industrial
		<input type="checkbox"/> no	<input type="checkbox"/> military
			<input type="checkbox"/> museum
			<input type="checkbox"/> park
			<input checked="" type="checkbox"/> private residence
			<input type="checkbox"/> religious
			<input type="checkbox"/> scientific
			<input type="checkbox"/> transportation
			<input type="checkbox"/> other:

4. Owner of Property

name Jerry Lesandro and Larry Martin

street & number 563 Ocean Avenue

city, town Ferndale _____ vicinity of state Calif. 95536

5. Location of Legal Description

courthouse, registry of deeds, etc. Humboldt County Courthouse

street & number 825 Fifth Street

city, town Eureka _____ state Calif. 95501

6. Representation in Existing Surveys

title Ferndale Historical Committee has this property been determined eligible? yes no

date 1973 _____ federal _____ state _____ county local

depository for survey records Ferndale Historical Committee

city, town Ferndale _____ state Calif. 95536

7. Description

Condition		Check one	Check one	
<input checked="" type="checkbox"/> excellent	<input type="checkbox"/> deteriorated	<input type="checkbox"/> unaltered	<input type="checkbox"/> original site	
<input type="checkbox"/> good	<input type="checkbox"/> ruins	<input checked="" type="checkbox"/> altered	<input checked="" type="checkbox"/> moved	date <u>1964</u>
<input type="checkbox"/> fair	<input type="checkbox"/> unexposed			

Describe the present and original (if known) physical appearance

Relocated in 1964 from its original site next to the Catholic Church, the old parish Rectory is a beautifully-restored example of Queen Anne/Eastlake architecture. Built in 1884, the original structure consisted of a two-story front section with a rear one-story kitchen. According to Julius and Frank Moranda, residents of the Ferndale area for more than ninety years, the one-story library on the northwest side was added about 1900. Moved to its present site to escape demolition, the Rectory enjoys a measure of privacy with hedges and plantings across the front and along both sides. An old-fashioned fence of square pickets atop a solid base extends the length of the front and the southeast side. A wide gate and walk lead directly to the porch steps and the double door entrance. Yard ornaments--fish pond, bird bath, and statuary, including St. Francis of Assisi--are tastefully integrated into the lovely curvilinear flowerbeds whose color and design create a formal, yet inviting garden setting. Lattice work surrounds an open patio and provides the structure for a glass-topped greenhouse in the rear side yard. A small garage serves as one side of the patio and the greenhouse where hanging fuchsias and potted plants in redwood boxes decorate the interior. The rear property line is marked by a lattice fence of large squares.

Of tall proportions with a steep hipped roof and projecting gables on the front and southeast side above two-story bays, the Rectory is decorated with Stick and Eastlake ornamentation. The library addition, however, has a flat roof with jig-saw cresting, but is tied to the main house by the porch extension, stained glass window panes, and the scroll-shaped brackets. The entrance porch, covered by a roof of fancy shingles, is supported by three pairs of tapered round posts and decorated with robust balusters and a frieze of small squares with circle cutouts. Atop the porch roof above the entrance steps is a small pediment with a cutout applique. Below a large divided transom are double doors with single glass panes above cutout appliques. In the second story above the entrance are two, narrow windows separated by horizontal stick decoration. Window molding on both bay and house windows is grooved and terminates above the upper-story windows in large, scroll-shaped brackets beneath wide eaves. Upper-story windows on the front and southeast side, as well as the porch windows in the addition, are decorated with panes of stained glass.

The focal points of the building's architecture are the two stacked bays. A pedimented gable tops the front bays which are squared with two narrow windows flanking a larger center window and single narrow windows on either side of each bay. Cutout appliques decorate panels above each window and the gable pediment which includes a small window of eight panes. The southeast side bays are slanted with three windows each and stand beneath a projecting gable decorated with an ornamental vergeboard and the same little squares used in the porch frieze. Cutout appliques decorate the little eight-pane window above the bays as well as the other windows, except the slant windows of the upper bay which are overhung by brackets and a single pendant. An ornamental band extending between the stories on the front and southeast side, consists of small diagonal strips and is accented by vertical, horizontal and diagonal boards applied between the windows and at the building's corners.

continued

FHR-8-300A
(11/78)

UNITED STATES DEPARTMENT OF THE INTERIOR
HERITAGE CONSERVATION AND RECREATION SERVICE

**NATIONAL REGISTER OF HISTORIC PLACES
INVENTORY -- NOMINATION FORM**

FOR HCRS USE ONLY
RECEIVED JAN 6 - 1982
DATE ENTERED FEB 11 1982

CONTINUATION SHEET

ITEM NUMBER 7 PAGE 1

The windows across the rear kitchen section and in the rear wall of the library addition are two-paned and without decoration. The building's north corner, however, is enclosed with four, large multi-paned windows to create a conservatory for plants. To the side of the conservatory is a full-height door leading to the Rectory's wine cellar. Construction material is redwood and siding is shiplap. New metal roof chimneys have been added to accommodate wood-burning stoves. Neighborhood setting includes the Ferndale Cemetery and old Methodist Church across the street, newer houses along Craig Street, and older buildings along Ocean Avenue.

3

8. Significance

Period	Areas of Significance—Check and justify below			
<input type="checkbox"/> prehistoric	<input type="checkbox"/> archeology-prehistoric	<input type="checkbox"/> community planning	<input type="checkbox"/> landscape architecture	<input checked="" type="checkbox"/> religion
<input type="checkbox"/> 1400-1499	<input type="checkbox"/> archeology-historic	<input type="checkbox"/> conservation	<input type="checkbox"/> law	<input type="checkbox"/> science
<input type="checkbox"/> 1500-1599	<input type="checkbox"/> agriculture	<input type="checkbox"/> economics	<input type="checkbox"/> literature	<input type="checkbox"/> sculpture
<input type="checkbox"/> 1600-1699	<input checked="" type="checkbox"/> architecture	<input type="checkbox"/> education	<input type="checkbox"/> military	<input type="checkbox"/> social/
<input type="checkbox"/> 1700-1799	<input type="checkbox"/> art	<input type="checkbox"/> engineering	<input type="checkbox"/> music	<input type="checkbox"/> humanitarian
<input checked="" type="checkbox"/> 1800-1899	<input type="checkbox"/> commerce	<input type="checkbox"/> exploration/settlement	<input type="checkbox"/> philosophy	<input type="checkbox"/> theater
<input type="checkbox"/> 1900-	<input type="checkbox"/> communications	<input type="checkbox"/> industry	<input type="checkbox"/> politics/government	<input type="checkbox"/> transportation
		<input type="checkbox"/> invention		<input type="checkbox"/> other (specify)

Specific dates 1884

Builder/Architect George F. Costerisa

Statement of Significance (In one paragraph)

Ferndale's first Rectory for the Catholic Church of the Assumption is nominated to the National Register because it is a beautifully-preserved example of Queen Anne/Eastlake architecture. Although moved from its original site next to the Church, the Rectory has been carefully restored to its original elegance, both inside and out, and was considered significant enough to be identified as a key building when the town of Ferndale was designated a State Historical Landmark in 1975. Ornamental detail, applied to this stately residence, is primarily Stick/Eastlake and provides the "Victorian" touches that are so exciting. Despite the addition of the one-story library, the building's integrity is preserved with the addition architecturally tied to the original structure through the porch extension, porch posts, and cornice brackets. The Rectory's double lot, formal gardens, and beautiful wood fence provide supportive surroundings for the rich qualities of this handsome building.

In addition to its architectural significance, the Rectory is recognized as culturally important, having served the local Catholic parish for eighty years. Beginning in the 1870's, a circuit rider priest celebrated masses in a rented hall, but with the continued influx of Catholic settlers, the parish grew to a point which required a resident priest and the construction of a church. Located at the corner of Washington and Berding, the first church was completed in 1879 with Father Lawrence Kennedy as parish priest. In 1884 the Rectory was built alongside the church which was replaced with the present structure in 1896. Together they served not only the spiritual needs of newly-arrived immigrants from Ireland, Italy, Switzerland, and Portugal, but equally important, the emotional and physical needs of people far from the security of their native homes. The parish priest provided advice, comfort, and help in times of trouble and most certainly, the old Rectory was viewed as a kind of refuge for those in need. The depth of that relationship was revealed in the early 1960's when the proposal to demolish the Rectory was met with strong opposition including impassioned letters to the Pope asking that the building be saved.

Because it is a fine representative of its architectural type and period, a valuable part of Ferndale's heritage, and culturally important to the Catholic community, the Rectory for the Catholic Church of the Assumption is nominated to the National Register of Historic Places. Designation of this building will provide both protection for and recognition of the architectural and historical qualities of this most deserving building.

9. Major Bibliographical References

Ferndale Enterprise, 9 August 1884, Ferndale, Calif.
Ferndale Union High School Class of 1977, Where the Ferns Grew Tall, 1977.
Young, Jan. Ferndale Today and Yesterday, Ferndale Historical Comm., c. 1975

UTM NOT VERIFIED
ACREAGE NOT VERIFIED

10. Geographical Data

Acreage of nominated property .25
Quadrangle name Ferndale

Quadrangle scale 1:24,000

UMT References

A

1	0	3	9	3	2	2	0	4	4	9	2	1	2	0
Zone				Easting				Northing						

B

Zone				Easting				Northing						

C

Zone				Easting				Northing						

D

Zone				Easting				Northing						

E

Zone				Easting				Northing						

F

Zone				Easting				Northing						

G

Zone				Easting				Northing						

H

Zone				Easting				Northing						

Verbal boundary description and justification

Beginning at the north corner of Craig St. and Ocean Ave., thence NE along Craig 86.25', thence NW 120', thence SW 100' to Ocean Ave., thence along Ocean 120.78' to place of beginning.

List all states and counties for properties overlapping state or county boundaries

state n/a code county code

state code county code

11. Form Prepared By

name/title Susie Van Kirk

organization date 25 June 1980

street & number 1162 C Street telephone (707) 822-6066

city or town Arcata state Calif, 95521

12. State Historic Preservation Officer Certification

The evaluated significance of this property within the state is:

national state local

As the designated State Historic Preservation Officer for the National Historic Preservation Act of 1966 (Public Law 89-665), I hereby nominate this property for inclusion in the National Register and certify that it has been evaluated according to the criteria and procedures set forth by the Heritage Conservation and Recreation Service.

State Historic Preservation Officer signature [Signature]

title date 12-30-81

For HCERS use only
I hereby certify that this property is included in the National Register.
g/w [Signature]
Keeper of the National Register
Attest:
Chief of Register

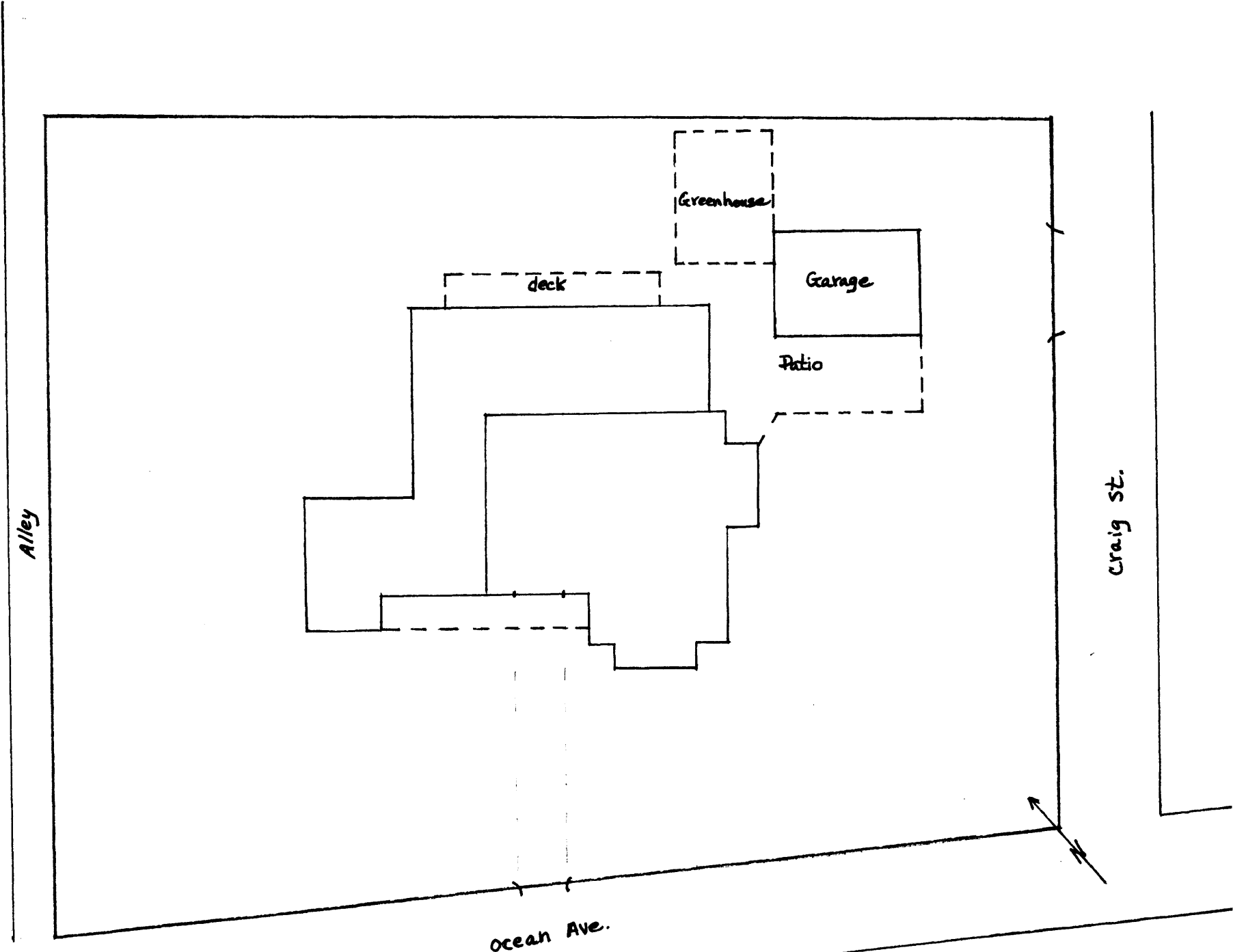

Alley

Greenhouse

deck

Garage

Patio

Craig St.

Ocean Ave.



Rectory, Catholic Church of the Assumption, AP# 31-094-04 ^{1sq = 2ft.}