

UNITED STATES DEPARTMENT OF THE INTERIOR
NATIONAL PARK SERVICE

THEME: Architecture

FOR NPS USE ONLY

RECEIVED

DATE ENTERED

**NATIONAL REGISTER OF HISTORIC PLACES
INVENTORY -- NOMINATION FORM**

SEE INSTRUCTIONS IN *HOW TO COMPLETE NATIONAL REGISTER FORMS*
TYPE ALL ENTRIES -- COMPLETE APPLICABLE SECTIONS

1 NAME

HISTORIC Santa Barbara Mission

AND/OR COMMON Santa Barbara Mission

2 LOCATION

STREET & NUMBER 2201 Laguna Street

CITY, TOWN Santa Barbara VICINITY OF 13th CONGRESSIONAL DISTRICT

STATE California CODE 06 COUNTY Santa Barbara CODE 083

3 CLASSIFICATION

CATEGORY	OWNERSHIP	STATUS	PRESENT USE
<input type="checkbox"/> DISTRICT	<input type="checkbox"/> PUBLIC	<input checked="" type="checkbox"/> OCCUPIED	<input type="checkbox"/> AGRICULTURE <input type="checkbox"/> MUSEUM
<input checked="" type="checkbox"/> BUILDING(S)	<input checked="" type="checkbox"/> PRIVATE	<input type="checkbox"/> UNOCCUPIED	<input type="checkbox"/> COMMERCIAL <input type="checkbox"/> PARK
<input type="checkbox"/> STRUCTURE	<input type="checkbox"/> BOTH	<input type="checkbox"/> WORK IN PROGRESS	<input type="checkbox"/> EDUCATIONAL <input type="checkbox"/> PRIVATE RESIDENCE
<input type="checkbox"/> SITE	PUBLIC ACQUISITION	ACCESSIBLE	<input type="checkbox"/> ENTERTAINMENT <input checked="" type="checkbox"/> RELIGIOUS
<input type="checkbox"/> OBJECT	<input type="checkbox"/> IN PROCESS	<input checked="" type="checkbox"/> YES: RESTRICTED	<input type="checkbox"/> GOVERNMENT <input type="checkbox"/> SCIENTIFIC
	<input type="checkbox"/> BEING CONSIDERED	<input type="checkbox"/> YES: UNRESTRICTED	<input type="checkbox"/> INDUSTRIAL <input type="checkbox"/> TRANSPORTATION
		<input type="checkbox"/> NO	<input type="checkbox"/> MILITARY <input type="checkbox"/> OTHER:

4 OWNER OF PROPERTY

NAME Franciscan Fathers of California

STREET & NUMBER 2201 Laguna Street

CITY, TOWN Santa Barbara VICINITY OF California STATE California

5 LOCATION OF LEGAL DESCRIPTION

COURTHOUSE, Santa Barbara County Registry of Deeds
REGISTRY OF DEEDS, ETC.

STREET & NUMBER
CITY, TOWN Santa Barbara STATE California

6 REPRESENTATION IN EXISTING SURVEYS

TITLE Historic American Buildings Survey (30 sheets, 11 photos)

DATE 1936 FEDERAL STATE COUNTY LOCAL

DEPOSITORY FOR SURVEY RECORDS Library of Congress/Annex Division of Prints and Photographs

CITY, TOWN Washington STATE D.C.

8 SIGNIFICANCE

PERIOD	AREAS OF SIGNIFICANCE -- CHECK AND JUSTIFY BELOW			
<input type="checkbox"/> PREHISTORIC	<input type="checkbox"/> ARCHEOLOGY-PREHISTORIC	<input type="checkbox"/> COMMUNITY PLANNING	<input type="checkbox"/> LANDSCAPE ARCHITECTURE	<input type="checkbox"/> RELIGION
<input type="checkbox"/> 1400-1499	<input type="checkbox"/> ARCHEOLOGY-HISTORIC	<input type="checkbox"/> CONSERVATION	<input type="checkbox"/> LAW	<input type="checkbox"/> SCIENCE
<input type="checkbox"/> 1500-1599	<input type="checkbox"/> AGRICULTURE	<input type="checkbox"/> ECONOMICS	<input type="checkbox"/> LITERATURE	<input type="checkbox"/> SCULPTURE
<input type="checkbox"/> 1600-1699	<input checked="" type="checkbox"/> ARCHITECTURE	<input type="checkbox"/> EDUCATION	<input type="checkbox"/> MILITARY	<input type="checkbox"/> SOCIAL/HUMANITARIAN
<input type="checkbox"/> 1700-1799	<input type="checkbox"/> ART	<input type="checkbox"/> ENGINEERING	<input type="checkbox"/> MUSIC	<input type="checkbox"/> THEATER
<input checked="" type="checkbox"/> 1800-1899	<input type="checkbox"/> COMMERCE	<input checked="" type="checkbox"/> EXPLORATION/SETTLEMENT	<input type="checkbox"/> PHILOSOPHY	<input type="checkbox"/> TRANSPORTATION
<input type="checkbox"/> 1900-	<input type="checkbox"/> COMMUNICATIONS	<input type="checkbox"/> INDUSTRY	<input type="checkbox"/> POLITICS/GOVERNMENT	<input type="checkbox"/> OTHER (SPECIFY)
		<input type="checkbox"/> INVENTION		

SPECIFIC DATES 1815-20

BUILDER/ARCHITECT

STATEMENT OF SIGNIFICANCE

Built in 1815-1820, the Santa Barbara Mission church was probably not only the finest and most distinguished of the 21 California mission churches from an architectural standpoint, but it was also the only original mission church to survive unaltered and in good condition into the 20th century.

HISTORY

Father Fermin Francisco de Lasuen consecrated Santa Barbara Mission on December 16, 1786, as the 10th California mission. The first chapel, erected in 1787 and measuring 39 by 14 feet, was a log, palisaded building with a grass roof and earthen floor. The second church, measuring 83 by 17 feet, with tile roof and built of adobe, was constructed in 1789. This was replaced by the even larger third church in 1793-94. Also built of adobe, with a tile roof, and measuring 125 by 26 feet, the third church was destroyed by the great earthquake of 1812.

The fourth church, the prototype of the present stone church, was begun in 1815 and was largely completed by 1820. Construction was performed by a labor force of Canalino Indians, who were probably directed by Jose Antonio Ramirez, a Mexican master stonemason.

The mission also had the usual buildings, such as the residence for padres, workshops, and storehouses. By 1803, some 1,792 Indian neophytes lived in 234 adobe huts surrounding the mission. By 1820 this number had fallen to 1,132 and by 1839 to 246.

Also constructed by Indian labor between 1806 and 1808 was a remarkable irrigation system, which included a large dam across Pedregoso Creek, a mile and a half north of the mission. Below this was a reservoir to work a grist-mill; (constructed in 1827-28) and an aqueduct system which provided purified water for the mission.

Mission Santa Barbara escaped the neglect and decay which affected all the other California missions after secularization. Although Santa Barbara was secularized in 1834 and finally sold in 1846, the Franciscan fathers continued to occupy the mission buildings during this transitional period. At this time the mission became the Franciscan capital of California, home of the last father-president, and in 1842 California's first bishop arrived at Santa Barbara to establish his see at the mission, and to administer the affairs of his diocese, which included all of Upper and Lower California.

(Continued)

9 MAJOR BIBLIOGRAPHICAL REFERENCES

(See Continuation Sheet)

10 GEOGRAPHICAL DATA

ACREAGE OF NOMINATED PROPERTY C. 19

UTM REFERENCES

A	1	2	5	0	9	2	0	3	8	1	3	8	3	0	
	ZONE	EASTING			NORTHING					ZONE	EASTING			NORTHING	
C	1	2	5	0	5	2	0	3	8	1	3	8	0	0	
	ZONE	EASTING			NORTHING					ZONE	EASTING			NORTHING	
B	1	2	5	0	7	2	0	3	8	1	3	6	1	0	
	ZONE	EASTING			NORTHING					ZONE	EASTING			NORTHING	
D	1	2	5	0	7	7	0	3	8	1	4	0	6	0	
	ZONE	EASTING			NORTHING					ZONE	EASTING			NORTHING	

VERBAL BOUNDARY DESCRIPTION The Mission Santa Barbara is set on a rise of land above the city of Santa Barbara. It is bounded on the southeast by Los Olivos Street, on the east by the continuation of Laguna Street as it curves northward around the Mission grounds, on the north, northwest and west by a drive around the rear of the Mission and on the southwest by Garden Street. This boundary includes all of the existing Mission structures with some modern additions to the building which do not contribute to the national significance of the landmark.

LIST ALL STATES AND COUNTIES FOR PROPERTIES OVERLAPPING STATE OR COUNTY BOUNDARIES

STATE	CODE	COUNTY	CODE
STATE	CODE	COUNTY	CODE

11 FORM PREPARED BY

NAME/TITLE Boundary determined by Patricia Heintzelman, Architectural Historian, Landmark Review Project; original form prepared by Charles Snell, 1967.

ORGANIZATION	DATE
Historic Sites Survey	September 1975
STREET & NUMBER	TELEPHONE
1100 L Street NW.	202-523-5464
CITY OR TOWN	STATE
Washington	D.C.

12 STATE HISTORIC PRESERVATION OFFICER CERTIFICATION

THE EVALUATED SIGNIFICANCE OF THIS PROPERTY WITHIN THE STATE IS:

NATIONAL _____ STATE _____ LOCAL _____

As the designated State Historic Preservation Officer for the National Historic Preservation Act of 1966 (Public Law 89-665), I hereby nominate this property for inclusion in the National Register and certify that it has been evaluated according to the criteria and procedures set forth by the National Park Service.

FEDERAL REPRESENTATIVE SIGNATURE

TITLE DATE

FOR NPS USE ONLY	
I HEREBY CERTIFY THAT THIS PROPERTY IS INCLUDED IN THE NATIONAL REGISTER	
	DATE
DIRECTOR, OFFICE OF ARCHEOLOGY AND HISTORIC PRESERVATION	
ATTEST:	DATE
KEEPER OF THE NATIONAL REGISTER	

((NATIONAL HISTORIC LANDMARKS))

((NATIONAL HISTORIC LANDMARKS))

UNITED STATES DEPARTMENT OF THE INTERIOR
NATIONAL PARK SERVICE

**NATIONAL REGISTER OF HISTORIC PLACES
INVENTORY -- NOMINATION FORM**

FOR NPS USE ONLY

RECEIVED

DATE ENTERED

CONTINUATION SHEET

ITEM NUMBER 7 PAGE 2

orchards, was built of stone and mortar and was 120 feet square and 7 feet high. Adjacent to the church was a stone fountain and long stone trough, used by Indian women for laundry purposes.

The Santa Barbara Mission Church survived virtually intact and unaltered from 1820 until June 29, 1925, when a violent earthquake struck the area. Damage was severe, the east tower being destroyed and the interior furnishings battered by falling stone. Only the massive buttresses held the walls in place. The following year restoration began, nearly half of the entire cost being subscribed by the people of California.

Original materials were used as far as possible, and the arches, columns, wall thickness, and all other details were accurately rebuilt. When the reconstruction was completed in 1927, the rebuilt church was little changed from its original appearance. A further reconstruction was found necessary during the period 1950-53, when the church was discovered to be settling and the towers cracking because of the disintegration of cement and foundations. The facade and tower were demolished and the entire church front carefully rebuilt to duplicate the original appearance.

Of the mission irrigation system the fountain and large reservoir near the church are perfectly preserved and form a part of the present water system of the city of Santa Barbara. Extensive portions of the remainder of the irrigation system are also still visible.

UNITED STATES DEPARTMENT OF THE INTERIOR
NATIONAL PARK SERVICE

**NATIONAL REGISTER OF HISTORIC PLACES
INVENTORY -- NOMINATION FORM**

FOR NPS USE ONLY

RECEIVED

DATE ENTERED

CONTINUATION SHEET

ITEM NUMBER

8

PAGE 2

In 1853, the church established a Franciscan missionary college at the mission to train English-speaking priests. All the mission buildings were thus used, kept in repair, and altered (except the church), and did not fall into ruins, as was the case with the abandoned structures at the other California missions. In 1865 the United States Government returned 283 acres of the original mission property, the church, and other mission buildings to the Catholic Church.

UNITED STATES DEPARTMENT OF THE INTERIOR
NATIONAL PARK SERVICE

**NATIONAL REGISTER OF HISTORIC PLACES
INVENTORY -- NOMINATION FORM**

FOR NPS USE ONLY

RECEIVED

DATE ENTERED

CONTINUATION SHEET

ITEM NUMBER 9 PAGE 1

- Baer, Kurt, Architecture of the California Missions, Berkeley, 1958.
- Berger, John A., The Franciscan Missions of California, New York, 1941.
- Engelhardt, Father Zephyria, Mission Santa Barbara, San Francisco, 1923.
- Geiger, Maynard, Pictorial History of the Physical Development of Mission Santa Barbara from Brush Hut to Institutional Greatness, 1786-1963, Franciscan Fathers of California, 1963.
- Morrison, Hugh, Early American Architecture, New York, 1952.

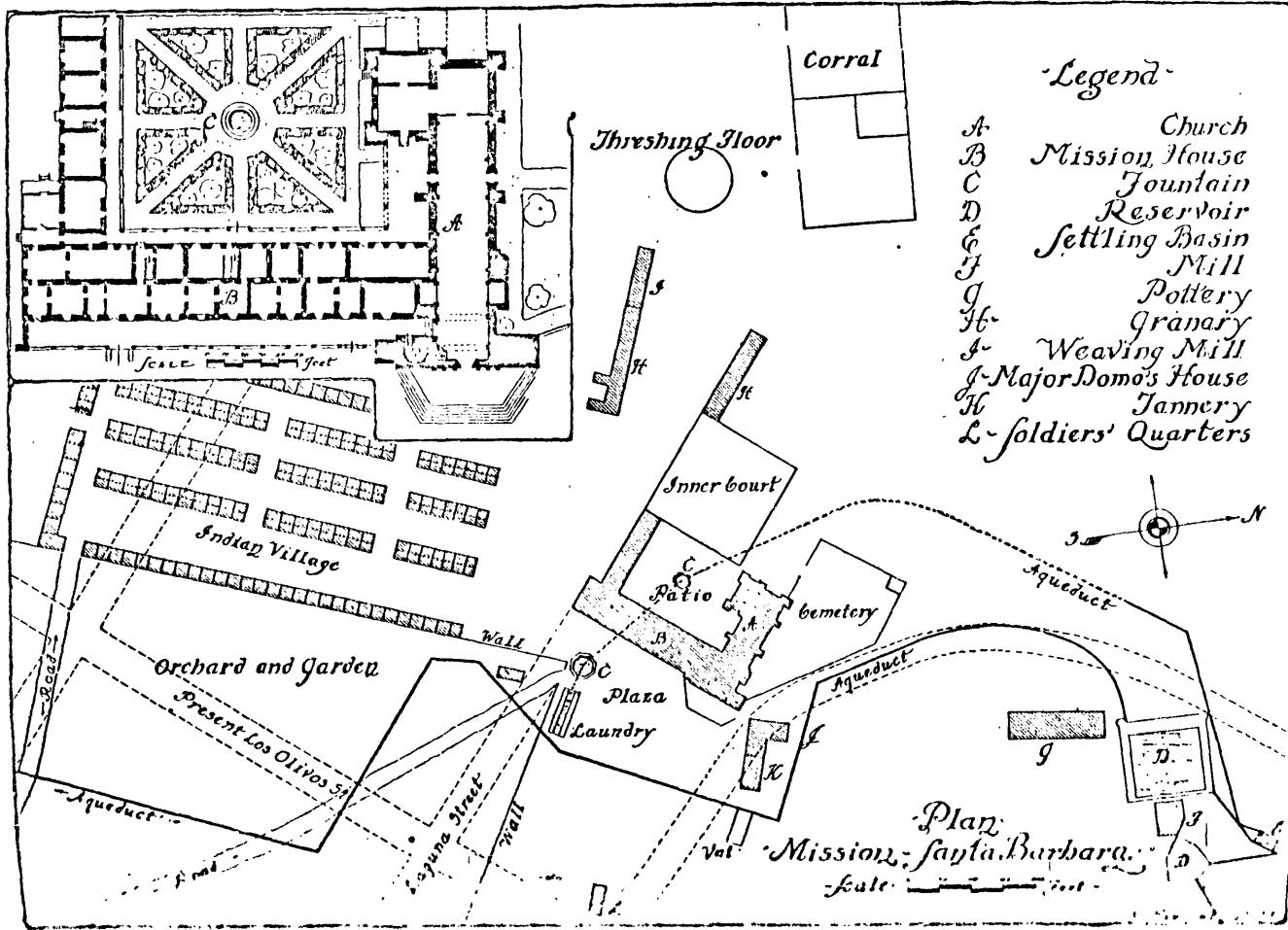

- Legend*
- A- Church
 - B- Mission House
 - C- Fountain
 - D- Reservoir
 - E- Settling Basin
 - F- Mill
 - G- Pottery
 - H- Granary
 - I- Weaving Mill
 - J- Major Domo's House
 - K- Tannery
 - L- soldiers' Quarters

From Barford, *Verde*, *The Old Mission Churches and Historic Houses of California* (Philadelphia: London, 1925).

I U S L I B R A R Y S E R V I C E S Y O U N I F I C A T I O N

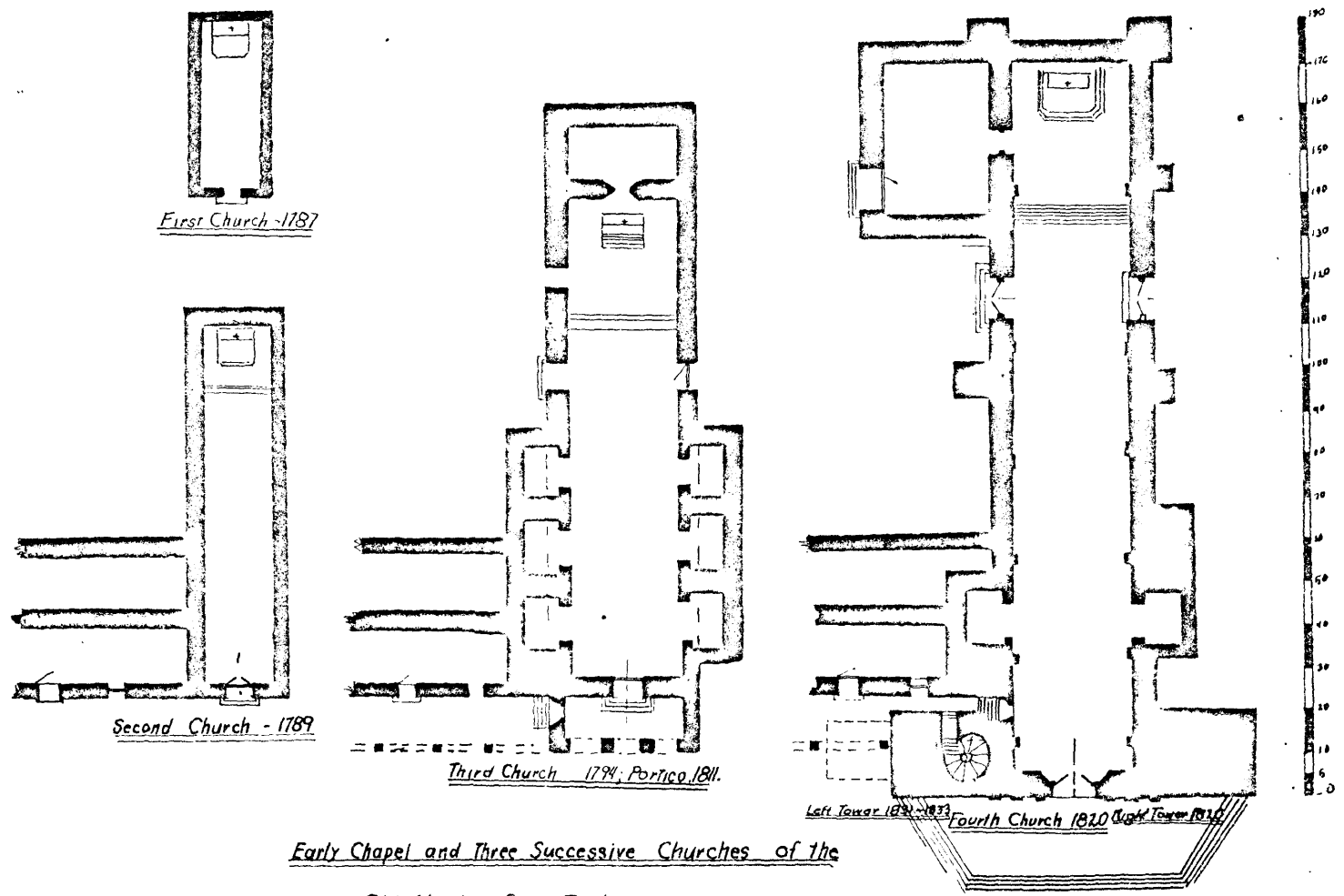

Early Chapel and Three Successive Churches of the
Old Mission Santa Barbara

May 27, 1963
Fr. Thaddeus H. Kreye OFM