

117

United States Department of the Interior  
National Park Service

National Register of Historic Places  
Registration Form

This form is for use in nominating or requesting determinations for individual properties and districts. See instructions in *How to Complete the National Register of Historic Places Registration Form* (National Register Bulletin 16A). Complete each item by marking "x" in the appropriate box or by entering the information requested. If an item does not apply to the property being documented, enter "N/A" for "not applicable." For functions, architectural classification, materials, and areas of significance, enter only categories and subcategories from the instructions. Place additional entries and narrative items on continuation sheets (NPS Form 10-900a). Use a typewriter, word processor, or computer, to complete all items.

1. Name of Property

historic name Robinson Hall, Louisiana Tech University

other names/site number \_\_\_\_\_

2. Location

street & number Madison Avenue, Louisiana Tech University N/A not for publication

city or town Ruston N/A  vicinity

state Louisiana code LA county Lincoln code 061 zip code 71272

3. State/Federal Agency Certification

As the designated authority under the National Historic Preservation Act, as amended, I hereby certify that this  nomination  request for determination of eligibility meets the documentation standards for registering properties in the National Register of Historic Places and meets the procedural and professional requirements set forth in 36 CFR Part 60. In my opinion, the property  meets  does not meet the National Register criteria. I recommend that this property be considered significant  nationally  statewide  locally. ( See continuation sheet for additional comments.)

Jonathan Fricker 1/14/98  
Signature of certifying official/Title Jonathan Fricker Date  
Deputy SHPO, Dept of Culture, Recreation and Tourism  
State of Federal agency and bureau

In my opinion, the property  meets  does not meet the National Register criteria. ( See continuation sheet for additional comments.)

\_\_\_\_\_  
Signature of commenting official/Title Date  
\_\_\_\_\_  
State or Federal agency and bureau

4. National Park Service Certification

I hereby certify that the property is:

- entered in the National Register.  
 See continuation sheet.
- determined eligible for the National Register  
 See continuation sheet.
- determined not eligible for the National Register.
- removed from the National Register.
- other, (explain:)

Edson M. Beall Signature of the Keeper Date of Action 2/20/98

Robinson Hall  
Name of Property

Lincoln Parish, LA  
County and State

**5. Classification**

**Ownership of Property**  
(Check as many boxes as apply)

- private
- public-local
- public-State
- public-Federal

**Category of Property**  
(Check only one box)

- building(s)
- district
- site
- structure
- object

**Number of Resources within Property**  
(Do not include previously listed resources in the count.)

Contributing	Noncontributing	
1		buildings
		sites
		structures
		objects
1	0	Total

**Name of related multiple property listing**  
(Enter "N/A" if property is not part of a multiple property listing.)  
"The 1930's Building Boom at  
Louisiana Tech University"

**Number of contributing resources previously listed  
in the National Register**  
0

**6. Function or Use**

**Historic Functions**  
(Enter categories from instructions)

EDUCATION/education-related

**Current Functions**  
(Enter categories from instructions)

EDUCATION/college

**7. Description**

**Architectural Classification**  
(Enter categories from instructions)

Colonial Revival

**Materials**  
(Enter categories from instructions)

foundation concrete

walls brick

roof asphalt

other concrete

**Narrative Description**

(Describe the historic and current condition of the property on one or more continuation sheets.)

United States Department of the Interior  
National Park Service

## National Register of Historic Places Continuation Sheet

Robinson Hall, Louisiana Tech University, Lincoln Parish, LA  
Section number 7 Page 1

---

Robinson Hall, located on the campus of Louisiana Tech in Ruston, was built in 1939 to serve as a men's dormitory. The three story brick Colonial Revival building features cast concrete details. It survives unaltered on the exterior, although the interior has been completely modernized.

Robinson Hall represents a distinct phase of the Colonial Revival. After World War I, the Colonial Revival entered an academic phase in which architects designed buildings which actually resembled real colonial buildings. Some produced archeologically correct copies while others borrowed details from various periods of colonial architecture to produce buildings evocative of the period. In short, American colonial architecture was the inspiration for buildings like Robinson Hall.

The dorm's red and brown brickwork resembles the textured effect found on colonial buildings where burnt headers were used. The building has a three-part composition, consisting of a long middle block with shorter end sections set at right angles, yielding an overall "I" footprint. The end sections are emphasized by gabled parapets. Two small dormers are found on the front and back of the main block. The locations of the building's four staircases are clearly evident on the facade. A staircase in each end section is marked by a composition consisting of two multi-pane windows of unequal size with a paneled area between. The two windows and paneled area are set within a frame which features shoulder molding. Crowning the entire affair is a swan neck pediment with a swag, and above that, an oculus with keystones in cast concrete. Below is a cast concrete aedicule style entrance pavilion with a dentil band in the entablature and paneling on the interior side walls. The two staircases on the main block are marked by a round arch composition, again with two windows of unequal size with a paneled area between. Here the entrances are simpler, consisting of a small brick hipped roof pavilion with a recessed entrance featuring a cast concrete keystone and paneling.

Robinson Hall's other numerous windows are also strongly articulated, featuring small panes, fairly thick frames, and a jack arch with a prominent keystone in cast concrete. Those on the ground story (except for the rear) have a panel below.

### Assessment of Integrity:

As noted previously, the interior of Robinson Hall is completely modern in character. However, it should be noted that it was always a very utilitarian, unornamented interior, consisting of dorm rooms off hallways. Because the exterior survives completely unaltered, there is no question that a student from the historic period would recognize the building.

Robinson Hall  
Name of Property

Lincoln Parish, LA  
County and State

**8. Statement of Significance**

**Applicable National Register Criteria**

(Mark "x" in one or more boxes for the criteria qualifying the property for National Register listing.)

- A** Property is associated with events that have made a significant contribution to the broad patterns of our history.
- B** Property is associated with the lives of persons significant in our past.
- C** Property embodies the distinctive characteristics of a type, period, or method of construction or represents the work of a master, or possesses high artistic values, or represents a significant and distinguishable entity whose components lack individual distinction.
- D** Property has yielded, or is likely to yield, information important in prehistory or history.

**Criteria Considerations** N/A  
(Mark "x" in all the boxes that apply.)

Property is:

- A** owned by a religious institution or used for religious purposes.
- B** removed from its original location.
- C** a birthplace or grave.
- D** a cemetery.
- E** a reconstructed building, object, or structure.
- F** a commemorative property.
- G** less than 50 years of age or achieved significance within the past 50 years.

**Narrative Statement of Significance**

(Explain the significance of the property on one or more continuation sheets.)

**9. Major Bibliographical References**

**Bibliography**

(Cite the books, articles, and other sources used in preparing this form on one or more continuation sheets.)

**Previous documentation on file (NPS):** N/A

- preliminary determination of individual listing (36 CFR 67) has been requested
- previously listed in the National Register
- previously determined eligible by the National Register
- designated a National Historic Landmark
- recorded by Historic American Buildings Survey # \_\_\_\_\_
- recorded by Historic American Engineering Record # \_\_\_\_\_

**Areas of Significance**

(Enter categories from instructions)

education

**Period of Significance**

1939

**Significant Dates**

1939

**Significant Person**

(Complete if Criterion B is marked above)

N/A

**Cultural Affiliation**

N/A

**Architect/Builder**

Neild, Somdal & Neild (Architects)

T.L. James & Co. (Contractor)

**Primary location of additional data:**

- State Historic Preservation Office
- Other State agency
- Federal agency
- Local government
- University
- Other

Name of repository:

Robinson Hall  
Name of Property

Lincoln Parish, LA  
County and State

## 10. Geographical Data

Acreege of Property less than an acre

### UTM References

(Place additional UTM references on a continuation sheet.)

1 

1	5
---	---

5	3	2	8	8	0
---	---	---	---	---	---

3	5	9	8	8	0	0
---	---	---	---	---	---	---

Zone

Easting

Northing

3 

--	--

--	--	--	--	--	--

--	--	--	--	--	--	--	--

Zone

Easting

Northing

4 

--	--

--	--	--	--	--	--

--	--	--	--	--	--	--	--

See continuation sheet

### Verbal Boundary Description

(Describe the boundaries of the property on a continuation sheet.)

### Boundary Justification

(Explain why the boundaries were selected on a continuation sheet.)

## 11. Form Prepared By

name/title National Register staff (assisted by Phi Alpha Theta, Louisiana Tech)

organization Division of Historic Preservation date SEPTEMBER 1997

street & number P. O. Box 44247 telephone 504-342-8160

city or town Baton Rouge state LA zip code 70804

### Additional Documentation

Submit the following items with the completed form:

#### Continuation Sheets

#### Maps

A **USGS map** (7.5 or 15 minute series) indicating the property's location.

A **Sketch map** for historic districts and properties having large acreage or numerous resources.

#### Photographs

Representative **black and white photographs** of the property.

#### Additional items

(Check with the SHPO or FPO for any additional items)

### Property Owner

(Complete this item at the request of SHPO or FPO.)

name Louisiana Tech University, Office of the President

street & number P. O. Box 3168 telephone 318-257-3785

city or town Ruston state LA zip code 71272

**Paperwork Reduction Act Statement:** This information is being collected for applications to the National Register of Historic Places to nominate properties for listing or determine eligibility for listing, to list properties, and to amend existing listings. Response to this request is required to obtain a benefit in accordance with the National Historic Preservation Act, as amended (16 U.S.C. 470 *et seq.*).

**Estimated Burden Statement:** Public reporting burden for this form is estimated to average 18.1 hours per response including time for reviewing instructions, gathering and maintaining data, and completing and reviewing the form. Direct comments regarding this burden estimate or any aspect of this form to the Chief, Administrative Services Division, National Park Service, P.O. Box 37127, Washington, DC 20013-7127; and the Office of Management and Budget, Paperwork Reductions Projects (1024-0018), Washington, DC 20503.

**United States Department of the Interior  
National Park Service**

**National Register of Historic Places  
Continuation Sheet**

Robinson Hall, Louisiana Tech University, Lincoln Parish, LA  
Section number 8, 9, 10 Page 1

---

Robinson Hall is of local significance in the area of education because it is an important component of a critical chapter in Louisiana Tech's history, the great construction boom of the 1930s which increased the physical plant by one-third, including numerous major buildings. See the multiple property cover form "The 1930s Building Boom at Louisiana Tech" for a fuller statement of significance. Robinson Hall was named for W. C. Robinson, who served as Tech's president from 1899 to 1900.

-----  
Bibliography: See the multiple property cover form's bibliography.  
-----

Boundary Description: See attached sketch map.

Justification: Boundaries were chosen to discretely encompass the nominated building, which is in a modern section of campus. For a college campus where only certain buildings were being nominated, following property lines obviously was not an option.

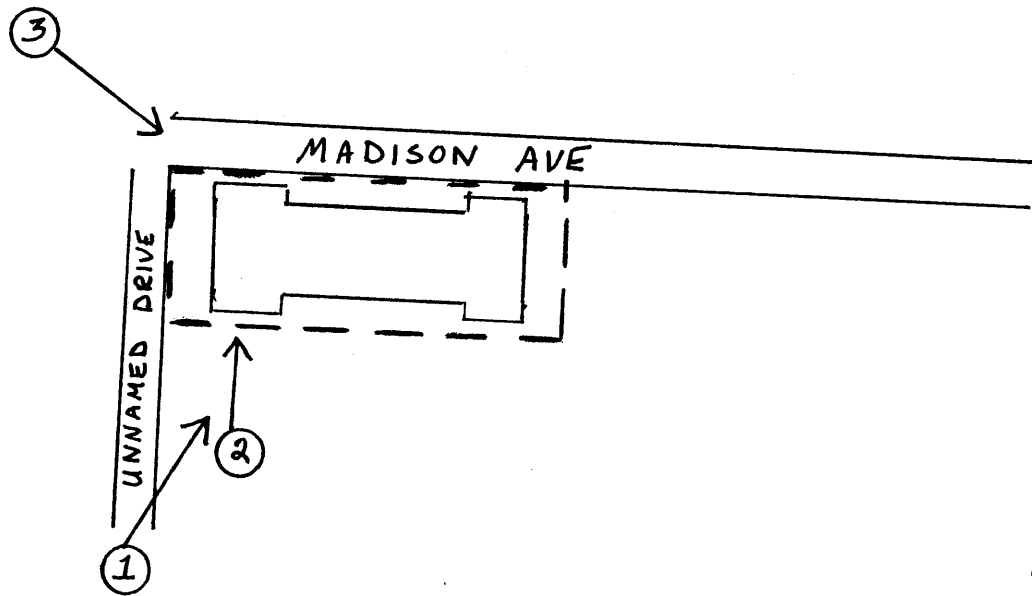

Robinson Hall  
LA Tech University  
Lincoln Parish, LA

1" = 100'

--- BOUNDARY