

United States Department of the Interior  
National Park Service

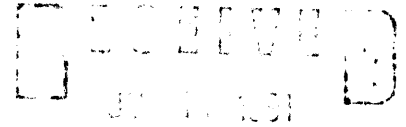

# National Register of Historic Places Registration Form

NATIONAL  
REGISTER

This form is for use in nominating or requesting determinations of eligibility for individual properties or districts. See instructions in *Guidelines for Completing National Register Forms* (National Register Bulletin 16). Complete each item by marking "x" in the appropriate box or by entering the requested information. If an item does not apply to the property being documented, enter "N/A" for "not applicable." For functions, styles, materials, and areas of significance, enter only the categories and subcategories listed in the instructions. For additional space use continuation sheets (Form 10-900a). Type all entries.

### 1. Name of Property

historic name Monk House  
other names/site number Richardson House

### 2. Location

street & number Claiborne Parish Rt 39 and LA HWY 9 N/A not for publication  
city, town Homer X vicinity  
state Louisiana code LA county Claiborne code 027 zip code 71040

### 3. Classification

Ownership of Property	Category of Property	Number of Resources within Property	
<input checked="" type="checkbox"/> private	<input checked="" type="checkbox"/> building(s)	Contributing	Noncontributing
<input type="checkbox"/> public-local	<input type="checkbox"/> district	<u>1</u>	<u>3</u> buildings
<input type="checkbox"/> public-State	<input type="checkbox"/> site	_____	_____ sites
<input type="checkbox"/> public-Federal	<input type="checkbox"/> structure	_____	_____ structures
	<input type="checkbox"/> object	<u>1</u>	<u>3</u> objects
			Total
			<u>0</u>

Name of related multiple property listing: N/A Number of contributing resources previously listed in the National Register 0

### 4. State/Federal Agency Certification

As the designated authority under the National Historic Preservation Act of 1966, as amended, I hereby certify that this  nomination  request for determination of eligibility meets the documentation standards for registering properties in the National Register of Historic Places and meets the procedural and professional requirements set forth in 36 CFR Part 60. In my opinion, the property  meets  does not meet the National Register criteria.  See continuation sheet.

Jonathan Fricker Signature of certifying official Jonathan Fricker, Deputy SHPO, Dept of Culture, Recreation and Tourism  
Date July 12, 1991

State or Federal agency and bureau \_\_\_\_\_

In my opinion, the property  meets  does not meet the National Register criteria.  See continuation sheet.

Signature of commenting or other official \_\_\_\_\_ Date \_\_\_\_\_

State or Federal agency and bureau \_\_\_\_\_

### 5. National Park Service Certification

I, hereby, certify that this property is:

entered in the National Register.  
 See continuation sheet.

determined eligible for the National Register.  See continuation sheet.

determined not eligible for the National Register.

removed from the National Register.

other, (explain:) \_\_\_\_\_

Michelle Byrum entered in the National Register 8/23/91  
Signature of the Keeper Date of Action

---

**6. Function or Use**

---

Historic Functions (enter categories from instructions)

DOMESTIC/single dwelling

---

---

---

Current Functions (enter categories from instructions)

DOMESTIC/single dwelling

---

---

---

---

**7. Description**

---

Architectural Classification

(enter categories from instructions)

Greek Revival

---

---

---

Materials (enter categories from instructions)

foundation concrete (piers)walls weatherboardasbestosroof asphaltother 

---

---

---

**Describe present and historic physical appearance.**

The Monk House (c. 1855) is a one story frame Greek Revival structure situated amid the woods and pastures of rural Claiborne Parish. Although the home has undergone some changes since its construction, its National Register eligibility remains intact.

The following Greek Revival features are found within the home:

- 1) a five bay front gallery whose simple Doric pillars and matching corner pilasters support an entablature. Another pillared gallery with entablature outlines the rear elevation of the house and ell.
- 2) transoms and sidelights flanking the front and rear entrances. Some of the antique glass within the transoms and sidelights has survived.
- 3) facade window surrounds composed of engaged fluted pilasters whose molded Doric capitals are incorporated into a cornice surmounted by a narrow architrave.
- 4) interior door surrounds which mimic those framing the facade's windows, except that the engaged pilasters are smooth rather than fluted.
- 5) tall two panel doors, one of which shows evidence of faux bois painting.
- 6) several plain vernacular Greek Revival mantels.

The home's symmetrical floorplan consists of two rooms on each side of a wide central hall. In addition to this basic mass, an ell is attached to one side at the rear, and an additional room is attached to the west side of the home. Although the ell appears to be original, available architectural evidence does not clarify whether or not it was at one time separated from the rest of the house by a breezeway. The side room also appears to be original. Interesting features attesting to the home's age include hand planed wall and floor boards, square nails, and nine-over-nine windows. The home also has 15 foot ceilings, wide baseboards, and a partial basement.

**United States Department of the Interior  
National Park Service**

**National Register of Historic Places  
Continuation Sheet**

Monk House, Homer vicinity, Claiborne Parish, LA

Section number 7 Page 1

---

The Monk House has experienced the following alterations:

- 1) The original folding accordian-like doors which closed off the home's central hall have been removed. The resulting facade and rear openings have been filled in with single leaf doors flanked by single windows on each side.
- 2) Several of the home's chimneys have been lost, and vents were inserted in the attic gables when the chimneys were removed. In addition, the porch balustrade has been removed, and the facade's original nine-over-nine windows have been replaced by one-over-one sashes from a later period. At least one side window has also been replaced in this manner.
- 3) Paneling has been added to the walls in two bedrooms and a closet has been added in one room.
- 4) At some point a side porch was added to the ell and a bathroom was added on the same side of the home. Later the ell's porch was enclosed and that entire elevation (including the bath) was sheathed with asbestos shingles.
- 5) A fascia of pressed tin made to resemble shingles was added to the edge of the porch sometime around the turn of the century.
- 6) The side projecting room has been virtually gutted on the interior as a result of its conversion for use as a carriage room and, later, a combination garage and shop. In conjunction with this change, the room's original small pillared and pedimented entrance porch was widened (and the columns removed) to provide shelter for the new garage opening.

Despite these changes, the Monk House still retains most of the original Greek Revival elements which form the basis of its architectural significance. The original columns, pilasters, door and window surrounds, primitive mantels, and the main section's center hall floorplan are all intact. In addition, the home's massing remains unchanged despite the gutting of the side room's interior. At least some of the folding accordian doors have been stored in the attic and are available for restoration or reproduction. Finally, the home's rural setting remain essentially unchanged. As a rare survivor in a parish which has few examples of antebellum Greek Revival architecture, the Monk House is a strong candidate for National Register listing.

CONTINUED

**United States Department of the Interior  
National Park Service**

**National Register of Historic Places  
Continuation Sheet**

Monk House, Claiborne Parish, LA

Section number 7 Page 2

---

Non-Contributing Elements:

Located within the nominated acreage are three dependencies which should be considered non-contributing for the purposes of this nomination. Two of the buildings were built around the turn of the century and hence were not present during the period of significance for the house. The third building, a log smokehouse, was moved to the site from elsewhere in the parish. For the record, none of the outbuildings are individually eligible for the Register.

**8. Statement of Significance**

Certifying official has considered the significance of this property in relation to other properties:

nationally  statewide  locally

Applicable National Register Criteria  A  B  C  D

Criteria Considerations (Exceptions)  A  B  C  D  E  F  G N/A

Areas of Significance (enter categories from instructions)

architecture  
\_\_\_\_\_  
\_\_\_\_\_  
\_\_\_\_\_  
\_\_\_\_\_

Period of Significance

c. 1855  
\_\_\_\_\_  
\_\_\_\_\_

Significant Dates

c. 1855  
\_\_\_\_\_  
\_\_\_\_\_

Cultural Affiliation

N/A  
\_\_\_\_\_  
\_\_\_\_\_

Significant Person

N/A  
\_\_\_\_\_

Architect/Builder

unknown  
\_\_\_\_\_

**State significance of property, and justify criteria, criteria considerations, and areas and periods of significance noted above.**

The Monk House is locally significant in the area of architecture because it is one of a limited number of surviving Greek Revival residences in Claiborne Parish.

Claiborne Parish was settled in the antebellum period by men and women whose devotion to the ideals of the Classical Age can be seen in the names they chose for parish towns like Homer, Athens, and Sparta. However, the vast majority of the parish's architectural patrimony dates from the early twentieth century. Claiborne Parish's comprehensive historic structures survey identifies some 545 50+ year old buildings, most of which are cabins, cottages, bungalows, or "vernacular" commercial buildings. In terms of residences, the earliest stylistic period represented in any notable number is the Queen Anne Revival. Very little remains from the earlier antebellum Greek Revival period. It is against this background that the rarity of the Monk House emerges. It is one of only thirteen Greek Revival residences remaining in the parish. Of these thirteen survivors, three are two story examples, and ten are one story homes with columnar or pillared galleries and simple details. The Monk House is among the finer examples of the latter, for it includes slightly more elaborate elements not found on most of the other houses. These include corner pilasters with molded Doric capitals and window surrounds featuring engaged fluted pilasters whose capitals are incorporated into a cornice.

Historical Note

Alabama native Merrell Monk moved his family to Claiborne Parish, Louisiana in the early 1850s. The Greek Revival house he built northeast of Homer may have been patterned after the plans of his wife's former home in Opelika, Alabama. It was built by slave labor. After the Civil War Monk was one of the stockholders in a cotton factory at Arizona, another community within Claiborne Parish. Although it eventually failed due to transportation and marketing problems, this plant may have been among the first manufacturing enterprises in North Louisiana. After Monk's death in 1888, his heirs sold the home to J. K. Barrow, who owned it until 1901. In that year the Richardson family purchased the house and surrounding land. It has remained in their possession ever since.

See continuation sheet

**9. Major Bibliographical References**

Historic Claiborne '77. Homer, LA: Claiborne Parish Historical Association, 1977.  
(Article on Monk family includes two old photos of the house.)

Historic Structures Survey for Claiborne Parish, LA.

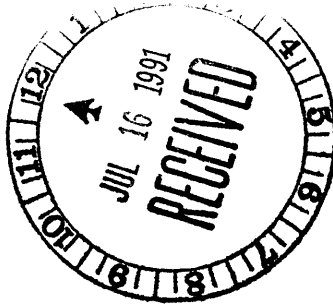

- Previous documentation on file (NPS): N/A
- preliminary determination of individual listing (36 CFR 67) has been requested
  - previously listed in the National Register
  - previously determined eligible by the National Register
  - designated a National Historic Landmark
  - recorded by Historic American Buildings Survey # \_\_\_\_\_
  - recorded by Historic American Engineering Record # \_\_\_\_\_

See continuation sheet

Primary location of additional data:

- State historic preservation office
- Other State agency
- Federal agency
- Local government
- University
- Other

Specify repository: \_\_\_\_\_

**10. Geographical Data**

Acreage of property less than an acre

UTM References

A 15 | 503250 | 3638800  
 Zone Easting Northing

C \_\_\_\_\_ | \_\_\_\_\_ | \_\_\_\_\_

B \_\_\_\_\_ | \_\_\_\_\_ | \_\_\_\_\_  
 Zone Easting Northing

D \_\_\_\_\_ | \_\_\_\_\_ | \_\_\_\_\_

See continuation sheet

Verbal Boundary Description

Please refer to sketch map.

See continuation sheet

Boundary Justification

Boundaries follow the fence line of the house's yard. To have followed property lines would have meant including extensive rural acreage that contained no contributing resources.

See continuation sheet

**11. Form Prepared By**

name/title National Register staff  
 organization Division of Historic Preservation date May 1991  
 street & number P. O. Box 44247 telephone 504-342-8160  
 city or town Baton Rouge state LA zip code 70804

Owner: Mrs. Myrtle S. Richardson  
 Rt. 4, Box 32  
 Homer, LA 71040

Monk House  
Homer vicinity, Claiborne Parish  
Louisiana

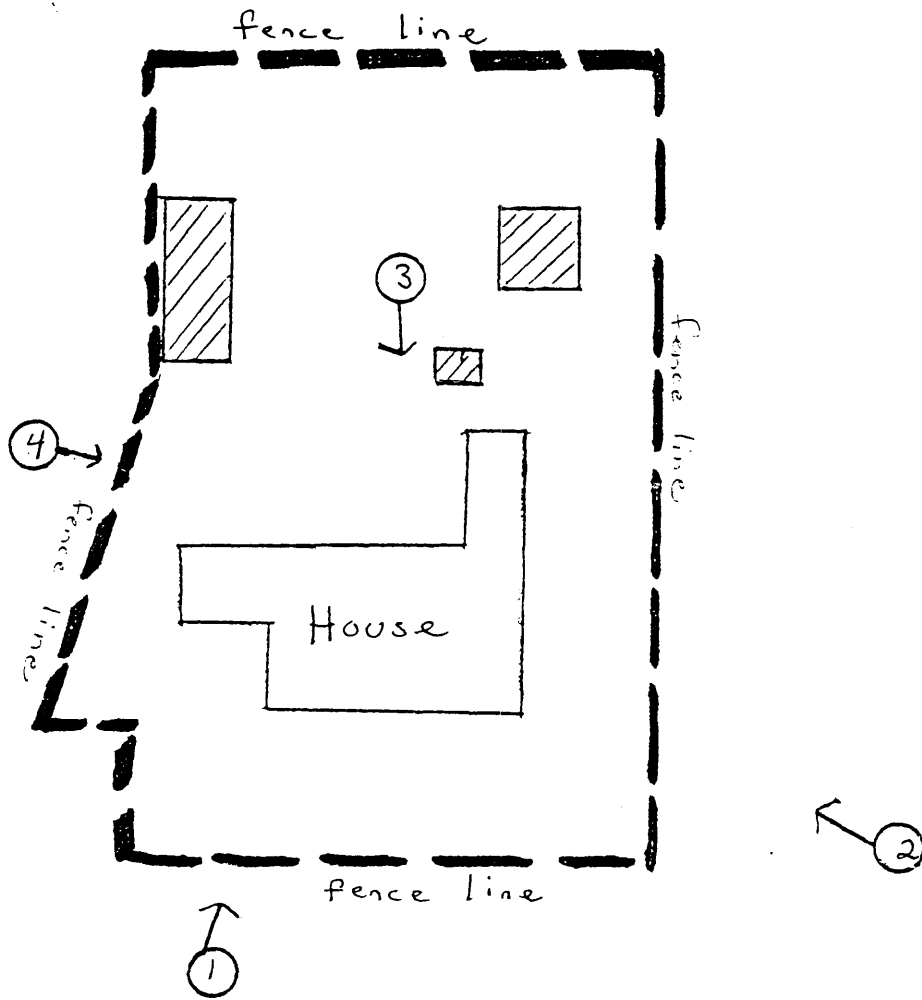

North ↑

Scale: 1" = 30'

Boundary: — — —

Non-Contributing Elements: 