

DEC 28 1988

3295

KENTUCKY HISTORIC RESOURCES
Individual Inventory Form

Resource # Be-358
Boone County

1. Name of Resource: Rogers, James, Farm

2. Original Owner: James Rogers

3. Other Names: None

4. Prehistoric Site	Building X	Object
Historic Site	Structure	Other

5. Location: 6259 Sycamore Street, Belleview, KY 41005

6. Owner's Name: Marion Rogers, David L. Clore []

7. Owner's Address: 6259 Sycamore Street, Belleview, KY 41005

8. Evaluation: National Register []

9. Recognition & Date:

Nat.Landmark	Local Landmark
Nat.Register	HABS/HAER
Highway Marker	KY Inventory 1987
KY Landmark Certificate	

10. N.R.Status & Date:

11. N.R.Group:

District Name:	[]
Mult.Resource Area:	Boone County []
Thematic Name:	[]

12. Historical Theme:

Primary:	Architecture	[]
Secondary:	Agriculture	[]
Other:		[]

13. Statement of Significance:
This property is significant under criterion C as a good example of the Queen Anne style, significant to Boone County in the period 1880-1915. It is one of six Queen Anne buildings identified in the county. The property is also significant under criterion A as a good example of a medium to large farmstead in Boone []

14. History: County in the period 1900-1938.
The house was built by carpenters John Presser and Henry Griffith and stonemason Timothy (?) Hogan. All materials for the house but the stone, which came from a nearby creek, were shipped from Aurora, Indiana, across the Ohio River; this presumably included much stock work.

16. Date: Original Building 1903* []
Addition []

17. Style: Queen Anne []

18. Architect/Builder: John Presser, Henry Griffith, Timothy Hogan

19. No. of Stories: two []

20. Original Floor Plan: irregular []

21. Single Pile Double Pile N.A. X

22. Roof Form & Material: Original X
gable/asphalt shingle Not Original

23. Structural Material: wood frame []

24. Exterior Material: weatherboard []

25. Foundation Material: rough-cut stone []

26. Major Alterations: Moved/Rebuilt Additions None X Other

27. Special Features: unusual cove cornice of horizontal boards

28. Outbuildings: five: livestock barn, smokehouse, 3 sheds []

29. Original Function: farm dwelling []

30. Present Use: dwelling []

31. Condition: excellent []

32. Endangered: Yes []
No X

33. Attach Photos:
Roll: 15 Photo Nos: 30-35 No. of Slides:

15. Source of historical information and/or contact person: *owner

34. Prepared by: Kenneth T. Gibbs

35. Organization: Boone Co. Hist. Pres. Rev. Brd.

36. Date: September 1986

37. New Survey X Resurvey

KENTUCKY HISTORIC RESOURCES
Individual Inventory Form

Resource # Be-358

38. UTM Point of Primary Building: Zone Easting Northing 39. G.I.S. Mod. []
 Quadrant: Rising Sun 16 688380 4317180 40. Coordi. Accuracy []

41. UTM Points of Boundary (for N. R. eligible sites only):

A. ---
 B. ---
 C. ---
 D. ---
 E. ---
 F. ---

42. Total Acreage in Present Property: 163.22 43. Acreage included in proposed N.R. boundary: 1

44. Site Plan (and boundary description and justification for N.R. sites):

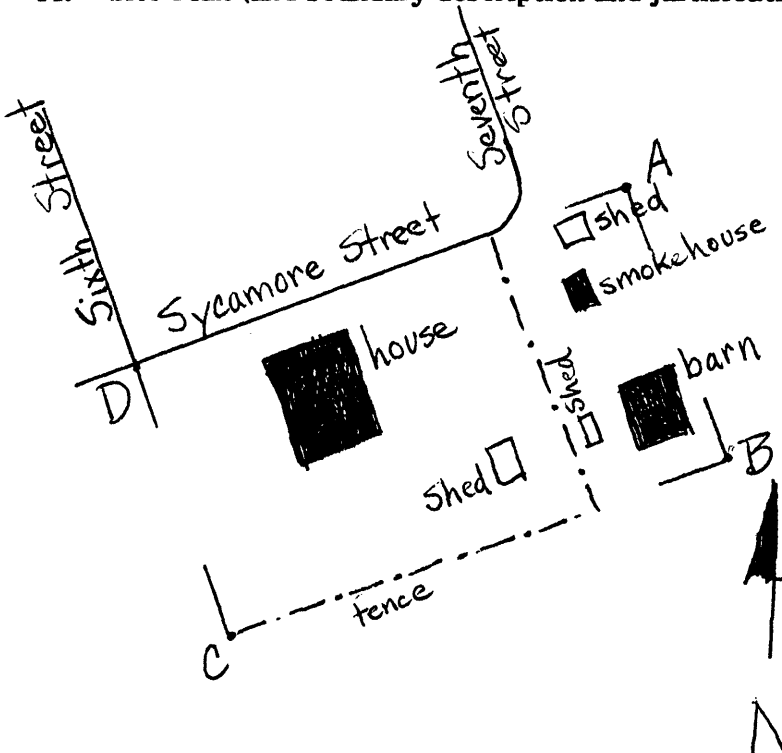

The nominated property occupies city lot/tax parcel BV1-13-1 and is roughly 270' x 150' in size. The boundary includes the entire city lot that has historically been associated with the property. Although agricultural out-buildings are included, the acreage is based on the house's location on the street grid of the town rather than on its previous role as a farmhouse.

Contributing: 3 buildings
 Noncontributing: 3 buildings (sheds)

45. Description and House Plan:

The frame house is a modified T-form with three cross-gables two-stories in height plus a 1½-story gabled kitchen wing at the rear. The principal exterior ornament includes the front (north) porch of turned posts and spindlework, the three main gables, filled with multiple shapes of shingles, flared at the bases and ornamented in the peaks, and a split sunburst motif between the first and second floor windows of the front projecting gable-end. The 2/2 double-hung sash windows, paired in two of the gable-ends, are topped with simple cornice strips.

Through the lighted and transomed front door one enters a generous stairhall, featuring a staircase with classical detail designed and constructed by carpenter Henry Griffith. Behind the stairhall are an open, recessed porch, a pantry and a bathroom (original to the house); the principal rooms on the right (west) side of the house, north to south, are the parlor, dining room, and kitchen, containing another set of stairs to the second floor and also to the basement, located under the kitchen wing. The interior openings are finished with bull's eye corner blocks, and the mantels are double, with columns and mirrors, ornamental coal grates backed with tile.

The livestock barn and smokehouse are contemporary with the house, while the three sheds were built somewhat later, after the period of significance, and do not contribute to the significance of the property. All outbuildings are of wood frame construction, sided with vertical boards (the shed within the fenced yard is also covered with asphalt sheeting). The stock barn and smokehouse are gabled-roofed, with standing-seam metal, and have their principal openings in the south gable-ends. The barn is distinguished with a projecting roof for the hay mow. The barn and smokehouse contribute to the integrity of the property by illustrating the agricultural economy of the original occupants of the house.

DEC 28 1988

3295

KENTUCKY HISTORIC RESOURCES
Individual Inventory Form

Resource # Be-358
Boone County

1. Name of Resource: Rogers, James, Farm

2. Original Owner: James Rogers

3. Other Names: None

4. Prehistoric Site	Building X	Object
Historic Site	Structure	Other

5. Location: 6259 Sycamore Street, Belleview, KY 41005

6. Owner's Name: Marion Rogers, David L. Clore []

7. Owner's Address: 6259 Sycamore Street, Belleview, KY 41005

8. Evaluation: National Register []

9. Recognition & Date:

Nat.Landmark	Local Landmark
Nat.Register	HABS/HAER
Highway Marker	KY Inventory 1987
KY Landmark Certificate	

10. N.R.Status & Date:

11. N.R.Group:

District Name:	[]
Mult.Resource Area:	Boone County []
Thematic Name:	[]

12. Historical Theme:

Primary:	Architecture	[]
Secondary:	Agriculture	[]
Other:		[]

13. Statement of Significance:
This property is significant under criterion C as a good example of the Queen Anne style, significant to Boone County in the period 1880-1915. It is one of six Queen Anne buildings identified in the county. The property is also significant under criterion A as a good example of a medium to large farmstead in Boone []

14. History: County in the period 1900-1938.
The house was built by carpenters John Presser and Henry Griffith and stonemason Timothy (?) Hogan. All materials for the house but the stone, which came from a nearby creek, were shipped from Aurora, Indiana, across the Ohio River; this presumably included much stock work.

16. Date: Original Building 1903* []
Addition []

17. Style: Queen Anne []

18. Architect/Builder: John Presser, Henry Griffith, Timothy Hogan

19. No. of Stories: two []

20. Original Floor Plan: irregular []

21. Single Pile Double Pile N.A. X

22. Roof Form & Material: Original X
gable/asphalt shingle Not Original

23. Structural Material: wood frame []

24. Exterior Material: []
weatherboard []

25. Foundation Material: rough-cut stone []

26. Major Alterations: Moved/Rebuilt None X
Additions Other

27. Special Features: unusual cove cornice of horizontal boards

28. Outbuildings: five: livestock barn, smokehouse, 3 sheds []

29. Original Function: farm dwelling []

30. Present Use: dwelling []

31. Condition: excellent []

32. Endangered: Yes []
No X

33. Attach Photos:
Roll: 15 Photo Nos: 30-35 No. of Slides:

15. Source of historical information and/or contact person: *owner

34. Prepared by: Kenneth T. Gibbs

35. Organization: Boone Co. Hist. Pres. Rev. Brd.

36. Date: September 1986

37. New Survey X Resurvey

KENTUCKY HISTORIC RESOURCES
Individual Inventory Form

Resource # Be-358

38. UTM Point of Primary Building: Zone Easting Northing 39. G.I.S. Mod. []
 Quadrant: Rising Sun 16 688380 4317180 40. Coordi.Accuracy []

41. UTM Points of Boundary (for N. R. eligible sites only):

A. ---
 B. ---
 C. ---
 D. ---
 E. ---
 F. ---

42. Total Acreage in Present Property: 163.22 43. Acreage included in proposed N.R. boundary: 1

44. Site Plan (and boundary description and justification for N.R. sites):

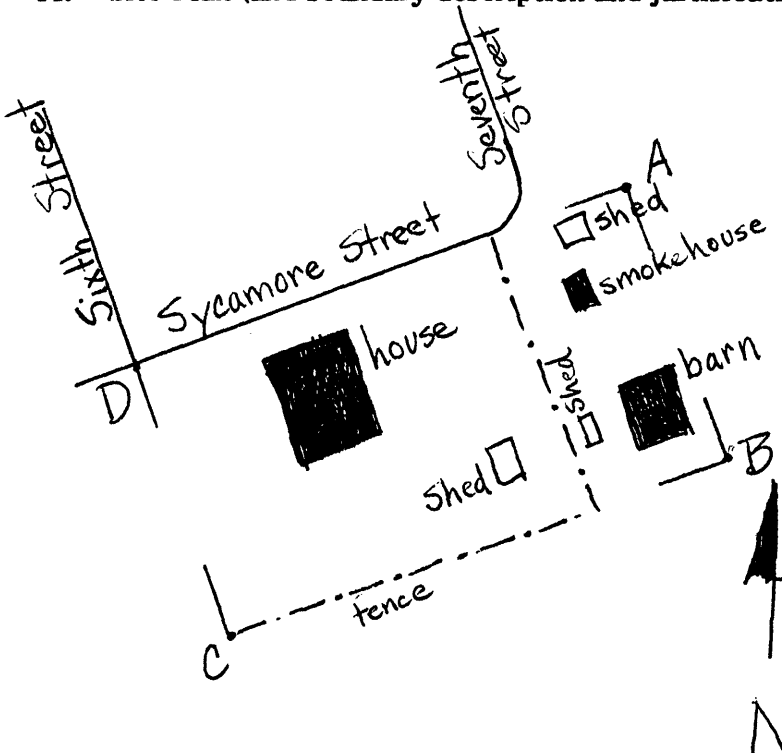

The nominated property occupies city lot/tax parcel BV1-13-1 and is roughly 270' x 150' in size. The boundary includes the entire city lot that has historically been associated with the property. Although agricultural out-buildings are included, the acreage is based on the house's location on the street grid of the town rather than on its previous role as a farmhouse.

Contributing: 3 buildings
 Noncontributing: 3 buildings (sheds)

45. Description and House Plan:

The frame house is a modified T-form with three cross-gables two-stories in height plus a 1½-story gabled kitchen wing at the rear. The principal exterior ornament includes the front (north) porch of turned posts and spindlework, the three main gables, filled with multiple shapes of shingles, flared at the bases and ornamented in the peaks, and a split sunburst motif between the first and second floor windows of the front projecting gable-end. The 2/2 double-hung sash windows, paired in two of the gable-ends, are topped with simple cornice strips.

Through the lighted and transomed front door one enters a generous stairhall, featuring a staircase with classical detail designed and constructed by carpenter Henry Griffith. Behind the stairhall are an open, recessed porch, a pantry and a bathroom (original to the house); the principal rooms on the right (west) side of the house, north to south, are the parlor, dining room, and kitchen, containing another set of stairs to the second floor and also to the basement, located under the kitchen wing. The interior openings are finished with bull's eye corner blocks, and the mantels are double, with columns and mirrors, ornamental coal grates backed with tile.

The livestock barn and smokehouse are contemporary with the house, while the three sheds were built somewhat later, after the period of significance, and do not contribute to the significance of the property. All outbuildings are of wood frame construction, sided with vertical boards (the shed within the fenced yard is also covered with asphalt sheeting). The stock barn and smokehouse are gabled-roofed, with standing-seam metal, and have their principal openings in the south gable-ends. The barn is distinguished with a projecting roof for the hay mow. The barn and smokehouse contribute to the integrity of the property by illustrating the agricultural economy of the original occupants of the house.