

Historic Resources of Hardin County

AUG 26 1988

Historic Name: Ditto, Abraham, House (HDWP-19) Classification: Building
Common Name: Ditto, Abraham, House

Owner: Mr. Walter Warman, 204 Elm Street, West Point, KY 40177

Location: 204 Elm Street, West Point, KY

<u>Contributing:</u>		<u>Non-Contributing:</u>	
Buildings	1	Buildings	3
Structures	0	Structures	0
Sites	0	Sites	0
<u>Total:</u>	1	<u>Total:</u>	3

Description:

The Abraham Ditto House is a two-story brick residence constructed in 1823. The house was built in a side passage ell plan with simple Federal detailing. On the main facade is a ca. 1890 glass and frame door with a single light transom. Windows are original six-over-six and replacement six-over-one sash on the main facade with ca. 1970 two-over-two horizontal sash on the ell. The windows have frame lintels and corner blocks. The house has Flemish bond brick, a gable roof with composition shingles and an interior end brick chimney. The main facade also features star tie rod anchors. The interior retains original Federal style fluted mantles and a staircase with a round newel post and balusters. At the rear of the house are three non-contributing outbuildings constructed between ca. 1930 and ca. 1960.

Period of Significance: 1823 - ca. 1870

Area of Significance: Commerce

Criterion: A

Architect/Builder: Unknown

Statement of Significance:

The Abraham Ditto House is notable for its role in the commercial history of West Point. The building was constructed in 1823 for Abraham Ditto as an inn for river travellers. It is the one of the oldest buildings remaining in West Point and operated as the Ditto House in the mid-1800s. It was later known as the Riverview House before closing ca. 1870. In 1873, the building was used as the district engineer's office during the construction of the Elizabethtown and Paducah Railroad. The house has simple Federal detailing and has not been significantly altered.

Acreage: Less than one acre.

UTM References: Kosmosdale Quad 16/592590/4206090

Verbal Boundary Description and Justification:

The boundary for the Abraham Ditto House is illustrated on the accompanying Hardin County property tax map 158-10, Block 1, lot 25, and is defined by the legal property boundary. The boundary includes the house, adjacent non-contributing outbuildings and property sufficient to protect the historical setting of the site.



LOT 25

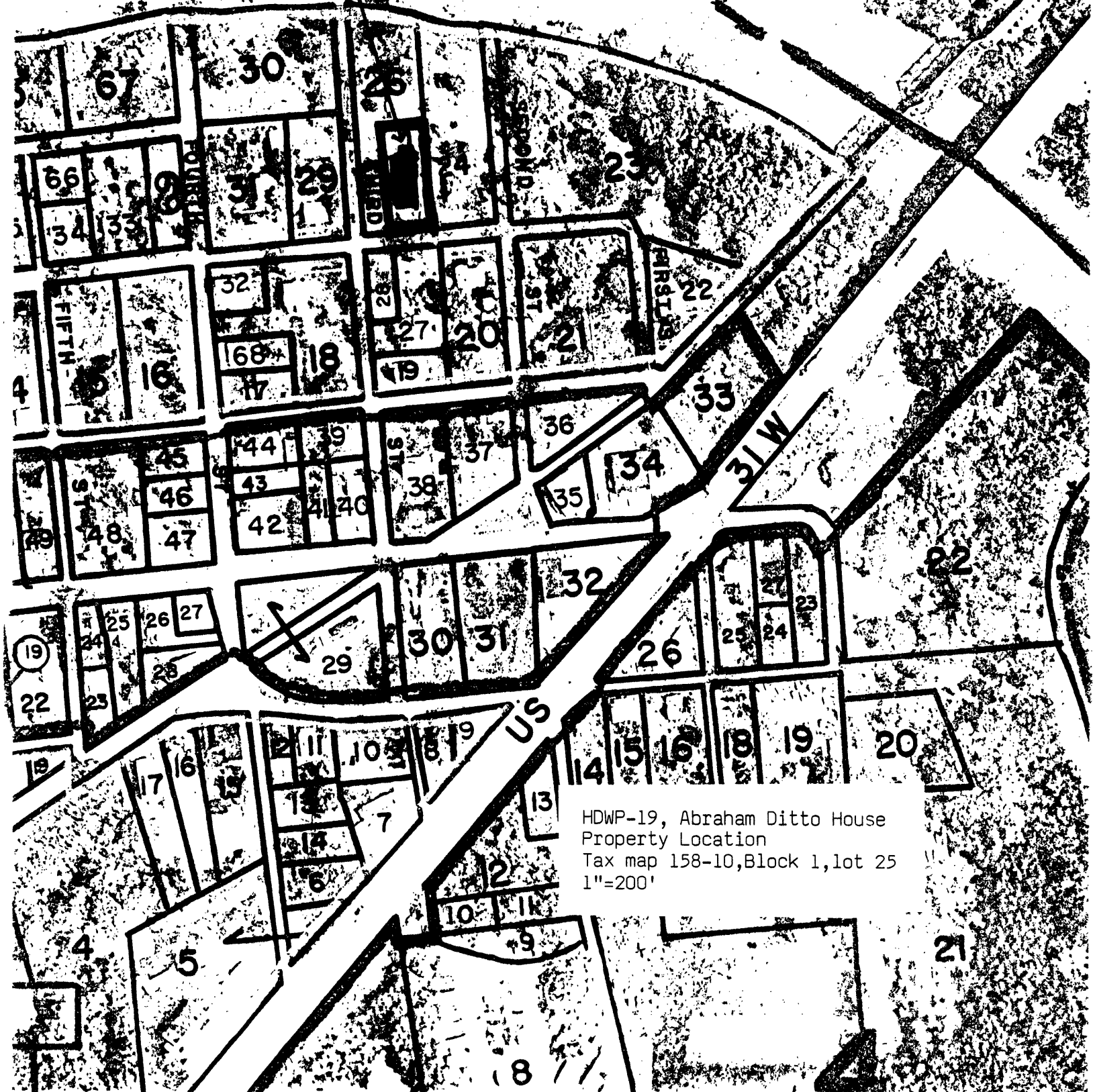

HDWP-19, Abraham Ditto House
 Property Location
 Tax map 158-10, Block 1, lot 25
 1"=200'