

KENTUCKY HISTORIC RESOURCES  
Individual Inventory Form

27 1988 Resource # GpC-10  
Greenup County

1. **Name of Resource:**  
Greenup Masonic Lodge

2. **Original Owner:**  
Greenup Lodge

3. **Other Names:**  
Leslie's Drugstore

4. **Prehistoric Site**  **Building**  **Object**  
**Historic Site**  **Structure**  **Other**

5. **Location:** corner of Main and Harrison  
Streets (314 Main St.)

6. **Owner's Name:**  
Mrs. Sam Leslie [ P ]

7. **Owner's Address:**  
Greenup, KY 41144

8. **Evaluation:** [ N ]

9. **Recognition & Date:**  
 Nat.Landmark \_\_\_\_\_ Local Landmark \_\_\_\_\_  
 Nat.Register \_\_\_\_\_ HABS/HAER \_\_\_\_\_  
 Highway Marker \_\_\_\_\_ KY Inventory 4/1987  
 KY Landmark Certificate \_\_\_\_\_

10. **N.R.Status & Date:**

11. **N.R.Group:**  
 District Name: [ ]  
 Mult.Resource Area: Greenup, Ky. [ ]  
 Thematic Name: [ ]

12. **Historical Theme:**  
 Primary: Architecture [ 030 ]  
 Secondary: [ ]  
 Other: [ ]

13. **Statement of Significance:**  
 The Greenup Masonic Lodge is significant under Criterion C as Greenup's best example of how Greek Revival and Italianate stylistic elements were combined to create impressive commercial buildings after the Civil War. [ C ]

14. **History:** The Greenup Masonic Lodge received its charter in 1827. By 1829, it had 155 members. The first Masonic Address was given by the Hon. J. M. McConnell, Greenup's representative in the Ky. legislature. The lodge met in the courthouse until 1865 when a movement began to build a lodge. In 1868, by legislative act, the Greenup Lodge was incorporated to construct a combination of commercial building and lodge hall.

15. **Source of historical information and/or contact person:** Dorothy Kendall Griffith, Mrs. Sam Leslie, Sanborn Insurance Map (1886)

16. **Date:**  
 Original Building 1867 [ 6 ]  
 Addition [ ]

17. **Style:**  
 Greek Revival [ 32 ]  
 Italianate [ 42 ]

18. **Architect/Builder:**  
 Unkno wn

19. **No. of Stories:** Three [ 3.0 ]

20. **Original Floor Plan:**  
 NA [ ]

21. **Single Pile**  **Double Pile**  **N.A.**

22. **Roof Form & Material:** **Original** \_\_\_\_\_  
 Hip/ asphalt **Not Original**

23. **Structural Material:**  
 Brick [ B ]

24. **Exterior Material:** [ B ]  
 Brick/common bond [ ]

25. **Foundation Material:**  
 Stone [ S ]

26. **Major Alterations:** **None** \_\_\_\_\_  
 Moved/Rebuilt **Other** \_\_\_\_\_  
 Additions first story storefront

27. **Special Features:**  
 None

28. **Outbuildings:**  
 None [ ]

29. **Original Function:**  
 Meeting Hall [ 03A ]

30. **Present Use:**  
 Commercial [ 02E ]

31. **Condition:**  
 Fair [ F ]

32. **Endangered:** **Yes** \_\_\_\_\_  
**No**

33. **Attach Photos:**  
 Roll: Photo Nos: No. of Slides:  
 1 1, 2

34. **Prepared by:** H. Powell & D. Griffith

35. **Organization:** Greenup Beautification Com

36. **Date:** 6/87

37. **New Survey**  **Resurvey** \_\_\_\_\_

KENTUCKY HISTORIC RESOURCES  
Individual Inventory Form

Resource # GpG-10

38. UTM Point of Primary Building: Zone 17 Easting 340000 Northing 4271320 39. G.I.S. Mod. [ ]  
 Quadrant: Greenup 40. Coordi.Accuracy [ ]

41. UTM Points of Boundary (for N. R. eligible sites only):

A. ----- D. -----  
 B. ----- E. -----  
 C. ----- F. -----

42. Total Acreage in Present Property: 43. Acreage included in proposed N.R. boundary: .037 acre  
 44. Site Plan (and boundary description and justification for N.R. sites):

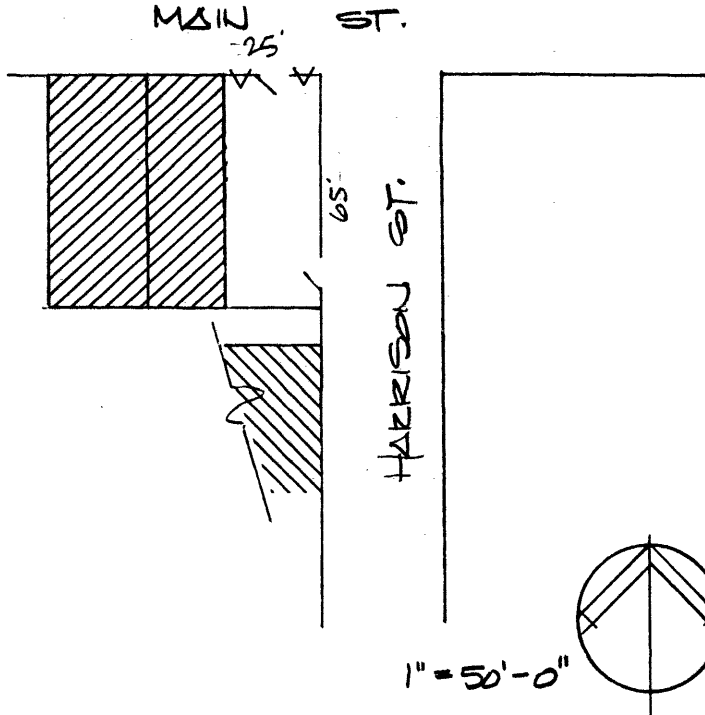

Starting at a point on the southeast corner of the intersection of Harrison and Main Streets; then south 65 feet along the west side of Harrison St. to the southeast corner of the lot of the Masonic Lodge; then west 25 feet along the south property line of the lodge to the southwest corner of the lot; then north along the west property line of the lodge to a point in the northwest corner of the lot of the Masonic Lodge; then east along the south side of Main St. 25 feet to the point of beginning.

The boundary contains one contributing building and all of the commercial lot for the Greenup Masonic Lodge.

45. Description and House Plan:

The Greenup Masonic Lodge is a rectangular three-story, common bond brick building. It is three bays on both Main Street and Harrison Street facades. Brick pilasters with stone capitals and bases delineate the bays on the Harrison Street side. The windows are 1/1 and have stone sills and lintels. The wide, plain brick cornice is separated from the rest of the facade by a single brick row. The overhanging eaves of the hip roof are supported by S-curved brackets.

The first floor facade on the Main Street side has been radically altered with a brick veneer, plate glass windows, and aluminum awning. Windows on the first floor of the Harrison Street facade have been bricked in and a doorway reduced in size. The stone lintels and sills of the altered windows are still visible. Despite the changes to the storefront, the building has retained the pilasters, lintels, and wide brick cornice associated with the Greek Revival style and the hip roof, overhanging eaves, and brackets associated with the Italianate style which lend the building its architectural quality especially in the upper stories.