

# Iowa Site Inventory

Office of Historic Preservation  
Iowa State Historical Department  
East 12th & Grand Avenue  
Des Moines, Iowa 50319

Site Number 15  
District Name \_\_\_\_\_  
Map Reference # 15

## Identification

- Site Name James Greer McQuilkin Round Barn
- Village/Town/City Eagle Center vic. Township Bruce County Benton
- Street Address County D56
- Legal Location 86 N 12 W 18 NE 1/4 of NE 1/4  
Urban: subdivision block parcel subparcel  
Rural: township range section 1/4 section of 1/4 section
- UTM Location: zone 15 easting 559,360 northing 4,679,600; Acreage less than one acre
- Owner(s) Name Kirk M. Mc Quilkin
- Owner(s) Address R. R. #1 La Porte City Iowa 50651  
(Street address) (City) (State) (Zip)
- Use: Present Hog barn Original Gen'l Purpose barn

## Description

- Date of Construction 1918 Architect/Builder James Greer McQuilkin
- Building Type:  
 single-family dwelling     industrial     other institutional     religious  
 multiple-family dwelling     educational     public     agricultural  
 commercial
- Exterior Walls:  clapboard     stone     brick     board and batten     shingles     stucco  
 other Clay Tile
- Structural System:  wood frame with interlocking joints     wood frame with light members (balloon frame)  
 masonry load-bearing walls     iron frame     steel frame with curtain walls     reinforced concrete  
 other \_\_\_\_\_
- Condition:  excellent     good     fair     deteriorated
- Integrity:  original site     moved—if so, when? \_\_\_\_\_  
 Notes on alterations, additions (with dates and architect, if known) and any other notable features of building and site:  
See reversed side.
- Related Outbuildings and Property:  barn     other farm structures     carriage house     garage     privy  
 other \_\_\_\_\_
- Is the building endangered?  no     yes—if so, why? \_\_\_\_\_
- Surroundings of the building:  open land     woodland     scattered outbuildings     densely built-up     commercial  
 industrial     residential     other \_\_\_\_\_

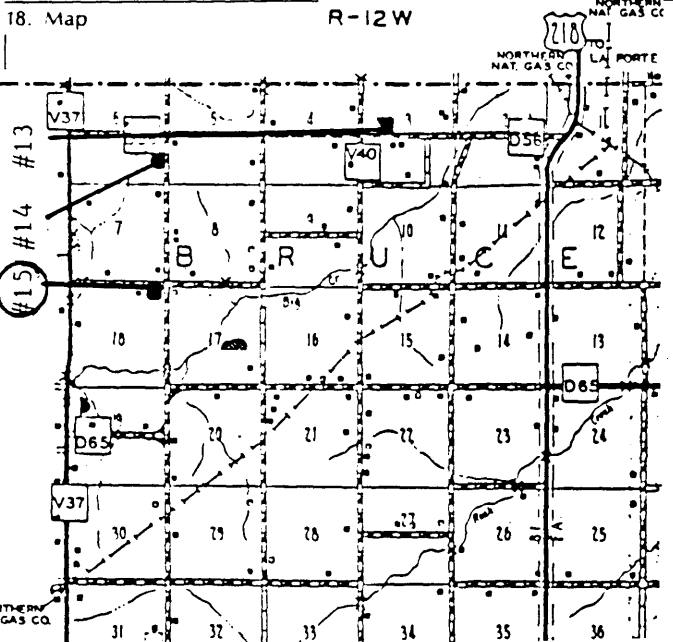

19. Photo Roll 692 Frame 8 View \_\_\_\_\_

VBD: A circle of 80' diameter, centered on the center point of the barn, includes no other buildings.

MAY 27 1986  
MAR 26 1986

# Significance (Indicate sources of information for all statements)

## 20. Architectural significance

- a. Key structure/individually may qualify for the National Register
- b. Contributing structure
- c. Not eligible/intrusion

N/A

Continuation of 14. Integrity.

Interior: Open with central silo,  $\frac{1}{4}$  for horse stalls. Built by company for whom J. G. McQuilkin sold barns. Diameter - 60', 45' high. Silo - clay tile diameter 14'. Cone shaped roof with gable hay dormer. Original cupola. Asphalt shingles. Concrete foundation.

Themes(s) True-Round; True-Round; Iowa/King type; Johnston Bros. Specialty Contractor; Clay Tile Supplier.

## 21. Historical Significance

- a. Key structure/individually may qualify for the National Register
- b. Contributing structure
- c. Not eligible/intrusion

Original owner, J.G. McQuilkin, "...farmed in northeast Benton County and sold barns on the side" (Soike 1983). Like this barn, the barns McQuilkin sold were of the typical Johnston Brothers' Clay Works design, with the clay tile of the exterior wall and silo wall likely supplied by the same. This barn is specifically characterized as a Johnston Brothers' sub-type by its exterior wall of "...small red clay tile in the lower story and larger tile above..." (Soike 1983). The conical roof is another common feature of the Johnston Brothers' design. The clay tile exterior wall and silo wall generally classify this barn as an Iowa Agricultural Experiment Station / Matt King influenced type. The use of structural clay tile was one of the later improvements in the history of round barns.

22. Sources (for primary and secondary sources, give complete facts of publication: author, title, place of publication, date, etc.):

- Kirk M. McQuilkin, RR 1, La Porte City, IA 50651
- Soike, Lowell J. Without Right Angles. Des Moines, Iowa: Iowa State Historical Department, Office of Historic Preservation, 1983.
- Wells, Wilson L. Barns in the U.S.A. San Diego, CA: Acme Printing Co., 1976.

Prepared by \_\_\_\_\_ Date \_\_\_\_\_  
 Address \_\_\_\_\_ Telephone \_\_\_\_\_  
 Organization \_\_\_\_\_

## For Office of Historic Preservation Use Only

### 1. Office Information Sources on this Property

- County Resource File
- Windshield Survey
- National Register
- Grants-In-Aid: \_\_\_\_\_
- Determination of Eligibility

### Review and Compliance Project:

- Other \_\_\_\_\_
- Other \_\_\_\_\_
- Other \_\_\_\_\_

### 2. Subject Traces

- a. \_\_\_\_\_
- b. \_\_\_\_\_
- c. \_\_\_\_\_
- d. \_\_\_\_\_
- e. \_\_\_\_\_

### 3. Photo Images \_\_\_\_\_

\_\_\_\_\_  
 \_\_\_\_\_  
 \_\_\_\_\_  
 \_\_\_\_\_