

United States Department of the Interior
National Park Service

National Register of Historic Places
Inventory—Nomination Form

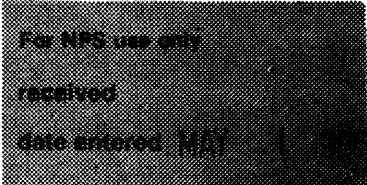

Continuation sheet Newell High School Item number BU-NL 3 Page 1

SITE BU-NL 3

NAME Newell High School (Rural Butte and Mease Studies MRA)

LOCATION Dartmouth Street between 4th and 5th Streets, Newell, Butte County (019), South Dakota (046)

OWNER Newell Board of Education
501 Dartmouth Street
Newell, South Dakota 57760

CLASSIFICATION Building, public, NA acquisition, occupied, restricted access, public school, education

DESCRIPTION Very good, altered (very slightly), original site

The Newell High School is the most imposing structure in Newell (1983 population, 638). Stylistically it is an English Vernacular Revival school and was constructed in the spring and summer of 1922. The campus of the school is located on a block facing Dartmouth Street (US Highway 212 and SD Highway 79), the major thoroughfare the school is surrounded by new buildings on the campus not included in this nomination.

The high school designed by the architectural firm of Johnson, Miller and Miller features Tudor arch doorways, stone trim and multipane casement windows. The building consists of two stories over a full basement. Only the first floor contains arched openings. The building is faced with red pressed brick and is topped with Tudor battlements.

The front elevation faces east and is approached by a dual cement walkway to either of the front doors. It features two end projecting sections with projecting doorways topped by Tudor battlements. The central portion divided into four visual units of four multipaned casement windows and topped by the Newell High School plaque surmounted by a large round stone arch with label stops and finials. The north elevation, which is duplicated on the south, has six multipaned windows in both stories surmounted by a molded cornice of brick headers that wraps around from the front elevation. The rear elevation faces west and has four multipaned windows in the second story and four windows in the first story. The brickwork above the level of the cornice can be seen as a false facade which wraps around tops of the east, north, and south elevations.

**United States Department of the Interior
National Park Service**

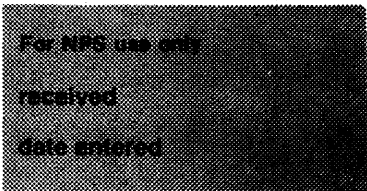

**National Register of Historic Places
Inventory—Nomination Form**

Continuation sheet Newell High School Item number BU-NL-3 Page 2

A gymnasium, three class rooms, office, rest rooms and coat rooms are located on the first floor. On the second floor is the auditorium, class rooms and coat rooms. The basement houses the shower facilities and other maintenance related rooms.

The only exterior alteration was the addition of wooden panels in the windows during the summer of 1984. These panels can be easily removed without compromising the architectural integrity of the school.

SIGNIFICANCE 1900-Present, architecture, education

DATE c. 1922

BUILDER Johnson, Miller and Miller

Newell High School is architecturally significant to Newell and South Dakota as an outstanding example of the English Vernacular Revival. The largest and most sophisticated rural school in Butte County, the Newell High School is located in a highly prominent location facing a major western South Dakota and United States highway. In addition to its numerous impressive architectural features, Newell High School attains significance in the area of education through its distinction as the largest rural school in Butte County with the most complete curriculum available to public school students.

On April 13, 1922 the plans for the Newell High School were approved by the Department of Public Instruction with a cost of \$55,000. Built through a largely community minded effort, the school was constructed during the summer and fall for opening early in 1923. Many Newell businesses donated supplies and equipment to aid in the building of the new school with much of the labor donated by local farmers and ranchers. Both the contractor, Mr. Webster, and the plumbing contractor, Henry O. Vik were local residents.

QUADRANGLE NAME Newell, South Dakota

UTM REFERENCE 141624650/4952580

QUADRANGLE SCALE 1:24000

ACREAGE Less than one acre

PHOTO REFERENCE NUMBER

United States Department of the Interior
National Park Service

National Register of Historic Places Inventory—Nomination Form

For NPS use only

received

date entered

Continuation sheet Newell High School Item number BU-NL 3 Page 3

VERBAL BOUNDARY DESCRIPTION

The site is bounded by the west edge of Dartmouth Street on the east and intersecting imaginary lines that extend ten feet from the exterior walls of the north, west, and south of the building. Newell High School is located in the NE quarter of the Ne quarter of Section 39 Township 9 North Range 6 East in Butte County.

United States Department of the Interior
National Park Service

National Register of Historic Places
Inventory—Nomination Form

For NPS use only

received

date entered

Continuation sheet NEWELL High School

Item number BU-NL3

Page 4

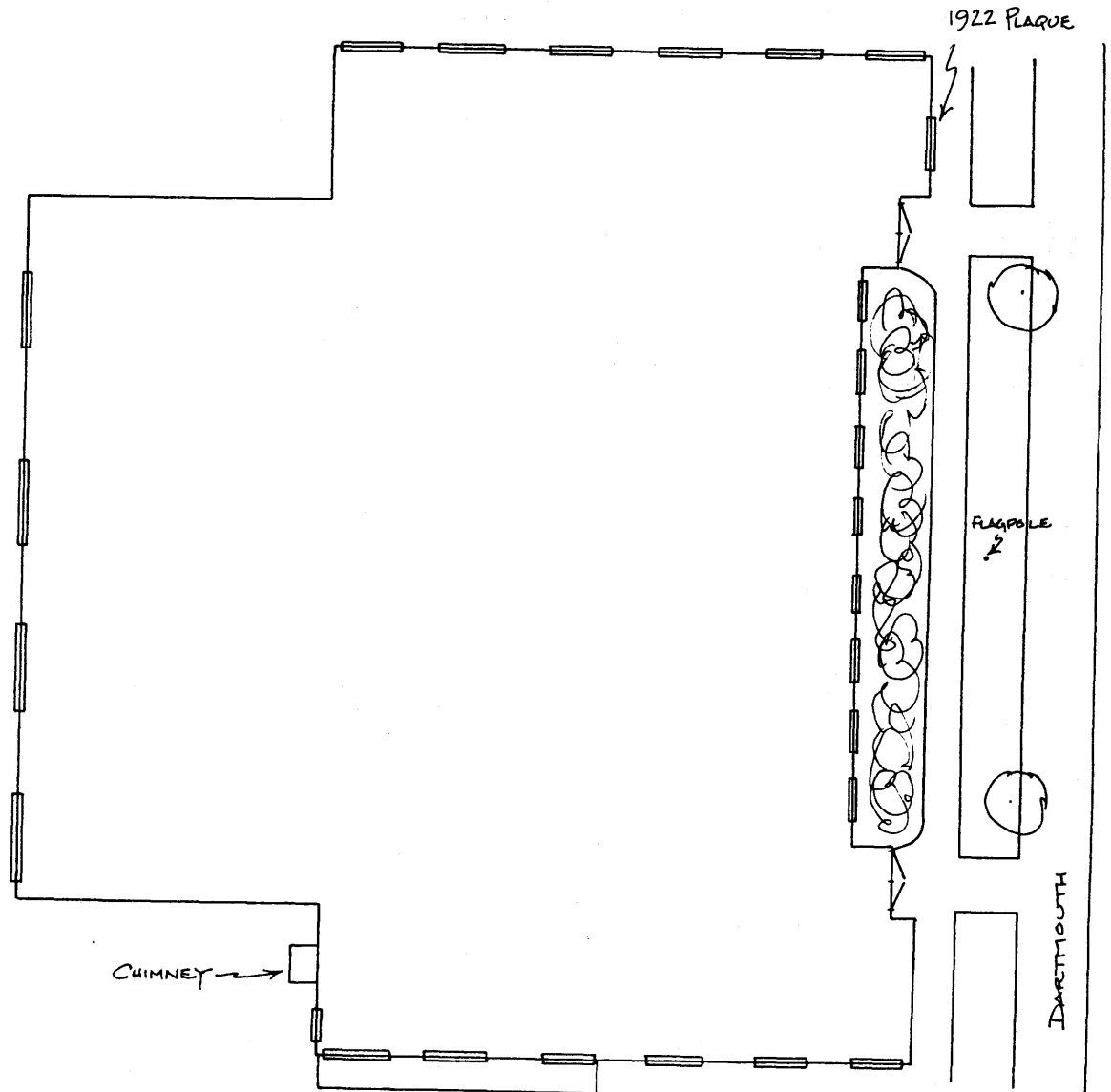

NOTE: 2ND STORY
WINDOWS IN N., S. & W. ELEVATIONS ARE LOCATED

NOTE: SECOND STORY