

United States Department of the Interior
National Park Service

For NPS use only

National Register of Historic Places
Inventory—Nomination Form

received AUG 5 1985

date entered SEP 5 1985

See instructions in *How to Complete National Register Forms*
Type all entries—complete applicable sections

1. Name

historic Christian F. Uytendale Farmstead

and or common Arthur and Anna Ulstad Farmstead

2. Location

street & number off County Highway 25 N/A not for publication

city, town Benson Township vicinity of City of Benson

state Minnesota code 22 county Swift code 151

3. Classification

Category	Ownership	Status	Present Use
<input type="checkbox"/> district	<input type="checkbox"/> public	<input checked="" type="checkbox"/> occupied	<input checked="" type="checkbox"/> agriculture
<input checked="" type="checkbox"/> building(s)	<input checked="" type="checkbox"/> private	<input type="checkbox"/> unoccupied	<input type="checkbox"/> commercial
<input type="checkbox"/> structure	<input type="checkbox"/> both	<input type="checkbox"/> work in progress	<input type="checkbox"/> educational
<input type="checkbox"/> site	Public Acquisition	Accessible	<input checked="" type="checkbox"/> private residence
<input type="checkbox"/> object	<input checked="" type="checkbox"/> N/A in process	<input type="checkbox"/> yes: restricted	<input type="checkbox"/> religious
	<input type="checkbox"/> being considered	<input type="checkbox"/> yes: unrestricted	<input type="checkbox"/> scientific
		<input checked="" type="checkbox"/> no	<input type="checkbox"/> transportation
			<input type="checkbox"/> other:

4. Owner of Property

name Arthur and Anna Ulstad

street & number Rural Route 1

city, town Benson N/A vicinity of state Minnesota 56215

5. Location of Legal Description

courthouse, registry of deeds, etc. Swift County Courthouse

street & number Idaho Avenue and 13th St. N.

city, town Benson state Minnesota 56215

6. Representation in Existing Surveys

title Minnesota Statewide Historic Sites Survey

has this property been determined eligible? yes no

date 1983-84 federal state county local

depository for survey records State Historic Preservation Office, Fort Snelling History Center

city, town St. Paul state Minnesota 55111

7. Description

<u> </u> excellent	<u> </u> deteriorated	<u> </u> unaltered	<u> X </u> original site
<u> X </u> good	<u> </u> ruins	<u> X </u> altered	<u> </u> moved
<u> </u> fair	<u> </u> unexposed		date <u> </u> N/A <u> </u>

Describe the present and original (if known) physical appearance

The Uytendale Farmstead is located on a 280 acre farm in Section 9 of Benson Township in northern Swift County, about six miles northeast of Benson, Minnesota. The farmstead is a beautiful, wooded site located on the south shore of Lake Hazel. The site consists of a farmhouse, six outbuildings, and a mobile home which was recently moved onto the farm. Although still well maintained, the Uytendale Farmstead was once well known for its carefully planned and manicured gardens, orchards, groves, and paths leading to the lake shore and throughout the farmstead.

The Uytendale Farmhouse was constructed in 1887 to replace a previous woodframe farmhouse. The new house was probably designed by its original owner, Danish immigrant Christian F. Uytendale, and constructed under his direction. The building is one of west central Minnesota's few farmhouses which so clearly shows a strong ethnic influence in its design. The house has an obviously European-influenced form and is a symmetrical 1½ story woodframe building constructed on a stone foundation and faced with narrow clapboard siding. The house is unusually long and shallow in plan, and has an intersecting gabled roof covered with wood shingles. Each of the four roof gables ends in a stepped parapet wall, a design element unique in western Minnesota. Cut-out finials with open diamond patterns once topped each level of the stepped gables on all facades, and wooden cresting with similar diamond-shaped patterning once lined the roof, projecting above the eaves. The house has a central single leaf door with transom and once had open porches on the south (main), east, and north facades which were topped by similar wooden cresting. Only the south porch remains, with a truncated hipped roof and turned columns. An early photograph of the house indicates that the north porch was supported by narrow rectangular columns with chamfered corners. The house has very tall and narrow windows with 2/2 sash, two interior chimneys, and originally had entrances on all four facades. On the west facade is a small hipped roof kitchen wing which was probably a very early addition to the building and appears on a circa 1900 photograph of the house. Exterior alterations to the house after circa 1900 have including removing the east and north porches, removing the north entrance, enlarging a main facade window, and removing the cresting and finials from the roof. The house is in good condition.

The interior of the Uytendale Farmhouse is basically intact. The house is only one room deep, and thus has an unusual floor plan with rooms arranged side by side across its width. Because of a lack of interior hallways, doors to the outside were located on all four sides. The house originally contained Uytendale's office and bedroom at the east end (with an exterior entrance), a central parlor (with an entrance leading north to the lakeshore), a dining room with a built-in opening to allow dishes to be passed from the kitchen, and a two room kitchen which included a separate dining area for farm and domestic employees. The house has very tall first floor ceilings and windows, woodwork with cornerblock ornamentation, wainscoting in the kitchen, and a main stairway with unusual square balusters with chamfered corners. Upstairs are three bedrooms for guests, servants, and family members who lived with Uytendale at various times. Interior alterations to the house have included removing the servants' stairway to the second story and adding one wall downstairs to create an extra bedroom.

The Uytendale Farmstead also contains a nearly complete set of outbuildings. The only outbuilding remaining from the period of Uytendale ownership is the circa 1900 granary, a gabled roofed frame building covered with shiplap siding and a wood shingled roof, which is located southwest of the house. South of the granary is a large gambrel roofed barn covered with clapboard siding which was constructed in 1916. A round wooden silo constructed of vertical boards held with metal bands, was built adjacent to the barn in 1917. East of the farmhouse is a quonset hut-like garage built in 1934 and a deteriorating corn crib erected

**United States Department of the Interior
National Park Service**

**National Register of Historic Places
Inventory—Nomination Form**

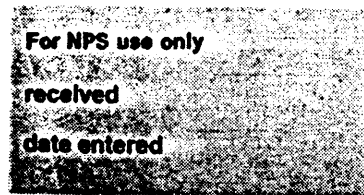

Continuation sheet Uytendale Farmstead

Item number 7

Page 1

Item #7 (Description) continued:

in 1935. West of the barn and granary is a gable roofed chicken house built in 1917, a hog house built in 1917 which has been altered and is deteriorating, and a mobile home which has recently been moved onto the site. The outbuildings are in good to deteriorating condition. A cattle barn, horse barn, and machine shed erected by Uytendale have been demolished.

8. Significance

Period	Areas of Significance—Check and justify below			
<input type="checkbox"/> prehistoric	<input type="checkbox"/> archeology-prehistoric	<input type="checkbox"/> community planning	<input type="checkbox"/> landscape architecture	<input type="checkbox"/> religion
<input type="checkbox"/> 1400-1499	<input type="checkbox"/> archeology-historic	<input type="checkbox"/> conservation	<input type="checkbox"/> law	<input type="checkbox"/> science
<input type="checkbox"/> 1500-1599	<input type="checkbox"/> agriculture	<input type="checkbox"/> economics	<input type="checkbox"/> literature	<input type="checkbox"/> sculpture
<input type="checkbox"/> 1600-1699	<input checked="" type="checkbox"/> architecture	<input type="checkbox"/> education	<input type="checkbox"/> military	<input type="checkbox"/> social/ humanitarian
<input type="checkbox"/> 1700-1799	<input type="checkbox"/> art	<input type="checkbox"/> engineering	<input type="checkbox"/> music	<input type="checkbox"/> theater
<input checked="" type="checkbox"/> 1800-1899	<input type="checkbox"/> commerce	<input checked="" type="checkbox"/> exploration/settlement	<input type="checkbox"/> philosophy	<input type="checkbox"/> transportation
<input checked="" type="checkbox"/> 1900-	<input type="checkbox"/> communications	<input type="checkbox"/> industry	<input type="checkbox"/> politics/government	<input type="checkbox"/> other (specify)
		<input type="checkbox"/> invention		

Specific dates 1887 (House) **Builder/Architect** Unknown

Statement of Significance (in one paragraph)

The Uytendale Farmstead in northeastern Swift County is historically significant as one of the first settled farms in the county, and as the home of Captain Christian F. Uytendale, a wealthy Danish immigrant who became one of the county's most well known turn of the century farmers and whose extensive farmstead was an early showplace in northern Swift County. The Uytendale farmhouse is historically significant as an unusual structure with a Danish-inspired design which is unique in Swift County and is probably the only house of its type in west central Minnesota.

The land occupied by the Uytendale Farmstead, located on the south shore of Lake Hazel, was one of the first settled farms in Swift County. The farm was originally homesteaded in 1868 by Norwegian immigrant Johannes Torgerson (1823-1909) who came to the area in 1867 from Wisconsin with two companions. Torgerson returned to Wisconsin and brought to Swift County the next summer a total of eight Norwegian families who settled together in a group around Lake Hazel. This group of families formed the nucleus of the Lake Hazel Lutheran Church. Torgerson first lived in a dugout on this property and later lived in a small woodframe house with his wife Ingeborg Stokkestad Torgerson (1836-1919).

In 1879 the Torgersons sold their farm for \$2,500 to Captain Christian F. Uytendale, who had come to the area the previous year.¹ Uytendale was born in Denmark in 1842 and immigrated to the United States in 1877. Known locally as "baron" or "captain" Uytendale, he was a wealthy, unmarried man who was believed locally to have been a member of a noble Danish family with a mysterious and possibly tragic background, although research indicates that he was probably the son of wealthy farmers.² Uytendale first lived in the house erected by Torgerson, but in 1887 built the present farmhouse, obviously inspired by a Danish design. Uytendale's house, outbuildings including a cattle barn, horse barn, granary, and machine shed, and extensive orchards, groves, and gardens became a showplace in the county. His 280 acre farm was operated by a staff of local farm laborers and domestic servants. Beginning circa 1895 a niece and nephew, Marie A. and Lucas E. de Bretton, and various other relatives lived with him. Uytendale was a leading member of the local Lake Hazel Lutheran Church, and was socially prominent in the area. His activities were frequently reported in local newspaper articles such as those describing an 1888 afternoon picnic and rowing party he held for nine leading Benson families and an 1893 trip where he attended the opening of the Chicago World's Fair "at the invitation of the Danish Ministry, several of whom are his intimate friends."³ Uytendale continued to live on his Lake Hazel farm until 1902 when he sold the farm and moved with a niece and nephew near Whitewood, Saskatchewan, Canada. In Canada Uytendale homesteaded and purchased two parcels of farmland where he lived until his death January 4, 1912.

¹Known also as Kristian Uytendahl and Christian Frederick Uytendale de Bretton.

²In a letter to Mrs. A. E. Iverson, 302 Jerrerson Rd. Princeton, N.J. the Danish National Archives indicated that the name Uytendahl de Bretton is not entered into the Annual of Danish Nobles but that Uytendale may be a decendent of Baron Lucas Uytendale de Bretton, a planter, probably in the Danish colonies in the West Indies.

³Benson Times, July 24, 1888 and May 9, 1893.

9. Major Bibliographical References

Property deed records, Swift County Courthouse, Benson.
 Swift County Monitor, November 29, 1912 and January 12, 1912.
 Swift County Review, January 19, 1912 and December 3, 1912.
 Whitewood [Saskatchewan] Herald, January 4, 1912.

SEE CONTINUATION SHEET

10. Geographical Data

Acreage of nominated property 2½ acres

Quadrangle name Lake Hassel Quad.

Quadrangle scale 7.5

UTM References

A

1	5	2	9	8	6	8	0	5	0	2	8	8	6	0
Zone		Easting						Northing						

B

Zone		Easting						Northing					

C

Zone		Easting						Northing					

D

Zone		Easting						Northing					

E

Zone		Easting						Northing					

F

Zone		Easting						Northing					

G

Zone		Easting						Northing					

H

Zone		Easting						Northing					

Verbal boundary description and justification

The property nominated is all that which is located in the northwest quarter, southwest quarter of the southeast quarter and the northeast quarter, northeast quarter of the southwest quarter, Section 9, T. 122 North, R. 39 West, Benson Township, Swift County.

List all states and counties for properties overlapping state or county boundaries

state N/A code N/A county N/A code N/A

state N/A code N/A county N/A code N/A

11. Form Prepared By

name/title Susan Granger, Field Assistant

organization State Historic Preservation Office
Minnesota Historical Society

date December 1984

street & number Fort Snelling History Center

telephone (612) 726-1171

city or town St. Paul

state Minnesota 55111

12. State Historic Preservation Officer Certification

The evaluated significance of this property within the state is:

national state local

As the designated State Historic Preservation Officer for the National Historic Preservation Act of 1966 (Public Law 89-665), I hereby nominate this property for inclusion in the National Register and certify that it has been evaluated according to the criteria and procedures set forth by the National Park Service.

State Historic Preservation Officer signature

Russell W. Fridley

title Russell W. Fridley
State Historic Preservation Officer

date

7/12/85

For NPS use only

I hereby certify that this property is included in the National Register

Delores Byer
Keeper of the National Register

Entered in the
National Register

date

9/5/85

Attest:

date

Chief of Registration

United States Department of the Interior
National Park Service

National Register of Historic Places
Inventory—Nomination Form

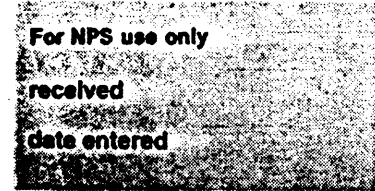

Continuation sheet Uytendale Farmstead

Item number 8, 9

Page 1

Item #8 (Significance) continued:

In April of 1902 the Uytendale Farm was purchased by Amund and Christina Lee (also members of the Lake Hazel Lutheran Church) for \$9,400. The Lees sold the property to their daughter and son-in-law, Agnete and Lawrence Ulstad in 1911, and in 1938 it was sold to a third generation of family members, the Ulstad's son Arthur and his wife Anna. Arthur and Anna Ulstad continue to own and operate the farm. Since 1902 new outbuildings have been erected on the site by the Ulstads including a barn (1916), silo (1917), chicken house (1917), hog house (1919), garage (1934), and corn crib (1935). All of these buildings are still standing, along with the Uytendale house (1887) and a granary built by Uytendale circa 1900. A mobile home has recently been moved onto the property.

The Uytendale Farmstead was included in a fifteen month historic sites survey of seven west central Minnesota counties conducted in 1983-84 by the State Historic Preservation Office. The survey staff determined that the Uytendale Farmhouse is unique in the seven county area because of its unusual Danish-inspired design. It is unlike any other farmhouse surveyed in the area, which is dominated by farmhouses based on standard Victorian vernacular designs and farmhouses based on variations on high style Victorian architecture. The Uytendale Farmhouse is one of the few farmhouses in west central Minnesota which so clearly shows an ethnic influence on its design.

Item #9 (Bibliographical References) continued:

Clausen, Heidi S., Assistant Archivist in First Department, Danish National Archives, letter to Mrs. A. E. Iverson, 302 Jefferson Road, Princeton, N.J. 08540, March 28, 1984. Benson Times, July 12, 1887; July 24, 1888; May 9, 1893; April 1, 1902; and April 8, 1902. Information provided by Art Ulstad, present owner of Uytendale Farmstead. Information provided by Mildred Torgerson, granddaughter of Johannes Torgerson.

Christian F. Uytendale Farmstead
Section 9 Benson Township, Swift County, Minn.

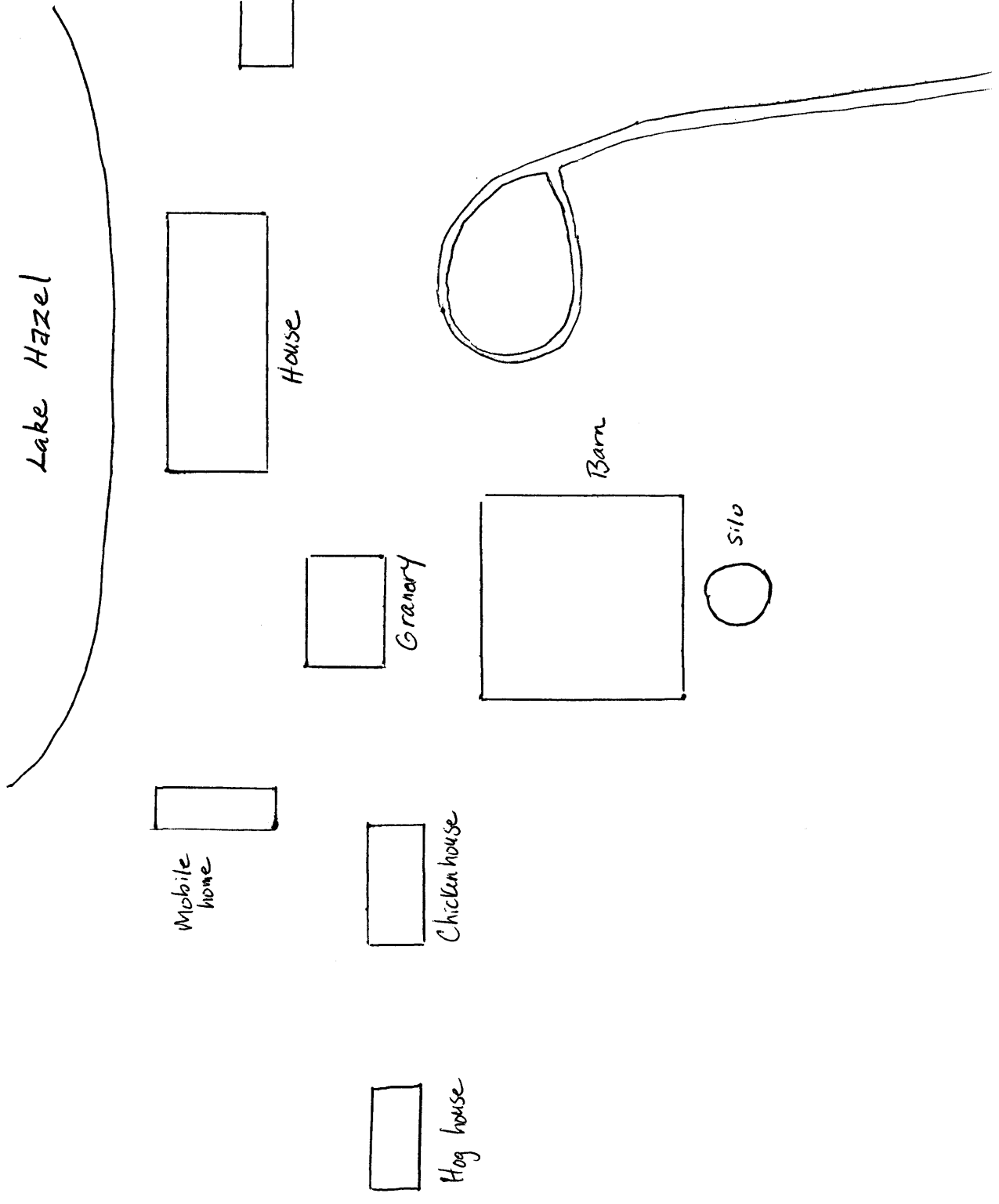

United States Department of the Interior
National Park Service

National Register of Historic Places Continuation Sheet

Section number _____ Page _____

ADDITIONAL INFORMATION

for Keeper Melvin Lynn
1/19/89

United States Department of the Interior
National Park Service

National Register of Historic Places Continuation Sheet

Section number _____ Page _____

Note: These changes apply to
Uytendale, Christian F., Farmstead
in Swift County, Minnesota.

REFERENCE NUMBER: 85001989

STATE: MINNESOTA

COUNTY: Swift

RESOURCE NAME (HISTORIC):

CITY:

VICINITY OF: Benson

ADDRESS: Co. Hwy. 25

CERTIFICATION DATE:

REMOVED DATE:

COMMENTS:

Nina M. Archabal
Nina M. Archabal
State Historic Preservation Officer

JUN 17 1988
Date