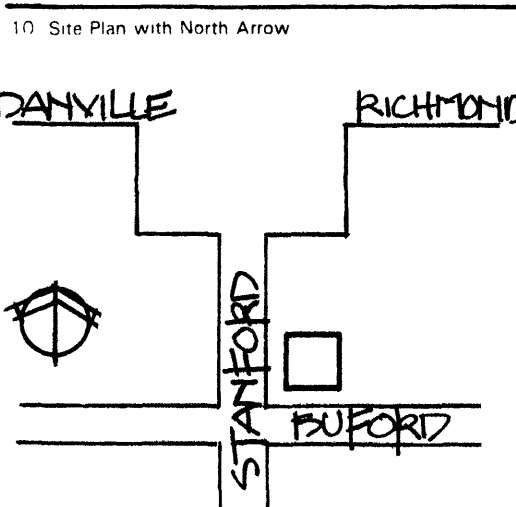
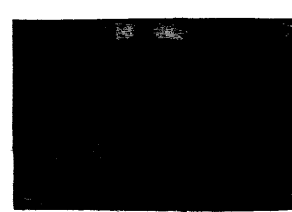

KENTUCKY HISTORIC RESOURCES INVENTORY

Site No. GDL 8

1 Historic Name(s) <u>Garrard County Jail</u>		22. ADD/County <u>BLUEGRASS/ GARRARD</u> 040	
Original Owner <u>Garrard County</u>		23. U.S.G.S. Quadrant (15'/75') <u>Lancaster</u> G.I.S. Mod.	
2 Present Name <u>Garrard County Jail</u>		24. UTM Reference <u>16 7 13 705 4 16 60 20</u>	
3 Location <u>Stanford Street</u>		Zone Easting Northing	
4 Owner's Name <u>Garrard County</u>		25. Coordinate Accuracy 	
5 Owner's Address <u>Garrard County Court House, Lancaster, Ky. 40444</u>		26. Prehistoric Site Object Historic Site Structure <input checked="" type="checkbox"/> Building Other	
6 Open to Public Yes <input type="checkbox"/> No <input checked="" type="checkbox"/>		27. National Register District Name: <u>Multiple Resources of Lancaster</u>	
7. Visible from road Yes <input checked="" type="checkbox"/> No <input type="checkbox"/>		28. Significance Evaluation D	
8. Ownership Private <input type="checkbox"/> Local <input checked="" type="checkbox"/> State <input type="checkbox"/> Federal <input type="checkbox"/>		29. Status Date National Landmark <input type="checkbox"/> National Register <input type="checkbox"/> Landmark Certificate <input checked="" type="checkbox"/> <u>1974</u> Kentucky Survey <input type="checkbox"/> Local Landmark <input type="checkbox"/> HABS/HAER <input type="checkbox"/>	
9. Local Contact/Organization GARRARD COUNTY HISTORICAL SOCIETY		30. Historic Theme Primary <input type="checkbox"/> Secondary <input type="checkbox"/> Other <input type="checkbox"/>	
10. Site Plan with North Arrow 		11. Architect <u>Edwin May -Indianapolis</u>	
		12. Builder <u>J.S. Goshern- Ft. Wayne</u>	
		13. Date <u>1873</u> A. <input checked="" type="checkbox"/> B. <input type="checkbox"/>	
		14. Style A. <u>Italianate</u> <input checked="" type="checkbox"/> B. <input type="checkbox"/>	
		15. Original Use <u>Jail</u> <input checked="" type="checkbox"/>	
		16. Present use <u>Jail</u>	
		17. Condition <u>Fair</u> <input checked="" type="checkbox"/>	
18. Description <u>2 story 4 bay brick Italianate structure; limestone foundation; hip roof with overhanging eaves and brackets; windows 2/2 with stone sills & lintels; raised first story with semi-circular stairs; iron fence along Stanford St.</u>		No. Stories <u>Two</u> <input checked="" type="checkbox"/> Single Pile <input type="checkbox"/> NA <input checked="" type="checkbox"/> Double Pile <input type="checkbox"/> Floor Plan <input type="checkbox"/> Structural Fabric <u>Brick</u> A. <input checked="" type="checkbox"/> B. <input type="checkbox"/> Decorative Fabric <u>Cast Iron</u> A. <input checked="" type="checkbox"/> B. <input type="checkbox"/> Roof Form <u>Hip</u>	
(Continue on Back)		31. Endangered Yes <input type="checkbox"/> No <input checked="" type="checkbox"/>	
19. History <u>This is the second jail built for the county in 1873. The building committee for this jail were: E. Brown, Chmm; E.H. Burnside, Secy; J. M. Doty, H. S. Burnham; George Smith, Supt.</u>		32. Preservation Project Status <input type="checkbox"/> Actual Cost in \$1,000s 	
20. Significance <u>Continuously used for the county jail since construction in 1873. Good example of Italianate style.</u>		33. ATTACH PHOTO 	
21. Source of Information <u>Plaque on corner of building Sanborn Map 1886</u>		34. Prepared by: HELEN POWELL	
		35. Organization CARMAN AND POWELL, INC.	
		36. Date 1983	
		37. Revision Dates 38. Staff Review	

KENTUCKY HISTORIC RESOURCE INVENTORY SUPPLEMENT
BOUNDARY AND LOCATION INFORMATION

Historic Property Name Garrard County Jail Site # GDL 8
Multiple Resource/Thematic Nomination Title Multiple Resources of Lancaster

U.T.M. Coordinates - List multiple UTMs if property is ten or more acres.

A. _____ D. _____
B. _____ E. _____
C. _____ F. _____

Verbal Boundary Description _____ Acreage .07

Beginning at a point 60 feet north of the intersection of Stanford St. and Buford St. on the east right of way of Stanford St.; then 70 feet east to a point; then 60 feet north to a point; then 70 feet west to a point; then 60 feet south along the east right of way of Stanford St. to the point of beginning.

Sketch of Site Plan (Showing outbuildings, structures, landscape features and the site boundary as described above.)

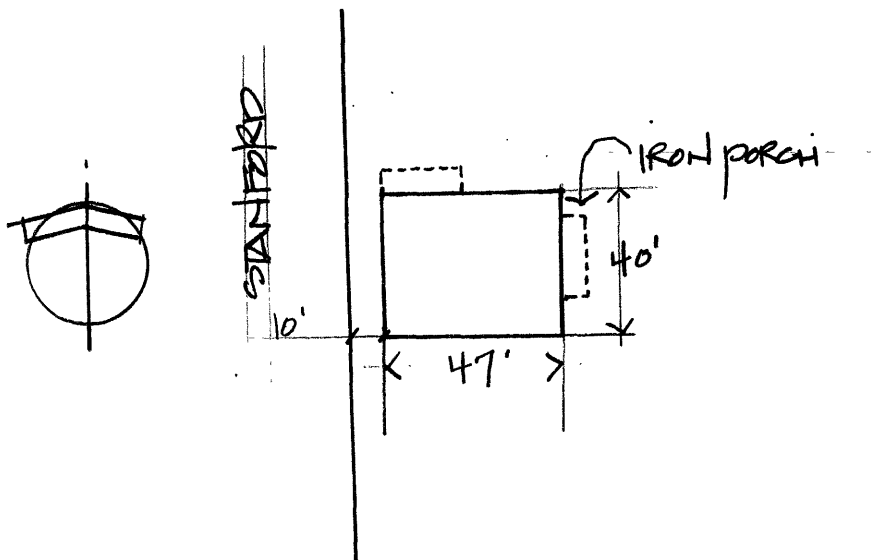

Official Courthouse Property Reference: