

Davenport
Department of Community Development
Iowa Office of Historic Preservation
Dennett, Muessig & Associates, Ltd.

DAVENPORT

SURVEY 1982

SITE #82-10-10-E1316 MAP NUMBER
HISTORIC DISTRICT
NAME Israel Hall House
ADDRESS 1316 E. 10th St.



LEGAL DESCRIPTION Fulton's Add., Blk. 11, Lot 3

ACREAGE <1 ZONE R6M UTM 15/703930 4600300
OWNER John V. Bloom TITLE H
2342 E. 11th Street
Davenport IA 52803

DESCRIPTION

ARCHITECTURAL STYLE Greek Revival DATE c.1878
FORM two stories, side gable, rectangular plan w/5 bay symmetrical front; hipped-roof addition across rear and NW corner, two stories; one-story room attached at extreme rear
MATERIALS brick construction; stone lintels and sills on front; rubble ashlar foundation
FENESTRATION aluminum sash; side and rear windows have segmental arches; round-arched window in each main gable end
FEATURES narrow molding (half-round) defines frieze; main entrance retains panelled soffit and reveals
ALTERATIONS rear addition c. 1895; full veranda added after 1892, replacing a 1-bay porch; both now replaced with modern flat roof, and entrance partly filled in to accommodate new door; exterior painted white
SITE well set back on terraced lot that is well above street level

ARCHITECTURAL SIGNIFICANCE The Hall house is a locally-significant, but apparently rather late, example of the side-gable Greek Revival which, influenced by the earlier Georgian, retained a formal symmetry and side gable orientation rather than the temple front more strongly associated with the Greek Revival. Along with the nearby 1333 E. 10th, this house is one of two good examples of this early Davenport style remaining in the Fulton Addition. The round-arched attic-level window is a recurring motif in Davenport's domestic architecture from this period. The turn of the century addition, although large, does not alter the basic character of the original house, which could be considerably improved simply by restoring the main entrance.

HISTORICAL DATA

This house was built c. 1878 for Israel Hall. Hall was alternately retired and Secretary-Treasurer of the Oakdale Cemetery Corporation in the years after this house was built. Hall may have use the house as a boarding house as well.

HISTORICAL SIGNIFICANCE

SOURCES John Milner Associates, East Davenport Survey, 1977
Davenport City Directories, 1873, 1878, 1881, 1890-91
Biographical History and Portrait Gallery of Scott County, Iowa.
Chicago: American Bibliographical Publishing Co., 1895.

ARCHITECTURAL EVALUATION

DESIGN good STATURE incident
LEVEL OF SIGNIFICANCE local

CONTEXT good FABRIC good
DISTRICT CLASSIFICATION

HISTORICAL EVALUATION

PRIMARY THEME
LEVEL OF SIGNIFICANCE

SECONDARY THEME

NATIONAL REGISTER ELIGIBLE yes

PHOTO ID 1743-34A,35A,36A

Martha H. Bowers, Architectural Historian

Marlys Svendsen, Historian

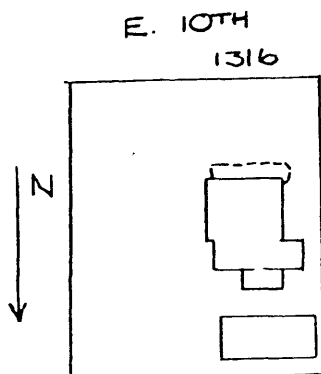

FOR DIVISION OF HISTORIC PRESERVATION USE ONLY

1 DATE RECEIVED _____

2 DATE OF STAFF EVALUATION _____

	A ARCHITECTURAL	B HISTORICAL
ELIGIBLE FOR NRHP	<input type="checkbox"/>	<input type="checkbox"/>
NOT ELIGIBLE FOR NRHP	<input type="checkbox"/>	<input type="checkbox"/>

3 NRHP ACTION

A STATE REVIEW COMM	APP <input type="checkbox"/>	DISAPP <input type="checkbox"/>	TABLED <input type="checkbox"/>	DATE _____
B FEDERAL REVIEW	APP <input type="checkbox"/>	DISAPP <input type="checkbox"/>	TABLED <input type="checkbox"/>	DATE _____

4 DHP SOURCES

<input type="checkbox"/> COUNTY RESOURCES	<input type="checkbox"/> DET OF ELIGIBILITY
<input type="checkbox"/> W-SHIELD SURVEY	<input type="checkbox"/> R B C _____
<input type="checkbox"/> NRHP	<input checked="" type="checkbox"/> DAVENPORT A/M SURVEY
<input type="checkbox"/> GRANT _____	<input type="checkbox"/> _____

5 SUBJECT TRACES _____

6 PHOTO _____