

Hoersch, John, House (Davenport MRA)
Scott County
IOWA

Working No. _____

Fed. Reg. Date: _____

Date Due: 6/23/83 - 7/8/83

Action: ACCEPT
 RETURN 7/7/83
 REJECT

Federal Agency: _____

- resubmission
- nomination by person or local government
- owner objection
- appeal

Substantive Review: sample request appeal NR decision

Reviewer's comments:

Recom./Criteria _____

Reviewer _____

Discipline _____

Date _____

see continuation sheet

Nomination returned for: technical corrections cited below
 substantive reasons discussed below

1. Name

2. Location

3. Classification

Category	Ownership	Status	Present Use
	Public Acquisition	Accessible	

4. Owner of Property

5. Location of Legal Description

6. Representation in Existing Surveys

Has this property been determined eligible? yes no

7. Description

Condition		Check one	Check one
<input type="checkbox"/> excellent	<input type="checkbox"/> deteriorated	<input type="checkbox"/> unaltered	<input type="checkbox"/> original site
<input type="checkbox"/> good	<input type="checkbox"/> ruins	<input type="checkbox"/> altered	<input type="checkbox"/> moved date _____
<input type="checkbox"/> fair	<input type="checkbox"/> unexcavated		

Describe the present and original (if known) physical appearance

- summary paragraph
- completeness
- clarity
- alterations/integrity
- data

8. Significance

Period _____ Area of Significance—Check and justify below

Specific dates _____ Builder/Architect _____

Statement of Significance (in one paragraph)

- summary paragraph
- completeness
- clarity
- applicable criteria
- justification of areas checked
- relating significance to the resource -
- context
- relationship of integrity to significance
- justification of exception
- other

9. Major Bibliographical References

10. Geographical Data

Acreage of nominated property _____

Quadrangle name _____

USFT References

Verbal boundary description and justification

11. Form Prepared By

12. State Historic Preservation Officer Certification

The evaluated significance of this property within the state is:

national state local

State Historic Preservation Officer signature

title _____ date _____

13. Other

- Maps
- Photographs *Please provide photo*
- Other

Questions concerning this nomination may be directed to _____

Signed *William Byers* Date 7/7/83 Phone: 202 272-350
343-9553

Comments for any item may be continued on an attached sheet

ARCHITECTURAL/HISTORICAL SURVEY

DAVENPORT, IOWA

The Architects Office

Wehner, Nowysz, Pottschull and Pfiffner
801 day building Iowa city Iowa 52240

DAVENPORT COMMUNITY DEVELOPMENT DEPARTMENT
IOWA DIVISION OF HISTORIC PRESERVATION

SITE #82-10- VI-716 MAP # 3

HIST. DIST. _____

NAME John Hoersch House H C

ADDRESS 716 Vine Street

LEGAL DES. Mitchell's 3rd Add. N 46' of 6 and S
SUB-DIVISION 14 BLOCK 1/2 of lot 7 PARCEL SUB-PARCEL

UTM 15 701280 4599900 ACREAGE -1 ZONE R-6M
EASTING NORTHING

OWNER Winton D. Anderson
1365 W. 34th St., Davenport, IA 52806

TITLE H. _____
(IF DIFF) _____

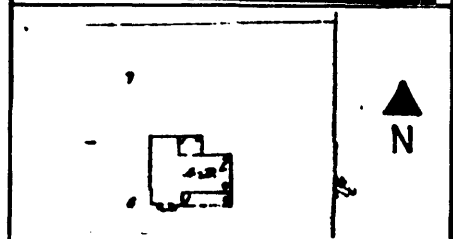

SITE SHEET

DESCRIPTION

2 story T-plan gable-roofed house, veranda along stem of T,
FORM central brick chimneys CONST. DATE 1879
MATERIALS Wood frame, stone foundation ARCH STYLE Vernacular
FENESTRATION Mostly rectangular; two front windows have cut upper corners
DIST. FEATURES Bracketted veranda w/small pendants, polygonal window bay at front
ALTERATIONS Porch railings, window sash
SITE & RELATED STR. Very steeply-sloping lot

ARCHITECTURE

STATEMENT

The L- or T-plan wood frame "farmhouse" is a common form in Iowa and the Midwest, but quite unusual in so heavily urban an environment as Davenport. This house is a good representation of its type, its basic form embellished with a well-preserved jigsaw-work veranda and decorative windows on the main elevation.

SOURCES

SIGNIFICANCE

HISTORY

DESCRIPTION

This house was probably built in 1879 by John Hoersch. Hoersch came to the Scott County area in the 1850's. He moved to this location in 1880 and continued at this address until the 1890's.

SOURCES

City Directories, 1878, 1880, 1890-91.
 Downer, Harry E., History of Davenport and Scott County, Iowa, Vol. II Chicago: S. J. Clarke Publishing Co., 1910.

ARCHITECTURAL HISTORIAN: Martha Bowers

HISTORIAN: MARLYS SVENDSEN - ROESLER

SURVEY COMP 1981

EVALUATION

ARCHITECTURAL

I. ARCH EVALUATION Good
 II. ENVIR. STATURE Incident
 III. INT OF CONTEXT Good
 IV. INT OF FABRIC Good

LEVEL OF SIGNIFICANCE.

NAT STATE LOCAL N ELIG

HISTORICAL

I. THEME(S) OF SIGNIFICANCE

A PRIMARY _____
 B SECONDARY _____

II. LEVEL OF SIGNIFICANCE

NAT STATE LOCAL

III. NRHP

ELIGIBLE NOT ELIGIBLE

HISTORIC DISTRICT CLASSIFICATION

FOR DIVISION OF HISTORIC PRESERVATION USE ONLY

1. DATE RECEIVED _____

2. DATE OF STAFF EVALUATION _____

	A ARCHITECTURAL	B HISTORICAL
ELIGIBLE FOR NRHP	<input type="checkbox"/>	<input type="checkbox"/>
NOT ELIGIBLE FOR NRHP	<input type="checkbox"/>	<input type="checkbox"/>

3. NRHP ACTION

A STATE REVIEW COMM APP DISAPP Tabled DATE _____
 B FEDERAL REVIEW APP DISAPP Tabled DATE _____

4. DHP SOURCES

<input type="checkbox"/> COUNTY RESOURCES	<input type="checkbox"/> DET. OF ELIGIBILITY
<input type="checkbox"/> WSHIELD SURVEY	<input type="checkbox"/> R & C _____
<input type="checkbox"/> NRHP	<input checked="" type="checkbox"/> DAVENPORT A/H SURVEY
<input type="checkbox"/> GRANT _____	<input type="checkbox"/> _____

5. SUBJECT TRACES

6. PHOTO

1618-4

1981