

Ref # 10000000

FOR HCRS USE ONLY
RECEIVED SEP 16 1980
DATE ENTERED NOV 25 1980

NATIONAL REGISTER OF HISTORIC PLACES INVENTORY -- NOMINATION FORM

Marshallville
Commercial
District

CONTINUATION SHEET

ITEM NUMBER

PAGE 1

1. Name: Marshallville Commercial District
Marshallville, Georgia
2. Location: The Marshallville Commercial District consists of two blocks of buildings, one on either side of the railroad tracks, facing Main Street. (See Map C.)
3. Classification: District
Private Ownership
Occupied
Accessible-Unrestricted
Present Uses: Commercial
Industrial
Transportation
4. Owner of Property: Multiple Ownership (See attached list, p. 3)
5. Location of Legal Description: Clerk of the Superior Court, Macon County Court-house - Oglethorpe, Georgia
6. Representation in Existing Survey: None
7. Description:

The Marshallville Commercial District is a small, two block collection of late-nineteenth century commercial buildings in downtown Marshallville. Fronting East and West Main Streets, they are separated from the street by a single sidewalk. The buildings are all made of brick, and are one and two stories in height. A Central of Georgia railroad line bisects the district, extending north and south. The Victorian styled railroad depot sits to the east of the tracks. Mid-twentieth century industrial sites border the district to the north and south, while residential districts are adjacent to the east and west. A few intrusions (gas stations, convenience store) break up the continuity between this district and the West Main Street Residential District.

All of the buildings, except for the depot and the Elberta Hotel, can be termed Victorian commercial architecture. They feature Romanesque arched windows, vents, brick corbelling and other typical details of the period. The Citizen's Bank Building also utilizes some classical features, such as stone pilasters. There are no intrusions, such as modern buildings, within the district. However,

**NATIONAL REGISTER OF HISTORIC PLACES
INVENTORY -- NOMINATION FORM**

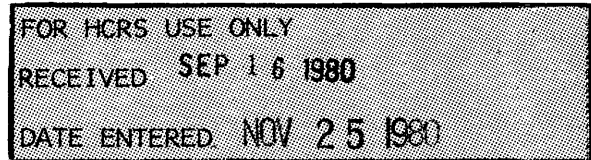

Marshallville
Commercial
District

CONTINUATION SHEET

ITEM NUMBER

PAGE 2

several of the buildings have been altered with the addition of false metal facades. Map C shows the elements of the district.

8. Significance:

The Marshallville Commercial District is a direct result of the railroad's influence and the area's involvement with agriculture. Since 1851, when the railroad was constructed through Marshallville, commercial structures have naturally gravitated around the tracks. Originally these were plantation oriented businesses, such as blacksmiths' shops. They ultimately became dry goods stores, grocery stores, general stores, and banks. With the success of the fruit industry, this district became both the shipping station (in conjunction with the depot) and the financial center. (Buyers stayed at the Elberta Hotel while conducting business in the community.) After the first decade of the twentieth century the peach industry faltered and the CBD declined.

Architecturally, the Marshallville Commercial District is a cohesive group of Victorian commercial buildings. Although none are outstanding individually, collectively they gain significance as a well-preserved architectural group typical of rural communities. Detailed inventory forms on three of the buildings within this district have been completed. They follow this summary.

9. Bibliographical References: See references for Multiple Resource Area and individual inventory forms.

10. Geographical Data:
Acreage 7.5 Acres

U.T.M. Reference
A) Z.17 E.223470 N.3594770
B) Z.17 E.223680 N.3594690
C) Z.17 E.223640 N.3594530
D) Z.17 E.223440 N.3594420

Verbal Boundary
Description: The boundary of this district is described by a heavy black line on the attached "property/sketch" map of the Marshallville Commercial District.

UNITED STATES DEPARTMENT OF THE INTERIOR
HERITAGE CONSERVATION AND RECREATION SERVICE

**NATIONAL REGISTER OF HISTORIC PLACES
INVENTORY -- NOMINATION FORM**

FOR HCRS USE ONLY
RECEIVED SEP 6 1980
DATE ENTERED NOV 25 1980

Marshallville
Commercial
District

CONTINUATION SHEET

ITEM NUMBER

PAGE 3

PROPERTY OWNERS

Mr. Julian E. Watson
P.O. Box 198
Marshallville, Ga 31057

First State Bank of Marshallville
Marshallville, Ga 31057

Mr. Ambrose Felton
P.O. Box 294
Marshallville, Ga 31057

D.L. Masee, Jr.
c/o D.L. Masee, Sr.
1045 Hurt Bldg.
Marshallville, Ga 31057

Mr. I.F. Murph
Marshallville, Ga 31057

Ms. Virginia H. Lloyd
5066 Idle Wood Drive
Macon, Ga 31204

Mr. Doyle Johnson
Marshallville, Ga 31057

E. & H. Machine Shop, Inc.
Marshallville, Ga 31057

T.T. Turner and R.P.
Turner, Jr.
Marshallville, Ga 31057

Ms. Celletta Grice
Marshallville, Ga 31057

Mr. Burke B. Murph
Marshallville, Ga 31057

Mr. Larry E. Garrett
P.O. Box 348
Marshallville, Ga 31057

F.L., M.F., and Della McKenzie
c/o Monroe McKenzie
Marshallville, Ga 31057

Russell and Patricia McIlrath
P.O. Box 274
Marshallville, Ga 31057

Mr. J.D. Chappell
Marshallville, Ga 31057

MARSHALLVILLE AND MACON COUNTY MULTIPLE RESOURCE NOMINATION
ARCHITECTURAL AND HISTORIC PROPERTIES INVENTORY FORM

No. 22
(Comm. Dist.,
p. 4)

IDENTIFICATION

Property Name Johnson's Farm Service Historic Name Central of Georgia Depot
Street Address East Main Street City Marshallville County Macon
Present Owner Doyle Johnson Street Address _____
City Marshallville State Georgia ZIP Code 31057
Original Owner Central of Georgia Railroad Acreage Less than 1
U.S.G.S. Quadrant _____ U.T.M. Reference _____
Tax Map Reference _____

Architectural Description and Present Condition: One story brick building with a loading platform on the south side. Composition roof. Wide overhang supported by brackets. Brick bay ticket office. Excellent condition.

HISTORY

Current Use Office and farm supply store Historic Use Railroad depot
c.
Construction Date 1912 Architect/Builder _____ Date of Alterations _____

Historical Narrative: The original railroad line was constructed in Marshallville in 1851 by the Southwestern Railroad Company. A wooden building was used as the depot. In 1870, the Central of Georgia Company took over the Southwestern line. This present building was built around 1912 when the wooden structure burned.

SIGNIFICANCE

Architecture;

Areas of Significance Transportation Statement of Significance: The railroad has played a very important role in the development of Marshallville, as the town sprang up around the tracks. From this depot, fruit was shipped North from Marshallville's fruit industry. The depot is also a good example of a fairly typical style of depot architecture in Georgia. Details like the bay and brackets seem to be holdovers from the earlier Victorian period.

SOURCES

Prepared by Mrs. Jane Bickley Street Address West Main Street
City Marshallville State Georgia Date 11/21/79
Representation in Other Surveys None

Sources of Information:

Hays, Louise Frederick. History of Macon County, Georgia. Originally published 1933. Reprinted 1979. Spartanburg, SC: The Reprint Company.
Lee, Henry. Marshallville, Georgia. Interview. 16 November 1979.

SEP 26 1980

NOV 25 1980



Photographer James R. Lockhart Direction Photographer Facing Northeast

Date March 1980 Negatives on File Georgia Dept. of Natural Resources

Photograph Number 1 of 41.

SITE PLAN--INCLUDE NORTH ARROW

CONTINUATION

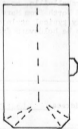

MAIN STREET

MARSHALLVILLE AND MACON COUNTY MULTIPLE RESOURCE NOMINATION
ARCHITECTURAL AND HISTORIC PROPERTIES INVENTORY FORM

No. 23
(Comm. Dist.,
p. 5)

IDENTIFICATION

Property Name Garrett's Pharmacy Historic Name Citizen's Bank
Street Address East Main Street City Marshallville County Macon
Present Owner Mr. Larry E. Garrett Street Address Box 348
City Marshallville State Georgia ZIP Code 31057
Original Owner Citizens Bank of Marshallville Acreage Less than one
U.S.G.S. Quadrant _____ U.T.M. Reference _____
Tax Map Reference _____

Architectural Description and Present Condition: The Citizens Bank Building is a one-story brick structure on the eastern edge of the CBD. Stone pilasters and recessed entranceway are used on the facade, while stone quoins were placed at the corners. A stone balustrade tops the facade. The height of the roof decreases toward the rear of the building. Fair condition.

HISTORY

Current Use Pharmacy Historic Use Bank
Construction Date 1906 Architect/Builder _____ Date of Alterations _____

Historical Narrative: Mims S. Ware opened the first bank in Marshallville in the 1880's. As the peach boom was in full swing, the Citizen's Bank was organized in 1906. Jacob Walter Frederick (Frederick House) was the president and I.F. Murph (Wilkes Knob Plantation) was the vice-president. The bank prospered for several years, but eventually closed in the mid-century.

SIGNIFICANCE

Areas of Significance Commerce, Architecture **Statement of Significance:** Although it utilizes details from the Neo-classical period, the Citizen's Bank Building relates in size, scale, and materials to the late Victorian commercial district and is an integral part of that district. Its facade radiates that impregnable air that was, and often still is, an important ingredient of bank architecture. The bank's founding is yet another manifestation of the economic well-being brought about by the commercial fruit industry.

SOURCES

Prepared by Ruth Grice Street Address Route 1
City Marshallville State Georgia Date 9/19/79
Representation in Other Surveys None

Sources of Information:

Hayes, Louise Frederick. History of Macon County, Georgia. Orig. pub. 1933. Rpt. 1979.
Spartanburg, SC: The Reprint Company.
Elberta City Reporter, 25 October 1915.

SEP 16 1980
NOV 25 1980



Photographer James R. Lockhart Direction Photographer Facing Southwest

Date March 1980 Negatives on File Georgia Dept. of Natural Resources

Photograph Number 4 of 41.

SITE PLAN--INCLUDE NORTH ARROW

CONTINUATION

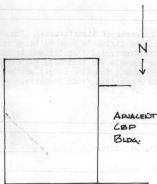

41

E. MAIN STREET

MARSHALLVILLE AND MACON COUNTY MULTIPLE RESOURCE NOMINATION
ARCHITECTURAL AND HISTORIC PROPERTIES INVENTORY FORM

No. 24
(Comm. Dist.,
p. 6)

IDENTIFICATION

Property Name Elberta Hotel Historic Name Elberta Hotel
Street Address East Main Street City Marshallville County Macon
Present Owner I.F. Murph Street Address _____
City Marshallville State Georgia ZIP Code 31057
Original Owner J.A. Coffee Acreage Less than 1
U.S.G.S. Quadrant _____ U.T.M. Reference _____
Tax Map Reference _____

Architectural Description and Present Condition: The Elberta Hotel is a two-story brick structure partially encircled by a one-story porch. It is rather plain in design. The interior chimneys are also brick. Poor condition.

HISTORY

Current Use Residence Historic Use Hotel
Construction Date 1912 Architect/Builder _____ Date of Alterations _____

Historical Narrative: The original Elberta Hotel burned in 1912 and Mr. and Mrs. J.A. Coffee purchased the hotel stock. They built the present building which, like its predecessor, was to serve peach buyers from the North. After the fall of the fruit industry, the building became a private residence.

SIGNIFICANCE

Areas of Significance Commerce; Agriculture Statement of Significance: The Elberta Hotel was built for a single purpose: to house fruit buyers from the North. This was a result of Marshallville's agricultural successes and the subsequent increase in commercial activity.

SOURCES

Prepared by Mrs. Jane Bickley Street Address West Main Street
City Marshallville State Georgia Date 11/21/79
Representation in Other Surveys None

Sources of Information:

Hays, Louise Frederick. History of Macon County, Georgia. Originally published 1933. Reprinted 1979. Spartanburg, SC: The Reprint Company.
Lee, Henry. Marshallville, Georgia. Interview. 16 November 1979.

NOV 25 1980



Photographer James R. Lockhart Direction Photographer Facing Southwest

Date March 1980 Negatives on File Georgia Dept. of Natural Resources

Photograph Number 5 of 41.

SITE PLAN--INCLUDE NORTH ARROW

CONTINUATION

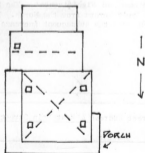

E. MAID STREET