

PH 36156 X

DATA SHEET

UNITED STATES DEPARTMENT OF THE INTERIOR  
NATIONAL PARK SERVICE

FOR NPS USE ONLY	
RECEIVED	FEB 20 1976
DATE ENTERED	JUN 3 1976

**NATIONAL REGISTER OF HISTORIC PLACES  
INVENTORY -- NOMINATION FORM**

SEE INSTRUCTIONS IN HOW TO COMPLETE NATIONAL REGISTER FORMS  
TYPE ALL ENTRIES -- COMPLETE APPLICABLE SECTIONS

**1 NAME**

HISTORIC *W*  
**\*\*** Montrose Historic District  
 AND/OR COMMON  
 Montrose

**LOCATION**

STREET & NUMBER  
 Main & Second Streets ( )  
 CITY, TOWN  
 Montrose  
 STATE Alabama CODE 01 COUNTY Baldwin CODE 003  
 VICINITY OF 001  
 NOT FOR PUBLICATION  
 CONGRESSIONAL DISTRICT

**CLASSIFICATION**

CATEGORY	OWNERSHIP	STATUS	PRESENT USE
<input checked="" type="checkbox"/> DISTRICT	<input checked="" type="checkbox"/> PUBLIC	<input checked="" type="checkbox"/> OCCUPIED	<input type="checkbox"/> AGRICULTURE <input type="checkbox"/> MUSEUM
<input type="checkbox"/> BUILDING(S)	<input type="checkbox"/> PRIVATE	<input type="checkbox"/> UNOCCUPIED	<input type="checkbox"/> COMMERCIAL <input type="checkbox"/> PARK
<input type="checkbox"/> STRUCTURE	<input type="checkbox"/> BOTH	<input type="checkbox"/> WORK IN PROGRESS	<input type="checkbox"/> EDUCATIONAL <input checked="" type="checkbox"/> PRIVATE RESIDENCE
<input type="checkbox"/> SITE	<b>PUBLIC ACQUISITION</b>	<b>ACCESSIBLE</b>	<input type="checkbox"/> ENTERTAINMENT <input type="checkbox"/> RELIGIOUS
<input type="checkbox"/> OBJECT	<input type="checkbox"/> IN PROCESS	<input checked="" type="checkbox"/> YES: RESTRICTED	<input type="checkbox"/> GOVERNMENT <input type="checkbox"/> SCIENTIFIC
	<input type="checkbox"/> BEING CONSIDERED	<input type="checkbox"/> YES: UNRESTRICTED	<input type="checkbox"/> INDUSTRIAL <input type="checkbox"/> TRANSPORTATION
		<input type="checkbox"/> NO	<input type="checkbox"/> MILITARY <input type="checkbox"/> OTHER:

**OWNER OF PROPERTY**

NAME  
 Multiple Ownership  
 STREET & NUMBER  
 CITY, TOWN VICINITY OF STATE

**LOCATION OF LEGAL DESCRIPTION**

COURTHOUSE, REGISTRY OF DEEDS, ETC.  
 Probate Court, Baldwin County Court House  
 STREET & NUMBER  
 CITY, TOWN STATE  
 Bay Minette Alabama

**6 REPRESENTATION IN EXISTING SURVEYS**

TITLE  
 DATE  
 DEPOSITORY FOR SURVEY RECORDS  
 CITY, TOWN STATE  
 FEDERAL STATE COUNTY LOCAL

# 7 DESCRIPTION

CONDITION		CHECK ONE	CHECK ONE
<input checked="" type="checkbox"/> EXCELLENT	<input type="checkbox"/> DETERIORATED	<input checked="" type="checkbox"/> UNALTERED	<input checked="" type="checkbox"/> ORIGINAL SITE
<input type="checkbox"/> GOOD	<input type="checkbox"/> RUINS	<input type="checkbox"/> ALTERED	<input type="checkbox"/> MOVED      DATE _____
<input type="checkbox"/> FAIR	<input type="checkbox"/> UNEXPOSED		

---

DESCRIBE THE PRESENT AND ORIGINAL (IF KNOWN) PHYSICAL APPEARANCE

The Montrose Historic District contains some 15 architecturally or historically significant buildings of which 9 are examples of a Gulf Coast vernacular style commonly called Creole Cottage. The unincorporated Village of Montrose is entirely residential and although modern construction has taken place in recent years, the entire town is given specific unity by the numerous live oaks, pines, spacious lots and occasional vistas of the bay. The town is laid out in a grid pattern containing 27 blocks of nine acres each and 26 bay front lots of 4.5 acres each. The historic district is located in the central section of the town and includes 4½ blocks and 5½ bay front lots.

The bay front lots contain five 19th century Creole Cottage style houses, one later home (c. 1930), and one recently relocated mid-19th century Mobile house which is most strongly influenced by the Greek Revival style. The Lewis-Thomasson House (1858), the McCullough-Garnett House (1850), the Brainard-Brekenridge House (c. 1850) and the Anderson-Phillips House (c. 1870) are all 1½ story clapboarded structures with gabled roofs and full-width, recessed porches. All are five bays wide with either chamfered posts or square columns and all have central doors with transoms. The Brainard-Brekenridge House has a shiplapped facade, pedimented architrave trim around the door and a large shed dormer which was added in the early 1900's. Sharing the same lot, but located to the north-west of the Brainard-Brekenridge House, is the Stanford House, a one-story stone structure which was originally a garage and workshop but which was converted into a dwelling in 1929. The Ledyard-Anderson-Moses House (1853) is a two-story clapboarded structure with a recessed full-width two-story porch. The second floor of the porch was enclosed in the 1930's. The Kearly House is a mid-19th century, one-story clapboarded structure with a hipped roof, bracketed cornices and pedimented portico. Facing Main Street from the bay front lots are two houses of more recent construction; the Thomas Bullock House (1940), a small clapboarded cottage with a gabled roof, and the Humphries House (1930), a one-and-a-half story clapboarded and stuccoed structure with two gabled dormer windows and a central chimney.

Beginning at Block 6 on the east side of Main Street and continuing south to the third lot of Block 4 are four Creole Cottages, a 1910 home with elaborate interior features, the old post office, and three other homes of more recent construction. The McIntyre-Kennedy House (1855), the Loftus-Thimbes House (1898), the Chapman-Scott House (1855) and the Fell-Hollinger-Bullock House (1855) are all 1½ story, 5 bay facade, gabled roof, clapboarded structures with full-width recessed porches, dormers, and central doorways. The McIntyre-Kennedy House has pilasters and a pedimented architrave surrounding the entrance door. Matching pilasters frame the gabled dormers. The Chapman-Scott property was enlarged in 1883 to include two additional rear rooms and at the same time dormers were added to the front. Also located on the Chapman-Scott property is the old post office (1890), a single pen board and batten structure which replaced an earlier store and post office located on the same site.

North of the Chapman-Scott House are located two houses which face onto Main Street; the J. V. Cummings House (1940), a one-story brick structure with a gabled roof, and the E. W. Winslow House (1935) at Main and Adams, a one-story board and batten structure with a gabled roof. West of the Winslow House and facing out onto Adams Street is the James Miller House (1950), a one-story structure with a gabled roof and beveled wooden siding painted deep blue.

UNITED STATES DEPARTMENT OF THE INTERIOR  
NATIONAL PARK SERVICE

**NATIONAL REGISTER OF HISTORIC PLACES  
INVENTORY -- NOMINATION FORM**

FOR NPS USE ONLY
RECEIVED FEB 20 1976
DATE ENTERED JUN 3 1976

CONTINUATION SHEET

ITEM NUMBER 7 PAGE 1

Directly south of the Chapman-Scott House is the Randall-Wachter House which was constructed in 1910. The 1½ story frame structure features stamped tin interior walls and ceilings and fine ornamental lattice work throughout the interior. Adjacent to the Randall-Wachter House is the Jacobs House, a one-story brick structure with a small cast iron portico. West of the Jacobs House is the recently completed Davis House, a board and batten structure with a high pitched gabled roof.

On the east side of Second Street in Block 14 are three houses of historic interest and two recently constructed homes. The Danzler and Jay houses, which occupy the 3rd lot of Block 14 are of modern construction. The Thomas-Malone House (1904) occupies the second lot and is a one-story board and batten structure with a hipped roof. The Grey Cottage, which was constructed in the 1860's, is a one-story clapboarded structure with a central door framed by sidelights and a transom; it shares the same lot as the Brewer-Allen Boarding House. The latter is a two-story clapboarded gable end structure.

On the west side of Second Street are two houses; the Ed Leak House (1955), a one-story hipped roof building with beveled siding, and the McFall House (1930), a one-story, gable end structure with green asbestoes siding and a shed roof porch.

The most notable groupings of live oak trees within the district are located along Adams Street between Main and Second and at the intersection of Second and Sibley. The Montrose Cemetery which occupies the entire 9 acres of Block 23 contains numerous pines and a monument to Cyrus Sibley.

UNITED STATES DEPARTMENT OF THE INTERIOR  
NATIONAL PARK SERVICE

FOR NPS USE ONLY	
RECEIVED	FEB 20 1976
DATE ENTERED	JUN 3 1976

**NATIONAL REGISTER OF HISTORIC PLACES  
INVENTORY -- NOMINATION FORM**

CONTINUATION SHEET

ITEM NUMBER 7 PAGE 2

1. Lewis-Thomasson House (Bay Lot 16): c. 1856, "Creole Cottage", 1 ½ story, clapboarded, gabled roof, full-width recessed porch, 6 square columns, 5 bay facade, double door entrance, transom, sidelights, T-shaped plan, side kitchen, 2 end-interior chimneys.
2. Thomas Bullock House (Bay Lot 15, east half): c. 1940, 1 story, frame gabled roof, screened porch.
3. McCullough-Garnett House (Bay Lot 15, west half): c. 1850, "Creole Cottage", 1½ story, clapboarded, gabled roof, full-width recessed porch, chamfered posts, 5 bay facade, double door is topped with transom, flanking single doors and windows have shutters.
4. Stanford House (Bay Lot 14, northeast): late 1920's, 1 story, stone, gabled roof.
5. Brainard-Breckenridge House (Bay Lot 14, southwest): c. 1855, "Creole Cottage", 1½ story, clapboarded, shiplapped facade, gabled roof, full-width recessed porch, 6 square columns, 5 bay facade, central single door, transom and sidelights, pedimented architrave trim, large shed dormer on facade, 2 gabled dormers on rear, kitchen wing.
6. Ledyard-Anderson-Moses House (Bay Lot 13): 1853, 2 story, clapboarded, gabled roof, 2 story recessed porch, 6 columns, 5 bay facade, 2nd story of porch was enclosed with clapboard and slender pilasters in 1936.
7. Anderson-Phillips House (Bay Lot 12): c. 1870, "Creole Cottage", 1½ story, clapboarded, gabled roof, full-width recessed porch, 6 square columns, double central door with transom and sidelights, floor-length facade windows.
8. Kearly House (Bay Lot 11, northwest): mid-19th century, 1 story, clapboarded, hipped roof, bracketed cornice, pedimented portico, single entrance door with cornice and pilasters, moved from Mobile in 1950.
9. Humphries House (Bay Lot 11, northeast): 1930, 1½ story, frame, gabled roof, dormers, central chimney.
10. Fell-Hollinger-Bullock House (southeast corner Main at Chapman): mid-1850's, "Creole Cottage", 1½ story, clapboarded, gabled roof, full-width recessed porch, 6 square columns, central door with sidelights and transom, central gabled dormer, 1970's additions to the rear.
11. Jacobs House (Main Street, Block 4, Lot 1, east side): 1950, 1 story, brick, gabled roof, small cast-iron portico.

UNITED STATES DEPARTMENT OF THE INTERIOR  
NATIONAL PARK SERVICE

FOR NPS USE ONLY
FEB 20 1976
RECEIVED
DATE ENTERED JUN 5 1976

**NATIONAL REGISTER OF HISTORIC PLACES  
INVENTORY -- NOMINATION FORM**

CONTINUATION SHEET

ITEM NUMBER 7 PAGE 3

12. Davis House (Chapman Street, Block 4, Lot 1, west side): 1975, 1½ story, board and batten, high-pitched gabled roof.
13. Randal-Wachter House (Main Street, Block 4, Lot 2): 1910, 1½ story, clapboarded, gable end entrance and shed portico, Corinthian columns on pedestals, all interior walls and ceilings are covered with stamped tin, fine interior fretwork.
14. Chapman-Scott House (Main Street, Block 4, Lot 1): 1855, "Creole Cottage", 1½ story, clapboarded, gabled roof, full-width recessed porch, 6 box columns, 5 bay facade, central door with transoms and sidelights, rear additions and gabled dormers added in 1883.
15. Montrose Post Office (Main Street, Block 4, Lot 1): 1890, 1 story, board and batten, single pen structure, gabled roof, shed roof porch.
16. Danzler House (Second Street, Block 14, Lot 3, south side): 1960, 1 story, brick, contemporary.
17. Jay House (Second Street, Block 14, Lot 3, northside): 1967, 1 story, brick, L-shaped, front gable.
18. Thomson-Malone House (Second Street, Block 14, Lot 2): 1904, 1 story, board and batten, high hipped roof with side overhangs, half-hipped roof portico, square posts, central double door, sidelights, transom.
19. Gray Cottage (Second Street, Block 14, Lot 1, south side): 1860's, 1 story, clapboarded, gabled roof, porch enclosed with screens, central door, sidelights, transom.
20. Brewer-Allen Boarding House (Second Street, Block 14, Lot 1, north side): 1855, 1½ story, clapboarded, gable end facade, shed roof portico, tapered columns, windows and door have simple architrave molding. (Now the Rudt House)
21. McIntyre-Kennedy House (Main Street, Block 6, Lot 2): 1855, "Creole Cottage", clapboarded, gabled roof, full-width recessed porch, 6 chamfered posts on piers, central door, pilasters, pedimented architrave, sidelights, transom, 3 gabled dormers with pilasters.
22. Loftus-Thimbes House (Main Street, Block 6, Lot 1): 1898, "Creole Cottage", clapboarded, gabled roof, full width recessed porch, 6 square columns, 5 bay facade, floor length facade windows, gabled dormers, central door with sidelights and transom, board and batten rear additions.
23. J. V. Cummings House (Main Street, Block 5, Lot 2): c. 1940, 1 story, brick gabled roof.

UNITED STATES DEPARTMENT OF THE INTERIOR  
NATIONAL PARK SERVICE

**NATIONAL REGISTER OF HISTORIC PLACES  
INVENTORY -- NOMINATION FORM**

FOR NPS USE ONLY
FEB 20 1976
RECEIVED
DATE ENTERED JUN 3 1976

CONTINUATION SHEET

ITEM NUMBER 7 PAGE 4

24. E. W. Winslow (Main and Adams, Block 5, Lot 1): c. 1935, 1 story, board and batten, gabled roof, end-interior chimney.
25. James Miller House (Adams Street, Block 5, Lot 1, center): c. 1950, 1 story, beveled siding, gabled roof, painted blue with white trim.
26. Ed Leak House (Northeast corner Adams and Second): 1955, 1 story, beveled siding, hipped roof.
27. McFall House (Second Street, Block 5, Lot 2): 1930, 1 story gable end structure, green asbestos siding.

# 8 SIGNIFICANCE

PERIOD	AREAS OF SIGNIFICANCE -- CHECK AND JUSTIFY BELOW			
<input type="checkbox"/> PREHISTORIC	<input type="checkbox"/> ARCHEOLOGY-PREHISTORIC	<input type="checkbox"/> COMMUNITY PLANNING	<input type="checkbox"/> LANDSCAPE ARCHITECTURE	<input type="checkbox"/> RELIGION
<input type="checkbox"/> 1400-1499	<input type="checkbox"/> ARCHEOLOGY-HISTORIC	<input type="checkbox"/> CONSERVATION	<input type="checkbox"/> LAW	<input type="checkbox"/> SCIENCE
<input type="checkbox"/> 1500-1599	<input type="checkbox"/> AGRICULTURE	<input type="checkbox"/> ECONOMICS	<input type="checkbox"/> LITERATURE	<input type="checkbox"/> SCULPTURE
<input type="checkbox"/> 1600-1699	<input checked="" type="checkbox"/> ARCHITECTURE	<input type="checkbox"/> EDUCATION	<input type="checkbox"/> MILITARY	<input type="checkbox"/> SOCIAL/HUMANITARIAN
<input type="checkbox"/> 1700-1799	<input type="checkbox"/> ART	<input type="checkbox"/> ENGINEERING	<input type="checkbox"/> MUSIC	<input type="checkbox"/> THEATER
<input checked="" type="checkbox"/> 1800-1899 <i>SRP</i>	<input type="checkbox"/> COMMERCE	<input type="checkbox"/> EXPLORATION/SETTLEMENT	<input type="checkbox"/> PHILOSOPHY	<input type="checkbox"/> TRANSPORTATION
<input checked="" type="checkbox"/> 900-	<input type="checkbox"/> COMMUNICATIONS	<input type="checkbox"/> INDUSTRY	<input type="checkbox"/> POLITICS/GOVERNMENT	<input type="checkbox"/> OTHER (SPECIFY)
		<input type="checkbox"/> INVENTION		

SPECIFIC DATES

BUILDER/ARCHITECT

## STATEMENT OF SIGNIFICANCE

The Montrose Historic District contains several examples of a vernacular style commonly called Creole Cottage. While well preserved examples of this style are found along the eastern shore of Mobile Bay and within the city of Mobile, only Montrose has retained a concentrated collection of these structures along with a large degree of its 19th century ambience. The nine examples which span a period of 50 years in their construction, share the full-width recessed porches, the five bay facades and gabled roofs which are the distinguishing marks of this Gulf Coast style. Since its earliest days Montrose has been a popular site for the location of summer homes by citizens of the city of Mobile and several of the existing homes were originally constructed for summer use. While the town was never one of the state's major resorts, it at one time boasted of a large two story hotel and continues to attract a steady number of summer visitors who own homes in and around the village.

Occupying one of the highest spots along the Gulf Coast, the site of the town has long been noted for its healthy location and the presence of fine clay for brick and pottery making. During the period of British occupation (1763-1783) the site was selected as a rest station for British soldiers stationed at Mobile and was known as Croftown. In 1839 Cyrus Sibley secured title to the property granted to Isabelle Campbell who had made brick and tile on the site. Sibley, a native of Massachusetts, was an early settler in Baldwin County and had been involved in the Kemper Rebellion. Along with his brother he owned vast acres of timberland and operated sawmills and plantations. By 1847 the town had been surveyed and platted as Sibley City, and its founder had opened a sawmill near the eastern terminus of Sibley Street. At the bay end of the same street, one of the earliest residents, William Steedman, had constructed a wharf and until 1852 when the town was renamed Montrose, it was known as Steedman's Landing. Much of the land within the village was originally distributed among Sibley's children and other relatives, but only one relative, Mary Elizabeth McCollough, actually built there. Sibley himself never resided in the town.

By 1859 Montrose had a sufficient number of year round inhabitants to merit the construction of a small school, and in that year Cyrus Sibley donated Block 12 to the trustees of the Montrose Academy for Male and Female Students. The town was increasingly popular as a location for the summer homes of Mobile families and several of the inhabitants made room for summer boarders in their private homes. In 1855, two sisters from Massachusetts, Julia Brewer and Mariah E. Allen, acquired a lot and constructed a large two-story structure which they operated as a boarding home. The Hutchinson Hotel, constructed in 1866, did much to further the reputation of Montrose as a summer resort and until its destruction in 1898 attracted a large clientele. Despite the loss of the hotel, the town

# 9 MAJOR BIBLIOGRAPHICAL REFERENCES

Hamilton, Peter J. Colonial Mobile, Rev. ed. Mobile: First National Bank, 1952.  
 Scott, Florence D. Montrose, privately printed, 1959.

# 10 GEOGRAPHICAL DATA

ACREAGE OF NOMINATED PROPERTY 79

UTM REFERENCES

SW	A	1,6	41,32,8,0	3,38,15,4,0	B	1,6	41,31,0,0	3,38,21,2,0
		ZONE	EASTING	NORTHING		ZONE	EASTING	NORTHING
	C	1,6	41,40,4,0	3,38,23,6,0	D	1,6	41,41,8,0	3,38,17,8,0

VERBAL BOUNDARY DESCRIPTION

Beginning at a point at the intersection of Sibley Street and Mobile Bay; then easterly approximately 1080 feet to the intersection of Main and Sibley Streets; then northerly approximately 420 feet along Main Street to the northern edge of Lot 2, Block 6; then easterly along said lot line for 420 feet; then south 200 feet to the northern edge of Lot 1 Block 6; then easterly 230 feet along the lot line to its intersection with Second Street; then southerly 220 feet to the intersection of Sibley and Second; then easterly 1380 feet to the eastern edge of the Montrose Cemetery (Block 23); then southerly

LIST ALL STATES AND COUNTIES FOR PROPERTIES OVERLAPPING STATE OR COUNTY BOUNDARIES

STATE	CODE	COUNTY	CODE

# 11 FORM PREPARED BY

NAME / TITLE

W. Warner Floyd, Executive Director & Ellen Mertins

ORGANIZATION

Alabama Historical Commission

DATE

2-6-76

STREET & NUMBER

725 Monroe Street

TELEPHONE

832-6621

CITY OR TOWN

Montgomery

STATE

Alabama 36130

# 12 STATE HISTORIC PRESERVATION OFFICER CERTIFICATION

THE EVALUATED SIGNIFICANCE OF THIS PROPERTY WITHIN THE STATE IS:

NATIONAL

STATE

LOCAL

As the designated State Historic Preservation Officer for the National Historic Preservation Act of 1966 (Public Law 89-665), I hereby nominate this property for inclusion in the National Register and certify that it has been evaluated according to the criteria and procedures set forth by the National Park Service.

FEDERAL REPRESENTATIVE SIGNATURE

*Miss B. Howard*

TITLE

34 PO Ala

DATE

Feb. 1976

FOR NPS USE ONLY

I HEREBY CERTIFY THAT THIS PROPERTY IS INCLUDED IN THE NATIONAL REGISTER

Acting

*Jerry L. ...*

DATE

6/9/76

DIRECTOR, OFFICE OF ARCHEOLOGY AND HISTORIC PRESERVATION

ATTEST

*Charles ...*

DATE

6.2.76

KEEPER OF THE NATIONAL REGISTER

RBR for WJM 6-2-76



UNITED STATES DEPARTMENT OF THE INTERIOR  
NATIONAL PARK SERVICE

**NATIONAL REGISTER OF HISTORIC PLACES  
INVENTORY -- NOMINATION FORM**

FOR NPS USE ONLY	
RECEIVED	FEB 20 1976
DATE ENTERED	JUN 3 1976

CONTINUATION SHEET

ITEM NUMBER 8 PAGE 5

retained its popularity with summer visitors and shortly after World War I, this continued popularity led to a number of retired northerners making their homes in the area.

The location of fine clay deposits in the area gave rise to a number of small pottery works during the 19th century, the most notable of which was the company of Gable and Dede which made crocks, churns, and flower pots which were shipped to Mobile and New Orleans prior to the Civil War. The McAdams Pottery, which was established in the late 1870's by a Scottish immigrant, operated until the end of 1800's when the firm moved its location to Montgomery. The last commercial pottery in the town, The Montrose Pottery, was established by Ashleigh Moses in 1903 and did a substantial trade in jugs and other wares until the prohibition movement in the state greatly decreased the demand for jugs.

Since the 1920's new construction has continued in the village, some of it replacing older homes, and subdivisions consisting of both summer and permanent homes have grown up around the outskirts.

UNITED STATES DEPARTMENT OF THE INTERIOR  
NATIONAL PARK SERVICE

**NATIONAL REGISTER OF HISTORIC PLACES  
INVENTORY -- NOMINATION FORM**

FOR NPS USE ONLY	
RECEIVED	FEB 20 1976
DATE ENTERED	JUN 3 1976

CONTINUATION SHEET

ITEM NUMBER 10 PAGE 6

for 700 feet to the southern boundary of the cemetery; then westerly along Adams for approximately 1380 feet to the intersection of Adams and Second; then southerly along Second 620 feet to its intersection with Chapman; then westerly along Chapman for 580 feet; then south for 200 feet to the southern edge of Lot 3, Block 3; then westerly 200 feet to Main Street; then northerly along Main for 360 feet; then westerly 980 feet to Mobile Bay; then northerly 1220 feet along the Bay front to the point of origin.

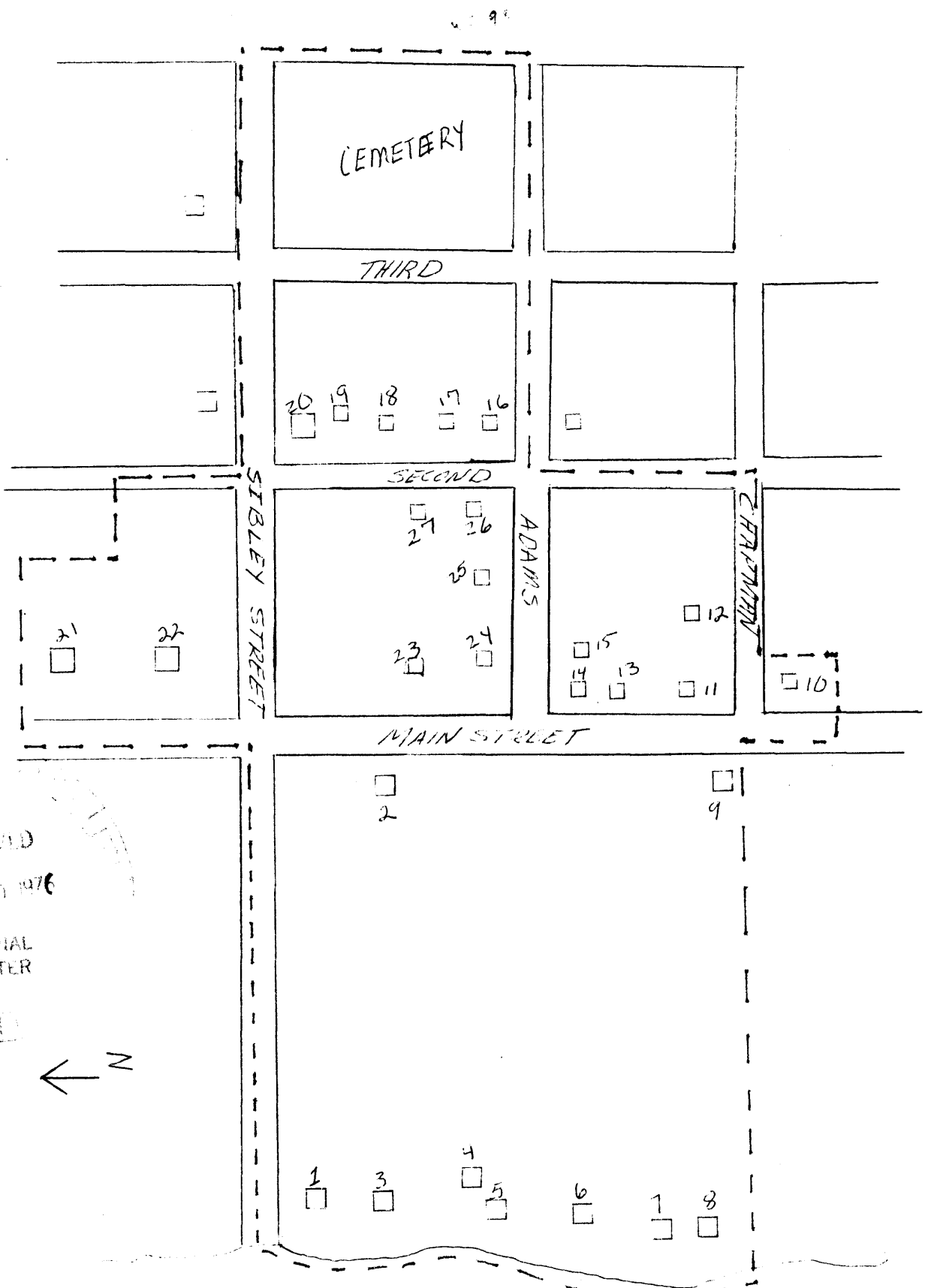

RECEIVED  
 FEB 20 1976  
 NATIONAL  
 REGISTER

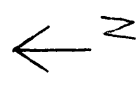

NO SCALE

MOBILE BAY

(Rev. 10-74)

UNITED STATES DEPARTMENT OF THE INTERIOR  
NATIONAL PARK SERVICE

**NATIONAL REGISTER OF HISTORIC PLACES  
PROPERTY MAP FORM**

FOR NPS USE ONLY	
RECEIVED	FEB 20 1976
DATE ENTERED	JUN 3 1976

SEE INSTRUCTIONS IN *HOW TO COMPLETE NATIONAL REGISTER FORMS*  
TYPE ALL ENTRIES -- ENCLOSE WITH MAP

**NAME**

HISTORIC  
Montrose Historic District

AND/OR COMMON  
Montrose

**2 LOCATION**

CITY, TOWN	___ VICINITY OF	COUNTY	STATE
Montrose		Baldwin	Alabama

**3 MAP REFERENCE**

SOURCE Ellen Mertins

SCALE None DATE 1975

**REQUIREMENTS**

TO BE INCLUDED ON ALL MAPS

1. PROPERTY BOUNDARIES
2. NORTH ARROW
3. UTM REFERENCES

INT: 2986-75