

**NATIONAL REGISTER OF HISTORIC PLACES
INVENTORY - NOMINATION FORM**

(Type all entries - complete applicable sections)

STATE: Nebraska	
COUNTY: Keith	
FOR NPS USE ONLY	
ENTRY NUMBER 70.10.31.0008	DATE 10/15/70

1. NAME	
COMMON:	Diamond Springs Stage Station (25KH6) ^{SITE}
AND/OR HISTORIC:	

2. LOCATION			
STREET AND NUMBER: One mile west of Brule exit along Interstate			
CITY OR TOWN: Brule vicinity			
STATE Nebraska	CODE 69127	COUNTY: Keith	CODE 101

3. CLASSIFICATION			
CATEGORY (Check One)	OWNERSHIP	STATUS	ACCESSIBLE TO THE PUBLIC
<input type="checkbox"/> District <input type="checkbox"/> Building <input checked="" type="checkbox"/> Site <input type="checkbox"/> Structure <input type="checkbox"/> Object	<input type="checkbox"/> Public <input checked="" type="checkbox"/> Private <input type="checkbox"/> Both	Public Acquisition: <input type="checkbox"/> In Process <input type="checkbox"/> Being Considered	<input type="checkbox"/> Occupied <input checked="" type="checkbox"/> Unoccupied <input type="checkbox"/> Preservation work in progress
PRESENT USE (Check One or More as Appropriate)			
<input checked="" type="checkbox"/> Agricultural <input type="checkbox"/> Commercial <input type="checkbox"/> Educational <input type="checkbox"/> Entertainment	<input type="checkbox"/> Government <input type="checkbox"/> Industrial <input type="checkbox"/> Military <input type="checkbox"/> Museum	<input type="checkbox"/> Park <input type="checkbox"/> Private Residence <input type="checkbox"/> Religious <input type="checkbox"/> Scientific	<input type="checkbox"/> Transportation <input type="checkbox"/> Other (Specify) _____ _____ _____

4. OWNER OF PROPERTY			
OWNER'S NAME: Hubert C. and Mabel R. Beal			
STREET AND NUMBER:			
CITY OR TOWN: Brule	STATE: Nebraska	CODE 26	

5. LOCATION OF LEGAL DESCRIPTION			
COURTHOUSE, REGISTRY OF DEEDS, ETC: County Clerk, Keith County Court House			
STREET AND NUMBER:			
CITY OR TOWN: Ogallala	STATE: Nebraska	CODE 26	

6. REPRESENTATION IN EXISTING SURVEYS			
TITLE OF SURVEY: Archeological Survey, Nebraska State Historical Society			
DATE OF SURVEY: 1938 to present	<input type="checkbox"/> Federal	<input checked="" type="checkbox"/> State	<input type="checkbox"/> County <input type="checkbox"/> Local
DEPOSITORY FOR SURVEY RECORDS: Nebraska State Historical Society			
STREET AND NUMBER: 1500 R Street			
CITY OR TOWN: Lincoln	STATE: Nebraska	CODE 26	

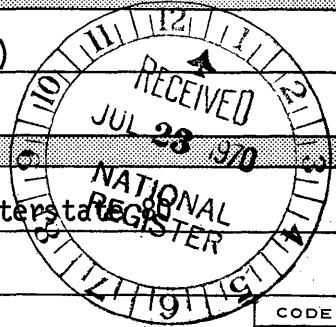

SEE INSTRUCTIONS

STATE: Nebraska
COUNTY: Keith
FOR NPS USE ONLY
ENTRY NUMBER: 70.10.31.0008
DATE: 10/15/70

7. DESCRIPTION

CONDITION

(Check One)

 Excellent Good Fair Deteriorated Ruins Unexposed

(Check One)

 Altered Unaltered

(Check One)

 Moved Original Site

DESCRIBE THE PRESENT AND ORIGINAL (if known) PHYSICAL APPEARANCE

The Diamond Springs Stage Station archeological site is located in a pasture approximately one mile southwest of Brule, Nebraska. It is situated near the edge of a low flat terrace of the South Platte River and is about five feet above the River level. The southern limits of the site lie 70-100 feet north of the right-of-way of Interstate 80, which passes in an east-west direction. The Brule interchange of I-80 is about one mile to the east. The South Platte River is a quarter of a mile north of the site. The occupation area of the site appears to cover about four acres and is located slightly southeast of the center of the southeast quarter of Section 21, Township 13 North, Range 40 West.

Although all above-ground building remains have disappeared during the ca. 100 years that the Station has been abandoned, an unusual amount of surface detail has survived, due to the fact that the land occupied by the site has never been plowed. Disturbed soil at one location, covering an area roughly 85 by 30 feet, appears to mark the site where a large building or corral once stood. About 60 feet west of that feature is a shallow rectangular trench which is clearly visible. It encloses an area about 90 feet long by 60 feet wide. This may be the remains of a corral or similar enclosure. Several shallow depressions ranging in size up to about 20 feet across offer further evidence of former occupancy. Surface artifactual material, such as fragments of rusted tin and iron, pieces of broken window and bottle glass, and other small articles, is scattered about.

No archeological excavations have as yet been conducted at the site. It was believed that the recent construction of Interstate 80 through Keith County would destroy part or all of the station remains, necessitating highway salvage excavations prior to highway construction. But the final location chosen for the Interstate missed the site by a narrow margin.

Plowing of the pasture or any type of grading or land leveling at some future time would damage the site considerably and should be avoided if at all possible.

SEE INSTRUCTIONS

SIGNIFICANCE

PERIOD (Check One or More as Appropriate)

- Pre-Columbian | 16th Century | 18th Century | 20th Century
 15th Century | 17th Century | 19th Century

SPECIFIC DATE(S) (If Applicable and Known) ca. 1859-1867

AREAS OF SIGNIFICANCE (Check One or More as Appropriate)

- | | | | |
|--|---|--|--|
| <input type="checkbox"/> Aboriginal | <input type="checkbox"/> Education | <input type="checkbox"/> Political | <input type="checkbox"/> Urban Planning |
| <input type="checkbox"/> Prehistoric | <input type="checkbox"/> Engineering | <input type="checkbox"/> Religion/Philosophy | <input type="checkbox"/> Other (Specify) |
| <input checked="" type="checkbox"/> Historic | <input type="checkbox"/> Industry | <input checked="" type="checkbox"/> Science | _____ |
| <input type="checkbox"/> Agriculture | <input type="checkbox"/> Invention | <input type="checkbox"/> Sculpture | _____ |
| <input type="checkbox"/> Architecture | <input type="checkbox"/> Landscape Architecture | <input type="checkbox"/> Social/Humanitarian | _____ |
| <input type="checkbox"/> Art | <input type="checkbox"/> Literature | <input type="checkbox"/> Theater | _____ |
| <input type="checkbox"/> Commerce | <input type="checkbox"/> Military | <input checked="" type="checkbox"/> Transportation | _____ |
| <input checked="" type="checkbox"/> Communications | <input type="checkbox"/> Music | | _____ |
| <input type="checkbox"/> Conservation | | | _____ |

STATEMENT OF SIGNIFICANCE

The Diamond Springs Stage Station site is of importance archeologically because of the relatively undisturbed remains present there of a station used by both the Pony Express and the Overland Stage during the mid 19th century.

This station was apparently built in 1859 by Russell, Majors and Waddell after that firm bought out Jones and Russell's Leavenworth and Pike's Peak Express Company. At that time, the Smoky Hill Route through Kansas was abandoned by the new owners in favor of the Central Route or Platte River trail, and 100 new stations were built. In 1860 the name of the company was changed to the Central Overland California and Pike's Peak Express, and the charter granted to it permitted the company to convey persons, mail, and property. A federal mail contract was not obtained at that time, however, because the government preferred the more southerly Butterfield route. The Pony Express, started by Russell, Majors and Waddell in 1860, did carry mail over the Central Route and, although its existence was short-lived because of the completion of the transcontinental telegraph line in 1861, it proved the worth of the Central Route to the government. Mail moved over the Central Route by stage beginning in 1861. The Diamond Springs Station appears on the official listing of stations used by the Pony Express during 1860-61. It apparently also served as a stage station both during the Pony Express period and for several years thereafter. After the demise of the Pony Express, the stage line operated by Russell, Majors and Waddell remained in business until March of 1862, when it was taken over by Ben Holladay in partial payment of loans made by him to Russell, Majors and Waddell.

In August of 1865, all stage stations between Julesburg and Cottonwood Springs were abandoned because of Indian depredations. Diamond Springs was among these stations. All property was left at the stations except livestock, which was hurriedly driven to either Julesburg or Cottonwood Springs. Losses sustained at Diamond Springs in feed alone were estimated at \$6,200. The stations were later remanned, but isolated minor incidents with the Indians still occurred. In August of 1866, a newspaper article reported that a number of Sioux called at Diamond Springs, a swing station of the Holladay overland route, "and levied some tax upon the keeper in the shape of pork, coffee and sugar and then departed in peace."

In the latter part of 1866, the Holladay Overland Mail and Express Company changed hands and became Wells, Fargo and Company. Stage travel along the

SEE INSTRUCTIONS

(CONTINUED)

9. MAJOR BIBLIOGRAPHICAL REFERENCES

Frederick, J.V., Ben Holladay: The Stagecoach King, Arthur H. Clark Co., Glendale, Calif., 1940.
 Mattes, Merrill and Paul Henderson, "The Pony Express: Across Nebraska From St. Joseph to Fort Laramie," Nebraska History, Vol. 41, No. 2, Lincoln, Nebr., 1960.
Omaha Republican (newspaper), August 17, 1866, p.2.
Senate Miscellaneous Documents, No. 19, 46th Congress, 2nd Session, "Testimony as to the Claim of Ben Holladay," Washington, 1879.

10. GEOGRAPHICAL DATA

LATITUDE AND LONGITUDE COORDINATES DEFINING A RECTANGLE LOCATING THE PROPERTY			OR	LATITUDE AND LONGITUDE COORDINATES DEFINING THE CENTER POINT OF A PROPERTY OF LESS THAN TEN ACRES		
CORNER:	LATITUDE	LONGITUDE		LATITUDE	LONGITUDE	
	Degrees Minutes Seconds	Degrees Minutes Seconds		Degrees Minutes Seconds	Degrees Minutes Seconds	
NW	0	0		41° 04' 47"	101° 54' 19"	
NE	0	0				
SE	0	0				
SW	0	0				

APPROXIMATE ACREAGE OF NOMINATED PROPERTY: **4 acres**

LIST ALL STATES AND COUNTIES FOR PROPERTIES OVERLAPPING STATE OR COUNTY BOUNDARIES

STATE:	CODE	COUNTY:	CODE

11. FORM PREPARED BY

NAME AND TITLE: **Gayle F. Carlson, Highway Salvage Archeologist**

ORGANIZATION: **Nebraska State Historical Society**

STREET AND NUMBER: **1500 R Street**

CITY OR TOWN: **Lincoln**

STATE: **Nebraska** CODE: **26**

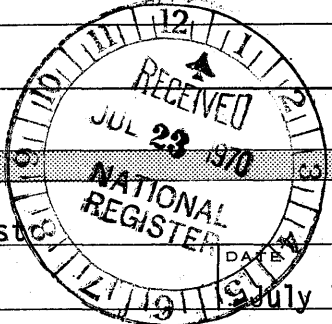

NO UTM CD

SEE INSTRUCTIONS

12. STATE LIAISON OFFICER CERTIFICATION NATIONAL REGISTER VERIFICATION

As the designated State Liaison Officer for the National Historic Preservation Act of 1966 (Public Law 89-665), I hereby nominate this property for inclusion in the National Register and certify that it has been evaluated according to the criteria and procedures set forth by the National Park Service. The recommended level of significance of this nomination is:

National State Local

Name: Morvin D. Kwett

Title: Director, Nebraska State Historical Society

Date: _____

I hereby certify that this property is included in the National Register.

Ernest Allen Connally
 Chief, Office of Archeology and Historic Preservation

OCT 15 1970

Date: _____

ATTEST: William J. Tuttle
 Keeper of The National Register

AUG 12 1970

Date: _____

**NATIONAL REGISTER OF HISTORIC PLACES
INVENTORY - NOMINATION FORM**

(Continuation Sheet)

STATE Nebraska	
COUNTY Keith	
FOR NPS USE ONLY	
ENTRY NUMBER 70,10,31,0008	DATE 10/15/70

(Number all entries)

DIAMOND SPRINGS STAGE STATION

8. ~~Platte valley diminished rapidly during the next two or three years because of the construction of the transcontinental railroad, which was extended to Nebraska's western border in 1867 and finally completed in 1869.~~

Because of the good preservation of the Diamond Springs Stage Station remains and their accessibility, the site is a good location to consider as a wayside stop for travelers on Interstate 80. With proper interpretation and possibly some restoration, it could become an attractive and meaningful spot to those interested in early western history.



BRULE QUADRANGLE
NEBRASKA
7.5 MINUTE SERIES (TOPOGRAPHIC)

OGALLALA 1:125 000

55'

4.5 MI TO U.S. 26

1 340 000 FEET

101°52'30"

41°07'30"



DIAMOND SPRINGS STAGE STATION
KEITH COUNTY, NEBRASKA

530 000
FEET

OGALLALA 8.4 MI.
NORTH PLATTE 60 MI.

SOUTH PLATTE RIVER

41°04'47"

101°54'19"

INTERSTATE 80

OREGON TRAIL

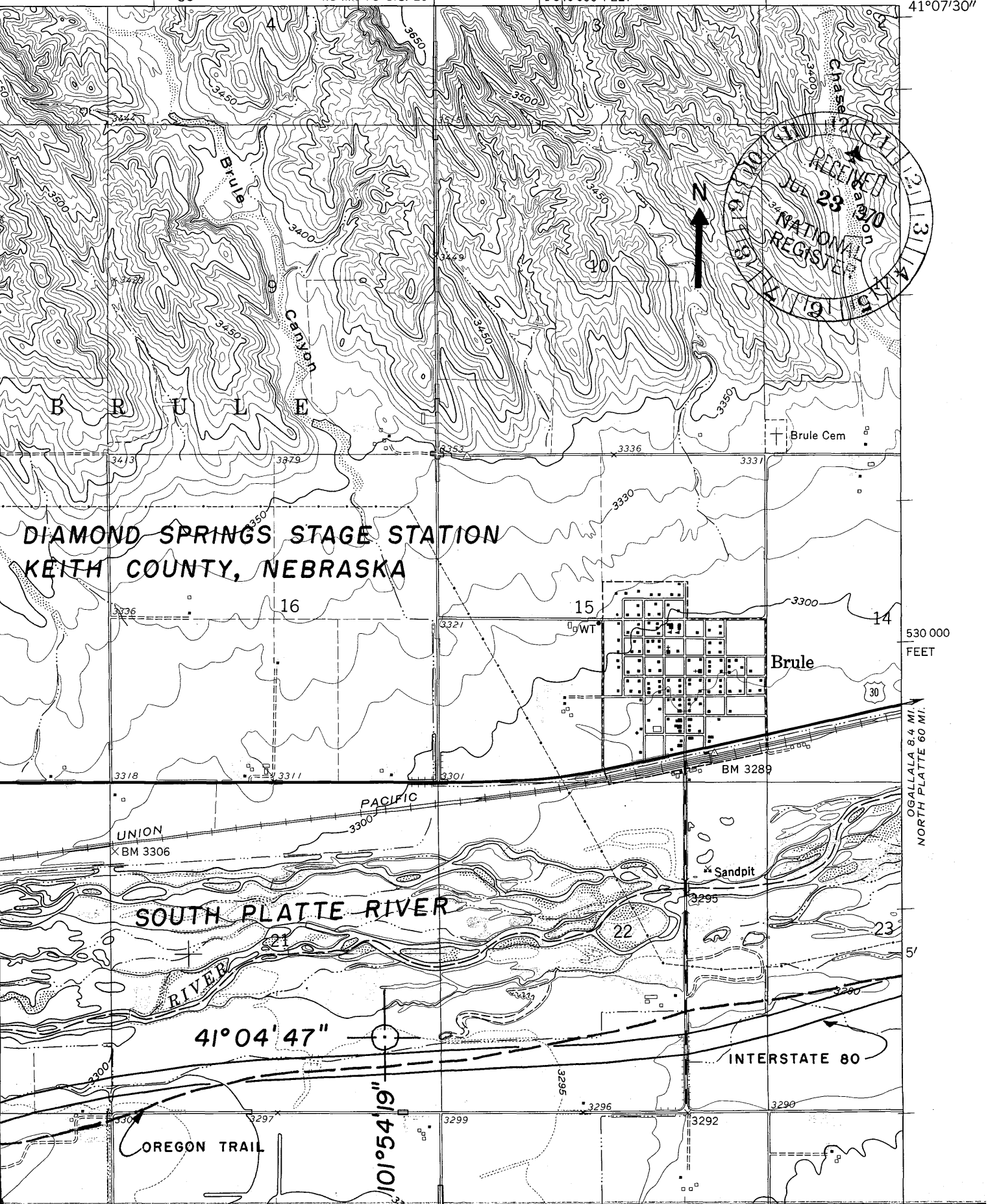

Form 10-301
(July 1969)

UNITED STATES DEPARTMENT OF THE INTERIOR
NATIONAL PARK SERVICE

**NATIONAL REGISTER OF HISTORIC PLACES
PROPERTY MAP FORM**

(Type all entries - attach to or enclose with map)

STATE	
Nebraska	
COUNTY	
Keith	
FOR NPS USE ONLY	
ENTRY NUMBER	DATE
70. 10.31.0008	10/15/70

SEE INSTRUCTIONS

1. NAME			
COMMON:		Diamond Springs Stage Station	
AND/OR HISTORIC:			
2. LOCATION			
STREET AND NUMBER:			
One mile west of Brule exit along Interstate 80			
CITY OR TOWN:			
Brule vicinity			
STATE:	CODE	COUNTY:	CODE
Nebraska	69127	Keith	101
3. MAP REFERENCE			
SOURCE:			
U.S.G.S. 7½', Quadrangle Brule			
SCALE:			
1: 24,000			
DATE:			
1961			
4. REQUIREMENTS			
TO BE INCLUDED ON ALL MAPS			
1. Property boundaries where required.			
2. North arrow.			
3. Latitude and longitude reference.			
Note: the map shows the Interstate 80 right-of-way and its proximity to the routing of the former Oregon Trail (or Central Route).			

