

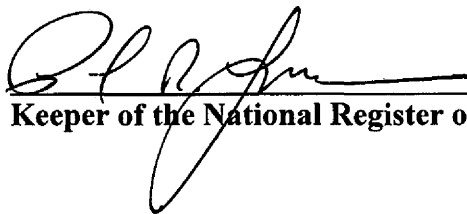

United States Department of the Interior

NATIONAL PARK SERVICE
1849 C Street, N.W.
Washington, D.C. 20240

The attached property, the Hitchcock-Schwarzmann Mill in Hartford County, Connecticut, reference number 77001409, was listed in the National Register of Historic Places by the Keeper of the National Register on 09/13/1977, as evidenced by the FEDERAL REGISTER/WEEKLY LIST notice of Tuesday, February 6, 1979, Part II, Vol. 44, No. 26, page 7440. The attached nomination form is a copy of the original documentation provided to the Keeper at the time of listing.

Keeper of the National Register of Historic Places

1/26/2009
Date

UNITED STATES DEPARTMENT OF THE INTERIOR
NATIONAL PARK SERVICE

FOR NPS USE ONLY
RECEIVED
DATE ENTERED

NATIONAL REGISTER OF HISTORIC PLACES
INVENTORY -- NOMINATION FORM

SEE INSTRUCTIONS IN HOW TO COMPLETE NATIONAL REGISTER FORMS
TYPE ALL ENTRIES -- COMPLETE APPLICABLE SECTIONS

1 NAME

HISTORIC
Hitchcock-Schwarzmann Mill
AND/OR COMMON
Hitchcock Mill, Foote Mill, Schwarzmann Mill

2 LOCATION

STREET & NUMBER
Foote Road (corner Vineyard Road) NOT FOR PUBLICATION
CITY, TOWN CONGRESSIONAL DISTRICT
Burlington VICINITY OF Sixth
STATE CODE COUNTY CODE
Connecticut 09 Hartford 003

3 CLASSIFICATION

CATEGORY	OWNERSHIP	STATUS	PRESENT USE
<input type="checkbox"/> DISTRICT	<input type="checkbox"/> PUBLIC	<input checked="" type="checkbox"/> OCCUPIED	<input type="checkbox"/> AGRICULTURE <input type="checkbox"/> MUSEUM
<input checked="" type="checkbox"/> BUILDING(S)	<input checked="" type="checkbox"/> PRIVATE	<input checked="" type="checkbox"/> UNOCCUPIED	<input type="checkbox"/> COMMERCIAL <input type="checkbox"/> PARK
<input type="checkbox"/> STRUCTURE	<input type="checkbox"/> BOTH	<input type="checkbox"/> WORK IN PROGRESS	<input type="checkbox"/> EDUCATIONAL <input checked="" type="checkbox"/> PRIVATE RESIDENCE
<input type="checkbox"/> SITE	PUBLIC ACQUISITION	ACCESSIBLE	<input type="checkbox"/> ENTERTAINMENT <input type="checkbox"/> RELIGIOUS
<input type="checkbox"/> OBJECT	<input checked="" type="checkbox"/> ON PROCESS	<input checked="" type="checkbox"/> YES: RESTRICTED	<input type="checkbox"/> GOVERNMENT <input type="checkbox"/> SCIENTIFIC
	<input type="checkbox"/> BEING CONSIDERED	<input type="checkbox"/> YES: UNRESTRICTED	<input type="checkbox"/> INDUSTRIAL <input type="checkbox"/> TRANSPORTATION
		<input type="checkbox"/> NO	<input type="checkbox"/> MILITARY <input checked="" type="checkbox"/> OTHER: vacant

4 OWNER OF PROPERTY

NAME
Town of Burlington
STREET & NUMBER
CITY, TOWN STATE
Burlington VICINITY OF Connecticut

5 LOCATION OF LEGAL DESCRIPTION

COURTHOUSE,
REGISTRY OF DEEDS, ETC.
Burlington Town Hall
STREET & NUMBER
CITY, TOWN STATE
Burlington Connecticut

6 REPRESENTATION IN EXISTING SURVEYS

TITLE
Connecticut Statewide Survey
DATE 1966 FEDERAL STATE COUNTY LOCAL
DEPOSITORY FOR SURVEY RECORDS
Connecticut Historical Commission
CITY, TOWN STATE
Hartford CT.

7 DESCRIPTION

CONDITION		CHECK ONE	CHECK ONE
<input type="checkbox"/> EXCELLENT	<input type="checkbox"/> DETERIORATED	<input type="checkbox"/> UNALTERED	<input checked="" type="checkbox"/> ORIGINAL SITE
<input checked="" type="checkbox"/> GOOD	<input type="checkbox"/> RUINS	<input checked="" type="checkbox"/> ALTERED	<input type="checkbox"/> MOVED DATE _____
<input type="checkbox"/> FAIR	<input type="checkbox"/> UNEXPOSED		

DESCRIBE THE PRESENT AND ORIGINAL (IF KNOWN) PHYSICAL APPEARANCE

The picturesque Hitchcock-Schwarzmann Mill has a rural location at the northeast corner of Foote and Vineyard Roads in Burlington, Connecticut. Across Foote Road to the southwest is a frame barn erected about 1930 and a recently developed small recreation area with pond and ball-field. Included in the nomination are two houses which are associated with the mill. About 130 feet south of the mill is the 1½ story frame miller's house. This building is a typical example of 18th century vernacular Connecticut architecture. It is a five-bay wide building with brick central chimney and rear ell. Its exterior, which is little altered, is enhanced by a very handsome and huge maple tree in its front (west) yard. The other house which is located about 70 feet northeast of the mill was erected about 1940. This small, 1½ story frame dwelling has a number of outbuildings such as sheds and a privy.

The mill is located on a site which slopes upward at the northeast. This sloping site provides an energy producing 20 foot to 30 foot drop for the fork of Burlington Brook which is channeled under the mill. It also allows convenient loading and unloading into the upper level of the mill building which although the attic floor has a loading platform at ground level on the north side.

The mill is an unadorned, rambling structure with an irregular mass of five parts. The largest and probably the oldest section (c. 1781) is the 2½ story east section (section 1 on attached plan). It has a saltbox shape since the south slope of its roof is much longer than the north slope. It has very heavy framing with kingpost and pegged joints. Extending across the front (south) of this section is a 2 story wing with an almost flat shed roof (section 5 on attached plan). The western part of this addition was built in the early 20th century. The eastern part is older, but the specific date it was erected is not known.

The central section of the mill (section 2 on attached plan) is attached to the west side of the east section (section 1). The ridge-pole of this section's gable roof is lower than that of the east section although both are 2½ story masses. This wing may be contemporary with the east wing since it also has heavy mortise-joint construction.

Attached to the central section at the west is a small 1½ story wing (section 3 on plan). The steepness of the gable roof of this wing and the 12/8 windows in its gable suggest that it has considerable age. This wing has been surrounded on the rear (north), the west, and part of the front (south) by a 1 story shed with an almost flat gable roof (section 4 on plan). This addition was erected in the early 20th century to store cider.

The mill has a number of types of exterior siding. The east section (section 1) is covered with vertical board siding, while the central section (section 2) has clapboards on its front (south, but vertical boards on the north and west sides. Its north side is painted red. The small 1½ story section (section 3) has clapboards on its limited area of exposed exterior wall. The west addition (section 4) has vertical board siding, while the south addition (section 5) attached to the east section has similar siding on its west and south sides, but its east side is covered with wood shingles. Most exterior walls are unpainted and their siding has weathered to a handsome brown. Roofs are

See Continuation Sheet 2

UNITED STATES DEPARTMENT OF THE INTERIOR
NATIONAL PARK SERVICE

**NATIONAL REGISTER OF HISTORIC PLACES
INVENTORY -- NOMINATION FORM**

FOR NPS USE ONLY

RECEIVED

DATE ENTERED

CONTINUATION SHEET 2

ITEM NUMBER 7

PAGE 2

Hitchcock-Schwarzmann Mill, Burlington, CT.

7. Description

covered with a variety of modern roofing materials. Except the north slope of the east wing (section 1) which is covered with wood shingles. The building has a variety of window sizes. Older sections have a number of double-hung windows of varying sizes including 6/6, 6/8, 8/12, 12/12, and 12/8. The east section (section 1) has a single interior brick chimney.

In front of (on the south side of) the central section (section 2) is a wooden bin about 10' x 8'. It held apples to be hoist into storage on the second story of the central section via the second story doorway. In front of the bin is a Fairbanks wagon scale which was used to weigh the apples. Another interesting piece of exterior equipment is a large cast-iron wheel attached to the south wall of the south shed wing (section 5). It is probably part of the rope drive power system.

The mill apparently was built directly over the sluice with its water wheel inside. This arrangement while not typical in early mills was not uncommon. The water wheel has been replaced by a vertical water powered turbine centrally located in the basement of the building. When the gates of the channel are open water enters a 36" pipe leading to the turbine, which is capable of generating 32-35 horsepower. A rope drive power system carries this power to the machinery used in milling operations.

The mill contains operable machinery for the cider milling, sawmilling, and shingle milling operations. Some of the grist milling equipment is gone since this was the first operation to be terminated at the mill. However, much of the gristmill machinery is there including a fanning mill, a corn grinder, corn shucker, and millstone. The contents of the mill have not yet been inventoried, but brief inspection seems to indicate that much of the equipment was made in the late 19th century. However, equipment of earlier date can also be found in the building such as parts of an up and down saw replaced about 1915 by a used circular saw.

Operations within the building were arranged so that the cider press and the huge cider vats are located on the first floor, while apples were stored on the second floor. Also on the first floor was a work bench area and some of the grist mill equipment. The second floor housed additional grist mill machinery and the shingle mill along with storage space. On the third level were the saw mill and more storage areas.

UNITED STATES DEPARTMENT OF THE INTERIOR
NATIONAL PARK SERVICE

FOR NPS USE ONLY

RECEIVED

DATE ENTERED

NATIONAL REGISTER OF HISTORIC PLACES
INVENTORY -- NOMINATION FORM

CONTINUATION SHEET 3

ITEM NUMBER 7 PAGE 2

Hitchcock-Schwarzmann Mill, Burlington, CT.
7. Description

PLAN OF ROOFS

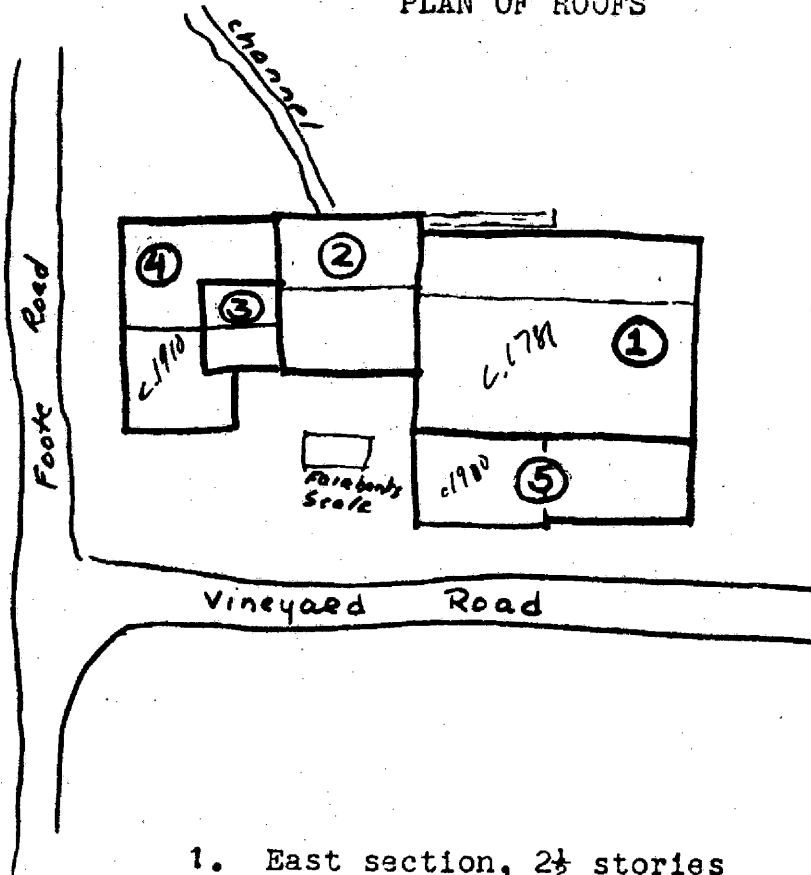

1. East section, 2½ stories
2. Central section, 2½ stories
3. 1½ story wing
4. 1 story shed
5. 2 story addition

8 SIGNIFICANCE

PERIOD	AREAS OF SIGNIFICANCE -- CHECK AND JUSTIFY BELOW				
<input type="checkbox"/> PREHISTORIC	<input type="checkbox"/> ARCHEOLOGY-PREHISTORIC	<input type="checkbox"/> COMMUNITY PLANNING	<input type="checkbox"/> LANDSCAPE ARCHITECTURE	<input type="checkbox"/> RELIGION	
<input type="checkbox"/> 1400-1499	<input type="checkbox"/> ARCHEOLOGY-HISTORIC	<input type="checkbox"/> CONSERVATION	<input type="checkbox"/> LAW	<input type="checkbox"/> SCIENCE	
<input type="checkbox"/> 1500-1599	<input type="checkbox"/> AGRICULTURE	<input type="checkbox"/> ECONOMICS	<input type="checkbox"/> LITERATURE	<input type="checkbox"/> SCULPTURE	
<input type="checkbox"/> 1600-1699	<input checked="" type="checkbox"/> ARCHITECTURE	<input type="checkbox"/> EDUCATION	<input type="checkbox"/> MILITARY	<input type="checkbox"/> SOCIAL/HUMANITARIAN	
<input checked="" type="checkbox"/> 1700-1799	<input type="checkbox"/> ART	<input type="checkbox"/> ENGINEERING	<input type="checkbox"/> MUSIC	<input type="checkbox"/> THEATER	
<input checked="" type="checkbox"/> 1800-1899	<input type="checkbox"/> COMMERCE	<input type="checkbox"/> EXPLORATION/SETTLEMENT	<input type="checkbox"/> PHILOSOPHY	<input type="checkbox"/> TRANSPORTATION	
<input checked="" type="checkbox"/> 1900	<input type="checkbox"/> COMMUNICATIONS	<input checked="" type="checkbox"/> INDUSTRY	<input type="checkbox"/> POLITICS/GOVERNMENT	<input type="checkbox"/> OTHER (SPECIFY)	
		<input type="checkbox"/> INVENTION			

SPECIFIC DATES c. 1781, later additions BUILDER/ARCHITECT

STATEMENT OF SIGNIFICANCE

The Hitchcock-Schwarzmann Hill, an excellent example of vernacular industrial architecture, is the only building of its type remaining in Burlington. The well-preserved mill retaining much of its machinery is unusual as it housed four different milling operations. Built as a grist mill in the late 18th century, the unadorned frame building was added to a number of times. In the 19th century it also housed a sawmill and in the 20th century a shingle mill and a cider mill were also in operation. Water-powered milling continued until the early 1970's, although the early waterwheel had been replaced by a turbine. The adjacent late 18th century miller's house is also well-preserved.

The earliest known documentary reference to this mill and to its miller's house is a deed of January 22, 1781, which records the sale of a dwelling house and one-half interest in a "new grist mill" to David Tyler by Jared Tyler.¹ Subsequently the mill was owned by Jared Covey and Elisha Covey. By the early 19th century it was known as Hitchcock's mill. Joel Hitchcock was the miller rather than the owner. In 1807 when an interest in the mill was purchased by Ira Foot it was still only a grist mill, but it is likely the saw milling operation was added shortly thereafter. In the 1880's the mill was purchased by George Schwarzmann. The Schwarzmann family operated it until 1972. It is not known exactly when the shingle mill and cider mill were added. The 1 story addition at the west and the addition at the southwest corner of the east section were added in the early 20th century. Both of these additions are occupied by large cider vats suggesting the addition of or expansion of the cider milling operation.

Just prior to the death of William Schwarzmann, George Schwarzmann's son, the milling operations stopped. In 1976 the mill and its machinery were purchased by the Burlington Historical Society. This group is in the process of transferring ownership to the Town of Burlington. The society will then lease the building, restore it, and open it as a museum. The miller's house is a private residence owned and occupied by William Schwarzmann's daughter.

¹ Information from Farmington Land Records quoted in a letter from Lois P. Humphrey to T. Robins Brown, July 22, 1976.

UNITED STATES DEPARTMENT OF THE INTERIOR
NATIONAL PARK SERVICE

**NATIONAL REGISTER OF HISTORIC PLACES
INVENTORY -- NOMINATION FORM**

FOR NPS USE ONLY

RECEIVED

DATE ENTERED

CONTINUATION SHEET 4

ITEM NUMBER 9

PAGE 4

Hitchcock-Schwarzmann Mill, Burlington, CT.

9. Major Bibliographical References

Interview with Mrs. Lois P. Humphrey, Mr. William Reeve, and Mr. Ernest Schwarzmann, June 17, 1976. Notes in files of T. Robins Brown
James Klanaski, "Schwartzmann Mill May be Listed National Historical Site," Burlington Trader, August 3, 1976.