

United States Department of the Interior
National Park Service

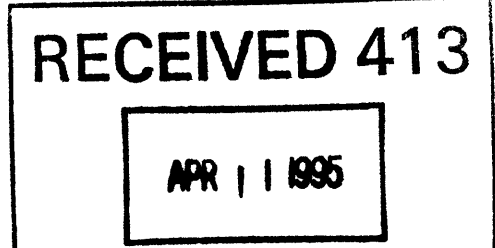

National Register of Historic Places Registration Form

This form is for use in nominating or requesting determination for individual properties. **INTERAGENCY RESOURCES DIVISION**
How to Complete the National Register of Historic Places Registration Form (National Register Bulletin 16A). Complete each item by marking "x" in the appropriate box or by entering the information requested. If an item does not apply to the property being documented, enter "N/A" for "not applicable." For functions, architectural classification, materials and areas of significance, enter only categories and subcategories from the instructions. Place additional entries and narrative items on continuation sheets (NPS Form 10-900a). Use a typewriter, word processor, or computer, to complete all items.

1. Name of Property

historic name Six Mile Creek Stage Station Historic District
other names/site number NPS Master Plan #81

2. Location

street & number 600' e. FAS 468 and 4-1/4 mi. s. US 56¹ [N/A] not for publication
city or town Burdick [X] vicinity
state Kansas code KS county Morris code 127 zip code 66838

3. State/Federal Agency Certification

As the designated authority under the National Historic Preservation Act, as amended, I hereby certify that this [X] nomination [] request for determination of eligibility meets the documentation standards for registering properties in the National Register of Historic Places and meets the procedural and professional requirements set forth in 36 CFR Part 60. In my opinion, the property [X] meets [] does not meet the National Register criteria. I recommend that this property be considered significant [] nationally [] statewide [X] locally.
(See continuation sheet for additional comments [].)

Ramon Power SHPO 11.2.94
Signature of certifying official/Title Date
Kansas State Historical Society
State or Federal agency and bureau

In my opinion, the property [] meets [] does not meet the National Register criteria.
(See continuation sheet for additional comments [].)

Signature of certifying official/Title Date

State or Federal agency and bureau

4. National Park Service Certification

I hereby certify that the property is:

- [X] entered in the National Register
See continuation sheet [].
- [] determined eligible for the
National Register
See continuation sheet [].
- [] determined not eligible for the
National Register.
- [] removed from the
National Register
- [] other, explain
See continuation sheet [].

Entered in the
National Register
Edson H. Beall 5.11.95
Signature of the Keeper Date

Six Mile Creek Stage Station
Name of Property

Morris/KS
County/State

Historic Resources of the Santa Fe Trail
Multiple Property Submission

5. Classification

Ownership of Property
(Check as many boxes as apply)

Category of Property
(Check only one box)

Number of Resources within Property
(Do not count previously listed resources.)
Contributing Noncontributing

- private
- public-local
- public-State
- public-Federal

- building(s)
- district
- site
- structure
- object

| | | |
|-----------|----------|------------|
| <u>0</u> | <u>2</u> | buildings |
| <u>10</u> | <u>0</u> | sites |
| <u>0</u> | <u>1</u> | structures |
| <u>0</u> | <u>0</u> | objects |
| <u>10</u> | <u>3</u> | Total |

Name of related multiple property listing.
(Enter "N/A" if property is not part of a multiple property listing.)

Number of contributing resources previously listed in the National Register.

Historic Resources of the Santa Fe Trail

N/A

6. Function or Use

Historic Function
(Enter categories from instructions)

TRANSPORTATION/road-related

DOMESTIC/hotel

Current Functions
(Enter categories from instructions)

VACANT/Not in Use

AGRICULTURE/SUBSISTENCE/

agricultural building

7. Description

Architectural Classification
(Enter categories from instructions)

N/A

Materials
(Enter categories from instructions)

foundation Limestone

walls Limestone

roof N/A

other N/A

Narrative Description

(Describe the historic and current condition of the property on one or more continuation sheets.)

Six Mile Creek Stage Station
Name of Property

Morris/KS
County/State

Historic Resources of the Santa Fe Trail
Multiple Property Submission

8. Statement of Significance

Applicable National Register Criteria

(Mark "x" in one or more boxes for the criteria qualifying the property for National Register listing.)

A Property is associated with events that have made a significant contribution to the broad patterns of our history

B Property is associated with the lives of persons significant in our past.

C Property embodies the distinctive characteristics of a type, period, or method of construction or represents the work of a master, or possesses high artistic values, or represents a significant and distinguishable entity whose components lack individual distinction.

D Property has yielded, or is likely to yield, information important in prehistory or history.

Criteria Considerations

(Mark "x" in all the boxes that apply.)

Property is:

A owned by a religious institution or used for religious purposes.

B removed from its original location.

C a birthplace or grave.

D a cemetery.

E a reconstructed building, object, or structure.

F a commemorative property.

G less than 50 years of age or achieved significance within the past 50 years.

Narrative Statement of Significance

(Explain the significance of the property on one or more continuation sheets.)

9. Major Bibliographic References

Bibliography

(Cite the books, articles and other sources used in preparing this form on one or more continuation sheets.)

Previous documentation on file (NPS):

preliminary determination of individual listing (36 CFR 67) has been requested

previously listed in the National Register

previously determined eligible by the National Register

designated a National Historic Landmark

recorded by Historic American Buildings Survey

recorded by Historic American Engineering Record

Areas of Significance

(Enter categories from instructions)

Transportation

Commerce

Archeology/Historic--non-aboriginal

Periods of Significance

1822 - c. 1870

Significant Dates

c. 1863

c. 1867

Significant Person(s)

(Complete if Criterion B is marked above).

N/A

Cultural Affiliation

Euro-American

Architect/Builder

N/A

Primary location of additional data:

State Historic Preservation Office

Other State Agency

Federal Agency

Local Government

University

Other:

Name of repository:

National Park Service Regional Office--
Santa Fe, New Mexico

Six Mile Creek Stage Station
Name of Property

Morris/KS
County/State

Historic Resources of the Santa Fe Trail
Multiple Property Submission

10. Geographical Data

Acreage of Property 7.5 acres

UTM References

(Place additional UTM references on a continuation sheet.)

A. Zone 14 Easting 686840 Northing 4275000

B. Zone Easting Northing

C. Zone Easting Northing

D. Zone Easting Northing

[] See continuation sheet

Verbal Boundary Description

(Describe the boundaries of the property on a continuation sheet.)

Boundary Justification

(Explain why the boundaries were selected on a continuation sheet.)

11. Form Prepared By

name/title see continuation sheet

organization The URBANA Group date May 1993

street & number 202 South Broadway, Suite 206, P.O. Box 1028 telephone (217) 344-7526

city or town Urbana state IL zip code 61801-9028

Additional Documentation

Submit the following items with the completed form:

Continuation Sheets

Maps

A USGS map (7.5 or 15 minute series) indicating the property's location.

A Sketch map for historic districts and properties having large acreage or numerous resources.

Photographs

Representative black and white photographs of the property.

Additional Items

(Check with the SHPO or FPO for any additional items)

Property Owner

(Complete this item at the request of SHPO or FPO.)

name Mr. and Mrs. Raleigh Sill

street & number _____ date _____

city or town Burdick state KS zip code 66838

Paperwork Reduction Act Statement: This information is being collected for applications to the National Register of Historic Places to nominate properties for listing or determine eligibility for listing, to list properties, and to amend existing listings. Response to this request is required to obtain a benefit in accordance with the National Historic Preservation Act, as amended (16 U.S.C. 470 *et seq.*).

Estimated Burden Statement: Public reporting burden for this form is estimated to average 18.1 hours per response including time for reviewing instructions, gathering and maintaining data, and completing and reviewing the form. Direct comments regarding this burden estimate or any aspect of this form to the Chief, Administrative Services Division, National Park Service, P.O. Box 37127, Washington, DC 20013-7127; and the Office of Management and Budget, Paperwork Reductions Projects (1024-0018), Washington, DC 20503.

United States Department of the Interior
National Park Service

National Register of Historic Places
Continuation Sheet

Six Mile Creek Stage Station Historic District; Morris County, KS
Historic Resources of the Santa Fe Trail, 1821-1880
Section number 2

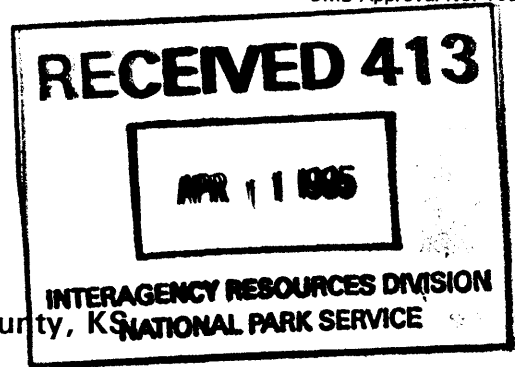

Page 1

2. Location

street and number:

1. In the Kansas Department of Transportation road system designation, the "FAS" designation is defined as "Federal-Aid Secondary Highway System."

**United States Department of the Interior
National Park Service**

**National Register of Historic Places
Continuation Sheet**

**Six Mile Creek Stage Station Historic District; Morris County, KS;
Historic Resources of the Santa Fe Trail, 1821-1880
Section number 7**

Page 2

Narrative Description

The Six Mile Creek Stage Station Historic District is located to the east of FAS 468 which runs south from U.S. Highway 56, just south of the bridge over Six Mile Creek. The historic district is two and one-half miles north of Burdick, in Morris County, Kansas. The contributing resources of the Six Mile Creek Stage Station Historic District include the surface and subsurface remains of the stage station building and a barn, the original well, subsurface remains of the blacksmith's shop and the corral, ruins of an outbuilding (stone wall and foundation), and four rutted segments; the creek crossing itself is no longer visible. Two farm buildings and a windmill in this historic district date outside of the period of significance. The historic district retains good visibility and focus due to the existing elements that allow for interpretation of the historic district. Mature spruce trees screen much of the historic district from the road.

The use of the creek crossing spans from 1822, with the initiation of wagon transportation across the Santa Fe Trail, to c. 1870, with the arrival of the railroad in Kansas. The stage station opened at this location about 1863, and was in use until 1866 or 1867 when the stage line moved to Junction City, Kansas due to railroad construction. After the station was abandoned, the station building served as a ranch house into the early twentieth century. The farmstead is abandoned. Environmental factors of relevance to the historic district during its period of significance include location along the Santa Fe Trail and the Six Mile Creek crossing. Today, the original creek channel has been diverted to the northeast of its original flow, but natural vegetation, in addition to the amount of physical features, lend much to the historic district's environment.

A dirt and grass lane goes east off FAS 468 to access the historic district. After passing the ruins, the lane curves northeast to reach the ruts, which are located in an adjacent field. The original stage station well is just north of this dirt road, approximately thirty-five meters east of FAS 468. The original well has walls of cut limestone for ten feet, and a bottom hewn from bedrock; the bottom of the well is wider than the top shaft. The well was capped with concrete in September, 1941. Two buildings, a chicken coop and a utility building, were constructed at this location in 1926 by the current property owner's father. These buildings are located near the well to the east. To the east of these two buildings are substantial ruins of a barn which date to the site's use as a stage station. One wall remains standing, and three fenestration openings are evident. The outline of the remaining foundation is visible at the surface. Ruins of another building are just to the east and while the date of these ruins has not been confirmed, they likely date after the period of significance for the historic district. Stones were reportedly salvaged from a building and/or a stone corral which were Trail-related, in order to construct this former building. Trees frame these ruins and farm buildings to the north, in a line just south of one of the rutted segments.

To the south of the dirt road is a Daughters of the American Revolution marker, three meters east of the FAS 468. Approximately thirty meters east of the road are the remains of the c. 1863 stage station. The original building was one and one-half stories, and included a basement. The building originally had three

**United States Department of the Interior
National Park Service**

**National Register of Historic Places
Continuation Sheet**

**Six Mile Creek Stage Station Historic District; Morris County, KS;
Historic Resources of the Santa Fe Trail, 1821-1880**

Section number 7

Page 3

rooms, but additions were made to the building in the 1890s. The 1890s additions remain evident today, on the east side of the original building. A blacksmith's shop was approximately five meters to the southeast of this house. The stone corral was located about ten meters north of the blacksmith's shop, and was near and under the present location of the dirt and grass lane which accesses this historic district. The corral was dismantled within about the last fifty years. About twenty meters east of the station building is a modern frame outhouse, adjacent to which is a concrete slab; neither are of sufficient size to count as resources in this historic district. The outhouse was placed in the historic district when the current owners became involved in Santa Fe Trail tours. A line of spruce trees frames these features to the east on the other side of which is a mound.

About two meters to the east of the mound is a windmill. To the northeast of the windmill are building ruins, just one to two meters south of the dirt road. These ruins consist of a stone wall and foundation, and are barely visible in tall weeds. These ruins likely date to the period of significance, as the ruins are similar in materials and construction evidence to those of the barn (ruins) to the northwest. Additionally, no concrete was used in this building's construction as was seen in buildings which were constructed later in this historic district. The creek crossing was to the northeast, approximately ten meters; it is no longer evident.

The original Six Mile Creek channel runs north/south, turning gradually southeasterly at the point where the Santa Fe Trail crossed the creek, after which the original channel continues more intermittently southeast. The creek bottom was filled within the last fifty years to prevent flooding.

The Santa Fe Trail generally followed a southwest-northeast line in this area. However, the Trail ran more east-west at the crossing. The four rutted segments are to the east and northeast of the crossing. A series of rutted segments exists, but tall vegetation prevents determining an exact bearing of each of the segments. Generally, they are oriented southwesterly/northeasterly approaching the creek from the east, paralleling the approximate location as indicated on the USGS map, Burdick Quadrangle. The segments continue for approximately 180 meters across a fallow field, and are being preserved by the current land owner.

The only known investigation of this historic district was a reconnaissance-level survey. Given its importance, a more detailed analysis of the archaeological potential of the stage station complex should be conducted. The archaeological integrity of the historic district is minimally affected by the 1890s and 1926 construction. However, the amount of extant surface and probable subsurface remains gives this historic district a high potential to yield information. The environmental context of the historic district is good, as the historic district contains a good degree of integrity for location, setting, feeling and association.

United States Department of the Interior
National Park Service

National Register of Historic Places
Continuation Sheet

Six Mile Creek Stage Station Historic District; Morris County, KS;
Historic Resources of the Santa Fe Trail, 1821-1880
Section number 7

Sketch Map

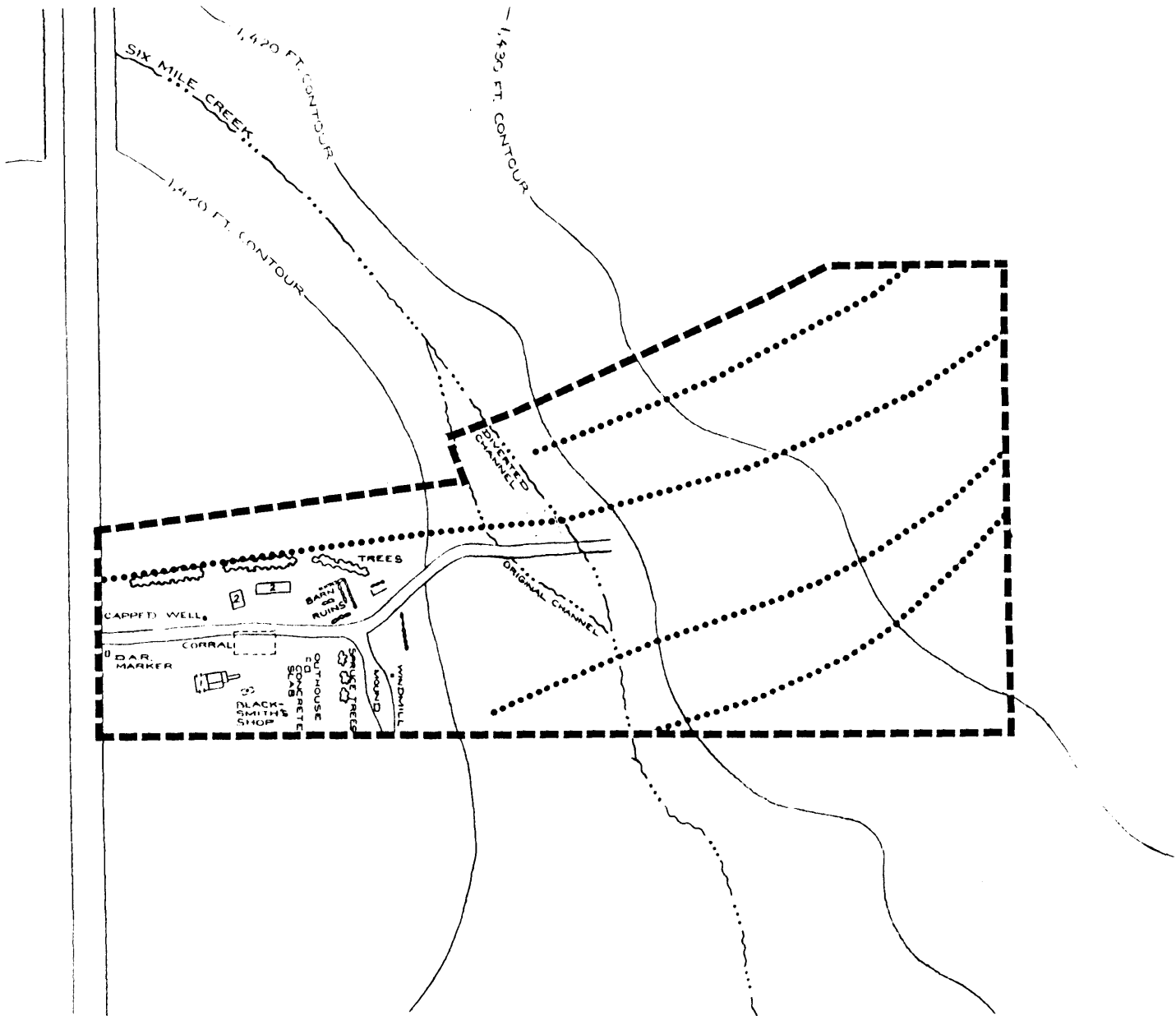

KEY

- SITE BOUNDARY
- TRAIL SEGMENTS
- STATION BUILDING
- 1926 OUTBUILDINGS

SCALE

0 20 METERS



United States Department of the Interior
National Park Service

National Register of Historic Places
Continuation Sheet

Six Mile Creek Stage Station Historic District; Morris County, KS;
Historic Resources of the Santa Fe Trail, 1821-1880
Section number 7

Photo View Map

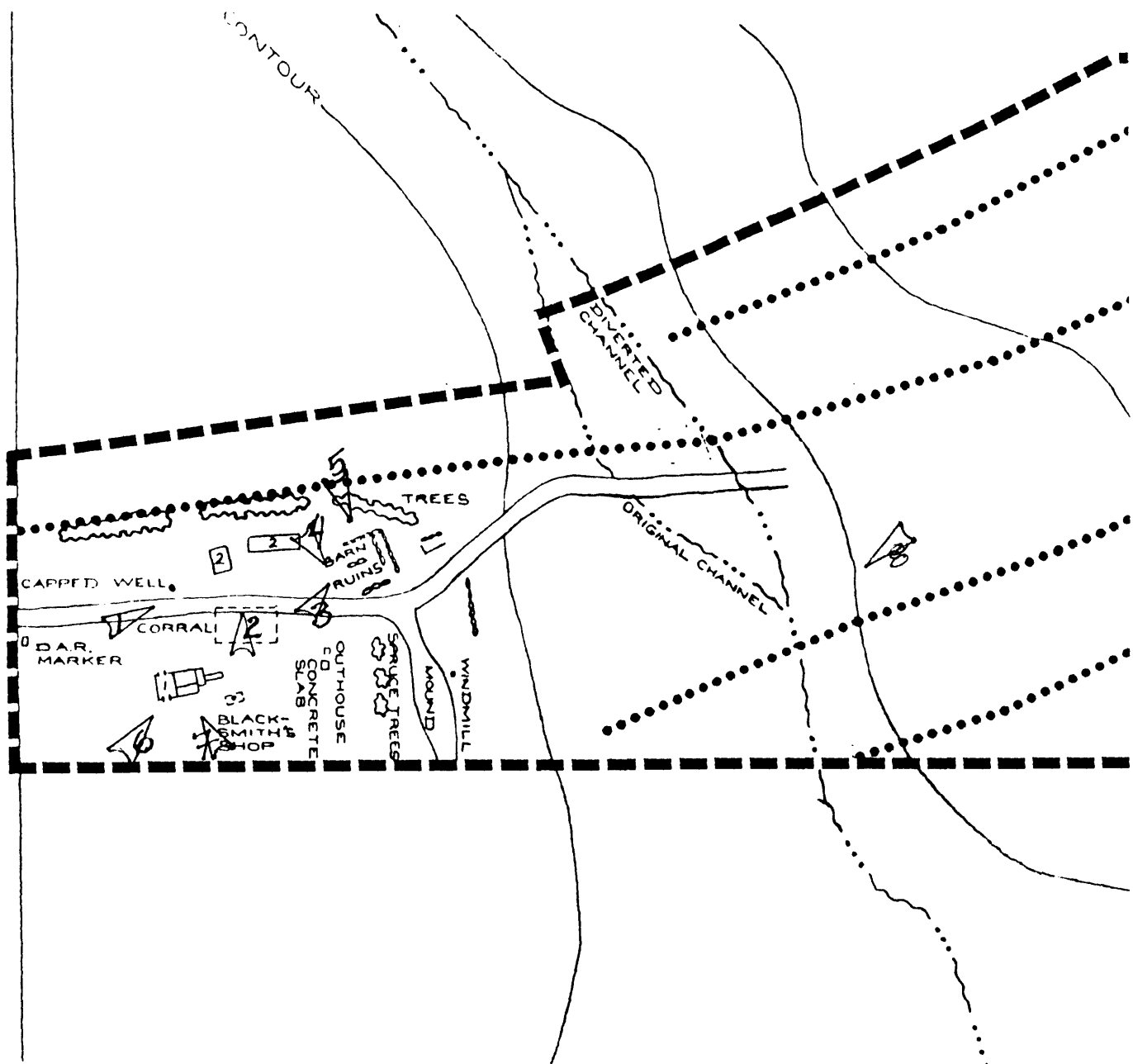

**United States Department of the Interior
National Park Service**

**National Register of Historic Places
Continuation Sheet**

**Six Mile Creek Stage Station Historic District; Morris County, KS;
Historic Resources of the Santa Fe Trail, 1821-1880
Section number 8**

Page 6

Narrative Statement of Significance

Summary

The Six Mile Creek Stage Station Historic District is eligible for the National Register under Criterion A as a reflection of historically-significant Trail traffic and meets the criterion within the areas of commerce and transportation. The historic district is also eligible under Criterion D for its potential to yield information. The property fulfills the registration requirements of the Historic Trail and Ancillary Historic Properties/Stage Stations property types detailed within Section F of the Historic Resources of the Santa Fe Trail, 1821-1880 Multiple Property Documentation Form. The ruts retain integrity in location, setting, feeling and association and bear witness to the Trail's importance in trans-Mississippi commerce and transportation in the late antebellum period. The historic district's period of significance begins with the initiation of wagon transportation across the Trail in 1822 until the arrival of the railroad through central Kansas circa 1870. The rutted segments and the stage station materially reflect important historic events outlined in the historic context: International Trade on the Mexican Road, 1821-1846; The Mexican War and the Santa Fe Trail, 1846-48; Expanding National Trade on the Santa Fe Trail, 1848-1865; and The Santa Fe Trail and the Railroad, 1865-1880.

History

Six Mile Creek got its name from wagon masters who estimated that the creek was six miles from Diamond Spring--the location of another stage station.¹ A stage station was established at Six Mile Creek in 1863 after the Diamond Spring stage station was destroyed.² The change in location of the stage station from Diamond Spring to Six Mile Creek was one of the changes implemented by M. Cottrill and Company after it assumed responsibility for the route in 1863.³ M. Cottrill and Company operated stages which passed through the station and this stagecoach line became known by several names: Kansas, Santa Fe and Canon City Express; Kansas City, Santa Fe and Denver Mail and Express Line; the Santa Fe Stage and Express; the Santa Fe Stage Company; and the Santa Fe Stage.⁴ The stage station at Six Mile Creek remained in operation until 1866 or 1867 when the stage route was moved to Junction City, Kansas as a result of railroad construction.⁵

Marc Simmons, in his Trail guide Following the Santa Fe Trail, has stated that Charley Owens established his Six Mile Ranch at this location in 1866, but it was destroyed by Cheyennes in 1868 while he and his wife were absent.⁶ Interviews conducted with current owners suggest that Frank and William Heartwell purchased the Six Mile Creek Ranch which consisted of a house, stone corral, and a stabling device for ten horses in 1864-1865.⁷

Six Mile Creek was just over one day's journey from Council Grove where the wagons adopted their four abreast defensive formation. The series of ruts oriented northeast-southwest across this historic district are representative of this type of formation. Six Mile Creek presented Trail travelers with their first creek crossing after leaving Diamond Spring en route to Lost Spring and on the second day after departing

**United States Department of the Interior
National Park Service**

**National Register of Historic Places
Continuation Sheet**

**Six Mile Creek Stage Station Historic District; Morris County, KS;
Historic Resources of the Santa Fe Trail, 1821-1880
Section number 8**

Page 7

Council Grove. Diamond Spring was mentioned by many Trail travelers in their accounts including Josiah Gregg, Susan Shelby Magoffin, and Marian Russell,⁸ and they probably crossed Six Mile Creek although no mention is made of it in their accounts. Six Mile Creek posed little obstacle to wagon movement.

Trail traffic declined as the railroad moved westward. The railroad which was established through central Kansas in the late 1860s and early 1870s hastened the decline of the Santa Fe Trail as an overland trade route.

The Six Mile Creek Stage Station Historic District has the potential of yielding data sets involving building construction techniques, spatial relationships to other non-extant buildings in the historic district area, and domestic and material life. These data sets, if present, could be profitably used in a comparative fashion with other stage station sites along the Trail. This historic district has the ability to address several important research questions. Site-specific questions involve the relationship of the station to the nearby establishments both spatially and commercially, the contents of the overgrown mound, the exact alignment of the station to the Trail, and the vernacular construction techniques involved. More general research questions that could potentially be elucidated by the Six Mile Creek Stage Station Historic District include trade patterns between eastern metropolitan areas and the "frontier" region, vernacular construction in the pioneer period, and patterns of settlement formation and evolution in the region. Through the presence of relatively undisturbed data sets capable of yielding information relevant to answering important research questions, this historic district fulfills the requirements for eligibility under Criterion D in the area of archaeology/historic--non-aboriginal.

Endnotes

1. United States Department of the Interior/National Park Service, Santa Fe National Historic Trail: Comprehensive Management and Use Plan (Washington, D.C.: U.S. Government Printing Office, 1990), p. 97.

2. Ibid.

Morris F. Taylor, First Mail West (Albuquerque: University of New Mexico Press, 1971), p. 95.

3. Ibid., p. 94.

4. Ibid., p. 95.

5. United States Department of the Interior/National Park Service, p. 97.

United States Department of the Interior
National Park Service

National Register of Historic Places
Continuation Sheet

Six Mile Creek Stage Station Historic District; Morris County, KS;
Historic Resources of the Santa Fe Trail, 1821-1880
Section number 8

Page 8

6. Marc Simmons, Following the Santa Fe Trail: A Guide for Modern Travelers, 2nd ed. (Santa Fe: Ancient City Press, 1986), p. 84-85.

7. Interview with Bonnie and Raleigh Sill, Burdick, Kansas, July 1991.

8. Gregg, Josiah, The Commerce of the Prairies, Edited by Milo Milton Quaife, Bison Book edition (Lincoln, Nebraska and London: University of Nebraska Press, 1967), p. 40.

Stella M. Drumm, ed., Down the Santa Fe Trail and Into Mexico: The Diary of Susan Shelby Magoffin, 1846-1847 (New Haven: Yale University Press, 1926 and 19 1962; reprint ed., Lincoln, Nebraska and London: University of Nebraska Press, 1982), p. 20.

Marian Russell, Land of Enchantment: Memoirs of Marian Russell along the Santa Fe Trail, dictated to Mrs. Hal Russell (Evanston, Illinois: The Branding Iron Press, 1954), pp. 69-70, 81.

**United States Department of the Interior
National Park Service**

**National Register of Historic Places
Continuation Sheet**

**Six Mile Creek Stage Station Historic District; Morris County, KS;
Historic Resources of the Santa Fe Trail, 1821-1880
Section number 9**

Page 9

Bibliography

- Drumm, Stella M., ed. Down the Santa Fe Trail and Into Mexico: The Diary of Susan Shelby Magoffin, 1846-1847. New Haven: Yale University Press, 1926 and 1962; reprint ed., Lincoln, Nebraska and London: University of Nebraska Press, 1982.
- Gregg, Josiah. The Commerce of the Prairies, Edited by Milo Milton Quaife, Bison Book edition. Lincoln, Nebraska and London: University of Nebraska Press, 1967.
- Russell, Marian. Land of Enchantment: Memoirs of Marian Russell along the Santa Fe Trail, dictated to Mrs. Hal Russell. Evanston, Illinois: The Branding Iron Press, 1954.
- Sill, Bonnie and Raleigh. Burdick, Kansas. Interview, July 1991.
- Simmons, Marc. Following the Santa Fe Trail: A Guide for Modern Travelers. 2nd ed. Santa Fe: Ancient City Press, 1986.
- Taylor, Morris F. First Mail West: Stagecoach Lines on the Santa Fe Trail. Albuquerque: University of New Mexico Press, 1971.
- United States Department of the Interior/National Park Service. Santa Fe National Historic Trail: Comprehensive Management and Use Plan. Washington, D.C.: U.S. Government Printing Office, 1990.

**United States Department of the Interior
National Park Service**

**National Register of Historic Places
Continuation Sheet**

**Six Mile Creek Stage Station Historic District; Morris County, KS;
Historic Resources of the Santa Fe Trail, 1821-1880
Section number 10**

Page 10

Verbal Boundary Description

Starting at the point of intersection of the rutted Trail segment and FAS 468, proceed south along the eastern edge of FAS 468 for forty meters. Turn east and continue the boundary for 245 meters. Proceed north for 125 meters before turning due west and proceeding for forty five-meters. Continue the boundary southwest parallel to the most northerly rutted Trail segment at a distance fifteen meters northwest of the segment until the original Six Mile Creek channel is reached. Follow the drainage channel south until the boundary is within fifteen meters from the second most northerly Trail segment. Turn west and continue the boundary parallel to said Trail segment at a distance of fifteen meters from the Trail segment until the eastern margin of FAS 468 is reached. Turn due south and follow the eastern edge of FAS 468 for fifteen meters and return to the point of origin. The use of the road margin as a boundary, contained within this nomination, presupposes the exclusion of the road's current publicly-designated right-of-way.

Boundary Justification

The boundaries of the historic district enclose the historic Trail resources and their immediate environs. The eastern boundary of the historic district follows the eastern edge of FAS 468. The southern, eastern, and northeastern boundaries of the historic district were chosen based on the extent of Trail-related resources and their immediate environs. Much of the northern boundary of the historic district parallels the two most northerly Trail segments at a distance of fifteen meters as recommended in National Register Bulletin #30, p. 27. A small portion of the northern boundary follows the original Six Mile Creek channel.

**United States Department of the Interior
National Park Service**

**National Register of Historic Places
Continuation Sheet**

**Six Mile Creek Stage Station; Morris County, KS;
Historic Resources of the Santa Fe Trail, 1821-1880
Section number 11**

Page 11

Form Prepared by:

For The URBANA Group:

Joseph Gallagher/Cultural Geographer
Writer; Map

Alice Edwards/Vice President, Preservation Planner
Writer

Archaeological Survey, University of Missouri-St. Louis
Colleen Hamilton and Brad Mueller/Historic Archaeologists
Field Work