

**United States Department of the Interior  
Heritage Conservation and Recreation Service**

**National Register of Historic Places  
Inventory—Nomination Form**

See instructions in *How to Complete National Register Forms*  
Type all entries—complete applicable sections

For HCRS use only

received APR 2 1985  
date entered 5/8/85

## 1. Name

historic "Upper Closter" or Alpine Historic District

and/or common

## 2. Location

street & number Various, see Maps I-III NA not for publication

city, town Alpine \_\_\_\_\_ vicinity of \_\_\_\_\_ congressional district

state New Jersey code 034 county Bergen code 003

## 3. Classification

Category	Ownership	Status	Present Use
<input checked="" type="checkbox"/> district	<input type="checkbox"/> public	<input checked="" type="checkbox"/> occupied	<input type="checkbox"/> agriculture
<input type="checkbox"/> building(s)	<input type="checkbox"/> private	<input type="checkbox"/> unoccupied	<input checked="" type="checkbox"/> commercial
<input type="checkbox"/> structure	<input checked="" type="checkbox"/> both	<input type="checkbox"/> work in progress	<input type="checkbox"/> educational
<input type="checkbox"/> site	<b>Public Acquisition</b>	<b>Accessible</b>	<input type="checkbox"/> entertainment
<input type="checkbox"/> object	<input type="checkbox"/> in process	<input checked="" type="checkbox"/> yes: restricted	<input checked="" type="checkbox"/> government
	<input type="checkbox"/> being considered	<input type="checkbox"/> yes: unrestricted	<input type="checkbox"/> industrial
	NA	<input type="checkbox"/> no	<input type="checkbox"/> military
			<input type="checkbox"/> museum
			<input type="checkbox"/> park
			<input checked="" type="checkbox"/> private residence
			<input checked="" type="checkbox"/> religious
			<input type="checkbox"/> scientific
			<input type="checkbox"/> transportation
			<input type="checkbox"/> other:

## 4. Owner of Property

name Multiple ownership

street & number

city, town \_\_\_\_\_ vicinity of \_\_\_\_\_ state

## 5. Location of Legal Description

courthouse, registry of deeds, etc. Bergen County Administrative Building

street & number Main Street

city, town Hackensack state New Jersey 07060

## 6. Representation in Existing Surveys

title Bergen County Historic Sites Survey (NJHSI) has this property been determined eligible?  yes  no

date 1982-83  federal  state  county  local

depository for survey records Office of New Jersey Heritage, CN-402,

city, town Trenton state New Jersey 08625

## 7. Description

<b>Condition</b>		<b>Check one</b>	<b>Check one</b>
<input checked="" type="checkbox"/> excellent	<input type="checkbox"/> deteriorated	<input checked="" type="checkbox"/> unaltered	<input checked="" type="checkbox"/> original site
<input checked="" type="checkbox"/> good	<input type="checkbox"/> ruins	<input checked="" type="checkbox"/> altered	<input type="checkbox"/> moved date _____
<input checked="" type="checkbox"/> fair	<input type="checkbox"/> unexposed		

### Describe the present and original (if known) physical appearance

Located on part of the crest and west downward slope of the Palisades which border the Hudson River, the "Upper Closter" or Alpine Historic District, with its winding roads, irregularly spaced houses, and informally landscaped properties, preserves the rural ambience of a late-19th-to-early-20th-century hamlet. The District includes 34 free-standing principal buildings. It has in addition one cemetery which dates to the mid-19th century and provides an area of open space. Twenty-five of its buildings are pre-1930, vernacular examples of modest-sized frame domestic architecture and most date to the last half of the 19-century. They vary in style and composition while exhibiting consistency in scale and material. Five of these have had, or presently contain commercial functions. The District's visual focal point is the stone Alpine Community Church, a High Victorian Gothic Revival Church edifice of high architectural quality (map #3). Its gabled roofed bell turret is the District's highest man-made vertical accent. Contributing to the District's character as a rural hamlet is the Alpine School, a 1½ to 2 story Queen Anne style frame school building which was erected in 1895 (map #2). The District only has one intrusive building, a recently remodelled gas station (map #18), and contains 6 nonhistoric houses.

The District is located on the west side of Highway Route 9W on the crest (approximately 450' elevation) and western slope, or downgrade of the Palisades. It begins at the intersection of Closter Dock Road and Old Dock Road, and continues west on both sides of Closter Dock Road to the east side of Forest Street. Buildings at map #11-19 front on the south side of Closter Dock Road while those at #2 and #35 are situated further south and front on Church Street and School House Lane. Buildings at map #3-10 front on the north side of Closter Dock Road and are situated at a higher elevation (2'-4') than street level. The north - western boundary of the district runs along Cemetery Street and includes the cemetery site (map #1). The eastern boundary of the district begins at the junction of Closter Dock Road and Old Road road, and extends north on the west and north side of Old Dock Road. Buildings at map #31-34 front on either side of Ridge Street and those at #20-24 are located on the north side of Forest Street.

The boundaries of the Historic District have been delineated to include the area of the historic hamlet of "Upper Closter" which contains a clear density of historic structures retaining architectural integrity. Parts of the former historic hamlet on the north and south sides of the juncture of Closter Dock Road and Old Dock Road, on East Main Street and along Du Bois Avenue, were omitted from the District since historic buildings there have been extensively altered. These altered buildings do not contribute to the area's historic character. Historic buildings to the west of the District are omitted from it because they do not contribute to the hamlet character of the area. These historic buildings are more widely spaced and there are recent buildings interspersed between them. Most buildings adjacent to the District's boundaries are houses erected since World War II. The boundaries of the District are shown on the enclosed maps and are drawn around current property lines of included buildings.

The "Upper Closter" or Alpine Historic District was identified by the Bergen County Historic Sites Survey. The Survey, begun in 1979, is a comprehensive

# 8. Significance

Period	Areas of Significance—Check and justify below			
<input type="checkbox"/> prehistoric	<input type="checkbox"/> archeology-prehistoric	<input type="checkbox"/> community planning	<input type="checkbox"/> landscape architecture	<input checked="" type="checkbox"/> religion
<input type="checkbox"/> 1400-1499	<input type="checkbox"/> archeology-historic	<input type="checkbox"/> conservation	<input type="checkbox"/> law	<input type="checkbox"/> science
<input type="checkbox"/> 1500-1599	<input type="checkbox"/> agriculture	<input type="checkbox"/> economics	<input type="checkbox"/> literature	<input type="checkbox"/> sculpture
<input type="checkbox"/> 1600-1699	<input checked="" type="checkbox"/> architecture	<input checked="" type="checkbox"/> education	<input type="checkbox"/> military	<input type="checkbox"/> social/ humanitarian
<input type="checkbox"/> 1700-1799	<input type="checkbox"/> art	<input type="checkbox"/> engineering	<input type="checkbox"/> music	<input type="checkbox"/> theater
<input checked="" type="checkbox"/> 1800-1899	<input checked="" type="checkbox"/> commerce	<input type="checkbox"/> exploration/settlement	<input type="checkbox"/> philosophy	<input type="checkbox"/> transportation
<input checked="" type="checkbox"/> 1900-	<input type="checkbox"/> communications	<input type="checkbox"/> industry	<input type="checkbox"/> politics/government	<input checked="" type="checkbox"/> other (specify)
		<input type="checkbox"/> invention		

**Specific dates**      NA                                      **Builder/Architect**      NA

**Statement of Significance (in one paragraph)**

The "Upper Closter" or Alpine Historic District is significant in Bergen County as it is one of two areas in the County which retain the character of a late 19th to early 20th century rural hamlet. Located atop the Palisades, the Alpine District has a history which is linked to its proximity to the Hudson River. It developed as a service and residential hamlet for people involved in maritime and stone quarrying activities in the area at the edge of the river below and for employees of the large estates on the crest of the Palisades. The "Upper Closter" Hamlet has been the civic, commercial and religious center of Alpine from the 1860's until the present time. The Alpine Community Church, a building of high aesthetic quality designed by J. Cleveland Cady; the Alpine School building; the J. Du Bois former general store and post office building; the Gecox Family cemetery, and twenty-five modest-sized, pre-1920 houses create a District which retains to a large degree its pre-1930 ambience. The relative density of these properties distinguishes the District as a physical entity from the rest of the Borough, and the area preserves the character and is clearly recognizable as a hamlet. Almost all the houses are relatively unadorned vernacular designs. However, some incorporate stylistic trends popular elsewhere in Bergen County such as Greek Revival, Italianate, Downingsque, Second Empire, and Queen Anne architectural styles.

The "Upper Closter" or Alpine Historic District in the late 19th century was a relatively isolated linear settlement situated at about an elevation of 450' on the crest of the Palisades cliffs. It was a residential community located along the transportation route linking the river port below to the farming villages of the interior Northern Valley. The area containing the Historic District did not develop as a hamlet until the mid 19th century since the poor soil cover and underlying trap rock of the vicinity was poor for farming. Historically the areas below the Palisades along the Hudson River were the only feasible places for initial settlement and economic activity in the Borough of Alpine. By 1876 (Walker's Atlas), this narrow strip of land area along the river was lined with fishing villages, docks, wharves and tidal-water -wheel powered industries such as a bone factory and a cereal mill.

The main thoroughfare passing through the District, today Closter Dock and Old Dock Road, zig-zagged down the cliffs to the Upper Closter Landing, a shipping port on the Hudson River. This transportation artery was established in pre-Revolutionary War times and continued as the main thoroughfare to the Landing into the 20th century. The Watkin's 1778 Revolutionary War period map shows the roads. While buildings are shown elsewhere, no buildings are indicated in the area of the District atop the Palisades (Map V). The U.S. Coast Guard Survey Map of 1839 (Map VI) shows only three buildings along this roadway in the area of the

# 9. Major Bibliographical References

See continuation sheet

# 10. Geographical Data

Acreeage of nominated property 16.1302

Quadrangle name Yonkers

Quadrangle scale 1:24000

**UMT References**

A 

1	18
Zone	

5	9	10
Easting		

4	5	3	13	6	4	10
Northing						

B 

1	18
Zone	

5	9	10	6	6	10
Easting					

4	5	3	13	4	4	10
Northing						

C 

1	8
Zone	

5	9	0	3	6	0
Easting					

4	5	3	3	2	6	0
Northing						

D 

1	8
Zone	

5	9	0	0	0	0
Easting					

4	5	3	3	3	0	0
Northing						

E 

1	8
Zone	

5	9	0	1	0	0
Easting					

4	5	3	3	6	4	0
Northing						

F 

Zone	

Easting					

Northing						

G 

Zone	

Easting					

Northing						

H 

Zone	

Easting					

Northing						

**Verbal boundary description and justification** Block 41, lots 4, part of 1. Block 42, lots 1-A,2,3. Block 43, lots, 1,2,3,4,5,6-A, 6-B,6-C,7,8. Block 44, lots 1,2,3, 4,5,8. Block 47, lots 1,2,3-A,3-B,4,5,10. Block 60, lots 9,10,11,12,13,14, 15,15-A, 16, portions of 17,17-A,18. See continuation sheet, Item 4, and

**List all states and counties for properties overlapping state or county boundaries** Map 11.

state	N/A	code	county	code
-------	-----	------	--------	------

state		code	county	code
-------	--	------	--------	------

# 11. Form Prepared By

name/title Alpine Citizens for Preservation/by Patricia Garbe Incorporating data supplied

organization Cultural and Historic Affairs date 2/84

street & number c/o General Delivery/ 355 Main St. telephone 201-768-6157/ 201-646-2323

city or town Hackensack state New Jersey

# 12. State Historic Preservation Officer Certification

The evaluated significance of this property within the state is:

national     state     local

As the designated State Historic Preservation Officer for the National Historic Preservation Act of 1966 (Public Law 89-665), I hereby nominate this property for inclusion in the National Register and certify that it has been evaluated according to the criteria and procedures set forth by the Heritage Conservation and Recreation Service.

Deputy State Historic Preservation Officer signature *William A. Sember*

title Assistant Commissioner for Natural Resources date 03/18/85

**For HCRS use only**

I hereby certify that this property is included in the National Register

*[Signature]* Entered in the National Register date 5-8-85

Keeper of the National Register

Attest: date

Chief of Registration

**United States Department of the Interior  
National Park Service**

**National Register of Historic Places  
Inventory—Nomination Form**

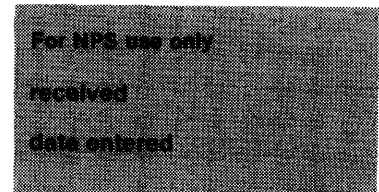

Alpine Historic District

Continuation sheet Alpine Borough, Bergen County, Item number 7

Page 1

NJ

effort to identify buildings, streetscapes, districts and sites of historic and architectural interest on a town by town basis. The Survey which is on-going is funded by Grants-In-Aid from the U.S. Department of the Interior, administered by the New Jersey Department of Environmental Protection, and matched by funds from the Bergen County Historic Sites Advisory Board. This Committee judged the "Upper Closter" or Alpine Historic District to be an area "of particular historic or architectural interest."

In the District Closter Dock Road has a straight east-west axis whereas the rest of the road pattern is winding creating in some cases irregular lot shapes. The heavily wooded terrain within the District is uneven and the placement of structures on parcels of various sizes along the roads creates an informal character. There are no sidewalks. Smaller lots, which are 60' to 80' wide, are located on the south side of Closter Dock Road, along Old Dock Road and Ridge Street, and buildings sited on them are clearly visible. Buildings on them (map #11-19 and #20-34), are only setback 10' to 20' from the roads. Buildings at map #2-10, on the north side of Closter Dock Road, are situated on larger lots of 100' to 200' in width, with more ample (30' to 50') setbacks, and have limited visibility from the road.

The earliest buildings in the hamlet are located in the vicinity of the juncture of Old Dock Road and Ridge Street and most of these were originally constructed between 1850-1870's. The house at map #26 was probably built earlier and stylistically appears to be about 1830-1840. The cemetery (map #1) is situated on over ½ acre of land and includes numerous tombstones dating to the mid-19th century as well as more recent ones. The majority of the houses, the church edifice (map #3), and the school building (map #2) were constructed in the last half of the 19th century. Early 20th century homes include map #5, 14, 17 and parts of #7. The remaining buildings in the District (map #6, 9, 15, 16, 28 and 30) are later 20th century non-contributing buildings.

Characteristic of the District is a modest-sized frame house displaying the vernacular or local interpretation of a developed style found elsewhere in Bergen County and the United States between about 1840 and the early 20th century. The District's houses are relatively unadorned buildings typical of rural settlements rather than distinguished examples of architecture. Architectural styles of the District's domestic architecture include vernacular interpretations of the Greek Revival (map #26), the Second Empire (map #11, 20, 32), Downingesque (map #8, 31, 35), Queen Anne (map #4, 10, 14) and Italianate (map #24, 27, 29) styles, and the early 20th century American Foursquare house type (map #13). Most of the houses have modifications which reflect their continuing construction histories, but

**United States Department of the Interior  
National Park Service**

**National Register of Historic Places  
Inventory—Nomination Form**

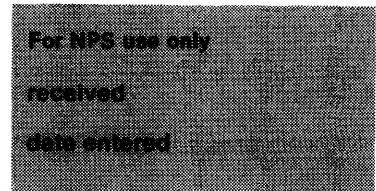

Continuation sheet Alpine Historic District Item number 7 Page 2  
Alpine Borough, Bergen County,  
NJ

retain sufficient historic fabric to clearly associate them with the hamlet's pre 1930 development. Five of the 19th century houses have detached historic frame outbuildings (map #4, 14, 29, 31, 32) which contributes to the rural ambience of the District.

The majority of the houses have 1½ or 2½ stories and have porches. The gable roof is the most common roof shape and several houses have low pitched gable roof shapes. The O. Jordan House (map #7) has a later, early 20th century gambrel pavilion. There are three structures with mansard roofs (map #11, 20, 32), and two with a hip roof (map #2, 13). There is one early 20th century frame stucco-covered house (map #17). Although ten houses have recent aluminum or wood shingle sidings, it appears that most of these re-sidings are reversible.

A coursed rubble church building, designed by J. Cleveland Cady, is one of two pivotal buildings in the District. Located at the highest point of land its siting is impressive; visually it is the focal point of the District. In terms of architectural design it is modelled after the small stone 1 story rectangular-in-plan Gothic Revival church buildings with pointed bell turrets which frequently are found in Great Britain. As a handsome example of the rural English County Church mode of the High Victorian Gothic Revival, the Alpine church building contributes to the rural ambience of the Alpine Historic District. It continues in its original ecclesiastical function.

A second pivotal building in the District is the cruciform-in-plan, little altered Queen Anne style school building (1895, map #2) which presently contains municipal offices and the Alpine Post Office. This 1½ to 2 story building with hipped roof and projecting pavilion with gable roof, displays the Queen Anne style's picturesque massing, variety of surface materials, and decorative details such as king post trusses in gables and diamond pattern window sashes. While not an elaborate example of a Queen Anne style building, it is typical of small town school architecture of the turn-of-the-20th-century, and it contributes to the District's sense of time and place.

The enclosed survey forms and listings give a closer examination of individual building descriptions.

**United States Department of the Interior  
National Park Service**

**National Register of Historic Places  
Inventory—Nomination Form**

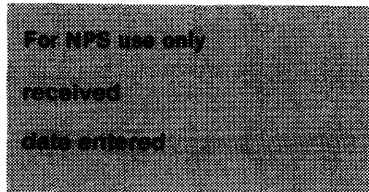

Continuation sheet Alpine Historic District Item number 7 Page 3  
Alpine Borough, Bergen County,  
NJ

**EXPLANATION FOR LISTS OF BUILDINGS ACCOMPANYING SOME DISTRICT  
AND STREETScape SURVEY FORMS**

Map # are keyed to district or streetscape maps.

Names and dates for historic owners are from city directories, dates of directories consulted are in parentheses.

Date erected: In most cases, construction took place between the two dates shown (i.e. a building with "1896-1908" given as its "date erected" was erected between 1896 and 1908). Dates were determined by consultation of historic maps, atlas, city directories, and for post-World War II structures, memories of residents. Visual dating preceded by "c." for "circa".

**Significance to District/Streetscape:**

This is an evaluation of the relative importance of the building to the district or streetscape. The codes are: [Code developed by Bergen County Office of Cultural & Historical Affairs. Words in parenthesis indicate Office of New Jersey Heritage Terminology]

**P for Pivotal:** A little altered building which has special visual merit or historical importance; probably qualifies for individual survey form.

**M for Matrix:** A vernacular building which represents typical area (Contributing) architecture and has good exterior integrity.

**F for Filler:** An old building which has had its significance (Conditional diminished by unsuitable alterations or siding Contributing) added, or one of lesser architectural interest. Age of structure is recognizable.

**C for Compatible:** (Harmonizing) A building constructed since World War II so it has no historic value. It is compatible in scale and materials with the historic environment. May be distinctive or significant in its own right.

**United States Department of the Interior  
National Park Service**

**National Register of Historic Places  
Inventory—Nomination Form**

For NPS use only

received

date entered

Continuation sheet Alpine Historic District, Alpine  
Borough, Bergen County, NJ Item number 7

Page 4

IC for Incompatible: A modern structure which detracts from or is disruptive to the historic character or design of the streetscape. May be distinctive or significant in its own right. Could be severely altered.

Description: See "Individual Structure Survey Form Guidelines" for definition.

Neg. File #: Filing code for photographic negatives of property at Office of Cultural and Environmental Services, NJDEP.



**HISTORIC NAME:** Alpine School  
**LOCATION:** Church Street (east side)

**COMMON NAME:** Alpine Borough Hall  
**BLOCK/LOT** 41/1

**MUNICIPALITY:** Alpine  
**USGS QUAD:** Yonkers  
**OWNER/ADDRESS:** Borough of Alpine  
Church Street  
Alpine, N. J. 07620

**COUNTY:** Bergen  
**UTM REFERENCES:** Zone/Easting/Northing

**DESCRIPTION**

**Construction Date:** 1895

**Source of Date:** Bradley

**Architect:**

**Builder:**

**Style:** Vernacular, Queen Anne

**Form/Plan Type:**

**Number of Stories:** A) 1 1/2, B) 1

**Foundation:** Rubble

**Exterior Wall Fabric:** Shingles with stucco and wood elements.

**Fenestration:** 4x2; variable, double hung sash diamond pattern/2; 4/4 and 2/2.

**Roof/Chimneys:** Hipped roof. Interior end chimney in front projecting pavilion, pavilion has gable roof.

**Additional Architectural Description:**

**Facade:** Projecting 2 story rectangular-in-plan pavilion with shingle siding on first level and half-timbering effect of stucco and wood timber elements in second level. Heavy molded belt course on pavilion. Single bay, 1 story gable entrance porch with rectangular door and side lights. King-post trusses in gables of pavilion and porch.

**General:** Hipped roof has hip and shed wall dormer.

**Rear or East Side:** Steel exterior fire stair on north east side. Attached 1 story wing, section B.



**Map (Indicate North)**

See District Map

Alpine School (Borough Hall)  
Church Street (map#2)  
Alpine, Bergen, NJ  
P. Garbe, 10/82  
BCOCSHA  
View SE  
4 of 47



tem 7 The building is situated 30' east of Church Street. A paved circular drive passes from  
p. 6 this roadway directly in front of the building. A paved parking lot is located directly  
to the south and an exit road passes around the east, or rear, side of the building and  
continues on the north side of the building past additional parking spaces for officials  
to Church Street. About 20' east of the rear of the building is a 5 bay detached non-  
historic garage and bins for salt. A flag pole is located about 15' from the building on  
the north west side. 2 mailboxes are northwest of this. A wooden hinge sign close to  
Church Street reads "Alpine Borough Hall: Police Dept., Municipal Court, Post Office."

**SURROUNDING ENVIRONMENT:** Urban  Suburban  Scattered Buildings   
Open Space  Woodland  Residential  Agricultural  Village   
Industrial  Downtown Commercial  Highway Commercial  Other

**SIGNIFICANCE:**

The Alpine School Building is one of two pivotal structures in the "Upper Closter" or Alpine Historic District and it is the oldest extant building in the Borough erected for educational purposes.

The Alpine School building is important because it contributes to the unique ambience of the late 19th and early 20th century hamlet of "Upper Closter", while it continues to function as the civic center of today's Borough of Alpine. The school building is of true distinction in the Historic District since it has had a continuous public function, first as a school and then as the municipal office building.

The Alpine School is also significant for its architecture. Built in 1895, it is one of the few extant, relatively little altered examples of Queen Anne style educational architecture which have survived in Bergen County. The building displays the Queen Anne style's picturesque massing, variety of surface materials including exposed half-timber framing and decorative details such as kingpost trusses in gables and diamond pattern window sashes.

One of the more interesting aspects of the building is the fact that the second story interior space has been little altered through the years.

Built in 1895 in the Queen Anne style this building replaced an earlier, circa 1840 educational structure which was also located within the boundaries (continued)

**ORIGINAL USE:** Public School **PRESENT USE:** Borough Hall  
**PHYSICAL CONDITION:** Excellent  Good  Fair  Poor   
**REGISTER ELIGIBILITY:** Yes  Possible  No  Part of District   
**THREATS TO SITE:** Roads  Development  Zoning  Deterioration   
No Threat  Other  Demolition

**COMMENTS:** The Alpine School Building is threatened with demolition as the Borough Building Committee hopes to construct a new municipal facility on the site. This plan has received mixed reactions. A group of local citizens is actively promoting the rehabilitation and continued use of this structure, as many citizens consider the building to be a significant historical building.

**REFERENCES:**

1861: Hopkin's Wall Map: not shown.  
1976: Walker's Atlas, pl. 97: not shown.  
1891: Beer's Atlas, sect. 5: not shown.  
1902: Robinson's map: "School No. 3".  
1912: Bromley's Atlas, vol. I, pl.25; "Public School!"  
Bradley, S. W. Crossroads of History: The Story of Alpine, N. J.  
Alpine Bicentennial Committee, 1976.

**RECORDED BY:** Patricia Garbe  
**ORGANIZATION:** BCOC&HA

**DATE:** 2/9/84

Alpine School, Church Street, Alpine, Bergen Co., NJ

SIGNIFICANCE: (continued)

of the former hamlet, however outside of the present district. The nonextant building was labeled "School No. 16" on Beers Atlas of 1891, and was situated on the south side of Old Dock Road. The present edifice was School No. 3 (Robinson's Map, 1902) in Harrington Township and continued its educational functions until 1961, when a new school building was erected on a different site. Since that time the Alpine School building has continued as a public structure and it presently is the site of the Borough's post office, police department and municipal offices.

**HISTORIC NAME:** Alpine Community Church  
**LOCATION:** Closter Dock Road (north side);  
N.W. corner Old Dock Road  
**MUNICIPALITY:** Alpine  
**USGS QUAD:** Yonkers  
**OWNER/ADDRESS:** Alpine Community Church, Alpine  
Closter Dock Road, Alpine, N.J.

**COMMON NAME:** Alpine Community Church  
**BLOCK/LOT:** 47/2  
**COUNTY:** Bergen  
**UTM REFERENCES:**  
M E Church Zone/Easting/Northing  
07620

**DESCRIPTION**

1867 cornerstone laid  
**Construction Date:** 1871 completed & dedicated **Source of Date:** (Bradley History)

**Architect:** J. Cleveland Cady

**Builder:** Stephen Hyde

**Style:** High Victorian Gothic Revival

**Form/Plan Type:** rectangular with west  
transept arm

**Number of Stories:** 1

**Foundation:**

**Exterior Wall Fabric:** Native stone: hard blue igneous trap rock and soft gray and pink  
stone for trim.

**Fenestration:** 4x1

**Roof/Chimneys:** steeply pitched gables. West transept arm, hipped roof with flares  
and central gable dormer.

**Additional Architectural Description:**

**East Entrance:** Single bay projecting porch with steeply pitched gable roof and  
doorway with Gothic pointed arch with stone voussoirs (lighter color).  
Replacement double glass doors and wrought iron gate. 2 sets of 3  
lancet windows and rear door at N.E. end.

**South End of Main Facade:** 3 lancet windows with lighter stone voussoirs enframed by  
large Gothic arch whose voussoirs are lighter stone. Surmounted by  
single small lancet window in gable end and a cross. South east  
wall continues upward into a stone bell turret with pointed-arched  
opening and steeply pitched gable roof.

**North Side:** Large Gothic arch composed of lighter stone voussoirs enframes tri-  
angular composition of 2 lancet windows in base area and a large  
oriel window above. There is a smaller lancet window above (continued)

**Map (Indicate North)**  
See District Map



Alpine Community Church  
Closter Dock Road (map# 3)  
Alpine, Bergen, NJ  
P Garbo, 10/82  
BCOC&HA  
View N  
5 of 47

The Church occupies an impressive location upon a hillock on the N.W. corner of Closter Dock Road and Old Dock Road. The south side of structure is approximately 75' from Closter Dock Road and the east side approximately 25' from Old Dock Road. The church is physically the focal point in the Alpine Historic District.

**SURROUNDING ENVIRONMENT:** Urban  Suburban  Scattered Buildings   
Open Space  Woodland  Residential  Agricultural  Village   
Industrial  Downtown Commercial  Highway Commercial  Other

The Alpine Community Church is the focal point building and one of two pivotal structures in the Alpine Historic District.

**SIGNIFICANCE:**

The Alpine Community Church, a small edifice of high quality design, materials and workmanship, is significant in United States architectural history as the first known church designed by the New York City-based architect, J. Cleveland Cady. It is important to the architectural history of Bergen County as one of the two most important examples of Cady's work in Bergen County. Cady had strong Bergen County ties as he maintained a summer home here, in Alpine. His other outstanding building in the County is the Demarest Railroad Station (1872) at 20 Park Street in Demarest. Both are well-preserved examples of Cady's early work: the Alpine church shows his handling of the High Victorian Gothic Style with its emphasis on polychromy and picturesque massing, while the Demarest Station, reflecting the eclecticism of architectural practices in the mid and late 19th century, is in another style, the Romanesque Revival, and has this mode's round-arched openings as a major design motif. It is important in the architectural history of Alpine since it is the only extant ecclesiastical edifice in the Borough.

The church contributes to the knowledge of the early work and career of J. Cleveland Cady (1827-1919). Cady's office from 1864 was in New York City and his career continued throughout the last half of the 19th c. into the first quarter of the 20th century. His firms are best known today for their large buildings such as the Brooklyn Academy of Design (1866), the (non-extant) Peabody Museum at Yale, the wings of the Museum of (cont.)

**ORIGINAL USE:** Ecclesiastical  **PRESENT USE:** Ecclesiastical   
**PHYSICAL CONDITION:** Excellent  Good  Fair  Poor   
**REGISTER ELIGIBILITY:** Yes  Possible  No  Part of District   
**THREATS TO SITE:** Roads  Development  Zoning  Deterioration   
No Threat  Other

**COMMENTS:**

Due to heavy truck traffic along Closter Dock Road the stone work of the church has been damaged. It is presently being repointed.

**REFERENCES:**

Withey & Withey: Biographical Dictionary of American Architects, p. 104, 1970  
Schuyler, Montgomery: "The Works of Cady, Berg and See", The Architectural Record, vol. 6, 1897, pp 517-552.

Unpublished research of T. Robins Brown  
Bradley, S. W: Crossroads of History: The Story of Alpine, N. J., Alpine Bicentennial Committee, 1976

**RECORDED BY:** Pat Garbe  
**ORGANIZATION:** BCOC&HA

**DATE:** Dec. 2, 1982 Revised 2/8/84

ADDITIONAL ARCHITECTURAL DESCRIPTION: (continued)

near the apex of the gable and a very small turret on the north-west, west side of the gable.

West Side: Transept arm has a large central lancet window flanked by 2 pairs of smaller Gothic windows; main block: 2 sets of 2 lancet windows. Throughout there is a consistent use of lighter gray/pinkish stone for accenting: corner quoining, multiple belt courses, voussoirs surrounding all windows and doors and voussoirs enframing and as fill area of compositions of window groupings. Single piece brackets used for window lintels and sills on side windows.

Interior: Central aisle; 3 bays with dark-colored wooden trusses and cream-colored walls. Shallow recessed chancel with elliptical plan. Colored glass windows are products of the J. & R. Lamb Studios. The wood carvings were done by an artist named Kilson. Stephen Hyde, the local contractor who completed the church carved the pulpit from a large Butternut tree. The large Altar chair was hand carved by Alex Campbell. The Pipe organ was built in New York City in 1878 by the Hook & Hasting Organ Co. for the residence of Dr. F. Allen of New York. Dr. Timothy Allen gave it to the Alpine Church in 1899, in memory of Evelyn Nordhoff. The organ was refurbished in 1967 and the J. & R. Lamb Studio stained glasses were restored in 1977.

SIGNIFICANCE: (continued)

Natural History and the (non-extant) original Metropolitan Opera House in N. Y. C. However, Cady himself was a very religious man and extremely interested in church design. He made a reputation in the field of ecclesiastical architecture with his design for the Covenant Memorial Chapel of 1870 in N. Y. C. (now a N. Y. C. designated landmark), which was his first church design in N. Y. C. Throughout his career he continued to design churches and he also published articles on Church design. He was very active in religious organizations, serving as president of the National Federation of Churches and Vice President of New York City Missions.

Cady first visited Alpine in 1865 when he designed the Nordhoff estate house here (no longer extant). Following the close of the Civil War in that same year, a number of wealthy New Yorkers donated a substantial amount of funds for the construction of a new church in Alpine. Mrs. Charles Nordhoff cast the deciding vote to build in stone by offering to pay the architect's fees. Cady was commissioned and the plans were completed in 1866-67. He would not accept a fee for his services, doing it as a "labor of Love", and contributed the sum of \$385.92 to defray a large part of the cost of the stained glass windows from the J. & R. Lamb Studios. The corner stone of the Alpine Community Church building was laid October 2, 1867, however, insufficient funds delayed completion and dedication until August 17, 1871. Cady also designed his own summer home in Alpine by 1876, demolished for Palisades Interstate Park, and the extant Brewster House on the south side of Closter Dock Road, which is located outside the historic district in Alpine. Other extant buildings in Bergen County designed by Cady include: the Demarest Railroad Station (1872) at 20 Park Street, Demarest, the Allison Estate Coach House on the property of Saint Michael's Provincialate in Englewood Cliffs; and in Englewood: the altered Lyceum Building (1888) (Mid-Atlantic Bank) at 1 Engle Street, and alterations to the First Presbyterian Church (1884) at 150 East Palisade Avenue.

According to tradition the Alpine Community Church became universally known as "The Christmas Church" when Thomas Nast depicted the church on Christmas cards in the late 19th century.

Additional Photos: #6 & 7.

LIST OF PROPERTIES INCLUDED IN THE "UPPER CLOSTER"  
OR ALPINE HISTORIC DISTRICT, ALPINE, BERGEN COUNTY, NEW JERSEY

Map #	Address	Historic Owners Names Dates in ( )	Date Erected	Sig. to District / Streetscape	Description (use; style; stories; ext. wall fabric; fenestration; roof; major features; alterations; etc.)	Photo #
1	Cemetery Street (south side) Block 44 Lot 8	Gecox Family (1802-1850's)  Current owners: Various Owners Borough of Alpine Alpine, NJ 07620	early 19th century to present	M	Cemetery, an active cemetery is located on the south side of Cemetery Street and situated upon the western downward slope and crest of the Palisades. The entirety of the cemetery is clearly visible from the road. There are approximately 30 small to medium sized grave stones, slabs with rounded tops, dating to the 19th century as well as more recent stones. Members of the earliest local families in Alpine are buried here such as the Tavineres, Ver Valens, Van Scivers, Gecoxes, Pearsalls, Crums. Several stones have carved anchors, an association with marine occupations held by many of the 19th century residents of Alpine. Historically always a private cemetery, registered deeded sales of plots date back to the 1850's when Samuel Gecox was listed as the seller. Originally this property was acquired by the Gecox family in 1802. Presently the property is maintained by the Borough.	3
2	Church Street (East Side) Block 41 Lot 1	Alpine School (Borough Hall)  Current Owners: Borough of Alpine Church Street Alpine, NJ 07620	1895	P	See Individual Structure Survey Form.	4
3	Closter Dock Road (north side, N.W. Corner of Old Dock Road) Block 47 Lot 2	Alpine Community Church  Current owners: Alpine M.E. Church Closter Dock Road Alpine, NJ 07620	1866-1871	P	See Individual Structure Survey Form.	5 6 7

Map #	Address	Historic Owners Names Dates in ( )	Date Erected	Sig. to District/ Streetscape	Description (use; style; stories; ext. wall fabric; fenestration; roof; major features; alterations; etc.)	Photo #
4	Closter Dock Road (north side) Block 47 Lot 1	P. Anthony House (1876)  Current owners: Peter & Audrey Urban Closter Dock Road Alpine, NJ 07620	c. 1860's with c. 1890 modifications	F	House; Vernacular with Queen Anne modifications; 2½; shingle and replacement aluminum siding; 4 x 2, 2½; central gable; Queen Anne wraparound porch with turned posts and scroll brackets, c. 1890's; panelled glazed entrance door with rectangular transom, patterned shingle and Palladian window in central gablet c. 1890's, angled west corner. Multiple additions (c. 1890's) at north (rear side) of building. To north and rear are 2 detached outbuildings and a privy.  The house is nicely sited on a large piece of property next to the church. It is likely this is a mid 19th century (c. 1860's) house enlarged and embellished at the turn-of-the-century. Although partially resided and with rear additions the building retains its basic turn-of-the-century appearance.	8 9 10 11
5	Closter Dock Road (north side) NE corner Main Street Block 47 Lot 10	Anthony House  Current owners: Jonathan & Linda P. Filley Closter Dock Road Alpine, NJ 07620	c. 1900 Mid-20th c. alterations and enlarge- ments	F	House; Vernacular; 2½; replacement aluminum; 4x2, 6/6; gables. Integrity of this house has been extremely altered by the addition of an east wing and west wing (2 car garage), Replacement aluminum siding, doors, etc. Original location was closer to the street and moved to present location in the early 20th century. Although altered this house has historical significance in the District because it housed the Borough Hall during the early 20th century. A recent occupant was Brian Garfield, author of <u>Death Wish I, II, III.</u>	12
6	Closter Dock Road (north side) NW corner Main Street Block 44 Lot 5	Current Owners: James & Dorothy McClain Closter Dock Road Alpine, NJ 07620	1961	Ic	House; Split Level; 1-1½; brick and wood shingles; 4x2, 6/6; gables; 2 car garage under E. side.	13



Map #	Address	Historic Owners Names Dates in ( )	Date Erected	Sig. to District/ Streetscape	Description (use; style; stories; ext. wall fabric; fenestration; roof; major features; alterations; etc.)	Photo #
7	Closter Dock Road (north side) Block 44 Lot 4	O. Jordan House (1876) Current owners: Joseph Ellicott Closter Dock Road Alpine, NJ 07620	mid 19th c. early 20th c. additions	M	<p>House; Vernacular Downingesque with Colonial Revival addition; 1½; clapboard and shiplap (pavilion); east section: 3 bays, west section: 3 bays including 2 bay pavilion: 6/6, eyebrows in east wing; 3/3; east section: gable, west section gable and pavilion gambrelletta projecting off-center. Pavilion has gambrel-end facing street, wraparound porch with square columns. Panelled entrance door with sidelight and heavy architrave trim. <u>East wing:</u> paired brackets on cornice, compatible 1 bay addition with exterior chimney is a 20th c. addition. <u>West wing:</u> compatible mid 20th c. addition on west side of pavilion.</p> <p>Obadiah Jordan was a descendant of the French Huguenot Joseph Jordan, who came to this country with the Marquis de Lafayette. Obadiah resided in this house in 1876, and he owned a sloop the GRATITUDE, which was engaged in the business of hauling trap rock from the quarries along the Palisades across the Hudson River to New York. The mid 19th century house received an attractive gambrel roofed west addition in the early 20th century.</p>	14
8	Closter Dock Road (north side) Block 44 Lot 3	Jas. Older House (1876) Current Owners: Joseph & Celia Oriscak Closter Dock Road Alpine, NJ 07620	between 1861 and 1876	F	<p>House; Vernacular Downingesque; 2½; replacement aluminum siding; main block: 3x2, 2/2; gable; 3 bay porch with square posts and elaborate scroll brackets, Federal Revival style panelled door with elliptical fanlight. Elliptical window in east side gable end, large west wing and a smaller east wing. Detached 2 car garage to N.E. (rear) of structure. In 1983 a 2 car garage was added to the west and is attached to the main house by a 1 story connector.</p> <p>This 3 bay house with charming mid-19th century picturesque porch and hilltop setting contributes to the historic ambience of the District. Alterations such as aluminum siding and the recent 2 car garage on the west side of the house appear to be reversible.</p>	15

Map #	Address	Historic Owners Names Dates in ( )	Date Erected	Sig. to District/ Streetscape	Description (use; style; stories; ext. wall fabric; fenestration; roof; major features; alterations; etc.)	Photo #
9	Closter Dock Road (north side) Block 44 Lot 2	Current owners: Emanuel & Josephine B Eschwege P.O. Box 422 Ship Bottom, NJ 08008	c. 1960	Ic	House; Raised Ranch; 1; brick and wood shingle; 4x2, 6/6; hip and gable; 2 car garage under west side of house	16
10	Closter Dock Road (NE corner of Forest Street) Block 44 Lot 1	Current owners: Delores Del Rosso Closter Dock Road Alpine, NJ 07620	c. 1890's	F	House; Vernacular Queen Anne; shiplap; 1st story: 3 bays second: 2, irregular, 2/2; gables with shed west wing; L-shaped plan with small west and north wings, 2 bay porch with 2 entrance doors, shingle pattern on west gable.  Set well back from Closter Dock Road on a heavily wooded lot, this unpretentious house has irregular massing and decorative shingles in the gables of the Queen Anne style.	17
11	Closter Dock Road (south side) Block 42 Lot 3	J. Du Bois, Store and Post Office (1876) (Terrace Realty)  Current owners: William M. & John R. Robertson Box 922 Alpine, NJ 07620	c. 1870	M	In 1876, store and post office, presently real estate office; Vernacular Second Empire; 2½ with 2 story east wing; clapboard; main block: 3x2, 2/2, east wing: 2x2, 1/1; main block: mansard with gable dormers, east wing: hip; <u>Main Block</u> : 2 bay porch with altered plain posts, 2 entrance doors and 2 store windows, sign attached to porch reads "Terrace Real Estate." Main block is the original structure. Has lost exterior decorative details, retains gable dormers with paired windows, dormer sash is replacement. <u>Wings</u> : a large east and south wing are later additions.  The J. Du Bois Store and Post Office building is an example of the Second Empire style of architecture. It is important as an early commercial building which housed a general store. The Alpine post office was located here from 1871 until 1926, and the first telephone in the community was installed here.	18

Map #	Address	Historic Owners Names Dates in ( )	Date Erected	Sig. to District/ Streetscape	Description (use; style; stories; ext. wall fabric; fenestration; roof; major features; alterations; etc.)	Photo #
12	Closter Dock Road (south side) Block 42 Lot 2	Charles DuBois House (?) Current owners: Spyridon & Irene Kateris Berkeley Place Alpine, NJ 07620	appears c. 1930, may incorporate older building	C	House; Vernacular, 20th c. English Cottage Revival modifications; east section: 2, west section 2½; east section: recent cedar shakes, west section: brick; east section: 1x2 bays, 6/6, west section: 2x2 bays, multipaned casement windows; east section: gable, west section: gable with central gable; west section: side cylindrical entrance pavilion with stone voussoirs and conical roof, elliptically-arched door, stepped exterior chimney. East side: gable roof with catslide and small south wing, paired windows.	19
13	Closter Dock Road (south side, SW corner DuBois Ave.) Block 43 Lot 7&8	Early 20th c. (after 1912) Current Owners: Phillip & Marilyn Gianuzzi 11005 Richlyne St. Temple Terrace, Fla. 33617	c. 1915	F	House; American Foursquare; 2½; replacement aluminum siding; 3x2, 6/1; hip with hip dormers, wraparound porch with early 20th c. Doric columns. This house which is the most recently erected historic house included in the District represents a house-type popular throughout the United States in the early 20th century, the cubic American Foursquare. It is compatible in scale with the other houses in the District. The recent aluminum siding is probably reversible.	20
14	Closter Dock Road (south side, opposite Main Street) Block 43 Lot 6A-B-C	Current owners: William & Elsie B. Hille Closter Dock Road Alpine, NJ 07620	c. 1890's	F	House; vernacular Queen Anne; E. wing: 1½, west: 2; replacement wood shingles; 3x2, 6/6; gables; 2 bay porch with Queen Anne turned posts. Added oriel window in west side of facade, added exterior chimney.  This house was recently re-sided with wood shingle covering its clapboard siding and an interesting shingle pattern in the main gable. This alteration is probably reversible.	21 & 22
15	Closter Dock Road (south side) Block 43 Lot 5	Current owners: Alexander J. Smith Forest Street Alpine, NJ 07620	post WWII	C	House; Cap Cod; 1; wood shingles; 3x2, 1/1 and 6/6; gable; central gable projecting entrance portico on facade side.	23

Map #	Address	Historic Owners Names Dates in ( )	Date Erected	Sig. to District/ Streetscape	Description (use; style; stories; ext. wall fabric; fenestration; roof; major features; alterations; etc.)	Photo #
16	Closter Dock Road (south side) Block 43 Lot 4	Current owners: Robert & John McCaffrey 31 McCain Court Closter, NJ 07624	c 1890's	F	House, now commercial; vernacular with Queen Anne style elements; 2½; clapboard; 3x2, 2/2; gable; 3 bay porch with replacement plain posts and spingle or splat frieze. Shingle pattern in gable end. Sign in front of property reads "Alpine Garden Shop."  This house is compatible in scale with other houses and contributes to the rural ambience of the district.	24
17	Closter Dock Road (south side) Block 43 Lot 3	Current owners: Harold Duncan & Barbara W. Shaw Box 105 Alpine, NJ 07620	early 20th c.	F	House, presently real estate office; vernacular; 2½; stucco or cement; 3x1, 6/1; shed gable; lower level: double glass sliding entrance doors. Large 1 story gable-roofed rear, or south, wing. 2 hinge signs: 1st story reads "McNerny, Talmo, Real Estate," 2nd story sign, "Duncan Snow Heating and Cooling."  This stucco covered frame structure is compatible in scale with the rest of the District and probably was at one time a residence. Recent alterations to the 1st level of the facade have not affected the early massing of the structure.	25
18	Closter Dock Road (south side, SE corner Church St.) Block 43 Lot 1	Texaco Gas Station Current Owners: Phillip & Marilyn Gianuzzi 11005 Richlyne St. Temple Terrace, Fla. 33617	c. 1950, re- modelled 1970's (formerly Shell)	Ic	Gas station, Commercial; 1; stone; 3 bays, 2 bay garage; mansard with dormers. Central island with 3 pumps.  This building is intrusive and does not contribute to the District. Recently remodelled the building has operated as a gas station since about 1950.	26
19	Closter Dock Road (south side, SW corner, Church St.) Block 55 Lot 12	Mrs. M. Campbell House (1876) D. Dutcher (1902)  Current owners: Mark E. Wellington Closter Dock Road Alpine, NJ 07620	c. 1876	F	House; vernacular; 1½; replacement synthetic siding; 3x1. 2/2; gables; 2 bay porch with gablet over entrance, L-shaped south wing has recently added unit on roof for solar heat.  This modest residence is compatible in scale, massing and design with the other houses in the District and contributes to its historic character.	27

Map #	Address	Historic Owners Names Dates in ( )	Date Erected	Sig. to District/ Streetscape	Description (use; style; stories; ext. wall fabric; fenestration; roof; major features; alterations; etc.)	Photo #
20	Forest St. (north side corner of Ridge St.) Block 60 Lot 13	Byvell House (1876?) Hotel (1913)  Current owners: Lestrino & Aurora Baquiran Anderson Avenue Alpine, NJ 07620	c. 1870's	M	House, originally and presently, shown as a hotel on Bromley's 1913 Atlas; Second Empire; 2½; clapboard; main block: 3x2, 2/2; mansard with hexagonal slates and patterning, gable dormers. Large altered wraparound porch (4 bays in front) with side steps and entrance, panelled entrance door with glazed top, brackets under eaves and pronounced label mouldings on windows. Added north wing is compatible, 3 detached outbuildings to the north and east.  This well preserved example of a Second Empire style house functioned as a hotel in the early 20th century. The house and its 3 frame outbuildings contribute to the historic character of the district.	28, 29, 30
21	Forest St. (north side) Block 60 Lot 12	J. Van Sciver House (1876)  Current owners: Robert & Judith B. Bantz Forest Street Alpine, NJ 07620	pre 1876	C	House; vernacular; 2; replacement aluminum; 2x1, 6/6; gable with catslide in rear over north wing; added projecting gable entrance portico. Recent east wing is an attached 2 car garage. Unsympathetic aluminum siding, shutters and window sash. Small freestanding structure to north or rear of building  Although altered this residence retains its earlier massing and is compatible in scale with the other modest-sized houses in the District.	31
22	Forest St. (north side) Block 60 Lot 11	Anthony House (1876)  Current Owners: Jerry J. & Irma K. Bonnabel Cassandra Alpine, NJ 07620	c. 1870's	F	House; vernacular Downingesque; replacement aluminum; 3x2, 2x2; gables; L-shaped with 2 bay front porch with turned posts, door with rectangular transom. Replacement aluminum siding.  This house is compatible in style and scale with the other modest-sized houses in the District. Recent aluminum siding is probably reversible.	32

Map #	Address	Historic Owners Names Dates in ( )	Date Erected	Sig. to District/ Streetscape	Description (use; style; stories; ext. wall fabric; fenestration; roof; major features; alterations; etc.)	Photo #
23	Forest St. (north side) Block 60 Lot 10	Mrs. Conklin (1876)  Current Owners: Esther Davldwitz & Mitch Stephens Forest Street Alpine, NJ 07620	c. 1870's	F	House; vernacular; 2-2½; wood shingles; 2x2, varied fenestration; gable with steeply pitched gablet. Replacement window sash, oriel window on west side. Altered enclosed front porch.  Although altered, this house retains its original massing and modifications such as siding and the enclosed porch are reversible. It retains enough of its historic fabric and is compatible in scale with the other houses in the District.	33
24	Forest St. (north side, NE corner of E. Main St.) Block 60 Lot 9	1876: not shown  Current owners: Robert & Bertha Perringer Dogwood Lane Alpine, NJ 07620	c. 1880's (?) or 1890's	F	House; vernacular Italianate; 2; replacement shingles; 3x1; 1st story: 6/6; second story: 2/2; low pitched; plain frieze, Queen Anne Style wraparound porch with turned posts.  This charming modest-sized residence is sited on a large piece of wooded property and contributes in scale and massing to the rural ambience of the historic hamlet.	34
25	Old Dock Rd. (north side) Block 60 Lot 18	1861: shown 1876: not shown  Current owners: Thomas W. McCaffrey 31 Mc Cain Court Closter, NJ 07624	c. mid 19th century	F	House; vernacular; 1½ with 1 story wing; synthetic shingles; main block: 2x2, east wing: 1x1, 6/6; gables; 2 bay porch with stick brackets. Porch has cobblestone foundation. Later east wing. Detached garage to NW or rear of house.  This house, situated along the old road which leads to the port below the cliffs, with its diminutive size and picturesque porch contributes to the historic character of the District. Its unsympathetic synthetic siding can be removed.	35

Map #	Address	Historic Owners Names Dates in ( )	Date Erected	Sig. to District/ Streetscape	Description (use; style; stories; ext. wall fabric; fenestration; roof; major features; alterations; etc.)	Photo #
26	Old Dock Rd. (north side) Block 60 Lot 17-A	1861: shown Mrs. Tavinere (1876)  Current owners: Mildred de Martini 500 Priscilla Lane Englewood, NJ 07631	early 19th c.	M	House; Vernacular Greek Revival; 1½; replacement clapboard; main block: 3x1, 6/6, east wing: 2x2, 2/2; gables; 2 bay porch on front of main block and another on east wing, both appear modified and have plain square posts. Both blocks have entrance doors and 2 eyebrow windows on upper level. East and 2 north wings are later additions. 2 car detached garage to north of house.  This little altered example of the Greek Revival style house is one of the earliest houses constructed in the District. Located along the Old Dock Road it contributes to our knowledge of the early development of the hamlet.	36
27	Old Dock Rd. (north side) Block 60 Lot 16	Mrs. Tavinere (1876)  Current owners: Edgar L. Boeck 265 Riverside Dr. Fort Lee, NJ 07024	c. 1870's	M	House; vernacular Italianate; 2; clapboard; 3x3, 6 panes throughout; low pitch, 3 bay porch with plain square posts with spindle frieze, bracketed cornice. Door flanked by pilasters and sidelights, north wing addition.  This well preserved and little altered modest sized house contributes to the historic rural ambience of the District.	37
28	Old Dock Rd. (north side) NE corner of Ridge St. Block 60 Lot 15-A	Current owners: Wm. A. Robinson & Dora Tellier 443 Homans Ave. Closter, NJ 07624	c. 1960's	Ic	House; Split level; 1-2; Cedar shakes and brick; 4x2; Casement; hip and gable roof, 3 car garage under west side of house.	38
29	Old Dock Rd. (west side) Block 47 Lot 3-B	Gecox (1861) Gecox (1876)  Current Owner: David M., Jr. & Sara C. Reeves Ridge St. Alpine, NJ 07620	c. 1860	M	House; vernacular Italianate; south wing: 1½, north wing: 2, west wing: 2; replacement aluminum; south wing: 3x2, north wing: 2 bays, 2/2; gables with paired brackets; north wing has large eyebrow windows and may be earlier, large sympathetic addition to west side of north wing. Detached barn to west of structure appears late 19th century.	39,40 outbuilding 198 44-36A

Map #	Address	Historic Owners Names Dates in ( )	Date Erected	Sig. to District/ Streetscape	Description (use; style; stories; ext. wall fabric; fenestration; roof; major features; alterations; etc.)	Photo #
29 (con't)					The Gecox family was one of the earliest settlers and residents of the Historic District and they at one time owned the land of the nearby cemetery. The house, built before 1861, still retains its basic mid 19th century appearance. It contributes to our knowledge of the early historic development, and combined with a detached remodelled barn, enhances the rural ambience of the District. The recent aluminum siding is reversible as decorative elements such as friezes and brackets were not removed.	
30	Old Dock Rd. (west side) Block 47 Lot 3-A	Current Owner: Hak Soo & Jin Ae Kim Old Dock Road Alpine, NJ 07620	c. 1980	C	House; Bi-level; 2; brick and aluminum siding; 4x2, 6/6 and 8/8; gable. 2 car garage south side of front, raised 3 bay porch.	41
31	Ridge St. (east side) Block 60 Lot 15	Mrs. Tavinere (1876)  Current Owners: Stephen E. Cohen Lucinda Beuhler Closter Dock Road Alpine, NJ 07620	between 1861-1876	M	House; Downingsque; 2½; clapboard; 3x2, 2/2; gable, 3 bay porch south side with square posts and brackets; panelled entrance door, added east and north wings, lace-like decorative vergeboard with large central drop.  The well-preserved Tavinere House is the best example of the picturesque Downingsque style of architecture in the District. The rather elaborate vergeboard or gingerbread trim is a charming contribution to the rural ambience of the historic hamlet. The Tavineres were another early family to settle here.	42
32	Ridge St. (east side) Block 60 Lot 14	Jno, Ferdon (1876)  Current Owners: Ralph A. & Michele Vierno 152 Cranberry Road Princeton Junction, NJ 08550	c. 1870's	M	House; vernacular Second Empire; 1½; shiplap siding; 3x2, 2/2; mansard; 2 bay porch with simple brackets, double gable dormer; added exterior end chimney west side, rear wing on north side. 19th c. freestanding structure to north; recent 2 car garage to north east.  The diminutive Ferdon House is the smallest example Second Empire style building in the District. This cottage, with its early detached frame outbuilding, contributes to the District's historical character.	43 outbuilding 44



Map #	Address	Historic Owners Names Dates in ( )	Date Erected	Sig. to District/ Streetscape	Description (use; style; stories; ext. wall fabric; fenestration; roof; major features; alterations; etc.)	photo #
33	Ridge St. (west side) Block 47 Lot 4	1876: not shown Henry Clay Frick II Closter Dock Road Alpine, NJ 07620	c. late 19th century	F	House; vernacular Queen Anne; 2½; clapboard; 3x2, 1/1; gable; 3 bay porch with turned posts, panelled and glazed door. Square window in gable end, northeast wing, Oriel window on south side. Detached garage to northwest of house.  This house is compatible in scale and materials with the other historic houses in the historic District.	45
34	Ridge St. (west side, SW corner Forest St.) Block 47 Lot 5	1876: not shown  Current Owners: Peter S. & Meredith E. Hallowell Ridge St. Alpine, NJ 07620	c. late 19th century	F	House; vernacular; 1½; replacement aluminum siding; Irregular; lower level: 6/6, upper: 2/2; gables. Wrap-around porch, multiple additions and enlargements; replacement window sash and siding. Detached garage to west with entrance on Forest Street.  In spite of considerable alterations and additions the early massing of this house is visible from the exterior and this building illustrates how a small cottage was enlarged during its continuing construction history.	46
35	School House Lane (south side) Block 41 Lot 4	Current owners: Henry & Ellen Cox School House Lane Alpine, NJ 07620	c. 1890	M	House; Downingsque/Queen Anne; 2½ clapboard with decorative shingling in gable; main block: 3x2; 2/2; gables. Wrap-around Queen Anne porch with turned posts, L-shaped plan, imbricated and diamond shingle pattern in gable end and belt course, scallop-shaped vergeboard trim.  This well preserved residence combines stylistic elements of both the picturesque Downingsque and Queen Anne styles.	47

**United States Department of the Interior  
National Park Service**

**National Register of Historic Places  
Inventory—Nomination Form**

For NPS use only  
received  
date entered

Continuation sheet Alpine Historic District, Alpine  
Borough, Bergen County, NJ Item number 8

Page 1

future hamlet. The vicinity of the Historic District was referred to as "Closter Mountain" in 19th century deeds, and was commonly known as "Upper Closter," because of its location on the high ridge above Closter Village, which was about two miles to the west.

In the last half of the 19th century two major trends were responsible for attracting population to the area of Alpine and for the initial growth of the Historic District. By the mid-19th century rock quarrying of the Palisades cliffs was becoming a lucrative business and quarries proliferated along the river during the remainder of the 19th century. The rustic settings and breathtaking vistas of the Palisades ridge were also being discovered by New Yorkers as a place for a healthful summer reprieve from the heat of the crowded city. Beginning in the mid 1860's wealthy and prominent New York businessmen built large estate houses atop the Palisades near the District. During this time the District developed as a linear settlement on the crest of the Palisades and it became a small residential, religious, commercial and civic center for the surrounding area. The majority of the modest houses there were constructed during the last half of the 19th century for people involved in marine activities or quarrying or for those employed in service occupations at the large estates.

According to Hopkin's Map of 1861 (Map VII), there were about fourteen buildings in the area of the hamlet, including non-extant store and school buildings. At this time the Gexoc and Tavinere families owned considerable land within the District. Included among the modest-sized houses from the pre-Civil War period is a 1½ story local interpretation of the Greek Revival style, one of the Tavinere Houses on Old Dock Road (map #26). Probably built before 1850, the small second-story eyebrow windows are characteristic local Greek Revival elements. The Gecox House (map #29), also on Old Dock Road, is a circa 1850 vernacular interpretation of the Italianate style, with characteristic blocky massing, a low pitched roof, and cornice brackets. The Gecox family originally owned the property upon which the cemetery (map #1) is situated and by the 1850's were selling private cemetery plots.

From 1866 to 1871, the District's most architecturally distinguished building, the Alpine Community Church edifice, was built funded by estate owners (Map #3). In 1866 a young New York City architect, J. Cleveland Cady, designed the High Victorian Gothic Revival style building which he modelled after small rural English country churches. The building is impressively sited and with its tall, gable turret, is the visual focal point of the District. By combining local hard blue igneous trap rock with a soft gray stone to accent trim areas Cady achieved attractive polychromy. Cady, a very religious man, was extremely

**United States Department of the Interior  
National Park Service**

**National Register of Historic Places  
Inventory—Nomination Form**

For NPS use only

received

date entered

Alpine Historic District, Alpine  
Continuation sheet Borough, Bergen County, NJ Item number 8

Page 2

interested in designing ecclesiastical buildings and with the design of the Covenant Memorial Chapel in New York City in 1870 became one of the United States' leading designers of churches. The Alpine Community Church building is significant in architectural history as the first known ecclesiastical edifice designed by him. Cady's practice was not limited to churches and some of his firm's later projects include the non-extant Metropolitan Opera House and the Romanesque Revival wings of the Museum of Natural History. Cady had strong ties to Alpine as he maintained a (non-extant) summer estate here on the crest of the Palisades.

References to the District as "Closter Mountain" or "Upper Closter" were abandoned in the late 19th century. The name Alpine was adopted in 1870 when the post office was first established here. In 1871 the post office was moved to the Second Empire style J. Du Bois store building at the juncture of Closter Dock and Old Dock Roads (Map #11). The area is referred to as "Alpine P.O." in Walker's 1876 Atlas (Map VIII) and was described as a "hamlet in Harrington Township." By this time there were about seventeen buildings in the District, including houses, a general store with post office, the church, and the cemetery. A non-extant school house was located in the hamlet but outside the present boundaries of the Historic District. Houses built during the 1860's and 1870's continued to be modest in size and vernacular in design. Several houses and the store building have the mansard roof and square cubic massing of the Second Empire style (map #11, 20, 32). The early section of the Older House (map #8) with picturesque porch scroll brackets and a Tavinere House (map #31) with elaborate decorative verge-board trim, are examples of the romantic Downingesque style. Walker's 1876 Atlas (Map VIII) also shows that one of the houses on Closter Dock Road was owned by Obidiah Jordan (map #17). Obidiah owned a sloop, the GRATITUDE, which was engaged in the business of hauling trap rock from the quarries along the Palisades across the Hudson River to New York. The earlier section of his house probably dates to soon after the mid 19th century. The house received an attractive gambrel roofed west addition with porch during the early 20th century.

Several of the houses of later construction dates, circa 1880's-1890's, employed the shingle patterning and porches common to the Queen Anne style (map #4, 10, 14, 35). In 1895 a new Queen Anne style school edifice was built on Church Street (map #2), and it remains the oldest extant building in Alpine erected for educational purposes. The school is of true distinction in the District as it is the only building there which has had a continuous public function, first as a school and then as the municipal office building. It is also one of the few relatively little altered examples of Queen Anne style educational architecture which have survived in Bergen County.

**United States Department of the Interior  
National Park Service**

**National Register of Historic Places  
Inventory—Nomination Form**

For NPS use only  
received  
date entered

Continuation sheet Alpine Historic District, Alpine Borough, Bergen County, NJ Item number 8 Page 3

In 1903 the Borough of Alpine was formed from greater Harrington Township and the District continued to function as the religious, civic and commercial center of the newly created municipality. By the time Bromley published his 1912 Atlas (Map XI), there were 24 principal buildings within the boundaries of the present District. This atlas shows that the large mansard-roofed Second Empire style former residence on Forest Street (map #20) was operating as a hotel. It is known that the area of Alpine was becoming a popular summer resort area for middle class New Yorkers during the early 20th century. The Yonker's Ferry operated from the Former Upper Closter Landing until the 1930's and the automobile afforded additional accessibility. In the late 19th century the Palisades were threatened with annihilation by the increased blasting of the rapidly multiplying rock quarries. The Palisades Park Commission was created in 1900 to insure the survival of the Palisades. Sponsored by the states of New York and New Jersey this commission purchased 14 miles along the Hudson River between Fort Lee, New Jersey, and Piermont, New York, from 1900-1909. With the purchase of the waterfront for the park the undercliff settlements and quarrying operations were abandoned. By the 1930's the Palisades Interstate Park Commission had confiscated the property of the large estates on the crest of the Palisades and had begun to systematically demolish these mansions. The Alpine hamlet ceased being the service community to the estates and a residential neighborhood for persons with quarry and marine interests. The Borough of Alpine lost population. The 1910 U.S. Census recorded a population of 377 persons for the entire Borough. The population declined to 350 persons in 1920. Only about two buildings were erected in the District in the early 20th century.

The present appearance of the District to a large degree was established before 1930. While individual buildings have been modified and some recent buildings erected, the District as a whole maintains its early 20th century character. It also continues to be the civic, religious, and commercial center of the Borough of Alpine. The Borough is now a residential area which in 1980 had a population of 1,549 and in 1979 had the highest average gross income for homeowners in Bergen County.

**United States Department of the Interior  
National Park Service**

**National Register of Historic Places  
Inventory—Nomination Form**

For NPS use only

received

date entered

Continuation sheet Alpine Historic District, Alpine  
Borough, Bergen County, NJ Item number 9

Page 1

Bibliographical References

Maps and Atlas

- Aug., 1778 Captain John Watkins. Map made for General Washington. Map No. 26, part 3.
- 1839 U.S. Coast Survey Map No. 96, Surveyed by J.A. Jenkins. Map at the Office of Cultural and Historic Affairs. Original in Archives of the National Oceanographic Survey, U.S. Department of Congress, Rockville, Maryland.
- 1861 G.M. Hopkins. Map of the Counties of Bergen and Passaic, New Jersey. Philadelphia: G.H. Corey.
- 1876 A.H. Walker, compiler. Atlas of Bergen County, 1776-1876. Plate 97. Reading, P.A.: C.C. Pease.
- c. 1891 Frederick W. Beers. Atlas of Hudson River Valley from New York City to Troy, New York. Section 5. Watson and Co.
- 1902 D. Robinson, compiler. Map of Bergen County, New Jersey with a portion of Passaic County and New York. E. Robinson and Co.
- 1912 George W. and Walter S. Bromley. Atlas of Bergen County, New Jersey. Vol. I, Plate 25. Philadelphia: G.W. Bromley and Co.

Books and Miscellaneous

- 1976 Bradley, Stanley. Crossroads of History: The Story of Alpine, New Jersey. Alpine Bicentennial Committee, Harrington Press, Harrington Park, New Jersey.
- 1971-present Brown, T.R. Ongoing unpublished research on J. Cleveland Cady.
- 1897 Schuyler, Montgomery. "The Works of Cady, Berg and See." The Architectural Record, Vol. 6, pp. 517-552.

**United States Department of the Interior  
National Park Service**

**National Register of Historic Places  
Inventory—Nomination Form**

For NPS use only  
received  
date entered

Continuation sheet Alpine Historic District, Alpine  
Borough, Bergen County, NJ Item number 9

Page 2

- 1975                      Spring, John.      "The 1776 British Landing at Closter."  
                                 Bergen County History, 1975 Annual, The Bergen Historical  
                                 Society, pp. 27-42. River Edge, New Jersey.
- 1970                      Withey, H.F. and E.R.      Bibliographical Dictionary of  
                                 American Architects (Deceased), p. 104. Hennessy and  
                                 Ingalls, Inc., Los Angeles, California.

Alpine, Bergen Co., N. J.

post WW II houses

vacant land

recent houses, large lots

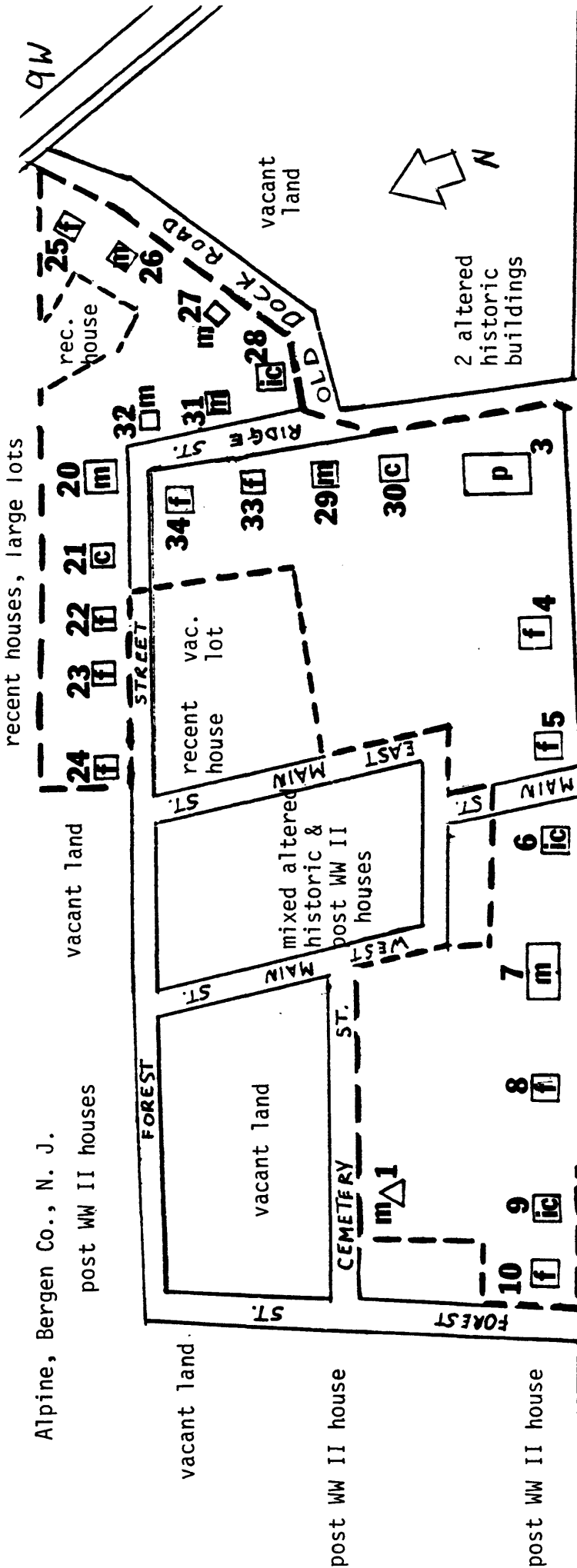

**KEY**

- p** = PIVOTAL
- m** = MATRIX
- f** = FILLER
- c** = COMPATIBLE
- ic** = INCOMPATIBLE

"Upper Closter" or Alpine Historic District.  
 Numbers refer to properties. Dashed line is District boundary. Notations adjacent to District boundaries indicate land use and character of buildings. Not to scale. 1984.

MAP III

HARING

recent houses

DUBOIS

SCHOOL HOUSE

CLOSTER DOCK ROAD

STREET

FOREST ST

CEMETERY ST

MAIN ST

EAST ST

MAIN ST

CHURCH ST

SCHOOL

HOUSE

AVENUE

LANE

RIVER ST

OLD DOCK ROAD

9W

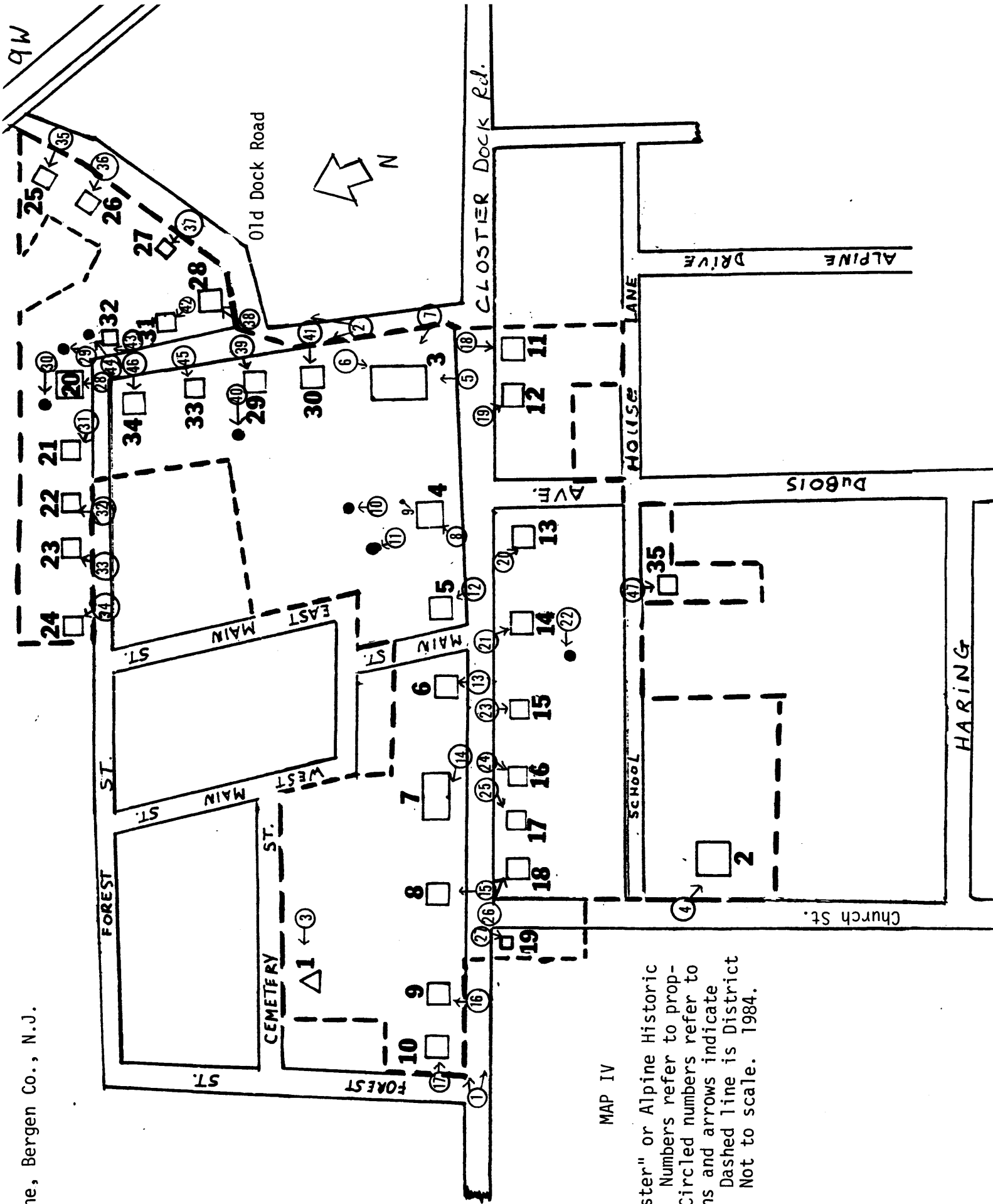

MAP IV

"Upper Closter" or Alpine Historic District. Numbers refer to properties. Circled numbers refer to photographs and arrows indicate the view. Dashed line is District boundary. Not to scale. 1984.



"Upper Closter" or Alpine Historic District  
Alpine, Bergen Co., N.J.

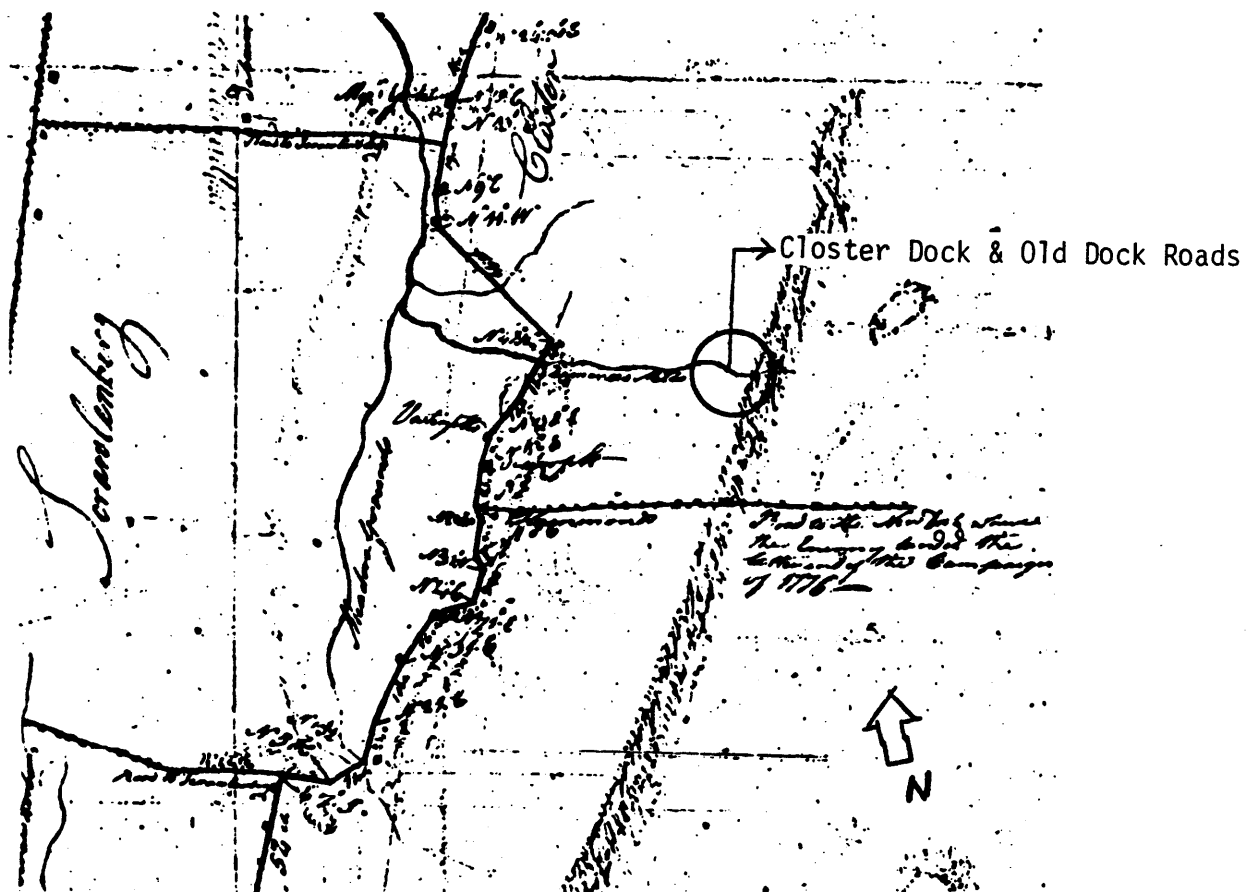

MAP V

Detail of Alpine area xeroxed from Revolutionary Period Map, # 26, part 3, surveyed by Captain John Watkins, August, 1778. The added circle indicates the general area of the "Upper Closter" or Alpine Historic District at the crest of the Palisades. Copied from Bergen County History, Annual 1975, p.28.

"Upper Closter" or Alpine Historic District  
Alpine, Bergen Co., N.J.

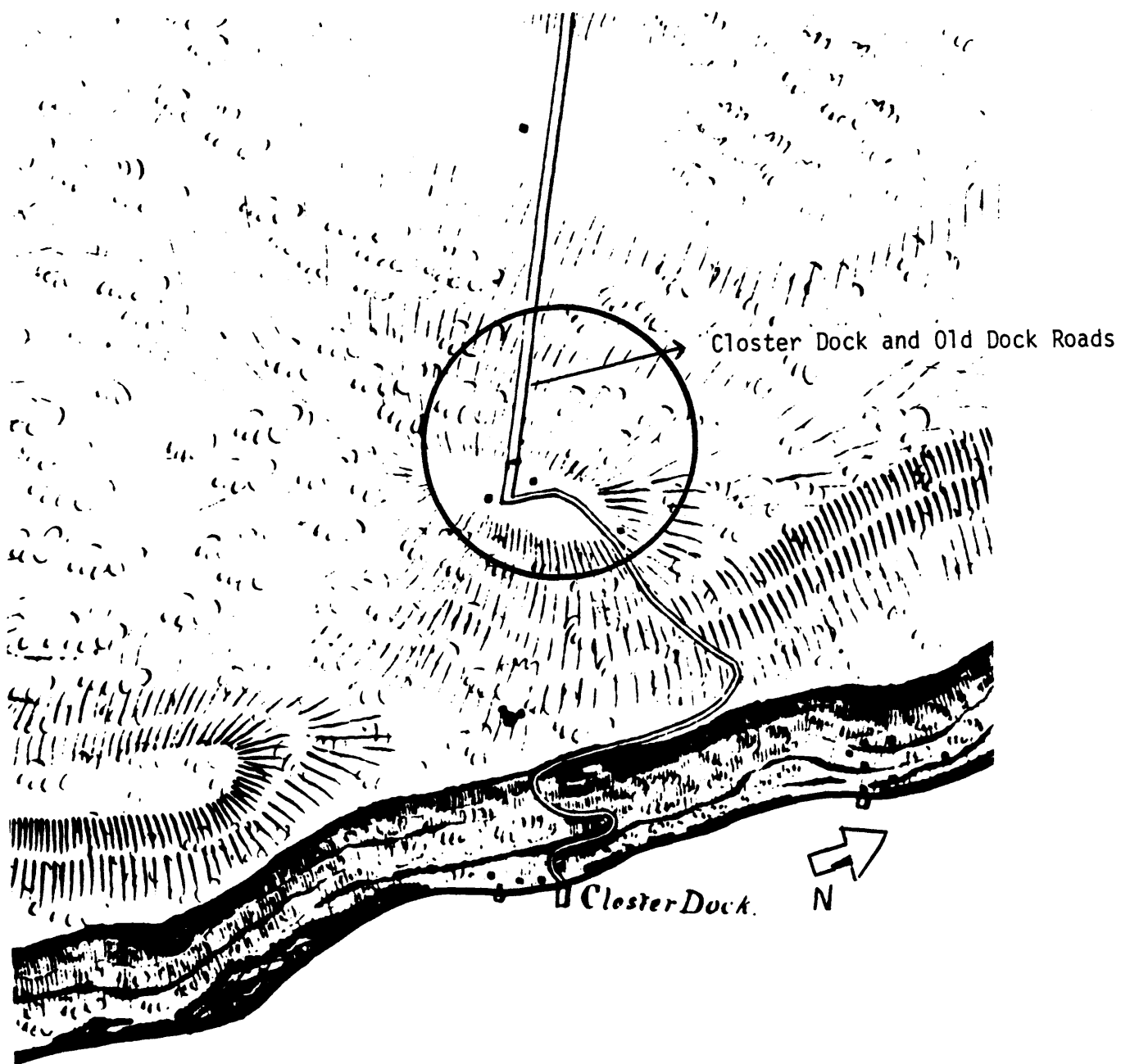

MAP VI

Circle indicates the area of the "Upper Closter" or Alpine Historic District in 1839. U.S. Coast Survey Map # 96, surveyed by J. A. Jenkins. Map at Office of Cultural and Historic Affairs. Original in Archives of National Ocean Survey, U.S. Department of Commerce, Rockville, Maryland.

"Upper Closter" or Alpine Historic District  
Alpine, Bergen Co., N.J.

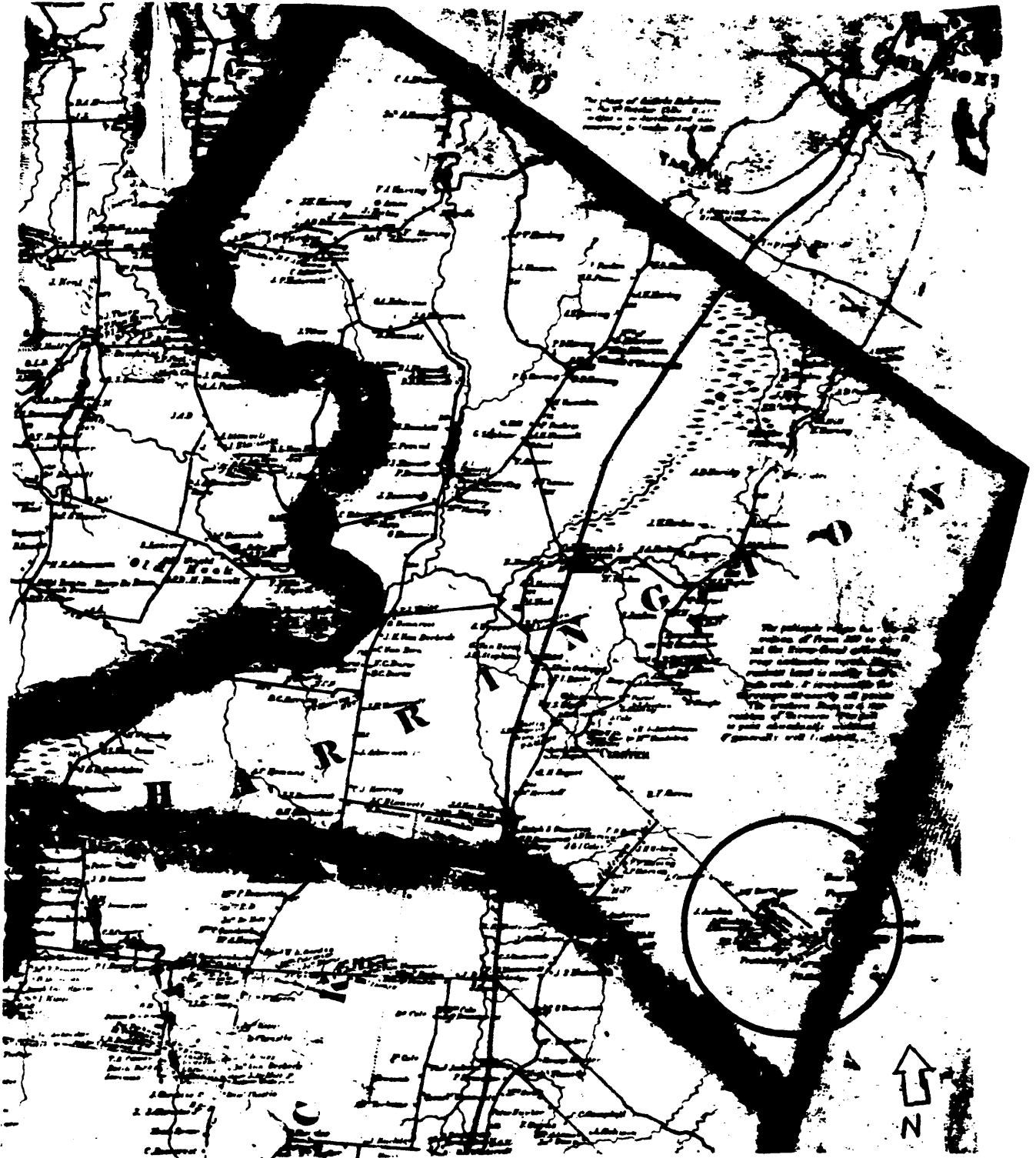

MAP VII

Area of the "Upper Closter" or Alpine Historic District in 1861. Hopkin's Map of Bergen and Passaic Counties, G. H. Corey, Philadelphia, Pa.

"Upper Closter" or Alpine Historic District  
 Alpine, Bergen Co., N.J.

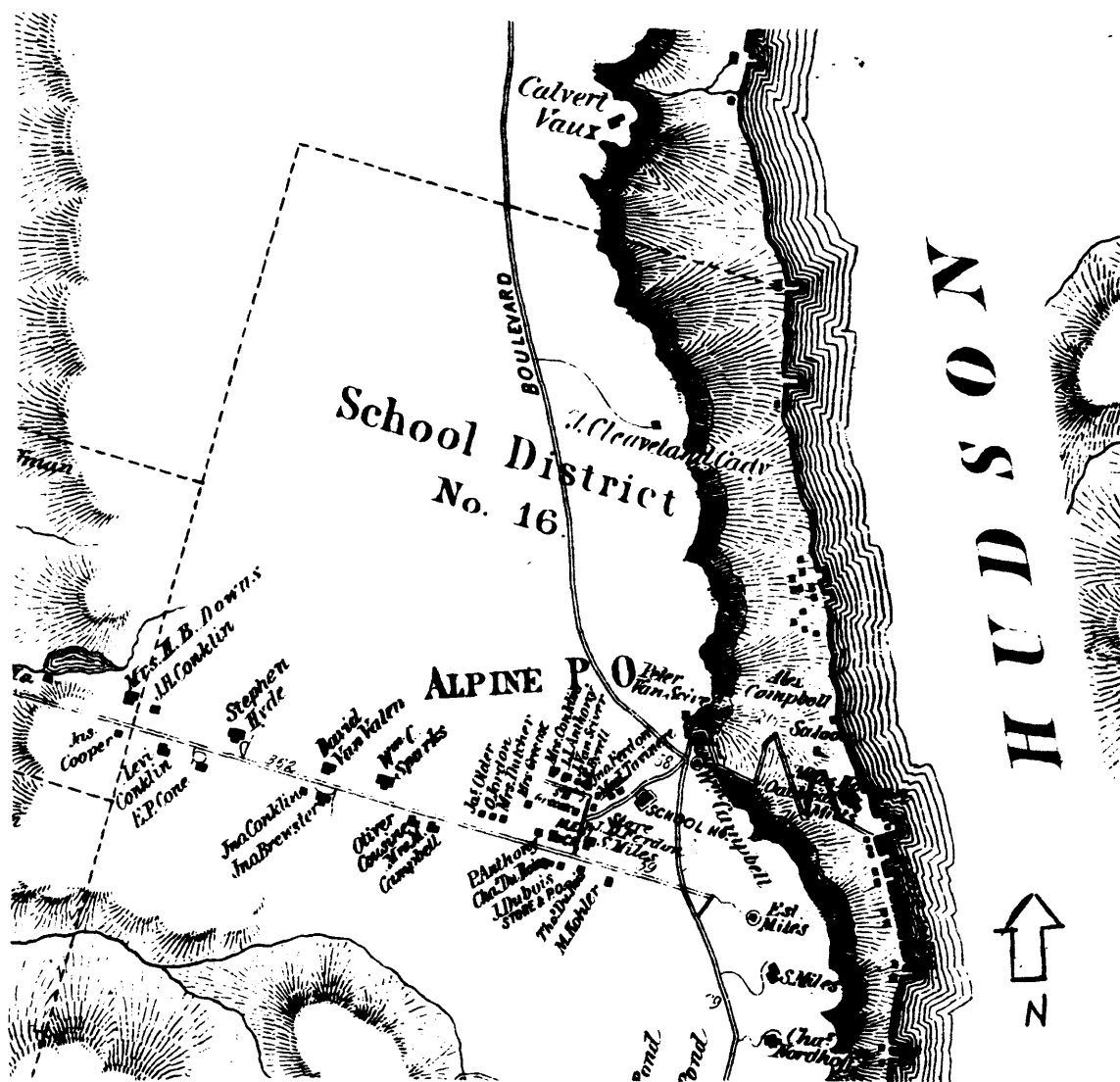

MAP VIII

The "Upper Closter" or Alpine Historic District  
 in 1876. Xeroxed from A. H. Walker, compiler,  
Atlas of Bergen County, 1776-1876. Reading Pa.,:  
 C. C. Pease, 1876, plate 97.

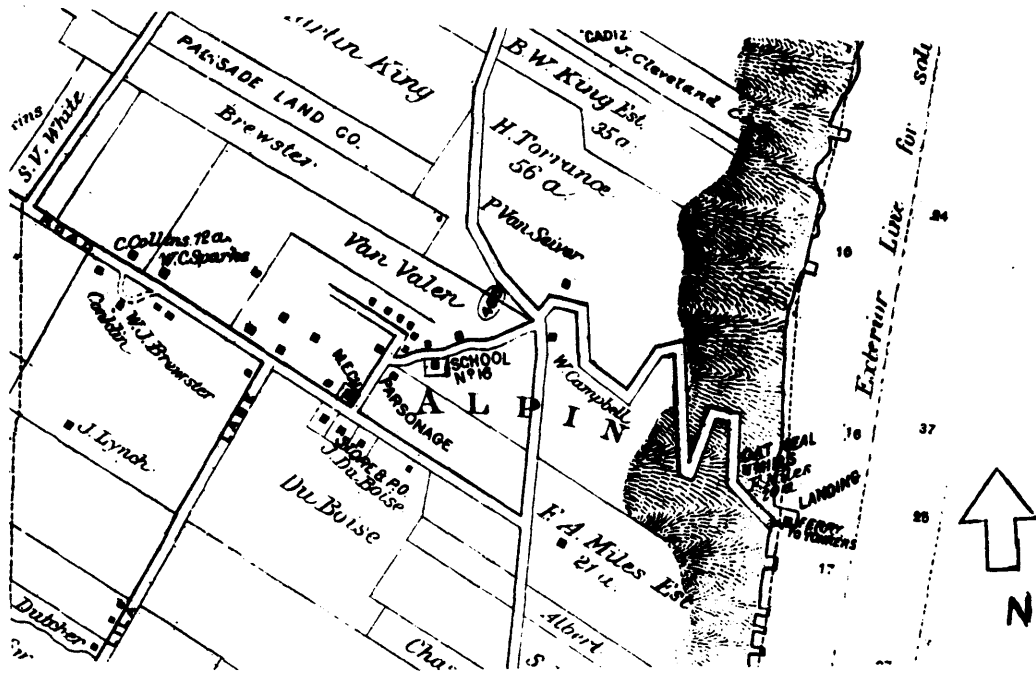

MAP IX

"Upper Closter" or Alpine Historic District in 1891.  
 Xeroxed from Beers, Atlas of Hudson River Valley from New York City to Troy, New York: Watson and Co., c. 1891, section 5.

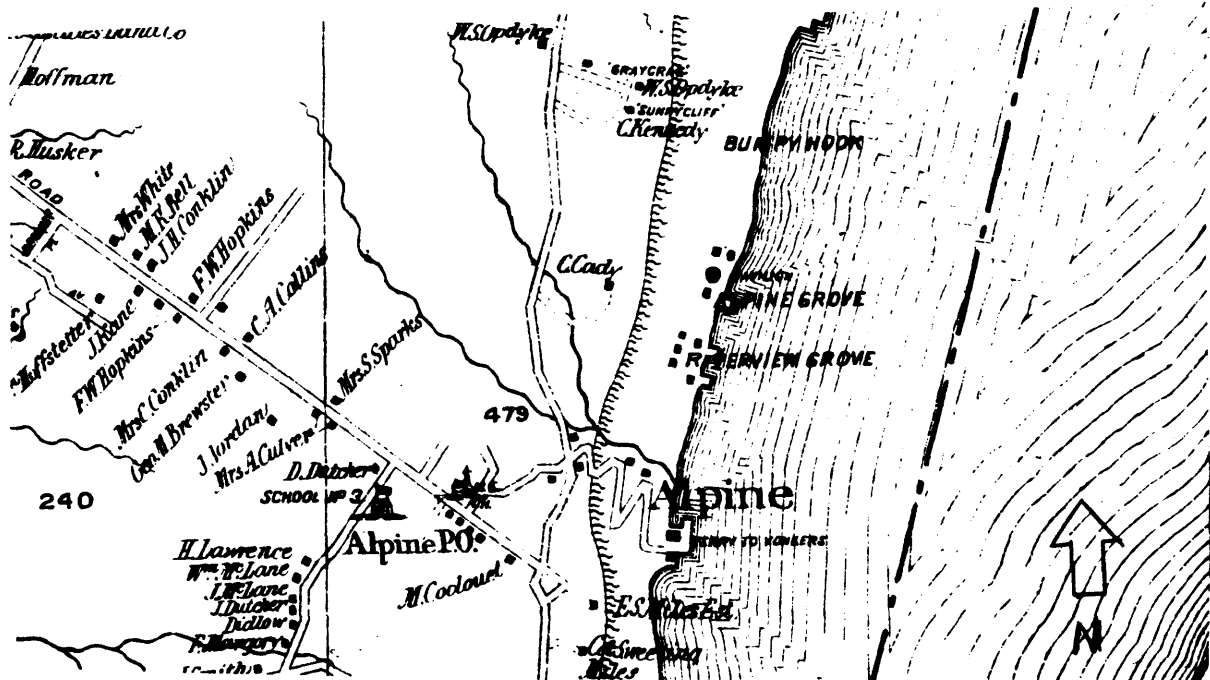

MAP X

"Upper Closter" or Alpine Historic District in 1902.  
 Xeroxed from D. Robinson, compiler "Map of Bergen County, New Jersey . . . .," New York: Robinson and Co., 1902.

"Upper Closter" or Alpine Historic District,  
Alpine, Bergen Co., N.J.



MAP XI

"Upper Closter" or Alpine Historic District in 1912. Xer-  
oxed from George W. and Walter S. Bromley, Atlas of Bergen  
County, N.J., Philadelphia: G. W. Bromley and Co., Vol. I,  
1912, plate 25.

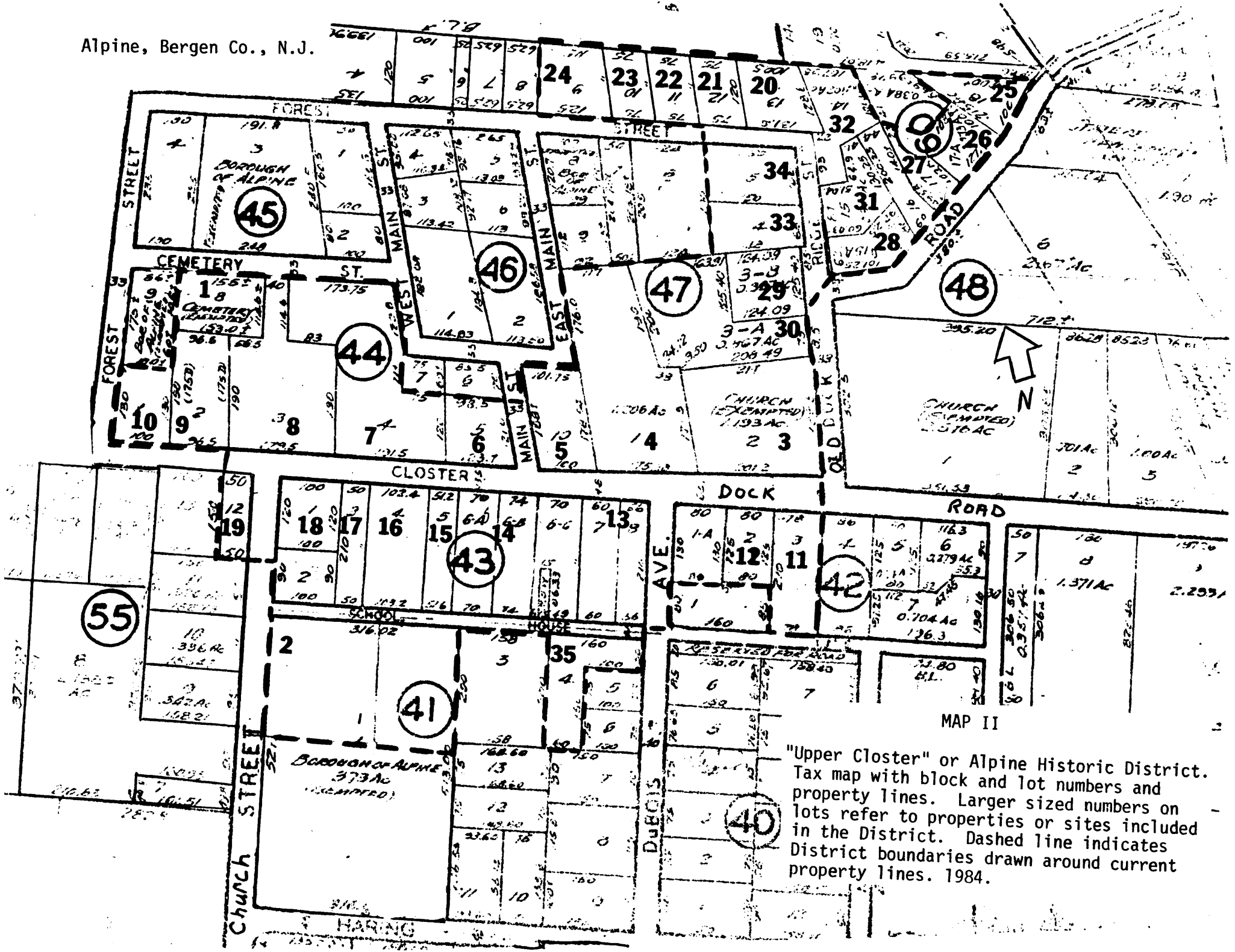

MAP II

"Upper Cluster" or Alpine Historic District. Tax map with block and lot numbers and property lines. Larger sized numbers on lots refer to properties or sites included in the District. Dashed line indicates District boundaries drawn around current property lines. 1984.