

PH 36143 X

DATA SHEET

UNITED STATES DEPARTMENT OF THE INTERIOR
NATIONAL PARK SERVICE

FOR NPS USE ONLY
RECEIVED NOV 9 1976
DATE ENTERED APR 1 1977

NATIONAL REGISTER OF HISTORIC PLACES
INVENTORY -- NOMINATION FORM

SEE INSTRUCTIONS IN HOW TO COMPLETE NATIONAL REGISTER FORMS
TYPE ALL ENTRIES -- COMPLETE APPLICABLE SECTIONS

1 NAME

HISTORIC AND/OR COMMON
Lime Springs Mill Company
Lidtkke Mill

LOCATION

STREET & NUMBER
E 1/2 NW 1/4 NE 1/4 SE 1/4; NE 1/4 NE 1/4 SE 1/4, T100NR12W, Sec. 20

CITY, TOWN: Lime Springs VICINITY OF: Third
STATE: Iowa COUNTY: Howard CODE: 89

CLASSIFICATION

CATEGORY	OWNERSHIP	STATUS	PRESENT USE
<input type="checkbox"/> DISTRICT	<input checked="" type="checkbox"/> PUBLIC	<input checked="" type="checkbox"/> OCCUPIED	<input type="checkbox"/> AGRICULTURE
<input checked="" type="checkbox"/> BUILDING(S)	<input checked="" type="checkbox"/> PRIVATE	<input type="checkbox"/> UNOCCUPIED	<input checked="" type="checkbox"/> MUSEUM
<input type="checkbox"/> STRUCTURE	<input type="checkbox"/> BOTH	<input type="checkbox"/> WORK IN PROGRESS	<input type="checkbox"/> COMMERCIAL
<input type="checkbox"/> SITE	PUBLIC ACQUISITION	ACCESSIBLE	<input type="checkbox"/> EDUCATIONAL
<input type="checkbox"/> OBJECT	<input checked="" type="checkbox"/> IN PROCESS	<input checked="" type="checkbox"/> YES: RESTRICTED	<input type="checkbox"/> ENTERTAINMENT
	<input type="checkbox"/> BEING CONSIDERED	<input type="checkbox"/> YES: UNRESTRICTED	<input type="checkbox"/> GOVERNMENT
		<input type="checkbox"/> NO	<input type="checkbox"/> INDUSTRIAL
			<input type="checkbox"/> MILITARY
			<input type="checkbox"/> PARK
			<input type="checkbox"/> PRIVATE RESIDENCE
			<input type="checkbox"/> RELIGIOUS
			<input type="checkbox"/> SCIENTIFIC
			<input type="checkbox"/> TRANSPORTATION
			<input type="checkbox"/> OTHER:

OWNER OF PROPERTY

NAME: Estate of Herman Lidtkke, Leland Johnson, Executor

STREET & NUMBER: Exchange Savings Bank
CITY, TOWN: Lime Springs VICINITY OF: IOWA STATE: Iowa

LOCATION OF LEGAL DESCRIPTION

COURTHOUSE, REGISTRY OF DEEDS, ETC.: Howard County Courthouse

STREET & NUMBER:
CITY, TOWN: Cresco IOWA STATE: Iowa

6 REPRESENTATION IN EXISTING SURVEYS

TITLE:
DATE: _____
_____ FEDERAL _____ STATE _____ COUNTY _____ LOCAL

DEPOSITORY FOR SURVEY RECORDS:
CITY, TOWN: _____ STATE: _____

7 DESCRIPTION

CONDITION		CHECK ONE	CHECK ONE
<input type="checkbox"/> EXCELLENT	<input type="checkbox"/> DETERIORATED	<input checked="" type="checkbox"/> UNALTERED	<input checked="" type="checkbox"/> ORIGINAL SITE
<input checked="" type="checkbox"/> GOOD	<input type="checkbox"/> RUINS	<input type="checkbox"/> ALTERED	<input type="checkbox"/> MOVED DATE _____
<input type="checkbox"/> FAIR	<input type="checkbox"/> UNEXPOSED		

DESCRIBE THE PRESENT AND ORIGINAL (IF KNOWN) PHYSICAL APPEARANCE

Two structures are included in this nomination, the mill and the miller's house. They are located in a wooded area of about 2 acres, on the bank of the Upper Iowa River.

The mill is an L-shaped structure, built mostly of limestone covered with a yellow brick veneer. The main section, originally constructed in 1857 and rebuilt in 1894 after a fire, is two stories high, on a basement that is above ground on the east side. It is rectangular in plan, with a tin-covered gable roof. Windows are rectangular on this side; on the west there are three round windows below the eaves and a tin-roofed porch which shelters two entries, one single-, the other double-doored. On the north end is a shelter on stilts which encloses the scales, with a loading area beneath.

On the west side is attached a dynamo room, approximately 1½ stories high. It is generally square in plan, with a low-pitched gable roof of tin and a brick chimney at one corner. Windows in this section are segmental arched, as is the double-door entrance. A small square brick "coal room", also with a gable roof, is joined to the larger structure at the northwest corner.

On the north side is an enclosure made of vertical boards, set within the angle between the mill and dynamo room. It houses the mill wheels, and a small latrine which hangs over the millrace.

The miller's house is rectangular in plan, largely of frame construction. The roofline displays great variety, due to the various additions made since the original, square, portion was built in 1857. Wings on the west and east were added about 1880, the whole north half, which is made of cement block on the ground floor level, in 1927.

Because the mill functioned until 1960, its machinery and equipment are intact. Restoration efforts have been limited to roof repairs and the laying of paths for visitors. In the miller's house, however, the living quarters will be restored and on display to visitors; the livery and drying room half of the building will accommodate eating facilities and a visitors' orientation center.

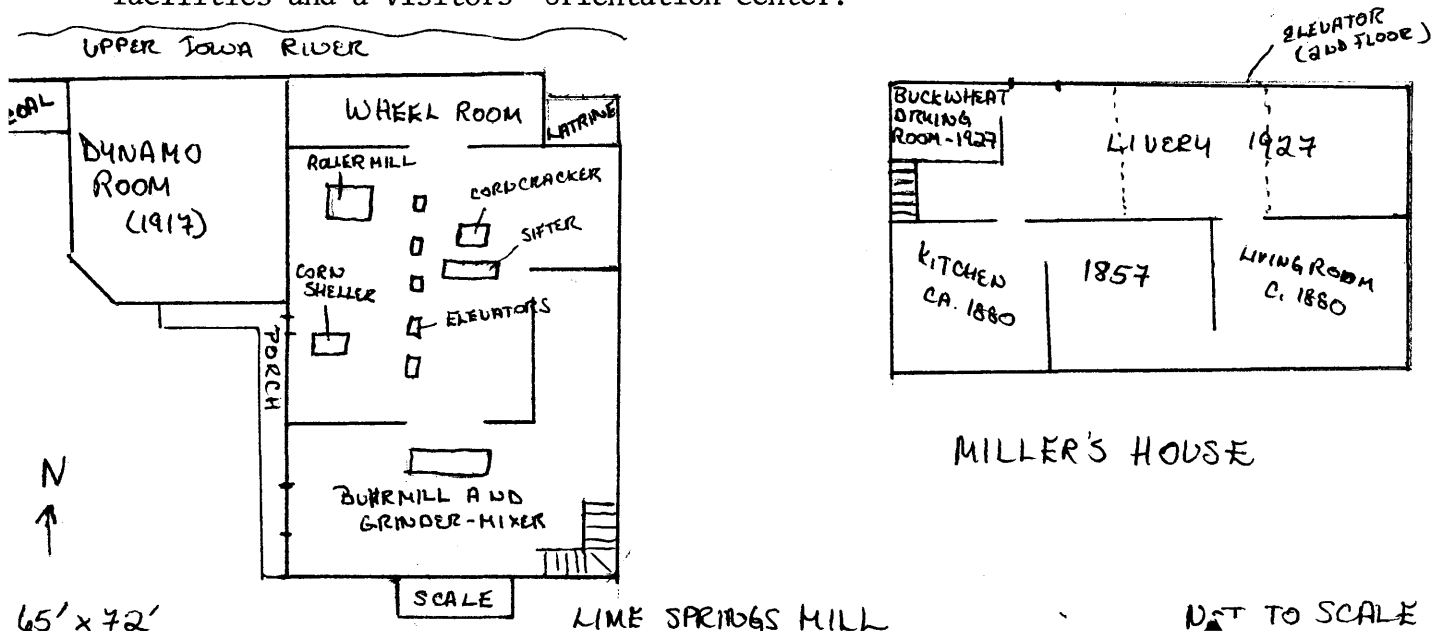

LIME SPRINGS MILL

NOT TO SCALE

8 SIGNIFICANCE

PERIOD	AREAS OF SIGNIFICANCE -- CHECK AND JUSTIFY BELOW			
<input type="checkbox"/> PREHISTORIC	<input type="checkbox"/> ARCHEOLOGY-PREHISTORIC	<input type="checkbox"/> COMMUNITY PLANNING	<input type="checkbox"/> LANDSCAPE ARCHITECTURE	<input type="checkbox"/> RELIGION
<input type="checkbox"/> 1400-1499	<input type="checkbox"/> ARCHEOLOGY-HISTORIC	<input type="checkbox"/> CONSERVATION	<input type="checkbox"/> LAW	<input type="checkbox"/> SCIENCE
<input type="checkbox"/> 1500-1599	<input type="checkbox"/> AGRICULTURE	<input type="checkbox"/> ECONOMICS	<input type="checkbox"/> LITERATURE	<input type="checkbox"/> SCULPTURE
<input type="checkbox"/> 1600-1699	<input type="checkbox"/> ARCHITECTURE	<input type="checkbox"/> EDUCATION	<input type="checkbox"/> MILITARY	<input type="checkbox"/> SOCIAL/HUMANITARIAN
<input type="checkbox"/> 1700-1799	<input type="checkbox"/> ART	<input type="checkbox"/> ENGINEERING	<input type="checkbox"/> MUSIC	<input type="checkbox"/> THEATER
<input checked="" type="checkbox"/> 1800-1899	<input type="checkbox"/> COMMERCE	<input type="checkbox"/> EXPLORATION/SETTLEMENT	<input type="checkbox"/> PHILOSOPHY	<input type="checkbox"/> TRANSPORTATION
<input type="checkbox"/> 1900-	<input type="checkbox"/> COMMUNICATIONS	<input checked="" type="checkbox"/> INDUSTRY	<input type="checkbox"/> POLITICS/GOVERNMENT	<input type="checkbox"/> OTHER (SPECIFY)
		<input type="checkbox"/> INVENTION		

SPECIFIC DATES 1857; 1894; ca. 1915 BUILDER/ARCHITECT

STATEMENT OF SIGNIFICANCE

The Lime Springs Mill is possibly the most important mill remaining in Iowa. Since 1857 it successively sawed lumber, ground wheat for flour, other grains for feed, and generated electricity for the nearby Lime Springs community. Its equipment and machinery are still extant and in partial working order, providing a rare and valuable opportunity to see and understand the actual processes of milling, one of the earliest industries of Iowa.

All through its history, the Lime Springs Mill was adapted to the varying needs of the community it served. Construction was begun in 1857 by M.M. Marsh, as a saw mill, for in this period of early settlement in Howard County, the greatest need at first was for lumber for houses. Shortly thereafter, as residents developed wheat crops, a flouring operation was included at the mill. By 1860 both activities were firmly established. Marsh sold the mill to brothers Lyman and George Drake in 1871. Under the Drakes, the mill produced one hundred barrels of flour each day. Within a few years, however, chinch bugs took a heavy toll of the surrounding area's wheat crops, and during the 1870's the mill, no longer very profitable, changed hands several times. From the 1880's until 1894, however, the mill prospered under the direction of Dr. John Reed and his son-in-law George Heath.

A fire in 1894 burned the mill to the ground. The ruins were sold to James Stafford, who erected a feed mill on the foundations. Wheat was no longer a major crop; agriculture in Iowa had turned to corn and cattle raising, and Stafford's mill ground grain for feed in response to the new situation. Stafford also took advantage of the growing demand for electricity to install a turbine water wheel for the benefit of the Lime Springs community.

From 1905-1915 the mill was owned by William Fruchte. In 1915, D.W. Davis purchased the mill and shortly thereafter added a large dynamo room to the west side, and covered most of the complex with a brick veneer. He also rebuilt the dam, which had deteriorated through long use. Herman Lidtke was the last operator of the Lime Springs Mill, which ceased operation in 1960.

9 MAJOR BIBLIOGRAPHICAL REFERENCES

Lime Springs Then and Now, by Anna Mae Davis and Jane Buresh. Lime Springs: Carl Cassidy, 1968.
 Records in the Howard County Courthouse, Cresco, Iowa.
 Personal interviews (1975) with Herman Lidtke.

10 GEOGRAPHICAL DATA

ACREAGE OF NOMINATED PROPERTY approx. 2 acres

UTM REFERENCES

A	15	550830	4810250	B			
	ZONE	EASTING	NORTHING		ZONE	EASTING	NORTHING
C				D			
	ZONE	EASTING	NORTHING		ZONE	EASTING	NORTHING

VERBAL BOUNDARY DESCRIPTION

LIST ALL STATES AND COUNTIES FOR PROPERTIES OVERLAPPING STATE OR COUNTY BOUNDARIES

STATE	CODE	COUNTY	CODE
STATE	CODE	COUNTY	CODE

11 FORM PREPARED BY

NAME / TITLE

James Walton, Director

ORGANIZATION

Lidtke Mill Restoration Board

DATE

STREET & NUMBER

C402 Hillcrest

TELEPHONE

CITY OR TOWN

Iowa City,

STATE

Iowa

12 STATE HISTORIC PRESERVATION OFFICER CERTIFICATION

THE EVALUATED SIGNIFICANCE OF THIS PROPERTY WITHIN THE STATE IS:

NATIONAL

STATE

LOCAL

As the designated State Historic Preservation Officer for the National Historic Preservation Act of 1966 (Public Law 89-665), I hereby nominate this property for inclusion in the National Register and certify that it has been evaluated according to the criteria and procedures set forth by the National Park Service.

STATE HISTORIC PRESERVATION OFFICER SIGNATURE

Adrian D. Anderson

TITLE Director, Division of Historic Preservation

DATE 11/2/76

FOR NPS USE ONLY

I HEREBY CERTIFY THAT THIS PROPERTY IS INCLUDED IN THE NATIONAL REGISTER

CHIEF DIRECTOR, OFFICE OF ARCHEOLOGY AND HISTORIC PRESERVATION

DATE 4/11/77

ATTEST:

DATE 8/28/77

KEEPER OF THE NATIONAL REGISTER

UNITED STATES DEPARTMENT OF THE INTERIOR
NATIONAL PARK SERVICE

**NATIONAL REGISTER OF HISTORIC PLACES
INVENTORY -- NOMINATION FORM**

FOR NPS USE ONLY	
RECEIVED	DEC 17 1976
DATE ENTERED	APR 11 1977

Lime Springs Mill and Dam, Lime Springs, Howard County, Iowa

CONTINUATION SHEET

ITEM NUMBER

PAGE

Addendum to #7:

The accompanying dam across the Upper Iowa River was built in 1916, to replace the original 1857 structure which had deteriorated from long use. The present dam is made of concrete, with scrap iron pilings for strength, and rock fill at the base. The spillway between the dam and the mill was covered over with concrete in the 1950's after the mill ceased operation.

(acreage of mill with dam should be approximately 2½ acres)