

PH0502171

UNITED STATES DEPARTMENT OF THE INTERIOR
NATIONAL PARK SERVICE

FOR NPS USE ONLY	DATA SHEET
RECEIVED AUG 9 1977	
DATE ENTERED	MAY 16 1978

**NATIONAL REGISTER OF HISTORIC PLACES
INVENTORY -- NOMINATION FORM**

SEE INSTRUCTIONS IN HOW TO COMPLETE NATIONAL REGISTER FORMS
TYPE ALL ENTRIES -- COMPLETE APPLICABLE SECTIONS

1 NAME

HISTORIC

Monument Park Area

AND/OR COMMON

Monument Park Historic District (preferred)

2 LOCATION

STREET & NUMBER

Multiple-see continuation sheet

NOT FOR PUBLICATION

CITY, TOWN

Fitchburg

VICINITY OF

4th

CONGRESSIONAL DISTRICT

STATE

Massachusetts

CODE

025

COUNTY

Worcester

CODE

01420

3 CLASSIFICATION

CATEGORY

OWNERSHIP

STATUS

PRESENT USE

DISTRICT

PUBLIC

OCCUPIED

AGRICULTURE

MUSEUM

BUILDING(S)

PRIVATE

UNOCCUPIED

COMMERCIAL

PARK

STRUCTURE

BOTH

WORK IN PROGRESS

EDUCATIONAL

PRIVATE RESIDENCE

SITE

PUBLIC ACQUISITION

ACCESSIBLE

ENTERTAINMENT

RELIGIOUS

OBJECT

IN PROCESS

YES: RESTRICTED

GOVERNMENT

SCIENTIFIC

BEING CONSIDERED

YES: UNRESTRICTED

INDUSTRIAL

TRANSPORTATION

NO

MILITARY

OTHER:

4 OWNER OF PROPERTY

NAME

Multiple-see continuation sheet

STREET & NUMBER

Multiple

CITY, TOWN

Fitchburg

VICINITY OF

STATE

Massachusetts 01420

5 LOCATION OF LEGAL DESCRIPTION

COURTHOUSE,
REGISTRY OF DEEDS, ETC.

Worcester County Registry of Deeds, Northern District

STREET & NUMBER

84 Elm Street

CITY, TOWN

Fitchburg

STATE

Massachusetts 01420

6 REPRESENTATION IN EXISTING SURVEYS

TITLE

Inventory of the Historic Assets of the Commonwealth

DATE

1975

FEDERAL STATE COUNTY LOCAL

DEPOSITORY FOR
SURVEY RECORDS

Massachusetts Historical Commission

CITY, TOWN

Boston

STATE

Massachusetts 02108

7 DESCRIPTION

CONDITION		CHECK ONE	CHECK ONE
<input checked="" type="checkbox"/> EXCELLENT	<input type="checkbox"/> DETERIORATED	<input checked="" type="checkbox"/> UNALTERED	<input checked="" type="checkbox"/> ORIGINAL SITE
<input checked="" type="checkbox"/> GOOD	<input type="checkbox"/> RUINS	<input checked="" type="checkbox"/> ALTERED	<input type="checkbox"/> MOVED DATE _____
<input type="checkbox"/> FAIR	<input type="checkbox"/> UNEXPOSED		

DESCRIBE THE PRESENT AND ORIGINAL (IF KNOWN) PHYSICAL APPEARANCE

Monument Park Historic District is comprised of 12 commercial, residential, and civic structures located around a small, formal park in the commercial center of Fitchburg. To the north of the district is a residential neighborhood; east, west and south is primarily commercial. Gothic Revival, Mansard, Romanesque, and Neo - Classical styles are represented to lend a variety of shapes and outlines to the district, yet the overall feeling is one of harmony which distinguishes the district from other downtown areas.

The structures surround Monument Park (#9), and can be observed as a group from the Park, or from Main Street which runs east to west through the district. Some of the structures have small lawns. A number of the properties have low granite retaining walls along the sidewalks. The Park provides an attractive landscape as the focal point of the district, and is a unifying factor for the entire area. Nearby hills which surround the downtown area can be seen from the Park.

The Courthouse (#4), Christ Church (#7), and residential buildings (#5) continue their original uses. The Central Hardware Building (#1) was originally the Trinitarian Church. It also housed the Post Office, the Park Club, and a commercial space before being converted to its present retail condition. The Armory (#2) was sold to the city for \$1.00 in 1974, and now serves as an informal community center. The Post Office Building (#3) was vacated in 1974. It is still owned by the Postal Service, which plans to sell it to the County to be used as a District Court. The Worcester County National Bank was built as the Y.M.C.A. (#8) and remodelled. The commercial buildings south of Main Street continue to serve commercial or institutional purposes.

CENTRAL HARDWARE (#1) is located at 621 Main Street. It was built in 1844 as a Greek Revival structure, The Trinitarian Church. The Church was completely remodelled during the 1870's and 80's in the Mansard style. It was again remodelled in this century. Most of the original or 1870 features have been obscured by the present unattractive commercial style. The steep Mansard roof is plain, and has been covered with asphalt shingles. The three bay wide facade is dominated by the large "Central Hardware" sign and storefront. All original 1844 detail has been completely removed.

ARMORY (#2) is located at 14 Wallace Ave. It was designed by Robert P. Wait and Olin W. Cutter, and built in 1891. An addition designed by H. M. Francis was constructed in 1914. The two story brick building has a flat roof and one tall chimney. A sandstone watertable runs continuously beneath the first story window sills. A corbelled string-course defines the base of the entablature, which is a parapet wall with cruciform openings. Penetration is long, narrow arched windows. Exposed basement windows are small and rectangular.

The east facade has a square central tower with a small turret on the southern end. The second story stage of the tower facade has two narrow windows headed by the title of the building in relief, crowned by the seal of the Commonwealth. The upper stage of the tower is an arcade of arched window openings with a parapet wall overhead. Each block of the parapet on all four sides of the tower contains a cruciform opening. The base of the tower is the building entrance, which is a large, molded, segmentally arched opening flanked by a turret on either side. The turrets are ornamented by wide sandstone band. The entire entrance section projects slightly from the tower, and thus forms a balcony at the second story level of the facade. The northern and southern ends of the

UNITED STATES DEPARTMENT OF THE INTERIOR
NATIONAL PARK SERVICE

**NATIONAL REGISTER OF HISTORIC PLACES
INVENTORY -- NOMINATION FORM**

FOR NPS USE ONLY
RECEIVED AUG 9 1977
DATE ENTERED MAY 1977

CONTINUATION SHEET

ITEM NUMBER 4 PAGE 1

Property Owners and Key to Sketch Map:

Building:	Owner:
#1- Central Hardware (Trinitarian Church)- 1844 621 Main Street Fitchburg, Mass. 01420	Aubuchon Realty Co., Inc. 95 Aubuchon Drive Westminster, Mass. 01473
#2- Armory- 1891 14 Wallace Ave. Fitchburg	City of Fitchburg City Hall, 718 Main Street Fitchburg, Mass. 01420
#3- Old Post Office- 1903 Wallace Ave. Fitchburg	Worcester County Commissioners Superior Court House Worcester, Mass. 01608
#4- County Court- 1871 84 Elm Street Fitchburg	Worcester County Commissioners Superior Court House Worcester, Mass. 01608
#5- c. 1890 18.20,22 Hartwell St. Fitchburg	The M.T.H. Corporation 170 Merrimack Street Lowell, Mass. 01852
#6- c. 1880 16 Hartwell Street Fitchburg	The M.T.H. Corporation 170 Merrimack Street Lowell, Mass. 01852
#7- Christ Church- 1868 569 Main Street Fitchburg	Christ Church 569 Main Street Fitchburg, Mass. 01420
#8- YMCA Building- 1894 533 Main Street Fitchburg	Sidney M. Bird & A. Frederick Richard 28 State Street Boston, Mass. 02109
#9- Monument Park- 1874 Main Street Fitchburg	City of Fitchburg City Hall, 718 Main Street Fitchburg, Mass. 01420
#10- Fitchburg Public Library-1950, 1964 610 Main Street Fitchburg	City of Fitchburg City Hall, 718 Main Street Fitchburg, Mass. 01420

UNITED STATES DEPARTMENT OF THE INTERIOR
NATIONAL PARK SERVICE

**NATIONAL REGISTER OF HISTORIC PLACES
INVENTORY -- NOMINATION FORM**

FOR NPS USE ONLY	
RECEIVED	AUG 9 1977
DATE ENTERED	MAY 18 1979

CONTINUATION SHEET

ITEM NUMBER 4 PAGE 2

Property Owners & Key to Sketch Map:

Building:

A- Commercial Building- date unknown
574-588 Main Street
Fitchburg, Mass. 01420

#11- Institutional Building- c. 1910
564 Main Street
Fitchburg

B- Commercial Building- date unknown
536-540 Main Street
Fitchburg

Owner:

H & R Block, Inc.- 574 Main St., Fitchburg ✓

Economy Paint Supply Co.- 588 Main St. ✓

Espresso Pizza, Inc.- 584 Main St. ✓

Worcester Telegram & Gazette-580 Main St. ✓

City Cleaners, Palace Laundry- 578 Main St. ✓

Fitchburg- Leominster Area Rehabilitation
and Work Center ✓

564 Main Street ✓

Fitchburg

Park Snow's of Fitchburg, Inc.- 540 Main St. ✓

Book Shop- 536 Main Street ✓

Fitchburg, Mass. 01420 ✓

UNITED STATES DEPARTMENT OF THE INTERIOR
NATIONAL PARK SERVICE

NATIONAL REGISTER OF HISTORIC PLACES
INVENTORY -- NOMINATION FORM

FOR NPS USE ONLY

RECEIVED MAY 2 1978

DATE ENTERED MAY 14 1979

CONTINUATION SHEET

ITEM NUMBER 4 PAGE 1

Property Owners and Key to Sketch Map:

Building:

Owner:

#1- Central Hardware
(Trinitarian Church)- 1844
621 Main Street
Fitchburg, Mass. 01420

Aubuchon Realty Co., Inc.
95 Aubuchon Drive
Westminster, Mass. 01473

#2- Armory- 1891
14 Wallace Ave.
Fitchburg

City of Fitchburg
City Hall, 718 Main Street
Fitchburg, Mass. 01420

#3- Old Post Office- 1903
Wallace Ave.
Fitchburg

Worcester County Commissioners
Superior Court House
Worcester, Mass. 01608

#4- County Court- 1871
84 Elm Street
Fitchburg

Worcester County Commissioners
Superior Court House
Worcester, Mass. 01608

#5- c. 1890
18.20,22 Hartwell St.
Fitchburg

The M.T.H. Corporation
170 Merrimack Street
Lowell, Mass. 01852

#6- c. 1880
16 Hartwell Street
Fitchburg

The M.T.H. Corporation
170 Merrimack Street
Lowell, Mass. 01852

#7- Christ Church- 1868
569 Main Street
Fitchburg

Christ Church
569 Main Street
Fitchburg, Mass. 01420

#8- YMCA Building- 1894
533 Main Street
Fitchburg

Sidney M. Bird & A. Frederick Richard
28 State Street
Boston, Mass. 02109

#9- Monument Park- 1874
Main Street
Fitchburg

City of Fitchburg
City Hall, 718 Main Street
Fitchburg, Mass. 01420

UNITED STATES DEPARTMENT OF THE INTERIOR
NATIONAL PARK SERVICE

**NATIONAL REGISTER OF HISTORIC PLACES
INVENTORY -- NOMINATION FORM**

FOR NPS USE ONLY

RECEIVED AUG 9 1977

DATE ENTERED MAY 16 1978

CONTINUATION SHEET

ITEM NUMBER 7 PAGE 1

facade project slightly from the core of the building. The southern end is two bays wide; the northern end is four bays wide.

OLD POSTOFFICE (#3) is located on Wallace Ave. The Classical Revival building was designed by James Knox Taylor, and constructed in 1903. It is a two story, flat roofed, granite structure with a wide molded entablature. A modillioned cornice runs beneath the overhanging eaves. A stone balustrade crowns the building with a sculpted heroic figure stationed at the center of the facade. A rounded water table connects the sills of the large segmentally arched windows with keystones. The segmental arches at the tops of the windows are separated from the rectangular window sections below by a stone jack arch with keystone. The five bay wide facade faces east. It is dominated by a three bay wide projecting center doric portico containing four full height columns. The portico is flanked by a single window on either side. The north and south elevations are seven bays deep. The building was enlarged in the 1930's.

WORCESTER COUNTY SUPERIOR COURT (#4) is located on 84 Elm Street. It was designed by E. Boyden and Son, and built in 1971. The High Victorian Gothic building is of random ashlar granite blocks with pressed granite trimwork. It is three stories with a steeply pitched intersecting ridge roof. The roof peaks are crowned by iron finials. The full basement story is sheathed in smooth granite blocks. A granite stringcourse links the sills of the first story windows; another defines the first story floor line. All of the building corners are quoined. Fenestration is 2/2. The basement level is large rectangular windows; the first story segmentally arched windows the second story Gothic arched windows. All of the windows are framed by dressed granite architraves, and wide granite lintels and sills. The entablature of the building is ornamented by a continuous quatrefoil motif. Tall Gothic dormers rise from the eaves and are crowned by cruciform finials.

The facade faces south. It is dominated by a one bay wide, full two story center entrance section. Gradually sloping granite steps lead to the Gothic arched first story entrance porch. A Gothic arched window is placed on the east and west sides of the porch. An open porch on the second story above is decorated by a stone balustrade with small triangular and circular openings. The slightly projecting second story of this entrance section has a large Gothic window in the tall, narrow intersecting gable. This section is flanked by two bays on either side, each containing one window on each story. The eastern end of the facade curves around the corner forming a five sided turret. The east elevation is four bays deep. The northern end bay projects from the core of the building. The bay has double windows on the basement and first floor, and a triple Gothic arched window on the second floor. The windows are separated by engaged columns. A dormer with a single Gothic window rises from the roof above.

16 Hartwell Street (#6) was also designed by H. M. Francis, and built c. 1886. It is an attractive asymmetrical brick house with gables, dormers, turrets, porches, and bay windows typical of the Queen Ann style. Fenestration is 1/1 of contrasting scale.

UNITED STATES DEPARTMENT OF THE INTERIOR
NATIONAL PARK SERVICE

**NATIONAL REGISTER OF HISTORIC PLACES
INVENTORY -- NOMINATION FORM**

FOR NPS USE ONLY	
RECEIVED	AUG 9 1977
DATE ENTERED	9/6/77

CONTINUATION SHEET

ITEM NUMBER 7 PAGE 2

CHRIST CHURCH (#7) is located at 569 Main Street. The High Victorian Gothic Church was designed by Richard Upjohn, and built in 1868. It is a granite building facing south onto the Park (#3). The eastern section of the facade has a large triple Gothic arched window flanked by two smaller Gothic windows to either side and lower. A cross stands on the peak of the gable above. The western section of the facade is a tall tower and steeple. The entrance to the church is in the tower. It is a Gothic arched wooden door painted red. The tower corners are quoined. The bell tower has double Gothic arched louvered openings on walls stepped back from the quoined corners and dentiled entablature. The octagonal spire above has a slate roof and four narrow dormers, each with a Gothic arched opening and a small cruciform finial at the peak. Almost the entire facade is covered over with ivy.

The west elevation is one story with a copper roof sloping from the entablature of the core of the building. This entablature is ornamented with continuous trefoil openings. The two southern end bays of the elevation by the church tower contain large Gothic windows. The center bay is an intersecting gable with a Gothic arched entrance, headed by a triple arched window on the second story. A round arched entrance headed by a small arched opening occupies the bay to the left of the intersecting gable. The northern end bays have a more steeply pitched roof. Fenestration is paired, composed of single round arched windows separated by engaged Romanesque columns, and headed by molded architraves.

The east elevation also has a copper roof sloping from the trefoil ornamented course of the main structure. The southern end has an arched entrance in a small intersecting gable. The northern end is large Gothic arched windows.

The church has had numerous additions, all in keeping with the original design. One of the major enlargements was designed by the architects' grandson, Hobart Upjohn.

Y.M.C.A. BUILDING (#8) at 533 Main St. was designed by H.M. Francis, and built in 1894. The sandstone and brick building is three stories with a flat roof. Fenestration is 1/1 with a transom window above each. The facade faces south. At the corner of the facade and the west elevation is an oriel window. It covers the top two stories of the elevation and has a triple window with transoms overhead on both stories. The windows are divided horizontally by a terra cotta band. The cornice of the oriel is rough granite blocks. The entire first story of the building is sheathed in tempered hardboard. The three bay wide facade has triple round arched windows covering the second and third stories. A terra cotta band divides the second and third story windows. The six bay deep west elevation second story has asymmetrically placed double and single windows. The third story is three single windows, and at the northern end two single windows with side lights, both headed by linked molded round arches.

The Y.M.C.A. building was originally a Richardsonian Romanesque structure. The top two floors and original steeply pitched Mansard roof were removed. The original red sandstone and brick have been painted over, and the first story remodelled. The building presently houses a branch office of the Worcester County National Bank.

UNITED STATES DEPARTMENT OF THE INTERIOR
NATIONAL PARK SERVICE

**NATIONAL REGISTER OF HISTORIC PLACES
INVENTORY -- NOMINATION FORM**

FOR NPS USE ONLY

RECEIVED AUG 9 1977

DATE ENTERED MAY 18 1978

CONTINUATION SHEET

ITEM NUMBER 7 PAGE 3

MONUMENT PARK (#9) is situated at the center of the district and is bordered by Main Street to the south, Hartwell Street to the east, Elm Street to the north, and Wallace Avenue to the west. The Park was constructed in 1874. It consists of 2/3 of an acre encircled by large maple trees, and bordered by shrubbery and an iron fence. The monument at the center of the green was sculpted by Martin Milmore. It is a granite structure carrying a statue of Victory holding a garland in each hand. Below her is a plaque flanked by a statue of a Civil War rifleman on the left, and a sailor on the right.

FITCHBURG PUBLIC LIBRARY (#10) is located at 610 Main Street. It was designed by Carl Koch and Associates, and constructed in 1950 and 1967. It is a two story, brick and concrete, flat roof structure. The wide overhang of the roof is supported by narrow square columns.

COMMERCIAL BUILDING (A) located at 574-588 Main Street was probably constructed during the 1950's. It is a one story brick building with aluminum and glass storefronts continuous along the north facade.

INSTITUTIONAL BUILDING (#11) was constructed c. 1910. It stands at 564 Main Street. It is a two story brick building with a copper frieze and a modillioned cornice and flat roof. The seven bay wide facade faces north. The first story is primarily glass storefronts. The second story is large panes with side lights.

COMMERCIAL BUILDING (B) was probably constructed in the late 1930's or 1940's. It is a one story brick building located at 536-540 Main Street. The north facade is glass storefronts.

Handwritten notes:
2/21/77
12/21/77
Fitchburg

8 SIGNIFICANCE

PERIOD	AREAS OF SIGNIFICANCE -- CHECK AND JUSTIFY BELOW			
<input type="checkbox"/> PREHISTORIC	<input type="checkbox"/> ARCHEOLOGY-PREHISTORIC	<input checked="" type="checkbox"/> COMMUNITY PLANNING ✓	<input type="checkbox"/> LANDSCAPE ARCHITECTURE	<input checked="" type="checkbox"/> RELIGION ✓
<input type="checkbox"/> 1400-1499	<input type="checkbox"/> ARCHEOLOGY-HISTORIC	<input type="checkbox"/> CONSERVATION	<input checked="" type="checkbox"/> LAW	<input type="checkbox"/> SCIENCE
<input type="checkbox"/> 1500-1599	<input type="checkbox"/> AGRICULTURE	<input type="checkbox"/> ECONOMICS	<input type="checkbox"/> LITERATURE	<input checked="" type="checkbox"/> SCULPTURE ✓
<input type="checkbox"/> 1600-1699	<input checked="" type="checkbox"/> ARCHITECTURE ✓	<input checked="" type="checkbox"/> EDUCATION	<input checked="" type="checkbox"/> MILITARY	<input checked="" type="checkbox"/> SOCIAL/HUMANITARIAN ✓
<input checked="" type="checkbox"/> 1700-1799	<input type="checkbox"/> ART	<input type="checkbox"/> ENGINEERING	<input type="checkbox"/> MUSIC	<input type="checkbox"/> THEATER
<input checked="" type="checkbox"/> 1800-1899	<input checked="" type="checkbox"/> COMMERCE	<input type="checkbox"/> EXPLORATION/SETTLEMENT	<input type="checkbox"/> PHILOSOPHY	<input type="checkbox"/> TRANSPORTATION
<input checked="" type="checkbox"/> 1900-	<input type="checkbox"/> COMMUNICATIONS	<input type="checkbox"/> INDUSTRY	<input checked="" type="checkbox"/> POLITICS/GOVERNMENT	<input type="checkbox"/> OTHER (SPECIFY)
		<input type="checkbox"/> INVENTION		

SPECIFIC DATES

BUILDER/ARCHITECT

STATEMENT OF SIGNIFICANCE

Monument Park Historic District is significant for its architecture and its associations with the history and development of the city. Most of the buildings within the district are of high quality design, material, and construction. Notable individual buildings include Worcester County Superior Court House (#4) designed by E. Boyden, Christ Church (#7) designed by Richard Upjohn, and the Armory (#2) designed by Cutter and Wait. H.M. Francis, the leading Fitchburg architect, designed three of the district buildings and remodeled two others.

The district is located between two old centers of the city - the Upper Common and the Old Town. Initially, development bypassed the district, but did begin to occur in the area during the 1840's because of growth encouraged by the arrival of the railroad. During this period more homes were built within the district boundaries, and the oldest building remaining there, the Trinitarian Church (Central Hardware, #1), was erected. The Church was established because of the slavery issue. Many members of the Congregational Church took a strong stand against slavery, and founded the new Trinitarian Church. Abolitionists who spoke at the Trinitarian Church included Fredrick Douglas, Lucy Stone, and George Thompson, an Englishman and member of Parliament who left his native land to labor on behalf of abolition.

Later growth in the district occurred during and immediately following the Civil War, which brought on a business and industry boom in the area. New jobs were created which attracted large numbers of immigrants. The war also brought death to 142 Fitchburg citizens, to whom Martin Milmores' monument and the Park were dedicated. Land surrounding the Park became highly suitable for important civic buildings and churches so necessary to the expanding town. Many of the existing district homes were relocated, and new buildings were constructed around the new Park. Upjohns' Christ Church (#7) was built in 1867, and the County Court House (#4) was erected on to the north of the Park in 1871. Except for the nation wide depression of 1873 which brought a halt to construction within the district until the 1880's, Fitchburg grew and prospered between 1845 when the railroad reached the city and 1910 when that growth leveled off. Most of the district buildings were erected during this period, and have continuously served a large portion of the city population. Monument Park (#9) was until 1974 surrounded by buildings serving four levels of government - The Federal Post Office (#3), the State Armory (#2), the County Court House (#4), and the City Library (#10). The district was largely constructed as a display of civic pride, and has become a source of community identity.

9 MAJOR BIBLIOGRAPHICAL REFERENCES

- Fitchburg, Mass. Pictorial Souvenir, 1901.
 Currier, Frederic, History of Christ Church, Christ Church Collection.
 Fitchburg Daily Sentinel- Souvenir Edition, June, 1892.
 Emerson, William A., Fitchburg, Mass, Past and Present, Blanchard and Brown,
 Fitchburg, 1887.
 Kirkpatrick, Doris, The City and the River, Fitchburg Historical Society, 1971.
 Fitchburg Historical Society Proceedings, Vol. 1-5, 1895-1914

10 GEOGRAPHICAL DATA

ACREAGE OF NOMINATED PROPERTY approximately 10 acres
 UTM REFERENCES

A	19	2710	0210	4718	31010	B	19	2710	2210	4718	2610
	ZONE	EASTING	NORTHING				ZONE	EASTING	NORTHING		
C	19	2710	2410	4718	0810	D	19	2710	1510	4718	0410
	ZONE	EASTING	NORTHING				ZONE	EASTING	NORTHING		

VERBAL BOUNDARY DESCRIPTION

Beginning at the northwestern corner of the property line of prop. #3 and continuing southwesterly to the rear property line of prop. #2; continuing easterly along rear property line of prop. #2 to prop. line of #1; continuing southeasterly along property line of prop. #1 to Main Street; continuing westerly to property line of #10; continuing south-easterly along property line of #10 to rear property line of prop. #10; continuing easterly along rear property line of #10, across Newton Place and on along rear property lines of properties A, 11, B to east property line of Prop. B; continuing northerly Cont.

LIST ALL STATES AND COUNTIES FOR PROPERTIES OVERLAPPING STATE OR COUNTY BOUNDARIES

STATE	CODE	COUNTY	CODE
STATE	CODE	COUNTY	CODE

11 FORM PREPARED BY

NAME / TITLE (Frank Garretson, Fitchburg Planning Department)
 Blaine Mallory and Joseph Orfant, National Register Editor

ORGANIZATION Massachusetts Historical Commission

DATE July 26, 1977

STREET & NUMBER 294 Washington Street

TELEPHONE 617-727-8470

CITY OR TOWN Boston

STATE Mass. 02108

12 STATE HISTORIC PRESERVATION OFFICER CERTIFICATION

THE EVALUATED SIGNIFICANCE OF THIS PROPERTY WITHIN THE STATE IS:

NATIONAL

STATE

LOCAL

As the designated State Historic Preservation Officer for the National Historic Preservation Act of 1966 (Public Law 89-665), I hereby nominate this property for inclusion in the National Register and certify that it has been evaluated according to the criteria and procedures set forth by the National Park Service.

STATE HISTORIC PRESERVATION OFFICER SIGNATURE

8/1/77

DATE

TITLE Acting Executive Director, Mass. Historical Commission

FOR NPS USE ONLY

I HEREBY CERTIFY THAT THIS PROPERTY IS INCLUDED IN THE NATIONAL REGISTER

ATTEST:

Walter Cole

DATE

5/16/78

DATE

5-12-78

UNITED STATES DEPARTMENT OF THE INTERIOR
NATIONAL PARK SERVICE

**NATIONAL REGISTER OF HISTORIC PLACES
INVENTORY -- NOMINATION FORM**

FOR NPS USE ONLY	
RECEIVED	AUG 9 1977
DATE ENTERED	MAY 16 1978

CONTINUATION SHEET

ITEM NUMBER 10 PAGE 1

UTM References:

E 19/269 960/4718 090

Verbal Boundary Description:

along property line of prop. B to Main Street; continuing easterly to east property line of prop. #8; continuing northerly along property line of #8 to north property line of #8; continuing westerly to Fox Street; continuing northeasterly on Fox Street to Elm Street; continuing westerly on Elm Street to property line of Prop. #6; continuing northeasterly along rear property lines of properties #6 and #5 to north property line of prop. #5; continuing westerly along property line of prop. #5 to Hartwell Street; continuing northerly on Hartwell St. to rear property line of property #4; continuing westerly along property line of #4 to Wallace Ave.; continuing southerly on Wallace Ave. to north property line of prop. #3; continuing westerly to starting point

UNITED STATES DEPARTMENT OF THE INTERIOR
NATIONAL PARK SERVICE

**NATIONAL REGISTER OF HISTORIC PLACES
INVENTORY -- NOMINATION FORM**

FOR NPS USE ONLY

RECEIVED

MAY 3 1978

DATE ENTERED

MAY 3 1978

CONTINUATION SHEET

ITEM NUMBER 10

PAGE 2

UTM REFERENCES:

- A 19/270 010/4718 280
- B 19/270 180/4718 240
- C 19/270 230/4718 080
- D 19/269 960/4718 170

VERBAL BOUNDARY DESCRIPTION:

Beginning at the northwestern corner of the property line of prop. #3 and continuing southwesterly to the rear property line of prop. #2; continuing easterly along rear property line of prop. #2 to prop. line of #1; continuing southeasterly along property line of prop. #1 to Main Street; continuing easterly along Main Street to the west property line of prop. #8; continuing northerly along property line of #8 to north property line of #8; continuing westerly to Fox Street; continuing northeasterly on Fox Street to Elm Street; continuing westerly on Elm Street to property line of prop. #6; continuing northeasterly along rear property lines of props. #6 and #5 to north property line of prop. #5; continuing westerly along property line of property #5 to Hartwell Street; continuing northerly on Hartwell St. to rear property line of prop. #4; continuing westerly along property line of #4 to Wallace Avenue; continuing southwesterly on Wallace Avenue to north property line of prop. #3; continuing westerly to starting point.

FORM B - BUILDING

MASSACHUSETTS HISTORICAL COMMISSION
Office of the Secretary, State House, Boston

In Area no. <u>X A</u>	Form no. <u>1</u>
---------------------------	----------------------

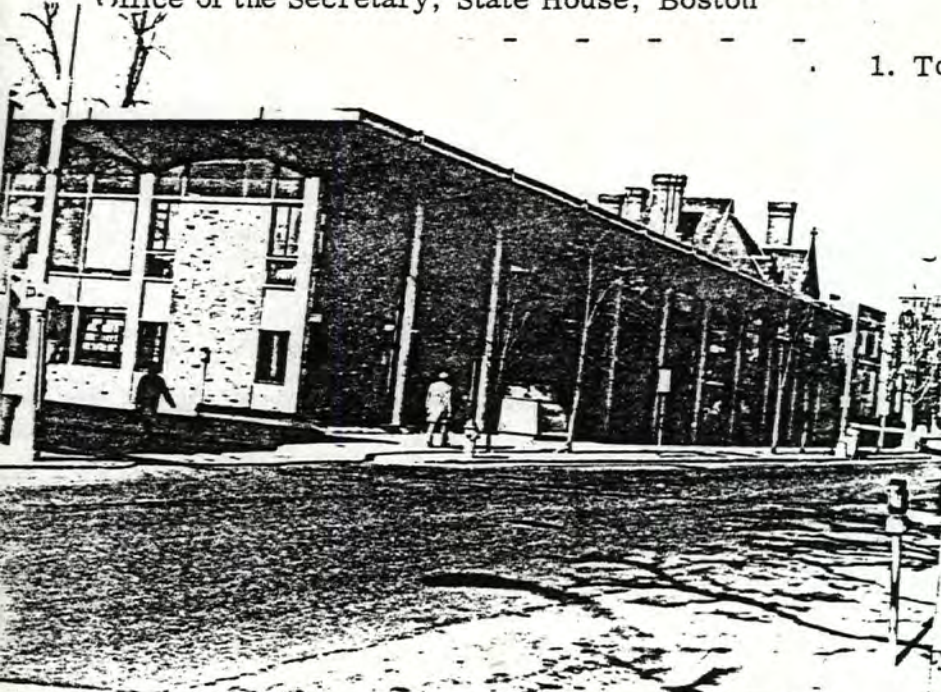

1. Town Fitchburg
 Address 610 Main Street
 Name Fitchburg Public Library
 Present use Library
 Present owner City of Fitchburg
 Description:
 Date 1950 - Youth Library
1967 - Wallace Library
 Source Fitchburg Public Library
 Style Contemporary
 Architect Carl Koch & Assoc.

4. Map. Draw sketch in relation to nearest cross streets and other buildings. Indicate north.

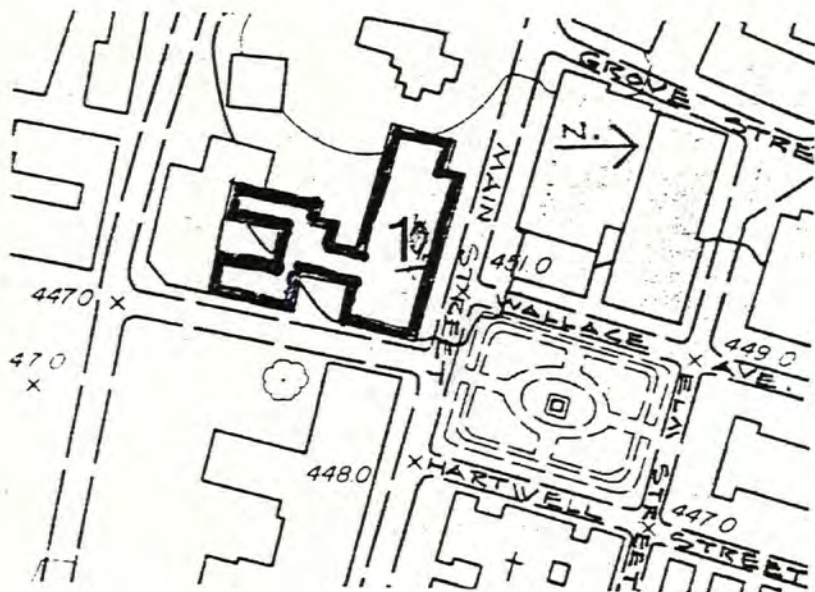

Exterior wall fabric Brick
 Outbuildings (describe) None
 Other features _____

 Altered _____ Date _____
 Moved _____ Date _____

5. Lot size:
 One acre or less _____ Over one acre 45,000
 Approximate frontage 215' on Main St.
170' on Newton Place
 Approximate distance of building from street
15' from curb

DO NOT WRITE IN THIS SPACE
 USGS Quadrant _____
 MHC Photo no. _____

RECEIVED

MAY 7 1975

6. Recorded by Frank Garretson
 Organization City Planning Department
 Date 12 March 1975

MASS. HIST. COMM.
(over)

7. Original owner (if known) Same

Original use Same

Subsequent uses (if any) and dates None

8. Themes (check as many as applicable)

Aboriginal	<u> </u>	Conservation	<u> </u>	Recreation	<u> </u>
Agricultural	<u> </u>	Education	<u> X </u>	Religion	<u> </u>
Architectural	<u> X </u>	Exploration/ settlement	<u> </u>	Science/ invention	<u> </u>
The Arts	<u> </u>	Industry	<u> </u>	Social/ humanitarian	<u> </u>
Commerce	<u> </u>	Military	<u> </u>	Transportation	<u> </u>
Communication	<u> X </u>	Political	<u> </u>		
Community development	<u> X </u>				

9. Historical significance (include explanation of themes checked above)

At a town meeting held on April 11, 1859 it was voted to appropriate the sum of \$1,851 for the establishment of a Free Town Library. On December 1, 1859 the library opened for the delivery of books in a small room in the Town Hall.

In 1885, Rodney Wallace gave the City a building to contain the library and an art collection at a site he owned on Main Street at Newton Place. At the time it was built, this brick building was praised as one of the finest and most beautiful in the City. In 1899, in this building, the library had up one of the first children's rooms in the country. The children's rooms were replaced by a new Youth Library addition in 1950.

In 1964, George R. Wallace, Jr., gave the City \$500,000 which with Federal funds replaced the library building given by his grandfather as well as the adjacent Baptist Church (1854) with the present building. This opened in 1967 and was dedicated and named for George R. Wallace, Jr. and his wife Alice G. Wallace.

The present library is of a high quality of design and construction. It fits in well with its surroundings.

10. Bibliography and/or references (such as local histories, deeds, assessor's records, early maps, etc.)

Emerson, William A., Fitchburg, Mass., Past and Present, Fitchburg, Blanchard and Brown, 1887.

Kirkpatrick, Doris, The City and the River, Fitchburg Historical Society, 1971.

7. Original owner (if known) _____
 Original use _____
 Subsequent uses (if any) and dates _____

8. Themes (check as many as applicable)

- | | | | | | |
|-----------------------|-------|----------------------------|-------|-------------------------|-------|
| Aboriginal | _____ | Conservation | _____ | Recreation | _____ |
| Agricultural | _____ | Education | _____ | Religion | _____ |
| Architectural | _____ | Exploration/
settlement | _____ | Science/
invention | _____ |
| The Arts | _____ | Industry | _____ | Social/
humanitarian | _____ |
| Commerce | _____ | Military | _____ | Transportation | _____ |
| Communication | _____ | Political | _____ | | |
| Community development | _____ | | | | |

9. Historical significance (include explanation of themes checked above)

This building is very plain with various advertizing signs. The building helps provide a sense of closure to the southern side of the Monument Park Historic District and maintains the urban facade and character of Main Street.

10. Bibliography and/or references (such as local histories, deeds, assessor's records, early maps, etc.)

FORM B - BUILDING

MASSACHUSETTS HISTORICAL COMMISSION
Office of the Secretary, State House, Boston XVI

In Area no. A	Form no. 13
------------------	----------------



1. Town Fitchburg

Address 564 Main Street

Bassett Building

Use Institutional,
Leominster Area Rehab. & Work

Present owner North Worcester Co.,
for the Retarded.

Description:

c. 1910

Source Style

Use Commercial

Architect -

Exterior wall fabric Brick

Outbuildings (describe) None

Other features Copper entablature

Altered No Date _____

Moved No Date _____

5. Lot size:

One acre or less 19,043 Over one acre _____

Approximate frontage 120'

Approximate distance of building from street
0'

6. Recorded by Frank Garretson

Organization City Planning Office

Date February 1977

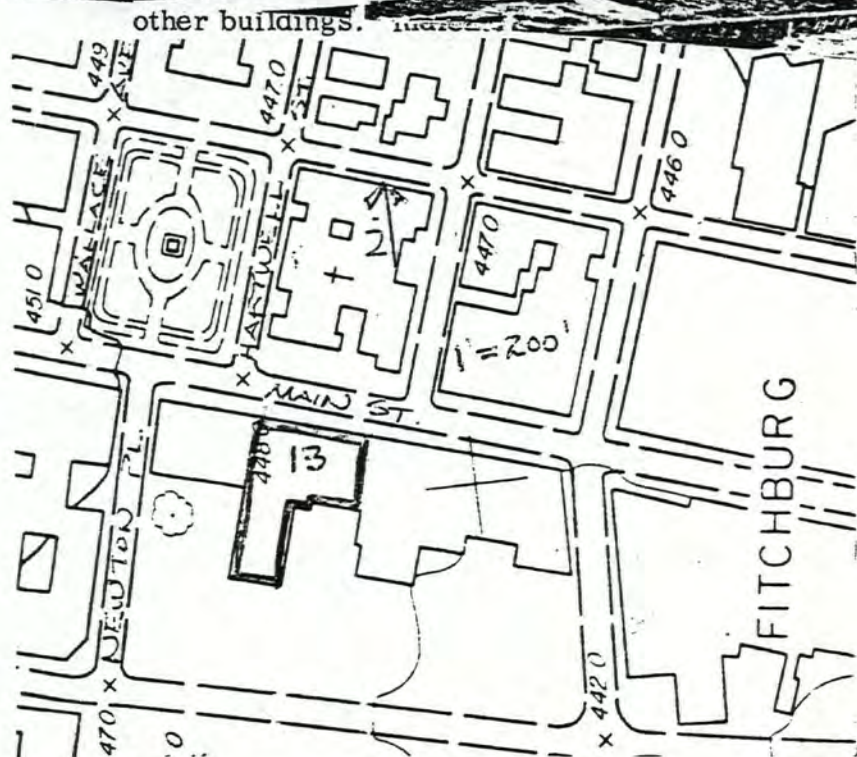

DO NOT WRITE IN THIS SPACE
USGS Quadrant _____

MHC Photo no. _____

7. Original owner (if known) -

Original use -

Subsequent uses (if any) and dates Sears Robuck Store

8. Themes (check as many as applicable)

- | | | | | | |
|-----------------------|-------------------------------------|----------------------------|--------------------------|-------------------------|--------------------------|
| Aboriginal | <input type="checkbox"/> | Conservation | <input type="checkbox"/> | Recreation | <input type="checkbox"/> |
| Agricultural | <input type="checkbox"/> | Education | <input type="checkbox"/> | Religion | <input type="checkbox"/> |
| Architectural | <input type="checkbox"/> | Exploration/
settlement | <input type="checkbox"/> | Science/
invention | <input type="checkbox"/> |
| The Arts | <input type="checkbox"/> | Industry | <input type="checkbox"/> | Social/
humanitarian | <input type="checkbox"/> |
| Commerce | <input checked="" type="checkbox"/> | Military | <input type="checkbox"/> | Transportation | <input type="checkbox"/> |
| Communication | <input type="checkbox"/> | Political | <input type="checkbox"/> | | |
| Community development | <input type="checkbox"/> | | | | |

9. Historical significance (include explanation of themes checked above)

This building is typical of the commercial building of the 1910's. Its fenestration, brickwork, and entablature are interesting and attractive. This building helps provide a sense of closure to the southern side of the Monument Park Historic District and maintains the urban facade and character of Main Street.

10. Bibliography and/or references (such as local histories, deeds, assessor's records, early maps, etc.)

FORM B - BUILDING

MASSACHUSETTS HISTORICAL COMMISSION XVI
Office of the Secretary, State House, Boston

In Area no. A	Form no. 14
------------------	----------------



City Fitchburg

Address 536-540 Main Street

Name -

Present use Commercial, Snow's and The Book Shop

Present owner Samuel A. Hornstein
George A. Snow

Description:

Approximate date c. 1940

Source Style

Use Commercial

Architect -

Exterior wall fabric Brick

Outbuildings (describe) None

Other features -

Altered No Date -

Moved No Date -

5. Lot size:

One acre or less 9565 Over one acre -

Approximate frontage 66'

Approximate distance of building from street 0'

6. Recorded by Frank Garretson

Organization City Planning Office

Date February 1977

Map. Draw sketch of building location in relation to nearest cross streets and other buildings. Indicate north.

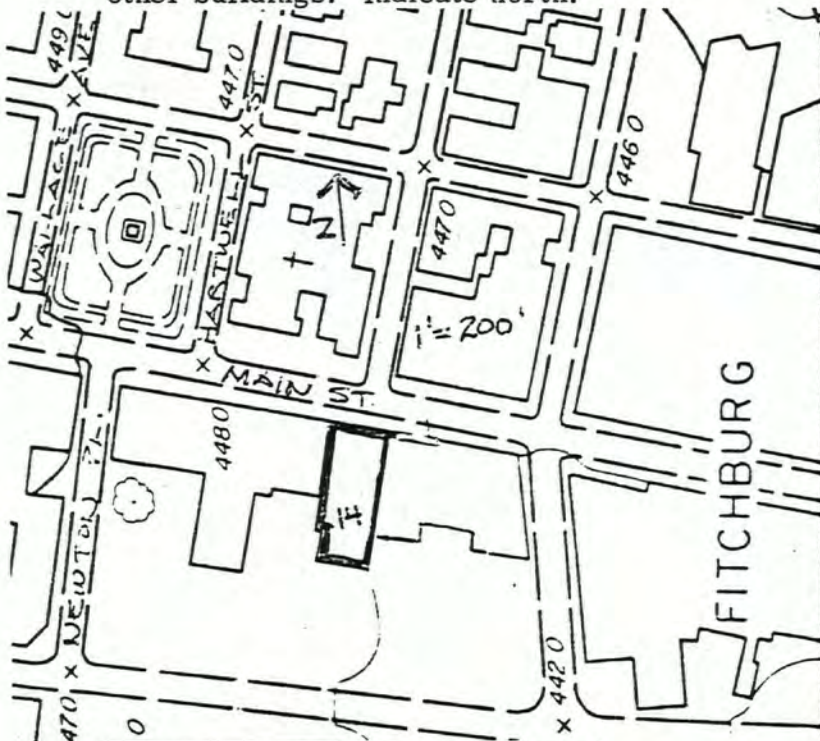

DO NOT WRITE IN THIS SPACE
USGS Quadrant _____
MHC Photo no. _____

7. Original owner (if known) _____ - _____

Original use Commercial

Subsequent uses (if any) and dates _____ - _____

8. Themes (check as many as applicable)

- | | | | | | |
|-----------------------|-------|----------------------------|-------|-------------------------|-------|
| Aboriginal | _____ | Conservation | _____ | Recreation | _____ |
| Agricultural | _____ | Education | _____ | Religion | _____ |
| Architectural | _____ | Exploration/
settlement | _____ | Science/
invention | _____ |
| The Arts | _____ | Industry | _____ | Social/
humanitarian | _____ |
| Commerce | _____ | Military | _____ | Transportation | _____ |
| Communication | _____ | Political | _____ | | |
| Community development | _____ | | | | |

9. Historical significance (include explanation of themes checked above)

This building is not historically important. This building helps provide a sense of closure to the southern side of the Monument Park Historic District and maintains the urban facade and character of Main Street.

10. Bibliography and/or references (such as local histories, deeds, assessor's records, early maps, etc.)

Monument Park Historic District
Fitchburg, Massachusetts

- Sketch Map with building numbers
- Map with key for photographs

Scale: 1"=200'

Source: Dept. of Public Works, Commonwealth of Mass.

Date: 1968

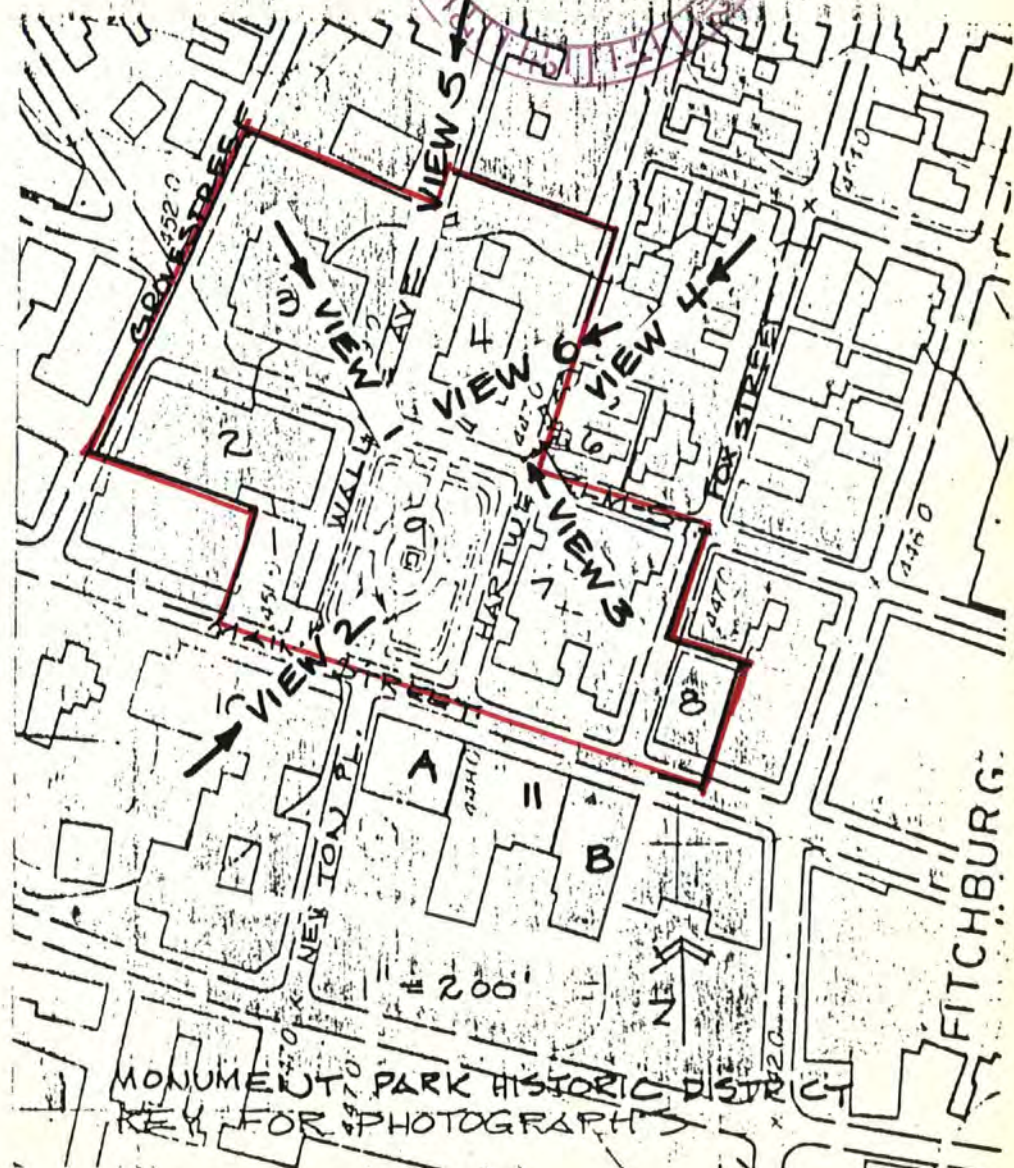
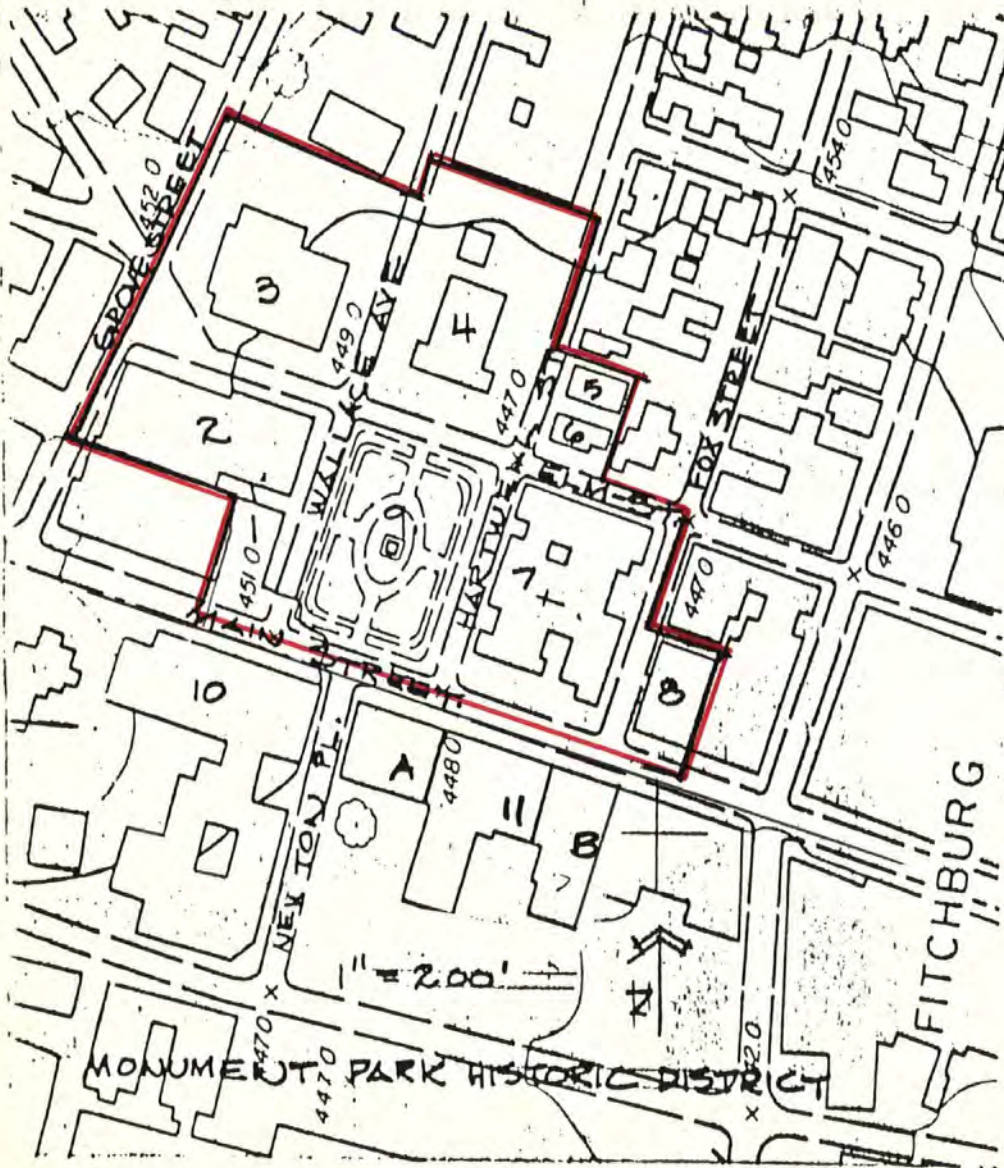

RECEIVED
MAY 2 1978
NATIONAL REGISTER

MAY 16 1978

Monument Park Historic District
Fitchburg, Massachusetts

- Sketch Map with building numbers
 - Map with key for photographs
- Scale: 1"=200'
Source: Dept. of Public Works, Commonwealth of Mass.
Date: 1968

RECEIVED
AUG 9 1977
NATIONAL REGISTER

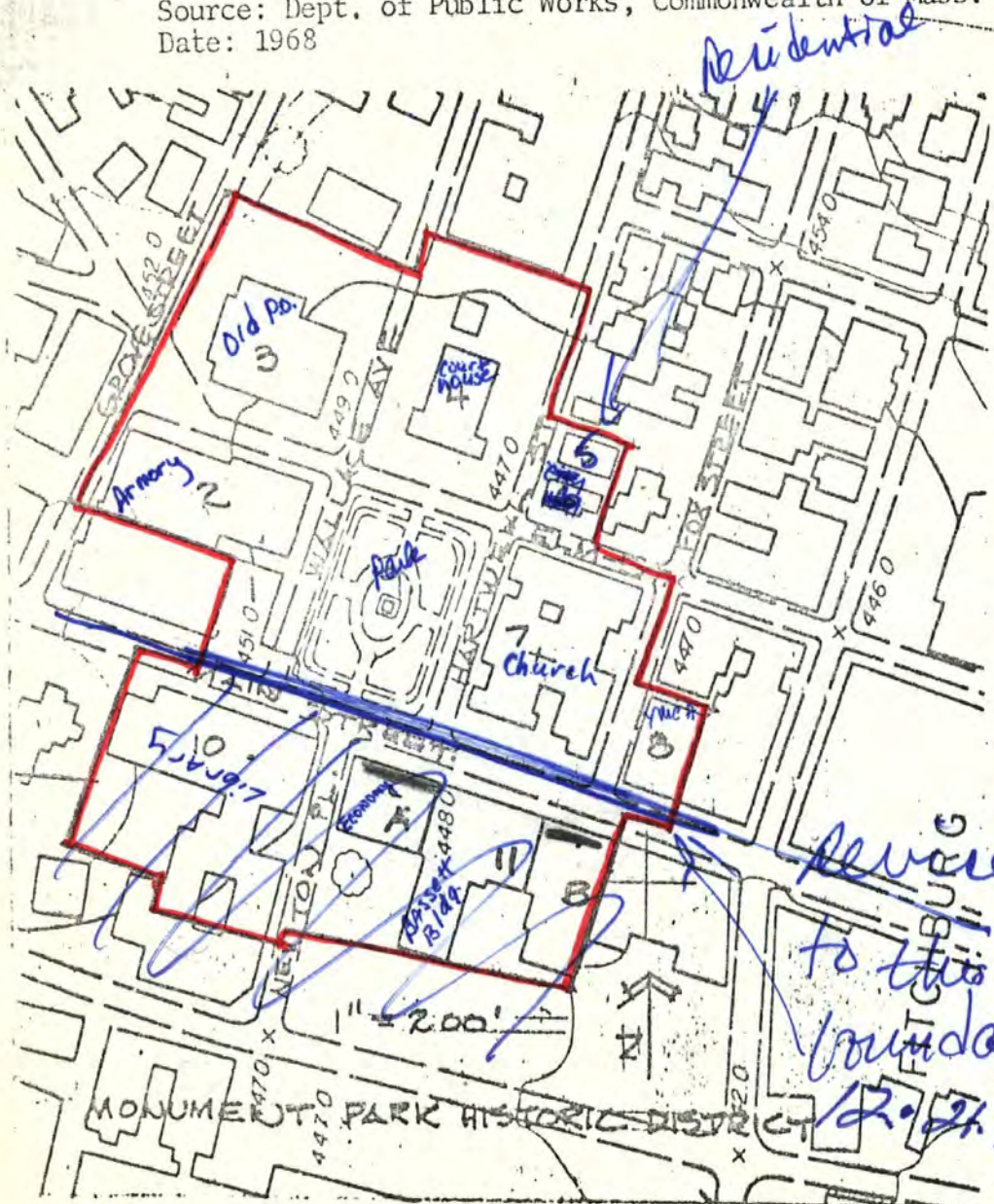

Residential

*Review
to this
boundary
12-21-77*



Handwritten notes in blue ink, possibly describing a survey or field observations. The text is partially obscured and difficult to read.



MAY 16 1978

Property Monument Park Historic District

State Mass.

Working Number 8.9.77.1265

Worcester

TECHNICAL

Photos 2
Maps 2

Signature ?

CONTROL

OK 8.10.77

HISTORIAN

maybe question obviously about the 1
end of square. Have called.

Sheffy
12-14-77

12-21-77 although that end of square has for 2 more 1920 century
steppents - nothing matches the grand, massiveness of the other sides.

ARCHITECTURAL HISTORIAN

question the need to include
Public library, commercial buildings A & B as long as the boundary excludes other intrusions
(which are not mentioned) adjacent to Bldgs 5, 6, & 8.

New map, UBO + sketch map
submitted accept
Bravham
10-26-77 5-2-78

Call for boundary justification + photos

ARCHEOLOGIST

Either we should suggest removal of that end or
make sure file covers clear description/analysis of
relative value of this side

Sheffy
accept - ?
12-21-77
accept as revised Sheffy
5-3-78

OTHER

HAER

Inventory _____
Review _____

REVIEW UNIT CHIEF

Rate 1944C governmental, residential,
and commercial bldgs flanking 3 sides
of park - 4th side excluded because of
intrusions

accept
labouch
5/8/78

BRANCH CHIEF

KEEPER

Perman
5/10/78

National Register Write-up _____
Federal Register Entry 6.6.78 Send-back _____
Re-submit _____

Entered MAY 16 1978

INT:2106-74



VIEW 5, MONUMENT PARK HISTORIC DISTRICT
WALLACE AVE.

XV

FITCHBURG, WORCESTER CO., MA

VIEW TOWARDS SOUTH

Monument Park Historic District
Fitchburg, Mass.

MAY 16 1978

1976

Frank Garretson

AUG 9 1977

Fitchburg City Hall

718 Main Street, Fitchburg 01420

#5

Wallace Ave., view toward south showing

Old Post Office (#3), Armory (#2), and

County Court (#4)

186

WORCESTER County

PROPERTY OF THE NATIONAL REGISTER

1976

Photograph #1

UNITED STATES DEPARTMENT OF THE INTERIOR
NATIONAL PARK SERVICE

NATIONAL REGISTER OF HISTORIC PLACES

PROPERTY PHOTOGRAPH FORM

(Type all entries - attach to or enclose with photograph)

STATE	
COUNTY	
FOR NPS USE ONLY	
ENTRY NUMBER	DATE
MAY 6 1976	

SEE INSTRUCTIONS

1. NAME

COMMON:	144 Pleasant Street
AND/OR HISTORIC:	same

2. LOCATION

STREET AND NUMBER:			
144 Pleasant Street			
CITY OR TOWN:			
Worcester			
STATE:	CODE	COUNTY:	CODE
Massachusetts		Worcester	

3. PHOTO REFERENCE

PHOTO CREDIT:	
DATE OF PHOTO:	July 1975
NEGATIVE FILED AT:	Worcester Heritage Society

4. IDENTIFICATION

DESCRIBE VIEW, DIRECTION, ETC.
Frontal view of structure Viewed from the North looking southerly





VIEW 2, MONUMENT PARK HISTORIC DISTRICT
MONUMENT PARK (#9)

XV

FITCHBURG, WORCESTER CO., MA

VIEW TOWARDS NORTHEAST

Monument Park Historic District
Fitchburg, Mass.
1976
Frank Garretson
Fitchburg City Hall
718 Main Street, Fitchburg 01420
#2
Civil War Monument in Monument Park.

MAY 16 1978

AUG 9 1977
296 Worcester County

PROPERTY OF THE NATIONAL REGISTER

1976

MAY 6 1976

Photograph #2

NATIONAL REGISTER OF HISTORIC PLACES

PROPERTY PHOTOGRAPH FORM

(Type all entries - attach to or enclose with photograph) -

SEE INSTRUCTIONS

1. NAME

COMMON: 10 Oxford Street

AND/OR HISTORIC: same

2. LOCATION

STREET AND NUMBER:

10 Oxford Street

CITY OR TOWN:

Worcester

STATE:

Massachusetts

CODE

COUNTY:

Worcester

CODE

3. PHOTO REFERENCE

PHOTO CREDIT: Susan Ceccacci

DATE OF PHOTO: July 1975

NEGATIVE FILED AT:

Worcester Heritage Society

4. IDENTIFICATION

DESCRIBE VIEW, DIRECTION, ETC.

Frontal and south side view of structure
Viewed from west looking northeasterly
(rear and west side view of 144 Pleasant St. also,
looking northerly)

24/2

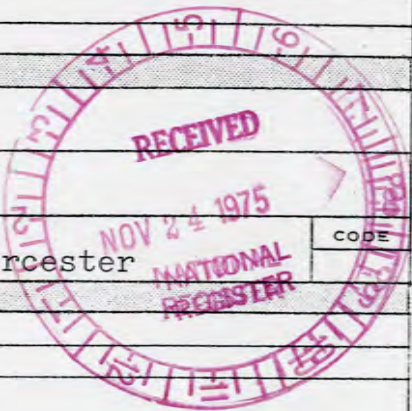



VIEW 3, MONUMENT PARK HISTORIC DISTRICT
COUNTY COURT HOUSE (BLDG. #4)
FITCHBURG, WORCESTER CO., MA
EAST ELEV.

XV

Monument Park Historic District

Fitchburg, Mass.

1976

MAY 16 1978

Frank Garretson

Fitchburg City Hall

718 Main Street, Fitchburg 01420

#3 County Court House, East elevation

3 of 6

AUG 9 1977
Worcester County

PROPERTY OF THE NATIONAL REGISTER

PROPERTY OF THE NATIONAL REGISTER

1976

Photograph #3

UNITED STATES DEPARTMENT OF THE INTERIOR
NATIONAL PARK SERVICE

NATIONAL REGISTER OF HISTORIC PLACES

PROPERTY PHOTOGRAPH FORM

(Type all entries - attach to or enclose with photograph)

STATE	
COUNTY	
FOR NPS USE ONLY	
ENTRY NUMBER	DATE
MAY 6 1975	

SEE INSTRUCTIONS

1. NAME			
COMMON:	14 Oxford Street		
AND/OR HISTORIC:	same		
2. LOCATION			
STREET AND NUMBER:			
14 Oxford Street			
CITY OR TOWN:			
Worcester			
STATE:	CODE	COUNTY:	CODE
Massachusetts		Worcester	
3. PHOTO REFERENCE			
PHOTO CREDIT:	Susan Ceccacci		
DATE OF PHOTO:	July 1975		
NEGATIVE FILED AT:	Worcester Heritage Society		
4. IDENTIFICATION			
DESCRIBE VIEW, DIRECTION, ETC.			
Frontal view of structure Viewed from the west			

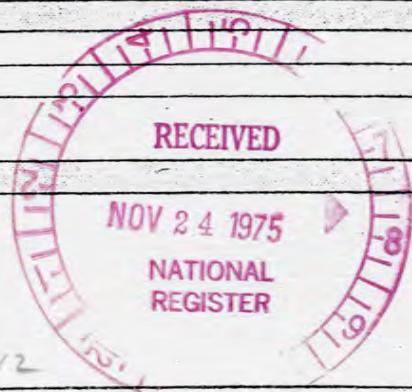

3-12



VIEW 6, MONUMENT PARK HISTORIC DISTRICT
ARMORY (BLDG. #2)

XV

FITCHBURG, # WORCESTER CO., MA

EAST ELEV.

Monument Park Historic District
Fitchburg, Mass.

MAY 16 1978

1976

Frank Garretson

Fitchburg City Hall

718 Main Street, Fitchburg 01420

#6
Armory, east elevation

AUG 9 1977

496

Worcester County

PROPERTY OF THE NATIONAL REGISTER

1976

Photograph #4

UNITED STATES DEPARTMENT OF THE INTERIOR
NATIONAL PARK SERVICENATIONAL REGISTER OF HISTORIC PLACES
PROPERTY PHOTOGRAPH FORM

(Type all entries - attach to or enclose with photograph)

STATE	
COUNTY	
FOR NPS USE ONLY	
ENTRY NUMBER	DATE
MAY 6 1976	

SEE INSTRUCTIONS

1. NAME			
COMMON:	Oxford Street		
AND/OR HISTORIC:	same		
2. LOCATION			
STREET AND NUMBER:			
Oxford Street			
CITY OR TOWN:			
Worcester			
STATE:	CODE	COUNTY:	CODE
Massachusetts		Worcester	
3. PHOTO REFERENCE			
PHOTO CREDIT:	Susan Ceccacci		
DATE OF PHOTO:	July 1975		
NEGATIVE FILED AT:	Worcester Heritage Society		
4. IDENTIFICATION			
DESCRIBE VIEW, DIRECTION, ETC.			
Streetscape, frontal views of 10 and 14 Oxford Street viewed from the South			

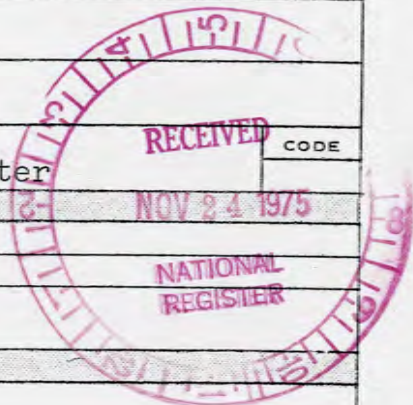

✓ 12



VIEW 4, MONUMENT PARK HISTORIC DISTRICT
MONUMENT PARK (#9)

FITCHBURG, WORCESTER CO, MA

VIEW TOWARDS SOUTH WEST

Monument Park Historic District
Fitchburg, Mass.

1976

Frank Garretson

MAY 16 1978

Fitchburg City Hall

718 Main Street, Fitchburg 01420

#4

Monument Park, view toward southwest

AUG 9 1977

596

Worcester County

XV

PROPERTY OF THE NATIONAL REGISTER

1976

Photograph #5

UNITED STATES DEPARTMENT OF THE INTERIOR
NATIONAL PARK SERVICE

NATIONAL REGISTER OF HISTORIC PLACES
PROPERTY PHOTOGRAPH FORM

(Type all entries - attach to or enclose with photograph)

STATE	
COUNTY	
FOR NPS USE ONLY	
ENTRY NUMBER	DATE
	MAY 6 1976

SEE INSTRUCTIONS

1. NAME			
COMMON:		Oxford Street School	
AND/OR HISTORIC:		same	
2. LOCATION			
STREET AND NUMBER:			
3 Oxford Street			
CITY OR TOWN:			
Worcester			
STATE:	CODE	COUNTY:	CODE
Massachusetts		Worcester	
3. PHOTO REFERENCE			
PHOTO CREDIT:		Susan Ceccacci	
DATE OF PHOTO:		July 1975	
NEGATIVE FILED AT:		Worcester Heritage Society	
4. IDENTIFICATION			
DESCRIBE VIEW, DIRECTION, ETC.			
Front and Eastside view of structure viewed from the Northeast			

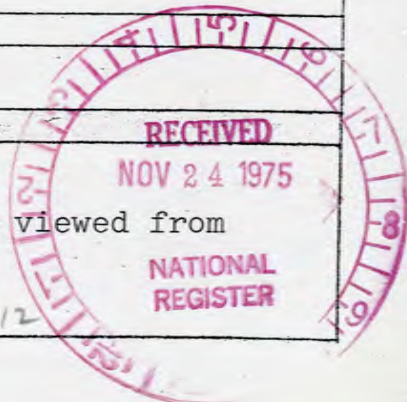



VIEW 1, MONUMENT PARK HISTORIC DISTRICT
CHRIST CHURCH (BLDG.#7)
FITCHBURG, WORCESTER CO., MA.
WEST ELEV.

XV

Monument Park Historic District
Fitchburg, Mass.

1976

Frank Garretson

Fitchburg City Hall

718 Main Street, Fitchburg, 01420

#1

Christ Church, west elevation.

MAY 16 1978

696

WORCESTER County

AUG 9 1977

PROPERTY OF THE NATIONAL REGISTER

1976

Photograph #6

UNITED STATES DEPARTMENT OF THE INTERIOR
NATIONAL PARK SERVICE

NATIONAL REGISTER OF HISTORIC PLACES

PROPERTY PHOTOGRAPH FORM

(Type all entries - attach to or enclose with photograph)

STATE	
COUNTY	
FOR NPS USE ONLY	
ENTRY NUMBER	DATE
	MAY 6 1976

SEE INSTRUCTIONS

1. NAME			
COMMON:	Oxford Street School		
AND/OR HISTORIC:	same		
2. LOCATION			
STREET AND NUMBER:			
3 Oxford Street			
CITY OR TOWN:			
Worcester			
STATE:	CODE	COUNTY:	CODE
Massachusetts		Worcester	
3. PHOTO REFERENCE			
PHOTO CREDIT:	Susan Ceccacci		
DATE OF PHOTO:	July 1975		
NEGATIVE FILED AT:	Worcester Heritage Society		
4. IDENTIFICATION			
DESCRIBE VIEW, DIRECTION, ETC.			
Front and westside view of structure Viewed from the northwest			

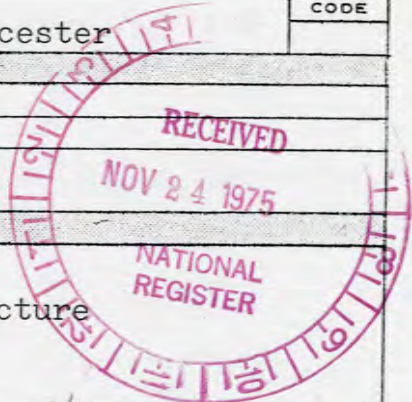

62/12

Photograph #7

UNITED STATES DEPARTMENT OF THE INTERIOR
NATIONAL PARK SERVICE

NATIONAL REGISTER OF HISTORIC PLACES
PROPERTY PHOTOGRAPH FORM

(Type all entries - attach to or enclose with photograph)

STATE	
COUNTY	
FOR NPS USE ONLY	
ENTRY NUMBER	DATE
	MAY 6 1976

SEE INSTRUCTIONS

1. NAME			
COMMON:	15 Oxford Street		
AND/OR HISTORIC:	same		
2. LOCATION			
STREET AND NUMBER:	15 Oxford Street		
CITY OR TOWN:	Worcester		
STATE:	CODE	COUNTY:	CODE
Massachusetts		Worcester	
3. PHOTO REFERENCE			
PHOTO CREDIT:	Susan Ceccacci		
DATE OF PHOTO:	July 1975		
NEGATIVE FILED AT:	Worcester Heritage Society		
4. IDENTIFICATION			
DESCRIBE VIEW, DIRECTION, ETC.			
Front and north side view of structure Viewed from the northeast			

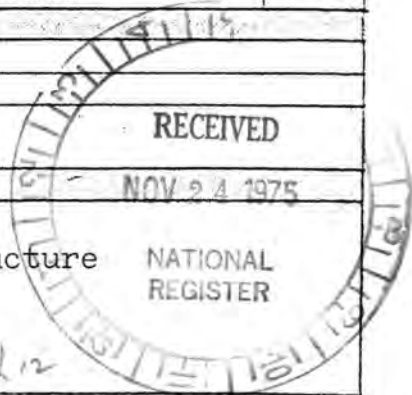

Photograph #8

UNITED STATES DEPARTMENT OF THE INTERIOR
NATIONAL PARK SERVICE

NATIONAL REGISTER OF HISTORIC PLACES

PROPERTY PHOTOGRAPH FORM

(Type all entries - attach to or enclose with photograph)

STATE	
COUNTY	
FOR NPS USE ONLY	
ENTRY NUMBER	DATE
MAY 6 1976	

SEE INSTRUCTIONS

1. NAME

COMMON: 19 Oxford Street

AND/OR HISTORIC: same

2. LOCATION

STREET AND NUMBER:

19 Oxford Street

CITY OR TOWN:

Worcester

STATE:

Massachusetts

CODE

COUNTY:

Worcester

CODE

3. PHOTO REFERENCE

PHOTO CREDIT: Susan Ceccacci

DATE OF PHOTO: July 1975

NEGATIVE FILED AT:

Worcester Heritage Society

4. IDENTIFICATION

DESCRIBE VIEW, DIRECTION, ETC.

Front and south side view of structure
Viewed from the southeast

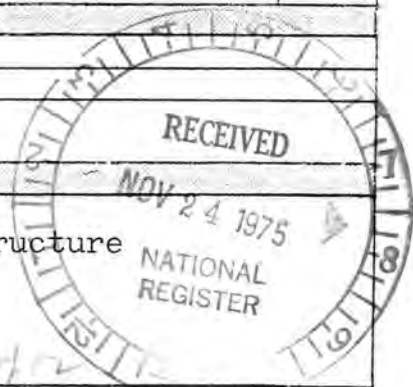

UNITED STATES DEPARTMENT OF THE INTERIOR
NATIONAL PARK SERVICE

Photograph #9

NATIONAL REGISTER OF HISTORIC PLACES

PROPERTY PHOTOGRAPH FORM

(Type all entries - attach to or enclose with photograph)

STATE	
COUNTY	
FOR NPS USE ONLY	
ENTRY NUMBER	DATE
MAY 6 1976	

SEE INSTRUCTIONS

1. NAME			
COMMON:		Worcester New School	
AND/OR HISTORIC:		Friend's Meeting House	
2. LOCATION			
STREET AND NUMBER:			
25 Oxford Street			
CITY OR TOWN:			
Worcester			
STATE:	CODE	COUNTY:	CODE
Massachusetts		Worcester	
3. PHOTO REFERENCE			
PHOTO CREDIT:		Susan Ceccacci	
DATE OF PHOTO:		July 1975	
NEGATIVE FILED AT:		Worcester Heritage Society	
4. IDENTIFICATION			
DESCRIBE VIEW, DIRECTION, ETC.			
Front and south side view of structure Viewed from the southeast			

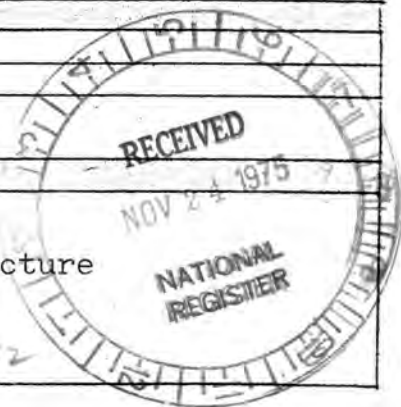

9412

Photograph #10

UNITED STATES DEPARTMENT OF THE INTERIOR
NATIONAL PARK SERVICE

NATIONAL REGISTER OF HISTORIC PLACES

PROPERTY PHOTOGRAPH FORM

(Type all entries - attach to or enclose with photograph)

STATE	
COUNTY	
FOR NPS USE ONLY	
ENTRY NUMBER	DATE
	MAY 6 1976

SEE INSTRUCTIONS

1. NAME

COMMON: Crown Street

AND/OR HISTORIC: same

2. LOCATION

STREET AND NUMBER:

Crown Street

CITY OR TOWN:

Worcester

STATE:

Massachusetts

CODE

COUNTY:

Worcester

CODE

3. PHOTO REFERENCE

PHOTO CREDIT: Susan Ceccacci

DATE OF PHOTO: July 1975

NEGATIVE FILED AT: Worcester Heritage Society

4. IDENTIFICATION

DESCRIBE VIEW, DIRECTION, ETC.

Streetscape, frontal views of 1, 3, 5, and 7 Crown Street
Viewed from the north

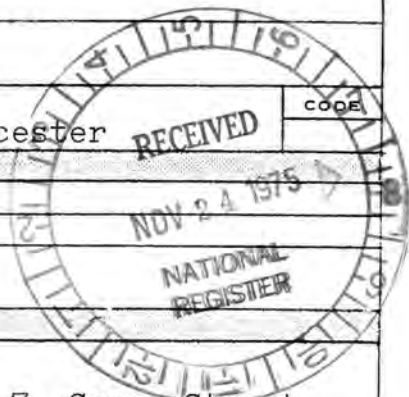

10712

UNITED STATES DEPARTMENT OF THE INTERIOR
NATIONAL PARK SERVICE

Photograph #11

NATIONAL REGISTER OF HISTORIC PLACES

PROPERTY PHOTOGRAPH FORM

(Type all entries - attach to or enclose with photograph)

STATE	
COUNTY	
FOR NPS USE ONLY	
ENTRY NUMBER	DATE
MAY 6 1976	

SEE INSTRUCTIONS

1. NAME			
COMMON:	7 Crown Street		
AND/OR HISTORIC:	same		
2. LOCATION			
STREET AND NUMBER:			
7 Crown Street			
CITY OR TOWN:			
Worcester			
STATE:	CODE	COUNTY:	CODE
Massachusetts		Worcester	
3. PHOTO REFERENCE			
PHOTO CREDIT:	Susan Ceccacci		
DATE OF PHOTO:	July 1975		
NEGATIVE FILED AT:	Worcester Heritage Society		
4. IDENTIFICATION			
DESCRIBE VIEW, DIRECTION, ETC.			
<p>Front view and north side view of structure Viewed from the northwest</p> <p style="text-align: right;">114/12</p>			

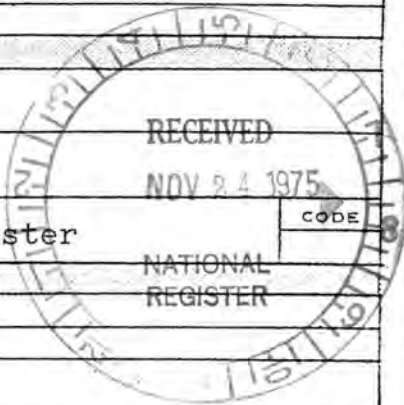

Photograph #12

UNITED STATES DEPARTMENT OF THE INTERIOR
NATIONAL PARK SERVICE

NATIONAL REGISTER OF HISTORIC PLACES
PROPERTY PHOTOGRAPH FORM

(Type all entries - attach to or enclose with photograph)

STATE	
COUNTY	
FOR NPS USE ONLY	
ENTRY NUMBER	DATE
MAY 6	1976

SEE INSTRUCTIONS

1. NAME			
COMMON:	2 Congress Street		
AND/OR HISTORIC:	same		
2. LOCATION			
STREET AND NUMBER:			
2 Congress Street			
CITY OR TOWN:			
Worcester			
STATE:	CODE	COUNTY:	CODE
Massachusetts		Worcester	
3. PHOTO REFERENCE			
PHOTO CREDIT:	Susan Ceccacci		
DATE OF PHOTO:	July 1975		
NEGATIVE FILED AT:	Worcester Heritage Society		
4. IDENTIFICATION			
DESCRIBE VIEW, DIRECTION, ETC.			
Front and east side view of structure Viewed from the South			

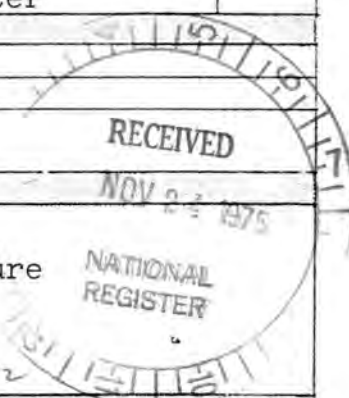

Missing Core Documentation

Property Name	County, State	Reference Number
Monument Park Historic District	Worcester County, Massachusetts	78000478

The following Core Documentation is missing from this entry:

Nomination Form

Photographs (missing #7-12)

USGS Map

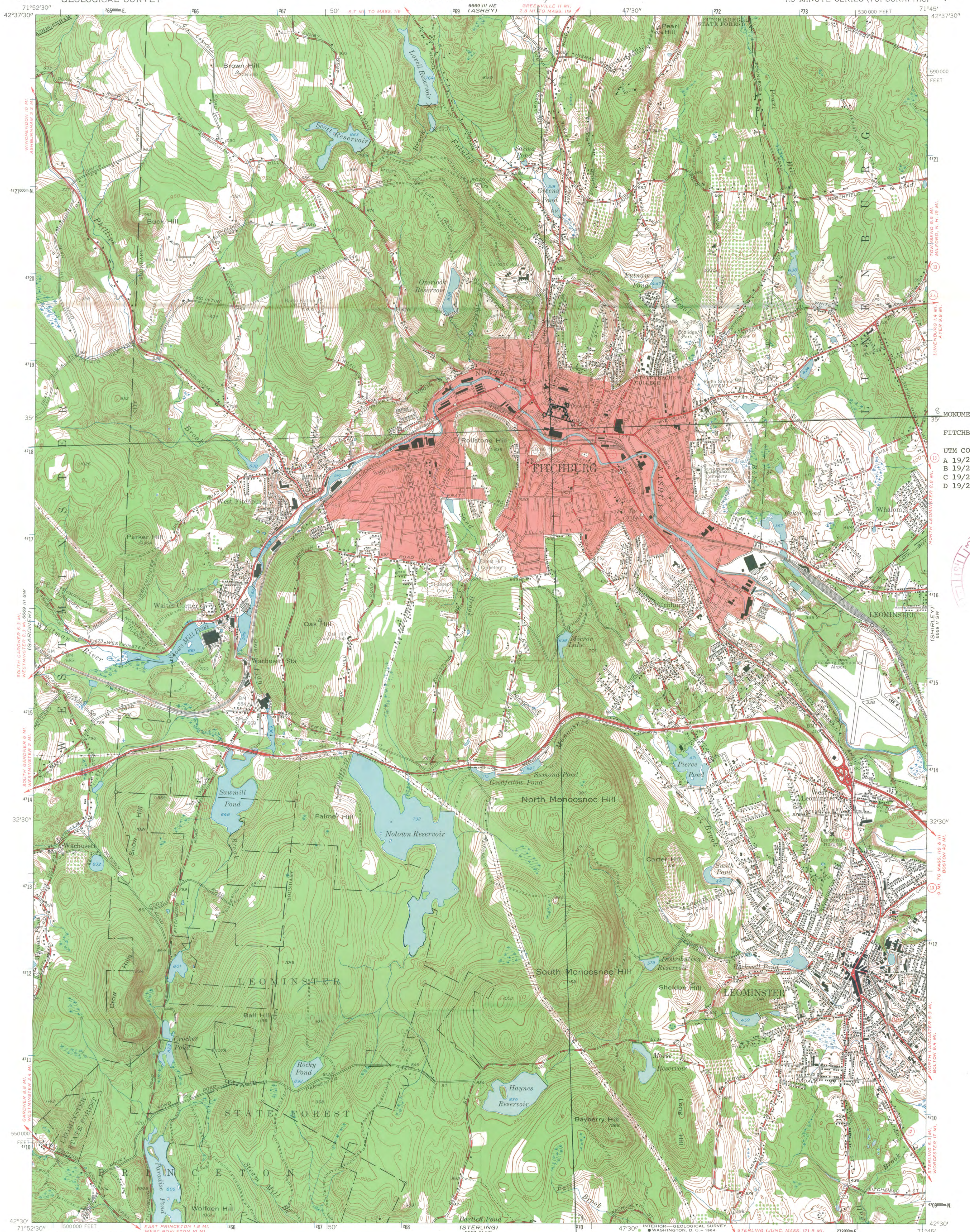

MONUMENT PARK HISTORIC DISTRICT
FITCHBURG, MASSACHUSETTS

UTM COORDINATES:
A 19/270 010/4718 280
B 19/270 180/4718 240
C 19/270 230/4718 080
D 19/269 960/4718 170



Mapped, edited, and published by the Geological Survey
Control by USGS, USC&GS, and Massachusetts Geodetic Survey
Culture and drainage in part compiled from aerial photographs taken 1938. Topography by planetable surveys 1943-1944
Revised 1954
Polyconic projection. 1927 North American datum
10,000-foot grid based on Massachusetts (Mainland) coordinate system
Red tint indicates area in which only landmark buildings are shown
1000-meter Universal Transverse Mercator grid ticks, zone 19, shown in blue

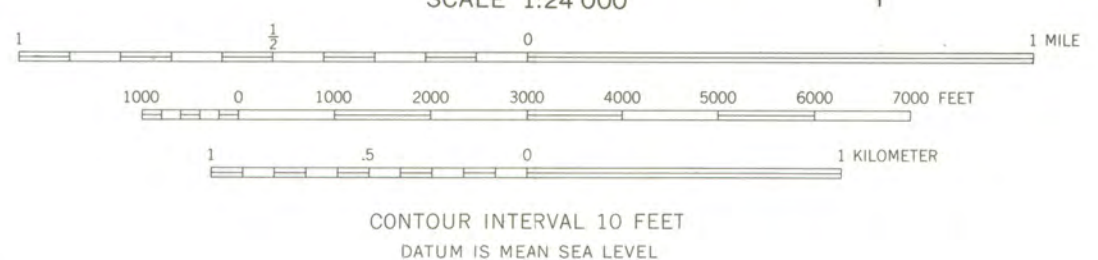
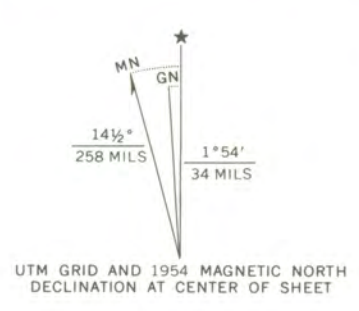

ROAD CLASSIFICATION

Heavy-duty	Light-duty
Medium-duty	Unimproved dirt

U.S. Route State Route

QUADRANGLE LOCATION

FITCHBURG, MASS.
N 4230—W 7145/7.5

44

THIS MAP COMPLIES WITH NATIONAL MAP ACCURACY STANDARDS
FOR SALE BY U. S. GEOLOGICAL SURVEY, WASHINGTON 25, D. C.
A FOLDER DESCRIBING TOPOGRAPHIC MAPS AND SYMBOLS IS AVAILABLE ON REQUEST

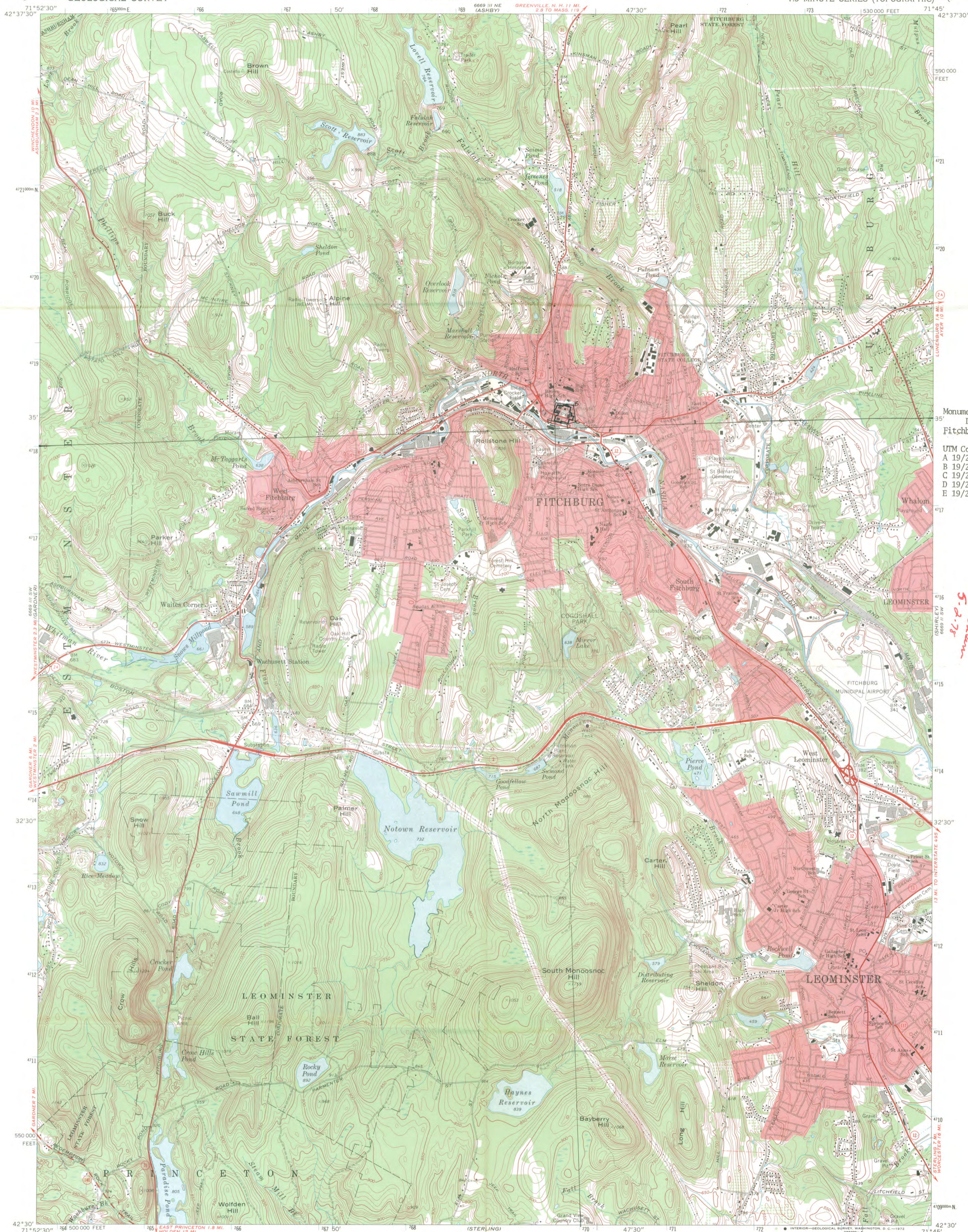

Monument Park Historic District
Fitchburg, Massachusetts

UTM Coordinates:
A 19/270 020/4718 300
B 19/270 220/4718 260
C 19/270 240/4718 080
D 19/270 150/4718 040
E 19/269 960/4718 090

*See map
of May 2, 1978
Branham
5-2-78*

Mapped, edited, and published by the Geological Survey
Control by USGS, USC&GS, and Massachusetts Geodetic Survey
Planimetry by photogrammetric methods from aerial photographs
taken 1938. Topography by planimetric surveys 1943 and 1944
Revised from aerial photographs taken 1968. Field checked 1970
Polyconic projection. 1927 North American datum
10,000-foot grid based on Massachusetts coordinate system,
mainland zone
1000-meter Universal Transverse Mercator grid ticks,
zone 19, shown in blue
Fine red dashed lines indicate selected fence and field lines where
generally visible on aerial photographs. This information is unchecked
Red tint indicates areas in which only landmark buildings are shown

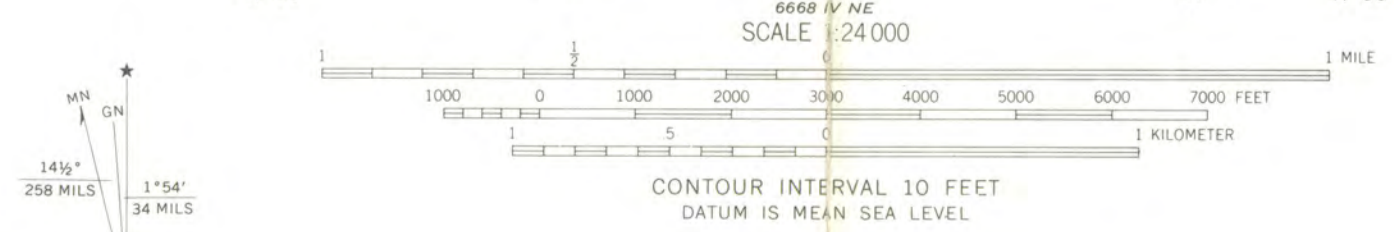

ROAD CLASSIFICATION
Primary highway, all weather, hard surface
Secondary highway, all weather, hard surface
Light-duty road, all weather, improved surface
Unimproved road, fair or dry weather



THIS MAP COMPLIES WITH NATIONAL MAP ACCURACY STANDARDS
FOR SALE BY U.S. GEOLOGICAL SURVEY, WASHINGTON, D.C. 20242
A FOLDER DESCRIBING TOPOGRAPHIC MAPS AND SYMBOLS IS AVAILABLE ON REQUEST



TELEPHONE REPORT

1. CALL TO: FROM (Name)

2. ADDRESS (Tel. No. if needed)

~~Blaine~~ Mallory
Joe Orfanit

3. SUBJECT/PROJECT NO./ETC.

Monument Park Historic District

4. DETAILS OF DISCUSSION

Do you ~~want~~ ^{consider} # 10, A, + B

intrusions - in contributing elements

Explanation of boundary

Joe indicated major disagreement within staff & community

- he doesn't think ~~any~~ buildings on that side of street contributing
- Saw likes library
- Rest of staff thought that side needed to make square complete.

He will send photo copies of buildings & we can decide whether we like boundaries

NAME OF PERSON PLACING/RECEIVING CALL

TITLE

OFFICE

Sheffy

Date: 12/14/77

TO: M. SHERY, NR FROM: J. ORFANT, MAC

- For your information, then file
- Your comments please
- Review and file
- Review and return to me
- Please reply
- Review and forward to: _____
- Please draft a reply for my signature
-

Comments/Reply...

HOPE THIS IS SOME HELP!
IF YOU HAVE ANY QUESTIONS
CALL.

- Joe O.

DATE 12.21.77

TELEPHONE REPORT

TIME OF CALL AM PM

1. CALL TO: FROM (Name)

Joe Orfant

2. ADDRESS (Tel. No. if needed)

Mass His. Comm.

3. SUBJECT, PROJECT NO., ETC.

Monument Park Historic District
Fitchburg, Mass

4. DETAILS OF DISCUSSION

Discussed the exclusion of buildings south of Main Street that includes 19605 library and 4 commercial buildings - ~~top~~ (3 do not contribute to District.).

Joe agreed to changes and will submit new sketch map, topo, and U. B. D.

NAME OF PERSON PLACING/RECEIVING CALL

Bravham

TITLE

~~Arch~~ Arch His

OFFICE

N.R.



The Commonwealth of Massachusetts

Office of the Secretary

Massachusetts Historical Commission

Secretary of the
Commonwealth

294 Washington Street Boston, Massachusetts 02108

(617) 727-8470

April 27, 1978

Mr. William Brabham
National Register of Historic Places
Department of the Interior
Washington, D.C. 20240



Dear Bill,

Enclosed are the revised sketch map, USGS map and verbal boundary description which you requested for the Monument Park Historic District in Fitchburg Massachusetts. I have also included a new list of property owners and key to the sketch map. As you discussed with Joe Orfant, properties #10, 11, A and B have been excluded. I hope that this information will be sufficient.

We would very much appreciate your giving this nomination special attention. May has been declared preservation month by the governor of the Commonwealth and several special events have been scheduled. We would like to arrange a ceremony in Fitchburg on May 23 at which we could present the certificate for this district.

If I can do anything to expedite this nomination, please let me know as soon as possible.

Sincerely,

Candace Jenkins

Candace Jenkins
National Register Coordinator
Massachusetts Historical Commission

/cj

MAY 2 1978

THE NATIONAL REGISTER OF HISTORIC PLACES

MAY 1 1978

DATE RECD _____

_____ (OFFICE OF THE SUPERVISOR)

_____ (OFFICE OF THE SUPERVISOR)

_____ (OFFICE OF THE SUPERVISOR)

DATE ADDED _____

INITIALS _____

ENTRIES IN THE NATIONAL REGISTER

STATE MASSACHUSETTS

Date Entered MAY 16 1978

Name

Location

Monument Park Historic District

Fitchburg
Worcester County

Also Notified

Hon. Edward M. Kennedy

Hon. Edward W. Brooke

Hon. Robert F. Drinan

State Historic Preservation Officer
Mrs. Patricia L. Weslowski
Executive Director, Massachusetts
Historical Commission
294 Washington Street
Boston, Massachusetts 02108

NR Mott 5/17/78

NATIONAL REGISTER DATA SHEET

① NAME as it appears on federal register: Monument Park Historic District
 ② OTHER NAMES: Monument Park Area
 ③ date of entry: MAY 16 1978
 ④ county code:

⑤ LOCATION street & number: See reverse side
 city / town: Fitchburg
 vicinity of:
 state: MA
 county: Worcester
 ⑥ NPS REGION: North Atlantic

⑦ OWNER PRIVATE STATE MUNICIPAL COUNTY MULTIPLE FEDERAL (agency name)
 ⑧ ADMINISTRATOR:

⑨ EXISTING SURVEYS RAS HAEQ NHL FUNDED? YES NO
 ⑩ CONGRESS DISTRICT: 4th
 ⑪ COURTESY NOMINATION TITLE: TITLE DEED
 if title who provided title:

⑫ WITHIN NATIONAL REGISTERED HISTORIC DISTRICT? YES NAME: NO
 ⑬ WITHIN NATIONAL HISTORIC LANDMARK? YES NAME: NO
 ⑭ ACRES: 10
 LOCAL PRIVATE ORGANIZATION

⑮ CONDITION deteriorated altered original site
 excellent ruins unaltered moved
 good unexposed reconstructed unknown
 fair unexcavated excavated
 ⑯ features SUBSTANTIALLY INTACT-2 SUBSTANTIALLY INTACT-3
 NOT INTACT-0 MODIFIED-0
 UNKNOWN-0 DRAINED-5
 NOT APPLICABLE-7 NOT APPLICABLE-8
 NOT APPLICABLE-9

⑰ ACCESS YES-Restricted YES-Unrestricted No Access Unknown
 ⑱ ADAPTIVE USE YES NO
 YES NO
 IS PROPERTY A HISTORIC DISTRICT? YES NO

⑲ AREAS OF SIGNIFICANCE:
 ARCHAEOLOGY-10 COMMERCE-4
 ARCHITECTURE-11 COMMUNICATIONS-12
 AGRICULTURE-3 CONSERVATION-8
 ARCHITECTURE-4 ECONOMICS-5
 ART-5 EDUCATION-10
 ENGINEERING-11 LANDSCAPE ARCH-12
 ENTERTAINMENT-10 LAW-10
 EXPLORATION-12 LITERATURE-13
 HEALTH-11 MILITARY-12
 INDUSTRY-13 MUSIC-13
 INVENTION-14 PHILOSOPHY-15
 COPIES-WAY-21
 RELIGION-22
 SCIENCE-10
 SOCIAL-HUMANITARIAN-24
 TRANSPORTATION-25
 MINERATION-26
 SETTLEMENT-26
 URBAN PLANNING-27
 OTHER SPECIFY:
 ⑳ CLAIMS explain:
 'first'
 'oldest'
 'only'

㉑ functions WHEN HISTORICALLY SIGNIFICANT: CURRENTLY:
 ㉒ dates of when constructed: MAJOR REPAIRS: HISTORIC DATES:
 ㉓ ETHNIC GROUP ASSOCIATION:

㉔ architectural style(s):
 ㉕ architect:
 ㉖ master builder:
 ㉗ engineer:

㉘ landscape architect / garden designer:
 ㉙ interior decorator:
 ㉚ artist:
 ㉛ artisan:
 ㉜ builder/contractor:

㉝ NAMES give role & date
 PERSONAL:
 EVENTS:
 INSTITUTIONAL:

㉞ NATIONAL REGISTER WRITE-UP

