

Iowa Site Inventory

Office of Historic Preservation
Iowa State Historical Department
East 12th & Grand Avenue
Des Moines, Iowa 50319

Site Number 102
District Name _____
Map Reference # 102

Identification

1. Site Name Round Barn, Cooper Twp., Monona County
 2. Village/Town/City Mapleton vic. Township Cooper County Monona
 3. Street Address IA 141
 4. Legal Location _____ 85 N _____ 42 W 33 W 1/2 of NE 1/4
Urban: subdivision block parcel subparcel
Rural: township range section 1/4 section of 1/4 section
 5. UTM Location: zone 15 easting 273,760 northing 4,667,970; Acreage less than one acre
 6. Owner(s) Name Earl Schelm
 7. Owner(s) Address R. R. #2 Mapleton Iowa 51034
(Street address) (City) (State) (Zip)
 8. Use: Present Gen'l purpose barn Original Sale barn

Description

9. Date of Construction 1921 Architect/Builder Seth Smith
 10. Building Type:
 single-family dwelling industrial other institutional religious
 multiple-family dwelling educational public agricultural
 commercial
 11. Exterior Walls: clapboard stone brick board and batten shingles stucco
 other _____
 12. Structural System: wood frame with interlocking joints wood frame with light members (balloon frame)
 masonry load-bearing walls iron frame steel frame with curtain walls reinforced concrete
 other _____
 13. Condition: excellent good fair deteriorated
 14. Integrity: original site moved—if so, when? _____
 Notes on alterations, additions (with dates and architect, if known) and any other notable features of building and site:
See reverse side.
 15. Related Outbuildings and Property: barn other farm structures carriage house garage privy
 other _____
 16. Is the building endangered? no yes—if so, why? _____
 17. Surroundings of the building: open land woodland scattered outbuildings densely built-up commercial
 industrial residential other _____

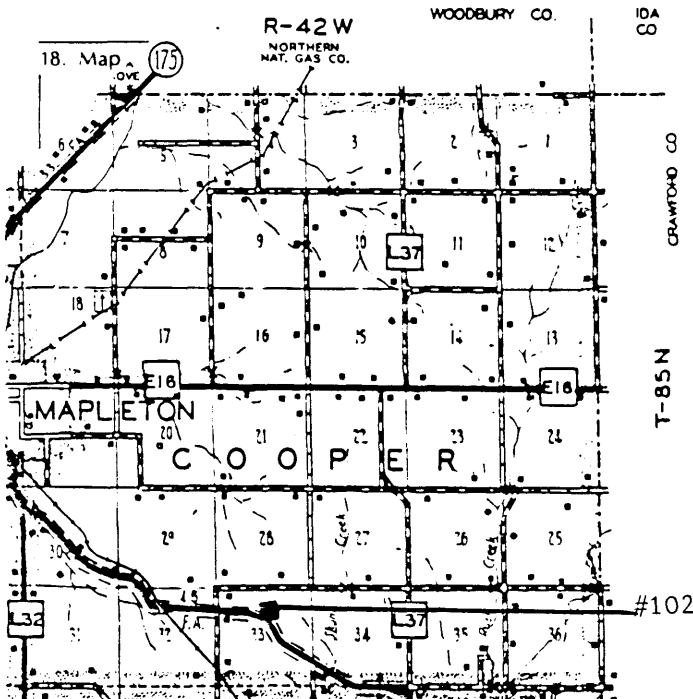

19. Photo Roll 604 Frame 3 View _____
 VBD: A circle 50' diameter based on center point of barn, excluding adjacent shed on one side.

MAY 27 1986

Significance (Indicate sources of information for all statements)

20. Architectural significance

- a. Key structure/individually may qualify for the National Register
- b. Contributing structure
- c. Not eligible/intrusion

N/A

Continuation of 14. Integrity.

Open interior ,Cone roof with asphalt shingles put on in 1972.

21. Historical Significance

Theme(s) Special Function; Farm Sale type.

- a. Key structure/individually may qualify for the National Register
- b. Contributing structure
- c. Not eligible/intrusion

"...A well known auctioneer had this barn built in 1921 in order to use it for selling his purebred cattle" (Soike 1983). The open plan and windows in the roof are identifying features of this type. The construction, in the early 20th century, of special function barns represented an important shift in the traditional use of barns.

22. Sources (for primary and secondary sources, give complete facts of publication: author, title, place of publication, date, etc.):

Earl Schelm, RR 2, Mapleton, IA 51034

Soike, Lowell J. Without Right Angles. Des Moines, Iowa: Iowa State Historical Department, Office of Historic Preservation, 1983.

Prepared by _____ Date _____
Address _____ Telephone _____
Organization _____

For Office of Historic Preservation Use Only

1. Office Information Sources on this Property

- County Resource File
- Windshield Survey
- National Register
- Grants-In-Aid: _____
- Determination of Eligibility

Review and Compliance Project:

- Other _____
- Other _____
- Other _____

2. Subject Traces

- a. _____
- b. _____
- c. _____
- d. _____
- e. _____

3. Photo Images _____

- _____
- _____
- _____
- _____
- _____