

KENTUCKY HISTORIC RESOURCES
Individual Inventory Form

Resource # 109
Shelby County

1. Name of Resource: Montgomery House		16. Date: Original Building 1830-1840 [7] Addition see Item #45 []	
2. Original Owner: Unknown		17. Style: Greek Rev. [] Settlement Vernacular [2V]	
3. Other Names: None		18. Architect/Builder: Unknown	
4. Prehistoric Site <input type="checkbox"/> Building <input checked="" type="checkbox"/> Object Historic Site <input type="checkbox"/> Structure <input type="checkbox"/> Other <input type="checkbox"/>		19. No. of Stories: 1 plus garret [1.0]	
5. Location: East side of Buzzard Roost Rd., 1 1/2 miles south of U.S. 60		20. Original Floor Plan: Center passage [CP]	
6. Owner's Name: Tyler Stratton [P]		21. Single Pile <input checked="" type="checkbox"/> Double Pile <input type="checkbox"/> N.A. <input type="checkbox"/>	
7. Owner's Address: Rte. 3, Box 526, Shelbyville, KY 40065		22. Roof Form & Material: Original <input checked="" type="checkbox"/> Gable, asphalt shingle Not Original <input type="checkbox"/>	
8. Evaluation: National Register [N]		23. Structural Material: Brick [B]	
9. Recognition & Date: Nat.Landmark _____ Local Landmark _____ Nat.Register _____ HABS/HAER _____ Highway Marker _____ KY Inventory 8-15-80 KY Landmark Certificate _____		24. Exterior Material: [] Brick, Flemish bond facade [B]	
10. N.R.Status & Date:		25. Foundation Material: Stone, coursed [S]	
11. N.R.Group: District Name: [] Mult.Resource Area: Shelby County [] Thematic Name: []		26. Major Alterations: None <input type="checkbox"/> Moved/Rebuilt <input type="checkbox"/> Other <input type="checkbox"/> x Additions <input checked="" type="checkbox"/>	
12. Historical Theme: Primary: Architecture [030] Secondary: [] Other: []		27. Special Features: Recessed front porch and detail	
13. Statement of Significance: This property is significant under criterion C as a well-preserved example of the early 19th century (1810-40) brick, 1-story, center-passage, single-pile plan in Shelby County. 17 such houses were identified from the period. This one is unique in possessing an [C]		28. Outbuildings: Non-contributing [NC]	
14. History: Property owned by William Montgomery in 1882.		29. Original Function: Residential/Domestic, single dwell [01A]	
		30. Present Use: As above [01A]	
		31. Condition: Excellent [E]	
		32. Endangered: Yes _____ No <input checked="" type="checkbox"/>	
		33. Attach Photos: Roll: Photo Nos: No. of Slides: 6 18 - 27 1	
15. Source of historical information and/or contact person: Measured drawings by Ed. Chappell and Gibson Worsham, 2-16-80. Atlas of Henry and Shelby Counties, KY, 1882.		34. Prepared by: C. Worsham	
		35. Organization: V, Shelby Co. Hist. Society	
		36. Date: March 1986	
		37. New Survey _____ Resurvey <input checked="" type="checkbox"/>	

KENTUCKY HISTORIC RESOURCES
Individual Inventory Form

Resource # 109

38. UTM Point of Primary Building: Zone Easting Northing 39. G.I.S. Mod. []
 Quadrant: Waddy 16 6 6 7 1 6 0 4 2 2 6 0 4 0 40. Coordi.Accuracy []

41. UTM Points of Boundary (for N. R. eligible sites only):

A. ----- D. -----
 B. ----- E. -----
 C. ----- F. -----

42. Total Acreage in Present Property: 140 43. Acreage included in proposed N.R. boundary: 43

44. Site Plan (and boundary description and justification for N.R. sites):

Beginning at A, south along a fence 90' to B, thence west 210' along the north side of the drive to C, thence north 90' continuing to follow the drive (on the east side) to D, thence east 210' along a property line to the point of origin. The boundaries were chosen to encompass the house and its domestic-related space defined by a fence, property line, and the drive. Included in the boundaries is a non-contributing frame, board and batten shed in a very poor state of repair. Outside the boundaries and also non-contributing is a frame barn.

Point A is the intersection of a treeline and fence-line in the northeast corner of the yard and is 68 feet northeast of the northeast corner of the dwelling's northernmost ell.

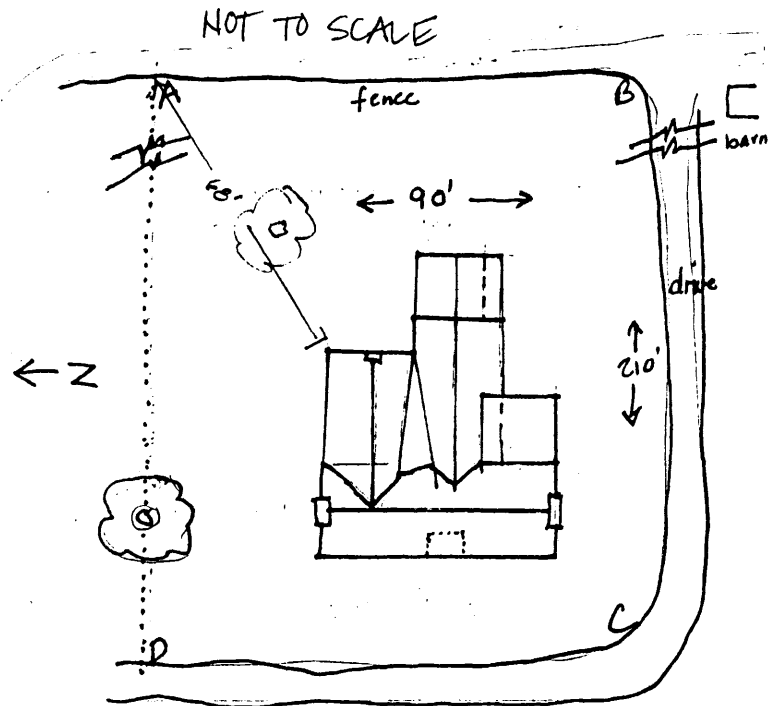

45. Description and House Plan: (for plan see page 4)

Exterior:

1-story, 5-bay, brick, center-passage, single-pile plan, Flemish bond principal (west) facade, common bond sides and rear, original recessed central porch: semi-circular fanlight set in flushboard supported by slender Doric wood columns, wood spandrels between columns and sides of porch opening, wood balustrade, horizontal and vertical panelled door with symmetrical trim and plain corner blocks, 3-pane sidelights with symmetrical trim and plain corner blocks have panelled aprons beneath and are flanked by attenuated engaged colonnettes on plinths, molded cornice and plain frieze which are recessed between colonnettes, doorway is framed by symmetrical trim with plain corner blocks, molded chair rail around sides of porch with panelled wainscot, plastered walls above chair rail, new wood benches; gabled roof, 3-course advanced brick cornice on principal facade, partially exterior end chimneys, jack arches, 9/6 sash, coursed stone foundation, brick appears to have been repointed ? on south gable end.

13. Statement of Significance: (continued)

elaborately detailed, recessed central porch. A 1-story, 1-room stone structure, now appended to the center-passage house, appears to pre-date the brick portions, which while built in various stages, all seem to date from 1830 to 1840. Part of the house's significance is its demonstration of a buildings enlargement over a short period of time.

45. Description and House Plan: (continued) (for plan see page 4)

1-story, 1-room stone section now attached to east of the center passage section appears to be the oldest structure on the site, pre-dating the brick portions; a 1-story, 1-room brick unit is appended to the west end of the stone building and appears to have been built at the same time as the center-passage section (it has a molded brick cornice) and probably served as a semi-detached kitchen, evidence suggests that a porch ran along the north side of the kitchen abutting the east side of the center-passage section and possibly opening into the passage, later a 1-story, brick ell was added to the east side of the north room of the center-passage section (north of the brick kitchen) and the porch was then enclosed; finally the space between the south room of the center-passage section and the brick kitchen was framed in. A cistern is located at the east gable end of the stone room.

Interior:

Center passage has symmetrical trim with plain corner blocks, south room of center passage has trim with architrive, a federal architrave mantel with Greek moldings, cupboards on the west side of the fireplace, and is the only room with splayed window reveals (in the west wall), north room of the center passage has symmetrical trim with plain corner blocks, a mantel with federal entablature supported by columns, but with Greek moldings, cupboards flank both sides of the fireplace, ell to the east of north room has federal form mantel and trim with Greek moldings; stair from former porch up into northeast ell, door made into window at east end of former porch, wall of beaded boards in framed-in section connecting south room to kitchen.

Outbuildings:

Non-contributing ruins of a frame, board and batten shed to east of house, non-contributing frame barn to southeast of house not included in boundaries.

The nominated area includes one contributing building.

