

KENTUCKY HISTORIC RESOURCES INVENTORY

Site No. Ja - L W - 3

1. Historic Name(s) <u>James, the Connells, house</u>		22. ADD/County <u>Bluegrass / Fayette</u>	
Original Owner <u>James Mc Connell</u>		23. U.S.G.S. Quadrant (15'/75') <u>Lexington West</u> G.I.S. Mod. <input type="checkbox"/>	
2. Present Name <u>The Connells Station (Francis Mc Connell's)</u>		24. UTM Reference <u>116 717200 4214880</u>	
3. Location <u>E of Foster Road on N side Old Frankfort Pike at Town Branch</u>		Zone Easting Northing	
4. Owner's Name <u>Central Rock Company</u>		25. Coordinate Accuracy <input type="checkbox"/>	
5. Owner's Address <u>1280 Old Frankfort Pike, Lexington, Ky 40504</u>		26. Prehistoric Site <input type="checkbox"/> Object Historic Site <input type="checkbox"/> Structure Building <input checked="" type="checkbox"/> Other <input type="checkbox"/>	
6. Open to Public Yes <input checked="" type="checkbox"/> No <input type="checkbox"/>	7. Visible from road Yes <input checked="" type="checkbox"/> No <input type="checkbox"/>	27. National Register District Name: <input type="checkbox"/>	
9. Local Contact/Organization		28. Significance Evaluation <input type="checkbox"/>	
8. Ownership Private <input checked="" type="checkbox"/> Local <input type="checkbox"/> State <input type="checkbox"/> Federal <input type="checkbox"/>		29. Status <input type="checkbox"/> Date National Landmark <input type="checkbox"/> National Register <input type="checkbox"/> Landmark Certificate <input type="checkbox"/> Kentucky Survey <input type="checkbox"/> Local Landmark <input type="checkbox"/> HABS/HAER <input type="checkbox"/>	
10. Site Plan with North Arrow <u>see attached boundary form</u>		30. Historic Theme Primary <u>Settlement</u> <input checked="" type="checkbox"/> <u>K</u> Secondary <u>Architecture</u> <input checked="" type="checkbox"/> <u>C</u> Other <input type="checkbox"/>	
11. Architect		31. Endangered Yes <input type="checkbox"/> No <input checked="" type="checkbox"/>	
12. Builder		32. Preservation Project Status <input type="checkbox"/>	
13. Date <u>late 18th C</u> A. <input checked="" type="checkbox"/> B. <input type="checkbox"/>		Actual Cost in \$1,000s <input type="checkbox"/>	
14. Style A. <u>Federal</u> <input checked="" type="checkbox"/> <u>B</u> B. <input type="checkbox"/>		33. ATTACH PHOTO <u>in attached envelope</u>	
15. Original Use <u>residence</u> <input checked="" type="checkbox"/> <u>a</u>			
16. Present use <u>laboratory</u>			
17. Condition <u>good - fair</u> <input checked="" type="checkbox"/> <u>C</u>			
18. Description <u>3 bay, 1 story dry stone house on high basement, built into earth bank. Attic windows in gables. (ph.4) Early style quarter round trim on W. end door; windows (ph.5) now have BR mitered corner frames; some 6/6 pane. Chippie tops rebuilt. Interior chimneys, each end.</u> (Continue on Back)		No. Stories <u>one</u> <input checked="" type="checkbox"/> <u>a</u> Single Pile <input checked="" type="checkbox"/> NA <input type="checkbox"/> Double Pile <input type="checkbox"/> Floor Plan <u>hall-parlor</u> <input checked="" type="checkbox"/> <u>E</u> Structural Fabric <u>stone</u> A. <input checked="" type="checkbox"/> B. <input type="checkbox"/> Decorative Fabric <input type="checkbox"/> A. <input type="checkbox"/> B. <input type="checkbox"/> Roof Form <u>gable</u>	
19. History <u>Built on site of the Connells Station by James Mc Connell, brother-in-law of Francis Mc Connell who was a founder of Lexington, killed by Indians. The Connells Station was the dwelling place of several early settlers during Indian danger years.</u>		Roll No. _____ Picture No. _____ Direction _____	
20. Significance <u>Early station during founding of Lexington. 1 of 2 early stone houses remaining in city.</u>		34. Prepared by: <u>C.M. Wooley</u>	
21. Source of Information <u>18. inspection</u> <u>19. Wooley, Founding of Lexington</u>		35. Organization _____	
		36. Date <u>1982</u>	
		37. Revision Dates _____ 38. Staff Review _____	

VERBAL BOUNDARY DESCRIPTION & JUSTIFICATION

Beginning at A, a point 21 ft diagonally S of the house, thence westerly parallel to house wall 65 ft to B, thence N 45 ft to C, thence along rail road 65 ft E to D, thence S 45 ft to the beginning - 2925 square feet.

This boundary includes only the space immediately around the house, which is surrounded by a parking lot, railroad,

SKETCH MAP OF SITE SHOWING BOUNDARIES AND KEY BUILDINGS AND FEATURES WITH NORTH ARROW.

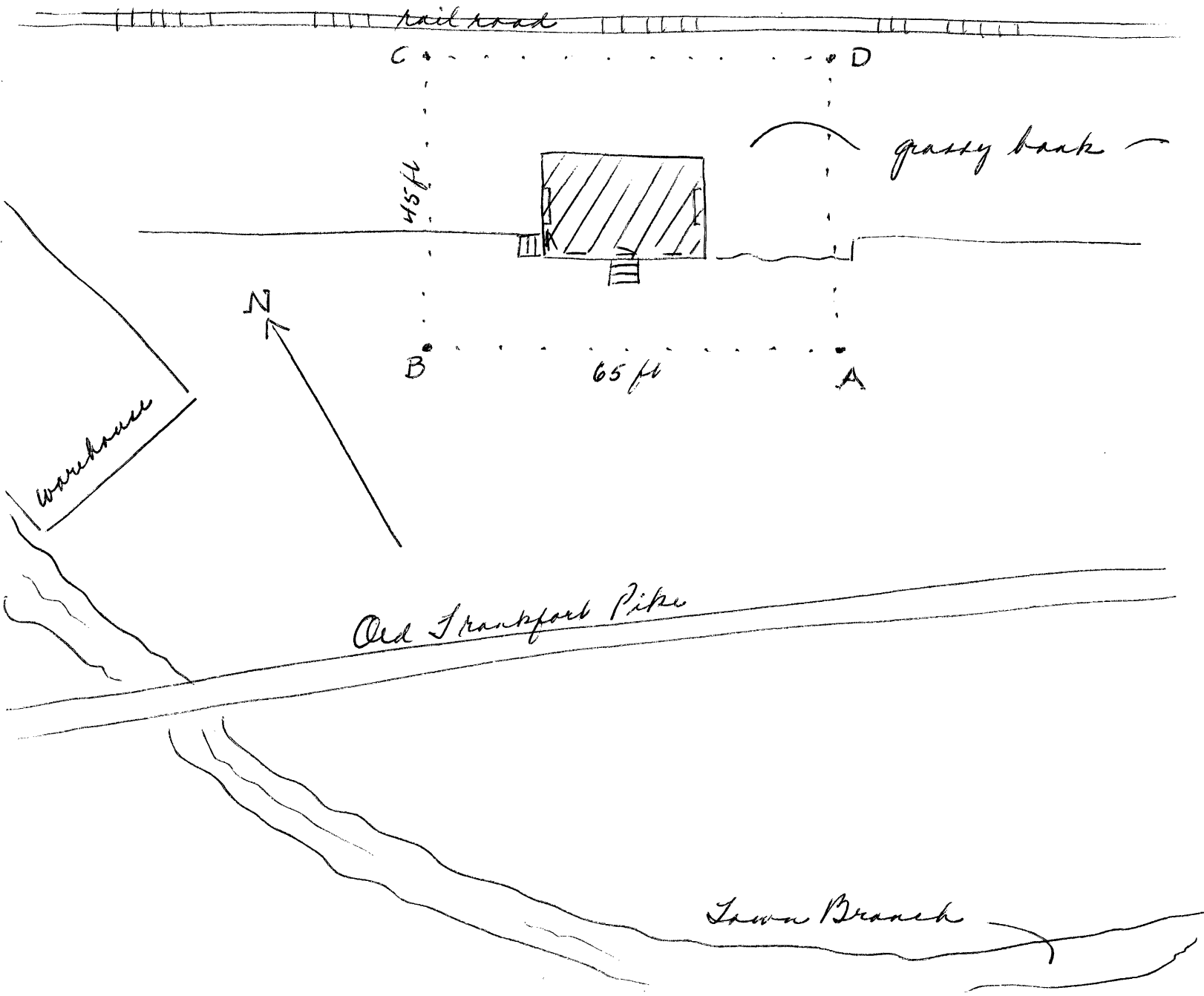

and warehouse. The bank into which the house is built is the only green space.