

United States Department of the Interior  
National Park Service

# National Register of Historic Places Inventory—Nomination Form

See instructions in *How to Complete National Register Forms*  
Type all entries—complete applicable sections

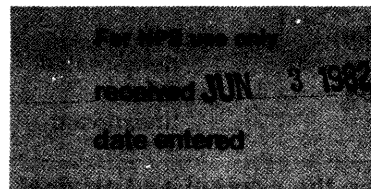

## 1. Name

historic Cooper-Alley House

and/or common George Alley Residence

## 2. Location

street & number About 1 3/4 miles south of Waldron, 600E to 700S N/A not for publication

city, town Waldron *vic.*  vicinity of ~~congressional district~~

state Indiana code 018 county Shelby code 145

## 3. Classification

Category	Ownership	Status	Present Use
<input type="checkbox"/> district	<input type="checkbox"/> public	<input checked="" type="checkbox"/> occupied	<input type="checkbox"/> agriculture
<input checked="" type="checkbox"/> building(s)	<input checked="" type="checkbox"/> private	<input type="checkbox"/> unoccupied	<input type="checkbox"/> commercial
<input type="checkbox"/> structure	<input type="checkbox"/> both	<input type="checkbox"/> work in progress	<input type="checkbox"/> educational
<input type="checkbox"/> site	<b>Public Acquisition</b>	<b>Accessible</b>	<input type="checkbox"/> entertainment
<input type="checkbox"/> object	<input type="checkbox"/> in process	<input checked="" type="checkbox"/> yes: restricted	<input type="checkbox"/> government
	<input type="checkbox"/> being considered	<input type="checkbox"/> yes: unrestricted	<input type="checkbox"/> industrial
	N/A	<input type="checkbox"/> no	<input type="checkbox"/> military
			<input type="checkbox"/> museum
			<input type="checkbox"/> park
			<input checked="" type="checkbox"/> private residence
			<input type="checkbox"/> religious
			<input type="checkbox"/> scientific
			<input type="checkbox"/> transportation
			<input type="checkbox"/> other:

## 4. Owner of Property

name Mrs. George W. Alley

street & number R. 1

city, town Waldron  vicinity of state Indiana 46182

## 5. Location of Legal Description

courthouse, registry of deeds, etc. Shelby County Courthouse

street & number Harrison Avenue

city, town Shelbyville state Indiana 46176

## 6. Representation in Existing Surveys

title N/A has this property been determined eligible?  yes  no

date  federal  state  county  local

depository for survey records N/A

city, town state

## 7. Description

**Condition**

excellent  
 good  
 fair

deteriorated  
 ruins  
 unexposed

**Check one**

unaltered  
 altered

**Check one**

original site  
 moved date N/A

**Describe the present and original (if known) physical appearance**

The Cooper-Alley house is a two story farmhouse located near the confluence of the Flat Rock River and Conn's Creek in Shelby County, Indiana. The original section of the house is rectangular in plan, with a foundation of stone brought up from the nearby Flat Rock River. The exterior walls are of brick fired on the site and laid up in common bond, with header courses occurring at random intervals. The simple gable roof is of medium pitch and is presently covered with asphalt composition shingles. The single chimney which now serves the structure is located towards the north end of the building.

The main entry is located in the south wall of the structure. This wall, a gable end, consists of three bays. The easternmost bay on the ground floor contains the front door, which features a rectangular transom overhead and an engaged pier and sidelight on each side. The two remaining first floor bays and all three second floor bays contain six-over-six double-hung windows with plain stone sills and lintels. A few of the glass panes in these windows are original to the house.

Over the second floor windows in the south gable is a pair of narrow windows with round arch tops. These two windows are separated by an engaged column with a fluted square shaft. The capital of this column also serves as the impost for the pair of round arch hood molds which surmount these narrow windows. This window treatment is similar to that found on many later Italianate houses. No other opening in the structure exhibits this type of detailing; all other windows in the original section of the house have plain stone sills and lintels.

A small, one story addition was constructed at the rear of the house in the late 19th century. Built of red brick similar to that used in the original structure, the addition differs from the rest of the building in the detailing of the door and window openings. Sills are of rock-faced stone, and instead of lintels, segmental round arches are employed.

The interior of the house features an entry hall leading to the large parlor on the west. This parlor and the adjoining dining room both contain original fireplaces. A small bedroom, a bathroom, and a modern kitchen are also located on the first floor. A staircase rises to the second floor from the east side of the entry hall. This staircase is among the more decorative features of the house, with a turned newel post and turned balusters. The stairs lead to a second floor hallway, which provides access to three large bedrooms, all with built-in closets. All second floor doors are original and have the original hardware. Some have been painted with white enamel, but the rest retain the original wood-grained paint finish. On the first floor, almost all woodwork has been painted with white enamel.

Inasmuch as this property has always been part of a working farm, several outbuildings are located on the site. Most notable among these are a small concrete block building once used as an icehouse, and a large barn constructed with heavy timbers and thought to be over 80 years old. However, these are not included within the designated boundary.

## 8. Significance

Period	Areas of Significance—Check and justify below			
<input type="checkbox"/> prehistoric	<input type="checkbox"/> archeology-prehistoric	<input type="checkbox"/> community planning	<input type="checkbox"/> landscape architecture	<input type="checkbox"/> religion
<input type="checkbox"/> 1400-1499	<input type="checkbox"/> archeology-historic	<input type="checkbox"/> conservation	<input type="checkbox"/> law	<input type="checkbox"/> science
<input type="checkbox"/> 1500-1599	<input type="checkbox"/> agriculture	<input type="checkbox"/> economics	<input type="checkbox"/> literature	<input type="checkbox"/> sculpture
<input type="checkbox"/> 1600-1699	<input checked="" type="checkbox"/> architecture	<input type="checkbox"/> education	<input type="checkbox"/> military	<input type="checkbox"/> social/ humanitarian
<input type="checkbox"/> 1700-1799	<input type="checkbox"/> art	<input type="checkbox"/> engineering	<input type="checkbox"/> music	<input type="checkbox"/> theater
<input checked="" type="checkbox"/> 1800-1899	<input type="checkbox"/> commerce	<input type="checkbox"/> exploration/settlement	<input type="checkbox"/> philosophy	<input type="checkbox"/> transportation
<input type="checkbox"/> 1900-	<input type="checkbox"/> communications	<input type="checkbox"/> industry	<input checked="" type="checkbox"/> politics/government	<input type="checkbox"/> other (specify)
		<input type="checkbox"/> invention		

**Specific dates** 1863-1864

**Builder/Architect** Edmund Cooper and George Carlisle, Sr.

### Statement of Significance (in one paragraph)

The Cooper-Alley House is one of the finest and best preserved mid-19th century, upper-middle class farmhouses remaining in the area. The builder, Edmund Cooper, was a locally prominent farmer who also served as Justice of the Peace, County Commissioner, and Representative to the Indiana General Assembly. He constructed this house on a commanding site overlooking a valley near the confluence of the Flat Rock River and Conn's Creek. The building features an interesting combination of Greek Revival and Italianate design elements, arranged in an unpretentious manner. The house has always been carefully maintained and remains a prominent local landmark.

### 9. Major Bibliographical References

Atlas of Shelby County, 1880, J. H. Beers & Co., Chicago. Reprod. Unigraphic, Inc., Evansville  
History of Shelby County, Indiana, Brant & Fuller, 1887, Chicago. Reprint by Bookmark, Knightstown, Indiana  
Letters by Margaret Jane Van Pelt (Mrs. Edmund Cooper) 1863, 1864

### 10. Geographical Data

Acreeage of nominated property 1 1/2 acres

Quadrangle name Waldron

Quadrangle scale 1:24000

UMT References

A 

1	6	6	1	4	2	2	0	4	3	6	4	7	2	0
Zone			Easting				Northing							

B 

Zone			Easting				Northing							

C 

Zone			Easting				Northing							

D 

Zone			Easting				Northing							

E 

Zone			Easting				Northing							

F 

Zone			Easting				Northing							

G 

Zone			Easting				Northing							

H 

Zone			Easting				Northing							

Verbal boundary description and justification

Please see continuation sheet

List all states and counties for properties overlapping state or county boundaries

state N/A code county code

state code county code

### 11. Form Prepared By

name/title Albert Glenn Cooper

organization Representing Mrs. George Alley date August 15, 1980

street & number 7 Heather Lane telephone 314/445-6429

city or town Columbia state Missouri 65201

### 12. State Historic Preservation Officer Certification

The evaluated significance of this property within the state is:

national  state  local

As the designated State Historic Preservation Officer for the National Historic Preservation Act of 1966 (Public Law 89-665), I hereby nominate this property for inclusion in the National Register and certify that it has been evaluated according to the criteria and procedures set forth by the National Park Service.

State Historic Preservation Officer signature [Signature]

title Indiana State Historic Preservation Officer date 5-21-82

For NPS use only	
I hereby certify that this property is included in the National Register	
<u>[Signature]</u>	Entered in the National Register date <u>7/7/82</u>
Keeper of the National Register	
Attest:	date
Chief of Registration	

**United States Department of the Interior  
National Park Service**

**National Register of Historic Places  
Inventory—Nomination Form**

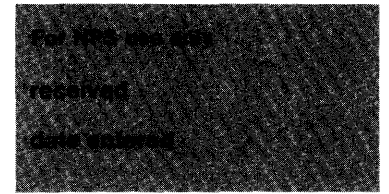

Continuation sheet Cooper-Alley House

Item number 10

Page 1

Located in the northeast quarter of Section 7, Range 8 East, Township 11 North of Shelby County, Indiana, an area of approximately 4.28 acres, more particularly described as follows:

Commencing at the southwest corner of the Cooper-Alley House, proceed 110' southward parallel with the west side of said house, thence 175' eastward in a line parallel with the south side of said house, thence 225' northward in a line parallel with the east side of said house; thence 303' westward in a line parallel with the north side of said house; thence 225' southward in a line parallel with the west side of said house; thence eastward 128' in a line parallel with the south side of the house, thus completing the rectangular dimensions of 225' x 303', an area equal to approximately 1.57 acres.

Barnyard

(2)

Proposed Boundary of Site

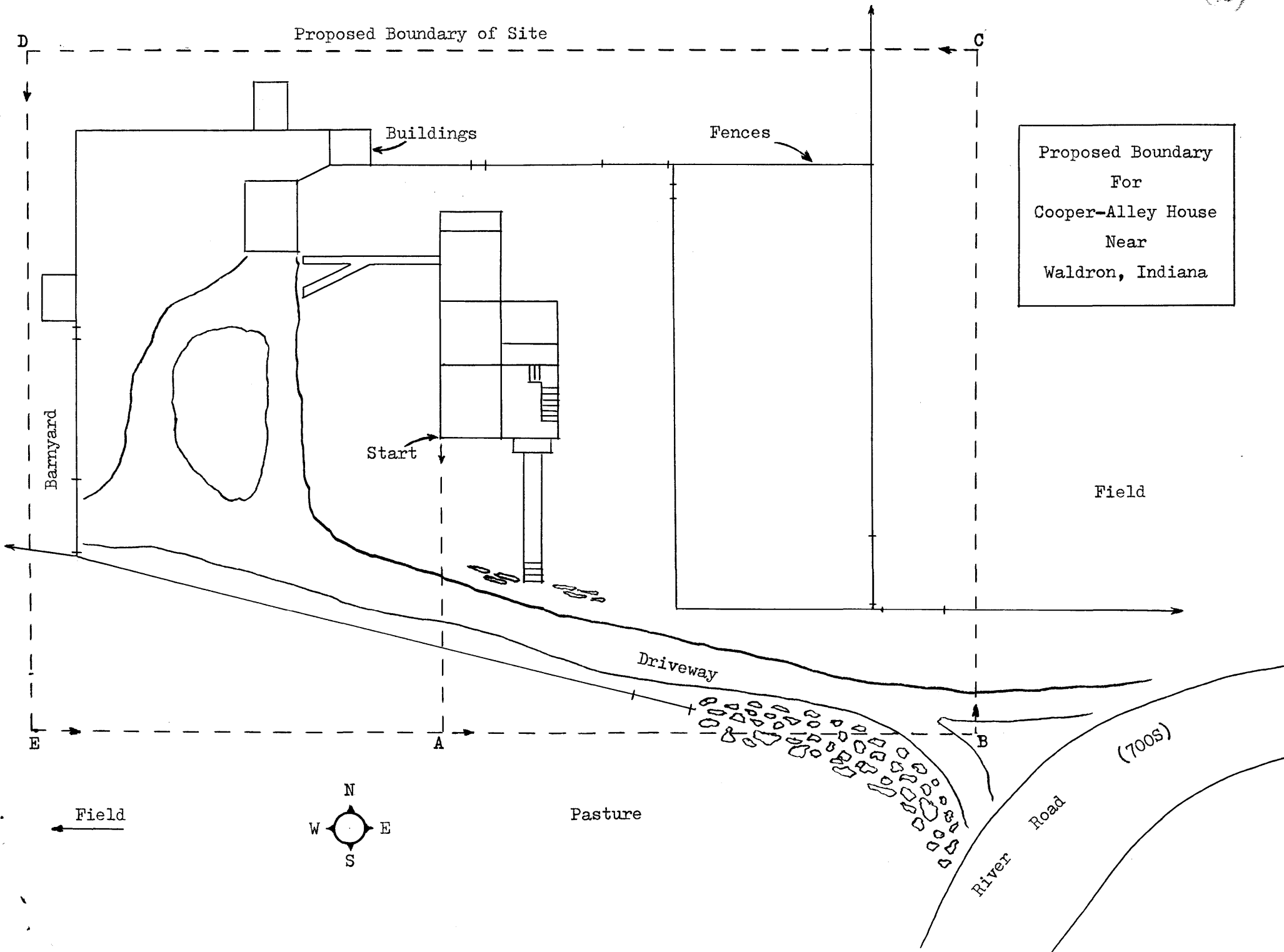

Buildings

Fences

Proposed Boundary  
For  
Cooper-Alley House  
Near  
Waldron, Indiana

Field

Start

Driveway

Pasture

River Road (700S)

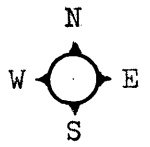

Field

Barnyard

D

C

E

A

B