

Page 3 of 70

DATA SHEET

UNITED STATES DEPARTMENT OF THE INTERIOR
NATIONAL PARK SERVICE

FOR NPS USE ONLY
RECEIVED JUL 17 1975
DATE ENTERED OCT 21 1975

**NATIONAL REGISTER OF HISTORIC PLACES
INVENTORY -- NOMINATION FORM**

SEE INSTRUCTIONS IN HOW TO COMPLETE NATIONAL REGISTER FORMS
TYPE ALL ENTRIES -- COMPLETE APPLICABLE SECTIONS

1 NAME

HISTORIC

Earlham College Observatory

AND/OR COMMON

Earlham College Observatory

2 LOCATION

STREET & NUMBER

Earlham College Campus, National Road West

NOT FOR PUBLICATION

CITY, TOWN

Richmond

VICINITY OF

CONGRESSIONAL DISTRICT

Tenth

STATE

Indiana

CODE

18

COUNTY

Wayne

CODE

17

3 CLASSIFICATION

CATEGORY	OWNERSHIP	STATUS	PRESENT USE
<input type="checkbox"/> DISTRICT	<input type="checkbox"/> PUBLIC	<input checked="" type="checkbox"/> OCCUPIED	<input type="checkbox"/> AGRICULTURE
<input checked="" type="checkbox"/> BUILDING(S)	<input checked="" type="checkbox"/> PRIVATE	<input type="checkbox"/> UNOCCUPIED	<input type="checkbox"/> MUSEUM
<input type="checkbox"/> STRUCTURE	<input type="checkbox"/> BOTH	<input type="checkbox"/> WORK IN PROGRESS	<input type="checkbox"/> COMMERCIAL
<input type="checkbox"/> SITE	PUBLIC ACQUISITION	ACCESSIBLE	<input checked="" type="checkbox"/> EDUCATIONAL
<input type="checkbox"/> OBJECT	<input type="checkbox"/> IN PROCESS	<input type="checkbox"/> YES: RESTRICTED	<input type="checkbox"/> PARK
	<input type="checkbox"/> BEING CONSIDERED	<input type="checkbox"/> YES: UNRESTRICTED	<input type="checkbox"/> PRIVATE RESIDENCE
		<input checked="" type="checkbox"/> NO	<input type="checkbox"/> ENTERTAINMENT
			<input type="checkbox"/> RELIGIOUS
			<input type="checkbox"/> GOVERNMENT
			<input checked="" type="checkbox"/> SCIENTIFIC
			<input type="checkbox"/> INDUSTRIAL
			<input type="checkbox"/> TRANSPORTATION
			<input type="checkbox"/> MILITARY
			<input type="checkbox"/> OTHER:

4 OWNER OF PROPERTY

NAME

Earlham College

STREET & NUMBER

National Road West

CITY, TOWN

Richmond

VICINITY OF

STATE

Indiana

5 LOCATION OF LEGAL DESCRIPTION

COURTHOUSE,
REGISTRY OF DEEDS, ETC.

Recorder's Office, Wayne County, Indiana

STREET & NUMBER

Courthouse 4th & Main Streets

CITY, TOWN

Richmond

STATE

Indiana

6 REPRESENTATION IN EXISTING SURVEYS

TITLE

Indiana Register of Historic Landmarks

DATE

1969-1974

FEDERAL STATE COUNTY LOCAL

DEPOSITORY FOR
SURVEY RECORDS

Indiana Department of Natural Resources

CITY, TOWN

Indianapolis

STATE

Indiana

7 DESCRIPTION

CONDITION		CHECK ONE	CHECK ONE
<input type="checkbox"/> EXCELLENT	<input type="checkbox"/> DETERIORATED	<input checked="" type="checkbox"/> UNALTERED	<input checked="" type="checkbox"/> ORIGINAL SITE
<input checked="" type="checkbox"/> GOOD	<input type="checkbox"/> RUINS	<input type="checkbox"/> ALTERED	<input type="checkbox"/> MOVED , DATE _____
<input type="checkbox"/> FAIR	<input type="checkbox"/> UNEXPOSED		

DESCRIBE THE PRESENT AND ORIGINAL (IF KNOWN) PHYSICAL APPEARANCE

I. Exterior. Earlham College Observatory is a 1 story 40 ft. x 19 ft. brick hip roofed structure having a plan which is 3 part consisting of a central block of 19x19 feet in which the telescope and dome are houses, and two flankers of 10 x 19 ft. The brick work of this little structure is laid in 1- 8 common bond. The Observatory has 4 voids of 4 x 4 light sash on each principal elevation and 1 void consisting of a doorway in the end elevations. The main block is topped by a sheathed copper dome which is slotted such that a section can be removed from within to permit the observatory telescope to be used to study celestial bodies. The exterior trim consists of a simple wooden cornice at the roofline of no particular order. The general appearance of this structure is plain, in keeping with the religious convictions of the institution which erected it.

II. Interior. The interior of Earlham College Observatory is dominated by a 6 1/2 inch object lense brass mounted telescope mounted upon a stone pier in the center of the main block of the observatory. A secondary telescope for tripod use is also stored in the Observatory. The dome can be revolved by means of a bell crank system through 360°. A second bell crank operates the sliding panel in the dome to permit use of the telescope. A wooden platform surrounds the base of the dome to permit operation of the machinery. The interior is otherwise plainly appointed, with shelves for scientific devices, and simple architraves for door and window trim.

8 SIGNIFICANCE

PERIOD	AREAS OF SIGNIFICANCE -- CHECK AND JUSTIFY BELOW				
<input type="checkbox"/> PREHISTORIC	<input type="checkbox"/> ARCHEOLOGY-PREHISTORIC	<input type="checkbox"/> COMMUNITY PLANNING	<input type="checkbox"/> LANDSCAPE ARCHITECTURE	<input type="checkbox"/> RELIGION	
<input type="checkbox"/> 1400-1499	<input type="checkbox"/> ARCHEOLOGY-HISTORIC	<input type="checkbox"/> CONSERVATION	<input type="checkbox"/> LAW	<input checked="" type="checkbox"/> SCIENCE	
<input type="checkbox"/> 1500-1599	<input type="checkbox"/> AGRICULTURE	<input type="checkbox"/> ECONOMICS	<input type="checkbox"/> LITERATURE	<input type="checkbox"/> SCULPTURE	
<input type="checkbox"/> 1600-1699	<input checked="" type="checkbox"/> ARCHITECTURE	<input checked="" type="checkbox"/> EDUCATION	<input type="checkbox"/> MILITARY	<input type="checkbox"/> SOCIAL/HUMANITARIAN	
<input type="checkbox"/> 1700-1799	<input type="checkbox"/> ART	<input type="checkbox"/> ENGINEERING	<input type="checkbox"/> MUSIC	<input type="checkbox"/> THEATER	
<input checked="" type="checkbox"/> 1800-1899	<input type="checkbox"/> COMMERCE	<input type="checkbox"/> EXPLORATION/SETTLEMENT	<input type="checkbox"/> PHILOSOPHY	<input type="checkbox"/> TRANSPORTATION	
<input type="checkbox"/> 1900-	<input type="checkbox"/> COMMUNICATIONS	<input type="checkbox"/> INDUSTRY	<input type="checkbox"/> POLITICS/GOVERNMENT	<input type="checkbox"/> OTHER (SPECIFY)	
		<input type="checkbox"/> INVENTION			

SPECIFIC DATES

1861

BUILDER/ARCHITECT

STATEMENT OF SIGNIFICANCE

I. Architectural Significance. Earlham Observatory is a simple unadorned functional early Victorian educational building designed for a single function: to store and protect a telescope. It has no architectural features other than the copper sheathed dome and the machinery housed within the structure. The telescope was manufactured in 1856 and installed in the completed observatory in 1861. It itself is an early piece of scientific equipment in practically original condition except for a new eyepiece purchased in 1872. The dome revolution system is interesting as an example of mid 19th century ingenuity. Architecturally, the Observatory is unique. There are no comparable buildings in Indiana. The only comparable building in the Midwest is the Western Reserve Observatory in Hudson, Ohio, dating from the 1830's. Earlham Observatory represents an outstanding survival of institutional scientific architecture of the mid 19th century.

II. Historical Significance: In 1856, the Young Friends Philosophical and Literary Institute of Earlham College purchased a 6 1/2 inch objective lens telescope from R. B. Rutherford, a pioneer American astronomer for use at Earlham. The Young Friends then began raising money to build a suitable observatory to house the scope. In 1861, the present 1 story structure was erected and opened for use for the faculty and student body. It has been maintained in nearly original functioning condition by the Science Department of Earlham College since 1861. The transit telescope was loaned by the United States Coast & Geodetic Survey in 1861. A German astronomical clock was procured in 1861. Earlham College Observatory is the best preserved early observatory in the Midwest. It is exceeded in age only by the Western Reserve Observatory. It represents an important scientific historical site, strongly attached to a peculiar institution, Earlham Friends Boarding School and College, an educational institution of extremely advanced design and principals for the 19th century.

9 MAJOR BIBLIOGRAPHICAL REFERENCES

O. Thornburg, Earlham, The Story of the College (1962); H.C. Fox, ed., Memoirs of Wayne County (1912); D. Eaton, History of Earlham Observatory (Undergraduate Thesis, 1907)

10 GEOGRAPHICAL DATA

ACREAGE OF NOMINATED PROPERTY less than 1

UTM OK um
11-10-75 um

UTM REFERENCES

A 16 | 678510 | 4410140
 ZONE EASTING NORTHING
 C | |

B | |
 ZONE EASTING NORTHING
 D | |

VERBAL BOUNDARY DESCRIPTION

LIST ALL STATES AND COUNTIES FOR PROPERTIES OVERLAPPING STATE OR COUNTY BOUNDARIES

STATE	CODE	COUNTY	CODE
<u>Indiana</u>	<u>18</u>	<u>Wayne</u>	<u>177</u>
STATE	CODE	COUNTY	CODE

11 FORM PREPARED BY

NAME / TITLE

Thomas J. Reed, Consultant (Swannsborough, Ltd.)

ORGANIZATION

Old Richmond, Inc.

DATE

July 8, 1974

STREET & NUMBER

1150 North "A" Street

TELEPHONE

CITY OR TOWN

Richmond

STATE

Indiana

12 STATE HISTORIC PRESERVATION OFFICER CERTIFICATION

THE EVALUATED SIGNIFICANCE OF THIS PROPERTY WITHIN THE STATE IS:

NATIONAL

STATE

LOCAL X

As the designated State Historic Preservation Officer for the National Historic Preservation Act of 1966 (Public Law 89-665), I hereby nominate this property for inclusion in the National Register and certify that it has been evaluated according to the criteria and procedures set forth by the National Park Service.

FEDERAL REPRESENTATIVE SIGNATURE

TITLE

Joseph D. Cloud S.H.P.O.

DATE

7/11-75

FOR NPS USE ONLY

I HEREBY CERTIFY THAT THIS PROPERTY IS INCLUDED IN THE NATIONAL REGISTER

DIRECTOR, OFFICE OF ARCHAEOLOGY AND HISTORIC PRESERVATION

DATE

10/21/75

ATTEST:

Ronald D. Buehler
 KEEPER OF THE NATIONAL REGISTER

DATE

10/14/75

Active

Actg

UNITED STATES DEPARTMENT OF THE INTERIOR
NATIONAL PARK SERVICE

FOR NPS USE ONLY	
RECEIVED	JUL 17 1975
DATE ENTERED	JUL 21 1975

**NATIONAL REGISTER OF HISTORIC PLACES
PROPERTY MAP FORM**

SEE INSTRUCTIONS IN *HOW TO COMPLETE NATIONAL REGISTER FORMS*
TYPE ALL ENTRIES -- ENCLOSE WITH MAP

NAME

HISTORIC Earlham College Observatory

AND/OR COMMON

Earlham College Observatory

2 LOCATION

CITY, TOWN Richmond

___VICINITY OF

COUNTY
Wayne

STATE
Indiana

3 MAP REFERENCE

SOURCE Griffing, Steveson & Co., an Illustrated Atlas of Wayne County

SCALE 1 rod equals 330 ft.

DATE 1874

REQUIREMENTS

TO BE INCLUDED ON ALL MAPS

1. PROPERTY BOUNDARIES
2. NORTH ARROW
3. UTM REFERENCES

South Part of RIC

Scale 4

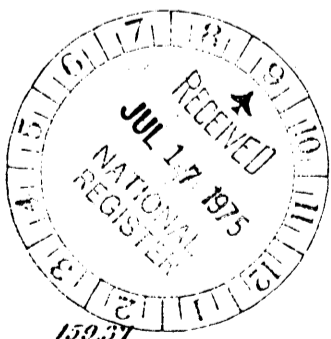
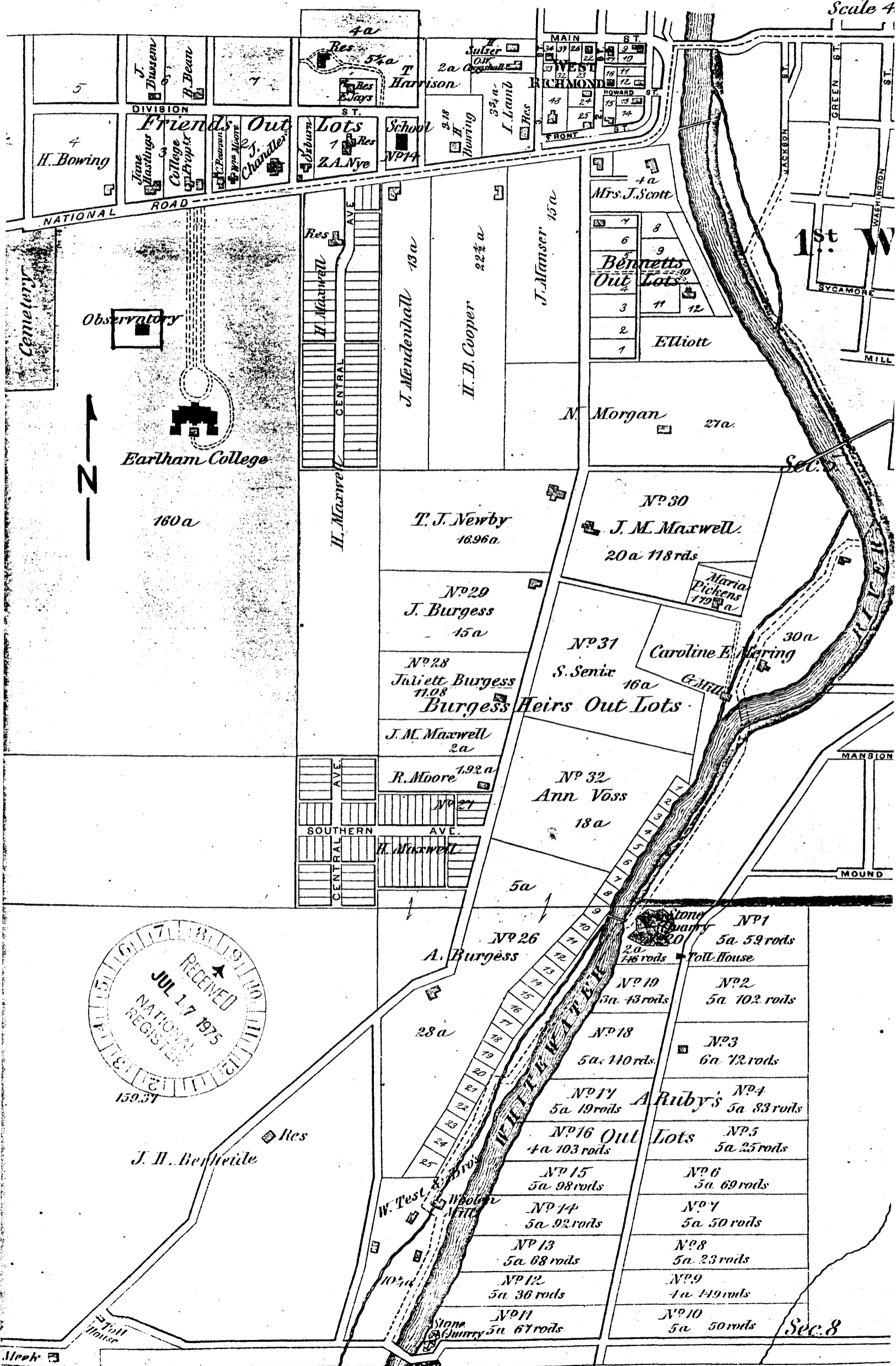

Sec. 8