

Form 10-300
(Rev. 6-72)

UNITED STATES DEPARTMENT OF THE INTERIOR
NATIONAL PARK SERVICE

NATIONAL REGISTER OF HISTORIC PLACES INVENTORY - NOMINATION FORM

(Type all entries - complete applicable sections)

| | |
|------------------|-----------|
| STATE: | Arkansas |
| COUNTY: | Jefferson |
| FOR NPS USE ONLY | |
| ENTRY DATE | |

1. NAME

| | |
|------------------|-----------------------|
| COMMON: | Plum Bayou Homesteads |
| AND/OR HISTORIC: | (Wright Plantation) |

2. LOCATION

| | | | |
|--------------------|----------------------------|--|-----------|
| STREET AND NUMBER: | | N of Pine Bluff, E of Arkansas River; includes town of Wright and its environs | |
| CITY OR TOWN: | Wright Pine Bluff vicinity | CONGRESSIONAL DISTRICT: | Fourth |
| STATE: | Arkansas | COUNTY: | Jefferson |
| CODE | 05 | CODE | 069 |

3. CLASSIFICATION

| CATEGORY (Check One) | OWNERSHIP | STATUS | ACCESSIBLE TO THE PUBLIC |
|--|---|---|--|
| <input checked="" type="checkbox"/> District <input type="checkbox"/> Site <input type="checkbox"/> Object | <input type="checkbox"/> Public <input type="checkbox"/> Private <input checked="" type="checkbox"/> Both | <input checked="" type="checkbox"/> Occupied <input type="checkbox"/> Unoccupied <input type="checkbox"/> Preservation work in progress | Yes: <input checked="" type="checkbox"/> Restricted <input type="checkbox"/> Unrestricted <input type="checkbox"/> No |

| | | | |
|---|--|---|---|
| PRESENT USE (Check One or More as Appropriate) | | | |
| <input checked="" type="checkbox"/> Agricultural <input checked="" type="checkbox"/> Commercial <input checked="" type="checkbox"/> Educational <input type="checkbox"/> Entertainment | <input type="checkbox"/> Government <input type="checkbox"/> Industrial <input type="checkbox"/> Military <input type="checkbox"/> Museum | <input type="checkbox"/> Park <input checked="" type="checkbox"/> Private Residence <input type="checkbox"/> Religious <input type="checkbox"/> Scientific | <input type="checkbox"/> Transportation <input type="checkbox"/> Other (Specify) _____ |

4. OWNER OF PROPERTY

| | |
|--------------------|--------------------|
| OWNER'S NAME: | multiple ownership |
| STREET AND NUMBER: | |
| CITY OR TOWN: | |
| STATE: | |

5. LOCATION OF LEGAL DESCRIPTION

| | |
|-------------------------------------|-----------------------------|
| COURTHOUSE, REGISTRY OF DEEDS, ETC: | Jefferson County Courthouse |
| STREET AND NUMBER: | Main and Barraque |
| CITY OR TOWN: | Pine Bluff |
| STATE: | Arkansas |
| CODE | 05 |

6. REPRESENTATION IN EXISTING SURVEYS

| | |
|--------------------------------|---|
| TITLE OF SURVEY: | |
| DATE OF SURVEY: | <input type="checkbox"/> Federal <input type="checkbox"/> State <input type="checkbox"/> County <input type="checkbox"/> Local |
| DEPOSITORY FOR SURVEY RECORDS: | |
| STREET AND NUMBER: | |
| CITY OR TOWN: | |
| STATE: | |
| CODE | |

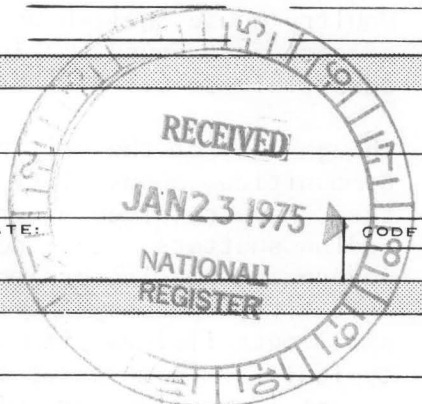

SEE INSTRUCTIONS

STATE: COUNTY: ENTRY NUMBER: DATE: FOR NPS USE ONLY

7. DESCRIPTION

| | | | | | | |
|-----------|------------------------------------|---|--------------------------------|---|--------------------------------|------------------------------------|
| CONDITION | (Check One) | | | | | |
| | <input type="checkbox"/> Excellent | <input checked="" type="checkbox"/> Good | <input type="checkbox"/> Fair | <input type="checkbox"/> Deteriorated | <input type="checkbox"/> Ruins | <input type="checkbox"/> Unexposed |
| | (Check One) | | | (Check One) | | |
| | <input type="checkbox"/> Altered | <input checked="" type="checkbox"/> Unaltered | <input type="checkbox"/> Moved | <input checked="" type="checkbox"/> Original Site | | |

DESCRIBE THE PRESENT AND ORIGINAL (if known) PHYSICAL APPEARANCE

Plum Bayou Homesteads was established in December, 1935, along the east bank of the Arkansas River about 30 miles north of Pine Bluff, Arkansas. The Resettlement Administration purchased 9,853 acres of river bottom land for a total of \$386,000.00. The land was divided into 200 family-size farm units of which 180 were developed.

Plum Bayou was a planned agricultural community. It was laid out in rectangular tracts of approximately forty acres with one tract allotted to each family. Several community buildings were built at the northwest boundary of the project. These buildings were the center of community life, and housed the social activities that helped make this planned rural community a success. The community center, school, store, and gin were a part of the common property of Plum Bayou residents. Several of these simple white frame buildings are now used to house Plum Bayou High School.

Plum Bayou houses were small one-storey structures with white ship-lap siding. Three slightly different architectural styles provided variety in the four, five and six room houses. Each house had a wood burning fireplace, running water and electricity. Square, T-shape, or ell-shape floor plans were used with gable or hipped roofs to produce bungalow style houses. Behind each house was a two-storey barn with a gambrel roof, along with such small structures as a poultry house, well-house and privy. All-weather roads ran in front of each farm house, making transportation and communication easily accessible to all Plum Bayou residents.

Though many of the original houses have been moved away to other communities, about fifty of the homestead houses remain. Most of these have received minor alterations, such as screening porches, adding shutters, etc.; however, the overall integrity of this 1930's government housing project remains. The simple features of these white frame houses, the two-storey barn behind each house, and the small outbuildings with each homestead combine to exemplify the typical farm homesteads established under the Resettlement Administration. Recent intrusions are minimal, and are limited to a few commercial and residential structures in the area of the original community center complex, now the Wright community.

SEE INSTRUCTIONS



8. SIGNIFICANCE

PERIOD (Check One or More as Appropriate)

- | | | | |
|--|---------------------------------------|---------------------------------------|--|
| <input type="checkbox"/> Pre-Columbian | <input type="checkbox"/> 16th Century | <input type="checkbox"/> 18th Century | <input checked="" type="checkbox"/> 20th Century |
| <input type="checkbox"/> 15th Century | <input type="checkbox"/> 17th Century | <input type="checkbox"/> 19th Century | |

SPECIFIC DATE(S) (If Applicable and Known)

AREAS OF SIGNIFICANCE (Check One or More as Appropriate)

- | | | | |
|---|---------------------------------------|---|--|
| <input type="checkbox"/> Aboriginal | <input type="checkbox"/> Education | <input type="checkbox"/> Political | <input type="checkbox"/> Urban Planning |
| <input type="checkbox"/> Prehistoric | <input type="checkbox"/> Engineering | <input type="checkbox"/> Religion/Philosophy | <input type="checkbox"/> Other (Specify) |
| <input type="checkbox"/> Historic | <input type="checkbox"/> Industry | <input type="checkbox"/> Science | |
| <input checked="" type="checkbox"/> Agriculture | <input type="checkbox"/> Invention | <input type="checkbox"/> Sculpture | |
| <input type="checkbox"/> Architecture | <input type="checkbox"/> Landscape | <input checked="" type="checkbox"/> Social/Humanitarian | |
| <input type="checkbox"/> Art | <input type="checkbox"/> Architecture | <input type="checkbox"/> Theater | |
| <input type="checkbox"/> Commerce | <input type="checkbox"/> Literature | <input type="checkbox"/> Transportation | |
| <input type="checkbox"/> Communications | <input type="checkbox"/> Military | | |
| <input type="checkbox"/> Conservation | <input type="checkbox"/> Music | | |

STATEMENT OF SIGNIFICANCE

In the years following the Civil War, the loss of the slavery system left southern plantations with an inadequate labor supply. Therefore, the continued existence of the cotton culture became dependent on a new breed of laborer. A system of farm tenancy grew up in which large landowners rented out small portions of their land to individual farmers. Rent was paid in cash, or by providing the landlord with a portion of the crop produced on the land. As each post-Civil War decade passed, the number of tenant farmers continued to increase. By 1930, over sixty percent of Southern cotton farms were operated by tenants.

Because most farm tenants/share croppers lived below subsistence levels, this socio-economic system was considered to be one of the greatest social blights in America. By 1930 Southern tenant farmers were adding a billion dollars annually to the world economy, yet the cotton growers themselves were the most impoverished and backward group of producers in the Nation.

When President Franklin D. Roosevelt took office in 1932, he promised a "New Deal" for the American people who were then suffering through the Great Depression. Among the many groups of people to benefit by the New Deal programs were Southern tenant farmers. Rural relief, rehabilitation and reform came to the tenant farm society through the efforts of the Resettlement Administration, established April 30, 1935, by Executive Order 7207.

The goals of the Resettlement Administration were deeply humanistic and concerned with the overall improvement of the human condition. According to historian Sidney Baldwin, the overall rural rehabilitation program had little widespread effect on the nation's agriculture; nevertheless, it had a tremendous beneficial impact on the lives of the low-income farm families.

The resettlement plan was to move tenant farmers off marginal and overworked land and onto land capable of producing a

SEE INSTRUCTIONS

9. MAJOR BIBLIOGRAPHICAL REFERENCES

American Guide Series. Arkansas, A Guide to the State. New York: Hastings House, 1941.
 Baldwin, Sidney. Poverty & Politics: The Rise & Decline of the Farm Security Administration. Chapel Hill: University of North Carolina Press, 1968.
 Johnson, Charles S.; Embree, Edwin R.; and Alexander, W. W. The Collapse of Cotton Tenancy. Chapel Hill: University of North Carolina Press, 1935.
 Sain, Walter Branch. Personal interview at Plum Bayou, July 16, 1974.

10. GEOGRAPHICAL DATA

| LATITUDE AND LONGITUDE COORDINATES DEFINING A RECTANGLE LOCATING THE PROPERTY | | | LATITUDE AND LONGITUDE COORDINATES DEFINING THE CENTER POINT OF A PROPERTY OF LESS THAN TEN ACRES | | |
|--|-------------------------|-------------------------|---|---------|---------|
| CORNER | LATITUDE | LONGITUDE | | | |
| | Degrees Minutes Seconds | Degrees Minutes Seconds | Degrees | Minutes | Seconds |
| NW | 34° 27' 38.3" | 92° 04' 57.2" | 0 | | |
| NE | 34° 27' 34" | 92° 01' 38.2" | | | |
| SE | 34° 24' 5.7" | 92° 01' 46.4" | | | |
| SW | 34° 24' 31.0" | 92° 05' 3.2" | | | |

APPROXIMATE ACREAGE OF NOMINATED PROPERTY: 5.307 acres

LIST ALL STATES AND COUNTIES FOR PROPERTIES OVERLAPPING STATE OR COUNTY BOUNDARIES

| STATE: | CODE | COUNTY | CODE |
|--------|------|---------|------|
| | | | |
| STATE: | CODE | COUNTY: | CODE |
| | | | |
| STATE: | CODE | COUNTY: | CODE |
| | | | |
| STATE: | CODE | COUNTY: | CODE |
| | | | |

11. FORM PREPARED BY

NAME AND TITLE:
 Dianna Kirk, Staff Historian

ORGANIZATION
 Arkansas Historic Preservation Program

DATE
 9/10/74

STREET AND NUMBER:
 Plaza West, Suite 1030 McKinley and Lee Streets

CITY OR TOWN:
 Little Rock

STATE
 Arkansas

CODE
 05

12. STATE LIAISON OFFICER CERTIFICATION

As the designated State Liaison Officer for the National Historic Preservation Act of 1966 (Public Law 89-665), I hereby nominate this property for inclusion in the National Register and certify that it has been evaluated according to the criteria and procedures set forth by the National Park Service. The recommended level of significance of this nomination is:

National ☒ State ☐ Local ☐

Name William E. Henderson

William E. Henderson

Title State Historic Preservation Officer

Date September 10, 1974

NATIONAL REGISTER VERIFICATION

I hereby certify that this property is included in the National Register.

ABuortensen
 Director, Office of Archeology and Historic Preservation

Date 6/5/75

ATTEST:

William E. Henderson
 Keeper of The National Register

Date 6.2.75

NW 15/584280 3813420 14L
 SW 15/584180 3807000
 SEE INSTRUCTIONS
 SE 15/589240 3806910
 NE 15/589340 3813330

JAN 23 1975

NATIONAL
REGISTERNATIONAL REGISTER OF HISTORIC PLACES
INVENTORY - NOMINATION FORM

(Continuation Sheet)

| | |
|---------------------|------------|
| STATE Arkansas | |
| COUNTY Jefferson | |
| FOR NPS USE ONLY | |
| ENTRY NUMBER | DATE |
| | JUN 5 1975 |

(Number all entries)

Significance (Continued - Page 2)

decent living. To meet the needs of the ill-housed, ill-clad, and ill-nourished segment of the rural population, resettlement projects were established.

After careful scrutiny, certain farm families were selected to become part of the government's great experiment. Only those families who had proved their good intentions and shown a definite ability to succeed were chosen. Each farmer was provided with an acreage allotment (usually 30 - 50 acres), a simple, but respectable home, and a barn. Most of the resettlement farms were set up so that the residents could purchase their farms over a long-term period. The Resettlement Administration felt that if an honest, hard-working tenant farmer could be given an opportunity to cast aside his yoke of unending poverty, made even more unbearable by the depression, he could make a success of the experiment. Many farmers were given such a start, and though many failed, others were able to make a new and better life for themselves and their families.

In the attempt to change farm tenancy to farm ownership, the Resettlement Administration established a number of rural resettlement projects throughout the South. The first project to be officially and ceremoniously dedicated was located in Jefferson County, Arkansas. Plum Bayou Homesteads marked the implementation of an economic theory which had, up to then, existed only on paper.

Plum Bayou was typical of the resettlement projects which were to follow. Almost 1,000 acres were purchased by the Resettlement Administration (prior to Federal purchase, the land had been owned by several individuals but cultivated by convict labor from the nearby penitentiary). The land was divided into 200 family units averaging about 43 acres each. A four to six room house with electricity and running water was built on each tract, along with a barn and several smaller farm-support structures. Families selected to live at Plum Bayou were chosen from among low income families from all parts of Arkansas. Each farm family was responsible for their own tract of land. After a trial period each successfully resettled family was given a contract to purchase their farm with payments extended over a forty year period.

One of the most innovative features of the resettlement projects were the community and cooperative services. Jointly owned by all residents of the farm were properties such as a cotton gin, store, farm equipment, school and community building. When the commercial ventures showed a profit, the excess was divided equally among the project settlers.

JAN 23 1975

NATIONAL
REGISTERNATIONAL REGISTER OF HISTORIC PLACES
INVENTORY - NOMINATION FORM

(Continuation Sheet)

| | |
|---------------------|------|
| STATE Arkansas | |
| COUNTY Jefferson | |
| FOR NPS USE ONLY | |
| ENTRY NUMBER | DATE |
| JUN 5 | 1975 |

(Number all entries)

Significance (Continued - Page 3)

Because it was the first in the Nation, the dedication of Plum Bayou on November 20, 1936, was attended by many dignitaries, including Resettlement Administrator Rexford G. Tugwell, Secretary of Agriculture Henry A. Wallace, Senators Joe T. Robinson and Hattie Carraway, and other state and local officials.

In presenting keys to the first homes at Plum Bayou, Administrator Rexford Tugwell told the new residents that he was giving them not only keys to the houses, but also keys to the future. Tugwell saw the Plum Bayou project as representative of a new chapter in American agricultural history.

Secretary of Agriculture Henry A. Wallace spoke to the large crowd about the era of transition from farm tenant to land owner. He hoped that business and industry would closely watch this experiment in farmstead operation and see it succeed on a business basis as a paying proposition. According to a recent (1974) interview with Mr. E. B. Whittaker, Assistant Regional Director of the Resettlement Administration, Plum Bayou proved to be the most successful of the sixteen resettlement projects in Arkansas.

Today about a fourth of the 180 developed homesteads are still intact and in use at Plum Bayou. Many of the original houses have been moved to nearby communities; nevertheless, most of these are recognizable as originating at Plum Bayou because of the uniform and simple architectural styles used at the farm project. The community buildings now house educational facilities. Though still standing, the gin is now longer in use and is rapidly deteriorating.

Despite the removal of many of the original buildings, the area still retains its historic integrity as a government-established farm community. Plum Bayou represents the Resettlement Administration's success in transforming at least a part of the old cotton culture tenant farmers into successful and independent landowners. Because it was the first of the many Resettlement Administration farm projects, and because it represents an important part of American agricultural and social history, Plum Bayou is an important twentieth century historic site.

**NATIONAL REGISTER OF HISTORIC PLACES
INVENTORY - NOMINATION FORM**

(Continuation Sheet)

| | |
|---------------------|------------|
| STATE Arkansas | |
| COUNTY Jefferson | |
| FOR NPS USE ONLY | |
| ENTRY NUMBER | DATE |
| | JUN 5 1975 |

(Number all entries)

Major Bibliographical References (Continued - Page 2)

Snow, Paul G. "Resettlement Administration Helps to Solve the Tenant Problem in Arkansas." Federal Writer's Project Manuscript. Archives, Arkansas History Commission.

Whittaker, E. B. (formerly Assistant Regional Director of Resettlement Administration). Personal interview, July 15, 1974.

_____. Personal correspondence, documents and manuscripts relating to the Resettlement Administration, 1935-1941.



most original farm project structures lie alongside the two roads marked in yellow.

① WRIGHT PLANTATION

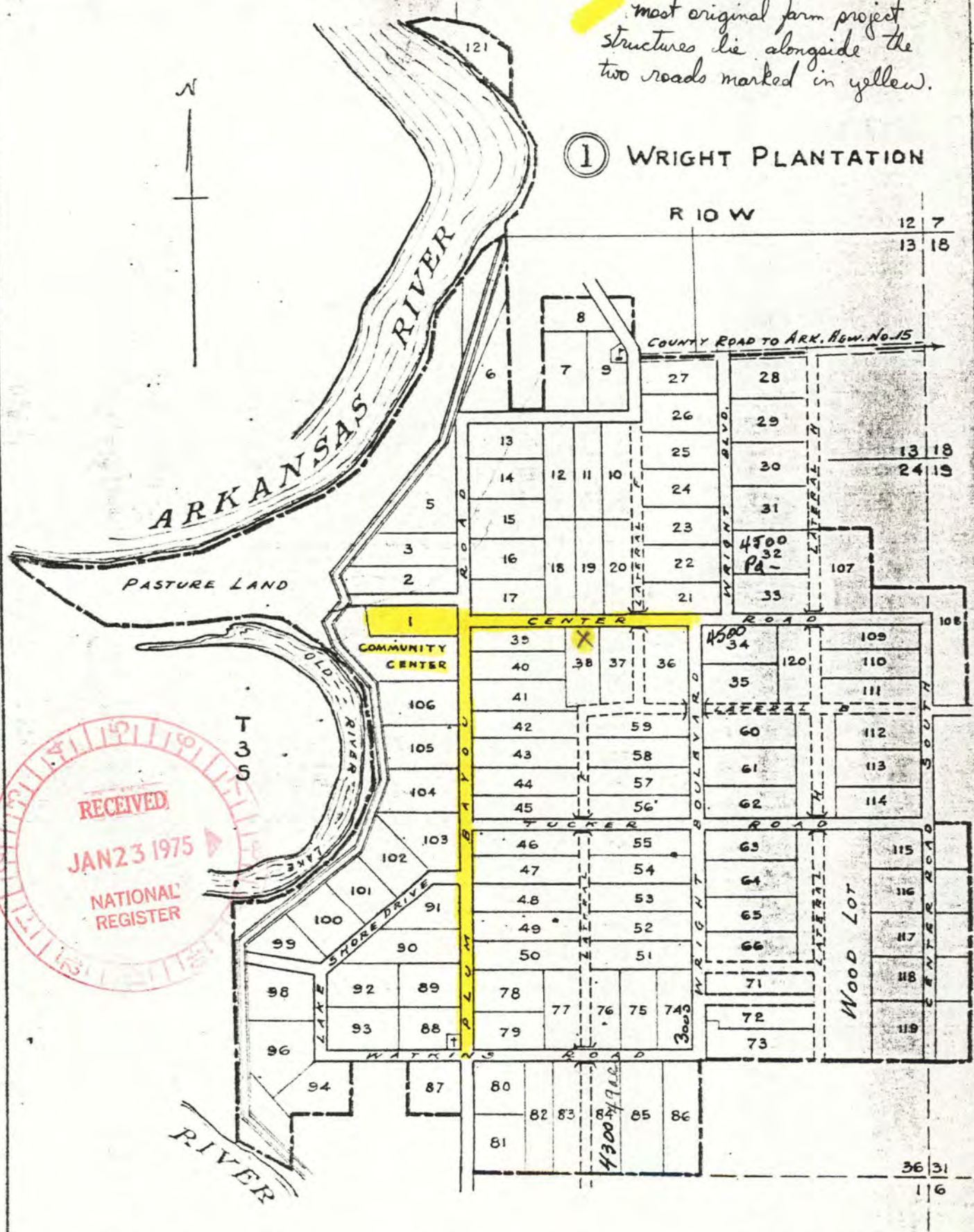

PLUM BAYOU HOMESTEADS

RF-AK-11

JEFFERSON CO. ARK.

2 OF 5

REGION 6.

DISTRICT 4

Erwin Schubert

area marked in pink is that
being nominated to the National Register
It is shown in relation to other
original sections of Plum Bayou

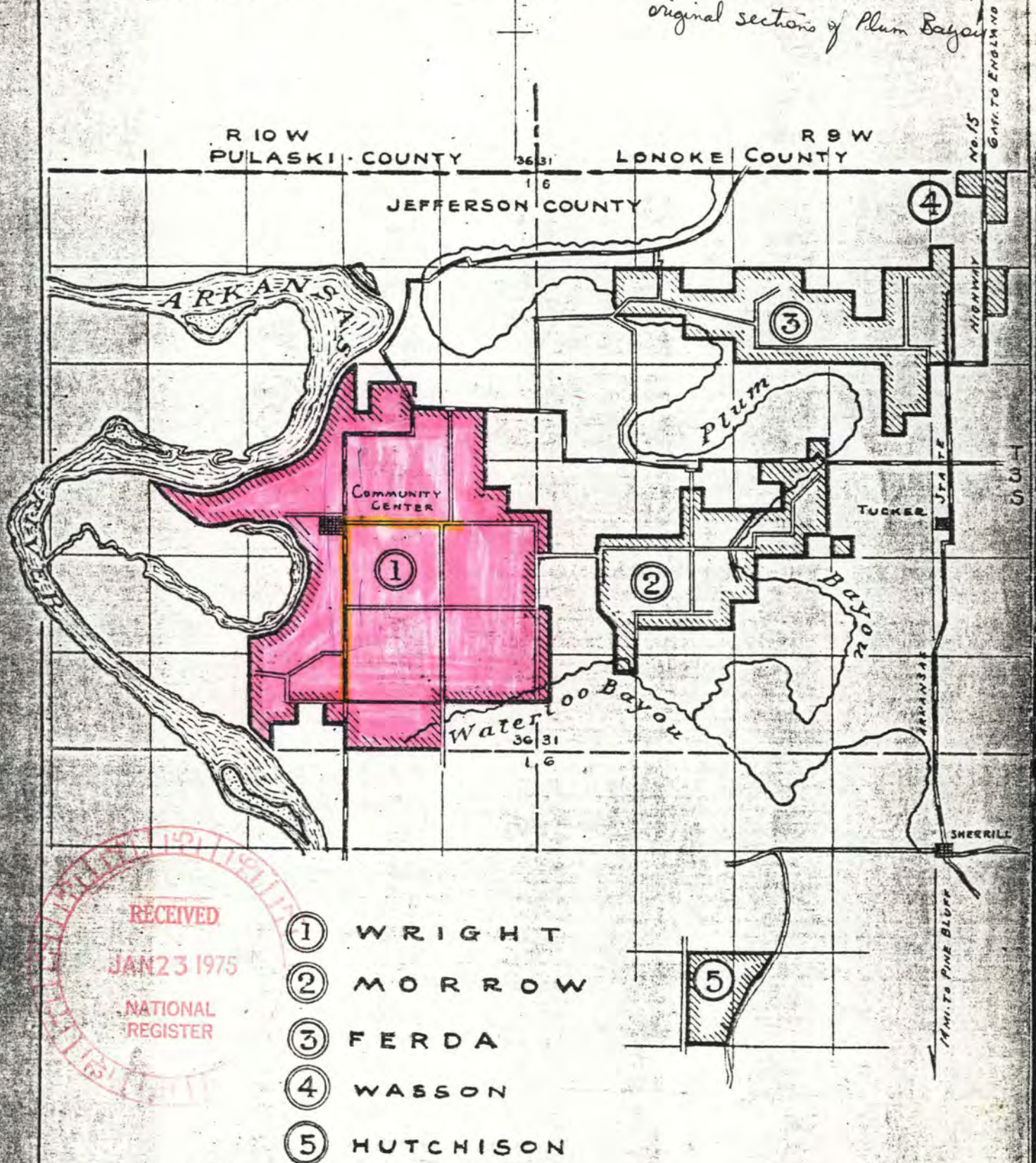

RECEIVED

JAN 23 1975

NATIONAL
REGISTER

PLUM BAYOU HOMESTEADS

JEFFERSON CO. ARK.

RF-AK-II

1 OF 5

Property

(Wright Plantation)
Plum Bayou Homestead A

Jefferson CO.

State

Arkansas

Working Number

1.23.75.117

75000396

TECHNICAL

Photos

12

Maps

3

CONTROL

cm

OK

1.29.75

HISTORIAN

Accept
E. Smith
1-30-75

Fifty year rule should be waived.

ARCHITECTURAL HISTORIAN

Added to title should be
(Wright Plantation)

Significant part
of Amer. history

1/31/75

ACCEPT
H. J. J. J.

ARCHEOLOGIST

OTHER

HAER

Inventory _____

Review _____

Very interesting

REVIEW UNIT CHIEF

Accept
Colz
2/10/75

As per discussion with Murlagh. BRANCH CHIEF

KEEPER

accept
H. J. J. J.
6.2.75

National Register Write-up

Federal Register Entry

8-5-75

Send-back

Re-submit

Entered

JUN 5 1975

INT:2106-74



UNITED STATES DEPARTMENT OF THE INTERIOR
NATIONAL PARK SERVICE

**NATIONAL REGISTER OF HISTORIC PLACES
PROPERTY PHOTOGRAPH FORM**

FOR NPS USE ONLY

RECEIVED

JAN 23 1975

DATE ENTERED

JUN 5 1975

SEE INSTRUCTIONS IN *HOW TO COMPLETE NATIONAL REGISTER FORMS*
TYPE ALL ENTRIES ENCLOSE WITH PHOTOGRAPH

1 NAME

HISTORIC Plum Bayou Homesteads

AND/OR COMMON

Wright Plantation

2 LOCATION

CITY, TOWN Wright _____ VICINITY OF COUNTY Jefferson STATE Arkansas

3 PHOTO REFERENCE

PHOTO CREDIT Dianna Kirk

DATE OF PHOTO 1974

NEGATIVE FILED AT Arkansas Historic Preservation Program

4 IDENTIFICATION

DESCRIBE VIEW, DIRECTION, ETC. IF DISTRICT, GIVE BUILDING NAME & STREET

Sain barn, viewed from northwest

PROPERTY OF THE NATIONAL REGISTER

PHOTO NO.



UNITED STATES DEPARTMENT OF THE INTERIOR
NATIONAL PARK SERVICE

**NATIONAL REGISTER OF HISTORIC PLACES
PROPERTY PHOTOGRAPH FORM**

FOR NPS USE ONLY

RECEIVED JAN 23 1975

DATE ENTERED JUN 5 1975

SEE INSTRUCTIONS IN *HOW TO COMPLETE NATIONAL REGISTER FORMS*
TYPE ALL ENTRIES ENCLOSE WITH PHOTOGRAPH

1 NAME

HISTORIC

Plum Bayou Homesteads

AND/OR COMMON

Wright Plantation

2 LOCATION

CITY, TOWN

Wright

____ VICINITY OF

COUNTY Jefferson

STATE Arkansas

3 PHOTO REFERENCE

PHOTO CREDIT

Dianna Kirk

DATE OF PHOTO

1974

NEGATIVE FILED AT

Arkansas Historic Preservation Program

4 IDENTIFICATION

DESCRIBE VIEW, DIRECTION, ETC. IF DISTRICT, GIVE BUILDING NAME & STREET

Sain farm structures, viewed from northwest

PROPERTY OF THE NATIONAL REGISTER

PHOTO NO.



Jefferson County, Arkansas
UNITED STATES DEPARTMENT OF THE INTERIOR
NATIONAL PARK SERVICE

NATIONAL REGISTER OF HISTORIC PLACES
PROPERTY PHOTOGRAPH FORM

| | |
|------------------|-------------|
| FOR NPS USE ONLY | |
| RECEIVED | JAN 23 1975 |
| DATE ENTERED | JUN 5 1975 |

SEE INSTRUCTIONS IN *HOW TO COMPLETE NATIONAL REGISTER FORMS*
TYPE ALL ENTRIES ENCLOSE WITH PHOTOGRAPH

1 NAME

HISTORIC Plum Bayou Homesteads

AND/OR COMMON Wright Plantation

2 LOCATION

CITY, TOWN Wright

____ VICINITY OF

COUNTY Jefferson

STATE Arkansas

3 PHOTO REFERENCE

PHOTO CREDIT Dianna Kirk

DATE OF PHOTO 1974

NEGATIVE FILED AT Arkansas Historic Preservation Program

4 IDENTIFICATION

DESCRIBE VIEW, DIRECTION, ETC. IF DISTRICT, GIVE BUILDING NAME & STREET
Typical barn

PHOTO NO.

PROPERTY OF THE NATIONAL REGISTER



UNITED STATES DEPARTMENT OF THE INTERIOR
NATIONAL PARK SERVICE

**NATIONAL REGISTER OF HISTORIC PLACES
PROPERTY PHOTOGRAPH FORM**

FOR NPS USE ONLY

RECEIVED JAN 23 1975

DATE ENTERED JUN 5 1975

SEE INSTRUCTIONS IN *HOW TO COMPLETE NATIONAL REGISTER FORMS*
TYPE ALL ENTRIES ENCLOSE WITH PHOTOGRAPH

1 NAME

HISTORIC Plum Bayou Homesteads

AND/OR COMMON Wright Plantation

2 LOCATION

CITY, TOWN Wright VICINITY OF COUNTY Jefferson STATE Arkansas

3 PHOTO REFERENCE

PHOTO CREDIT Dianna Kirk DATE OF PHOTO 1974

NEGATIVE FILED AT Arkansas Historic Preservation Program

4 IDENTIFICATION

DESCRIBE VIEW, DIRECTION, ETC. IF DISTRICT, GIVE BUILDING NAME & STREET

Walter Branch Sain House, viewed from northeast

PROPERTY OF THE NATIONAL REGISTER

PHOTO NO.



UNITED STATES DEPARTMENT OF THE INTERIOR
NATIONAL PARK SERVICE

**NATIONAL REGISTER OF HISTORIC PLACES
PROPERTY PHOTOGRAPH FORM**

FOR NPS USE ONLY

RECEIVED JAN 23 1975

DATE ENTERED JUN 5 1975

SEE INSTRUCTIONS IN *HOW TO COMPLETE NATIONAL REGISTER FORMS*
TYPE ALL ENTRIES ENCLOSE WITH PHOTOGRAPH

1 NAME

HISTORIC Plum Bayou Homesteads

AND/OR COMMON Wright Plantation

2 LOCATION

CITY, TOWN Wright

____ VICINITY OF

COUNTY Jefferson

STATE Arkansas

3 PHOTO REFERENCE

PHOTO CREDIT Dianna Kirk

DATE OF PHOTO 1974

NEGATIVE FILED AT Arkansas Historic Preservation Program

4 IDENTIFICATION

DESCRIBE VIEW, DIRECTION, ETC. IF DISTRICT, GIVE BUILDING NAME & STREET

PHOTO NO.

Community building/school, viewed from the northwest

PROPERTY OF THE NATIONAL REGISTER



Plum Bayou
orig
pre
Form No. 10-301a
(Rev. 10-74)

UNITED STATES DEPARTMENT OF THE INTERIOR
NATIONAL PARK SERVICE

**NATIONAL REGISTER OF HISTORIC PLACES
PROPERTY PHOTOGRAPH FORM**

FOR NPS USE ONLY

RECEIVED JAN 23 1975

DATE ENTERED JUN 5 1975

SEE INSTRUCTIONS IN *HOW TO COMPLETE NATIONAL REGISTER FORMS*
TYPE ALL ENTRIES ENCLOSE WITH PHOTOGRAPH

1 NAME

HISTORIC

Plum Bayou Homesteads

AND/OR COMMON

Wright Plantation

2 LOCATION

CITY, TOWN

Wright

____ VICINITY OF

COUNTY

Jefferson

STATE

Arkansas

3 PHOTO REFERENCE

PHOTO CREDIT

Dianna Kirk

DATE OF PHOTO

1974

NEGATIVE FILED AT

Arkansas Historic Preservation Program

4 IDENTIFICATION

DESCRIBE VIEW, DIRECTION, ETC. IF DISTRICT, GIVE BUILDING NAME & STREET

Community building/gymnasium, viewed from the southeast

PHOTO NO.

PROPERTY OF THE NATIONAL REGISTER



UNITED STATES DEPARTMENT OF THE INTERIOR
NATIONAL PARK SERVICE

**NATIONAL REGISTER OF HISTORIC PLACES
PROPERTY PHOTOGRAPH FORM**

FOR NPS USE ONLY

RECEIVED JAN 23 1975

JUN 5 1975

DATE ENTERED

SEE INSTRUCTIONS IN *HOW TO COMPLETE NATIONAL REGISTER FORMS*
TYPE ALL ENTRIES ENCLOSE WITH PHOTOGRAPH

1 NAME

HISTORIC Plum Bayou Homesteads

AND/OR COMMON
Wright Plantation

2 LOCATION

CITY, TOWN Wright VICINITY OF COUNTY Jefferson STATE Arkansas

3 PHOTO REFERENCE

PHOTO CREDIT Dianna Kirk

DATE OF PHOTO 1974

NEGATIVE FILED AT Arkansas Historic Preservation Program

4 IDENTIFICATION

DESCRIBE VIEW, DIRECTION, ETC. IF DISTRICT, GIVE BUILDING NAME & STREET
house #5

PROPERTY OF THE NATIONAL REGISTER

PHOTO NO.



UNITED STATES DEPARTMENT OF THE INTERIOR
NATIONAL PARK SERVICE

**NATIONAL REGISTER OF HISTORIC PLACES
PROPERTY PHOTOGRAPH FORM**

FOR NPS USE ONLY

RECEIVED JAN 23 1975

DATE ENTERED

JUN 5 1975

SEE INSTRUCTIONS IN *HOW TO COMPLETE NATIONAL REGISTER FORMS*
TYPE ALL ENTRIES ENCLOSE WITH PHOTOGRAPH

1 NAME

HISTORIC Plum Bayou Homesteads

AND/OR COMMON Wright Plantation

2 LOCATION

CITY, TOWN Wright VICINITY OF COUNTY Jefferson STATE Arkansas

3 PHOTO REFERENCE

PHOTO CREDIT Dianna Kirk

DATE OF PHOTO 1974

NEGATIVE FILED AT Arkansas Historic Preservation Program

4 IDENTIFICATION

DESCRIBE VIEW, DIRECTION, ETC. IF DISTRICT, GIVE BUILDING NAME & STREET

House #6

PROPERTY OF THE NATIONAL REGISTER

PHOTO NO.



UNITED STATES DEPARTMENT OF THE INTERIOR
NATIONAL PARK SERVICE

**NATIONAL REGISTER OF HISTORIC PLACES
PROPERTY PHOTOGRAPH FORM**

FOR NPS USE ONLY

RECEIVED JAN 23 1975

DATE ENTERED JUN 5 1975

SEE INSTRUCTIONS IN *HOW TO COMPLETE NATIONAL REGISTER FORMS*
TYPE ALL ENTRIES ENCLOSE WITH PHOTOGRAPH

1 NAME

HISTORIC Plum Bayou Homesteads

AND/OR COMMON

Wright Plantation

2 LOCATION

CITY, TOWN Wright VICINITY OF COUNTY Jefferson STATE Arkansas

3 PHOTO REFERENCE

PHOTO CREDIT Dianna Kirk

DATE OF PHOTO 1974

NEGATIVE FILED AT Arkansas Historic Preservation Program

4 IDENTIFICATION

PROPERTY OF THE NATIONAL REGISTER

DESCRIBE VIEW, DIRECTION, ETC. IF DISTRICT, GIVE BUILDING NAME & STREET
house #4, showing barn and outbuildings

PHOTO NO.



UNITED STATES DEPARTMENT OF THE INTERIOR
NATIONAL PARK SERVICE

**NATIONAL REGISTER OF HISTORIC PLACES
PROPERTY PHOTOGRAPH FORM**

FOR NPS USE ONLY

RECEIVED JAN 23 1975

DATE ENTERED JUN 5 1975

SEE INSTRUCTIONS IN *HOW TO COMPLETE NATIONAL REGISTER FORMS*
TYPE ALL ENTRIES ENCLOSE WITH PHOTOGRAPH

1 NAME

HISTORIC Plum Bayou Homesteads

AND/OR COMMON Wright Plantation

2 LOCATION

CITY, TOWN Wright VICINITY OF COUNTY Jefferson STATE Arkansas

3 PHOTO REFERENCE

PHOTO CREDIT Dianna Kirk

DATE OF PHOTO 1974

NEGATIVE FILED AT Arkansas Historic Preservation Program

4 IDENTIFICATION

DESCRIBE VIEW, DIRECTION, ETC. IF DISTRICT, GIVE BUILDING NAME & STREET

PHOTO NO.

House #3, showing barn and outbuildings

PROPERTY OF THE NATIONAL REGISTER



UNITED STATES DEPARTMENT OF THE INTERIOR
NATIONAL PARK SERVICE

**NATIONAL REGISTER OF HISTORIC PLACES
PROPERTY PHOTOGRAPH FORM**

FOR NPS USE ONLY

RECEIVED JAN 23 1975

DATE ENTERED JUN 5 1975

SEE INSTRUCTIONS IN *HOW TO COMPLETE NATIONAL REGISTER FORMS*
TYPE ALL ENTRIES ENCLOSE WITH PHOTOGRAPH

1 NAME

HISTORIC Plum Bayou Homesteads

AND/OR COMMON Wright Plantation

2 LOCATION

CITY, TOWN Wright VICINITY OF COUNTY Jefferson STATE Arkansas

3 PHOTO REFERENCE

PHOTO CREDIT Dianna Kirk

DATE OF PHOTO 1974

NEGATIVE FILED AT Arkansas Historic Preservation Program

4 IDENTIFICATION

DESCRIBE VIEW, DIRECTION, ETC. IF DISTRICT, GIVE BUILDING NAME & STREET

House #2

PHOTO NO.

PROPERTY OF THE NATIONAL REGISTER



UNITED STATES DEPARTMENT OF THE INTERIOR
NATIONAL PARK SERVICE

**NATIONAL REGISTER OF HISTORIC PLACES
PROPERTY PHOTOGRAPH FORM**

FOR NPS USE ONLY

RECEIVED JAN 23 1975

DATE ENTERED JUN 5 1975

SEE INSTRUCTIONS IN *HOW TO COMPLETE NATIONAL REGISTER FORMS*
TYPE ALL ENTRIES ENCLOSE WITH PHOTOGRAPH

1 NAME

HISTORIC Plum Bayou Homesteads

AND/OR COMMON

Wright Plantation

2 LOCATION

CITY, TOWN Wright

____ VICINITY OF

COUNTY Jefferson

STATE Arkansas

3 PHOTO REFERENCE

PHOTO CREDIT Dianna Kirk

DATE OF PHOTO 1974

NEGATIVE FILED AT Arkansas Historic Preservation Program

4 IDENTIFICATION

DESCRIBE VIEW, DIRECTION, ETC. IF DISTRICT, GIVE BUILDING NAME & STREET

House #1

PHOTO NO.

PROPERTY OF THE NATIONAL REGISTER

UNITED STATES DEPARTMENT OF THE INTERIOR
NATIONAL PARK SERVICE

**NATIONAL REGISTER OF HISTORIC PLACES
PROPERTY MAP FORM**

(Type all entries - attach to or enclose with map)

1. NAME

COMMON

Plum Bayou Homesteads

AND/OR HISTORIC

Wright Plantation

NUMERIC CODE *(Assigned by NPS)*

JUN 5 1975

2. LOCATION

STATE

Arkansas

COUNTY

Jefferson

TOWN

Wright

STREET AND NUMBER

Center Road

3. MAP REFERENCE

SOURCE

U.S.G.S. 7.5 Minute
Quadrangle Series

DATE

1970

SCALE

1/24000

REQUIREMENTS: PROPERTY BOUNDARIES, WHERE REQUIRED, AND NORTH ARROW:

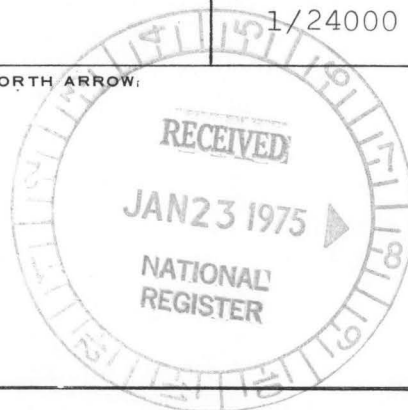

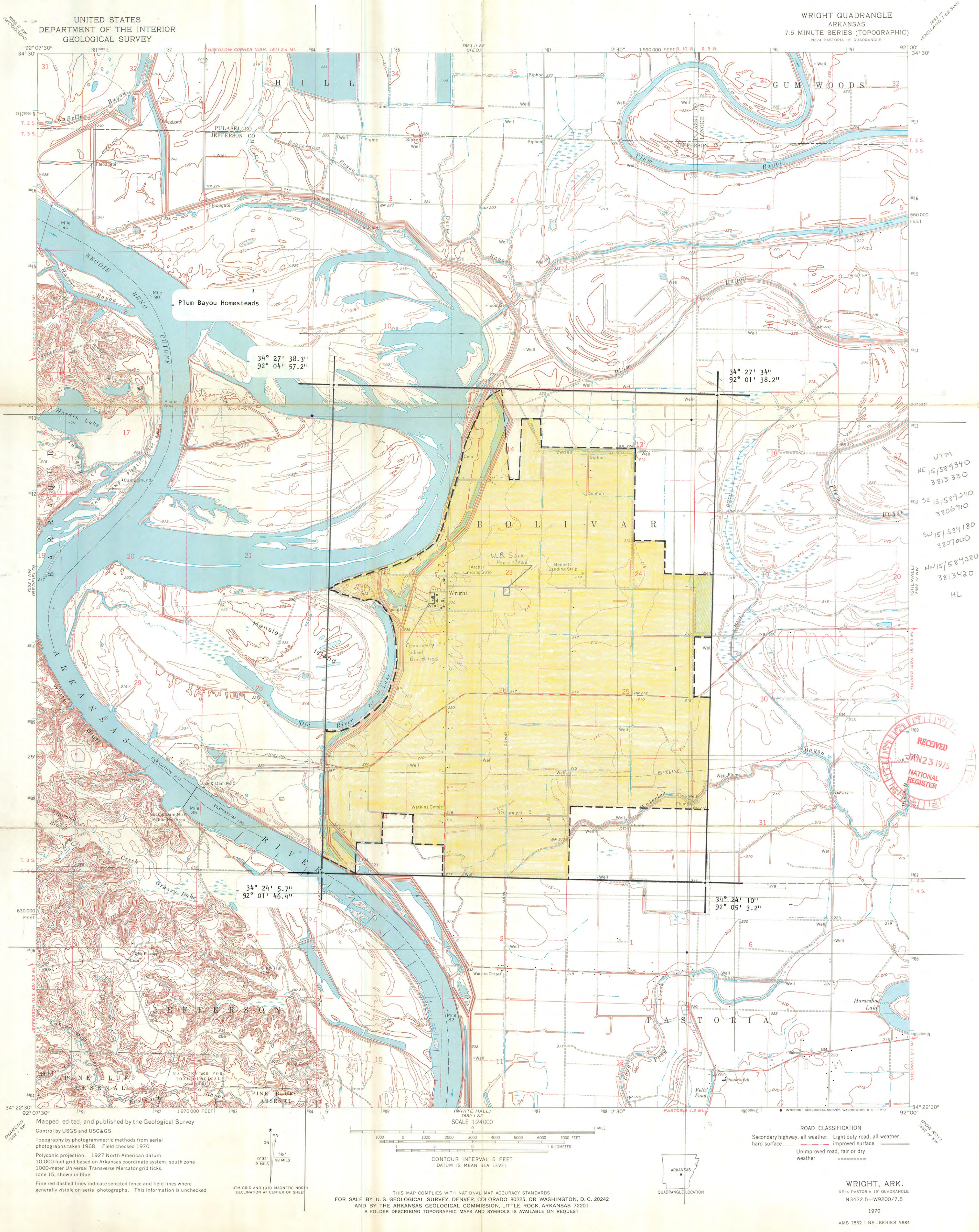

UNITED STATES
DEPARTMENT OF THE INTERIOR
GEOLOGICAL SURVEY

WRIGHT QUADRANGLE
ARKANSAS
7.5 MINUTE SERIES (TOPOGRAPHIC)
NE 1/4 PASTORIA 15' QUADRANGLE

Plum Bayou Homesteads

34° 27' 38.3"
92° 04' 57.2"

34° 27' 34"
92° 01' 38.2"

34° 24' 5.7"
92° 01' 46.4"

34° 24' 10"
92° 05' 3.2"

UTM
NE 15/589340
3813330
SE 15/589240
3806910
SW 15/584180
3807000
NW 15/584280
3813420
HL



Mapped, edited, and published by the Geological Survey
Control by USGS and USC&GS
Topography by photogrammetric methods from aerial
photographs taken 1968. Field checked 1970
Polyconic projection. 1927 North American datum
10,000-foot grid based on Arkansas coordinate system, south zone
1000-meter Universal Transverse Mercator grid ticks,
zone 15, shown in blue
Fine red dashed lines indicate selected fence and field lines where
generally visible on aerial photographs. This information is unchecked

UTM GRID AND 1970 MAGNETIC NORTH
DECLINATION AT CENTER OF SHEET

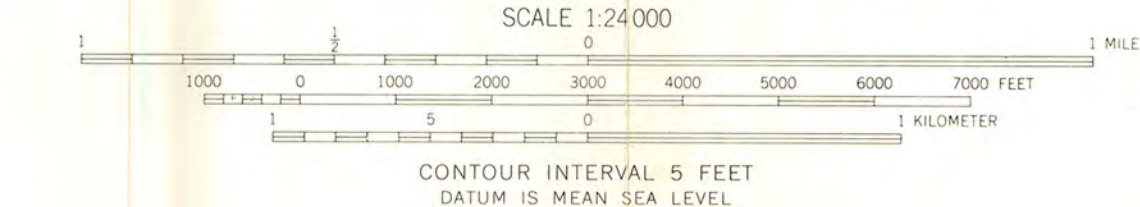

ROAD CLASSIFICATION
Secondary highway, all weather, Light-duty road, all weather,
hard surface improved surface
Unimproved road, fair or dry
weather

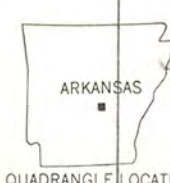

THIS MAP COMPLIES WITH NATIONAL MAP ACCURACY STANDARDS
FOR SALE BY U. S. GEOLOGICAL SURVEY, DENVER, COLORADO 80225, OR WASHINGTON, D. C. 20242
AND BY THE ARKANSAS GEOLOGICAL COMMISSION, LITTLE ROCK, ARKANSAS 72201
A FOLDER DESCRIBING TOPOGRAPHIC MAPS AND SYMBOLS IS AVAILABLE ON REQUEST

WRIGHT, ARK.
NE 1/4 PASTORIA 15' QUADRANGLE
N3422.5-W9200/7.5

1970

AMS 7552 I NE-SERIES W884

ARKANSAS HISTORIC PRESERVATION PROGRAM

1023 WEST THIRD STREET LITTLE ROCK, ARKANSAS 72201 501-374-0375



"THE OLD STATE HOUSE" 300 WEST MARKHAM

LITTLE ROCK, ARKANSAS 72201
TELEPHONE - 501 371-1639

January 14, 1975



Dr. William Murtagh
Keeper of the National Register
U. S. Department of the Interior
National Park Service
Washington, D. C. 20240

Dear Dr. Murtagh:

Attached are National Register Nominations for the following properties:

1. Plum Bayou Homesteads
2. Lake Dick
3. Lake View
4. County Line School and Lodge
5. Leake-Ingham Building
6. Choctaw Route Station
7. Reichardt House
8. Maxfield House
9. Glenn House
10. Wycough-Jones House
11. Handford-Schooler House
12. Handford-Terry House
13. Roland Mound
14. Zebree Homestead

These nominations have been approved by a majority of the State Review Committee.

Sincerely,

William E. Henderson
State Historic Preservation Officer

WEH:cm

Enclosures

ENTRIES IN THE NATIONAL REGISTER

STATE ARKANSAS

Date Entered JUN 5 1975

| <u>Name</u> | <u>Location</u> |
|---|---|
| Steamboat House | Dardanelle Yell County |
| Yoss, Colonel Jacob, Building | Chester Crawford County |
| Knox, R. M., House | Pine Bluff Jefferson County |
| Plum Bayou Homesteads (Wright Plantation) | Wright Pine Bluff vicinity Jefferson County |
| Shiloh Church | Springdale Washington County |

!! Change Card!!

| <u>Also Notified</u> | |
|----------------------------|---------------------------------------|
| Hon. John L. McClellan | State Historic Preservation Officer |
| Hon. Dale Bumpers | Mr. William E. Henderson |
| Hon. John P. Hammerschmidt | Director, Arkansas Dept. of Parks and |
| Hon. Ray Thornton | Tourism |
| | State Capitol |
| | Little Rock, Arkansas 72201 |

Regional Director, Southwest
Region

PR MMOTT: p1 6/9/75

NATIONAL REGISTER DATA SHEET

1 NAME as it appears on federal register: Plum Bayou Homesteads (Wright Plantation)

2 OTHER NAMES:

3 date of entry: 6-5-75 **4 county code:** 069

5 LOCATION street & number reverse side **city / town** Pine Bluff **state** AR **county** Jefferson **6 NPS REGION:** SW

7 OWNER ☐ PRIVATE ☐ STATE ☐ MUNICIPAL ☒ COUNTY ☐ MULTIPLE ☐ FEDERAL (agency name)

8 ADMINISTRATOR:

9 EXISTING SURVEYS ☐ HABS ☐ HAER ☐ NHL **10 FUNDED?** ☒ YES ☐ NO **11 CONGRESS DISTRICT** 4th **12 SOURCE of NOMINATION** ☒ STATE ☐ FEDERAL if state who prepared form?

13 WITHIN NATIONAL REGISTER HISTORIC DISTRICT? ☐ YES, NAME **14 WITHIN NATIONAL HISTORIC LANDMARK?** ☒ YES, NAME **15 ACRES** 5.307 ☐ LOCAL ☐ PRIVATE ORGANIZATION

16 CONDITION ☐ deteriorated ☒ altered ☒ original site ☐ excellent ☐ ruins ☐ unaltered ☐ moved ☒ good ☐ unexposed ☐ reconstructed ☐ unknown ☐ fair ☐ unexcavated ☐ excavated

17 features: ☒ SUBSTANTIALLY INTACT-1 ☒ SUBSTANTIALLY INTACT-2 ☒ SUBSTANTIALLY INTACT-3 ☐ NOT INTACT-0 ☐ NOT INTACT-0 ☐ NOT INTACT-0 ☐ UNKNOWN-4 ☐ UNKNOWN-5 ☐ UNKNOWN-6 ☐ NOT APPLICABLE-7 ☐ NOT APPLICABLE-8 ☐ NOT APPLICABLE-9

18 ACCESS ☒ YES-Restricted ☐ YES-Unrestricted ☐ No Access ☐ Unknown **19 ADAPTIVE USE** ☐ YES ☒ NO **20 SAVED?** ☐ YES ☐ NO **IS PROPERTY A HISTORIC DISTRICT?** ☒ YES ☐ NO

21 AREAS OF SIGNIFICANCE: ☐ ENGINEERING-11 ☐ LANDSCAPE ARCH.-15 ☐ POLITICS/GOVT.-21 ☐ RECREATION-28 ☐ ARCHEOLOGY-prehistoric-2 ☐ COMMERCE-6 ☐ ENTERTAINMENT-26 ☐ LAW-16 ☐ RELIGION-22 ☐ SETTLEMENT-29 ☒ ARCHEOLOGY-historic-1 ☐ COMMUNICATIONS-7 ☐ EXPLORATION-12 ☐ LITERATURE-17 ☐ SCIENCE-23 ☐ URBAN PLANNING-31 ☒ AGRICULTURE-3 ☐ CONSERVATION-8 ☐ HEALTH-27 ☐ MILITARY-18 ☒ SOCIAL/HUMANITARIAN-24 ☐ OTHER (SPECIFY) ☐ ARCHITECTURE-4 ☐ ECONOMICS-9 ☐ INDUSTRY-13 ☐ MUSIC-19 ☒ SOCIAL/CULTURAL-30 ☐ TRANSPORTATION-25 ☐ ART-5 ☐ EDUCATION-10 ☐ INVENTION-14 ☐ PHILOSOPHY-20

22 CLAIMS: explain 'first' ☐ 'oldest' ☐ 'only' ☐

23 functions WHEN HISTORICALLY SIGNIFICANT: Residential/AGRICULTURAL CURRENTLY: Ditto **24 dates** of initial construction: 1935 major alterations: historic events: **25 ETHNIC GROUP ASSOCIATION**

26 architectural style(s): Vernacular **27 architect:** **28 master builder:** **29 engineer:**

30 landscape architect / garden designer: **31 interior decorator:** **32 artist:** **33 artisan:** **34 builder/contractor:**

35 NAMES give role & date PERSONAL: EVENTS: INSTITUTIONAL:

36 NATIONAL REGISTER WRITE-UP Planned agricultural community of ~~some 100 developed~~ 40-acre tracts; each tract developed with frame, 1 1/2-story dwelling with rear 2-story barn; 50 ^{extant} surviving farmsteads show minor alterations; original ^{complex} community included community center buildings. Developed by the Resettlement Administration ~~in order~~ to improve the socio-economic conditions of the ~~southern~~ tenant farmer; retains much original rural character.

5. ✓ N of Pine Bluff, E of Arkansas River, includes town of Wright and its environs.