

DEC 28 1988

3305

KENTUCKY HISTORIC RESOURCES
Individual Inventory Form

Resource # Be-371
Boone County

1. Name of Resource: Chandler house

2. Original Owner: Unknown

3. Other Names: None

4. Prehistoric Site Building X Object
Historic Site Structure Other

5. Location: 167 South Main Street
Walton

6. Owner's Name: Ronald & Myra Cauth []

7. Owner's Address: 167 South Main Street
Walton, KY 41094

8. Evaluation: National Register []

9. Recognition & Date:
Nat.Landmark _____ Local Landmark _____
Nat.Register _____ HABS/HAER _____
Highway Marker _____ KY Inventory 1987
KY Landmark Certificate _____

10. N.R.Status & Date:

11. N.R.Group:
District Name: []
Mult.Resource Area: Boone County []
Thematic Name: []

12. Historical Theme:
Primary: Architecture []
Secondary: []
Other: []

13. Statement of Significance:
This property is significant under criterion C as a good example of the Craftsman/Bungalow style, significant to Boone County in the period 1905-1930.
[]

16. Date: Original Building 1920s []
Addition []

17. Style: Craftsman/bungalow []
[]

18. Architect/Builder: unknown

19. No. of Stories: 1½ []

20. Original Floor Plan: approx. foursquare []

21. Single Pile Double Pile N.A. X

22. Roof Form & Material: Original X
gable/ asphalt shingle Not Original

23. Structural Material: brick []

24. Exterior Material: []
common bond brick/shingle []

25. Foundation Material: poured concrete []

26. Major Alterations: None X
Moved/Rebuilt Other

27. Special Features: multiple gables

28. Outbuildings: garage []

29. Original Function: dwelling []

30. Present Use: dwelling []

31. Condition: excellent []

32. Endangered: Yes _____
No X

33. Attach Photos:
Roll: Photo Nos: No. of Slides:
5 26-29

14. History:
N/A

15. Source of historical information and/or contact person: owner

34. Prepared by: Kenneth T. Gibbs
35. Organization: Boone Co.Hist.Pres.Rev.Brd.
36. Date: September 1986
37. New Survey X Resurvey _____

KENTUCKY HISTORIC RESOURCES
 Individual Inventory Form

Resource # Be-371

38. UTM Point of Primary Building: Zone Easting Northing 39. G.I.S. Mod. []
 Quadrant: Walton 16 707785 4303245 40. Coordi.Accuracy []

41. UTM Points of Boundary (for N. R. eligible sites only):

A.	---	D.	---
B.	---	E.	---
C.	---	F.	---

42. Total Acreage in Present Property: 40 43. Acreage included in proposed N.R. boundary: 0.91

44. Site Plan (and boundary description and justification for N.R. sites):

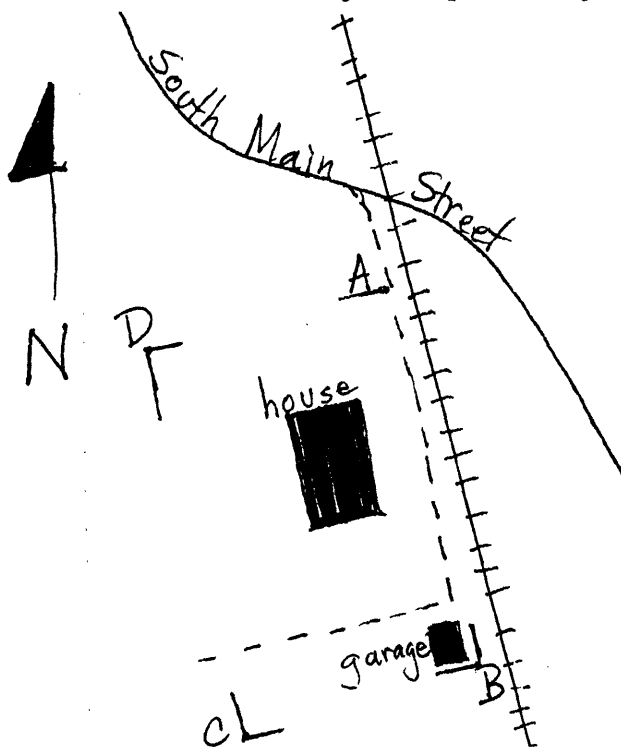

Beginning at a point 50' east northeast from the north corner of the house (A), proceed southeast 200' along the west side of the paved access lane to a point 5' east from the southeast corner of the garage (B). Then proceed 125' southwest (C), turning northwest 200' (D). Then proceed 125' northeast to the point of origin.

The boundary includes the house and garage and sufficient acreage to provide an appropriate setting. The boundary A-B is on the west side of a paved access lane.

Contributing: 2 buildings

45. Description and House Plan:

The simple, side-gabled main mass of this brick and frame 1½-story building is varied by dormers, shed-roofed at the back and gabled at the front, and by a complexly roofed porch, a crossgable combined with a shed-roofed portion. The porch is further enriched by pairs of wooden posts on brick piers, friezes of sticks, and decorative braces. All the gables of the house are filled with shingles. The double-hung sash windows appear mostly in groups, those on the first floor in the principal rooms equipped with transoms. The interior, except for the simple trabeated surrounds, is more classical in derivation than one would normally expect in a Craftsman bungalow.

The site also includes a frame, hip-roofed, single-bay garage, now covered with asphalt sheeting and is contemporary with the house.

DEC 28 1988

3305

KENTUCKY HISTORIC RESOURCES
Individual Inventory Form

Resource # Be-371
Boone County

1. Name of Resource: Chandler house

2. Original Owner: Unknown

3. Other Names: None

4. Prehistoric Site Building Structure Object Other

5. Location: 167 South Main Street
Walton

6. Owner's Name: Ronald & Myra Cauth []

7. Owner's Address: 167 South Main Street
Walton, KY 41094

8. Evaluation: National Register []

9. Recognition & Date:
 Nat.Landmark Local Landmark
 Nat.Register HABS/HAER
 Highway Marker KY Inventory 1987
 KY Landmark Certificate

10. N.R.Status & Date:

11. N.R.Group:
 District Name: []
 Mult.Resource Area: Boone County []
 Thematic Name: []

12. Historical Theme:
 Primary: Architecture []
 Secondary: []
 Other: []

13. Statement of Significance:
 This property is significant under criterion C as a good example of the Craftsman/Bungalow style, significant to Boone County in the period 1905-1930.
 []

16. Date: Original Building 1920s []
 Addition []

17. Style: Craftsman/bungalow []
 []

18. Architect/Builder: unknown

19. No. of Stories: 1½ []

20. Original Floor Plan: approx. foursquare []

21. Single Pile Double Pile N.A.

22. Roof Form & Material: Original
 gable/ asphalt shingle Not Original

23. Structural Material: brick []

24. Exterior Material: []
 common bond brick/shingle []

25. Foundation Material: poured concrete []

26. Major Alterations: None
 Moved/Rebuilt Other
 Additions

27. Special Features: multiple gables

28. Outbuildings: garage []

29. Original Function: dwelling []

30. Present Use: dwelling []

31. Condition: excellent []

32. Endangered: Yes
 No

33. Attach Photos:
 Roll: 5 Photo Nos: 26-29 No. of Slides:

14. History:
N/A

15. Source of historical information and/or contact person: owner

34. Prepared by: Kenneth T. Gibbs
 35. Organization: Boone Co.Hist.Pres.Rev.Brd.
 36. Date: September 1986
 37. New Survey Resurvey

KENTUCKY HISTORIC RESOURCES
 Individual Inventory Form

Resource # Be-371

38. UTM Point of Primary Building: Zone Easting Northing 39. G.I.S. Mod. []
 Quadrant: Walton 16 707785 4303245 40. Coordi.Accuracy []

41. UTM Points of Boundary (for N. R. eligible sites only):

A.	---	D.	---
B.	---	E.	---
C.	---	F.	---

42. Total Acreage in Present Property: 40 43. Acreage included in proposed N.R. boundary: 0.91

44. Site Plan (and boundary description and justification for N.R. sites):

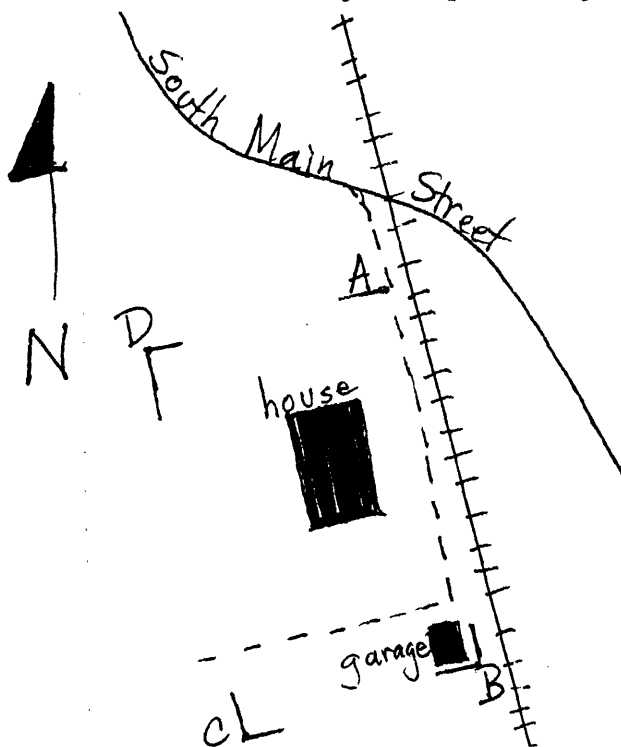

Beginning at a point 50' east northeast from the north corner of the house (A), proceed southeast 200' along the west side of the paved access lane to a point 5' east from the southeast corner of the garage (B). Then proceed 125' southwest (C), turning northwest 200' (D). Then proceed 125' northeast to the point of origin.

The boundary includes the house and garage and sufficient acreage to provide an appropriate setting. The boundary A-B is on the west side of a paved access lane.

Contributing: 2 buildings

45. Description and House Plan:

The simple, side-gabled main mass of this brick and frame 1½-story building is varied by dormers, shed-roofed at the back and gabled at the front, and by a complexly roofed porch, a crossgable combined with a shed-roofed portion. The porch is further enriched by pairs of wooden posts on brick piers, friezes of sticks, and decorative braces. All the gables of the house are filled with shingles. The double-hung sash windows appear mostly in groups, those on the first floor in the principal rooms equipped with transoms. The interior, except for the simple trabeated surrounds, is more classical in derivation than one would normally expect in a Craftsman bungalow.

The site also includes a frame, hip-roofed, single-bay garage, now covered with asphalt sheeting and is contemporary with the house.