

RECEIVED

TENNESSEE MULTIPLE PROPERTY FORM

MAR 03 1988

Title: Historic Resources of Williamson County

Historic Name: Hardeman, Franklin, House (WM-291)

Common Name: Sugar Hill

NATIONAL REGISTER

Classification: Building

Owner: Walter T. Bates, Route # 2, Sugar Hill, Franklin, TN, 37064.

Location: On Lewisburg Pike one mile south of the Goose Creek Bypass.

<u>Contributing:</u>		<u>Non-Contributing:</u>	
Buildings	1	Buildings	2
Structures	0	Structures	1
Sites	0	Sites	0
<u>Total:</u>	1	<u>Total:</u>	3

Description:

The Franklin Hardeman House is a two-story brick Greek Revival influenced residence built ca. 1835. On the main (west) facade is a two-story frame portico with four Doric motif square columns. The columns have recessed rectangular panels. The central bay is recessed with two main entrances. These entrances are composed of double doors with three vertical lights and a frame lower panel. Above the doors are stone lintels. Windows are original six-over-six sash with stone lintels and sills. On the second story of the main facade is a balcony with square posts and a square spindled railing. Doors leading to the balcony match those on the first floor.

The main facade of the house is of stretcher bond brick construction with six-course common bond found on all remaining facades. The house rests on a stone block foundation. On the north facade is a small one-story brick addition added ca. 1950. Rear doors are original four panel frame with rectangular panels in the surround. The house has a gable roof and two interior brick chimneys. At the rear (east) facade is a ca. 1960 one-story open garage.

The interior of the house retains its original floor plan which is unusual in the county with its large open room as opposed to a central passage and flanking rooms. The interior displays Greek Revival influenced mantles and a staircase with a simple newel post and square balusters. Interior photographs were not possible. Adjacent to the house are modern outbuildings and a pool. There are no contributing outbuildings. A ca. 1840 brick outbuilding is located approximately 50 yards northeast of the house but it has been extensively altered and is not included in the boundary.

Period of Significance: ca. 1835 - ca. 1860

Area of Significance: Architecture/Politics/Government

Criterion: B and C

Architect/Builder: Unknown

Statement of Significance:

The Franklin Hardeman House is a notable example of a Greek Revival influenced antebellum brick residence and is also notable for its association with Franklin Hardeman, a prominent county politician of the early 19th century. The house was built in a floor plan which is unusual in the county. Instead of the traditional central passage plan design the house was built with paired entrances on the facade entering into one large room. No other ante-bellum brick residence remaining in the county has this type of floor plan. The house is also notable for its association with Franklin Hardeman who served in the state legislature from 1847-49 and 1853-55. Hardeman also used his political influence to assist in the routing of the Tennessee and Alabama Railroad through the county in the 1850s.

In 1800, Thomas Hardeman acquired 2,160 acres in Williamson County. Hardeman was a Revolutionary War soldier and Senator in the Second General Assembly of Tennessee in 1797. Hardeman constructed a three-story log house on his lands south of Franklin and named it Sugar Hill. Hardeman's son, Peter Hardeman, inherited the house and 648 acres and lived here until his death in 1820. Upon his death, his son, Franklin Hardeman inherited the property and in 1834, he married Catherine Wilson and built a brick residence on the site of the earlier log home.

Hardeman was an influential county politician who was elected to the state house in 1847 where he served two years. He was again elected in 1853 where he served a two year term. Several accounts list Hardeman as one of the most influential county politicians before the war. In addition to his duties in the state house Hardeman was also active in using his political influence to assist the construction of the Tennessee and Alabama Railroad through Williamson County. Hardeman served as treasurer of the railroad during its formation and construction. By 1859, Hardeman owned 490 acres and 18 slaves on his farm. Hardeman was opposed to secession and remained a staunch Unionist during the Civil War. This opposition to secession ended his political career. Hardeman died in 1878 and his family continued to reside at the house until the early 1900s.

Acreage: 8.1 acres

UTM References: Bethesda Quad 16/513970/3966690

Verbal Boundary Description and Justification: The boundary for the Franklin Hardeman House are illustrated on the accompanying Williamson County tax map # 117, lot 17.06. The boundary is the legal boundary of the property and includes the house and adjacent modern outbuildings and pool. The boundary includes sufficient property to protect the historical setting of the site.

Supplemental Bibliographical References: Historic Williamson County, Bowman

* 291 FRANKLIN HARDEMAN HOUSE

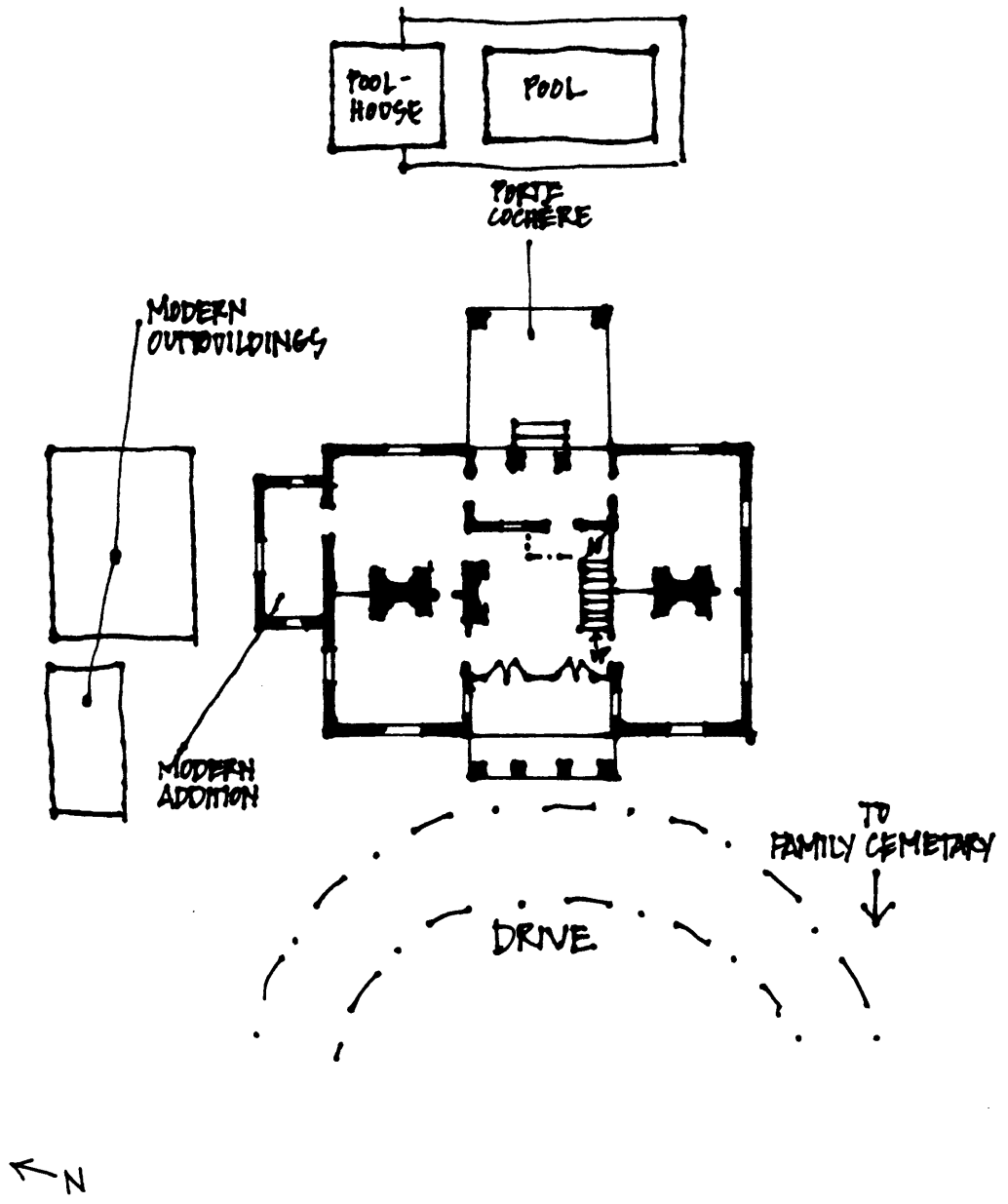

* NOT TO SCALE