

FORM B - BUILDING

MASSACHUSETTS HISTORICAL COMMISSION  
 294 WASHINGTON STREET, BOSTON, MA 02108

AREA	FORM NO.
	211

Roll 8:4A

PHOTO: (3x3" or 3x5", black & white)  
 staple to left side of form

Photo number \_\_\_\_\_

SKETCH MAP

Show property's location in relation to nearest cross streets and/or geographical features. Indicate all buildings between inventoried property and nearest intersection. Indicate north.

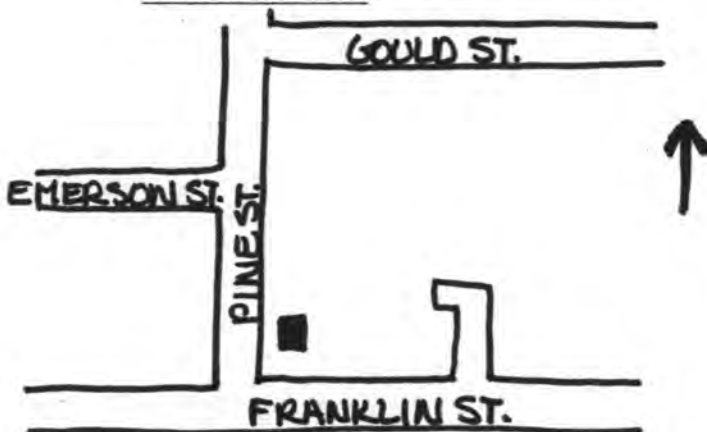

Recorded by Carole Zellie (ed. Candace Jenkins)

Organization Landscape Research (MHC)

Date May, 1979

Assessor's Map #211-41

Town Stoneham

Address 36 Pine Street

Historic Name Boston & Maine Railroad Depot

Present Owner: Stoneham Municipal Employees Credit Union

Use: Present Print shop: Versatile Printing Service

Original Train station

DESCRIPTION:

Date ca. 1895

Source Town history

Style None

Architect Unknown

Exterior wall fabric Brick with granite trim

Outbuildings None

Major alterations (with dates) Once-glazed gable fanlight blocked, recently.

Moved No Date N/A

Approx. acreage 6,312 square feet

Setting Mixed commercial, residential, institutional setting.

UTM: Boston North Quad  
 19 327570 4704820

(Staple additional sheets here)

ARCHITECTURAL SIGNIFICANCE (Describe important architectural features and evaluate in terms of other buildings within the community.)

Stoneham's Boston & Maine Railroad Depot of 1895 is typically a low, one-story structure of rectangular plan, enclosed by an overhanging hipped roof. It is constructed of brick with granite stringcourses which form a watertable and a sill for the windows. The windows contain 12/12 sash and are irregularly interspersed with five panel doors headed by rectangular transoms. The roof is pierced by a cross gable containing decorative shingles and a large, once glazed fanlight.

HISTORICAL SIGNIFICANCE (Explain the role owners played in local or state history and how the building relates to the development of the community.)

Stoneham's Boston & Main Railroad Depot possesses integrity of location, design, materials and workmanship, as well as significant associations with the town's development as a commuter suburb. Thus it meets criteria A and C of the National Register of Historic Places.

This station replaced a gambrel-roofed frame structure shown on the 1879 Bird's Eye View of Stoneham, which was constructed when the Boston & Maine (then Boston & Lowell) tracks reached the Franklin Street depot in 1863, two years after the construction of the Farm Hill station. Located adjacent to Central Square, the railroad station served to reinforce its position as Stoneham's commercial, institutional and industrial center.

This is the only 19th century depot on its original site: the frame Farm Hill station has been moved to Central Street and converted to residential use.

BIBLIOGRAPHY and/or REFERENCES (name of publication, author, date and publisher)

Stevens, History of Stoneham.

1879 Bird's Eye View.

United States Department of the Interior  
National Park Service

National Register of Historic Places  
Inventory—Nomination Form

For NPS use only

received 2/28/84  
date entered

Continuation sheet

Item number

Page 1 of 7

Multiple Resource Area  
Thematic Group

dnr-11

Name Stoneham Multiple Resource Area  
State Middlesex County, MASSACHUSETTS

Nomination/Type of Review

Date/Signature

- |                                      |   |   |
|--------------------------------------|---|---|
| 1. Lang, William Bailey, House       | Substantive Review<br>DOE/OWNER OBJECTION | Determined Eligible<br>Keeper <u>MacBrage</u> 4/13/84           |
| 2. Martin-Maxwell Estate             | Substantive Review<br>DOE/OWNER OBJECTION | Attest<br>Determined Eligible<br>Keeper <u>MacBrage</u> 4/13/84 |
| 3. Sweetser, Warren, House           | Substantive Review<br>DOE/OWNER OBJECTION | Attest<br>Determined Eligible<br>Keeper <u>MacBrage</u> 4/13/84 |
| 4. Almshouse                         | Entered in the<br>National Register       | Keeper <u>Delores Byers</u> 4/13/84                             |
| 5. Beard, Padilla, House             | Entered in the<br>National Register       | Attest<br>Keeper <u>Delores Byers</u> 4/13/84                   |
| 6. Boston and Main<br>Railroad Depot | Entered in the<br>National Register       | Attest<br>Keeper <u>Delores Byers</u> 4/13/84                   |
| 7. Bottume, John, House              | Entered in the<br>National Register       | Attest<br>Keeper <u>Delores Byers</u> 4/13/84                   |
| 8. Brown, C. H., Cottage             | Entered in the<br>National Register       | Attest<br>Keeper <u>Delores Byers</u> 4/13/84                   |
| 9. Bryant, William, Octagon<br>House | Entered in the<br>National Register       | Attest<br>Keeper <u>Delores Byers</u> 4/13/84                   |
| 10. Buck, Charles, House             | Entered in the<br>National Register       | Attest<br>Keeper <u>Delores Byers</u> 4/13/84                   |

NATIONAL REGISTER OF HISTORIC PLACES  
EVALUATION/RETURN SHEET

Boston and Maine Railroad Depot  
(Stoneham MRA)  
Middlesex County  
MASSACHUSETTS

Working No. FEB/28 1984  
Fed. Reg. Date: 2/5/85  
Date Due: 3-29-84 - 4-13-84  
Action:  ACCEPT 4-13-84  
 RETURN  
 REJECT  
Federal Agency: \_\_\_\_\_

- resubmission
- nomination by person or local government
- owner objection
- appeal

Entered in the  
National Register

Substantive Review:  sample  request  appeal  NR decision

Reviewer's comments:

Recom./Criteria \_\_\_\_\_  
Reviewer \_\_\_\_\_  
Discipline \_\_\_\_\_  
Date \_\_\_\_\_  
\_\_\_\_\_ see continuation sheet

Nomination returned for: \_\_\_\_\_ technical corrections cited below  
\_\_\_\_\_ substantive reasons discussed below

1. Name

2. Location

3. Classification

Category	Ownership	Status	Present Use
	Public Acquisition	Accessible	

4. Owner of Property

5. Location of Legal Description

6. Representation in Existing Surveys

Has this property been determined eligible?  yes  no

7. Description

Condition

- |                                    |                                       |
|------------------------------------|---------------------------------------|
| <input type="checkbox"/> excellent | <input type="checkbox"/> deteriorated |
| <input type="checkbox"/> good      | <input type="checkbox"/> ruins        |
| <input type="checkbox"/> fair      | <input type="checkbox"/> unexposed    |

Check one

- unaltered
- altered

Check one

- original site
- moved date \_\_\_\_\_

Describe the present and original (if known) physical appearance

- summary paragraph
- completeness
- clarity
- alterations/integrity
- dates
- boundary selection

---

**8. Significance**

Period      Areas of Significance—Check and justify below

Specific dates                      Builder/Architect  
Statement of Significance (*in one paragraph*)

- summary paragraph
- completeness
- clarity
- applicable criteria
- justification of areas checked
- relating significance to the resource
- context
- relationship of integrity to significance
- justification of exception
- other

---

**9. Major Bibliographical References**

---

**10. Geographical Data**

Acreage of nominated property \_\_\_\_\_  
Quadrangle name \_\_\_\_\_  
UTM References \_\_\_\_\_

Verbal boundary description and justification

---

**11. Form Prepared By**

---

**12. State Historic Preservation Officer Certification**

The evaluated significance of this property within the state is:

\_\_\_\_ national      \_\_\_\_ state      \_\_\_\_ local

State Historic Preservation Officer signature

title                      date

---

**13. Other**

- Maps
- Photographs
- Other

Questions concerning this nomination may be directed to \_\_\_\_\_

Signed \_\_\_\_\_ Date \_\_\_\_\_ Phone: \_\_\_\_\_



Boston + Maine RR Depot

Station, MRA, MA

9290

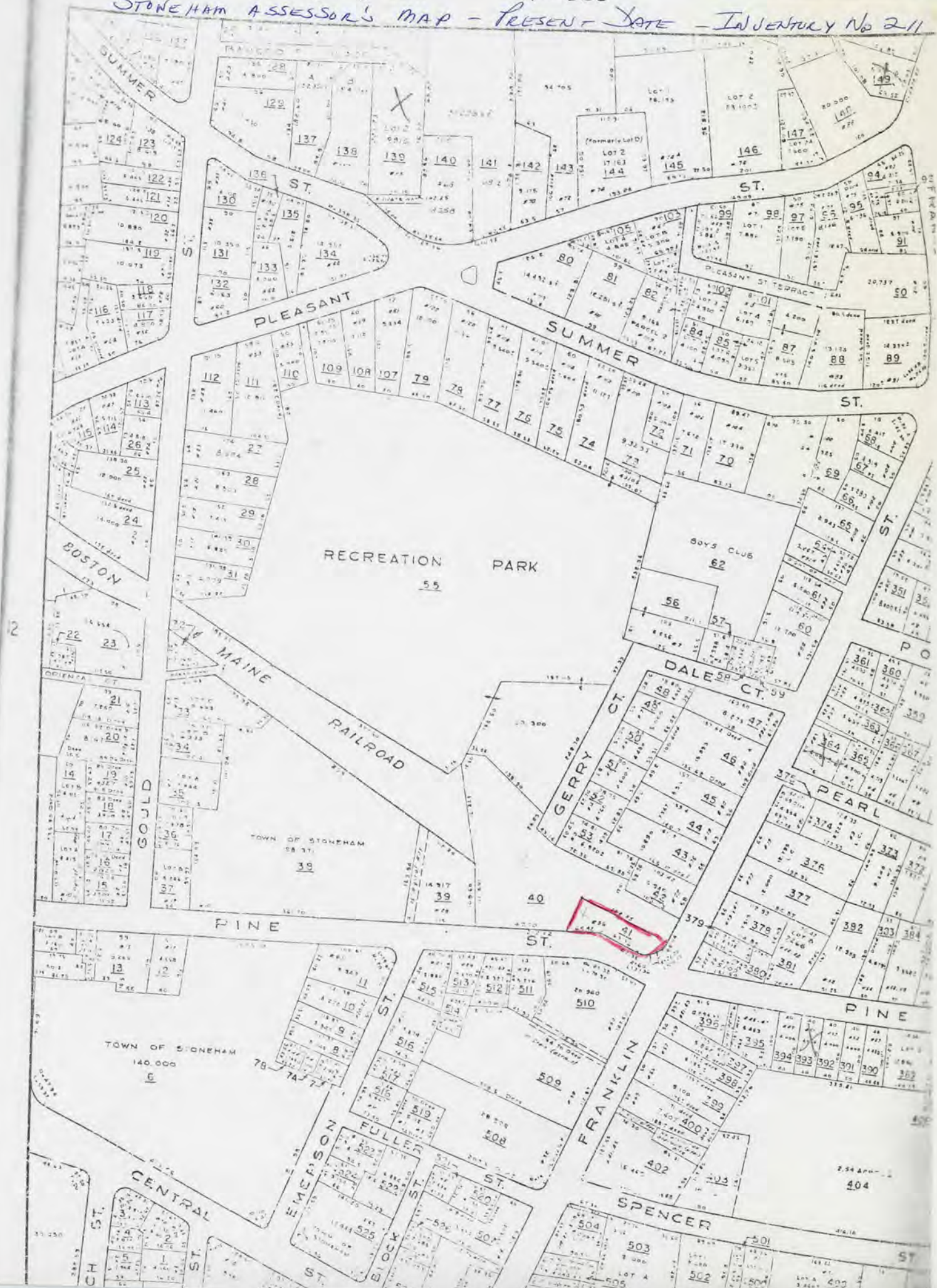

234 Apr 1900  
404

Please refer to the map in the  
Multiple Property Cover Sheet  
for this property

Multiple Property Cover Sheet Reference Number: 64000295