

NOV 26 1986

KENTUCKY HISTORIC RESOURCES
Individual Inventory Form

Resource # MS-49
Mason County

1. Name of Resource:
Springhouse in Mays Lick

2. Original Owner:
Not Known

3. Other Names:

4. Prehistoric Site Building X Object
Historic Site Structure Other

5. Location: one block northeast of town center
in Mays Lick

6. Owner's Name:
James E. Gifford [P]

7. Owner's Address:
Sardis, Kentucky 41056

8. Evaluation: [G]

9. Recognition & Date:
Nat.Landmark _____ Local Landmark _____
Nat.Register _____ HABS/HAER _____
Highway Marker _____ KY Inventory X
KY Landmark Certificate

10. N.R.Status & Date:

11. N.R.Group:
District Name: []
Mult.Resource Area: []
Thematic Name: Early Stone Buildings []

12. Historical Theme:
Primary: Architecture [030]
Secondary: []
Other: []

13. Statement of Significance:

One of several dry-stone springhouses of
this type in county. In good condition.
See Cover.

[]

14. History:

Not Researched.

15. Source of historical information and/or contact
person:

16. Date:
Original Building Ca. 1800 [8]
Addition []

17. Style:
Federal/Vernacular [2V]
[]

18. Architect/Builder:
Not Known

19. No. of Stories: One [1.0]

20. Original Floor Plan:
Rec. Pen [1R]

21. Single Pile Double Pile N.A. X

22. Roof Form & Material: Original
Metal, Gable Not Original

23. Structural Material:
Stone [S]

24. Exterior Material: Stone [S]

25. Foundation Material:
Stone [S]

26. Major Alterations: None X
Moved/Rebuilt Other

27. Special Features:
Spring arises outside springhouse

28. Outbuildings:
House & Dependency [2]

29. Original Function:
Springhouse [01C]

30. Present Use:
Vacant [9V]

31. Condition:
Good [G]

32. Endangered: Yes
No X

33. Attach Photos:
Roll: 25 Photo Nos: 2-7 No. of Slides: X

34. Prepared by: Carolyn Murray-Wooley

35. Organization: Kentucky Heritage Council

36. Date: March 1984

37. New Survey X Resurvey

KENTUCKY HISTORIC RESOURCES INVENTORY

36. UTM Point of Primary Building: 17 252300 4266890
 37. USGS Quadrant: Map Tick
 38. G.I.S. Mod. []
 39. Coordinate Accuracy []

40. UTM Points of Boundary:
 A. _____ C. _____ E. _____
 B. _____ D. _____ F. _____

41. Total Acreage in Present Property: _____ . 42. Acreage Included in Nominated Boundary: 1 acre

43. Site Plan and Boundary Description and Justification:

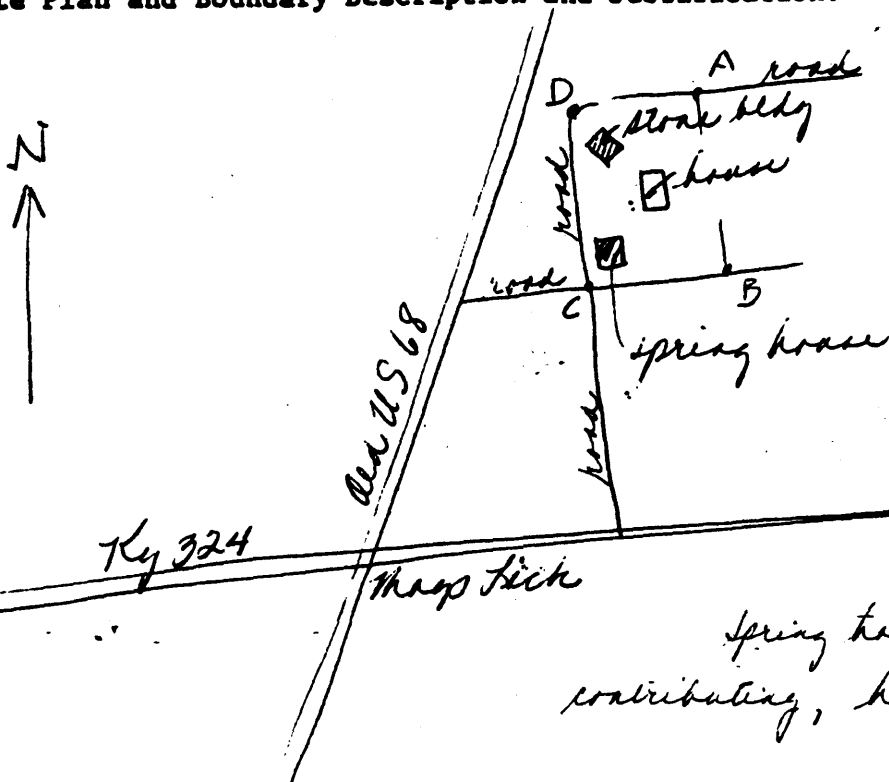

Site enclosed by A. B. C. D.
 200 feet, each side
 C-D-A are with an old road, now a lane.
 B.C are on a side street.

Spring house, stone building are contributing, house is non contributing.

45. Description & House Plan:

One and one-fourth story, dry-stone springhouse, size 12 x 14 feet; two doors in east gable end, one up, one down; one window in west gable end. Spring arises outside entrance, flows under doorway into house; flows out below north wall. Steps descend to spring from east corner (see plan).

Also at this site is a small stone dependency whose original purpose is not known. It is presently used for storage and has sheds built on both sides, which abutt, but are not interconnected with the stone building.

The house on the site has been remodelled.

