

1365

United States Department of the Interior  
National Park Service

National Register of Historic Places  
Registration Form

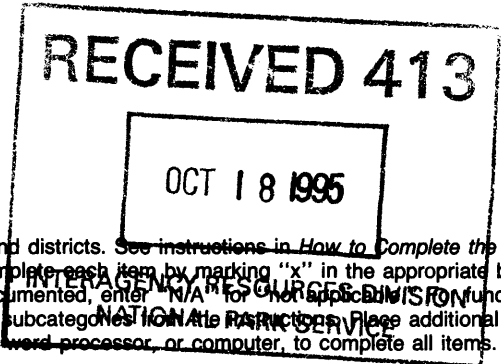

This form is for use in nominating or requesting determinations for individual properties and districts. See instructions in *How to Complete the National Register of Historic Places Registration Form* (National Register Bulletin 16A). Complete each item by marking "x" in the appropriate box or by entering the information requested. If an item does not apply to the property being documented, enter "N/A" for "not applicable." For functions, architectural classification, materials, and areas of significance, enter only categories and subcategories from the *National Register of Historic Places* additional entries and narrative items on continuation sheets (NPS Form 10-900a). Use a typewriter, word processor, or computer, to complete all items.

1. Name of Property

historic name CITIZENS BANK

other names/site number \_\_\_\_\_

2. Location

street & number 5 North Main Street n/a  not for publication

city or town Williston n/a  vicinity

state Florida code FL county Levy code 075 zip code 32696

3. State/Federal Agency Certification

As the designated authority under the National Historic Preservation Act, as amended, I hereby certify that this  nomination  request for determination of eligibility meets the documentation standards for registering properties in the National Register of Historic Places and meets the procedural and professional requirements set forth in 36 CFR Part 60. In my opinion, the property  meets  does not meet the National Register criteria. I recommend that this property be considered significant  nationally  statewide  locally. ( See continuation sheet for additional comments.)

Suzanne P. Walker / Deputy SHPO 10/9/95  
Signature of certifying official/Title Date

**Florida State Historic Preservation Officer, Division of Historical Resources**  
State of Federal agency and bureau

In my opinion, the property  meets  does not meet the National Register criteria. ( See continuation sheet for additional comments.)

\_\_\_\_\_  
Signature of certifying official/Title Date

\_\_\_\_\_  
State or Federal agency and bureau

4. National Park Service Certification

- I hereby certify that the property is:
- entered in the National Register.  See continuation sheet.
  - determined eligible for the National Register.  See continuation sheet.
  - determined not eligible for the National Register.
  - removed from the National Register.
  - other, (explain): \_\_\_\_\_

Edson R. Beall  
Signature of the Keeper

11-29-95  
Date of Action

Entered in the  
National Register

**5. Classification**

**Ownership of Property**

(Check as many boxes as apply)

- private
- public-local
- public-State
- public-Federal

**Category of Property**

(Check only one box)

- building(s)
- district
- site
- structure
- object

**Number of Resources within Property**

(Do not include previously listed resources in the count.)

Contributing	Noncontributing	
1	0	buildings
0	0	sites
0	0	structures
0	0	objects
1	0	Total

**Name of related multiple property listing**

(Enter "N/A" if property is not part of a multiple property listing.)

N/a

**Number of contributing resources previously listed in the National Register**

0

**6. Function or Use**

**Historic Functions**

(Enter categories from instructions)

COMMERCE/TRADE/  
Financial Institution

**Current Functions**

(Enter categories from instructions)

COMMERCE/TRADE/  
Speciality Store

**7. Description**

**Architectural Classification**

(Enter categories from instructions)

Vernacular

**Materials**

(Enter categories from instructions)

foundation Brick

walls Brick

roof Asphalt

other Ceramic Tile  
Glass Block

**Narrative Description**

(Describe the historic and current condition of the property on one or more continuation sheets.)

**8. Statement of Significance**

**Applicable National Register Criteria**

(Mark "x" in one or more boxes for the criteria qualifying the property for National Register listing.)

- A** Property is associated with events that have made a significant contribution to the broad patterns of our history.
- B** Property is associated with the lives of persons significant in our past.
- C** Property embodies the distinctive characteristics of a type, period, or method of construction or represents the work of a master, or possesses high artistic values, or represents a significant and distinguishable entity whose components lack individual distinction.
- D** Property has yielded, or is likely to yield, information important in prehistory or history.

**Criteria Considerations**

(Mark "x" in all the boxes that apply.)

Property is:

- A** owned by a religious institution or used for religious purposes.
- B** removed from its original location.
- C** a birthplace or grave.
- D** a cemetery.
- E** a reconstructed building, object, or structure.
- F** a commemorative property.
- G** less than 50 years of age or achieved significance within the past 50 years.

**Areas of Significance**

(Enter categories from instructions)

**COMMERCE**

**ARCHITECTURE**

**Period of Significance**

**1914-1938**

**Significant Dates**

**1914**

**Significant Person**

(Complete if Criterion B is marked above)

**N/A**

**Cultural Affiliation**

**N/A**

**Architect/Builder**

**Unknown / Unknown**

**Narrative Statement of Significance**

(Explain the significance of the property on one or more continuation sheets.)

**9. Major Bibliographical References**

**Bibliography**

(Cite the books, articles, and other sources used in preparing this form on one or more continuation sheets.)

**Previous documentation on file (NPS):**

- preliminary determination of individual listing (36 CFR 67) has been requested
- previously listed in the National Register
- previously determined eligible by the National Register
- designated a National Historic Landmark
- recorded by Historic American Buildings Survey # \_\_\_\_\_
- recorded by Historic American Engineering Record # \_\_\_\_\_

**Primary location of additional data:**

- State Historic Preservation Office
- Other State agency
- Federal agency
- Local government
- University
- Other

Name of repository:

\_\_\_\_\_

**CITIZENS BANK**

Name of Property

**Levy County, Fl.**

County and State

**10. Geographical Data**

**Acreege of Property** Less than one acre

**UTM References**

(Place additional UTM references on a continuation sheet.)

1	17	359540	3251600
Zone	Easting	Northing	
2			

3			
Zone	Easting	Northing	
4			

See continuation sheet

**Verbal Boundary Description**

(Describe the boundaries of the property on a continuation sheet.)

**Boundary Justification**

(Explain why the boundaries were selected on a continuation sheet.)

**11. Form Prepared By**

name/title Sherry Piland, Historic Sites Specialist

organization Bureau of Historic Preservation date October 1995

street & number R.A. Gray Bldg., 500 S. Bronough telephone (904) 487-2333

city or town Tallahassee state Fl. zip code 32399-0250

**Additional Documentation**

Submit the following items with the completed form:

**Continuation Sheets**

**Maps**

A **USGS map** (7.5 or 15 minute series) indicating the property's location.

A **Sketch map** for historic districts and properties having large acreage or numerous resources.

**Photographs**

Representative **black and white photographs** of the property.

**Additional items**

(Check with the SHPO or FPO for any additional items)

**Property Owner**

(Complete this item at the request of SHPO or FPO.)

name \_\_\_\_\_

street & number \_\_\_\_\_ telephone \_\_\_\_\_

city or town \_\_\_\_\_ state \_\_\_\_\_ zip code \_\_\_\_\_

**Paperwork Reduction Act Statement:** This information is being collected for applications to the National Register of Historic Places to nominate properties for listing or determine eligibility for listing, to list properties, and to amend existing listings. Response to this request is required to obtain a benefit in accordance with the National Historic Preservation Act, as amended (16 U.S.C. 470 *et seq.*)

**Estimated Burden Statement:** Public reporting burden for this form is estimated to average 18.1 hours per response including time for reviewing instructions, gathering and maintaining data, and completing and reviewing the form. Direct comments regarding this burden estimate or any aspect of this form to the Chief, Administrative Services Division, National Park Service, P.O. Box 37127, Washington, DC 20013-7127; and the Office of Management and Budget, Paperwork Reductions Projects (1024-0018), Washington, DC 20503.

RECEIVED 413

OCT 18 1995

United States Department of the Interior  
National Park Service

## National Register of Historic Places Continuation Sheet

CITIZENS BANK, NORTH MAIN STREET, DIVISION  
LEVY COUNTY NATIONAL PARK SERVICE

Section number 7 Page 1

The Citizens Bank at 5 North Main Street in downtown Williston, Florida, was constructed in 1914. The one-story commercial building is of masonry construction, with exterior yellow brick walls. A cast stone cornice marks the beginning of a parapet which partially conceals a low hipped roof.

### SETTING

The bank is located on the northeast corner of a commercial block, bounded by E. Main (formerly E. Railroad) on the west and E. Noble on the south. It is one of numerous buildings that were constructed between the 1910s and 1930 on the major commercial block of Williston. The railroad originally ran down the middle of what is now Main Street. Other commercial buildings are located to the north, south, and east. The Williston City Hall is to the west.

### EXTERIOR

The canted main entrance of the Citizens Bank is recessed at the southwest corner of the building (Photo 1). Openings on each side of a brick pier at this corner provides access to the entrance from either E. Noble or E. Main. A secondary entrance is located at the north end of the west elevation (Photo 2). Like the main entrance, it retains its original glazed doors. Plate glass display windows are located on the south (Photo 3) and west elevations. They have recessed, brick kick panels and cast stone sills. Glass block transoms are located above the windows and the entrances (Photos 4 and 5). The floor of the entry porch has white, octagonal tile with "Citizens Bank" inlaid in red tile. A metal plate at the edge of the tile is imprinted with "Citizens Bank 1914."

### INTERIOR

The interior of the bank is a large, rectangular space which opens to the adjoining shop on the north wall. A quarter turn stairway in the northeast corner leads to an attic that is used for storage (Photo 6). A small bathroom is located under the stairway.

United States Department of the Interior  
National Park Service

# National Register of Historic Places Continuation Sheet

Section number 7 Page 2

CITIZENS BANK, WILLISTON,  
LEVY COUNTY, FLORIDA

---

The most distinguishing features of the interior are the floor and ceiling. The floor at the entry and in what was the public area of the bank has octagonal tile with an intricate, colorful pattern (Photo 7). The edge of the tiled area corresponds to where the bank teller counter was formerly located. The rest of the floor is wood. The ceiling is covered with decorative pressed metal which gives a coffered effect (Photo 8). There is also a pressed metal cornice (Photo 9). The walls are plastered, except for a small area of the north wall, which is covered with mahogany veneer panelling.

## ALTERATIONS

The Citizens Bank has received few alterations. Some of the glass block and transoms have been painted, and the bathroom fixtures are not original. The banking furniture and grill work have been removed, probably when the bank was liquidated between 1927 and 1938. In the late 1940s, the flat roof was converted to a low hip in order to create an attic storage space. Interior stairs accessing the attic were added at the same time (Photo 6).

**United States Department of the Interior  
National Park Service**

**National Register of Historic Places  
Continuation Sheet**

**CITIZENS BANK, WILLISTON,  
LEVY CO., FL.**

Section number 8 Page 1

---

The Citizens Bank in Williston, Florida, is significant at the local level under Criterion A in the area of Commerce as a representation of the prosperity Williston enjoyed from the early 1900s until the collapse of the Florida land boom in the mid-1920s. The building is also significant under Criterion C as the oldest bank building remaining in Williston and as a well preserved local example of early twentieth century commercial architecture. Although the banking furniture has been removed, the building retains its original architectural features to a remarkable degree. It is one of the most intact, historic buildings in Williston.

**HISTORIC CONTEXT**

Williston is located in Levy County, which borders the Gulf Coast of Florida, north of the Tampa area. Levy is a rural county supported by the timber industry and vegetable farming. Williston, thirteen miles southeast of Bronson, the county seat, is a major trading center in the eastern part of the county. In 1993, it had a population of 2,240.

The Williston area was first settled in 1840, but did not really grow until after the Civil War. By 1875, it had a population of 200, and between 1879 and 1880, a post office was established there and named after Jesse Mercer Willis (1822-1881), the founder of the community. In 1886, Williston, with a population of 100, had one general store, a steam saw, grist mill, vegetable crate factory, cotton gin, public school, and two churches. The major crops were Sea Island cotton, oranges, and vegetables. The nearest bank was in Gainesville. Williston was first incorporated on June 2, 1897. Over the next three decades the town was unincorporated and reincorporated twice, obtaining its present charter in 1929.

In 1906, J. B. Epperson, R. D. Medlin, W. M. Barton, J. N. Willis, and H. DeLand chartered the community's first financial institution, the Bank of Williston. These were among the most prominent businessmen in the community. Epperson was a developer and operator of a large general merchandise business. He was also the second post master of the town, a position he held for a number of years. Jasper N. Willis was the son of the town's founder. By 1911-12, Williston had grown to a population of 400.

United States Department of the Interior  
National Park Service

National Register of Historic Places  
Continuation Sheet

CITIZENS BANK, WILLISTON,  
LEVY CO., FL.

Section number 8 Page 2

It was serviced by the Seaboard Air Line and Atlantic Coast Line Railroads. It also had a hotel and a weekly newspaper, The Advocate. By this time, Williston was well established as a trading center and shipping point, serving the region's truck farmers. The major crop was cucumbers, and the town adopted the nickname, "Cucumber Capital of the World." As many as seventeen railroad cars of cucumbers were shipped daily from the town in 1917.

**HISTORIC SIGNIFICANCE**

The Bank of Williston remained the only bank in the community until 1914, when the Citizens Bank was constructed at the corner of E. Noble and E. Railroad (now E. Main), near the Bank of Williston, in the heart of the town's commercial area. In 1918, the president of the Citizens Bank was R. L. Watt, and the cashier was George Blitch. Their capital was \$18,000, less than that of the Bank of Williston. In addition to this second bank, as of 1918, the town of 1,200 citizens had added a second hotel, a theater, an ice and cold storage plant, and electricity.

The 1920s, however, brought a decline in Williston's prosperity. By 1925, the population fell to 1,100, and the Citizens Bank was the only Williston bank listed in the state business directory. At that time the bank president was Norvin A. Perry, a Tampa financier. The Citizens Bank officially absorbed the Bank of Williston on August 2, 1926, leaving the town with only one financial institution. Its capital was only \$15,000.

In November 1927, the Citizens Bank itself closed, perhaps a victim of the 1926 collapse of the Florida Land Boom. Although the real estate boom is primarily associated with South Florida, its effects were felt throughout the state. Liquidation proceedings for the Citizens Bank lasted until September 1938.

**ARCHITECTURAL CONTEXT**

The one-part block is a commercial design that was common in small cities and towns in the late nineteenth and twentieth centuries. The one-part block is a simple rectangular, one-story building, often with an ornate facade. It was usually utilized



**United States Department of the Interior  
National Park Service**

**National Register of Historic Places  
Continuation Sheet**

**CITIZENS BANK, WILLISTON,  
LEVY CO., FL.**

Section number 8 Page 3

---

for retail or office space. Most have flat, built-up roofs with parapets, and exteriors of brick or stucco. Fenestration was often plate glass windows and glazed, wooden doors.

**ARCHITECTURAL SIGNIFICANCE**

The Citizens Bank displays many of the features associated with one-part block commercial buildings, including its one-story configuration and fenestration. It also displays, however, some exceptional details which contribute to its architectural significance in Williston. Most outstanding is the intricately patterned tile floor at the entrance and in the interior which probably conveyed a sense of prosperity. The pressed metal ceilings also would have added to that sense which a financial institution would want to promote. In addition, the building retains its original doors, windows, and glass block storefront features. The bank is one of the least altered buildings in the commercial area of Williston.

United States Department of the Interior  
National Park Service

**National Register of Historic Places  
Continuation Sheet**

Section number   9   Page   1  

**CITIZENS BANK, WILLISTON,  
LEVY COUNTY, FL.**

---

The Book of Florida. n.p.: James O. Jones, 1925

Coulter, William R. "A Brief History of Williston." Williston Sun, 30 October 1947.

Florida Gazetteer and Business Directory. New York: South Publishing Company, 1886-87.

Florida Gazetteer and Business Directory. Jacksonville: R. L. Polk and Company, 1918.

"Levy County, Florida." Florida Times Union, January 1890.

Sanborn Fire Insurance Map of Williston, Levy County, Florida. Pelham, New York: Sanborn Publishing Co., 1923.

Search for Yesterday: A History of Levy County, Florida. Bronson: Levy County Archives Committee, 1977.

State of Florida. Office of the Comptroller, Closed Bank Records, 1898-1942. In the Florida State Archives, S64, Box 2, #25240

Verrill, Ruth. Romantic and Historic Levy County. Gainesville: Storter Printing Co., 1976.

**United States Department of the Interior  
National Park Service**

**National Register of Historic Places  
Continuation Sheet**

**CITIZENS BANK, WILLISTON, LEVY  
COUNTY, FLORIDA**

Section number 10 Page 1

---

**VERBAL BOUNDARY DESCRIPTION**

Williston Block 12, begin at corner of lot 10, run south 52 feet, east 26 feet, north 52 feet, and west 26 feet; as described in Deed Book 423, pages 9-10.

**BOUNDARY JUSTIFICATION**

The nominated property includes the entire parcel historically associated with the Citizens Bank.

**United States Department of the Interior  
National Park Service**

**National Register of Historic Places  
Continuation Sheet**

**CITIZENS BANK, WILLISTON,  
LEVY COUNTY, FL.**

Section number Photo Page 1

---

1. Citizens Bank
2. Williston, Levy County, Florida
3. Rebecca Pessa
4. January 1995
5. Rebecca Pessa, Route 4, Box 1400, Williston, Fl.
6. West facade on left, south facade on right; view looking northeast
7. Photo 1 of 9

1. Citizens Bank
2. Williston, Levy County, Florida
3. Robert Jones
4. April 1995
5. Bureau of Historic Preservation, 500 S. Bronough Street, Tallahassee, Fl.
6. Main (west) facade, view looking east
7. Photo 2 of 9

1. Citizens Bank
2. Williston, Levy County, Florida
3. Robert Jones
4. April 1995
5. Bureau of Historic Preservation, 500 S. Bronough Street, Tallahassee, Fl.
6. South elevation, view looking northwest
7. Photo 3 of 9

1. Citizens Bank
2. Williston, Levy County, Florida
3. Rebecca Pessa
4. January 1995
5. Rt. 4, Box 1400, Williston, Fl.
6. Interior detail, view looking south
7. Photo 4 of 9

**Numbers 1-5 are the same for the remaining photographs**

6. Interior detail, view looking southwest
7. Photo 5 of 9

6. Interior detail, view looking northeast
7. Photo 6 of 9

**United States Department of the Interior  
National Park Service**

**National Register of Historic Places  
Continuation Sheet**

Section number Photo Page 2

**CITIZENS BANK, WILLISTON,  
LEVY COUNTY, FL.**

- 
- 6. Interior detail, ceramic tile floor; view looking northeast
  - 7. Photo 7 of 9
  
  - 6. Interior detail, ceiling; view looking up
  - 7. Photo 8 of 9
  
  - 6. Interior detail, ceiling; view looking up
  - 7. Photo 9 of 9

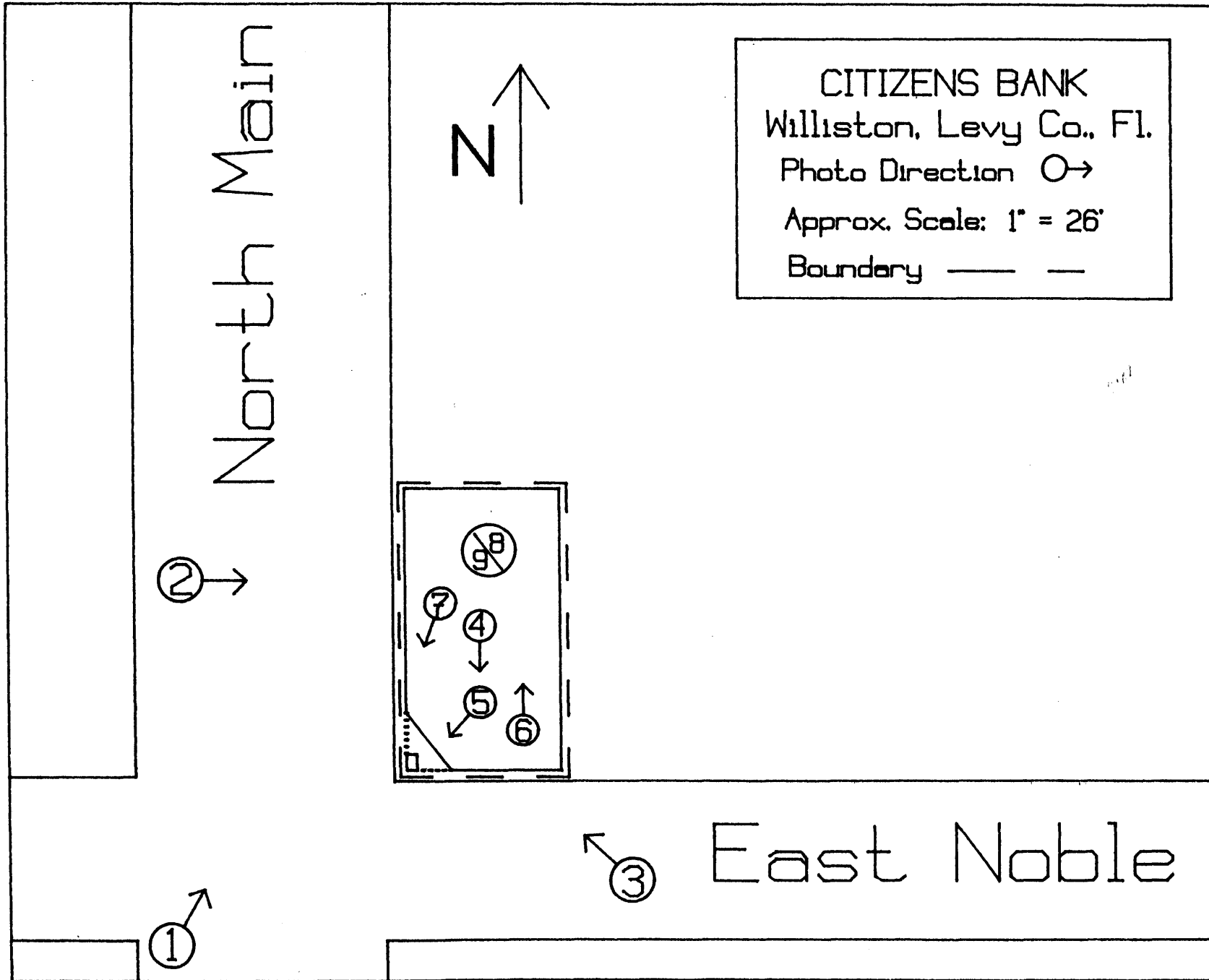

CITIZENS BANK  
Williston, Levy Co., Fl.  
Photo Direction  $\rightarrow$   
Approx. Scale: 1" = 26'  
Boundary — —

North Main

East Noble

