

P11602-1051

**NATIONAL REGISTER OF HISTORIC PLACES
INVENTORY - NOMINATION FORM**

(Type all entries - complete applicable sections)

STATE: Indiana	
COUNTY: Vanderburgh	
FOR NPS USE ONLY	
ENTRY NUMBER 71.7.18.0001	DATE 7/3/71

1. NAME

COMMON:
Evansville Post Office

AND/OR HISTORIC:
Customs House

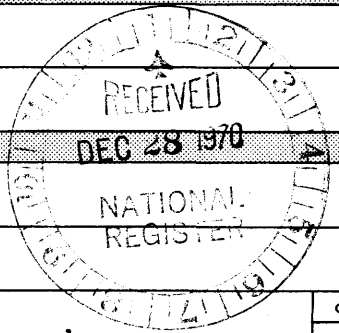

2. LOCATION

STREET AND NUMBER:
100 Block North West Second Street

CITY OR TOWN:
Evansville

STATE: Indiana	CODE: 18	COUNTY: Vanderburgh	CODE: 163
--------------------------	--------------------	-------------------------------	---------------------

3. CLASSIFICATION

CATEGORY (Check One)	OWNERSHIP	STATUS	ACCESSIBLE TO THE PUBLIC
<input type="checkbox"/> District <input type="checkbox"/> Site <input type="checkbox"/> Object <input checked="" type="checkbox"/> Building <input type="checkbox"/> Structure	<input checked="" type="checkbox"/> Public <input type="checkbox"/> Private <input type="checkbox"/> Both	<input type="checkbox"/> Occupied <input checked="" type="checkbox"/> Unoccupied <input type="checkbox"/> Preservation work in progress	Yes: <input type="checkbox"/> Restricted <input type="checkbox"/> Unrestricted <input checked="" type="checkbox"/> No
PRESENT USE (Check One or More as Appropriate)			
<input type="checkbox"/> Agricultural <input type="checkbox"/> Commercial <input type="checkbox"/> Educational <input type="checkbox"/> Entertainment	<input type="checkbox"/> Government <input type="checkbox"/> Industrial <input type="checkbox"/> Military <input type="checkbox"/> Museum	<input type="checkbox"/> Park <input type="checkbox"/> Private Residence <input type="checkbox"/> Religious <input type="checkbox"/> Scientific	<input type="checkbox"/> Transportation <input type="checkbox"/> Other (Specify) <input checked="" type="checkbox"/> Comments Not in use

4. OWNER OF PROPERTY

OWNER'S NAME:
United States Government

STREET AND NUMBER:
General Services Administration

CITY OR TOWN:
Washington, D. C.

STATE:
DC

CODE:
11

5. LOCATION OF LEGAL DESCRIPTION

COURTHOUSE, REGISTRY OF DEEDS, ETC.:
Pigeon Township Assessor Office

STREET AND NUMBER:
Vanderburgh City and County Building

CITY OR TOWN:
Evansville

STATE:
Indiana

CODE:
18

6. REPRESENTATION IN EXISTING SURVEYS

TITLE OF SURVEY:
None

DATE OF SURVEY:
 Federal State County Local

DEPOSITORY FOR SURVEY RECORDS:

STREET AND NUMBER:

CITY OR TOWN:
Evansville

STATE:
Indiana

CODE:
18

SEE INSTRUCTIONS

STATE:

COUNTY:

ENTRY NUMBER

DATE

FOR NPS USE ONLY

71.7.18.0001
7/3/71

7. DESCRIPTION

CONDITION

(Check One)			
<input checked="" type="checkbox"/> Excellent	<input type="checkbox"/> Good	<input type="checkbox"/> Fair	<input type="checkbox"/> Deteriorated
(Check One)		(Check One)	
<input checked="" type="checkbox"/> Altered	<input type="checkbox"/> Unaltered	<input type="checkbox"/> Moved	<input checked="" type="checkbox"/> Original Site

DESCRIBE THE PRESENT AND ORIGINAL (if known) PHYSICAL APPEARANCE

The United States Customs House and Post Office, 1876-79 is an example of Victorian or Ruskinian Gothic. It was designed by A. B. Mullett and constructed of Bedford (Indiana) limestone. Features are the frontal arcade, the oriel window, the slate roof, and the brownstone color contrast and carving. The building consists of three stories and a basement. The interior is typical of the era. It has been in use until recently when the Government Offices were moved to the new building at the Civic Center.

A loading dock has been added to the rear of the building for the use of mail trucks.

The most apt description would probably be from Evansville,

Her Commerce and Manufactures by Charles E. Roberts---

Supervisory Architect A. B. Mullet, Esq. declared his purpose to erect a building as spacious and elegant as the future importance of the place demands and the appropriation will permit, above all things, building it substantial and of non-combustible material. The grounds will also be handsomely ornamented so that when completed, the edifice and surroundings will reflect credit both on the city and on the Government.

*Original of
copy of the building*

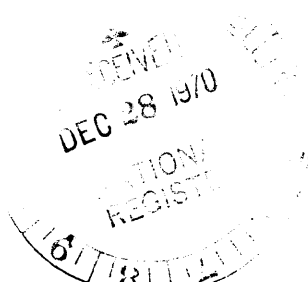

SEE INSTRUCTIONS

4. SIGNIFICANCE

PERIOD (Check One or More as Appropriate)

- Pre-Columbian | 16th Century | 18th Century | 20th Century
- 15th Century | 17th Century | 19th Century

SPECIFIC DATE(S) (If Applicable and Known) **Appropriation 1873 completion 1879**

AREAS OF SIGNIFICANCE (Check One or More as Appropriate)

- | | | | |
|---|---|---|---|
| <input type="checkbox"/> Aboriginal
<input type="checkbox"/> Prehistoric
<input type="checkbox"/> Historic
<input type="checkbox"/> Agriculture
<input checked="" type="checkbox"/> Architecture
<input type="checkbox"/> Art
<input type="checkbox"/> Commerce
<input type="checkbox"/> Communications
<input type="checkbox"/> Conservation | <input type="checkbox"/> Education
<input type="checkbox"/> Engineering
<input type="checkbox"/> Industry
<input type="checkbox"/> Invention
<input type="checkbox"/> Landscape
<input type="checkbox"/> Literature
<input type="checkbox"/> Military
<input type="checkbox"/> Music | <input type="checkbox"/> Political
<input type="checkbox"/> Religion/Philosophy
<input type="checkbox"/> Science
<input type="checkbox"/> Sculpture
<input type="checkbox"/> Social/Humanitarian
<input type="checkbox"/> Theater
<input type="checkbox"/> Transportation | <input type="checkbox"/> Urban Planning
<input type="checkbox"/> Other (Specify)

_____ |
|---|---|---|---|

STATEMENT OF SIGNIFICANCE

This structure is considered one of the finest representations of the work of A. B. Mullett still in existence.

SEE INSTRUCTIONS

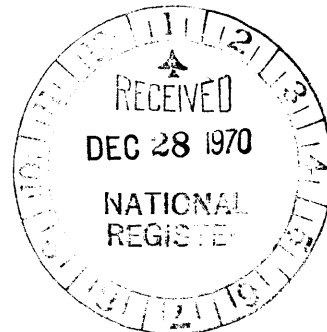

9. MAJOR BIBLIOGRAPHICAL REFERENCES

Charles E. Robert Evansville, Her Commerce and Manufactures
 Courier Co. Job and Book Printers, Evansville, Indiana 1874

Evansville City Directory 1876 and 1879

Act of Congress 43rd Session, Bill 2987 (To authorize erection
 of Customs House at Evansville.)

Howard Wooden Architectural Heritage of Evansville
 Copyright 1962 by the Evansville Museum of Arts and Science

10. GEOGRAPHICAL DATA

LATITUDE AND LONGITUDE COORDINATES DEFINING A RECTANGLE LOCATING THE PROPERTY			O R	LATITUDE AND LONGITUDE COORDINATES DEFINING THE CENTER POINT OF A PROPERTY OF LESS THAN TEN ACRES		
CORNER	DEGREES	LONGITUDE		LATITUDE	LONGITUDE	
	Degrees Minutes Seconds	Degrees Minutes Seconds	Degrees Minutes Seconds	Degrees Minutes Seconds		
NW	00° 00' 00"	00° 00' 00"	37° 58' 17"	87° 34' 17"		
NE	00° 00' 00"	00° 00' 00"				
SE	00° 00' 00"	00° 00' 00"				
SW	00° 00' 00"	00° 00' 00"				

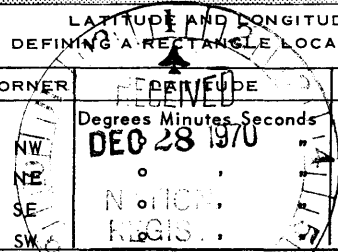

No UTM
 CX

APPROXIMATE ACREAGE OF NOMINATED PROPERTY: **Approximately one acre**

LIST ALL STATES AND COUNTIES FOR PROPERTIES OVERLAPPING STATE OR COUNTY BOUNDARIES

STATE:	CODE	COUNTY	CODE
Indiana		Vanderburgh	
STATE:	CODE	COUNTY:	CODE
None overlapping		None overlapping	
STATE:	CODE	COUNTY:	CODE
STATE:	CODE	COUNTY:	CODE

SEE INSTRUCTIONS

11. FORM PREPARED BY

NAME AND TITLE:
Gwendolyn F. Koch, Area Rep. Martha J. Rogers, Historian

ORGANIZATION **Southwestern Region of Historic Landmarks Foundation of Indiana** DATE **July 10, 1970**

STREET AND NUMBER:
400 S. E. Riverside Drive

CITY OR TOWN: **Evansville** STATE **Indiana 47713** CODE **18**

12. STATE LIAISON OFFICER CERTIFICATION

As the designated State Liaison Officer for the National Historic Preservation Act of 1966 (Public Law 89-665), I hereby nominate this property for inclusion in the National Register and certify that it has been evaluated according to the criteria and procedures set forth by the National Park Service. The recommended level of significance of this nomination is:

MS National State Local
 9/15/83

Name *John R. Dreyfus*

Title State Liaison Officer

Date December 23, 1970

NATIONAL REGISTER VERIFICATION

I hereby certify that this property is included in the National Register.

Ernest A. Connolly
 Chief, Office of Archeology and Historic Preservation

JUL 2 1971

Date _____

ATTEST:

William H. Hunt
 Keeper of The National Register

Date JUN 29 1971

HISTORIC PRESERVATION IN EVANSVILLE

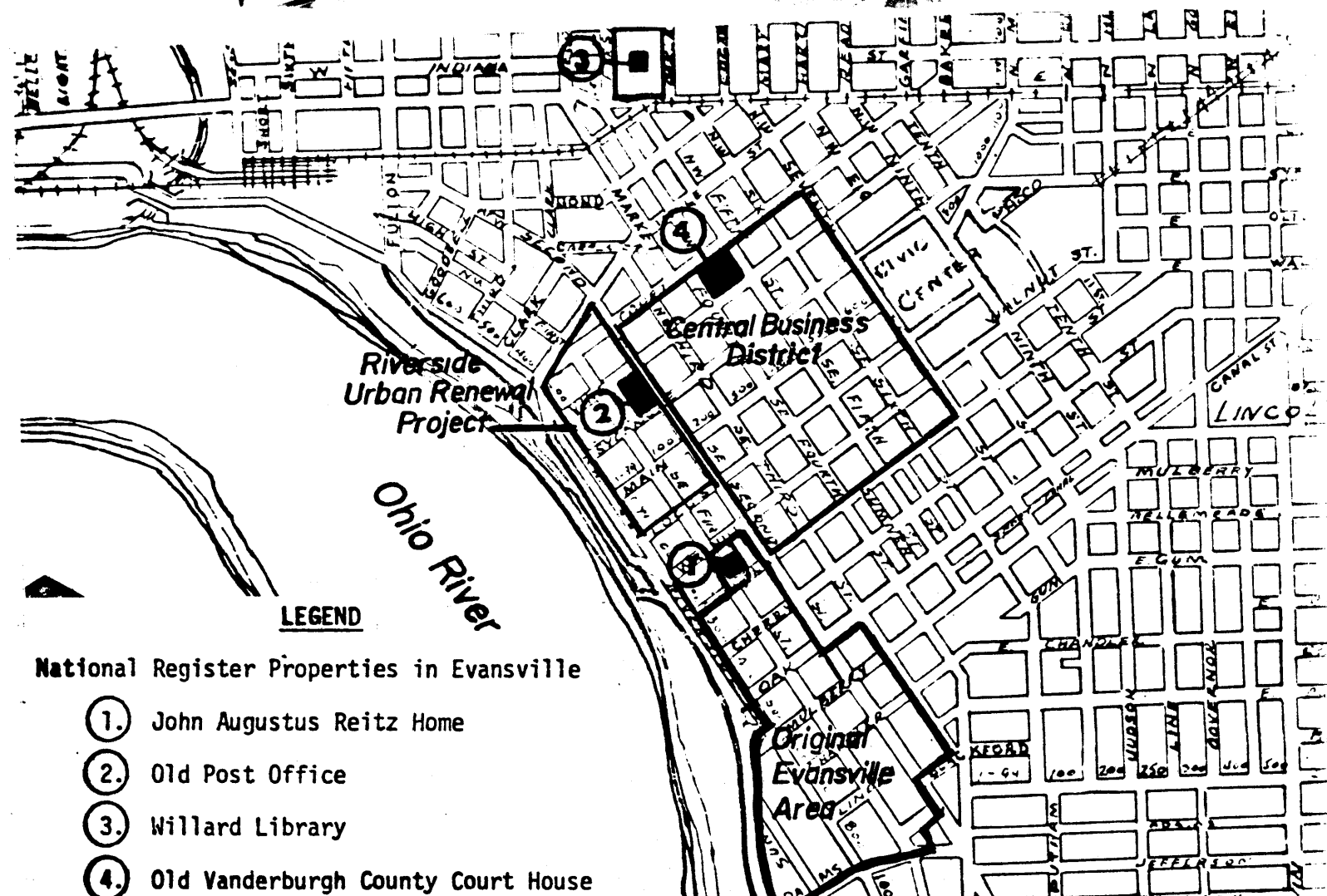
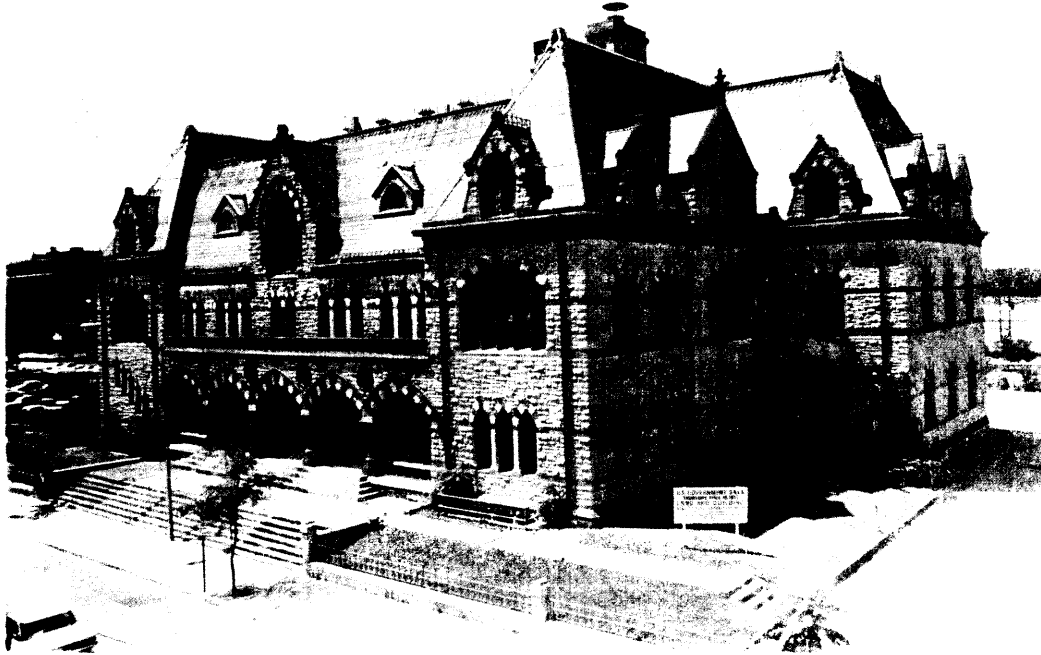

HISTORIC PRESERVATION IN EVANSVILLE

THE OLD VANDERBURGH COUNTY COURT HOUSE

Courts & Vine

The Old Vanderburgh County Court House was placed on the National Register of Historic Places in 1970. The Conrad Baker Foundation was established in 1967. The corporate charter provides that the purpose of the Foundation is to foster an interest in the preservation of significant structures and to engage in the preservation of such structures. With that in mind the Foundation entered into a ninety-nine (99) year lease on the Old Vanderburgh County Courthouse and has directed its efforts toward preserving and restoring that structure. The Foundation has sponsored a wide variety of activities in pursuit of its objectives of maintaining this architecturally significant building. Some of the present activities are gift shops, embroidery shop, churches, YMCA, theatrical groups, fun shop displays, and the Enchanted World of Christmas.

WILLARD LIBRARY

21 First Avenue

Willard Library was built in 1884 by architect Charles Reid and was placed on the National Register of Historic Places in 1972. Since 1974 Willard Library has been engaged in a program of renovation involving extensive repairs to the heating system; installation of heating, air conditioning, and lighting on the top floor; electrical work; interior painting; construction of shelving consonant with the original oak woodwork; purchase of solar screens; roof repair; and widening of the driveway and parking area. The results of this program, which is still in progress, will be to restore the interior of the building to the feeling of its original Victorian elegance and also to increase the useable floorspace by more than one-third through making the upper story serviceable year round. Much of the funding for the renovation has come from the Friends of Willard Library and federal revenue sharing.

EVANSVILLE JUNIOR LEAGUE

The Junior League of Evansville became involved in Historic Preservation around 1970 when an interest group was formed. The group joined the National Trust for Historic Preservation and began to inventory a designed

area of downtown Evansville. Later committees were instrumental in the formation of the Reitz Home Preservation Society and two slide presentations. Currently, a special committee is publishing a book on the architectural and historical homes of Evansville.

OLD POST OFFICE AND CUSTOM HOUSE

1st and Sycamore

Mayor Lloyd in February of 1976 decided that action would be necessary to save the Old Post Office and Customhouse from demolition. The City has made an application to the General Services Administration to acquire the building. This process is currently in the negotiation stage. Plans call for cooperative venture between City and private developers to rehabilitate the building. The year 1976 should see the City accepting title and developing a plan for restoration.

THE ORIGINAL EVANSVILLE PRESERVATION COMMISSION

The Original Evansville Preservation Commission was established by a State enabling ordinance in 1974. The Commission is comprised of nine citizen members who serve without compensation. Meetings are held monthly where the members are charged with the duty of approving or disapproving proposed exterior changes to structures within the Preservation District. The Preservation Commission, in effect, tries to insure proper restoration of the historic district and continued preservation of the old structures for the community.

THE REITZ HOME PRESERVATION SOCIETY

224 S.E. 1st

The purpose of this preservation society is to restore the victorian John Augustus Reitz Home (since 1870). The home was listed on National Register of Historic Places in 1973 and serves the people of Evansville as a living museum. The Reitz Home Preservation Auxiliary plans to act as tour guides and operate a gift shop featuring prints, note cards, original Reitz Home needlework and other objects of art. The Auxiliary will also show "Historic Evansville" and "History of Indiana" slide presentations to adults and school children touring the home. All proceeds received are used to restore, furnish, equip and maintain the Reitz Home for the community.

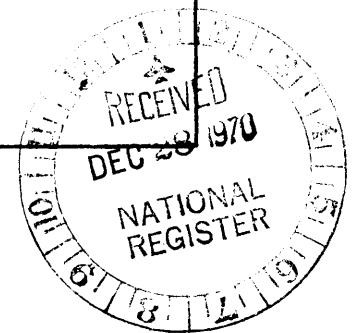
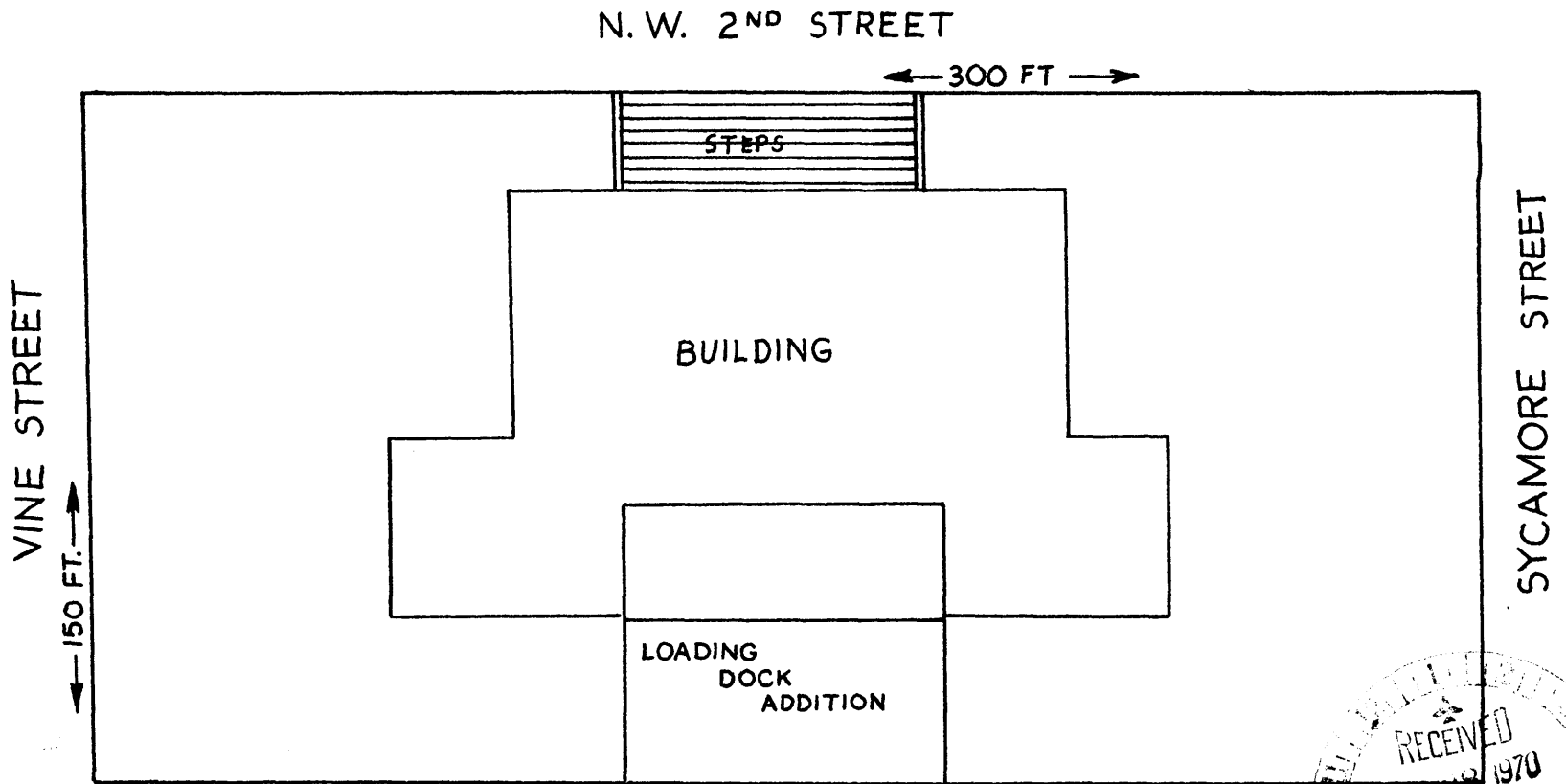
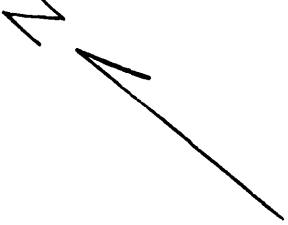

SCALE 1" = 40'

LAT. 37° 58' 17" } TAKEN FROM CENTER OF BLOCK
LONG. 87° 34' 17" }

NATIONAL REGISTER OF HISTORIC PLACES
PROPERTY MAP FORM

(Type all entries - attach to or enclose with map)

STATE Indiana	
COUNTY Vanderburgh	
FOR NPS USE ONLY	
ENTRY NUMBER 71.7.18.0001	DATE 7/2/71

SEE INSTRUCTIONS

1. NAME

COMMON: **Evansville Post Office**
AND/OR HISTORIC: **Customs House**

2. LOCATION

STREET AND NUMBER:
100 Block North West Second Street
CITY OR TOWN:
Evansville

STATE: Indiana	CODE 18	COUNTY: Vanderburgh	CODE 163
--------------------------	-------------------	-------------------------------	--------------------

3. MAP REFERENCE

SOURCE:
County Surveyor
SCALE: **1" = 40'**
DATE: **July 10, 1970**

4. REQUIREMENTS

- TO BE INCLUDED ON ALL MAPS
1. Property boundaries where required.
 2. North arrow.
 3. Latitude and longitude reference.

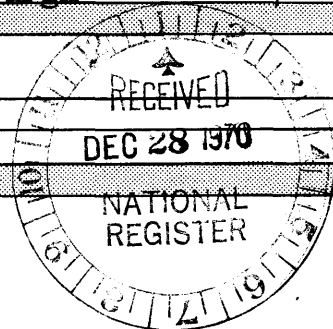

STATE OF INDIANA DEPARTMENT OF NATURAL RESOURCES INDIANA HISTORIC SITES AND STRUCTURES INVENTORY

1. HISTORIC NAME U.S. POST OFFICE, COURTHOUSE, & CUSTOMHOUSE
2. OWNERSHIP: X PUBLIC PRIVATE
NAME City of Evansville Redevelopment Comm.
ADDRESS
3. LOCATION NOTES O.P. Lts. 77-80
4. VISIBLE FROM PUBLIC RIGHT OF WAY: X YES NO

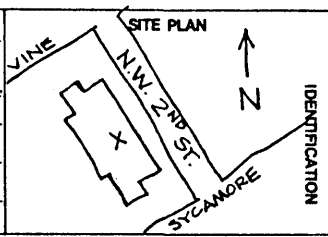

5. USE PRESENT PAST 6. CATEGORY 8. ENDANGERED
Residential (sing.) [] DISTRICT X NO
Residential (mult.) [] BUILDING(S) YES/BY WHAT
Commerce [] STRUCTURE
Industrial [] SITE
Agriculture [] OBJECT
Transportation []
Organization []
Military []
Political []
Unknown []
Vacant []
Other POST OFFICE []
7. ACCESSIBLE 9. DATE 1879 1918
YES/RESTRICTED
YES/UNRESTRICTED
X NO 10. ARCHITECT/BUILDER WM. A. POTTER

11. PERIODS: PREHISTORIC 17TH/18TH CEN. 1800-1860 X 1861-1899 1900-PRESENT

12. AREAS OF SIGNIFICANCE
Archeology-Prehistoric Conservation Law Sculpture
Archeology-Historic Economics Literature Social/Humanitarian
Agriculture Education Military Theater
X Architecture Engineering Music Transportation
Art Exploration/Settlement Philosophy Other (Specify)
Commerce Industry X Politics/Government
Communications Invention Religion
Community Planning Landscape Architecture Science

13. STYLE 14. CONDITION 16. SITE INTEGRITY
Federal EXCELLENT X ORIGINAL SITE
Greek Revival GOOD MOVED DATE
Gothic Revival X FAIR
Italianate DETERIORATED
Second Empire RUINS X NO
Stick Style/Eastlake UNEXPOSED YES
Queen Anne
Romanesque Revival
Colonial Revival
Neo-Classical
Bungalow
Vernacular RUSKINIAN MINOR
X Other (Specify) GOTHIC X MAJOR

15. ALTERATIONS 18. IN ESTABLISHED HISTORIC DISTRICT
UNALTERED X NO
MINOR YES/NAME
MAJOR

19. DESCRIPTION OF ENVIRONMENT (NATURAL AND MAN-MADE) DOWNTOWN AREA BETWEEN POST OFFICE AND RIVER WAS CLEARED AS PART OF URBAN RENEWAL. BLDG. ENCLOSED ON 3 SIDES BY STONE & WROUGHT IRON FENCE

20. INFORMATION SOURCES TOWNSHIP ASSESSOR, THE JOURNAL 1875-79

21. PREPARED BY N. LONG 22. DATE 8/78

IDENTIFICATION

CLASSIFICATION/DATE

SIGNIFICANCE

DESCRIPTION

Architectural Information



1.
2. The plan of this 2 1/2 story building is basically U-shaped.
3. Wings project from the river side of the building, around
4. a one story sorting room. The side wings were added in 1918, the sorting room enlarged, and a skylight installed. A single story loading dock was added in 1955.

The interior framing is of iron, concrete and wood. Masonry bearing walls are faced with small blocks of rusticated Bedford limestone laid in random coursed ashlar. Belt courses at the sill and impost levels and the water table are of dressed red sandstone. The trefoil and quatrefoil motifs are repeated throughout the building.

A wide stairway approaches the main facade, a 5-bay arched arcade with two side pavilions. The two end bays of the arcade have balustrades and are now enclosed. Four massive granite columns support the arcade, above which are four terra cotta medallions representing the United States, the Treasury Dept., the Postal Service, and the Justice Dept. The left pavilion contains the main stairwell; 5 narrow windows follow the line of the stairs. An oriel window at the side contains the stairway landing.

The second floor of each side pavilion features five windows with trefoil stained glass transoms grouped beneath a single broad arch. Above

see continuation sheet

STATE OF INDIANA
DEPARTMENT OF NATURAL RESOURCES
INDIANA HISTORIC SITES AND STRUCTURES INVENTORY

Previously Listed

Additional Architectural Information

A. NAME Old Post Office C. NUMBER 82-196-18-0184

B. ADDRESS 100 N.W. Second Street

D. UTM References Census Tract #18

E. the loggia the second floor is recessed and a red sandstone railing with a quatrefoil pattern runs between the pavilions. A red sandstone cornice supports the gutter, with foliate ornamentation across the central facade, and a trefoil arched pattern with brackets elsewhere.

The uppermost story is characterized by dormers set into a steeply pitched roof of red and gray patterned slate. The large central front dormer features traceried windows with stained glass, granite columns supporting the arch, small ornamental squares, and crocketed edges. The three front wall dormers at one time had red stone finials; finials still remain on three rear and two side dormers, although their conditions vary.

Iron cresting and copper decorate the ridges of the roof. Roof decks, of standard asphaltum composition, have recently been repaired, and much of the slate is presently being replaced.

The interior of the Old Post Office features an iron stairway that connects the first through third floors, with quatrefoils and perforated scallops as the main decorative motifs. A wainscot of white walnut, also with the quatrefoil and scallops motif, is employed throughout the public spaces of the second and third floors of the original building. Other rooms of the original building have walnut wainscoting of a simpler design.

A main feature of the building is the two-story high courtroom. A skylight originally illuminated the central stained glass ceiling, which rests on vertical panels of trefoil arches and columns in walnut. This raised rectangular area is set into a tray ceiling; plaster molding forms a cornice.

The iron elevator doors, located near the stairway, repeat the quatrefoil, and have brass fleur-de-lis. Some of these have vanished, as have some of the ornate wood column capitals and most of the brass hardware.

The building has been vacant since 1969, but is presently the subject of restoration efforts. One of four known surviving public buildings by William A. Potter, it was placed on the National Register of Historic Places in 1971.

F. INFORMATION SOURCES NAT'L REG 2 JULY 1971

G. PREPARED BY N. LONG

H. DATE 8/78