

FORM B - BUILDING

MASSACHUSETTS HISTORICAL COMMISSION  
294 WASHINGTON STREET, BOSTON, MA 02108

AREA	FORM NO.
	209

Roll 4:26A

Town Stoneham  
 Address 32 Franklin Street  
 Historic Name William Griffin Fuller House  
 Present Owner: Home for Aged People

PHOTO: (3x3" or 3x5", black & white)  
staple to left side of form

Photo number \_\_\_\_\_

Use: Present Nursing Home  
 Original Residential

DESCRIPTION:

Date 1850

Source town records

Style Greek Revival/Italianate transitional

Architect unknown

Exterior wall fabric vinyl

Outbuildings none

Major alterations (with dates) siding added, 1980 (?)

Moved No Date n/a

Approx. acreage 28,278 sq. ft.

Setting Mixed residential and commercial uses.

UTM - Boston North Quad 19/327460/4704830

SKETCH MAP

Show property's location in relation to nearest cross streets and/or geographical features. Indicate all buildings between inventoried property and nearest intersection. Indicate north.



Recorded by Carole Zellie  
Candace Jenkins, editor  
 Organization Landscape Research  
 Date May, 1979

Assessor's Map: #13-508

(Staple additional sheets here)

ARCHITECTURAL SIGNIFICANCE (Describe important architectural features and evaluate in terms of other buildings within the community.)

The William Griffin Fuller House is an excellent example of transitional Greek Revival/Italianate style motifs applied to a traditional five-bay, center entry form. Although this example has been sided, it preserves most of its important original features. Constructed at mid-century, the Fuller House is a two-story structure enclosed by a bracketed, slate-clad, pitched roof with twin interior chimneys, the easternmost of which has been removed. Windows headed by projecting lintels contain 6/6 sash. The center entry contains glazed double doors. A one-story Ionic porch extends across the facade and continues around (CONTINUE)

HISTORICAL SIGNIFICANCE (Explain the role owners played in local or state history and how the building relates to the development of the community.)

William Griffin Fuller (b. 1810) was in the leather and real estate businesses. He was a Trustee of the Stoneham Five Cents Savings Bank. This residence is one of the best detailed late Greek Revival/Early Italianate examples in Stoneham, and is in good exterior condition.

The W.G. Fuller House possesses integrity of location, design, setting, materials and workmanship. It is significant for its associations with a prominent local business leader and primarily for the high quality of its architectural design. It meets criteria A, B, and C of the National Register of Historic Places.

BIBLIOGRAPHY and/or REFERENCES (name of publication, author, date and publisher)

INVENTORY FORM CONTINUATION SHEET

MASSACHUSETTS HISTORICAL COMMISSION  
Office of the Secretary, Boston

Community: Stoneham	Form No: 209
Property Name: William Griffin Fuller House	

Indicate each item on inventory form which is being continued below.

ARCHITECTURAL SIGNIFICANCE (Continued)

the west elevation. In 1939 a smaller three-bay replica was constructed immediately to the west; a one-story walkway now joins the two buildings.

Staple to Inventory form at bottom

United States Department of the Interior  
National Park Service

National Register of Historic Places  
Inventory—Nomination Form

For NPS use only  
received 2/28/84  
date entered

Continuation sheet

Item number

Page 3 of 7

Multiple Resource Area  
Thematic Group

Name Stoneham Multiple Resource Area  
State Middlesex County, MASSACHUSETTS

Nomination/Type of Review

Date/Signature

21. Farrier, Amasa, Boardinghouse

Entered in the  
National Register

for Keeper Delores Byers 4/13/84

Attest

22. Farrier, Amasa, House

Entered in the  
National Register

for Keeper Delores Byers 4/13/84

Attest

23. First Baptist Church

Entered in the  
National Register

for Keeper Delores Byers 4/13/84

Attest

24. First Congregational Church

Entered in the  
National Register

for Keeper Delores Byers 4/13/84

Attest

25. First Unitarian Church

Entered in the  
National Register

for Keeper Delores Byers 4/13/84

Attest

26. Foley, Michael, Cottage

Entered in the  
National Register

for Keeper Delores Byers 4/13/84

Attest

27. Foster, Walter K.,  
House

Entered in the  
National Register

for Keeper Delores Byers 4/13/84

Attest

28. Fuller, Enoch, House

Entered in the  
National Register

for Keeper Delores Byers 4/13/84

Attest

29. Fuller, William Griffin,  
House

Entered in the  
National Register

for Keeper Delores Byers 4/13/84

Attest

30. Gill, Charles, House

Entered in the  
National Register

for Keeper Delores Byers 4/13/84

Attest

NATIONAL REGISTER OF HISTORIC PLACES  
EVALUATION/RETURN SHEET

Fuller, William Griffin, House (Stoneham MRA)  
Middlesex County  
MASSACHUSETTS

FEB 28 1984

Working No. \_\_\_\_\_  
Fed. Reg. Date: 2/5/85  
Date Due: 3-29-84 - 4-13-84  
Action:  ACCEPT 4-13-84  
 RETURN \_\_\_\_\_  
 REJECT \_\_\_\_\_  
Federal Agency: \_\_\_\_\_

Entered in the  
National Register

- resubmission
- nomination by person or local government
- owner objection
- appeal

Substantive Review:  sample  request  appeal  NR decision

Reviewer's comments:

Recom./Criteria \_\_\_\_\_  
Reviewer \_\_\_\_\_  
Discipline \_\_\_\_\_  
Date \_\_\_\_\_  
\_\_\_\_\_ see continuation sheet

Nomination returned for: \_\_\_\_\_ technical corrections cited below  
\_\_\_\_\_ substantive reasons discussed below

1. Name

2. Location

3. Classification

Category	Ownership Public Acquisition	Status Accessible	Present Use
----------	---------------------------------	----------------------	-------------

4. Owner of Property

5. Location of Legal Description

6. Representation in Existing Surveys

Has this property been determined eligible?  yes  no

7. Description

Condition	Check one	Check one
<input type="checkbox"/> excellent	<input type="checkbox"/> deteriorated	<input type="checkbox"/> original site
<input type="checkbox"/> good	<input type="checkbox"/> ruins	<input type="checkbox"/> moved date _____
<input type="checkbox"/> fair	<input type="checkbox"/> unexposed	
	<input type="checkbox"/> unaltered	
	<input type="checkbox"/> altered	

Describe the present and original (if known) physical appearance

- summary paragraph
- completeness
- clarity
- alterations/integrity
- dates
- boundary selection

---

**8. Significance**

Period \_\_\_\_\_ Areas of Significance—Check and justify below

Specific dates \_\_\_\_\_ Builder/Architect \_\_\_\_\_  
Statement of Significance (*in one paragraph*)

- summary paragraph
- completeness
- clarity
- applicable criteria
- justification of areas checked
- relating significance to the resource
- context
- relationship of integrity to significance
- justification of exception
- other

---

**9. Major Bibliographical References**

---

**10. Geographical Data**

Acreage of nominated property \_\_\_\_\_  
Quadrangle name \_\_\_\_\_  
UTM References \_\_\_\_\_

Verbal boundary description and justification \_\_\_\_\_

---

**11. Form Prepared By**

---

**12. State Historic Preservation Officer Certification**

The evaluated significance of this property within the state is:

\_\_\_\_ national      \_\_\_\_ state      \_\_\_\_ local

State Historic Preservation Officer signature \_\_\_\_\_

title \_\_\_\_\_ date \_\_\_\_\_

---

**13. Other**

- Maps
- Photographs
- Other

Questions concerning this nomination may be directed to \_\_\_\_\_

Signed \_\_\_\_\_ Date \_\_\_\_\_ Phone: \_\_\_\_\_



Fuller, William, Griffin, House  
Stoneham MRT, MA

8070

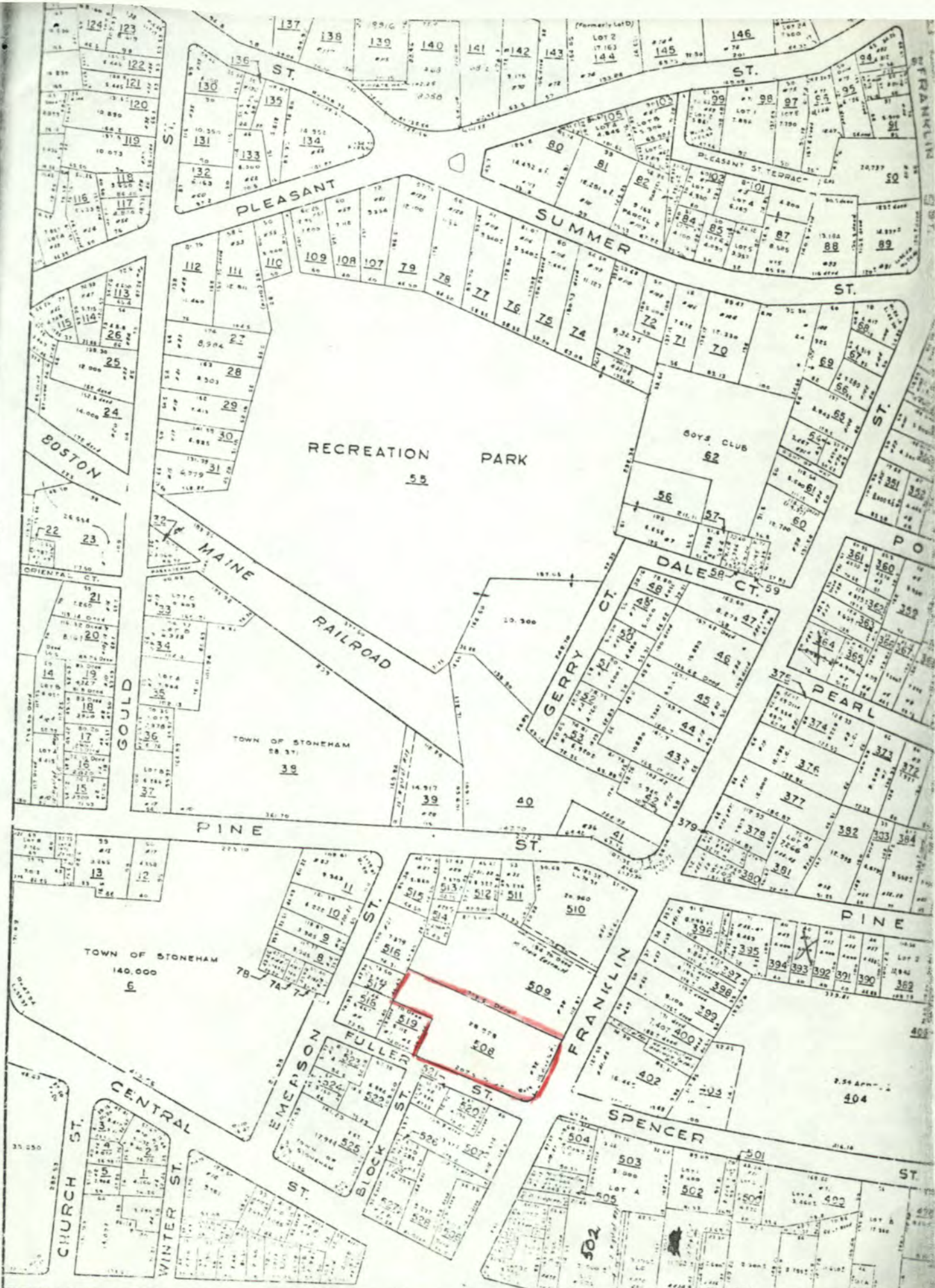

Town of Stoneham Assessor's Map: page 13, lot 508; 1"=200'; present date #209

Please refer to the map in the  
Multiple Property Cover Sheet  
for this property

Multiple Property Cover Sheet Reference Number: 64000295