

**NATIONAL REGISTER OF HISTORIC PLACES
INVENTORY - NOMINATION FORM**

(Type all entries - complete applicable sections)

| | |
|--------------------------|------|
| STATE: California | |
| COUNTY: San Francisco | |
| FOR NPS USE ONLY | |
| ENTRY NUMBER | DATE |
| MAR 8 | 1973 |

1. NAME

COMMON NAME: House at 736-38 Franklin Street Western Addition Project Area Two *

AND/OR HISTORIC: 736-38 Franklin Street 33-35 Beideman Place

2. LOCATION

STREET AND NUMBER: 736-38 Franklin Street

CITY OR TOWN: San Francisco

STATE: California CODE: 06 COUNTY: San Francisco CODE: 075

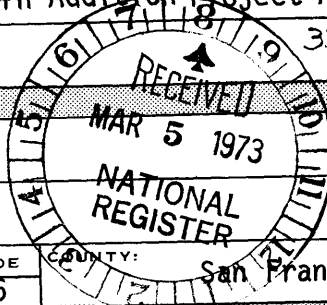

* see attached

3. CLASSIFICATION

| CATEGORY (Check One) | OWNERSHIP | STATUS | ACCESSIBLE TO THE PUBLIC |
|--|---|--|---|
| <input type="checkbox"/> District <input checked="" type="checkbox"/> Building | <input type="checkbox"/> Public | <input type="checkbox"/> Occupied | Yes: <input checked="" type="checkbox"/> Restricted |
| <input type="checkbox"/> Site <input type="checkbox"/> Structure | <input checked="" type="checkbox"/> Private | <input checked="" type="checkbox"/> Unoccupied | <input type="checkbox"/> Unrestricted |
| <input type="checkbox"/> Object | <input type="checkbox"/> Both | <input type="checkbox"/> Preservation work in progress | <input type="checkbox"/> No |
| PRESENT USE (Check One or More as Appropriate) | | | |
| <input type="checkbox"/> Agricultural | <input type="checkbox"/> Government | <input type="checkbox"/> Park | <input type="checkbox"/> Transportation |
| <input type="checkbox"/> Commercial | <input type="checkbox"/> Industrial | <input checked="" type="checkbox"/> Private Residence | <input type="checkbox"/> Other (Specify) |
| <input type="checkbox"/> Educational | <input type="checkbox"/> Military | <input type="checkbox"/> Religious | _____ |
| <input type="checkbox"/> Entertainment | <input type="checkbox"/> Museum | <input type="checkbox"/> Scientific | _____ |

Visual access on

SEE INSTRUCTIONS

4. OWNER OF PROPERTY

OWNER'S NAME: San Francisco Redevelopment Agency

STREET AND NUMBER: 762 Fulton Street

CITY OR TOWN: San Francisco STATE: California CODE: 06

STATE: California
COUNTY: San Francisco

5. LOCATION OF LEGAL DESCRIPTION

COURTHOUSE, REGISTRY OF DEEDS, ETC.: San Francisco Assessor's Office

STREET AND NUMBER: City Hall

CITY OR TOWN: San Francisco STATE: California CODE: 06

6. REPRESENTATION IN EXISTING SURVEYS

TITLE OF SURVEY: San Francisco Conservation Committee Survey *
(Under the auspices of San Francisco Redevelopment Agency)

DATE OF SURVEY: 1962 Federal State County Local

DEPOSITORY FOR SURVEY RECORDS: San Francisco Redevelopment Agency

STREET AND NUMBER: 762 Fulton Street

CITY OR TOWN: San Francisco STATE: California CODE: 06

ENTRY NUMBER
DATE
FOR NPS USE ONLY

*Also: Junior League of San Francisco Survey
(Both surveys were adopted by the Landmarks Preservation Advisory Board of the City and County of San Francisco).

7. DESCRIPTION

| | | | | | | |
|-----------|------------------------------------|---|-------------------------------|---|--|------------------------------------|
| CONDITION | (Check One) | | | | | |
| | <input type="checkbox"/> Excellent | <input checked="" type="checkbox"/> Good | <input type="checkbox"/> Fair | <input type="checkbox"/> Deteriorated | <input type="checkbox"/> Ruins | <input type="checkbox"/> Unexposed |
| | (Check One) | | | In process (Check One) | | |
| | <input type="checkbox"/> Altered | <input checked="" type="checkbox"/> Unaltered | | <input checked="" type="checkbox"/> Moved | <input type="checkbox"/> Original Site | |

DESCRIBE THE PRESENT AND ORIGINAL (if known) PHYSICAL APPEARANCE

A two-story, wood frame dwelling, Italianate Style, with its two-family occupancy being reflected in the bilateral arrangement of the facade. Set back about six feet, and attached on either hand to its neighbors, the house has a flat facade, with fenestration and doorways arranged in alternating paired windows on each story with single windows and doorway openings. Windows and doors are uniformly flanked by flat trim, characteristic of the Italianate Style. The windows and doors, as befitting a building 25 feet wide, are tall, narrow and double-hung, giving a vertical amplification to the rectangular facade. The balance of the facade is unusual in that it is slightly off-set to the right as the observer faces the building; with the interval between openings and the corners of the building being less on the southern side than on the northern side. The exterior facing of the walls is of wood, with flat, horizontal rusticated boards.

All openings are surmounted by flat or triangular shallow projecting pediments with those of the two doorways being larger and more prominent. The pediments are supported by small brackets or consoles characteristic of the Ionic Style. All exterior ornaments are, like the structure, entirely of wood.

There is a simple projecting cornice of wood at the roofline, supported by five evenly spaced brackets similar to those of the fenestration. Above the cornice the slightly raked parapet completes the facade.

The two narrow flights of six steps lead to the two separate entrance doors. The doors are dissimilar stylistically, one being lighted by a small square window, and the other with a larger glass light. Both doors are surmounted by transoms.

Although this building was owned by absentee landlords, it has been kept in good condition both inside and outside. This Victorian is to be moved to become one a row of lovely Victorians on Beideman Place near Ellis Street.

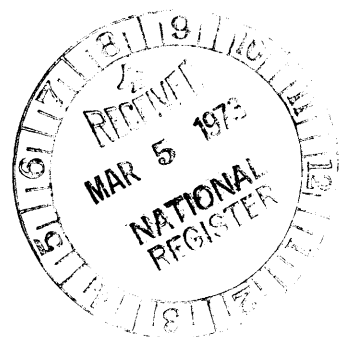

SEE INSTRUCTIONS

3. SIGNIFICANCE

PERIOD (Check One or More as Appropriate)

| | | | |
|--|---------------------------------------|--|---------------------------------------|
| <input type="checkbox"/> Pre-Columbian | <input type="checkbox"/> 16th Century | <input type="checkbox"/> 18th Century | <input type="checkbox"/> 20th Century |
| <input type="checkbox"/> 15th Century | <input type="checkbox"/> 17th Century | <input checked="" type="checkbox"/> 19th Century | |

SPECIFIC DATE(S) (If Applicable and Known) 1876

AREAS OF SIGNIFICANCE (Check One or More as Appropriate)

| | | | |
|--|--------------------------------------|--|--|
| <input type="checkbox"/> Aboriginal | <input type="checkbox"/> Education | <input type="checkbox"/> Political | <input type="checkbox"/> Urban Planning |
| <input type="checkbox"/> Prehistoric | <input type="checkbox"/> Engineering | <input type="checkbox"/> Religion/Philosophy | <input type="checkbox"/> Other (Specify) |
| <input type="checkbox"/> Historic | <input type="checkbox"/> Industry | <input type="checkbox"/> Science | _____ |
| <input type="checkbox"/> Agriculture | <input type="checkbox"/> Invention | <input type="checkbox"/> Sculpture | _____ |
| <input checked="" type="checkbox"/> Architecture | <input type="checkbox"/> Landscape | <input type="checkbox"/> Social/Humanitarian | _____ |
| <input type="checkbox"/> Art | <input type="checkbox"/> Literature | <input type="checkbox"/> Theater | _____ |
| <input type="checkbox"/> Commerce | <input type="checkbox"/> Military | <input type="checkbox"/> Transportation | _____ |
| <input type="checkbox"/> Communications | <input type="checkbox"/> Music | | |
| <input type="checkbox"/> Conservation | | | |

STATEMENT OF SIGNIFICANCE

SEE INSTRUCTIONS

The San Francisco Water Department records show that this building was connected to the water system in 1876. The Junior League of San Francisco's book Here Today concurs with this date and goes on to say, "The facade of this flat front Italianate is broken up by more doors and windows....than usual."

The original owner was Henry Vollmer.

He lived a few doors away and rented this property out as an absentee landlord, and owned the building until 1894. After that there were three absentee owners until the San Francisco Redevelopment Agency bought it in 1967. This Victorian survived the 1906 earthquake and fire.

Because of the zoning within the project area, this building has to be either demolished or moved to a more suitable location where it can be rehabilitated and preserved. This will be one of eight buildings to be moved onto a two-block development within the Western Addition Area 2. These two city blocks will be intensively developed with projects including scattered public housing, moderately priced private housing, private rehabilitation and rehabilitation for public bidding and resale by the San Francisco Redevelopment Agency. A few rehabilitation projects have already been completed within these two blocks.

736-738 Franklin is to be moved to Block 1100, Lots 31, 32, 33, to be next to another moved Victorian and between two rehabilitated Victorians on Beideman Place. 736-738 Franklin is one of the six most important Victorian structures chosen by the San Francisco Landmarks Preservation Advisory Board as having exceptional merit.

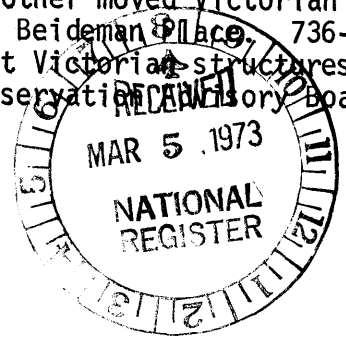

9. MAJOR BIBLIOGRAPHICAL REFERENCES

Junior League of San Francisco, Inc. Here Today - San Francisco's Architectural Heritage (Chronicle Books, San Francisco, 1968)

10. GEOGRAPHICAL DATA

| LATITUDE AND LONGITUDE COORDINATES DEFINING A RECTANGLE LOCATING THE PROPERTY | | | O R | LATITUDE AND LONGITUDE COORDINATES DEFINING THE CENTER POINT OF A PROPERTY OF LESS THAN TEN ACRES | | |
|---|-------------------------|-------------------------|--------|---|-------------------------|--|
| CORNER | LATITUDE | LONGITUDE | | LATITUDE | LONGITUDE | |
| | Degrees Minutes Seconds | Degrees Minutes Seconds | | Degrees Minutes Seconds | Degrees Minutes Seconds | |
| NW | ° ' " | ° ' " | | N37° 46' 55" | W122° 25' 14" | |
| NE | ° ' " | ° ' " | | | | |
| SE | ° ' " | ° ' " | | | | |
| SW | ° ' " | ° ' " | | | | |

APPROXIMATE ACREAGE OF NOMINATED PROPERTY: 2,012 sq. ft.

LIST ALL STATES AND COUNTIES FOR PROPERTIES OVERLAPPING STATE OR COUNTY BOUNDARIES

| STATE: | CODE | COUNTY | CODE |
|--------|------|--------|------|
| | | | |
| | | | |
| | | | |
| | | | |

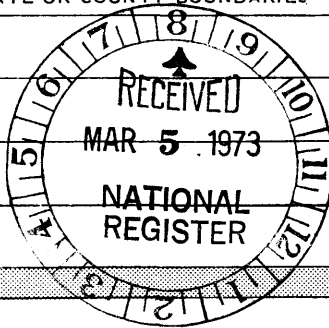

UTM
10/551000
4181520
CD

SEE INSTRUCTIONS

11. FORM PREPARED BY

NAME AND TITLE:
Enid Sales, Supervisor; Susan Bragstad, Architect

ORGANIZATION: **San Francisco Redevelopment Agency*** DATE: **January 9, 1973**

STREET AND NUMBER:
762 Fulton Street

CITY OR TOWN: **San Francisco** STATE: **California** CODE: **06**

12. STATE LIAISON OFFICER CERTIFICATION NATIONAL REGISTER VERIFICATION

| | |
|--|---|
| <p>As the designated State Liaison Officer for the National Historic Preservation Act of 1966 (Public Law 89-665), I hereby nominate this property for inclusion in the National Register and certify that it has been evaluated according to the criteria and procedures set forth by the National Park Service. The recommended level of significance of this nomination is:</p> <p>National <input type="checkbox"/> State <input type="checkbox"/> Local <input checked="" type="checkbox"/></p> <p>Name <u>[Signature]</u></p> <p>Title <u>State Liaison Officer</u></p> <p>Date <u>FEB 12 1972</u></p> | <p>I hereby certify that this property is included in the National Register.</p> <p><u>[Signature]</u> Chief, Office of Archeology and Historic Preservation</p> <p>Date <u>3/8/73</u></p> <p>ATTEST:</p> <p><u>[Signature]</u> Keeper of The National Register</p> <p>Date <u>3-7-73</u></p> |
|--|---|

Also *San Francisco Landmarks Preservation Advisory Board
100 Larkin Street
San Francisco, CA 06

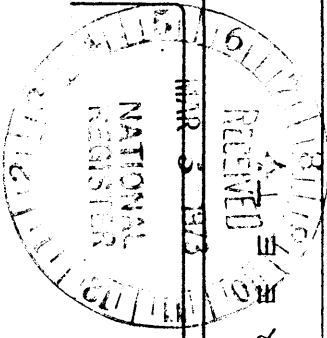

O'FARRELL STREET
BLK. 1100

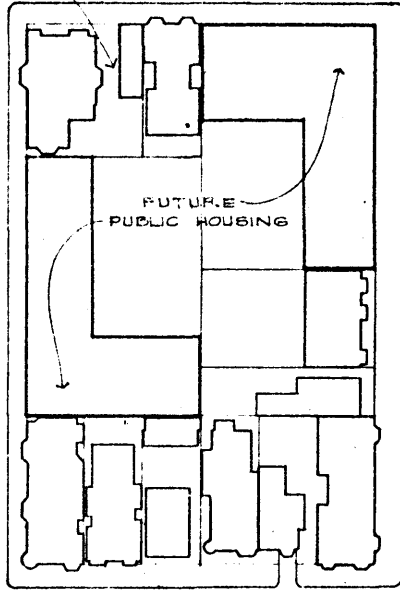
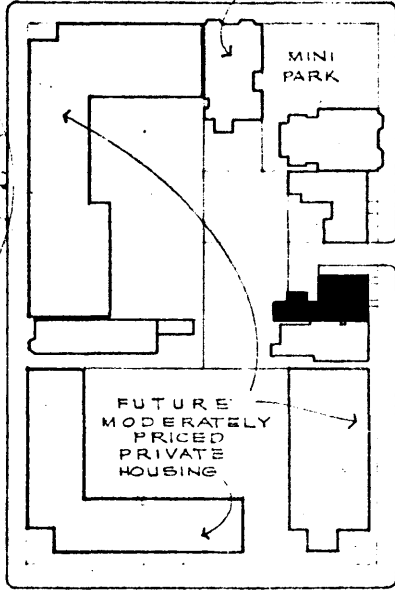

L
I
P
B
E
I
D
E
M
A
N
S
T
R
E
E
T

ELLIS STREET

D
I
V
I
S
A
D
E
R
O
S
T
R
E
E
T

S
T
R
E
E
T

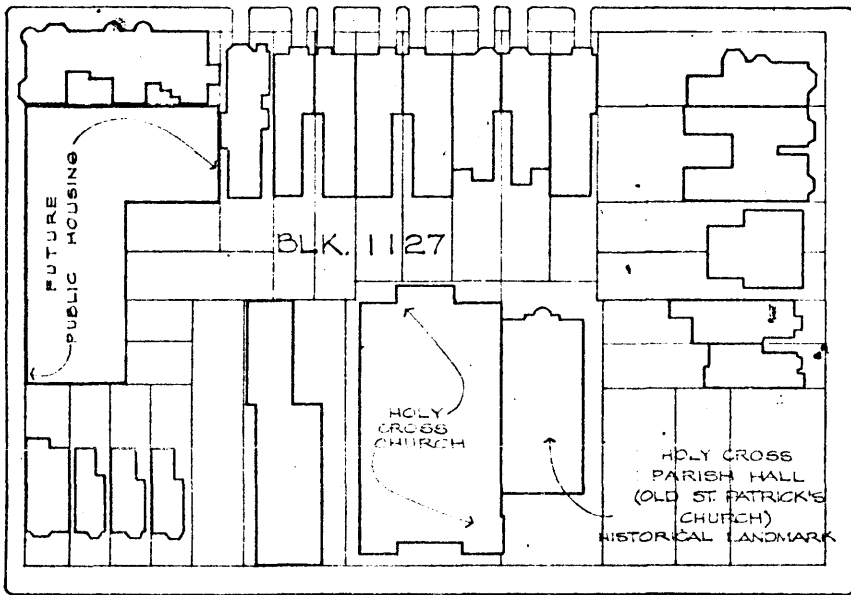

BLK. 1127

EDDY STREET

S
C
O
T
T
S
T
R
E
E
T

LEGEND

- NEW LOCATION OF 736-38 FRANKLIN
- BLDGS. TO BE REHABILITATED

SCALE 1"=100'-0"



NORTH

MAP C : DEVELOPMENT PLAN

JAN. 8, 1973

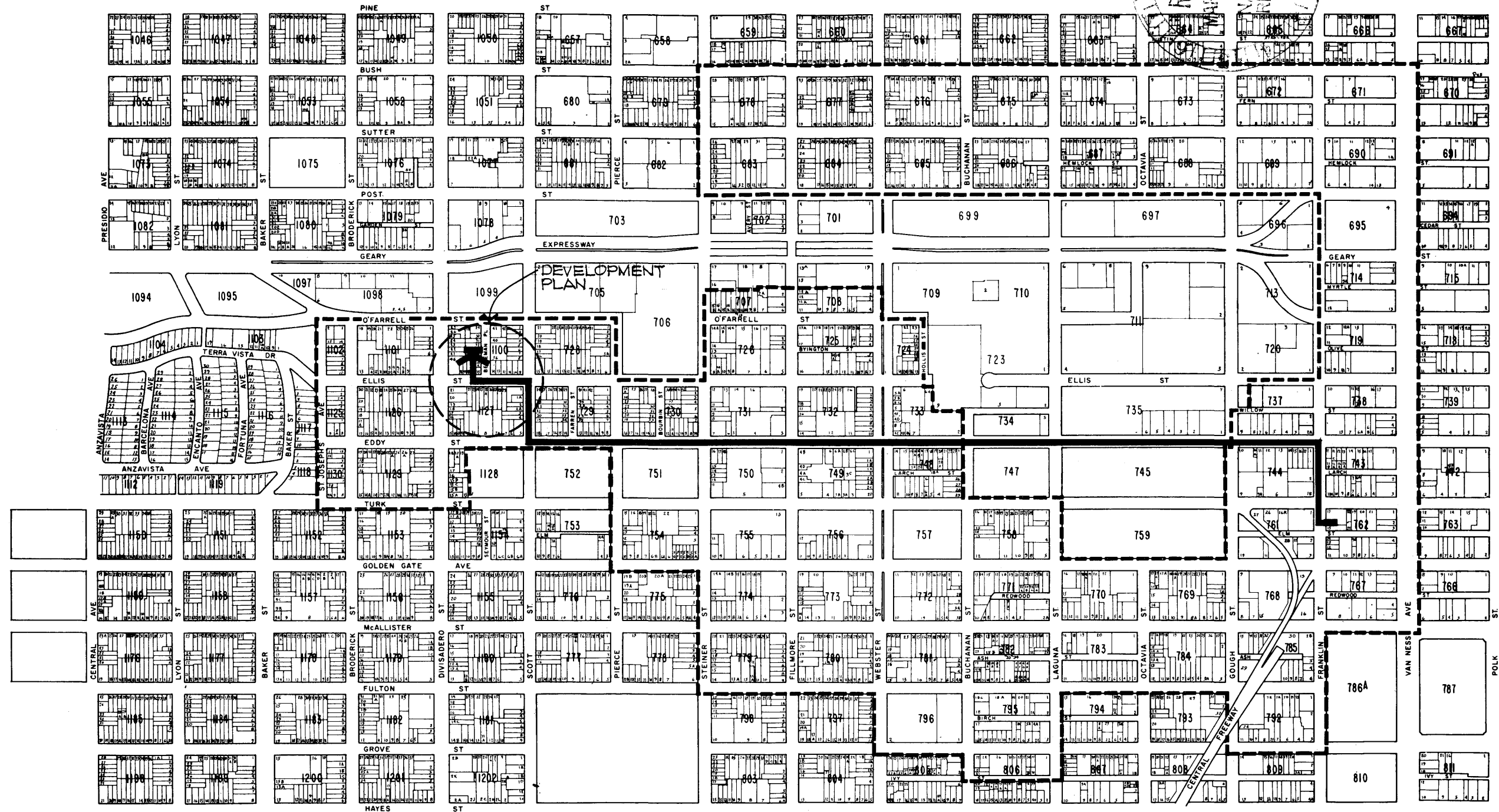
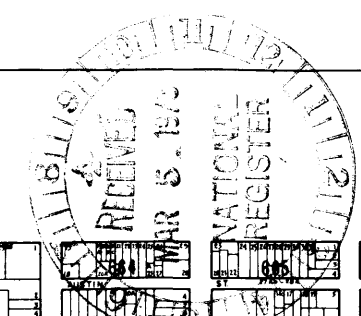

LEGEND - - - - - PROJECT BOUNDARY

WESTERN ADDITION AREA TWO

MAP B: RELOCATION OF 736-38 FRANKLIN

(REFER TO MAP "C" FOR DEVELOPMENT PLAN)

- █ EXIST. LOCATION
- █ NEW LOCATION

