

DEC 29 1988

3405

KENTUCKY HISTORIC RESOURCES INVENTORY

Site No. WS-24

1. Historic Name(s) Archibald Scott Mayes House Original Owner _____		22. ADD/COUNTY Lincoln Trail/Wash. <input type="checkbox"/> <input type="checkbox"/> <input type="checkbox"/> <input type="checkbox"/> <input type="checkbox"/>	
2. Present Name Arhold Home		23. U.S.G.S. Quadrant (15/75') Springfield G.I.S. Mod. 108	
3. Location S. sd Hwy 150, 4 m. E. of Springfield		24. UTM Reference <input type="checkbox"/> 16 <input type="checkbox"/> 66 <input type="checkbox"/> 17 <input type="checkbox"/> 60 <input type="checkbox"/> 41 <input type="checkbox"/> 69 <input type="checkbox"/> 58 <input type="checkbox"/> 0	
4. Owner's Name Robert Sullivan		25. Coordinate Accuracy <input type="checkbox"/>	
5. Owner's Address Rt. 3B, Springfield, KY 40069		26. Prehistoric Site _____ Object _____ Historic Site _____ Structure _____ <input checked="" type="checkbox"/> Building Other _____	
6. Open to Public Yes _____ No <input checked="" type="checkbox"/>	7. Visible from road Yes <input checked="" type="checkbox"/> No _____	8. Ownership Private <input checked="" type="checkbox"/> Local _____ State _____ Federal _____	
9. Local Contact/Organization Owner		27. National Register District Name: N/A	
10. Site Plan with North Arrow 		11. Architect unknown	
		12. Builder unknown	
		13. Date 1826-1850 A. <input checked="" type="checkbox"/> B. <input type="checkbox"/>	
		14. Style A. Grk., Rev. <input checked="" type="checkbox"/> B. <input type="checkbox"/>	
		15. Original Use Sing. fam. res. <input checked="" type="checkbox"/>	
16. Present use As above		28. Significance Evaluation NR <input checked="" type="checkbox"/>	
17. Condition Fair <input checked="" type="checkbox"/>		29. Status _____ Date _____ National Landmark _____ National Register _____ Landmark Certificate _____ Kentucky Survey _____ Local Landmark _____ HABS/HAER _____	
18. Description 5 bay, 2 story, frame w/monumental double pedimented portico; internal brick chimneys; transom, sidelights, corner lights at central entrance.		30. Historic Theme Primary Architecture <input checked="" type="checkbox"/> Secondary _____ Other _____	
19. History Unknown		31. Endangered Yes <input checked="" type="checkbox"/> No _____	
20. Significance Excellent example of frame Greek Revival and a house associated with several prominent Washington County families. Only example(over)		32. Preservation Project Status N/A Actual Cost in \$1,000s _____	
21. Source of Information See attached		33. Photos 	
(Continue on Back)		34. Prepared by: Joe DeSpain	
35. Organization Green Co. Hist. Soc., Inc.		Roll No. 28 Picture No. 6-8 Direction _____	
36. Date 5 May 1983		37. Revision Dates 1/87 38. Staff Review _____	

DESCRIPTION OF SIGNIFICANT OUTBUILDINGS

Single story brick , possible kitchen to S., w/internal
end chimney; 5/1 bond.

Brick pyramidalroofed smokehouse to S. w/segmental arched door;
9/1 bond.

20.(cont.) of "Georgian plan" in county (chimneys are between rooms on either side of
center passage rather than on exterior wall). This property is significant under criterion
C.

KENTUCKY HISTORIC RESOURCE INVENTORY SUPPLEMENT
BOUNDARY AND LOCATION INFORMATION

Historic Property Name Archibald Scott Mayes House Site # WS-24

Multiple Resource/Thematic Nomination Title Washington County Multiple Resource Area

U.T.M. Coordinates - List multiple UTM's if property is ten or more acres.

A. <u>16</u>	<u>661760</u>	<u>4169580</u>	D. _____
B. _____	_____	_____	E. _____
C. _____	_____	_____	F. _____

Verbal Boundary Description Acreage approx. 3 acres

Point A is 100 ft. east of the Intersection of the driveway and U. S. 150.
Beginning at point A on the south side of U.S.150, proceeding south along a fence 300 feet to point B, then 200' east along a line to the south (rear) of the kitchen and smoke house to point C., north along a fence 300' to point D on U.S. 150, west 200' along south of U.S.150 to the point of origin. The boundaries were drawn to include the house, lawn, and domestic-related space as enclosed by fences, the highway, and outbuildings. Two contributing outbuildings are included: a brick meathouse and a brick two-room outbuilding which appears to have been a kitchen. "Carriage" house apparently cut into north room east wall. Roof overhangs east front. Property includes three contributing buildings and two non-contributing buildings.

Sketch of Site Plan (Showing outbuildings, structures, landscape features and the site boundary as described above.)

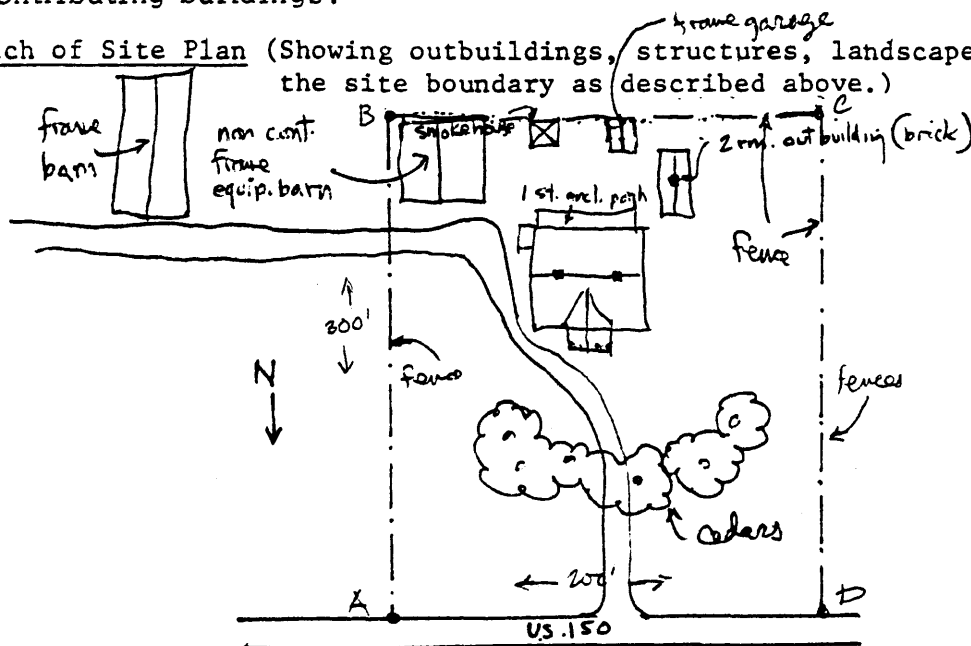

Official Courthouse Property Reference:

Washington County Courthouse, Springfield, Kentucky