

United States Department of the Interior
National Park Service

National Register of Historic Places
Registration Form

NATIONAL REGISTER

This form is for use in nominating or requesting determinations of eligibility for individual properties or districts. See instructions in Guidelines for Completing National Register Forms (National Register Bulletin 16). Complete each item by marking "x" in the appropriate box or by entering the requested information. If an item does not apply to the property being documented, enter "N/A" for "not applicable." For functions, styles, materials, and areas of significance, enter only the categories and subcategories listed in the instructions. For additional space use continuation sheets (Form 10-900a). Type all entries.

1. Name of Property

historic name Lake Shetek State Park WPA/Rustic Style Group Camp
other names/site number Lake Shetek State Park

2. Location

street & number off County Highway 37 not for publication N/A
city, town Murray and Shetek Townships Currie vicinity
state Minnesota code MN county Murray code 101 zip code 56123

3. Classification

Ownership of Property	Category of Property	Number of Resources within Property	
		Contributing	Noncontributing
<input type="checkbox"/> private	<input checked="" type="checkbox"/> building(s)	2	_____ buildings
<input type="checkbox"/> public-local	<input type="checkbox"/> district	_____	_____ sites
<input checked="" type="checkbox"/> public-State	<input type="checkbox"/> site	_____	_____ structures
<input type="checkbox"/> public-Federal	<input type="checkbox"/> structure	_____	_____ objects
	<input type="checkbox"/> object	2	0 Total

Name of related multiple property listing: Minnesota State Park CCC/WPA/Rustic Style
Historic Resources
Number of contributing resources previously listed in the National Register 0

4. State/Federal Agency Certification

As the designated authority under the National Historic Preservation Act of 1966, as amended, I hereby certify that this nomination request for determination of eligibility meets the documentation standards for registering properties in the National Register of Historic Places and meets the procedural and professional requirements set forth in 36 CFR Part 60. In my opinion, the property meets does not meet the National Register criteria. See continuation sheet.
Signature of certifying official Ian R. Stewart, Deputy State Historic Preservation Officer Date 5/12/92
State or Federal agency and bureau Minnesota Historical Society

In my opinion, the property meets does not meet the National Register criteria. See continuation sheet.
Signature of commenting or other official Date
State or Federal agency and bureau

5. National Park Service Certification

I, hereby, certify that this property is:
 entered in the National Register. See continuation sheet.
 determined eligible for the National Register. See continuation sheet.
 determined not eligible for the National Register.
 removed from the National Register.
 other, (explain:)
Signature of the Keeper Beth Boland Date of Action 7/2/92

6. Function or Use

Historic Functions (enter categories from instructions)

RECREATION/Outdoor Recreation

LANDSCAPE/State Park

Current Functions (enter categories from instructions)

RECREATION/Outdoor Recreation

LANDSCAPE/State Park

7. Description

Architectural Classification

(enter categories from instructions)

Other: NPS Rustic Architecture

Materials (enter categories from instructions)

foundation Concrete

walls Wood

roof Asphalt

other Stone

Describe present and historic physical appearance.

See Continuation Sheets

See continuation sheet

8. Statement of Significance

Certifying official has considered the significance of this property in relation to other properties:

nationally statewide locally

Applicable National Register Criteria A B C D

Criteria Considerations (Exceptions) A B C D E F G

Areas of Significance (enter categories from instructions)

Architecture
Recreation
Government

Period of Significance

1940-41

Significant Dates

1940

Cultural Affiliation

N/A

Significant Person

N/A

Architect/Builder

State of Minnesota
Works Progress Administration

State significance of property, and justify criteria, criteria considerations, and areas and periods of significance noted above.

See Continuation Sheets

See continuation sheet

9. Major Bibliographical References

Department of Conservation. Third Biennial Report. 1935-36.
Department of Natural Resources. Working Drawings and Specifications for Buildings and Structures at Lake Shetek State Park. Bureau of Engineering. St. Paul, Minnesota.
Minnesota State Emergency Relief Administration. Minnesota Work Relief History from 4/1/34 to 6/30/35. Mimeographed, undated, bound volume at the Minnesota Historical Society Reference Library.
State of Minnesota. Minnesota State Park, Parkway and Recreational Area Study. 1938.

See continuation sheet

Previous documentation on file (NPS):

- preliminary determination of individual listing (36 CFR 67) has been requested
- previously listed in the National Register
- previously determined eligible by the National Register
- designated a National Historic Landmark
- recorded by Historic American Buildings Survey # _____
- recorded by Historic American Engineering Record # _____

Primary location of additional data:

- State historic preservation office
- Other State agency
- Federal agency
- Local government
- University
- Other

Specify repository: _____

10. Geographical Data

Acreage of property 2.5 Acres

UTM References

A 1 15 284310 4887210
 Zone Easting Northing

C _____

B _____
 Zone Easting Northing

D _____

See continuation sheet

Verbal Boundary Description

The boundary for the Lake Shetek State Park WPA/Rustic Style Group Camp is shown as the heavy, cross-hatched line on the accompanying map entitled, "Lake Shetek State Park." It is defined by Lake Shetek to the north and the park road to the west.

See continuation sheet

Boundary Justification

The boundary includes the two buildings that have been historically associated with the property and that maintain historic integrity. It defines an area of the park developed by the Works Progress Administration.

See continuation sheet

11. Form Prepared By

name/title Rolf T. Anderson
 organization N/A date April 26, 1992
 street & number 212 West 36th Street telephone 612-824-7807
 city or town Minneapolis state Minnesota zip code 55408

United States Department of the Interior
National Park ServiceNational Register of Historic Places
Continuation SheetSection number 7 Page 1 Lake Shetek State Park WPA/Rustic Style Group Camp
Murray and Shetek Townships, Murray County, MinnesotaDESCRIPTION

The Lake Shetek State Park WPA/Rustic Style Group Camp consists of a 2.5 acre area located on Lake Shetek just to the east of the Lake Shetek State Park Historic District. The Group Camp includes two contributing buildings. Several additional buildings have been constructed at the camp during the modern era. However, only the two buildings constructed by the Works Progress Administration are included in the nomination. Architects for the group camp buildings were from the Design Office within the Minnesota Division of State Parks.

Department of Natural Resources building identification numbers are located after the name of each building.

1. Building: Mess Hall 4-133 Builder: WPA
Architect: H. Petersen Date: 1940

The group camp Mess Hall consists of a T-shaped building containing a 60' x 20' dining room and a 20' x 21'6" extension for the kitchen. A massive split stone fireplace with a stone hearth is located at the intersection of the T. The building rests on a concrete foundation with a series of 8" x 12" screened openings provided for ventilation. The building is covered with rough, clapboard siding to the sill level with vertical board and batten siding above. Nine light casements are spaced along the facades of the dining room while six light casements are employed in the kitchen wing. Entrances are located on the north, east, and west facades of the dining room and the south wall of the kitchen. Three ridge ventilators are located on the intersecting gable roof: two are above the dining room and one is placed above the kitchen. The interior features exposed trussed rafters.

Minor interior remodeling was completed in 1958.

United States Department of the Interior
National Park Service

National Register of Historic Places
Continuation Sheet

Section number 7 Page 2 Lake Shetek State Park WPA/Rustic Style Group Camp
Murray and Shetek Townships, Murray County, Minnesota

2. Building: Crafts & Recreation Bldg 4-128 Date: 1941
Architect: N. Nielsen Builder: WPA

The Crafts and Recreation Building is a 48' x 24' rectangular structure covered by a gable roof. The building rests on a concrete foundation with a series of 8" x 12" screened openings provided for ventilation. 10" rough board siding rises to the sill level with vertical board and batten siding above. Six light casements hinged at the bottom are spaced along the facades. The building may be entered from central entries on the north, south, and west facades while a massive split stone fireplace is located on the east facade.

The interior is divided into two rooms by a partition wall. The craft area encompasses roughly one-third of the building while the recreation area occupies the remaining space. The exposed 2" x 8" rafters are placed 18" on center with 2" x 6" collars 3' on center.

United States Department of the Interior
National Park Service

National Register of Historic Places Continuation Sheet

Section number 8 Page 1 Lake Shetek State Park WPA/Rustic Style Group Camp
Murray and Shetek Townships, Murray County, Minnesota

STATEMENT OF SIGNIFICANCE

The Lake Shetek State Park WPA/Rustic Style Group Camp is historically significant for its association with the social, political, and economic impact of the Great Depression and the subsequent development of the various Federal Relief Programs such as the Works Progress Administration which was responsible for its construction. The Group Camp is also significant for its association with the development of the Minnesota state park system. Lake Shetek was selected as the site for the park because lakes are extremely rare in this section of the state and a park with extensive recreational facilities could attract a large county population. The park was also located 30 miles from Camden State Park and was intended to relieve the heavy use from that location.

The Lake Shetek State Park WPA/Rustic Style Group Camp is architecturally significant as an example of Rustic Style construction utilizing irreplaceable labor intensive methods and finely crafted detailing. The Mess Hall and the Crafts and Recreation Building are two of only five group camp buildings in the state park system which were constructed outside of the St. Croix Recreational Demonstration Area. The Group Camp was part of one of the most extensive designs from the period which also included the public use area of the park, the service yard, and a series of causeways which were designed in order to link five islands and provide a roadway across the lake. Five causeways were eventually constructed, although the final section was never built.

Lake Shetek State Park was established in 1937 although a monument had been built on the site in 1907 in memory of 12 people who died in the U.S.-Dakota Conflict of 1862. The park was developed by a WPA camp for 200 transient and homeless men which was located on Keeley Island directly across Lake Shetek from the park. The camp was initially operated by the State Emergency Relief Administration and was one of 32 transient camps in the state. The camp was established in the fall of 1934 and was involved with various projects throughout Murray County until it closed in about 1941.

The buildings occupied by the WPA were of permanent construction rather than the typical temporary structures of the work camp facilities and were intended to serve as an underprivileged group camp after they were no longer needed for the relief program. However, that section of the park was later sold and the WPA camp is now used as a church camp.

Lake Shetek State Park WPA/Rustic Style Historic District
 *non-contributing

1. Beach House
2. Drinking Fountain
3. Stone Steps
4. Kitchen Shelter
5. Sanitation Building
6. Picnic Shelter*
7. Causeway

LAKE SHETEK

- Group Camp
 1. Mess Hall
 2. Crafts & Rec Bldg

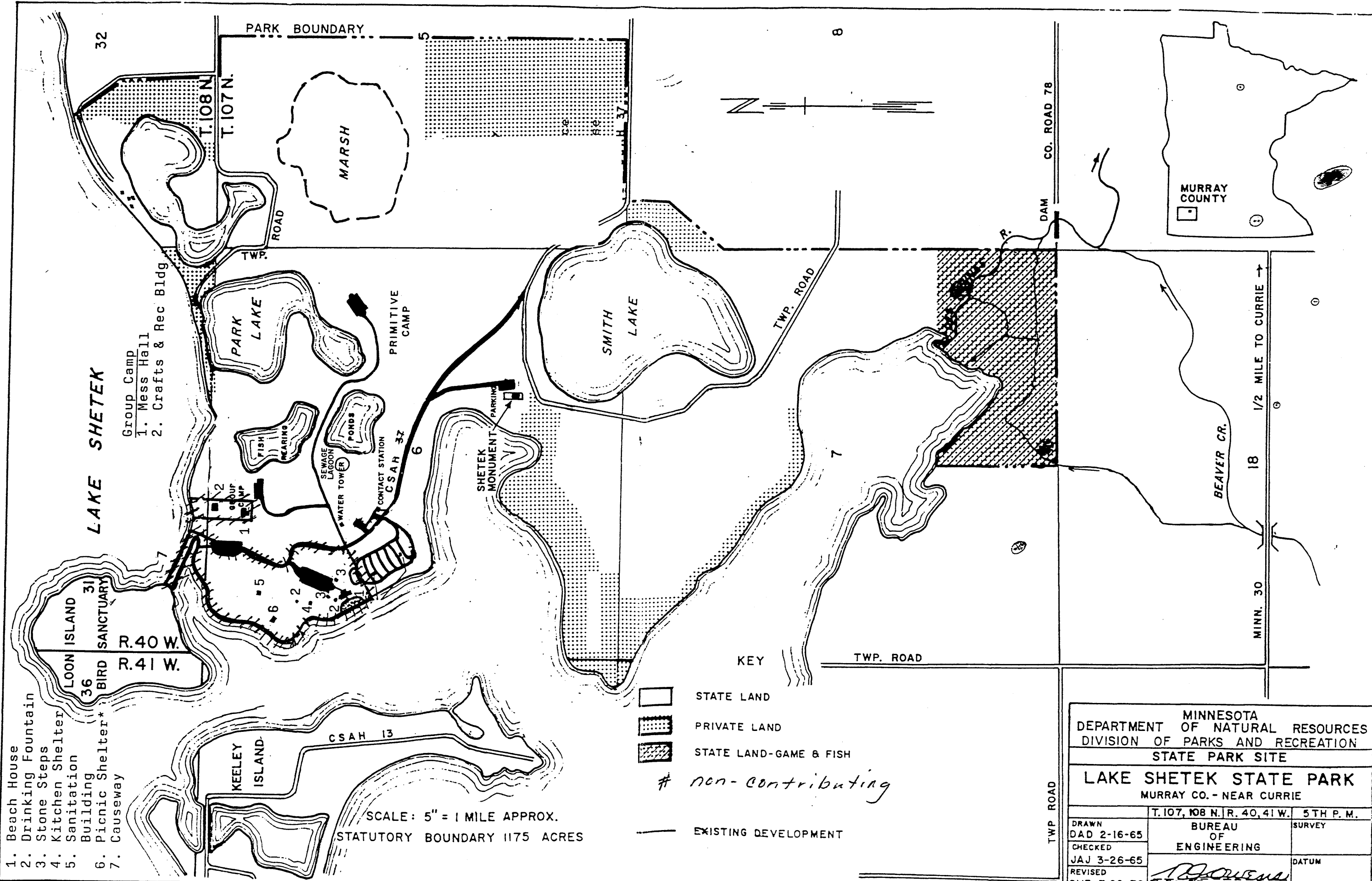

KEY TWP. ROAD

- STATE LAND
- PRIVATE LAND
- STATE LAND-GAME & FISH
- # non-contributing*
- EXISTING DEVELOPMENT

SCALE: 5" = 1 MILE APPROX.
 STATUTORY BOUNDARY 1175 ACRES

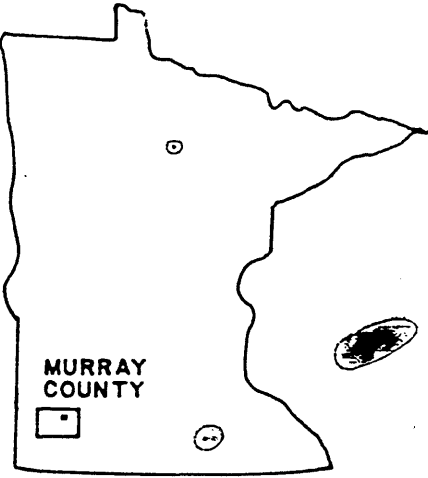

MINNESOTA
 DEPARTMENT OF NATURAL RESOURCES
 DIVISION OF PARKS AND RECREATION
 STATE PARK SITE
LAKE SHETEK STATE PARK
 MURRAY CO. - NEAR CURRIE

DRAWN DAD 2-16-65	BUREAU OF ENGINEERING	SURVEY
CHECKED JAJ 3-26-65		DATUM
REVISED SVF 7-20-78	<i>[Signature]</i> CHIEF ENGINEER	