

(Rev. 10-90)

United States Department of the Interior
National Park Service



541

National Register of Historic Places
Registration Form

This form is for use in nominating or requesting determinations for individual properties and districts. See instructions in How to Complete the National Register of Historic Places Registration Form (National Register Bulletin 16A). Complete each item by marking "x" in the appropriate box or by entering the information requested. If any item does not apply to the property being documented, enter "N/A" for "not applicable." For functions, architectural classification, materials, and areas of significance, enter only categories and subcategories from the instructions. Place additional entries and narrative items on continuation sheets (NPS Form 10-900a). Use a typewriter, word processor, or computer, to complete all items.

1. Name of Property

historic name Wannalancit Street Historic District

other names/site number _____

2. Location

street & number 14-71 Wannalancit Street, 390, 406 Pawtucket Street n/a not for Publication

city or town Lowell N/A vicinity _____

state Massachusetts code MA county Middlesex code 017 zip code 01854

3. State/Federal Agency Certification

As the designated authority under the National Historic Preservation Act of 1986, as amended, I hereby certify that this nomination request for determination of eligibility meets the documentation standards for registering properties in the National Register of Historic Places and meets the procedural and professional requirements set forth in 36 CFR Part 60. In my opinion, the property meets does not meet the National Register Criteria. I recommend that this property be considered significant nationally statewide locally. (See continuation sheet for additional comments.)

Judith B. McDonough
Signature of certifying official/Title Judith B. McDonough, Executive Director
Massachusetts Historical Commission, State Historic Preservation Officer

4/10/98
Date

State or Federal agency and bureau _____

In my opinion, the property meets does not meet the National Register criteria. (See continuation sheet for additional Comments.)

Signature of certifying official/Title _____ Date _____

State or Federal agency and bureau _____

4. National Park Service Certification

I, hereby certify that this property is:

- entered in the National Register
 See continuation sheet.
- determined eligible for the National Register
 See continuation sheet.
- determined not eligible for the National Register
- removed from the National Register
- other (explain): _____

Signature of the Keeper

Edson H. Beall

Date of Action

5-20-98

Wannalancit Street Historic District

Name of Property

Middlesex, Massachusetts

County and State

5. Classification

Ownership of Property

(Check as many boxes as apply)

(Check only one box)

- private
- public-local
- public-State
- public-Federal

- building(s)
- district
- site
- structure
- object

Number of Resources within Property

(Do not include previously listed resources in the count.)

Contributing	Noncontributing	
19	3	buildings
		sites
2		structures
		objects
21	3	Total

Number of contributing resources previously listed in the National Register

1 Round House (NR: 1976)

Name of related multiple property listing

(Enter "N/A" if property is not part of a multiple property listing.)

N/A

6. Function or Use

Historic Functions

(Enter categories from instructions)

DOMESTIC: single dwelling

Current Functions

(Enter categories from instructions)

DOMESTIC: single dwelling, multiple dwelling

7. Description

Architectural Classification

(Enter categories from instructions)

LATE VICTORIAN: Italianate, Queen Anne, Second Empire
COLONIAL REVIVAL
GREEK REVIVAL

Materials

(Enter categories from instructions)

foundation granite
walls clapboard, shingle, vinyl, granite
roof slate, asphalt
other

Narrative Description

(Describe the historic and current condition of the property on one or more continuation sheets.)

(See continuation sheet)

United States Department of the Interior
National Park ServiceNational Register of Historic Places
Continuation SheetWannalancit Street Historic District
Lowell (Middlesex Co.), MassachusettsSection number 7 Page 1**7. DESCRIPTION**

The Wannalancit Street Historic District includes twenty contributing resources (plus the previously listed Bowers House) in an approximately 5.5 acre area immediately south of the Merrimack River in Lowell. The city is located in northeastern Massachusetts in Middlesex County, approximately 25 miles north of Boston. The district is comprised primarily of mid-nineteenth to early twentieth century houses, and is bounded by the Pawtucket Canal to the west, a school and later residential development to the south and east, and residential and institutional development of less integrity along Pawtucket Street (north).

The district is set on a hill rising to the south from Pawtucket Street, dropping off sharply to the west to the canal. Most houses are set on lots of $\frac{1}{4}$ to $\frac{1}{2}$ acre, with the larger lots generally located at the south end of the district. The houses nearer the north end of Wannalancit Street (14, 22, 26, 33-37) are set closer to the street, while several of the houses on larger lots (48 and 58) are set back farther on their lots. Mature shade trees, ornamental shrubbery, lawns and stone walls punctuate the area.

The district contains 23 buildings and two structures. Of these nineteen buildings and two structures contribute to the architectural and historic character and integrity. There are twelve principal contributing buildings (plus one previously listed); the remaining seven contributing buildings are carriage houses and garages. Of the three noncontributing buildings, two are principal buildings. One was built after the period of significance, while the other has been altered to the point of loss of integrity. The remaining noncontributing building is a garage constructed after the period of significance. One building was previously listed on the National Register in 1976 (The Round House, 58 Wannalancit Street).

Most buildings in the district are two to two and one half stories in height and are generally in good condition. With the exception of the **Apartment House**, 15 Wannalancit Street (**Map #A, NC**) a 1960s brick apartment building, all are of wood frame construction with clapboard or shingle sheathing. The houses represent a variety of architectural styles from the mid-nineteenth to early twentieth centuries, and vary in building plan and roof type. Most are in good condition. The integrity of the district is good; the most common alteration has been the addition of aluminum siding. However in most cases siding has been applied while retaining decorative trim. Five houses have had aluminum siding added. Other alterations include window replacement in several houses and several altered.

Landscaping in the district consists primarily of deciduous shade trees and a few evergreen trees

(continued)

United States Department of the Interior
National Park ServiceNational Register of Historic Places
Continuation SheetWannalancit Street Historic District
Lowell (Middlesex Co.), MassachusettsSection number 7 Page 2

on the larger lots, while the smaller lots with houses set close to the street have foundation plantings of flowering shrubs and small evergreen shrubs. Lawns exist where space permits. A description of key and representative buildings in the district follows. Contributing buildings and structures range in date from ca. 1853 to ca. 1936.

The earliest residence in the district is also its only example of the Greek Revival/Gothic Revival styles. The **William Swett House**, 22 Wannalancit Street (ca. 1851, map #5, MHC #144) is a modest 1 1/2 story, sidehall house with a front gable roof. The decorative bargeboards and trim at bays and porch add an element of the Gothic Revival to a Greek Revival form.

The Italianate style is well-represented in the district by the **Mary and Benjamin Collins House**, 14 Wannalancit Street (ca. 1866, map #3, MHC#142), and by the **Irvin A. Foote House**, 28 Wannalancit Street (ca. 1870, map #6). Quite different in form, these two houses also reflect the diversity of the district. The Collins House is a two-story, three-bay house with a center entry and a low hipped roof. Its Italianate features include a bracketed hood at the entry, projecting molded window caps, and quoins. The Foote House is constructed in a more common Italianate form, having a front gable roof and sidehall entry. In addition to a bracketed hood at the entry and projecting window caps, the Foote House also features painted brackets at the cornice. Other examples of the Italianate style include the **Samuel L. Dana House**, 33-37 Wannalancit Street (ca. 1867, map #7) and the **Warren S. Foote House**, 38 Wannalancit Street (ca. 1869, map #8).

The district contains two examples of the Second Empire style: the **Henry M. Thompson House**, 406 Pawtucket Street (by 1876, map #2) and the exceptional **Jonathan Bowers House**, 58 Wannalancit Street (1872, map #11, MHC #147). The Thompson House is a large 2 1/2 story, Mansard roofed residence featuring bracketed, pedimented dormers, tab-bracketed window hoods, and a wraparound porch. The Bowers House, also known as "The Round House," or "The Castle," is an unusual two and one half story, round granite structure capped by a fishscale slate Mansard roof with a cupola. Notable features include arched windows, pedimented dormers, round bays and round granite chimneys.

Wannalancit Street has several very fine examples of Queen Anne-style design, including the **Edward N. Wood House**, 43 Wannalancit Street (ca. 1878, map #9, MHC#145), and the Shingle style-influenced **Oliver E. Cushing House**, 48 Wannalancit Street (ca. 1885, map #10, MHC#146). The Wood House is typical of the Queen Anne style in its irregular plan and massing. It is a 2 1/2 story house with a complex gable roof. Also characteristic of the style is the use of clapboards, varied, shingle patterns, and half-timbering, and the varied shape and placement of the windows. The Cushing House is a 2 1/2 story dwelling with characteristic

(continued)

United States Department of the Interior
National Park ServiceNational Register of Historic Places
Continuation SheetWannalancit Street Historic District
Lowell (Middlesex Co.), MassachusettsSection number 7 Page 3

Queen Anne asymmetry in plan and massing. The use of varied shingle patterns without interruption at corner, and the recessed window at the north end gable end reflect the influence of the Shingle style. A somewhat altered example of the Queen Anne style is the Haven C. Perham House, 19 Wannalancit Street (ca. 1883, Map #4, MHC #143). Substantial examples of the Colonial Revival style exist at opposite ends of the district with the Kitson-Lacey House, 390 Pawtucket Street (by 1896, map #1, MHC#141) and the John H. and Mabel Lambert House, 70 Wannalancit Street (ca. 1907-1910, map #12). The Kitson-Lacey House is a 2 1/2 story house with a center entry, and reflects the early phase of the Colonial Revival style, retaining elements typical also of the Queen Anne style. It features a high slate hipped roof with several intersecting gables. Its notable features include pedimented dormers, some with modified Palladian windows, projecting bays and dentilated and bracketed cornices. Located at the south end of the district is the Lambert House, a five-bay, two and one half story house with a side gable roof. It is typical of the later Colonial Revival period in its more restrained use of historical detail. The house has a center entry sheltered by a Doric portico, a large central chimney, and three pedimented dormers.

In addition to the houses, the district contains three carriage houses in the Queen Anne and Colonial Revival styles. The Haven C. Perham Carriage House and the Edward N. Wood Carriage House (attached to the main house) are both hip-roofed buildings with dormers and cupolas. While these two carriage houses appear to be contemporary with the houses, the Warren S. Foote House has a Colonial Revival style carriage house constructed at a date twenty to thirty years after the main house.

Archaeological Description

While no prehistoric sites are currently recorded in the Wannalancit Street Historic District, it is possible that sites are present. Six prehistoric sites are recorded in the general area (within one mile), including site 19-MD-49, which is located on the south side of Pawtucket Street near the confluence of the Pawtucket Canal and the Merrimack River. That site could extend to the district area, an interpretation that is reinforced by the fact that the Pawtucket Canal was not built until 1792. The site was originally reported as a village site and this area in general was reportedly the location of the Native American village of Wamesit until the late 17th century. The physical characteristics of the area also include locational criteria that are favorable indicators for several types of prehistoric sites. Portions of the district include well-drained level to moderately sloping areas in close proximity to wetlands, in this instance the Merrimack River and the Pawtucket Canal. The district is also immediately south of the Pawtucket Dam, which also marks the location of Pawtucket Falls, a historically important Native American fishing

(continued)

**United States Department of the Interior
National Park Service**

**National Register of Historic Places
Continuation Sheet**

**Wannalancit Street Historic District
Lowell (Middlesex Co.), Massachusetts**

Section number 7 Page 4

ground probably also important to prehistoric Native Americans. Given the above information and the size of the district (approximately 5.5 acres), a high potential exists for the recovery of prehistoric resources in the District. Unfortunately, however, historic development and urban growth have likely adversely affected the integrity of any resources present.

The potential for recovering historic archaeological resources in the district is low at this time simply because the historic archaeological potential, if it exists, is unknown. All if not most of the structures built in the district since Wannalancit Street was laid out in 1850 are still present. Any structures that have been removed are unknown at this time. Some information is present indicating potential locations for earlier structures, however, they have yet to be documented. For example, the location of a noncontributing ca. 1960s apartment house at 15 Wannalancit Street hints at an earlier structure at that location. Potential sites for carriage houses, garages, barns and other outbuildings are also suggested at residences where these structures are presently absent. Occupational-related features, especially some type of refuse areas, may be present; however, these features may not be common in a moderately affluent neighborhood such as Wannalancit Street.

(end)

Wannalancit Street HD
Name of Property

Middlesex, Massachusetts
County and State

8. Statement of Significance

Applicable National Register Criteria

(Mark "x" in one or more boxes for the criteria qualifying the property for National Register listing.)

- A** Property is associated with events that have made a significant contribution to the broad patterns of our history.
- B** Property is associated with the lives of persons significant in our past.
- C** Property embodies the distinctive characteristics of a type, period, or method of construction or represents the work of a master, or possesses high artistic values, or represents a significant and distinguishable entity whose components lack individual distinction.
- D** Property has yielded, or is likely to yield, information important in prehistory or history.

Criteria Considerations

(Mark "x" in all the boxes that apply.)

Property is:

- A** owned by religious institution or used for religious purposes.
- B** removed from its original location.
- C** a birthplace or grave.
- D** a cemetery.
- E** a reconstructed building, object, or structure.
- F** a commemorative property.
- G** less than 50 years of age or achieved significance within the past 50 years.

Narrative Statement of Significance

(Explain the significance of the property on one or more continuation sheets.)

9. Major Bibliographical References

(Cite the books, articles, and other sources used in preparing this form on one or more continuation sheets.)

Previous documentation on file (NPS):

- preliminary determination of individual listing (36 CFR 67) has been requested
- previously listed in the National Register
- previously determined eligible by the National Register
- designated a National Historic Landmark
- recorded by Historic American Buildings Survey # _____
- recorded by Historic American Engineering Record # _____

Areas of Significance

(Enter categories from instructions)

Architecture

Community Planning and Development

Period of Significance

ca. 1852-1947

Significant Dates

Significant Person

(Complete if Criterion B is marked above)

N/A

Cultural Affiliation

N/A

Architect/Builder

Stickney, Frederick W.

Primary location of additional data:

- State Historic Preservation Office
- Other State Agency
- Federal agency
- Local government, Library, Town Hall
- University
- Other

Name of repository:

Lowell Historic Board

**United States Department of the Interior
National Park Service****National Register of Historic Places
Continuation Sheet****Wannalancit Street Historic District
Lowell (Middlesex Co.), Massachusetts**Section number 8 Page 1**8. SIGNIFICANCE**

The Wannalancit Street Historic District, Lowell, possesses integrity of location, design, materials, workmanship, feeling and associations. The district is significant for its role in the mid-nineteenth to early twentieth century residential development of Lowell during a period of growing prosperity, and reflects the ongoing patterns of use as a moderately affluent neighborhood through the first half of the twentieth century. It also possesses an architectural significance as a well preserved collection of buildings representing many of the architectural styles of the mid-nineteenth through early twentieth centuries. The district is of local significance, and meets Criteria A and C for listing on the National Register of Historic Places. The period of significance extends from ca. 1852 when Wannalancit Street was laid out to 1948 based on the development and continued use of the district as a home for some of Lowell's successful merchant and business owners.

Development of Wannalancit Street began in the 1850s during a period of rapid development of residential neighborhoods throughout Lowell for its expanding population and growing middle class. The land in the vicinity of the Wannalancit Street Historic District prior to the late seventeenth century was part of the Indian village Wamesit, established near a fishing ground at Pawtucket Falls, and was sold to English settlers in 1686 by Wannalancit, the last sachem of the Pennacook Indians. This area, which included much of the central section of present-day Lowell, was part of the town of Chelmsford, and was scattered with farms. Pawtucket Street and School Street (immediately east of Wannalancit Street) were early and major arteries, intersecting just south of the Pawtucket Bridge, which was constructed in 1792 over the Merrimack River.

Along with the construction of the bridge, 1792 brought the construction of Lowell's first canal, the Pawtucket Canal west of Wannalancit Street. Developed by a group of Newburyport merchants organized as the Proprietors of Locks and Canals on Merrimack River, the canal around Pawtucket Falls was intended to open trade between remote areas of New Hampshire and the communities in the Merrimack valley by circumnavigating the obstacle of the falls.

The area close to the Pawtucket Bridge by 1820 was developed with a small cluster of houses and a few commercial buildings. The development of early small industries along the Merrimack River near Pawtucket and School Streets included the sawmill of John Ford just above the Pawtucket Falls. Ford is shown on an 1821 map owning the land on which Wannalancit Street was later laid out. The area of East Chelmsford soon to become Lowell had a population of approximately 200 in 1820.

(continued)

United States Department of the Interior
National Park ServiceNational Register of Historic Places
Continuation SheetWannalancit Street Historic District
Lowell (Middlesex Co.), MassachusettsSection number 8 Page 2

Lowell's well-documented and rapid industrial transformation began in the 1820s when a group of Boston investors bought the shares of the Proprietors of Locks and Canals on Merrimack River, and, capitalizing on the water power found at Pawtucket Falls, developed a new system of locks and canals. The development associated with the new canals and mills led to a population boom in Lowell (incorporated in 1826). The expansion brought a population of 6,500 by 1830, 21,000 by 1840, and by 1850 Lowell's population exceeded 33,000.

With the construction of canals and mills and the arrival of a large new work force to Lowell came rapid development of new residential neighborhoods. A middle class consisting of owners of small businesses associated with the mills, merchants of all sorts, doctors, teachers and others established themselves in neighborhoods slightly removed from the smoke of the mills and the density of the neighborhoods built for laborers. Pawtucket Street east of School Street was the early location of many of the mill owners' houses, while the 1840s and 1850s brought the development of such fashionable areas as Belvidere Hill, Centralville, and The Highlands.

Reflecting the need for more middle-class housing away from the heart of the city, Wannalancit Street was laid out ca. 1850. Much of the land in the area had been owned since the eighteenth century by the Bowers family. The estate of Jonathan Bowers was ordered in September 1850 to sell enough land to raise \$1,966.75 to pay his debts. While Wannalancit Street did not appear on the 1850 map of Lowell, it was mentioned by name in a deed of that year between the estate of Jonathan Bowers and William L. Swett. The deed refers to the parcel where 22 Wannalancit Street was constructed as Lot 8 and part of Lot 7 on a "Plan of land in Lowell belonging to the heirs of Jonathan Bowers taken by Cyrus Latham 1849." The 1849 Latham plan does not appear to have been recorded, but a comparison of lot dimensions in deeds to current lot configurations suggests that lot lines have changed considerably in the years since the Latham plan was drawn.

The first house constructed on the street was the William Swett House, 22 Wannalancit Street, ca. 1851. Swett, a carriage maker, purchased the land from the Bowers estate in October 1850 and owned the house as late as 1879. Later owners included Catherine O'Brien (1896, 1906 atlases), and Dr. Edward Patenaude, a dentist, who owned the house in 1924. In addition to its significance as the first house in the district, the 1 1/2 story sidehall cottage is also the only example in the district of the Greek Revival style, and features Gothic Revival elements in its curvilinear bargeboard and other trim.

The decade between 1855 and 1856 brought a period of economic decline nationally, and slowed growth in Lowell. The rapidly growing population shrunk slightly, and development of new residential neighborhoods slowed. Perhaps as a result, the Swett House appears to have

(continued)

United States Department of the Interior
National Park ServiceNational Register of Historic Places
Continuation SheetWannalancit Street Historic District
Lowell (Middlesex Co.), MassachusettsSection number 8 Page 3

remained the only house on Wannalancit Street for approximately a decade. Frederick W. Sargent resided at 57 Wannalancit Street by 1861, and owned the land on which 43 and 71 Wannalancit Street were later built. Sargent was an owner of Chase, Sargent & Sons, a tailors and clothiers business located at 5 Central Street. A subsequent owner was Elizabeth Mansur during the first decades of the twentieth century. Mansur was the widow of Charles H. Mansur, and was herself involved in the business of John Tripp & Co. Tripp was her son-in-law, who owned a firm which manufactured leather belts and roll covering.

The late 1860s and early 1870s brought a flurry of construction activity to the district and Jonathan Bowers (descendent of the Jonathan Bowers who sold land to William Swett) sold several parcels and constructed his own house. This activity was likely influenced by the establishment of one of Lowell's first street railway lines from Belvidere to nearby Pawtucket Falls in 1864. Houses constructed during this period on land sold by Bowers include the Benjamin and Mary Collins House, 14 Wannalancit Street (ca. 1866), the Samuel L. Dana House, 33-37 Wannalancit Street (ca. 1867), the Irvin A. Foote House, 28 Wannalancit Street (ca. 1870), and the Warren S. Foote House, 38 Wannalancit Street (ca. 1869).

These houses illustrate the prominence of the Italianate style in various forms during this period. They feature various combinations of such typical Italianate features as bracketed entry hoods, projecting molded window caps, paired cornice brackets and bay windows. Their forms vary, with hipped and gable roofs, and sidehall and center entries.

The owners of houses constructed during the 1860s and 1870s were typical of the occupants of the district throughout its period of significance, many of them owning small industrial or mercantile businesses, often related to Lowell's larger industries. The original owner of 14 Wannalancit Street, Benjamin Collins, was variously listed in city directories as an auctioneer, dry goods merchant, and milliner. He occupied the house as late as 1879. Between 1896 and 1924 it was occupied by Walter Cobra, who owned a cotton waste business and from the mid 1920s through at least 1947 the family of Joseph Roy, a physician, resided here.

Samuel L. Dana, a physician and eminent chemist at the Merrimack Print Works, occupied 33-37 Wannalancit Street briefly until his death in 1868. The Dana heirs owned the property as late as 1879. A later owner was Roswell Boutwell, who owned Boutwell Brothers, a company providing "iron and steel, heavy hardware, blacksmith supplies, carriage work of all kinds." By 1906 Boutwell had moved to Boston, although his business remained in Lowell. By 1927 the house had become a three-family residence, with occupants including the owner of a garage, a hairdresser, a teacher, a bakery salesman and an insurance agent.

(continued)

United States Department of the Interior
National Park ServiceNational Register of Historic Places
Continuation SheetWannalancit Street Historic District
Lowell (Middlesex Co.), MassachusettsSection number 8 Page 4

Irvin, Warren, and James Foote purchased the land on which the houses at 28, 38, and 48 Wannalancit Street stand, although James appears to have sold the land undeveloped. They were in business together as Warren S. Foote & Company, dealers in upright and square pianofortes. The business was located at 275 Merrimack Street. Members of the Foote family remained in residence at 28 Wannalancit Street as late as 1947, and at 38 Wannalancit Street through 1917. In 1869, when Bowers sold the lot on which 48 Wannalancit Street was later built, he included an easement requiring that no building be constructed closer than 25' from the southern lot line in order not to obstruct the view from his own house which was erected in 1872. The Jonathan Bowers House, 58 Wannalancit Street, marked a shift to more substantial-sized higher-style dwellings, and remains the dominant landmark on Wannalancit Street, as befitted the original owner of much of the district. Bowers was an industrialist whose business ventures included Willowdale, a pleasure resort in Tyngsboro. His Wannalancit Street home was said to have been built at a cost of \$30,000.

The Jonathan Bowers House is also the district's best example of the Second Empire style, albeit an unusual one. It is a round granite structure with round bays and chimneys. Features characteristic of the style include the fishscale Mansard roof, arched windows, and pedimented dormers.

Development of the Wannalancit Street district was gradual over the next decades, when some of the district's largest houses were built and the street had its most prominent residents. As Lowell continued to thrive economically, those who were successful built homes to reflect that success. During the late 1870s, additions to the district included the Second Empire style home of Henry M. Thompson, agent and treasurer of the Lowell Felting Mills, at 406 Pawtucket Street (by 1876) and the Edward N. Wood House at 43 Wannalancit Street (ca. 1878). Wood was a partner in his father's successful flour and grain business beginning in 1868, and acquired full control of the business in 1882.

Two fine Queen-Anne style houses were added during the 1880s, the Haven C. Perham House, 19 Wannalancit Street (ca. 1883) and the Oliver E. Cushing House, 48 Wannalancit Street (ca. 1885). Also constructed during this period was the more modest Elizabeth M. Edson House at 71 Wannalancit Street (ca. 1886), which reflected the transition from the Queen Anne style to the Colonial Revival. Each of the examples of the Queen Anne style display the characteristic variety in roof forms, wall materials and use of such decorative elements as projecting bays, varied fenestration, porches and rich architectural ornamentation.

Perham was treasurer of the Kitson Machine Company, the second largest manufacturer of cotton machinery in Lowell. Perham's heirs resided at 19 Wannalancit Street as late as 1917.

(continued)

United States Department of the Interior
National Park ServiceNational Register of Historic Places
Continuation SheetWannalancit Street Historic District
Lowell (Middlesex Co.), MassachusettsSection number 8 Page 5

Elizabeth Edson was the daughter of prominent Lowell minister Rev. Theodore Edson, who came to Lowell in the early 1820s as the minister of the Merrimack Company, and soon was rector of St. Anne's Church. His daughter was probably the first owner of this house, owning it from ca. 1886 through at least 1906.

Oliver E. Cushing (1829-1890) was a prominent figure in Lowell. He was a civil and mechanical engineer who served as an agent of the Lowell Gas Company for 25 years. Cushing also held the positions of clerk of St. Anne's parish for 30 years, alderman (1885), and President of the Board of Trustees of the Lowell Cemetery. The house remained in the ownership of the Cushing family as late as 1927. Cushing hired Lowell and Boston architect Frederick W. Stickney to design his house ca. 1885. Stickney designed several major Lowell public buildings, including Memorial Hall/Public Library, Butler School, the Lawrence Street firehouse, and several structures at the Lowell Cemetery, including the Talbot Memorial Chapel (1885), the Superintendent's Office (1887), and the Shedd Memorial Receiving Tomb (1891).

The last additions to the Wannalancit Street district, both fine examples of the Colonial Revival style, were the Kitson-Lacey House, 390 Pawtucket Street (by 1896) and the John H. and Mabel Lambert House, 70 Wannalancit Street (ca. 1907-1910). The earlier Kitson-Lacey House uses the complex roof design typical of the Queen Anne style in combination with the greater symmetry of the Colonial Revival style. Its features typical of the Colonial Revival style include pedimented dormers, modified Palladian windows, and dentilated and bracketed cornices. The more restrained John H. and Mabel Lambert House illustrates the greater simplicity of the later Colonial Revival period with a center entry sheltered by a Doric portico, a large central chimney, and pedimented dormers.

During the decades between 1910 and 1947, after construction had been completed on Wannalancit Street, the district continued in use as a residential area occupied by businessmen, physicians, and educators. While some houses were divided for multi-family use, several houses continued in the ownership of their original owners through all or part of this period. These included 14, which was occupied by the family of business owner Walter Coburn as late as 1924; #19, which was still occupied by a member of the Perham family in 1917; and #48, which remained in the Cushing family as late as 1927. The Irvin and Warren Foote Houses at # 28 and 38 remained in the Foote families through 1947 and 1917 respectively. 70 Wannalancit Street continued to be occupied by its original owner, Dr. John Lambert, as late as 1947.

In addition to those houses remaining in their original ownership, Lowell businessmen resided at the following houses during this period: 57 (Christos Laganas, president of Laganas Shoe Mfg. Co., 1927) and 58 (Victor F. Jewett, president of F.E. Jewett Co., between 1927 and 1947). Among the houses occupied by physicians and dentists during these decades wer #14 (Joseph H.

(continued)

United States Department of the Interior
National Park ServiceNational Register of Historic Places
Continuation SheetWannalancit Street Historic District
Lowell (Middlesex Co.), MassachusettsSection number 8 Page 6

Roy, physician, 1927), 22 (Edward Patenaude, dentist, between 1917 and 1947), 43 (Edward M. Murphy, eye physician, 1947), and 57 (Demosthenes Generales, physician, 1947). Educators living in the district occupied the following houses: 14 (Berangere Roy, teacher, 1947), 19 (William A. Donovan, sub-master, high school, 1947), and 33-37 (Eleanor LaLacheur, teacher, between 1927 and 1937).

In recent years residents of the Wannalancit Street district have shown a growing interest in the preservation of their neighborhood. Repairs and restoration work occurs on a regular basis, with attention to such details as appropriate paint colors and choice of materials. An active neighborhood association has supported the preparation of this National Register nomination, and a recent Preservation Week walking tour was well attended, suggesting that concern for the preservation of the district will continue.

Archaeological Significance

Since patterns of prehistoric settlement and subsistence in Lowell are poorly understood, any surviving sites could be significant. Furthermore, the potential for recovering evidence of a regionally important village site and fisheries site also indicates that fragments of sites affected by historic development or urban growth may also be significant. Potential archaeological sites in this area may have gained local if not regional importance at the time water levels in the Merrimack River and available riverine resources created this area as an important Native American fishing station. By the Contact and early historic period, this factor and the nearby confluence of the Concord and Merrimack Rivers, approximately one mile east of the district, combined to make the village of Wamesit a probable regional and locally important core area. Any archaeological resources that survive in this area can help document the history of Native American settlement in this area and the importance of a village that we know only from early historical accounts and folklore. Evidence can be present that helps better understand the importance of this village area within the main Merrimack River Corridor and its relationship to more interior sites and areas made accessible by interior transportation corridors such as the Concord River. Archaeological features recovered at sites in this area can be important by providing information on Native subsistence, fishery technology, seasonality, and socio-political organization, especially if some level of group cooperation was involved in fishing efforts. Prehistoric sites in this area may also contain information contributing to a greater understanding of regional trade patterns that may have linked interior areas of New Hampshire with more coastal locales.

Although largely unknown and undocumented at this time, historic archaeological resources described above may have the potential to provide detailed information relating to the structure

(continued)

**United States Department of the Interior
National Park Service**

**National Register of Historic Places
Continuation Sheet**

**Wannalancit Street Historic District
Lowell (Middlesex Co.), Massachusetts**

Section number 8 Page 7

of the district and the lives of its successful merchant and business owner inhabitants during a period of prosperous growth for the City of Lowell in the mid 19th to early 20th century. Further documentary research combined with archaeological testing and monitoring of any excavations in the area can document the locations of any structures that may have been lost in the district. These structures could contribute evidence of structures and land use predating the mid 19th century date when Wannalancit Street was laid out, and later buildings or residences whose presence has simply been lost or forgotten. Structural remains from outbuildings and detailed analysis of any occupational-type features present can also provide evidence of the range of domestic activities occurring in a moderately affluent neighborhood and the extent to which varied forms of transportation were available to its inhabitants.

(end)

United States Department of the Interior
National Park Service

National Register of Historic Places
Continuation Sheet

Wannalancit Street Historic District
Lowell (Middlesex Co.), Massachusetts

Section number 9 Page 1

9. BIBLIOGRAPHY

Boynton, G.W. Plan of the City of Lowell, 1845.

Coburn, F.W. History of Lowell and its People. New York: Lewis Historical Publishing Co., 1920

Contributions of the Old Residents' Historical Association of Lowell, Mass. 1879-1904

Cowley, Charles. History of Lowell. Boston: Lee and Shepard, 1868.

Hales, J.G. A Plan of Sundry Farms at Patucket in the Town of Chelmsford. Boston, 1821.

Illustrated History of Lowell and Vicinity. Lowell, Curier Citizens Co., 1897

The Lowell Book. Boston, 1899.

Lowell City Directories.

Lowell City Atlases - 1879, 1888, 1896, 1906, 1936

Lowell Historical Society. "Selection Historical and General, mostly concerning Lowell & Vicinity." (newspaper clippings). Lowell, 1884 and 1894.

Lowell Year Book. Lowell: The Morning Mail, 1888.

Mass. Historical Commission inventory forms, prepared by Harriet White, 1980.

Mather, Benjamin. Plan of the Town of Lowell and Belvidere Village. Boston: Pendleton's Lithography, 1832.

Middlesex County Registry of Deeds. Individual property records.

Moody, S. Plan of Lowell, MA. 1850

(end)

Wannalancit St. Historic District
Name of Property

Middlesex County, MA
County and State

10. Geographical Data

Acreage of Property ca. 5.5 acres

UTM References See continuation sheet.

(Place additional UTM references on a continuation sheet)

1. 19	309000	4724140	2. 19	309140	4723900
Zone	Easting	Northing	Zone	Easting	Northing
3. 19	309020	4723900	4. 19	308940	4724100
Zone	Easting	Northing	Zone	Easting	Northing

See continuation sheet

Verbal Boundary Description

(Describe the boundaries of the property on a continuation sheet.)

Boundary Justification

(Explain why the boundaries were selected on a continuation sheet.)

11. Form Prepared By

name/title Kim Withers Brengle, Preservation Consultant, with Betsy Friedberg, MHC, National Register Director

organization Massachusetts Historical Commission date April 1998

street & number 220 Morrissey Boulevard telephone 617-727-8470

city or town Boston state MA zip code 02125

Additional Documentation

Submit the following items with the completed form:

Continuation Sheets

Maps

A **USGS map** (7.5 or 15 minute series) indicating the property's location.

A **sketch map** for historic districts and properties having large acreage or numerous resources.

Photographs

Representative **black and white photographs** of the property.

Additional items (Check with the SHPO or FPO for any additional items)

Property Owner

(Complete this item at the request of the SHPO or FPO.)

name Multiple

street & number _____ telephone _____

city or town Lowell state MA zip code 01854

Paperwork Reduction Act Statement: This information is being collected for applications to the National Register of Historic Places to nominate properties for listing or determine eligibility for listing, to list properties, and to amend existing listings. Response to this request is required to obtain a benefit in accordance with the National Historic Preservation Act, as amended (16 U.S.C. 470 et seq.).

Estimated Burden Statement: Public reporting burden for this form is estimated to average 18.1 hours per response including the time for reviewing instructions, gathering and maintaining data, and completing and reviewing the form. Direct comments regarding this burden estimate or any aspect of this form to the Chief, Administrative Services Division, National Park Service, P.O. Box 37127, Washington, DC 20013-7127; and the Office of Management and Budget, Paperwork Reductions Project (1024-0018), Washington, DC 20503.

**United States Department of the Interior
National Park Service****National Register of Historic Places
Continuation Sheet****Wannalancit Street Historic District
Lowell (Middlesex Co.), Massachusetts**Section number 10 Page 1

10. VERBAL BOUNDARY DESCRIPTION

Beginning at the northeast corner of Wannalancit and West Bowers Streets, the district extends approximately 188' easterly along West Bowers Street (the south lot line of 70 Wannalancit Street); then northerly approximately 737' (along the rear lot lines of 70, 58, 48, 38, 28, 22 and 14 Wannalancit, and the east lot line of 390 Pawtucket Street); then westerly approximately 215' along the south side of Pawtucket Street (along the front lot lines of 390 and 406 Pawtucket Street); then southerly approximately 687' (along the west side lot lines of 406 Pawtucket and the rear lot lines of 15, 19, 33-37, 43 and 57 Wannalancit Street); then easterly approximately 229' to the northeast corner of Wannalancit and West Bowers Streets (along the south lot lines of 57 and 71 Wannalancit Street.)

BOUNDARY JUSTIFICATION

The nominated district is comprised of a single block of Wannalancit Street containing a consistently intact collection of residences dating from the second half of the 19th century. Pawtucket Street forms the northern boundary. While adjacent Pawtucket Street buildings are generally of the same period as those in the district, buildings have lost integrity due to alterations, and intrusions exist. To the west side of Wannalancit Street, the land drops off sharply to the Pawtucket Canal and is undeveloped. Immediately to the south of the district on Wannalancit Street is the Bartlett School (c. 1930s), and modest residential development of the late 19th to early 20th century. East of the district on West Bowers Street are multi-family dwellings of the early 20th century.

(end)

**Wannalancit Street National Register District
Lowell (Middlesex), Massachusetts**

District Data Sheet

<u>Map#</u>	<u>MHC#</u>	<u>Name</u>	<u>Address</u>	<u>Date</u>	<u>Status</u>	<u>Style</u>	<u>Resource</u>
1	141	Kitson-Lacy House	390 Pawtucket Street	by 1896	C	Colonial Revival	B
2	N/A	Henry M. Thompson House	406 Pawtucket Street	by 1876	C	Second Empire	B
3	142	Mary & Benj. Collins House	14 Wannalancit Street	ca 1866	C	Italianate	B
A	N/A	Apartment House	15 Wannalancit Street	ca 1960s	NC	No Style	B
4	143	Haven C. Perham House Carriage House	19 Wannalancit Street	ca 1883 ca 1883	C C	Queen Anne Queen Anne	B B
5	144	William Swett House Garage	22 Wannalancit Street	ca 1851 ca 1910-1924	C C	Greek Revival/Gothic Rev.	B B
6	N/A	Irvin A. Foote House	28 Wannalancit Street	ca 1870	C	Italianate	B
7	N/A	Samuel L. Dana House Garage	33-37 Wannalancit Street	ca 1867 unknown	C NC	Italianate	B B
8	N/A	Warren S. Foote House Carriage House	38 Wannalancit St.	ca 1869 ca 1896-1906	C C	Italianate/Col. Revival Colonial Revival	B B
9	145	Edward N. Wood House Carriage House (attached)	43 Wannalancit St.	ca 1878 ca 1878	C C	Queen Anne Queen Anne	B B
10	146	Oliver E. Cushing House Garage	48 Wannalancit St.	ca 1885 ca 1924-1936	C C	Queen Anne/Shingle	B B
B	N/A	Frederick W. Sargent House	57 Wannalancit St.	by 1861	NC	No style	B
11	147	Jonathan Bowers House Wall	58 Wannalancit St.	1872 unknown	NR C	Second Empire	B S

**Wannalancit Street National Register District
Lowell (Middlesex), Massachusetts**

District Data Sheet

<u>Map#</u>	<u>MHC#</u>	<u>Name</u>	<u>Address</u>	<u>Date</u>	<u>Status</u>	<u>Style</u>	<u>Resource</u>
12	N/A	John H./Mabel Lambert House Carriage House Wall	70 Wannalancit St.	ca 1907-1910	C C C	Colonial Revival	B B S
13	N/A	Elizabeth Edson House Garage	71 Wannalancit St.	ca 1886 by 1924	C C	Queen Anne/Col.Rev.B	B B

KEY: C Contributing Resource NC Noncontributing Resource B Building S Structure

19 Contributing Buildings 3 Noncontributing Buildings
2 Contributing Structures

TOTAL 21 Contributing 3 Noncontributing

ADDITIONAL 1 Building Previously Listed

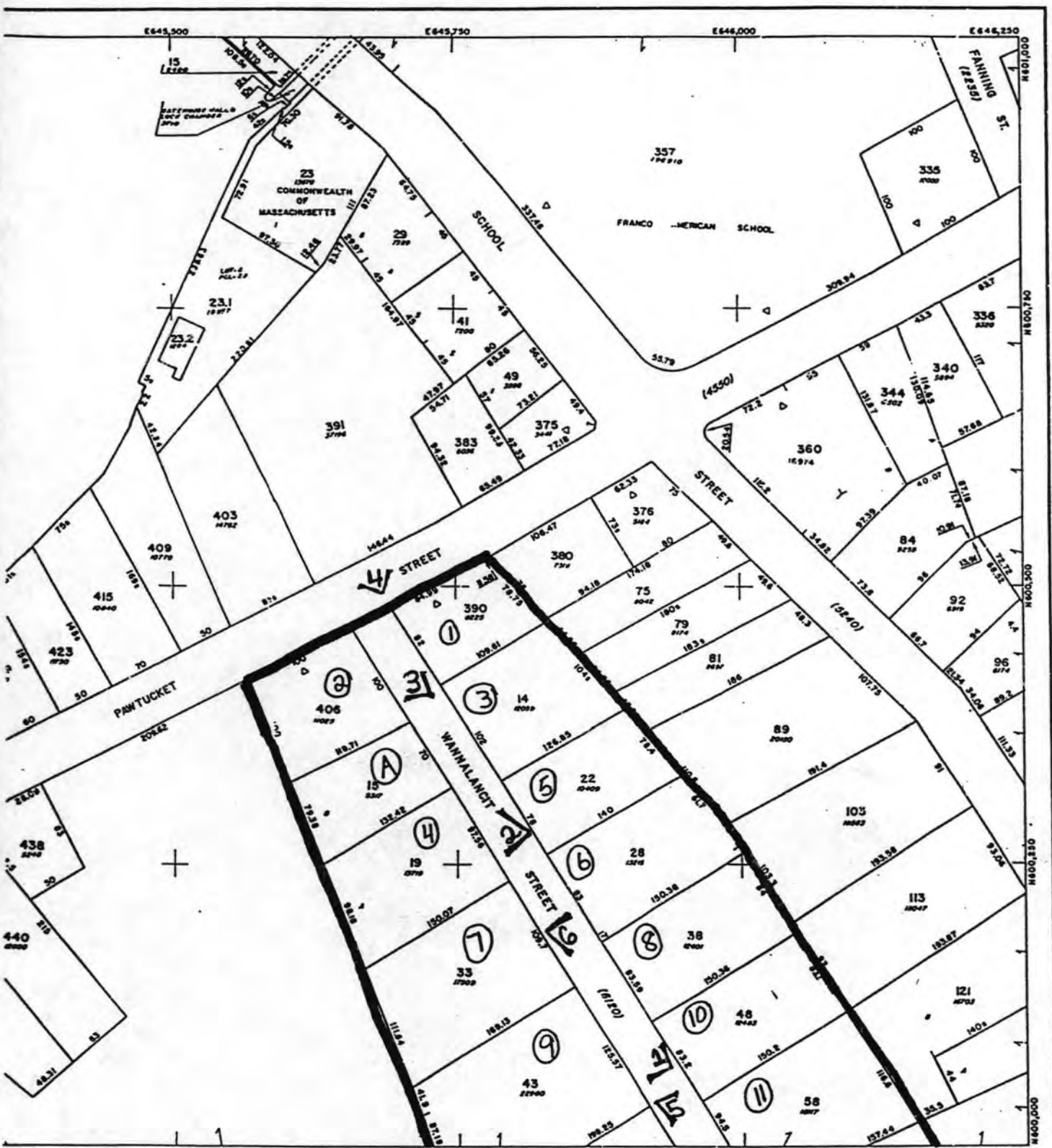

WANNALANCIT ST. HISTORIC DISTRICT
 LOWELL, MA.
 ASSESSOR'S MAP # 99
 SCALE: 1" = 50'
 MAP # 1 OF 2

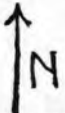

30X

PROPERTY OWNERSHIP MAPS			SHEET INDEX		
82	98	116	82	98	116
83	99	117	83	99	117
84	100	118	84	100	118

CITY OF
 LOWELL, MASSACHUSETTS

DATE: JAN. 1, 1982

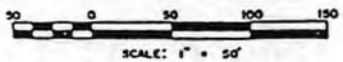



WANNALANCIT ST. HISTORIC DISTRICT
 LOWELL, MA.
 ASSESSOR'S MAP # 100
 SCALE: 1" = 50'
 MAP # 2 OF 2



PROPERTY OWNERSHIP MAPS			SHEET INDEX		
83	95	117	83	95	117
84	100	118	84	100	118
85	101	119	85	101	119

CITY OF
 LOWELL, MASSACHUSETTS

UNITED STATES DEPARTMENT OF THE INTERIOR
NATIONAL PARK SERVICE

NATIONAL REGISTER OF HISTORIC PLACES
EVALUATION/RETURN SHEET

REQUESTED ACTION: NOMINATION

PROPERTY Wannalancit Street Historic District
NAME:

MULTIPLE
NAME:

STATE & COUNTY: MASSACHUSETTS, Middlesex

DATE RECEIVED: 4/17/98 DATE OF PENDING LIST: 4/28/98
DATE OF 16TH DAY: 5/14/98 DATE OF 45TH DAY: 6/01/98
DATE OF WEEKLY LIST:

REFERENCE NUMBER: 98000541

NOMINATOR: STATE

REASONS FOR REVIEW:

APPEAL: N DATA PROBLEM: N LANDSCAPE: N LESS THAN 50 YEARS: N
OTHER: N PDIL: N PERIOD: N PROGRAM UNAPPROVED: N
REQUEST: N SAMPLE: N SLR DRAFT: N NATIONAL: N

COMMENT WAIVER: N

ACCEPT RETURN REJECT 5.20.98 DATE

ABSTRACT/SUMMARY COMMENTS:

**Entered in the
National Register**

RECOM./CRITERIA _____

REVIEWER _____ DISCIPLINE _____

TELEPHONE _____ DATE _____

DOCUMENTATION see attached comments Y/N see attached SLR Y/N



48 and 58 Wannalancit St.
Wannalancit St. Historic District
Lowell, MA.

Photographer: Kim Brengle

Location of Negative: Lowell Historic Board, JFK Civic Center, Lowell, Ma.

Date: January, 1997

View facing east

Photo 1 of 6



2

22, 28 and 38 Wannalancit St.

Wannalancit St. Historic District

Lowell, MA.

Photographer: Kim Brengle

Location of Negative: Lowell Historic Board, JFK Civic Center, Lowell, MA.

Date: January, 1997

View facing northeast

Photo # 2 of 6



14, 22 and 28 Wannalancit St.
Wannalancit St. Historic District
Lowell, MA.

Photographer: Kim Brengle

Location of Negative: Lowell Historic Board, JFK Civic Center, Lowell, MA.

Date: May 1997

View facing southeast

Photo # 3 of 6



390 PAWTUCKET ST.

WANNALANCIT ST. HISTORIC DISTRICT

LOWELL, MA.

PHOTOGRAPHER: KIM BRENGLE

LOCATION OF NEGATIVE: LOWELL HISTORIC BOARD, JFK CIVIC CENTER, LOWELL, MA,

DATE: MAY, 1997

VIEW FACING SOUTHEAST

PHOTO #4 of 6



43 WANNALANCIT ST,
WANNALANCIT ST. HISTORIC DISTRICT
LOWELL, MA,

PHOTOGRAPHER: KIM BREngle

LOCATION OF NEGATIVE: LOWELL HISTORIC BOARD, JFK CIVIC CENTER, LOWELL, MA.

DATE: JANUARY, 1997

VIEW FACING NORTHWEST

PHOTO # 5 of 6



33-37 and 19 WANNALANCIT ST.
WANNALANCIT ST. HISTORIC DISTRICT
LOWELL, MA.

PHOTOGRAPHER: KIM BRENGLE

LOCATION OF NEGATIVE: LOWELL HISTORIC BOARD, JFK CIVIC CENTER, LOWELL, MA,

DATE: JANUARY, 1997

VIEW FACING NORTHWEST

PHOTO # 6 of 6



WANMALANCIT ST. HISTORIC DISTRICT
LOWELL, MA.
A. 19/309000/4724140
B. 19/309140/4723920
C. 19/309020/4723900
D. 19/308940/4724100

Mapped, edited, and published by the Geological Survey
Control by USGS, USC&GS, and Massachusetts Geodetic Survey
Topography by planetable surveys 1939 and 1944. Revised 1966
Polyconic projection. 1927 North American datum
10,000-foot grids based on Massachusetts coordinate system,
mainland zone, and New Hampshire coordinate system
1000-meter Universal Transverse Mercator grid ticks,
zone 19, shown in blue
Red tint indicates areas in which only landmark buildings are shown
There may be private inholdings within the boundaries of
the National or State reservations shown on this map
Revisions shown in purple compiled in cooperation with State of
Massachusetts agencies from aerial photographs taken 1977 and other
source data. This information not field checked. Map edited 1979

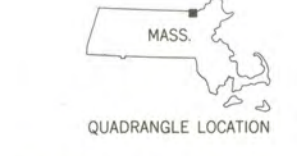
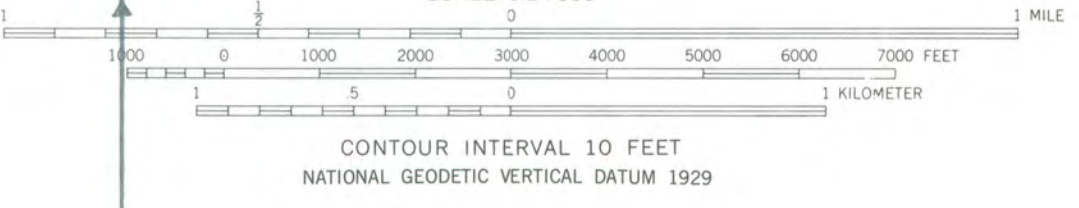

ROAD CLASSIFICATION

Heavy-duty	Light-duty
Medium-duty	Unimproved dirt
Interstate Route	State Route

THIS MAP COMPLIES WITH NATIONAL MAP ACCURACY STANDARDS
FOR SALE BY U.S. GEOLOGICAL SURVEY
DENVER, COLORADO 80225, OR RESTON, VIRGINIA 22092
A FOLDER DESCRIBING TOPOGRAPHIC MAPS AND SYMBOLS IS AVAILABLE ON REQUEST

To place on the predicted North American Datum 1983,
move the projection lines 6 meters south and
41 meters west as shown by dashed corner ticks

LOWELL, MASS.-N. H.
42071-F3-IF-024
1966
PHOTOREVISED 1979
DMA 6769 III NE--SERIES Y814



The Commonwealth of Massachusetts
William Francis Galvin, Secretary of the Commonwealth
Massachusetts Historical Commission

March 30, 1998

Ms. Carol Shull
National Register of Historic Places
Department of the Interior
National Park Service
Mail Stop 2280, Suite 400
1849 C Street, N.W.
Washington, DC 20240

Dear Ms. Shull:

Enclosed please find the following nomination for:

Wannalancit Street Historic District, Lowell (Middlesex Co.), MA

The nomination has been voted eligible by the State Review Board and has been signed by the State Historic Preservation Officer. The owners of property in the Certified Local Government community of Lowell were notified of pending State Review Board consideration 60-120 days before the meeting.

Sincerely,

A handwritten signature in cursive script that reads "Betsy Friedberg".

Betsy Friedberg, National Register Director
Massachusetts Historical Commission

cc: Debra Grossman, Chair, Lowell Historic Board
Stephen Stowell, Lowell Historic Board
Hon. Edward Caulfield, Mayor, City of Lowell
Virginia Dolloff, Director of Planning, City of Lowell
Kim Withers Brengle, Preservation Consultant