

A. HISTORIC NAME Huber Motor Sales B. COUNTY Vanderburgh C. NUMBER 163-196-00288 29  
 D. ADDRESS 215-219 S E Fourth Street E. TWP/CITY Pigeon F. QUAD NAME Evansville South  
 RATING  Outstanding  Significant/Notable  Contributing/Reference  Non-Contributing UTM REFERENCES 16 4491299 4202370

STATE OF INDIANA DEPARTMENT OF NATURAL RESOURCES INDIANA HISTORIC SITES AND STRUCTURES INVENTORY REVISED 1981

MOUNT CONTACT PRINTS HERE

1. COMMON NAME <u>Kenny Kent Body Shop</u>	4. PROPERTY'S MAILING ADDRESS <u>Kenny Kent</u> <u>215-219 SE Fourth Street</u> <u>Evansville, Indiana 47708</u>	5. LOCATION NOTES <u>Lot 191, Donation Enlargement</u>
2. OWNERSHIP <u>Public</u> <input checked="" type="checkbox"/> Private		
3. VISIBLE <input checked="" type="checkbox"/> Yes <input type="checkbox"/> No		

6. USE	PRESENT	PAST	PRESENT	PAST	7. ENDANGERED	8. CATEGORY	9a. LOCAL LEGAL PROTECTIONS
Residence	<input type="checkbox"/>	<input type="checkbox"/>	Military	<input type="checkbox"/>	<input type="checkbox"/> Vacant	<input type="checkbox"/> District	<input type="checkbox"/> Historic District
Govt./Pol.	<input type="checkbox"/>	<input type="checkbox"/>	Entertainment	<input type="checkbox"/>	<input type="checkbox"/> Neglected	<input checked="" type="checkbox"/> Building(s)	<input type="checkbox"/> Landmark
Commerce	<input checked="" type="checkbox"/>	<input checked="" type="checkbox"/>	Scientific	<input type="checkbox"/>	<input type="checkbox"/> Encroachment	<input type="checkbox"/> Structure	<input type="checkbox"/> Deed Restriction
Industrial	<input checked="" type="checkbox"/>	<input type="checkbox"/>	Religious	<input type="checkbox"/>	<input type="checkbox"/> Other	<input type="checkbox"/> Site	<input type="checkbox"/> Other
Agriculture	<input type="checkbox"/>	<input type="checkbox"/>	Park	<input type="checkbox"/>		<input type="checkbox"/> Object	
Transportation	<input type="checkbox"/>	<input type="checkbox"/>	Museum	<input type="checkbox"/>			
Organization	<input type="checkbox"/>	<input type="checkbox"/>	Educational	<input type="checkbox"/>			
Other					9b. SURVEYS		
					SR <input type="checkbox"/> NR <input type="checkbox"/> NHL <input type="checkbox"/> HABS <input type="checkbox"/> HAER <input type="checkbox"/>		

10. CONDITION	11. BUILDING INTEGRITY	11a. Specify Alterations
<input type="checkbox"/> Excellent	<input type="checkbox"/> Unaltered	Removals _____
<input checked="" type="checkbox"/> Good	<input checked="" type="checkbox"/> Altered	Structural _____
<input type="checkbox"/> Fair	<input type="checkbox"/> Moved	Replacement <u>ground floor storefront windows</u>
<input type="checkbox"/> Deteriorated	Date _____	Additions _____
<input type="checkbox"/> Ruins		

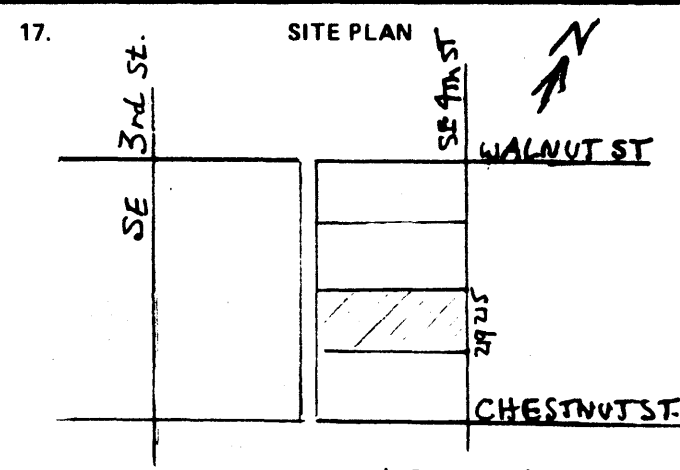

12. DATE 1916 13. STYLE See below. 14. ARCHITECT/BUILDER Shoppell & Co.

15. DESCRIPTION \_\_\_\_\_

Inscriptions none Facade Material glazed brick.

16. OUTBUILDINGS none

18. ENVIRONMENT commercial; retail

19. AREAS OF SIGNIFICANCE: Specify the significance for each area checked

<input type="checkbox"/> Aboriginal	15.	ATTACH NEGATIVE ENVELOPE HERE
<input type="checkbox"/> Arts	Measuring 75 feet wide by 130 feet in depth, the Huber building is comprised	
<input checked="" type="checkbox"/> Architecture	of two brick sections. The front part is two stories, about 50 feet in depth,	
<input checked="" type="checkbox"/> Commerce	and has a sloped roof. The facade is faced above the ground story with white	
<input type="checkbox"/> Communications	glazed brick and contains 5 large multi-paned steel sash windows. A stone stringcourse under-	
<input type="checkbox"/> Community Planning	scores the windows and stone was used for coping on the straight-line parapet. The ground floor	
<input type="checkbox"/> Education	facade, remodeled during the 1970's has an off-center single-leaf doorway flanked by large plate	
<input type="checkbox"/> Engineering	glass windows. The rear section of the building is one story in height and is also enclosed by	
<input type="checkbox"/> Environs/Neighborhoods	a sloped roof. The southside wall contains a vehicle bay with an overhead door and a pedestrian	
<input type="checkbox"/> Exploration/Settlement	entry. The north side wall abuts with the adjoining Newman building. The approximate	
<input type="checkbox"/> Humanities	acreage of the Huber Motor Sales site is .2 acre.	
<input type="checkbox"/> Indian		
<input type="checkbox"/> Landscape Architecture		
<input type="checkbox"/> Military		
<input type="checkbox"/> Politics/Government		
<input type="checkbox"/> Religion		
<input type="checkbox"/> Science/Technology		
<input type="checkbox"/> Social/Ethnicity		
<input checked="" type="checkbox"/> Transportation		
<input type="checkbox"/> Vernacular/Construction		
<input type="checkbox"/> Other		

20. INFORMATION SOURCES City Directories; Deed records; Deeds photo (ca. 1920; Willard Library);

21 SURVEYOR Douglas L Stern 22. DATE 15 December 1982 (amended)

**STATE OF INDIANA  
DEPARTMENT OF NATURAL RESOURCES  
INDIANA HISTORIC SITES AND STRUCTURES INVENTORY**

Additional Architectural Information

**A. NAME** Huber Motor Sales **C. NUMBER** 163-196-00288

**B. ADDRESS** 215-219 Southeast Fourth Street

**D. UTM References** 1,6 4,4,9,9,9,0 4,2,0,2,3,7,0

**E.** 19.

When real estate speculator William Gray erected a garage and auto show room for lease on Upper Fourth, the car had become firmly entrenched in the city's commercial base. The year was 1916, and Gray was riding a rising tide of small town entrepreneurship, with car dealers, manufacturers, and mechanics establishing themselves all over the city. The City Directory for the year before listed 23 auto-related enterprises. Gray was not particularly interested in the promotion of the car, however, as his varied real estate investments city-wide indicate money making as a prime motive. Car sales would do as well as any other tenant, and Gray's garage on Fourth did not have any trouble attracting a leasee, proving the correctness of Gray's thinking and the strength of the local auto market on the eve of the First World War.

The building remained associated with a series of auto dealers through 1938 and the end of the Great Depression, a crisis which sorely tested even the most profitable retail car dealerships. The longest tenancy by an auto representative was Huber Motor Sales, Evansville's Hupmobile dealer, which spent 18 years in Gray's building beginning in 1920.

**F. INFORMATION SOURCES** \_\_\_\_\_  
\_\_\_\_\_  
\_\_\_\_\_  
\_\_\_\_\_

**G. PREPARED BY** Douglas L Stern

**H. DATE** 15 December 1982

FEB 23 1984