

Theme 9. Society and Social Conscience

Form 10-300  
(July 1969)

UNITED STATES DEPARTMENT OF THE INTERIOR  
NATIONAL PARK SERVICE

NATIONAL REGISTER OF HISTORIC PLACES  
INVENTORY - NOMINATION FORM

(Type all entries - complete applicable sections)

STATE: South Carolina	
COUNTY: Sumter	
FOR NPS USE ONLY	
ENTRY NUMBER 71.2.45.0010	DATE 3/24/71

1. NAME

COMMON:  
Stateburg Historic District

AND/OR HISTORIC:

2. LOCATION

STREET AND NUMBER:  
Located in the "High Hills of the Santee" one mile north of US Hwy. 76

CITY OR TOWN:  
&378 between Sumter and Columbia, on S.C. Hwy. 261, 12 miles from Sumter.

STATE: South Carolina      CODE: 45      COUNTY: Sumter      CODE: 085

3. CLASSIFICATION

CATEGORY (Check One)	OWNERSHIP	STATUS	ACCESSIBLE TO THE PUBLIC
<input checked="" type="checkbox"/> District <input type="checkbox"/> Building <input type="checkbox"/> Site <input type="checkbox"/> Structure <input type="checkbox"/> Object	<input checked="" type="checkbox"/> Public <input checked="" type="checkbox"/> Private <input type="checkbox"/> Both	Public Acquisition: <input type="checkbox"/> In Process <input type="checkbox"/> Being Considered	<input checked="" type="checkbox"/> Occupied <input checked="" type="checkbox"/> Unoccupied <input type="checkbox"/> Preservation work in progress
PRESENT USE (Check One or More as Appropriate)			
<input checked="" type="checkbox"/> Agricultural <input type="checkbox"/> Commercial <input type="checkbox"/> Educational <input type="checkbox"/> Entertainment	<input type="checkbox"/> Government <input type="checkbox"/> Industrial <input type="checkbox"/> Military <input type="checkbox"/> Museum	<input checked="" type="checkbox"/> Park <input checked="" type="checkbox"/> Private Residence <input checked="" type="checkbox"/> Religious <input type="checkbox"/> Scientific	<input type="checkbox"/> Transportation <input type="checkbox"/> Other (Specify) _____ <input type="checkbox"/> Comments _____

4. OWNER OF PROPERTY

OWNER'S NAME:  
Miscellaneous

STREET AND NUMBER:

CITY OR TOWN:      STATE:      CODE:

5. LOCATION OF LEGAL DESCRIPTION

COURTHOUSE, REGISTRY OF DEEDS, ETC.:

Sumter County Court House

STREET AND NUMBER:  
North Main Street

CITY OR TOWN: Sumter      STATE: South Carolina      CODE: 45

6. REPRESENTATION IN EXISTING SURVEYS

TITLE OF SURVEY:  
South Carolina Preliminary Survey of Historic Places

DATE OF SURVEY: 1969       Federal       State       County       Local

DEPOSITORY FOR SURVEY RECORDS:  
South Carolina Department of Archives and History

STREET AND NUMBER:  
1430 Senate Street, P.O. Box 11,188, Capitol Station 29211

CITY OR TOWN: Columbia      STATE: South Carolina      CODE: 45

SEE INSTRUCTIONS

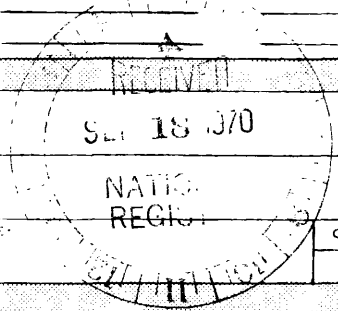

FOR NPS USE ONLY  
ENTRY NUMBER: 71.2.45.0010  
DATE: 3/24/71

7. DESCRIPTION

CONDITION

(Check One)

Excellent     Good     Fair     Deteriorated 18 370     Ruins     Unexposed

(Check One)

Altered     Unaltered NATL HIST PRES 1783     Moved     Original Site

DESCRIBE THE PRESENT AND ORIGINAL (if known) PHYSICAL APPEARANCE

Prior to its founding as a town in 1785 by Gen. Thomas Sumter, Stateburg was primarily the site of summer homes for Low Country people in the healthful "High Hills of the Santee." A few settlers also drifted there as early as 1735 via the nearby King's Highway (Charleston to Camden). Located on a hillcrest overlooking the Wateree Valley, Stateburg had its own courthouse, post office, taverns, academy, race track, and many stately homes. In the Civil War most of these were destroyed by Potter's Raiders, and Stateburg is now more an area than a town. Some buildings, at a distance from the public roads, were spared. Those in existence today include:

1. The Ruins--home of Mr. and Mrs. St. Julian Barnwell, owned by Gen. Thomas Sumter in 1784. From 1835-1837 served as Hawthorndean Seminary for Young Ladies. Original locks and keys, window panes, plaster moldings; marble base boards, large double sliding doors, fan-shaped skylight, many antiques and collectors' items.
2. Brookland Plantation--owned by Mr. and Mrs. William Dinkins, built late 1700s by Gen. Thomas Sumter. Used as rectory for Church of The Holy Cross in 1870s and as private school for boys. Architecture is modified Greek Revival.
3. Moorhill--home of Mr. and Mrs. Sherman Smith, built 1880 on site of much older house. One-and-a-half story white clapboard structure with four paneled columns across front portico.
4. Tomb of Revolutionary General Thomas Sumter--and the private Chapel of Ease built for his daughter-in-law, Natalie DeLage Sumter. Tomb remained unmarked 71 years until 1907 S. C. Legislature passed the appropriation for a simple monument. Now a S.C. State Historical Park.
5. The Borough House--home of Capt. and Mrs. Richard K. Anderson, descendants of first owners; built 1758. One of oldest homes in Sumter County. Architecturally interesting as largest complex of old buildings in U. S. built of pisé de terre (rammed earth), a Spanish and French type of construction. Center of house may once have been a tavern. Contains many rare books, portraits, and military mementos as well as fine furniture collected over seven generations. Grounds were site, in early 1900s, of first S. C. tree farm.
6. Millwood Plantation--home of Mr. and Mrs. W. Loring Lee, Jr., built 1840. Moved in sections from original site in town of Sumter. Now occupies land grant to family in 1780s; eighth generation living there. Original locks and keys, window panes, shutters, flooring, banister rails, many fine pieces of antique furniture. Pine clapboard construction, cottage-type architecture.
7. Holy Cross Episcopal Church--built 1850 to serve congregation founded 1770. Constructed of yellow pisé de terre (rammed earth). Gothic

SEE INSTRUCTIONS

**3. SIGNIFICANCE**

PERIOD (Check One or More as Appropriate)

- Pre-Columbian |  16th Century |  18th Century |  20th Century  
 15th Century |  17th Century |  19th Century

SPECIFIC DATE(S) (If Applicable and Known)

AREAS OF SIGNIFICANCE (Check One or More as Appropriate)

- |  |  |   |  |
|--|--|---|--|
| <input type="checkbox"/> Aboriginal              | <input checked="" type="checkbox"/> Education              | <input checked="" type="checkbox"/> Political | <input type="checkbox"/> Urban Planning  |
| <input type="checkbox"/> Prehistoric             | <input type="checkbox"/> Engineering                       | <input type="checkbox"/> Religion/Philosophy  | <input type="checkbox"/> Other (Specify) |
| <input checked="" type="checkbox"/> Historic     | <input type="checkbox"/> Industry                          | <input type="checkbox"/> Science              |  |
| <input checked="" type="checkbox"/> Agriculture  | <input type="checkbox"/> Invention                         | <input type="checkbox"/> Sculpture            |  |
| <input checked="" type="checkbox"/> Architecture | <input checked="" type="checkbox"/> Landscape Architecture | <input type="checkbox"/> Social/Humanitarian  |  |
| <input checked="" type="checkbox"/> Art          | <input checked="" type="checkbox"/> Literature             | <input type="checkbox"/> Theater              |  |
| <input type="checkbox"/> Commerce                | <input checked="" type="checkbox"/> Military               | <input type="checkbox"/> Transportation       |  |
| <input type="checkbox"/> Communications          | <input type="checkbox"/> Music                             |   |  |
| <input type="checkbox"/> Conservation            |  |   |  |

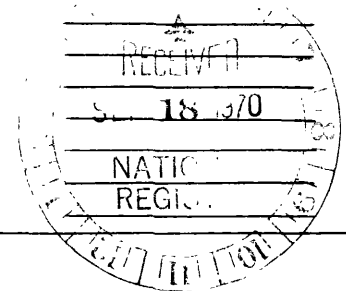

STATEMENT OF SIGNIFICANCE

Stateburg derives part of its historical significance from its connection with Revolutionary Gen. Thomas Sumter, who founded (1783) and named it in hopes that it would be chosen new state capital. It missed this distinction in 1786 by only a few votes. The town was also the site of much Revolutionary War activity--Sumter's home was destroyed by Col. Tarleton and both Generals Cornwallis and Greene camped in the Stateburg area. Although original plans to construct water transportation routes to facilitate trade with other parts of the state never materialized, Stateburg developed into an important South Carolina antebellum residential area. From 1783 to 1800 it was county seat for Claremont County, and until the Civil War, was a thriving town.

The area's most significant home, architecturally and historically, is the Borough House. Occupied by Generals Cornwallis and Greene during the Revolution, its grounds still display a fragment of the 400-year-old "Spy Oak" (destroyed by a 1969 storm) on which Gen. Sumter hanged two Tory spies. Built of buff pisé de terre (rammed earth), this house and its dependencies comprise the largest complex of old buildings of this material in the United States. On its grounds the state's first tree farm was established in the early 1900s.

Opposite Borough House stands the Episcopal Church of the Holy Cross, a notable example of Gothic Revival architecture, built in 1850 by Charleston architect E. C. Jones. Second church on the site, it replaced a frame church built there when Claremont parish was incorporated in 1788. Buried in its graveyard with his wife is Joel Poinsett, member and organizer of the S. C. Board of Public Works, U.S. congressman, minister to Mexico, secretary of war, and first president of the National Institute for the Promotion of Science (forerunner of the Smithsonian Institute). An opponent of Calhoun's "nullification policy," he is probably best remembered for bringing the poinsettia flower to this country from Mexico.

High Hills Baptist Church serves one of the oldest congregations of Baptists in South Carolina, organized 1770. Built in 1803, it exhibits distinctive Greek Revival architecture. Its first pastor was Richard Furman, ardent Revolutionary patriot and founder of Furman University, which, as a seminary, was located in Stateburg from 1828 to 1835.

The High Hills of the Santee in which Stateburg is located is one of the state's most famous and distinctive areas.

SEE INSTRUCTIONS

9. MAJOR BIBLIOGRAPHICAL REFERENCES

Gregorie, Anne, A History of Sumter County. Sumter, 1954.

Julien and Milling, Beneath So Kind a Sky. Columbia, 1958.

WPA, South Carolina: A Guide to the Palmetto State. New York, 1941.

10. GEOGRAPHICAL DATA

LATITUDE AND LONGITUDE COORDINATES DEFINING A RECTANGLE LOCATING THE PROPERTY				OR	LATITUDE AND LONGITUDE COORDINATES DEFINING THE CENTER POINT OF A PROPERTY OF LESS THAN TEN ACRES				
CORNER	LATITUDE		LONGITUDE		LATITUDE		LONGITUDE		
	Degrees	Minutes	Seconds	Degrees	Minutes	Seconds	Degrees	Minutes	Seconds
NW	33	59	37.6	80	32	30			
NE	33	59	37.6	80	29	21.4			
SE	33	56	42.9	80	29	21.4			
SW	33	56	42.9	80	32	30			

APPROXIMATE ACREAGE OF NOMINATED PROPERTY: 5066 acres

LIST ALL STATES AND COUNTIES FOR PROPERTIES OVERLAPPING STATE OR COUNTY BOUNDARIES

STATE:	CODE	COUNTY	CODE

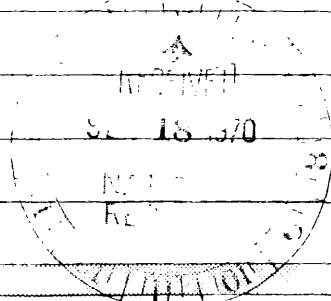

11. FORM PREPARED BY

NAME AND TITLE:  
Mary Schuette, Historic Resources Division

ORGANIZATION: South Carolina Dept. of Archives and History  
DATE: August 29, 1970

STREET AND NUMBER:  
1430 Senate Street, PO Box 11,188, Capitol Station 29211

CITY OR TOWN: Columbia  
STATE: South Carolina  
CODE: 45

12. STATE LIAISON OFFICER CERTIFICATION

As the designated State Liaison Officer for the National Historic Preservation Act of 1966 (Public Law 89-665), I hereby nominate this property for inclusion in the National Register and certify that it has been evaluated according to the criteria and procedures set forth by the National Park Service. The recommended level of significance of this nomination is:

National  State  Local

Name Charles Lee

Title Director, S.C. Dept. of Archives and History

Date August 29, 1970

I hereby certify that this property is included in the National Register.

Ernest A. Connally  
Chief, Office of Archeology and Historic Preservation  
FEB 24 1971

Date \_\_\_\_\_

ATTEST:

William J. Trusty  
Keeper of The National Register

Date DEC 17 1970

SEE INSTRUCTIONS

NATIONAL REGISTER OF HISTORIC PLACES  
INVENTORY - NOMINATION FORM

(Continuation Sheet)

STATE South Carolina	
COUNTY Sumter	
FOR NPS USE ONLY	
ENTRY NUMBER	DATE
71-245,0010	2/

(Number all entries)

7. Description

Revival design, cruciform plan, corner towers, pointed arches, red tiled roof--like Old World parish church. Inside: tiled floors, handcarved walnut woodwork, stained glass windows.

8. High Hills Baptist Church--Congregation founded 1770; built 1803. Greek Revival architecture with four paneled columns across front, engaged columns at front corners. White clapboard with gable roof; four bays deep.

9. Marston--home of Mr. and Mrs. S. O. Plowden, built c. 1820. Impressive brick and frame structure, unusually high ceilings, broad central hallways, spacious rooms, encircling piazzas on ground and second levels. Many fine pre-Revolutionary pieces of furniture and heirlooms. Upper-piazza view extends 30 miles.

10. Edgehill--home of Maj. and Mrs. Alfred DeLorme rebuilt after 1965 fire on original foundations; authentic replica of old house, The Oaks, built 1832. Four original massive columns at front of present pink brick structure. Many valuable pieces of furniture lost in fire have been replaced or reproduced.

11. Miller or Ellison House--home of Miss Martha White, built c. 1816. Owned by S. C. Governor and U. S. Senator Stephen Miller in early 19th century; acquired 1838 by William Ellison, free Negro who operated cotton gin factory and plantation with 40 or 50 slaves. House has hand-wrought hinges, handmade nails, wainscoting of wide single boards, small window panes, narrow central hall.

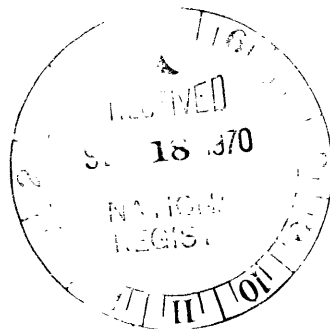

**NATIONAL REGISTER OF HISTORIC PLACES  
INVENTORY - NOMINATION FORM**

(Continuation Sheet)

STATE	
South Carolina	
COUNTY	
Sumter	
FOR NPS USE ONLY	
ENTRY NUMBER	DATE
71.2.45.0010	2/24/71

(Number all entries)

8. Significance

A few miles outside Stateburg town limits lies the grave of Gen. Thomas Sumter (1734-1832), famed partisan general known as the "Gamecock of the Revolution." Near his grave stands the small Chapel of Ease built for his daughter-in-law, Countess Natalie DeLage (Sumter). A Catholic emigrée from the French Revolution and a protégée of Aaron Burr, she is buried beneath the chapel.

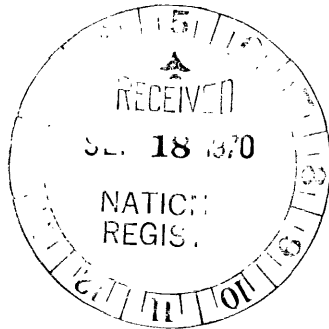

NE 33° 59' 37.6"  
80° 29' 21.4"

SE 33° 56' 42.9"  
80° 29' 21.4"

NW 33° 59' 37.6"  
80° 29' 21.4"

SW 33° 59' 37.6"  
80° 29' 21.4"

Stateburg  
5066 acres

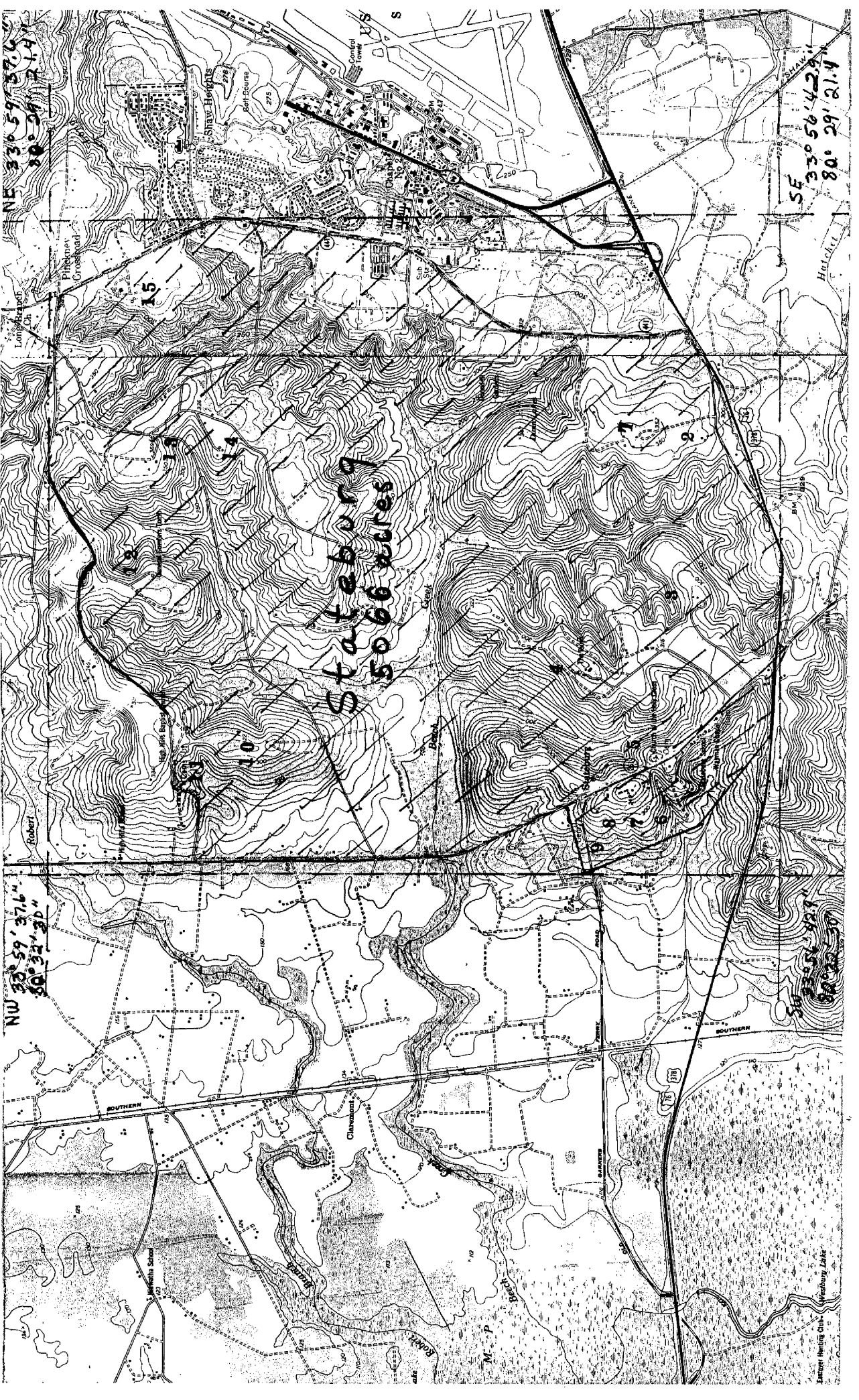

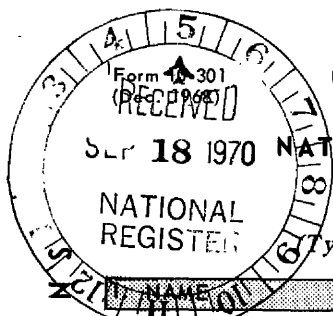

UNITED STATES DEPARTMENT OF THE INTERIOR  
NATIONAL PARK SERVICE

Slr 18 1970 NATIONAL REGISTER OF HISTORIC PLACES

PROPERTY MAP FORM

Type all entries - attach to or enclose with map)

STATE
South Carolina
COUNTY
Sumter
FOR NPS USE ONLY

ENTRY NUMBER	DATE
--------------	------

71.245.0010 2/24/71

SEE INSTRUCTIONS

NAME
------

COMMON: Stateburg
AND/OR HISTORIC:

2. LOCATION

STREET AND NUMBER:
Located in the one mile north of U.S. Hwy. 76 & 378 "High Hills of the Santee", between Sumter and Columbia

CITY OR TOWN:
on S.C. Hwy. 261, 12 miles from Sumter.

STATE:	CODE	COUNTY:	CODE
South Carolina	41	Sumter	435

3. MAP REFERENCE

SOURCE:	
U.S. Geological Survey, Topographic, 7.5" series, Wedgefield and Sumter West	
SCALE: 1:24000	Quadrangles
DATE: 1953, 1957	

4. REQUIREMENTS

TO BE INCLUDED ON ALL MAPS	KEY TO HOUSE LOCATION NUMBERS:
1. Property boundaries where required.	1. Farmhill
2. North arrow.	2. The Parsonage
3. Latitude and longitude reference.	3. Brookland (see continuation sheet)



NATIONAL REGISTER OF HISTORIC PLACES  
INVENTORY - NOMINATION FORM

(Continuation Sheet)

STATE South Carolina	
COUNTY Sumter	
FOR NPS USE ONLY	
ENTRY NUMBER 71.2.45.0010	DATE 2/24/71

(Number all entries)

PROPERTY MAP FORM CONTINUATION -2-  
STATEBURG HISTORIC DISTRICT

4. The Ruins (see picture)
5. The Church of the Holy Cross (see picture)
6. Borough House (see picture)
7. Maverick House
8. Stephen D. Miller House
9. Ellison Family Cemetery
10. Moorhill
11. High Hills Baptist Church (see picture)
12. General Sumter's Tomb (see picture)
13. Marsdon
14. Edgehill
15. Oakland

