

11. WILLIAM C. JONES HOUSE
507 Mesopotamia Street

Mr. and Mrs. William H. Tuck
507 Mesopotamia St.
Eutaw, AL 35462

Lot 86 Tax Map 35-18-08-33-1-7-3

2 acres (189' Mesopotamia x 333')

Latitude: 32° 50' 33"

Longitude: 87° 53' 39"

between 1840-1845 construction

Architect/Builder unknown

SIGNIFICANCE: This is the more intact of only two examples of fully raised cottages - in which the ground floor is largely above ground and is subservient to the upper floor. Although some minor alterations to the facade make the house look somewhat more contemporary (the paired windows) these features are easily repaired.

DESCRIPTION: This building was of elementary plan. It had a basement story at ground level and first floor above, each with a center hall and two rooms about 21 feet square. A two piered portico preceded the doorway with transom and sidelights and triple windows lighted the rooms to either side. Chimneys were inside the end walls, which would have been crowned with pediments, and probably an open gallery ran across the back. There was no inside connection between the two levels though possible there was a stairs on the rear gallery. The basement ceiling height is 7 feet 3 inches, and that upstairs about 12 feet.

The mantel in the west basement room is the most elaborate in the house, having pilasters with molded shafts, imposts, a breakfront center block in the frieze, and sunken panels between the three advanced sections. The mantel directly above is similar except for a plain entablature over the pilasters. That in the east upper room has full round colonnette supports to a plain entablature. There was chairrailing in the upstairs interiors, and paneled aprons under the windows. Door paneling matched that of the frontispiece, though with two panels, side by side at the bottom, adaptable to the wider single unit. Enframements of both kinds of openings had plinths of baseboard height and blocks at the upper corners.

REMODELING: Some of the architectural dress (such as the corner pilasters and end pediments) and the front steps have been removed; the upper triple windows have been exchanged for double lights, and changes made at the back of the house.

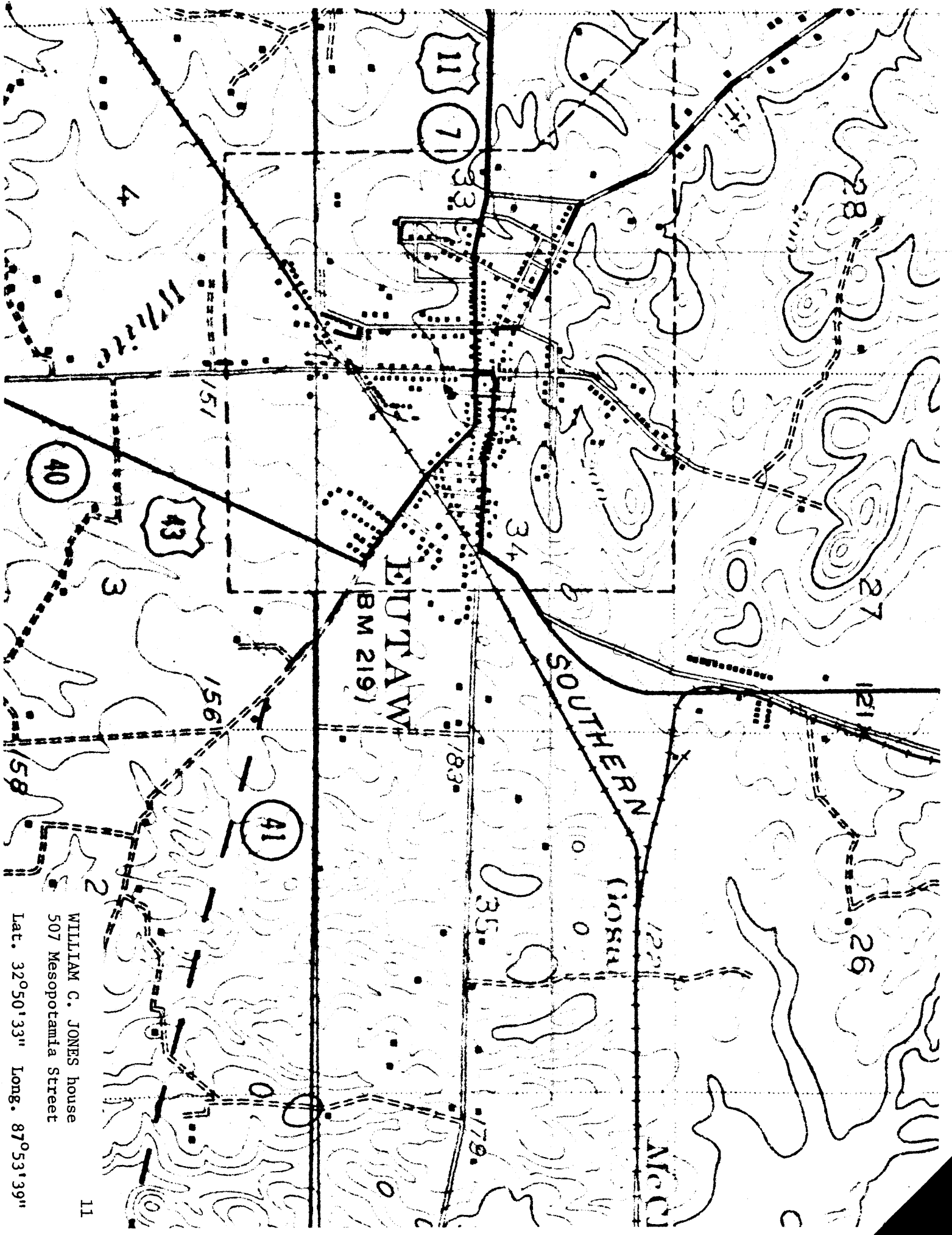

BUJAW
(BM 219)

SOUTHERN

MCC

WILLIAM C. JONES house
507 Mesopotamia Street

Lat. 32°50'33" Long. 87°53'39"