

YULEE SUGAR MILL RUINS

Fla. 480, Old Homosassa
Citrus County

Standing on what once was part of a 3200-acre plantation belonging to David Levy Yulee, (1810-1886) Florida's first United States Senator, the ruins of the Yulee sugar mill are all that remain of this early Florida promoter's enterprises in this part of the State.

Much of the machinery of the mill is still intact, though the place was burned near the end of the Civil War, less than 20 years after its construction in 1851.

Yulee was active in many phases of the expansion of the new State of Florida, and owned railroad interests as well as plantations.

At the beginning of the Civil War, Yulee and his family were living at Fernandina, but his wife and children were sent to his Homosassa property near the Gulf for safety. He joined them when Fernandina was captured by the Federals, but later, while the family was visiting away from the plantation, the Federals ascended the Homosassa River, and that place was burned. The Yulees then moved to a cotton plantation near Archer, and the Homosassa property was never rebuilt.

I hereby certify that this property is included in the National Register.

Ernest Allen Connally
Chief, Office of Archeology and Historic Preservation

AUG 12 1970

Date _____

ATTEST:

William G. Hunter
Keeper of The National Register

Date **JUL 6 1970**

PH0022161

NATIONAL REGISTER OF HISTORIC PLACES
INVENTORY - NOMINATION FORM

(Type all entries - complete applicable sections)

STATE: Florida	
COUNTY: Citrus	
FOR NPS USE ONLY	
ENTRY NUMBER 70-8-09-0005	DATE 8/12/70

1. NAME

COMMON:
Yulee Sugar Mill ~~Historic Memorial~~ *Remains*

AND/OR HISTORIC:

2. LOCATION

STREET AND NUMBER:
State Road 490, west of U.S. 19

CITY OR TOWN:
Homosassa

STATE Florida	CODE 12	COUNTY: Citrus	CODE 017
------------------	------------	-------------------	-------------

3. CLASSIFICATION

CATEGORY (Check One)	OWNERSHIP	STATUS	ACCESSIBLE TO THE PUBLIC
<input type="checkbox"/> District <input type="checkbox"/> Building <input type="checkbox"/> Site <input checked="" type="checkbox"/> Structure <input type="checkbox"/> Object	<input checked="" type="checkbox"/> Public <input type="checkbox"/> Private <input type="checkbox"/> Both	Public Acquisition: <input type="checkbox"/> In Process <input type="checkbox"/> Being Considered	<input type="checkbox"/> Occupied <input checked="" type="checkbox"/> Unoccupied <input type="checkbox"/> Preservation work in progress
PRESENT USE (Check One or More as Appropriate)			
<input type="checkbox"/> Agricultural <input type="checkbox"/> Commercial <input type="checkbox"/> Educational <input type="checkbox"/> Entertainment	<input type="checkbox"/> Government <input type="checkbox"/> Industrial <input type="checkbox"/> Military <input type="checkbox"/> Museum	<input checked="" type="checkbox"/> Park <input type="checkbox"/> Private Residence <input type="checkbox"/> Religious <input type="checkbox"/> Scientific	<input type="checkbox"/> Transportation <input type="checkbox"/> Other (Specify) _____ <input type="checkbox"/> Comments _____

4. OWNER OF PROPERTY

OWNER'S NAME:
Division of Recreation and Parks
Department of Natural Resources

STREET AND NUMBER:
Larson Building

CITY OR TOWN:
Tallahassee

STATE: Florida	CODE 12
-------------------	------------

5. LOCATION OF LEGAL DESCRIPTION

COURTHOUSE, REGISTRY OF DEEDS, ETC.:
Trustees of the Internal Improvement Fund

STREET AND NUMBER:
Elliott Building

CITY OR TOWN:
Tallahassee

STATE: Florida	CODE 12
-------------------	------------

6. REPRESENTATION IN EXISTING SURVEYS

TITLE OF SURVEY:
Florida Historic Sites Survey 1940

DATE OF SURVEY: 1940 Federal State County Local

DEPOSITORY FOR SURVEY RECORDS:
Division of Archives, History and Records Management

STREET AND NUMBER:
Department of State, The Capitol

CITY OR TOWN:
Tallahassee

STATE: Florida	CODE 12
-------------------	------------

SEE INSTRUCTIONS

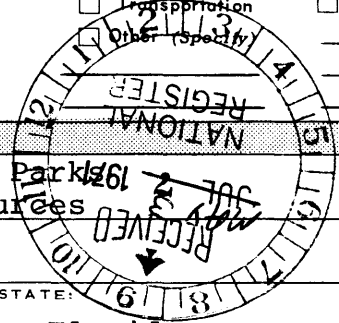

FOR NPS USE ONLY
ENTRY NUMBER: 70-8-09-0005
DATE: 8/12/70

7. DESCRIPTION

CONDITION	(Check One)					
	<input type="checkbox"/> Excellent	<input type="checkbox"/> Good	<input type="checkbox"/> Fair	<input type="checkbox"/> Deteriorated	<input checked="" type="checkbox"/> Ruins	<input type="checkbox"/> Unexposed
	(Check One)			(Check One)		
	<input checked="" type="checkbox"/> Altered	<input type="checkbox"/> Unaltered		<input type="checkbox"/> Moved	<input checked="" type="checkbox"/> Original Site	

DESCRIBE THE PRESENT AND ORIGINAL (if known) PHYSICAL APPEARANCE

Yulee Sugar Mill Historic Memorial is located at Old Homosassa on Florida 90, west of U.S. 19. The area is covered by a stand of live oak and sable palm. It is likely that this growth has achieved its maturity since the sugar mill ceased to be productive in the mid 1860's.

The 35 foot long iron boiler with firebox beneath was encased in limestone, like that of the adjoining smokestack. The smokestack, or chimney, is approximately nine feet square at the base, made of the same limestone rock, and reaches a height of approximately 30 feet with some tapering towards the top. In the chimney, six small holes (approximately eight inches in diameter) puncture the four sides. Through these holes passed the suspension system for the dampers, which regulated the intensity of the heat by controlling the amount of air allowed to pass up the chimney.

The original platforms on which the steam engine and associated cane crushing machinery set have disappeared. It is surmised that they were carted off to be used as building materials by residents of the area. Fortunately, most of the machinery was too heavy to suffer a similar fate. The reconstruction of these platforms and reassembling of the machinery was supervised by Vincent Havens, Ranger for the Division of Recreation and Parks. This was done after a careful analysis of the operation of similar steam-powered mechanisms and a thorough examination of the former foundations. The name of the manufacturer, Stillman-Allen and Company, Novelty Iron Works, New York, is readily seen in raised letters on the boiler, steam engine and stamped into the kettles. Three of the five original kettles and the wells used to provide water for the boiler are also present. Provided with a brief history, each visitor conducts himself on a tour around the sugar mill. Interpretive signs explain the entire process by which raw cane from the field was manufactured into sugar.

SEE INSTRUCTIONS

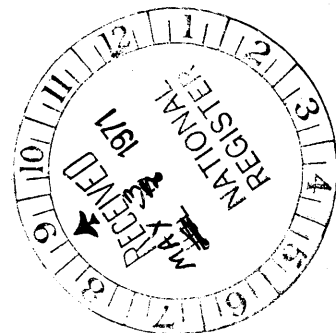

8. SIGNIFICANCE

PERIOD (Check One or More as Appropriate)

- Pre-Columbian; 16th Century 18th Century 20th Century
 15th Century 17th Century 19th Century

SPECIFIC DATE(S) (If Applicable and Known)

AREAS OF SIGNIFICANCE (Check One or More as Appropriate)

- | | | | |
|---|---|--|---|
| <input type="checkbox"/> Aboriginal | <input type="checkbox"/> Education | <input type="checkbox"/> Political | <input type="checkbox"/> Urban Planning |
| <input type="checkbox"/> Prehistoric | <input type="checkbox"/> Engineering | <input type="checkbox"/> Religion/Philosophy | <input checked="" type="checkbox"/> Other (Specify) |
| <input type="checkbox"/> Historic | <input checked="" type="checkbox"/> Industry | <input type="checkbox"/> Science | |
| <input checked="" type="checkbox"/> Agriculture | <input type="checkbox"/> Invention | <input type="checkbox"/> Sculpture | |
| <input type="checkbox"/> Architecture | <input type="checkbox"/> Landscape Architecture | <input type="checkbox"/> Social/Humanitarian | |
| <input type="checkbox"/> Art | <input type="checkbox"/> Literature | <input type="checkbox"/> Theater | |
| <input checked="" type="checkbox"/> Commerce | <input checked="" type="checkbox"/> Military | <input type="checkbox"/> Transportation | |
| <input type="checkbox"/> Communications | <input type="checkbox"/> Music | | |
| <input type="checkbox"/> Conservation | | | |

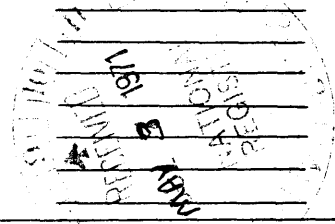

STATEMENT OF SIGNIFICANCE

SEE INSTRUCTIONS

Yulee Sugar Mill Historic Memorial was once part of a thriving sugar plantation owned by one of Florida's most outstanding historic figures, David Levy Yulee. Yulee was born to Moses Elias and Hanna Levy on June 12, 1810, on the island of St. Thomas in the British West Indies (now the Virgin Islands). In 1819, they sent their son, David, to Virginia to pursue his education. His father, Moses, came to Florida settling near Micanopy. Moses retained the name Levy, but David resumed the family name of Yulee just before he married the beautiful daughter of Governor Charles Wickliff of Kentucky. He was to name his property at Homosassa "Margarita" (Spanish for pearl) in honor of his wife, saying that she was a pearl among women.

David Levy Yulee was a member of the First Constitutional Convention at St. Joseph in 1839, and in 1841 was elected territorial delegate to the U.S. Congress. He was Florida's first United States Senator when the territory became the 27th state of the Union in 1845. In approximately 1851, "Margarita," his 5,100 acre plantation on the Homosassa River, became productive. In that year, machinery was bought from the New York firm of Stillman-Allen and Company, Novelty Iron Works. After being transported to Florida by a sailing vessel, it was laborously moved inland to be assembled at its present location. Yulee's plantation was to continue as a productive operation for only 13 years.

In January of 1861, when Florida seceded from the Union, Yulee and his family moved back to Florida from Washington to share the fate of their state. Federal vessels of the blockading squadrons were stationed off the mouth of the Homosassa River. This did not prevent the Yulee plantation from supplying much needed sugar, syrup and fruit out through canals near the mouth of the river to sustain the Southern troops. While the family was on a trip to the interior, a Federal force came up the Homosassa River and burned the Yulee Mansion on Tigertail Island on May 28, 1864. The mill, which was a considerable distance inland, escaped a similar fate. After the war, Yulee returned to live in Washington, D. C.

9. MAJOR BIBLIOGRAPHICAL REFERENCES

Cash, William T. The Story of Florida. New York: The American Historical Society, 1938.
 Griffin, John W. "Report on the Yulee Sugar Mill, Homosassa, Fla., December 23, 1952." Manuscript on file Division of Archives.
 Personal interview (April 7, 1971) with Vincent Havens, Ranger, supervised the reconstruction of segments of Yulee Sugar Mill.
 Rerick, Rowland H. Memoirs of Florida. Vol. 1, Atlanta. The Southern Historical Association, 1902.
 U.S. Congress. Official Records of the Union and Confederate Navies in War of the Rebellion, Vol. 17, East Gulf Blockading Squadron.

10. GEOGRAPHICAL DATA Washington: Government Printing Office, 1903.

LATITUDE AND LONGITUDE COORDINATES DEFINING A RECTANGLE LOCATING THE PROPERTY			O R	LATITUDE AND LONGITUDE COORDINATES DEFINING THE CENTER POINT OF A PROPERTY OF LESS THAN TEN ACRES		
CORNER	LATITUDE	LONGITUDE		LATITUDE	LONGITUDE	
	Degrees Minutes Seconds	Degrees Minutes Seconds		Degrees Minutes Seconds	Degrees Minutes Seconds	
NW	° ' "	° ' "		28° 47' 01"	82° 36' 28"	
NE	° ' "	° ' "				
SE	° ' "	° ' "				
SW	° ' "	° ' "				

APPROXIMATE ACREAGE OF NOMINATED PROPERTY: Six acres

LIST ALL STATES AND COUNTIES FOR PROPERTIES OVERLAPPING STATE OR COUNTY BOUNDARIES

STATE:	CODE	COUNTY:	CODE

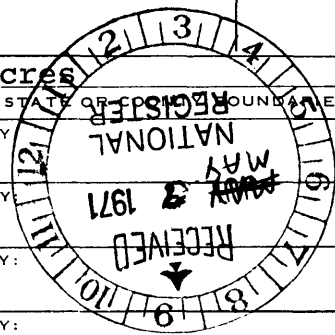

11. FORM PREPARED BY

NAME AND TITLE:
Randy F. Nimnicht, Historic Preservationist

ORGANIZATION: Division of Archives, History and Records Mgt. DATE: 4/14/71

STREET AND NUMBER:
Department of State, The Capitol

CITY OR TOWN: Tallahassee STATE: Florida CODE: 12

12. STATE LIAISON OFFICER CERTIFICATION

NATIONAL REGISTER VERIFICATION

As the designated State Liaison Officer for the National Historic Preservation Act of 1966 (Public Law 89-665), I hereby nominate this property for inclusion in the National Register and certify that it has been evaluated according to the criteria and procedures set forth by the National Park Service. The recommended level of significance of this nomination is:

National State Local

Name: [Signature]

Title: State Liaison Officer

Date: April 29, 1971

I hereby certify that this property is included in the National Register.

[Signature]
 Chief, Office of Archeology and Historic Preservation

SEP 10 1971

Date: _____

ATTEST:

[Signature]
 Keeper of The National Register

Date: AUG 17 1971

SEE INSTRUCTIONS

Form 10-301
(July 1969)

UNITED STATES DEPARTMENT OF THE INTERIOR
NATIONAL PARK SERVICE

NATIONAL REGISTER OF HISTORIC PLACES
PROPERTY MAP FORM

(Type all entries - attach to or enclose with map)

STATE Florida	
COUNTY Citrus	
FOR NPS USE ONLY	
ENTRY NUMBER 70-8-09-0005	DATE 8/12/70

SEE INSTRUCTIONS

1. NAME

COMMON: Yulee Sugar Mill Historic Memorial
AND/OR HISTORIC:

2. LOCATION

STREET AND NUMBER:

State Road 90, west of U.S. 19

CITY OR TOWN:

Homosassa

STATE:

Florida

CODE

12

COUNTY:

Citrus

CODE

017

3. MAP REFERENCE

SOURCE:

U.S. Coast & Geodetic Survey, Homosassa Quadrangle 7.5 min. series

SCALE: 1:24000

DATE: 1954

4. REQUIREMENTS

TO BE INCLUDED ON ALL MAPS

1. Property boundaries where required.
2. North arrow.
3. Latitude and longitude reference.

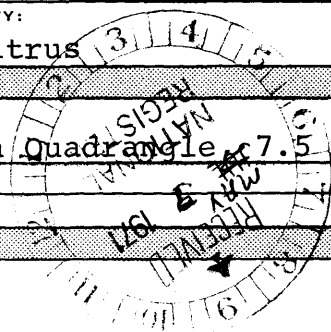

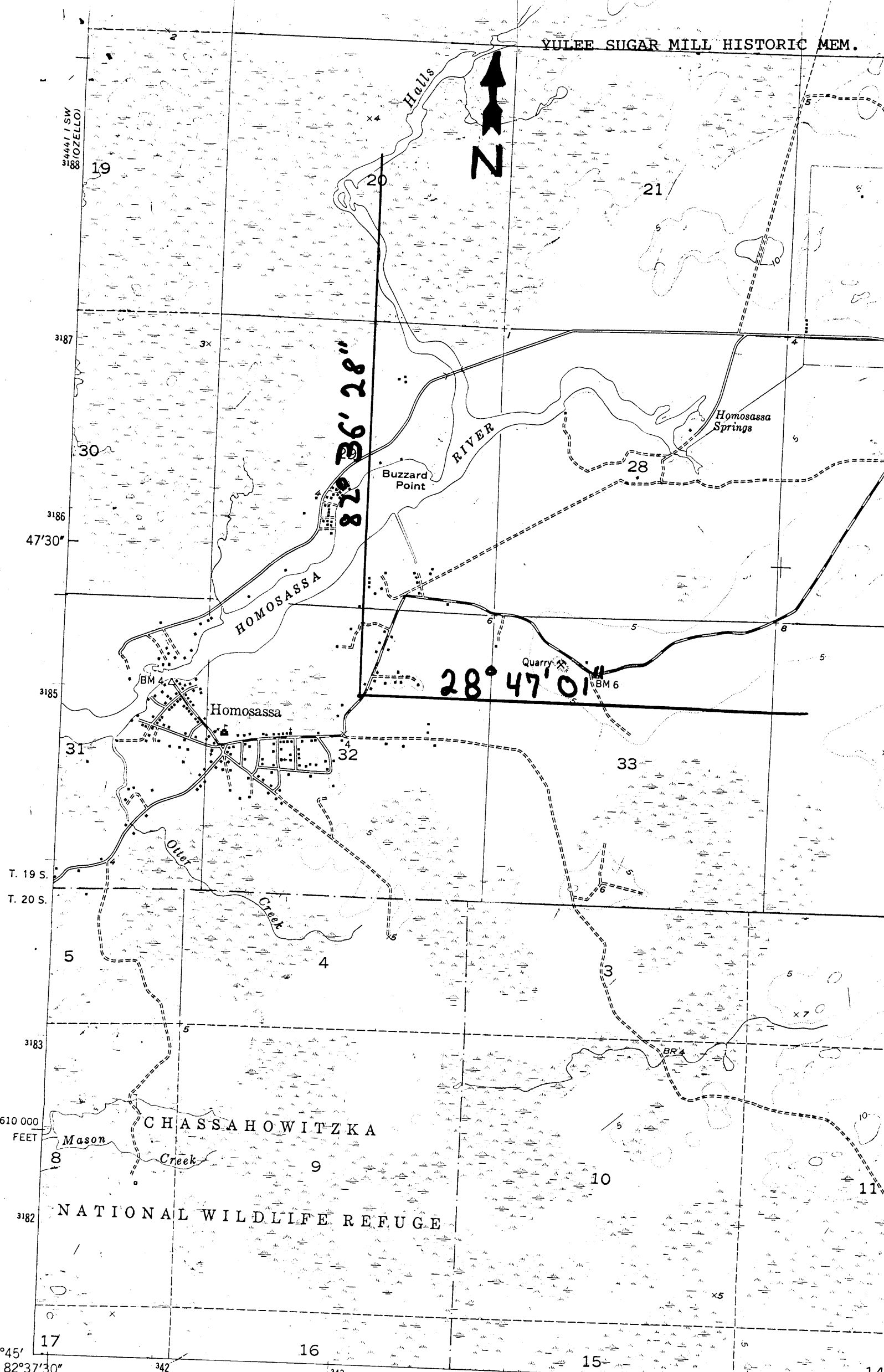

82° 36' 28"

28° 47' 01"



Mapped, edited, and published by the Geological Survey

Control by USGS and USC&GS

Topography from aerial photographs by Kelsh plotter and by plane-table surveys 1953-1954. Aerial photographs taken 1951

