

**NATIONAL REGISTER OF HISTORIC PLACES
INVENTORY - NOMINATION FORM**

(Type all entries - complete applicable sections)

STATE: Minnesota
COUNTY: Morrison
FOR NPS USE ONLY
ENTRY DATE

DEC 4 1974

1. NAME

COMMON: **Old McDougall Farm** *is a*

AND/OR HISTORIC: **William Warren Two Rivers Cabin Site and McDougall Homestead**

2. LOCATION

STREET AND NUMBER: **On County Road 23, 2 miles west-northwest of Royalton, Minn.**

CITY OR TOWN: **Royalton Minn. Belleview Township**

CONGRESSIONAL DISTRICT: **7th**

STATE: **Minnesota** CODE: **22** COUNTY: **Morrison** CODE: **097**

3. CLASSIFICATION

CATEGORY (Check One)	OWNERSHIP	STATUS	ACCESSIBLE TO THE PUBLIC
<input type="checkbox"/> District <input checked="" type="checkbox"/> Site <input type="checkbox"/> Object <input checked="" type="checkbox"/> Buildings <input type="checkbox"/> Structure <input type="checkbox"/> Object	<input type="checkbox"/> Public <input checked="" type="checkbox"/> Private <input type="checkbox"/> Both	<input type="checkbox"/> Occupied <input checked="" type="checkbox"/> Unoccupied <input type="checkbox"/> Preservation work in progress	Yes: <input type="checkbox"/> Restricted <input type="checkbox"/> Unrestricted <input checked="" type="checkbox"/> No

PRESENT USE (Check One or More as Appropriate)

<input type="checkbox"/> Agricultural	<input type="checkbox"/> Government	<input type="checkbox"/> Park	<input type="checkbox"/> Transportation	<input checked="" type="checkbox"/> Comments to be privately acquired for Nature Conservation
<input type="checkbox"/> Commercial	<input type="checkbox"/> Industrial	<input checked="" type="checkbox"/> Private Residence	<input type="checkbox"/> Other (Specify)	
<input type="checkbox"/> Educational	<input type="checkbox"/> Military	<input type="checkbox"/> Religious		
<input type="checkbox"/> Entertainment	<input type="checkbox"/> Museum	<input type="checkbox"/> Scientific		

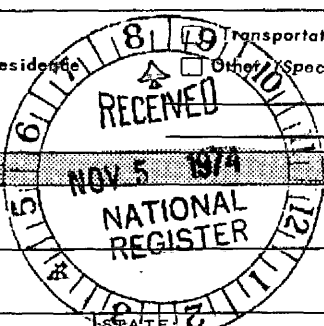

4. OWNER OF PROPERTY

OWNER'S NAME: **Clement Dufrene**

STREET AND NUMBER: **6352 70th Street South**

CITY OR TOWN: **Cottage Grove** STATE: **Minnesota** CODE: **22**

5. LOCATION OF LEGAL DESCRIPTION

COURTHOUSE, REGISTRY OF DEEDS, ETC.: **Morrison County Courthouse**

STREET AND NUMBER:

CITY OR TOWN: **Little Falls** STATE: **Minnesota** CODE: **22**

6. REPRESENTATION IN EXISTING SURVEYS

TITLE OF SURVEY: **Historic Sites Archaeological Survey**

DATE OF SURVEY: **1972** Federal State County Local

DEPOSITORY FOR SURVEY RECORDS: **Archaeology Department - Minnesota Historical Society**

STREET AND NUMBER: **Building 27, Fort Snelling**

CITY OR TOWN: **St. Paul** STATE: **Minnesota** CODE: **22**

SEE INSTRUCTIONS

STATE: **Minnesota**

COUNTY: **Morrison**

ENTRY NUMBER: **DEC 4 1974**

DATE: **DEC 4 1974**

FOR NPS USE ONLY

7. DESCRIPTION

CONDITION	to (Check One)					
	<input checked="" type="checkbox"/> Excellent	<input type="checkbox"/> Good	<input checked="" type="checkbox"/> Fair	<input type="checkbox"/> Deteriorated	<input type="checkbox"/> Ruins	<input type="checkbox"/> Unexposed
	(Check One)			(Check One)		
	<input checked="" type="checkbox"/> Altered	<input type="checkbox"/> Unaltered	<input type="checkbox"/> Moved	<input checked="" type="checkbox"/> Original Site		

DESCRIBE THE PRESENT AND ORIGINAL (if known) PHYSICAL APPEARANCE

The William Warren Two Rivers Cabin Site and McDougall Homestead is a small farmstead comprised of a farmhouse, four-bay barn with attached granary and dairy shed, blacksmith shop, machine shed, corn crib and three cellar depressions.

The site is an area approximately one hundred yards long, north to south, and seventy yards wide, west to east. The area is bordered on the east by a wire fence, on the north by a small grove of trees, on the west by an embankment which drops away from the buildings, and on the south by a row of trees and hedges. The land terrain surrounding the buildings is relatively level, being situated on an alluvial plain overlooking the Mississippi River less than a quarter mile to the west.

All buildings are of frame construction with field stone foundations ranging in fair to good structural condition. The construction dates range in age from the oldest (1874) for the barn to early twentieth century for such structures as the shed addition to the barn; most of the buildings, however, date prior to 1900.

The farmhouse, the northernmost structure in the complex, is a large two story simple gable structure with a symmetrical facade. It is devoid of any ornamentation. The style is venacular, but more visually akin to rural farmhouses in either the eastern United States or Canada than midwestern America. A summer kitchen and wood shed are attached to the side of the house in a single story low gable wing. The house is located in a small grove of oak and fir trees, and appears to be unchanged since its construction in the late 1870's.

The original blacksmith shop is the first building in a row of three structures to the south of the farmhouse. It is a simple gable structure with original windows and chimney. The original door, however, has been replaced with a modern garage door to suit its present use. Between the blacksmith shop and the machine shed to the south and a few feet to the west is the site of the James McDougall cabin and first Two Rivers post office. A slight cellar depression is still discernable.

The machine shed was designed in the English barn style with three original doors still remaining; the last set having been replaced by a sliding door. A distinctive feature of the doors is the eastern characteristic of truncated corners at the upper hinged corner.

The corn crib is also somewhat unusual for its shed-like appearance and sliding doors. All of the three out buildings were constructed in the late nineteenth century.

The last building is the four-bay English style barn. Constructed in the mortise-and-tenon fashion, its hundred year old condition is excellent with only two noticeable signs of any structural deterioration. The building further shows excellent carpentry characteristics in its pegged joinery and hand hewn timbers. The two center bays were designed as the hub of the grain harvesting activity with the north center bay operating as the drive-through for wagons and the south center bay containing a rectangular threshing floor. Each end bay is bi-level with the first floor containing stalls for cattle or oxen and the second level functioning as a hay loft. A one story

SEE INSTRUCTIONS

SIGNIFICANCE

PERIOD (Check One or More as Appropriate)

- Pre-Columbian | 16th Century | 18th Century | 20th Century
 15th Century | 17th Century | 19th Century

SPECIFIC DATE(S) (If Applicable and Known) **1847-1900**

AREAS OF SIGNIFICANCE (Check One or More as Appropriate)

- | | | | |
|--|---|---|---|
| <input type="checkbox"/> Aboriginal | <input type="checkbox"/> Education | <input checked="" type="checkbox"/> Political | <input type="checkbox"/> Urban Planning |
| <input type="checkbox"/> Prehistoric | <input type="checkbox"/> Engineering | <input type="checkbox"/> Religion/Philosophy | <input checked="" type="checkbox"/> Other (Specify) |
| <input checked="" type="checkbox"/> Historic | <input type="checkbox"/> Industry | <input type="checkbox"/> Science | <u>Immigration and Settlement</u> |
| <input checked="" type="checkbox"/> Agriculture | <input type="checkbox"/> Invention | <input type="checkbox"/> Sculpture | _____ |
| <input checked="" type="checkbox"/> Architecture | <input type="checkbox"/> Landscape Architecture | <input type="checkbox"/> Social/Humanitarian | _____ |
| <input type="checkbox"/> Art | <input checked="" type="checkbox"/> Literature | <input type="checkbox"/> Theater | _____ |
| <input type="checkbox"/> Commerce | <input type="checkbox"/> Military | <input type="checkbox"/> Transportation | _____ |
| <input type="checkbox"/> Communications | <input type="checkbox"/> Music | | _____ |
| <input type="checkbox"/> Conservation | | | _____ |

STATEMENT OF SIGNIFICANCE

William Whipple Warren came to the area then known as "Two Rivers" in 1847 after serving as Indian interpreter in other portions of the Minnesota Territory. Born on the Apostle Islands on Lake Superior in what is now Wisconsin, he was the member of a family steeped in American history, dating back to Revolutionary War times. Both his father and uncle were traders with the American Fur Company and his family was well known to other established frontier figures during the first half of the nineteenth century.

Soon after coming to "Two Rivers", Warren erected a cabin and trading post on the Pembina Ox Cart Trail, the major fur trade route connecting commerce on the Red River of the north, and the head of navigation on the Mississippi River at Saint Paul. This route was the backbone of overland commerce in the territory and it was logical for Warren to locate his trading post along it. The site location was proximate to the fur post at Swan River, six miles north which was the home of another prominent trader and also Warren's father-in-law, William Aitkin. As Aitkin had come to the area in 1848, these two men are considered to be among the very first white settlers to this area.

Elected to the territorial legislature in 1850, Warren, while at the capitol in Saint Paul, met Col. Daniel A. Robertson. He, also being a representative, was the founder of the second newspaper in the territory, the Minnesota Democrat, which was the political voice of the controlling party in Minnesota. Their meeting and consequent friendship was to be the catalyst for the creation of Warren's most significant historical contribution, his writing of the History of the Ojibways based upon Traditions and Oral Statements. This was the first attempt to record such information regarding the Ojibway or Chippewa Indian and it came about from strong encouragement by Robertson due to Warren's extensive knowledge and exceedingly friendly relations with these people. Warren started his writings almost immediately at his Two Rivers cabin site, publishing a short history of the Ojibway in the Minnesota Democrat in 1851. His death in Saint Paul on June 1, 1853, while returning from an unsuccessful trip to a New York publisher, is commonly attributed to the long exhaustive hours spent on the completion of the manuscript. He was only twenty-eight years of age at his death. His manuscript was eventually published in 1885 by the Minnesota Historical Society. It is now known that Warren wrote and completed the history at his residence at Two Rivers, utilizing not only his own experiences but also information obtained from many Ojibway friends, some of whom traveled long distances to help in the writing.

SEE INSTRUCTIONS

9. MAJOR BIBLIOGRAPHICAL REFERENCES

The Land Called Morrison, Harold L. Fischer, Volkmuth Printing Company, St. Cloud, Minn., 1972

U.S. Government Survey Notes of 1852, State Attorney General's Office Minnesota Democrat, St. Paul, March 17, 1852, p.3

History of Morrison and Todd Counties, Minn., Clara K. Fuller, B.F. Bowen and Co., Indianapolis, Ind., 1915, p. 621

Historical Sketches of Royalton and Vicinity, Frank B. Logan, June 14, 1930

(see continuation sheet - page 1)

10. GEOGRAPHICAL DATA

LATITUDE AND LONGITUDE COORDINATES DEFINING A RECTANGLE LOCATING THE PROPERTY			O R	LATITUDE AND LONGITUDE COORDINATES DEFINING THE CENTER POINT OF A PROPERTY OF LESS THAN TEN ACRES		
CORNER	LATITUDE	LONGITUDE		LATITUDE	LONGITUDE	
	Degrees Minutes Seconds	Degrees Minutes Seconds		Degrees Minutes Seconds	Degrees Minutes Seconds	
NW	° ' "	° ' "		45 ° 50 ' 36 "	94 ° 20 ' 49 "	
NE	° ' "	° ' "				
SE	° ' "	° ' "				
SW	° ' "	° ' "				

APPROXIMATE ACREAGE OF NOMINATED PROPERTY: **approx. 2 acres**

LIST ALL STATES AND COUNTIES FOR PROPERTIES OVERLAPPING STATE OR COUNTY BOUNDARIES

STATE:	CODE	COUNTY	CODE

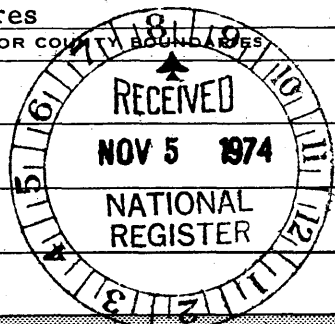

NO
UTM
CD

SEE INSTRUCTIONS

11. FORM PREPARED BY

NAME AND TITLE: **Thomas J. Lutz**

ORGANIZATION: **Minnesota Historical Society** DATE: **10/29/74**

STREET AND NUMBER: **Building 25, Fort Snelling**

CITY OR TOWN: **St. Paul** STATE: **Minnesota** CODE: **22**

12. STATE LIAISON OFFICER CERTIFICATION

As the designated State Liaison Officer for the National Historic Preservation Act of 1966 (Public Law 89-665), I hereby nominate this property for inclusion in the National Register and certify that it has been evaluated according to the criteria and procedures set forth by the National Park Service. The recommended level of significance of this nomination is:

National State Local

Name: Russell W. Fridley
Russell W. Fridley, Director

Title: Minnesota Historical Society

Date: October 31, 1974

NATIONAL REGISTER VERIFICATION

I hereby certify that this property is included in the National Register.

A. R. Mortensen
Director, Office of Archeology and Historic Preservation

Date: 12/4/74

ATTEST: George F. Emery
Keeper of The National Register

Date: Dec 3, 1974

NATIONAL REGISTER OF HISTORIC PLACES
INVENTORY - NOMINATION FORM

(Continuation Sheet)

STATE	
Minnesota	
COUNTY	
Morrison	
FOR NPS USE ONLY	
ENTRY NUMBER	DATE
DEC 4	1974

(Number all entries)

7. Description - continuation sheet - page 1

granary built in the 1880s extends to the north, while a dairy shed extends to the west. The exterior is now tin sheathed, but the original board and batten siding in an excellent state of preservation remains beneath.

To the west of the barn are the two surviving cellar depressions relating to William Warren; the northernmost one being the site of the Warren cabin. This site location is documented by a number of local historical references, but the most exacting is given by the United States government surveyors notes of 1852 which places Warren's cabin two hundred links (128 feet-approximately) west of the southwest corner of the northwest quarter of Section 28, Belleview Township. This benchmark, incidently, is located in the approximate center of the large barn. The other remaining depression, although still unknown, is generally considered to be either Warren's barn or his trading post.

9. Major Bibliographical References

History of the Upper Mississippi River Valley, J. Fletcher Williams,
Minnesota Historical Society, Minneapolis, 1881, pp. 386-7 and p. 597

Family Records of the McDougall, LaFond and Dufrene families

Files of the Minnesota and Morrison County Historical Societies



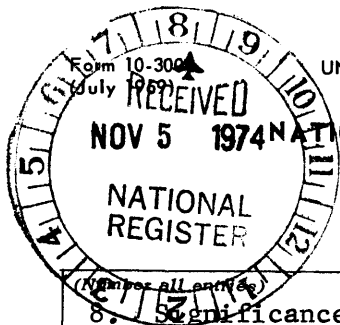

UNITED STATES DEPARTMENT OF THE INTERIOR
NATIONAL PARK SERVICE

**NATIONAL REGISTER OF HISTORIC PLACES
INVENTORY - NOMINATION FORM**

(Continuation Sheet)

STATE	
Minnesota	
COUNTY	
Morrison	
FOR NPS USE ONLY	
ENTRY NUMBER	DATE
	DEC 4 1974

8. Significance - continuation sheet - page 2

Any historical relationship between William Warren and the McDougall family who immigrated from the County Huron area of Ontario, Canada is not known. However, Duncan McDougall, the first of at least four brothers to immigrate to this area, is known to have been in the vicinity as early as the spring of 1849. He eventually homesteaded in 1852 on a farm less than one mile north, and serving as a county commissioner, supervisor, and county treasurer during his residence. James McDougall, another brother, is the first known to reside at the Two Rivers site, operating a post office on the Pembina Trail for those settlers located across the Mississippi River to the west. The post office/residence stood between and to the west of the present blacksmith shop and machine shed according to family recollections. A third brother, Donald, who served as the first town clerk as well as County sheriff and surveyor, settled on the adjacent homestead to the north of "Two Rivers" in 1857. No buildings related to these early McDougall brothers remain.

Peter McDougall was the last of the four known brothers to immigrate to the area coming in October of 1873. According to family information he lived in Duncan's cabin while constructing the barn in 1874 and the house soon after. He is the major force behind the present appearance of the farmstead. Both the barn and house are, architecturally, more akin to vernacular Canadian architecture and its carpentry techniques than local midwest architecture. This is especially true of the English style barn which is a showcase of beautifully crafted, precision joinery throughout its mortise-and-tenon construction. The house, while not as spectacular, architecturally, has not been appreciably altered, even retaining its summer kitchen and wood shed to the side. The entire farmstead has retained nearly all its nineteenth century buildings, presenting today an exceptional example in northern Minnesota of a mid-century immigrants farm. It remains the sole surviving symbol of the immigration of the McDougall family to the area.

In conclusion the William Warren Two Rivers Cabin Site and McDougall Homestead is an unusual combination of two early stages of the development of frontier Minnesota; first, the territorial fur trade period, and second, the homesteading of the state's vast agricultural lands. The historical significance is further strengthened by the added dimension of aboriginal history first recorded at this site. The farmstead is one of the few places, not only in Minnesota, but also the midwest area where diverse aspects of the history of midwest American group to form microcosm of this area's early history.

The farmstead along with surrounding land to the west and north, which includes an active heron rookery and the greatest concentration of virgin white pine this far south in Minnesota, will soon be acquired by the Nature Conservancy for the perpetual preservation of the site's natural qualities. They have agreed to indefinitely protect the buildings until a time when other preservation alternatives can be developed for the farmstead.

North

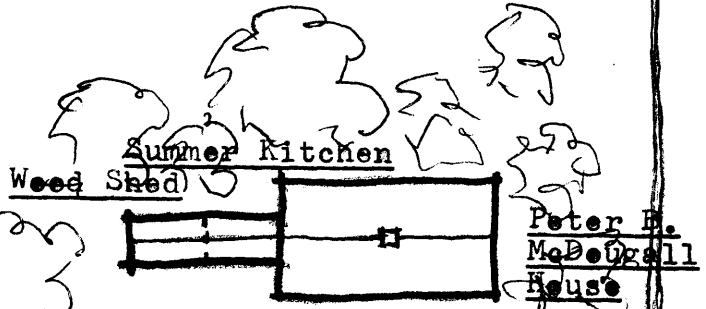

Fence

Embankment

Blacksmith Shop

Site of
James
McDougall
Cabin/Post Office



Machine
Shed

Corn
Crib

Trees

Site of
William
Warren
Cabin



Dairy
Shed

Grainary

Barn

Hedge

Hedge

Trees

Field

Form No. 10-301
Rev. 7-72

UNITED STATES DEPARTMENT OF THE INTERIOR
NATIONAL PARK SERVICE

**NATIONAL REGISTER OF HISTORIC PLACES
PROPERTY MAP FORM**

(Type all entries - attach to or enclose with map)

STATE	
Minnesota	
COUNTY	
Morrison	
FOR NPS USE ONLY	
ENTRY NUMBER	DATE
DEC 4	1974

SEE INSTRUCTIONS

1. NAME			
COMMON:		Old McDougall Farm	
AND/OR HISTORIC:		William Warren Two Rivers Cabin Site and McDougall Homestead	
2. LOCATION			
STREET AND NUMBER:			
On County Road 23, 2 miles west-northwest of Royalton, Minn.			
CITY OR TOWN:			
Bellevue Township			
STATE:	CODE	COUNTY:	CODE
Minnesota	22	Morrison	097
3. MAP REFERENCE			
SOURCE:			
Sketch Map - Thomas J. Lutz			
SCALE:			
none			
DATE:			
October 1974			
4. REQUIREMENTS			
TO BE INCLUDED ON ALL MAPS			
1. Property boundaries where required.			
2. North arrow.			
3. Latitude and longitude reference.			

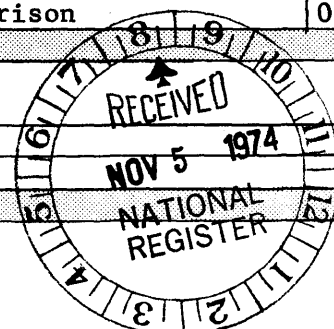

United States Department of the Interior
National Park Service

National Register of Historic Places Continuation Sheet

Section number _____ Page _____

ADDITIONAL INFORMATION

for Keeper *Helena Lynn*
1/19/89

United States Department of the Interior
National Park Service

National Register of Historic Places Continuation Sheet

Section number _____ Page _____

Note: These changes apply to
Old McDougall Farm in Morrison
County, Minnesota.

REFERENCE NUMBER: 74001031

STATE: MINNESOTA

COUNTY: Morrison

RESOURCE NAME (HISTORIC): Warren, William, Two Rivers House Site
and McDougall, Peter, Farmstead

CITY:

VICINITY OF:

ADDRESS: Co.Rd. 231

CERTIFICATION DATE:

REMOVED DATE:

COMMENTS:

Nina M. Archabal
Nina M. Archabal
State Historic Preservation Officer

JUN 17 1988
Date