

German Catholic Churches and Cemeteries of Lawrence County
 (1872-c.1930) Thematic Resources

IDENTIFICATION	Historic name: <u>St. Mary's Cemetery</u>	STATUS	Open to public: <u>Yes X No Restricted</u>
	Common name: <u>same</u>		Visible from road: <u>Yes X No</u>
	Address: <u>Rascal Town Road</u> <u>Vicinity of Rascal Town</u>		Occupied: <u>Yes X No</u>
	Owner's name: <u>Bishop of Nashville</u>		Present use: <u>Cemetery</u>
	Owner's address: <u>2400 Twenty-first Ave., S.</u> <u>Nashville, Tennessee</u>		Current condition: <u>Good</u>
	Classification: <u>Site</u>		Alterations: <u>None</u>
	Tax map reference: <u>#167</u>		Site features: <u>Cast iron entrance arch,</u> <u>large wrought iron cross, variety of</u> <u>nineteenth-century and later monuments</u>
	Acreage: <u>approximately .1 acre</u>		
	UTM reference: <u>Loretto, Tn.-Ala., Quad.</u> <u>16/462160/3876410</u>		
HISTORY	Date of construction: <u>established 1872</u>	SOURCES	Bibliographical data: <u>Moore, Lewis, (ed.).</u> <u>Glimpses of History in Lawrence</u> <u>County. Columbia: Columbia State</u> <u>Community College, n.d.</u>
	Architect/builder: <u>N/A</u>		
	Original or previous owners: <u>N/A</u>		
	Original use: <u>Cemetery</u>		Form prepared by: <u>Richard Quin</u>
	Theme/s: Primary <u>Exploration/Settlement</u> Secondary <u>Architecture</u> Other _____		Title: <u>Historic Preservation Planner</u> Organization: <u>South Central Tennessee</u> Development District _____ Date: <u>4-84</u>
DESCRIPTION	The cemetery of St. Mary's is located off the southeast side of the Rascal Town Road, about six miles southwest of Loretto and two miles northeast of Rascal Town. The cemetery measures about eighty feet square and is enclosed by mature cedar trees. A white iron gate emblazoned "St. Mary's" and a large iron crucifix are the only distinct man-made features. The cemetery contains about twenty graves, of the Gieske, Bergob, and Kersteins families. The older monuments date to 1881 and are inscribed in German.		
SIGNIFICANCE	As part of the German Catholic settlement of Lawrence County in the 1870s, the small community of "St. Mary's" was established about five miles southeast of St. Joseph off Rascal Town Road. A small log church was erected in 1872. The settlement failed to prosper and the parish was consolidated with St. Joseph a few years later. Only the churchyard and cemetery remain to mark the site of the settlement.		

PHOTOGRAPHIC DATA

Photographer: Richard Quin

Date: May 1984

Negatives on file: Tennessee Historical
Commission, Nashville

Photographer facing: N/A

Photograph number 18-20 of 20 .

CONTINUATION

SITE PLAN - Include North Arrow



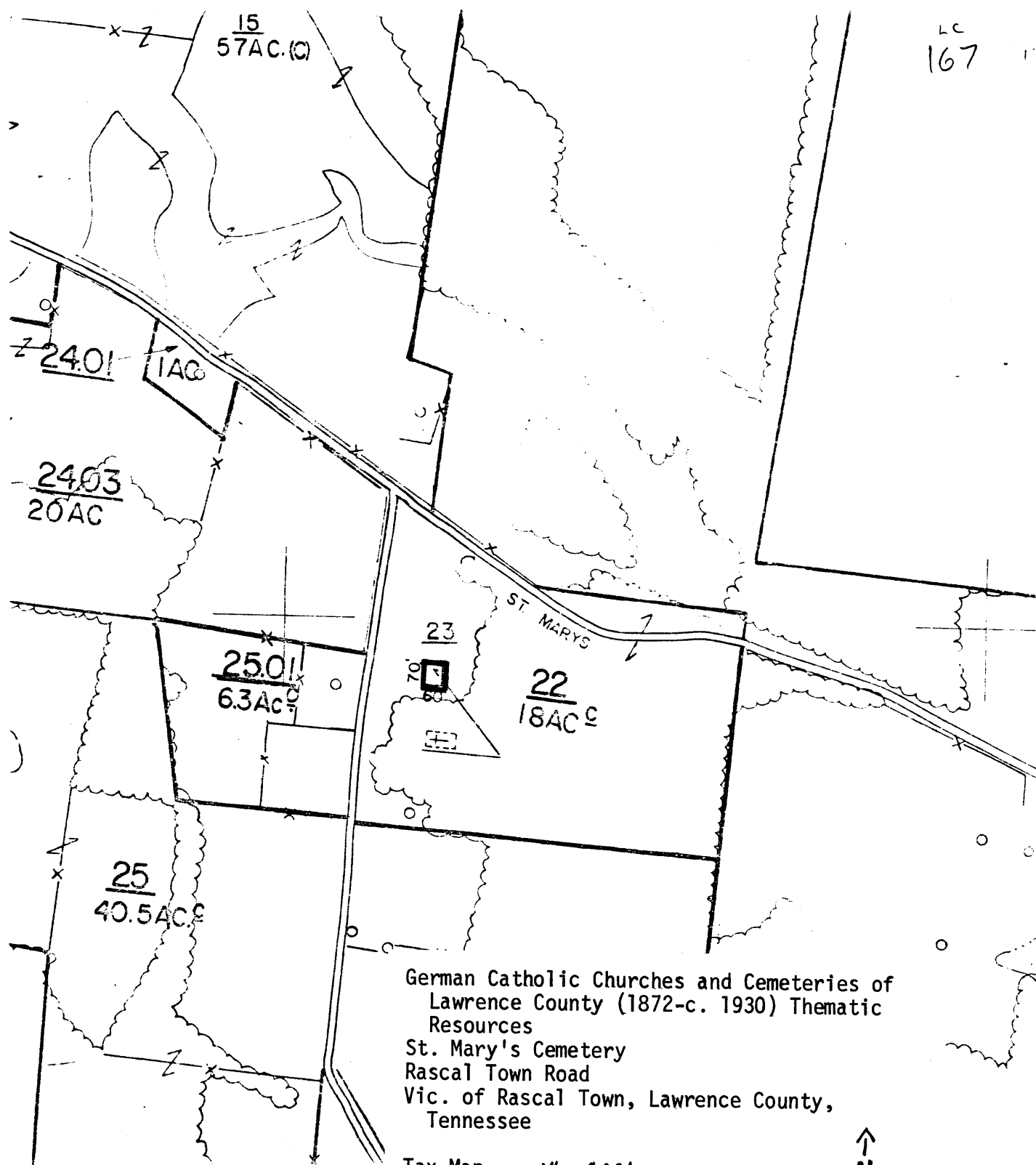

LC
167

German Catholic Churches and Cemeteries of
Lawrence County (1872-c. 1930) Thematic
Resources
St. Mary's Cemetery
Rascal Town Road
Vic. of Rascal Town, Lawrence County,
Tennessee

Tax Map 1" = 400'

