



SCALE: $\frac{1}{8}'' = 10'$ 

PHOTO NO. 1

CONTRIBUTING RESOURCE
SITE AND STRUCTURE

PHOTO #1

DUNN GARDENS

KING COUNTY, WASHINGTON

1930

AERIAL PHOTO OF SITE



SCALE: $\frac{1}{8}$ " = 10'



PHOTO No. 2

CONTRIBUTING RESOURCE
SITE AND STRUCTURE

PHOTO # 2

DUNN GARDENS

KING COUNTY, WASHINGTON

1990

AERIAL PHOTO OF SITE

87th AVE. N.W.

E. 1/2 SEC. 16, T. 124 N., R. 10 W.

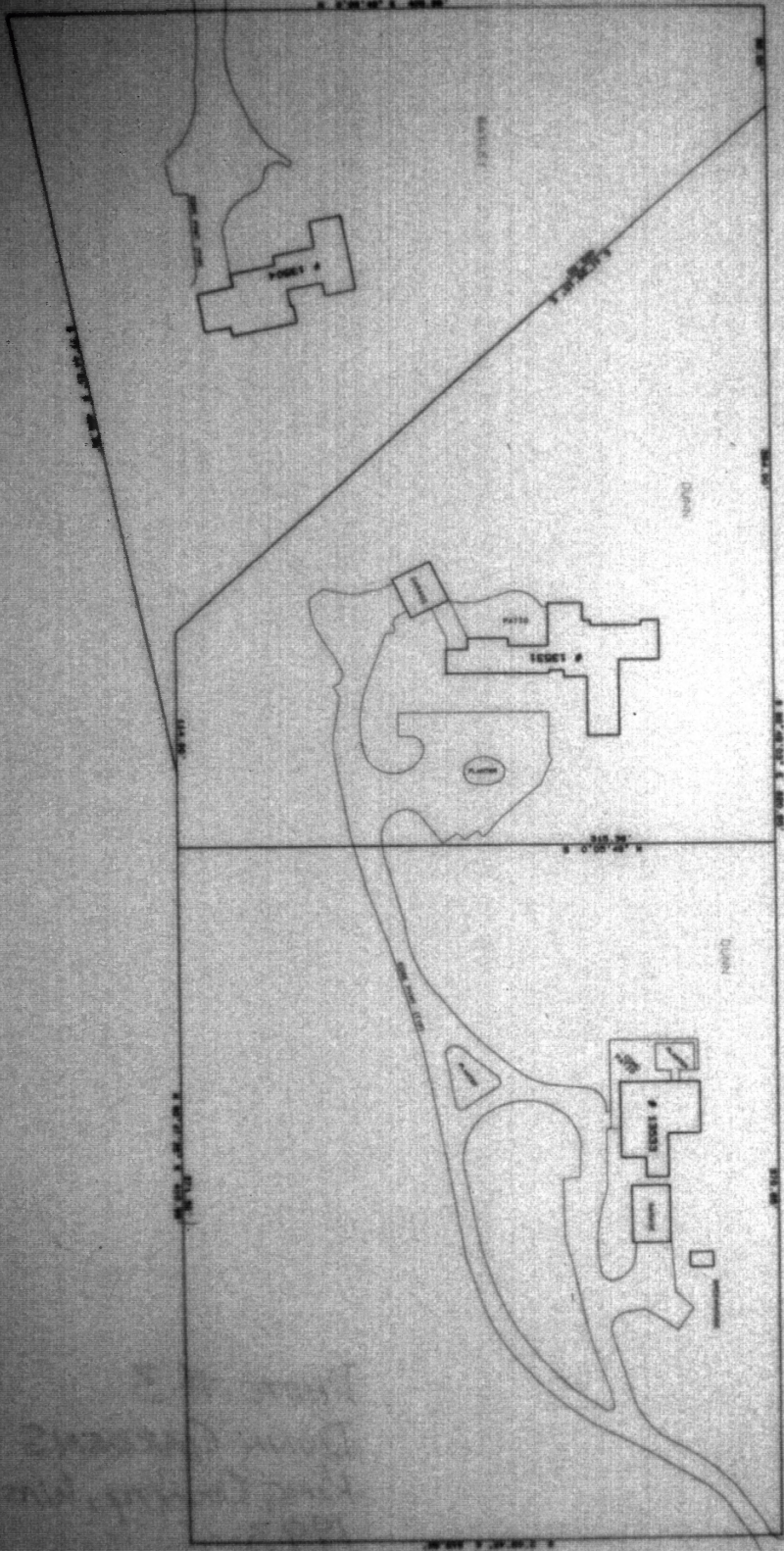

THIS SURVEY WAS MADE BY THE SURVEYOR AND ENGINEER IN CHARGE OF THE SURVEYING DEPARTMENT OF THE STATE OF MINNESOTA, AND IS A TRUE AND CORRECT COPY OF THE ORIGINAL SURVEY RECORD AS KEPT IN HIS OFFICE.



SURVEY FOR
E. O. SLACK

TOPOGRAPHY SURVEY FOR
DURN/BAYLEY PARCELS
(13031 NORTHSHIRE RD., MN)



C&C Surveying
Surveying and Engineering
13031 Northshire Rd., Suite 100, Eden Prairie, MN 55347
(952) 935-1111

DATE	11-18-20	SCALE	1"=100'
BY	CS	PROJECT	
CHECKED BY		DATE	
APPROVED BY		DATE	

SCALE: 1"=100'

PHOTO No. 3

PHOTO # 3

DUNN GARDENS

KING COUNTY, WASHINGTON
1993

PROPERTY BOUNDARIES



PHOTO No. 4

CONTRIBUTING RESOURCE
STRUCTURE

DUNN GARDENS

KING COUNTY, WASHINGTON

1994

PHOTO # 4

CURVING ENTRY DRIVE
BENEATH WOODLAND
CANOPY



PHOTO No. 5

NON-CONTRIBUTING RESOURCE

BUILDING

DUNN GARDENS

KING COUNTY, WASHINGTON

1993

PHOTO # 5

BAYLEY RESIDENCE, 1940



PHOTO No. 6

NON-CONTRIBUTING
RESOURCE

BUILDING

DUNN GARDENS

KING COUNTY, WASHINGTON

1980

PHOTO # 6

EDWARD B. DUNN

RESIDENCE, 1947

ORIGINAL MOTOR GARAGE

1918



PHOTO No. 7

NON-CONTRIBUTING RESOURCE
BUILDING

DUNN GARDENS

KING COUNTY, WASHINGTON

1993

PHOTO # 7

VIEW OF GREAT LAWN
AND 1949 RESIDENCE



PHOTO No. 8

DUNN GARDENS

KING COUNTY, WASHINGTON

1993

PHOTO # 8

VIEW OF WOODLAND
GLEN



PHOTO NO. 9

PHOTO #9
DUNK GARDENS
KING COUNTY, WASHINGTON
1993

WOODLAND POND AND
WATER GARDEN

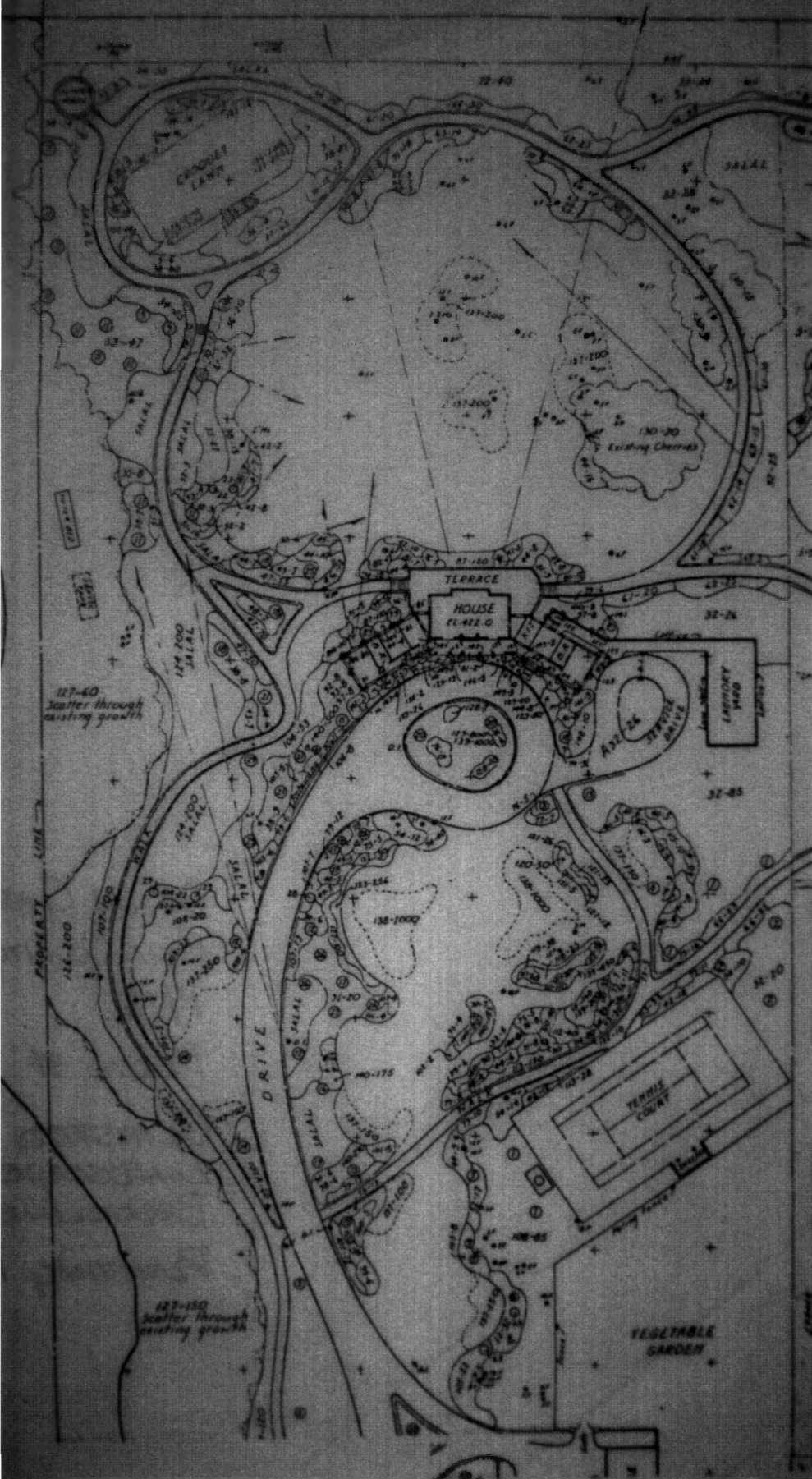

SCALE: 1 1/2" = 100' —

PHOTO No. 10

DUNN GARDENS
KING COUNTY, WASHINGTON
1916

PHOTO # 12

OLMSTED BROTHERS
LANDSCAPE ARCHITECTS
BROOKLINE, MA
PLANTING PLAN



PHOTO No. 17

DUNN GARDENS
KING COUNTY, WASHINGTON
1994

PHOTO # 13

SCREEN PLANTINGS
DEFINE SPACES AND
DIRECT VIEWS
THROUGHOUT LANDSCAPE



PHOTO No. 19

CONTRIBUTING RESOURCE
PHOTO # 14 - STRUCTURE
DUNN GARDENS
KING COUNTY, WASHINGTON
1994

FOOTPATHS ALONG
EDGE OF LAWN
PROVIDES DIAGONAL
VIEWS



Surrounded by
Pines

PHOTO No. 13

CONTRIBUTING RESOURCE
STRUCTURE

DUNN GARDENS

KING COUNTY, WASHINGTON
1993

PHOTO # 15

GREAT LAWN

SURROUNDED BY
NATIVE FIRS AND
SPECIMEN TREES



APPENDIX PHOTO #1

DUNN GARDENS

KING COUNTY

SEATTLE, WASHINGTON

1993

SEE APPENDIX
DESCRIPTION

West

CONTRIBUTING RESOURCE

ENTRY DRIVE



APPENDIX PHOTO #2
DUNN GARDENS
KING COUNTY
SEATTLE, WASHINGTON
1993

NON-CONTRIBUTING
RESOURCE-BUILDING

See APPENDIX DESCRIPTION
Northeast



APPENDIX PHOTO #3

DUNN GARDENS

KING COUNTY

SEATTLE, WASHINGTON

1987

NON-CONTRIBUTING
RESOURCE-BUILDING

SEE APPENDIX

DESCRIPTION

North



APPENDIX PHOTO #4
DUNN GARDENS
KING COUNTY
SEATTLE, WASHINGTON
1993.

CONTRIBUTING RESOURCE
STRUCTURE

FOOTPATHS AND
INTERNAL VIEWS



APPENDIX PHOTO #5
DUNN GARDENS
KING COUNTY
SEATTLE, WASHINGTON
1992

CONTRIBUTING RESOURCE
STRUCTURE

THE GREAT LAWN
W/ VIEW OF

NON-CONTRIBUTING
RESOURCE -

BUILDING IN
BACKGROUND

East



APPENDIX PHOTO # 6

DUNN GARDENS

KING COUNTY

SEATTLE, WASHINGTON

1993

CONTRIBUTING RESOURCE

STRUCTURE

THE GREAT LAWN

East