

STATE: Arkansas
COUNTY: Columbia
FOR NPS USE ONLY
ENTRY NUMBER: 22 SEP 1972
DATE:

**NATIONAL REGISTER OF HISTORIC PLACES
INVENTORY - NOMINATION FORM**

(Type all entries - complete applicable sections)

1. NAME

COMMON:

Frog Level

AND/OR HISTORIC:

2. LOCATION

STREET AND NUMBER:

SE 1/4 of NW 1/4 of Section 11, T 17 S, R 22 W

CITY OR TOWN:

Bursey via

STATE

Arkansas

CODE

05

COUNTY:

Columbia

CODE

027

3. CLASSIFICATION

CATEGORY (Check One)	OWNERSHIP	STATUS	ACCESSIBLE TO THE PUBLIC
<input type="checkbox"/> District	<input type="checkbox"/> Public	<input type="checkbox"/> Occupied	Yes:
<input checked="" type="checkbox"/> Building	<input checked="" type="checkbox"/> Private	<input checked="" type="checkbox"/> Unoccupied	<input checked="" type="checkbox"/> Restricted
<input type="checkbox"/> Site	<input type="checkbox"/> Both	<input type="checkbox"/> Preservation work in progress	<input type="checkbox"/> Unrestricted
<input type="checkbox"/> Object			<input type="checkbox"/> No

PRESENT USE (Check One or More as Appropriate)

<input type="checkbox"/> Agricultural	<input type="checkbox"/> Government	<input type="checkbox"/> Park	<input type="checkbox"/> Transportation	<input type="checkbox"/> Comments
<input type="checkbox"/> Commercial	<input type="checkbox"/> Industrial	<input checked="" type="checkbox"/> Private Residence	<input type="checkbox"/> Other (Specify)	
<input type="checkbox"/> Educational	<input type="checkbox"/> Military	<input type="checkbox"/> Religious		
<input type="checkbox"/> Entertainment	<input type="checkbox"/> Museum	<input type="checkbox"/> Scientific		

4. OWNER OF PROPERTY

OWNER'S NAME:

Mrs. W. A. G. Woodward

STREET AND NUMBER:

1710 Dogwood Drive

CITY OR TOWN:

Magnolia

STATE:

Arkansas

CODE

05

5. LOCATION OF LEGAL DESCRIPTION

COURTHOUSE, REGISTRY OF DEEDS, ETC:

Columbia County Courthouse

STREET AND NUMBER:

CITY OR TOWN:

Magnolia

STATE

Arkansas

CODE

05

6. REPRESENTATION IN EXISTING SURVEYS

TITLE OF SURVEY:

DATE OF SURVEY:

DEPOSITORY FOR SURVEY RECORDS:

☐ Federal

☐ State

☐ County

☐ Local

STREET AND NUMBER:

CITY OR TOWN:

STATE:

CODE



SEE INSTRUCTIONS

STATE:

COUNTY:

FOR NPS USE ONLY

ENTRY NUMBER

DATE

22 SEP 1972

7. DESCRIPTION

CONDITION	(Check One)					
	<input type="checkbox"/> Excellent	<input checked="" type="checkbox"/> Good	<input type="checkbox"/> Fair	<input type="checkbox"/> Deteriorated	<input type="checkbox"/> Ruins	<input type="checkbox"/> Unexposed
	(Check One)			(Check One)		
	<input checked="" type="checkbox"/> Altered	<input type="checkbox"/> Unaltered	<input type="checkbox"/> Moved	<input checked="" type="checkbox"/> Original Site		

DESCRIBE THE PRESENT AND ORIGINAL (if known) PHYSICAL APPEARANCE

The William Frazier House, named "Frog Level," was begun in 1852 and completed about 1854. This two story frame house, with two rooms on each floor plus a center hall, has a large chimney at either end with a two story temple portico on the front. This portico is supported by two sets of four columns each, one set for the first floor and the second set for the second floor, which includes a balustrade railing. The main entrance on the first floor has double doors with simple rectangular sidelights and transom with a second doorway matching this one, opening onto the second floor gallery above. The main house is crowned with a simple gable roof having a simple cornice line with one story extension to the back of the house having a simple shed roof. Shutters have been added to the windows of the main house, however, they are obviously not the original shutters. The exterior of the house is covered with simple clapboard with the two main chimneys being stuccoed brick or stone, however, they were probably not stuccoed originally.

The four main rooms of the house all measure twenty-two foot square with the center hall being fourteen feet wide. The fireplace mantels in each of the four main rooms are pegged together and are handcarved in several simple designs. The floors are heart pine, six inches wide and one and one-half inches thick. The handblown glass for the sidelights and transom over the front doors are back in place after having been removed and stored in Southern State College during the years that the house was deserted. Several of the doors of the house still have their original handwrought locks. The original wooden dado extends up the stairway and around each of the four original main rooms.

Frog Level has been changed relatively little since it was first built and its overall appearance is still very reminiscent of its ancestors first built in the Piedmont section of Virginia. Today the night noises still include the little amphibians which gave the house its unusual name, "Frog Level."

SEE INSTRUCTIONS

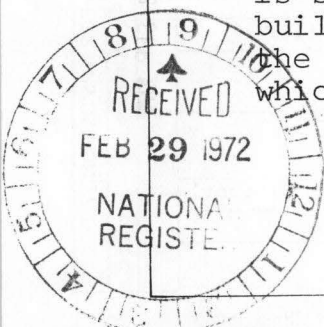

8. SIGNIFICANCE

PERIOD (Check One or More as Appropriate)

- ☐ Pre-Columbian ☐ 16th Century ☐ 18th Century ☐ 20th Century
☐ 15th Century ☐ 17th Century ☒ 19th Century

SPECIFIC DATE(S) (If Applicable and Known)

AREAS OF SIGNIFICANCE (Check One or More as Appropriate)

- | | | | |
|--|---|--|--|
| <input type="checkbox"/> Aboriginal | <input type="checkbox"/> Education | <input type="checkbox"/> Political | <input type="checkbox"/> Urban Planning |
| <input type="checkbox"/> Prehistoric | <input type="checkbox"/> Engineering | <input type="checkbox"/> Religion/Philosophy | <input type="checkbox"/> Other (Specify) _____ |
| <input type="checkbox"/> Historic | <input type="checkbox"/> Industry | <input type="checkbox"/> Science | _____ |
| <input type="checkbox"/> Agriculture | <input type="checkbox"/> Invention | <input type="checkbox"/> Sculpture | _____ |
| <input checked="" type="checkbox"/> Architecture | <input type="checkbox"/> Landscape Architecture | <input type="checkbox"/> Social/Humanitarian | _____ |
| <input type="checkbox"/> Art | <input type="checkbox"/> Literature | <input type="checkbox"/> Theater | _____ |
| <input type="checkbox"/> Commerce | <input type="checkbox"/> Military | <input type="checkbox"/> Transportation | _____ |
| <input type="checkbox"/> Communications | <input type="checkbox"/> Music | | |
| <input type="checkbox"/> Conservation | | | |

STATEMENT OF SIGNIFICANCE

Originally called the Frazier Plantation House, "Frog Level" was constructed in 1852. B. F. Askew, a young attorney who practiced in the area suggested the unusual name because of the noise created by the unusually numerous frogs in the bottoms near the house.

William Frazier, the builder and original owner of Frog Level, was a native of Ireland and was born in 1805. He lived for a time in Ouachita County until floods inundated his farm. Frazier then moved his family to high ground in what was then LaFayette County. In December, 1852 Columbia County was created from a portion of LaFayette County and Frog Level became a part of it.

A short distance from the house was the Ferguson and Morgan store. Here the first term of the Columbia County Court was held on March 21, 1853.

In 1852 the LaFayette County tax assessment lists show that Frazier owned 480 acres and 14 slaves. In 1853 the Columbia County tax assessment lists show he had expanded his holdings to 845 acres and 16 slaves. By 1866 Frazier owned 1046 acres, however, the Civil War had taken its toll. While the total evaluation for the property in 1861 was \$11,275, the total evaluation in 1866 including an increase of 201 acres to offset the loss of the slaves was \$1,156, or barely one-tenth of all his taxable property in 1861.

Following the close of the Civil War, a government controlled brewery was established and operated at Frog Level about one-half mile from the house.



9. MAJOR BIBLIOGRAPHICAL REFERENCES

Brown, Walter L. "The Magnolia Meeting of the Arkansas Historical Association - 1968," Arkansas Historical Quarterly, Vol. XXVII, No. 3 (Autumn, 1968).

Columbia County Tax Assessment Lists, 1853, 1861, 1866.

El Dorado Daily News, May 7, 1961.

HB
120
47m

10. GEOGRAPHICAL DATA

LATITUDE AND LONGITUDE COORDINATES DEFINING A RECTANGLE LOCATING THE PROPERTY			O R	LATITUDE AND LONGITUDE COORDINATES DEFINING THE CENTER POINT OF A PROPERTY OF LESS THAN TEN ACRES		
CORNER	LATITUDE	LONGITUDE		LATITUDE	LONGITUDE	
	Degrees Minutes Seconds	Degrees Minutes Seconds		Degrees Minutes Seconds	Degrees Minutes Seconds	Degrees Minutes Seconds
NW	° ' "	° ' "		33° 16' 42.8"	93° 21' 01.2"	
NE	° ' "	° ' "				
SE	° ' "	° ' "				
SW	° ' "	° ' "				

APPROXIMATE ACREAGE OF NOMINATED PROPERTY:

LIST ALL STATES AND COUNTIES FOR PROPERTIES OVERLAPPING STATE OR COUNTY BOUNDARIES

STATE:	CODE	COUNTY	CODE
STATE:	CODE	COUNTY:	CODE
STATE:	CODE	COUNTY:	CODE
STATE:	CODE	COUNTY:	CODE

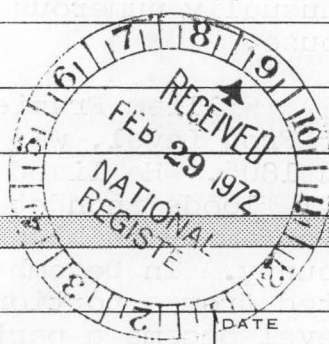

11. FORM PREPARED BY

NAME AND TITLE:

Staff

ORGANIZATION

Arkansas Historic Preservation Program

STREET AND NUMBER:

1023 West Third Street

CITY OR TOWN:

Little Rock

STATE

Arkansas

CODE

05

12. STATE LIAISON OFFICER CERTIFICATION

NATIONAL REGISTER VERIFICATION

As the designated State Liaison Officer for the National Historic Preservation Act of 1966 (Public Law 89-665), I hereby nominate this property for inclusion in the National Register and certify that it has been evaluated according to the criteria and procedures set forth by the National Park Service. The recommended level of significance of this nomination is:

National ☐ State ☐ Local ☒

Name

William E. Henderson

Title

State Liaison Officer

Date

Jan 25, 1972

I hereby certify that this property is included in the National Register.

Chief, Office of Archeology and Historic Preservation

Date

9/22/72

ATTEST:

Keeper of The National Register

Date

SEE INSTRUCTIONS

**NATIONAL REGISTER OF HISTORIC PLACES
INVENTORY - NOMINATION FORM**

(Continuation Sheet)

STATE Arkansas	
COUNTY Pulaski	
FOR NPS USE ONLY	
ENTRY NUMBER	DATE
2	2 SEP 1972

(Number all entries)

8. Significance

Today Frog Level, due to the careful restoration of its owner, Mrs. W. A. G. Woodward, has been preserved as one of the few remaining gracious old plantation homes of southwestern Arkansas.



**NATIONAL REGISTER OF HISTORIC PLACES
INVENTORY - NOMINATION FORM**

(Continuation Sheet)

STATE Arkansas	
COUNTY Columbia	
FOR NPS USE ONLY	
ENTRY NUMBER	DATE
22	SEP 1972

(Number all entries)

9. Major Bibliographical References

Lafayette County Tax Assessment Lists, 1852.

Martel, Glenn G. "Early Days in Columbia County,"
Arkansas Historical Quarterly, Vol. II, No. 3
(September, 1943).

Woodward, Mary Davis. "Frog Level, Oldest House In
Columbia County," Arkansas Historical Quarterly,
Vol. VIII, No. 4 (Winter, 1949).



Columbia CO.

72 000 201

PROPERTY

Frog Level

STATE

Arkansas

22 SEP 1972

DATE OF RECEIPT 2/29/72 YES

NO

NUMBER

REGISTER:

DATA PAGE

PHOTO (S)

PHOTO DESCRIPTION (S)

MAP (S)

MAP DESCRIPTION (S)

LOGGED

ACKNOWLEDGE 2/29/72

RESUBMIT



REVIEW

HISTORIAN

ARCHEOLOGIST

ARCHITECT

ASST. KEEPER

KEEPER

WRITER/EDITOR

DIRECTOR, OAHP

EDITORIAL PROCESSING, EDITOR

OK

OK means 9/5

Olney, Sables 2/11/72

OK Chambers 9-6-72

OK Rgt 9/12/72

LOP 9/2

Marcus

Although arch. could be better done, OK 9/8/72

Federal Registry Entry 10-2-72

Annual Edition Entry

Logged 22 SEP 1972

Card 22 SEP 1972

COMMENTS:

WORKING NUMBER 2.29.72.291

CONGRESSIONAL DISTRICT:



NPS Number

Sept. 22, 1972

Title:

Frog Level

Loc.

UNITED STATES DEPARTMENT OF THE INTERIOR
NATIONAL PARK SERVICE

NATIONAL REGISTER OF HISTORIC PLACES

PROPERTY PHOTOGRAPH FORM

(Type all entries - attach to or enclose with photograph)

STATE

Arkansas

COUNTY

Columbia

FOR NPS USE ONLY

ENTRY NUMBER

DATE

22 SEP 1972

SEE INSTRUCTIONS

1. NAME

COMMON: Frog Level

AND/OR HISTORIC:

2. LOCATION

STREET AND NUMBER:

SE $\frac{1}{4}$ of NW $\frac{1}{4}$ of Section 11, T 17 S, R 22 W

CITY OR TOWN:

STATE:

Arkansas

CODE

05

COUNTY:

Columbia

CODE

027

3. PHOTO REFERENCE

PHOTO CREDIT: Staff, Arkansas Historic Preservation Program

DATE OF PHOTO: 1971

NEGATIVE FILED AT:

Arkansas History Commission

4. IDENTIFICATION

DESCRIBE VIEW, DIRECTION, ETC.

View from the east.

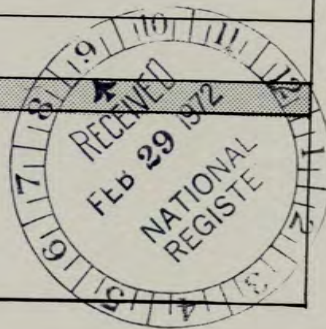

PROPERTY OF THE NATIONAL REGISTER

UNITED STATES DEPARTMENT OF THE INTERIOR
NATIONAL PARK SERVICE

NATIONAL REGISTER OF HISTORIC PLACES

PROPERTY MAP FORM

(Type all entries - attach to or enclose with map)

STATE Arkansas	
COUNTY Columbia	
FOR NPS USE ONLY	
ENTRY NUMBER 22 SEP 1972	DATE

1. NAME

COMMON: Frog Level
AND/OR HISTORIC:

2. LOCATION

STREET AND NUMBER:

SE $\frac{1}{4}$ of NW $\frac{1}{4}$ of Section 11, T 17 S, R 22 W

CITY OR TOWN:

STATE:

Arkansas

CODE

05

COUNTY:

Columbia

CODE

027

3. MAP REFERENCE

SOURCE:

U.S.G.S. 7.5' Series Waldo, Arkansas Quadrangle

SCALE:

1:24,000

DATE:

1968

4. REQUIREMENTS

TO BE INCLUDED ON ALL MAPS

1. Property boundaries where required.
2. North arrow.
3. Latitude and longitude reference.

SEE INSTRUCTIONS

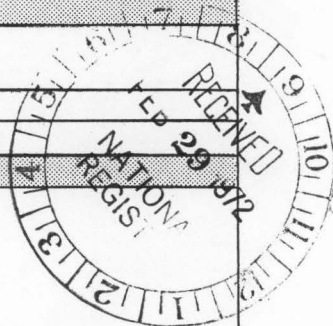

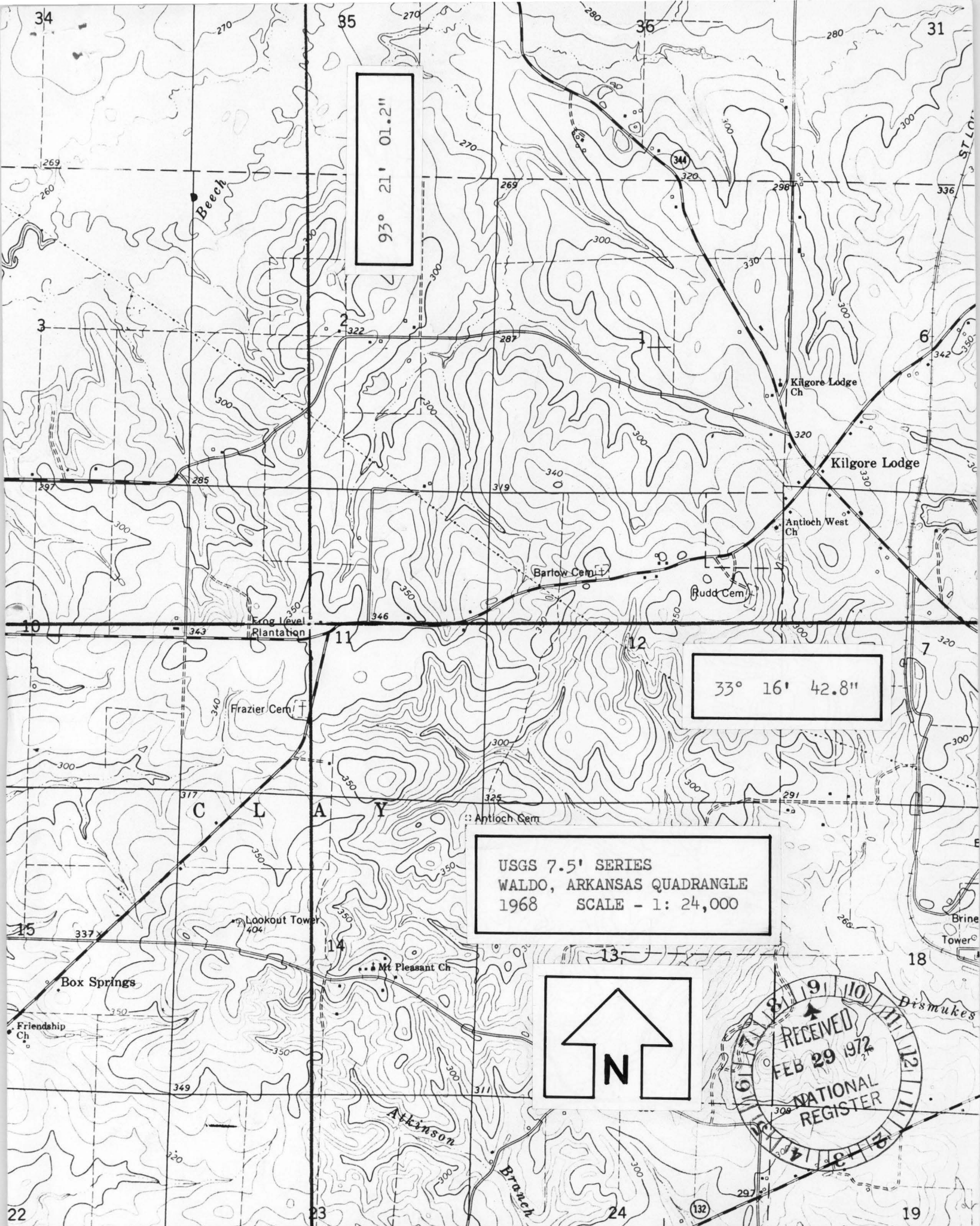

ENTRIES IN THE NATIONAL REGISTER

STATE ARKANSAS

Date Entered 2 2 SEP 1972

Name

Location

Frog Level

Columbia County

Selma Methodist Church

Selma
Drew County

Also Notified

Hon. John L. McClellan

Hon. J. W. Fulbright

Hon. David Pryor

Director, Southwest Region

HR

NRowland:mm 9/25/72

State Liaison Officer

Mr. William E. Henderson

Director

Arkansas Department of Parks &
Tourism

State Capitol - Room 149

Little Rock, Arkansas 72201