

KENTUCKY HISTORIC RESOURCES INVENTORY

Site No. GDL 6

1. Historic Name(s) <p style="text-align: center;">Wherritt House</p>		22. ADD/County BLUEGRASS/ GARRARD 040																									
Original Owner <p style="text-align: center;">S.W. Miller- W. H. Wherritt</p>		23. U.S.G.S. Quadrant (15'/75') <p style="text-align: center;">Lancaster</p>																									
2. Present Name <p style="text-align: center;">Lancaster Family Health Center</p>		24. UTM Reference <table style="width: 100%; border-collapse: collapse;"> <tr> <td style="border: 1px solid black; padding: 2px;">16</td> <td style="border: 1px solid black; padding: 2px;">7</td> <td style="border: 1px solid black; padding: 2px;">1</td> <td style="border: 1px solid black; padding: 2px;">3</td> <td style="border: 1px solid black; padding: 2px;">7</td> <td style="border: 1px solid black; padding: 2px;">2</td> <td style="border: 1px solid black; padding: 2px;">5</td> <td style="border: 1px solid black; padding: 2px;">4</td> <td style="border: 1px solid black; padding: 2px;">1</td> <td style="border: 1px solid black; padding: 2px;">6</td> <td style="border: 1px solid black; padding: 2px;">6</td> <td style="border: 1px solid black; padding: 2px;">3</td> <td style="border: 1px solid black; padding: 2px;">3</td> <td style="border: 1px solid black; padding: 2px;">0</td> </tr> <tr> <td colspan="3" style="text-align: center;">Zone</td> <td colspan="4" style="text-align: center;">Easting</td> <td colspan="3" style="text-align: center;">Northing</td> </tr> </table>		16	7	1	3	7	2	5	4	1	6	6	3	3	0	Zone			Easting				Northing		
16	7	1	3	7	2	5	4	1	6	6	3	3	0														
Zone			Easting				Northing																				
3. Location <p style="text-align: center;">210 Lexington Street</p>		25. Coordinate Accuracy <div style="text-align: right;"><input type="checkbox"/></div>																									
4. Owner's Name <p style="text-align: center;">Dr. Nicholas Martin</p>		26. Prehistoric Site <table style="width: 100%; border-collapse: collapse;"> <tr> <td style="width: 50%;">Historic Site</td> <td style="width: 50%;">Object</td> </tr> <tr> <td>Building</td> <td>Structure</td> </tr> <tr> <td><input checked="" type="checkbox"/></td> <td>Other</td> </tr> </table>		Historic Site	Object	Building	Structure	<input checked="" type="checkbox"/>	Other																		
Historic Site	Object																										
Building	Structure																										
<input checked="" type="checkbox"/>	Other																										
5. Owner's Address <p style="text-align: center;">210 Lexington St., Lancaster, Ky. 40444</p>		27. National Register District Name: <p style="text-align: center;">Multiple Res. of Lancaster</p>																									
6. Open to Public Yes <input type="checkbox"/> No <input checked="" type="checkbox"/>		7. Visible from road Yes <input checked="" type="checkbox"/> No <input type="checkbox"/>																									
9. Local Contact/Organization <p style="text-align: center;">GARRARD COUNTY HISTORICAL SOCIETY</p>		8. Ownership <table style="width: 100%; border-collapse: collapse;"> <tr> <td style="width: 50%;">Private</td> <td style="width: 50%; text-align: center;"><input checked="" type="checkbox"/></td> </tr> <tr> <td>Local</td> <td style="text-align: center;"><input type="checkbox"/></td> </tr> <tr> <td>State</td> <td style="text-align: center;"><input type="checkbox"/></td> </tr> <tr> <td>Federal</td> <td style="text-align: center;"><input type="checkbox"/></td> </tr> </table>		Private	<input checked="" type="checkbox"/>	Local	<input type="checkbox"/>	State	<input type="checkbox"/>	Federal	<input type="checkbox"/>																
Private	<input checked="" type="checkbox"/>																										
Local	<input type="checkbox"/>																										
State	<input type="checkbox"/>																										
Federal	<input type="checkbox"/>																										
10. Site Plan with North Arrow <div style="text-align: center;"> </div>		11. Architect _____																									
		12. Builder <p style="text-align: center;">Miller</p>																									
18. Description <p>Two story; three bay structure beaded clapboard; enclosed end chimneys; original structure is log; gable roof; stone foundation brick addition on North-East 1830; jack arches in brick addition. The log portion is 30'x20'.</p>		13. Date <p style="text-align: center;">1920</p>																									
		14. Style <table style="width: 100%; border-collapse: collapse;"> <tr> <td style="width: 50%;">A. Federal</td> <td style="width: 50%; text-align: center;"><input type="checkbox"/></td> </tr> <tr> <td>B. Class. Rev.</td> <td style="text-align: center;"><input checked="" type="checkbox"/></td> </tr> </table>		A. Federal	<input type="checkbox"/>	B. Class. Rev.	<input checked="" type="checkbox"/>																				
A. Federal	<input type="checkbox"/>																										
B. Class. Rev.	<input checked="" type="checkbox"/>																										
(Continue on Back)		15. Original Use <p style="text-align: center;">Residence <input type="checkbox"/> A</p>																									
		16. Present use <p style="text-align: center;">Medical Offices</p>																									
19. History <p>Built in the early 1800s of logs - Mary Jane Miller, daughter of the builder was married in this house to W. H. Wherritt and this was their family home. The property remained in this family until the early 1900s- when it was purchased by Hallie Dunlap. (Continued)</p>		17. Condition <p style="text-align: center;">Good <input type="checkbox"/> B</p>																									
		15. No. Stories <p style="text-align: center;">Two <input type="checkbox"/> C</p>																									
20. Significance <p>One of a few log houses remaining in Lancaster and has been well maintained. The floors are the original wide poplar boards-fireplaces in every room-kitchen has narrow stair way to traveler's room.</p>		31. Endangered Yes <input type="checkbox"/> No <input checked="" type="checkbox"/>																									
		32. Preservation Project Status <div style="text-align: right;"><input type="checkbox"/></div>																									
28. Beers Map 1879 Sandborn Maps 1886- 1891 Patches of Garrard County- ed. by Lancaster Woman's Club.		33. ATTACH PHOTO <div style="display: flex; justify-content: space-around;"> </div>																									
		34. Prepared by: <p style="text-align: center;">HELEN POWELL</p>																									
35. Organization <p style="text-align: center;">CARMAN AND POWELL, INC.</p>		36. Date <p style="text-align: center;">1983</p>																									
37. Revision Dates		38. Staff Review																									

19. HISTORY (Continued)

The Lancaster Woman's Club purchased this property from Dr. Rodney Johnston (who owned the property a very short time) in 1974. Much research was done by the Lancaster Woman's Club and some restoration work accomplished. In 1980 the property was sold to Drs. Peter Powers, Dr. Colin Raitier, and Dr. Steven Royse who opened the Lancaster Family Health Center. In August 1983 this building was sold to the present owner Dr. Nicholas Martin.

The log portion (two story) was covered with a beaded clapboard and two additional rooms were build of brick (dining room and kitchen) probably in the 1850s. The kitchen contains a large fireplace for cooking with the original crane. Another two rooms and bath were added in the 1920s to the older portions of the house and is under a separate roof.

When the house was converted to a medical facility the older portions of the house were not altered, just the latest addition was converted into three examining rooms.

Deed Book References:

1866	DB W	Page	477	(Miller to Wheritt)
1901	DB 17	"	285	(Wherritt to Kinnaird)
1903	DB 18	"	638	(Kinnaird to Wheritt)
1929	DB 47	"	551	(Miller to Dunlop)
1930	DB 48	"	282	(Dunlop to Ross)
	DB 55	"	266	(Ross to Gulley)
1972	DB 101	"	172	(Gulley to Dowd)
1974	DB 107	"	748	(Dowd to Johnston)
1974	DB 108	"	603	(Johnston to the Lancaster Women's Club)

KENTUCKY HISTORIC RESOURCE INVENTORY SUPPLEMENT
BOUNDARY AND LOCATION INFORMATION

Historic Property Name Wherritt House Site # GDL 6

Multiple Resource/Thematic Nomination Title Multiple Resources of Lancaster

U.T.M. Coordinates - List multiple UTM's if property is ten or more acres.

A. _____ D. _____

B. _____ E. _____

C. _____ F. _____

Verbal Boundary Description _____ Acreage .05

From a point in the east right of way of Lexington St. 198 feet north of the intersection of Lexington St. and Maple Ave.; then 60 feet east to a point; then 40 feet north to a point; then 60 feet west to a point; then 40 feet south along the right of way of Lexington St. to the point of beginning.

Sketch of Site Plan (Showing outbuildings, structures, landscape features and the site boundary as described above.)

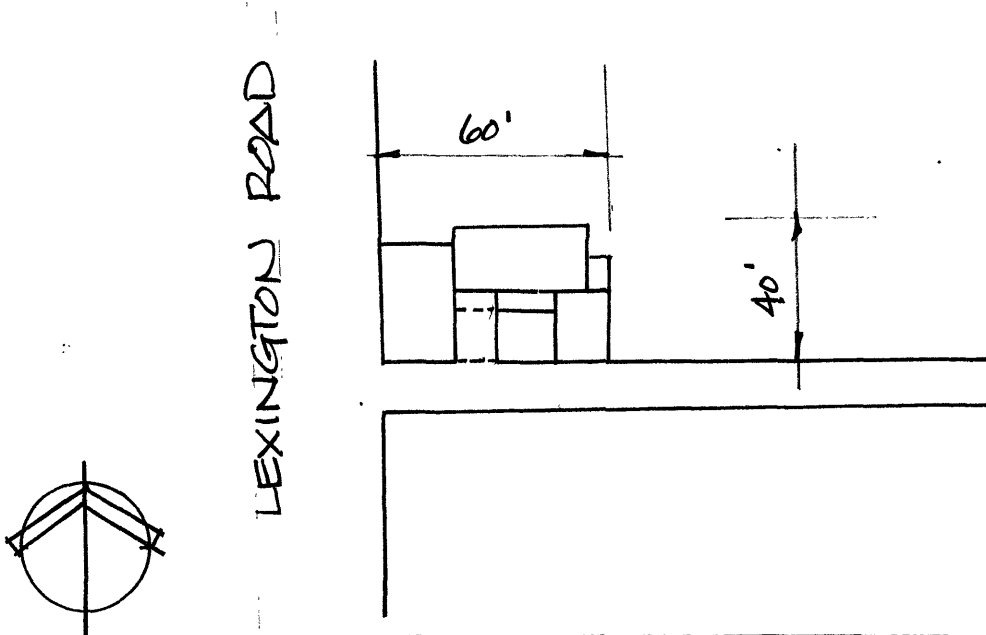

Official Courthouse Property Reference:

1866 Deed Book W Page 477 (Miller to Wherritt)
See page 2 for remainder of deeds