

**United States Department of the Interior
Heritage Conservation and Recreation Service**



**National Register of Historic Places
Inventory—Nomination Form**

See instructions in *How to Complete National Register Forms*
Type all entries—complete applicable sections

1. Name

historic Ouachita Parish High School

and/or common

2. Location

street & number 500 S. Grand Street not for publication

city, town Monroe vicinity of congressional district 5th--Jerry Huckaby

state La. code 22 county Ouachita Parish code 073

3. Classification

Category	Ownership	Status	Present Use	
<input type="checkbox"/> district	<input checked="" type="checkbox"/> public	<input type="checkbox"/> occupied	<input type="checkbox"/> agriculture	<input type="checkbox"/> museum
<input checked="" type="checkbox"/> building(s)	<input type="checkbox"/> private	<input checked="" type="checkbox"/> unoccupied	<input type="checkbox"/> commercial	<input type="checkbox"/> park
<input type="checkbox"/> structure	<input type="checkbox"/> both	<input type="checkbox"/> work in progress	<input type="checkbox"/> educational	<input type="checkbox"/> private residence
<input type="checkbox"/> site	Public Acquisition	Accessible	<input type="checkbox"/> entertainment	<input type="checkbox"/> religious
<input type="checkbox"/> object	<input type="checkbox"/> in process	<input checked="" type="checkbox"/> yes: restricted	<input type="checkbox"/> government	<input type="checkbox"/> scientific
	<input type="checkbox"/> being considered	<input type="checkbox"/> yes: unrestricted	<input type="checkbox"/> industrial	<input type="checkbox"/> transportation
		<input type="checkbox"/> no	<input type="checkbox"/> military	<input type="checkbox"/> other:

4. Owner of Property

name Ouachita Parish Police Jury

street & number 300 St. John Street

city, town Monroe vicinity of state La. 71201

5. Location of Legal Description

courthouse, registry of deeds, etc. Ouachita Parish Courthouse

street & number

city, town Monroe state La.

6. Representation in Existing Surveys

title La. Historic Sites Survey has this property been determined eligible? yes no

date 1980 federal state county local

depository for survey records La. State Historic Preservation Office

city, town Baton Rouge state La.

7. Description

Condition excellent good fair deteriorated ruins unexposed**Check one** unaltered altered**Check one** original site moved

date _____

Describe the present and original (if known) physical appearance

The Ouachita Parish High School is located on Grand Street adjacent to the Ouachita River in downtown Monroe. The Interstate 20 overpass runs beside the property.

Built between 1924 and 1930, the building consists of a 3 story rectangular classroom block with a courtyard to the south and a large auditorium to the north. The building is constructed of brick, hollow tile, and concrete. On the facades the brick is laid up in Flemish bond.

Except for the auditorium and vestibule, the interiors are unornamented. The auditorium vestibule is a small 3 bay paneled space with pilasters, dado, and scallop filled arches. The auditorium is ornamented with fluted pilasters, dado, and Georgian style doors flanking the proscenium.

The building's main significant feature is its exterior. Most of the classrooms have broad bands of medieval looking windows which are set off in limestone quoins on the exterior. The Jacobean look is further enhanced by the fact that the building mass has a large number of slight projections, each of which is trimmed in limestone quoins. The parapet features Dutch Baroque gables with pendants and strapwork. The doorways are of classical design with arches set in aedicule motifs. The auditorium vestibule has an impressive 3 part arch entrance with double pilasters.

8. Significance

Period	Areas of Significance—Check and justify below			
<input type="checkbox"/> prehistoric	<input type="checkbox"/> archeology-prehistoric	<input type="checkbox"/> community planning	<input type="checkbox"/> landscape architecture	<input type="checkbox"/> religion
<input type="checkbox"/> 1400-1499	<input type="checkbox"/> archeology-historic	<input type="checkbox"/> conservation	<input type="checkbox"/> law	<input type="checkbox"/> science
<input type="checkbox"/> 1500-1599	<input type="checkbox"/> agriculture	<input type="checkbox"/> economics	<input type="checkbox"/> literature	<input type="checkbox"/> sculpture
<input type="checkbox"/> 1600-1699	<input checked="" type="checkbox"/> architecture	<input type="checkbox"/> education	<input type="checkbox"/> military	<input type="checkbox"/> social/ humanitarian
<input type="checkbox"/> 1700-1799	<input type="checkbox"/> art	<input type="checkbox"/> engineering	<input type="checkbox"/> music	<input type="checkbox"/> theater
<input type="checkbox"/> 1800-1899	<input type="checkbox"/> commerce	<input type="checkbox"/> exploration/settlement	<input type="checkbox"/> philosophy	<input type="checkbox"/> transportation
<input checked="" type="checkbox"/> 1900-	<input type="checkbox"/> communications	<input type="checkbox"/> industry	<input type="checkbox"/> politics/government	<input type="checkbox"/> other (specify)
		<input type="checkbox"/> invention		

Specific dates 1924-1930 **Builder/Architect** Architect--H. H. Land

Statement of Significance (in one paragraph) Criterion C

The Ouachita Parish High School is significant in the area of architecture as an unusual example of early twentieth century eclectic architecture. The Jacobean Revival style was popular for educational institutions in much of the United States, but there are probably only about 20 "full blown" examples in Louisiana. In addition, the Ouachita Parish High School is a landmark in Monroe's downtown area. Most of the structures there represent the commercial builder architecture tradition. The high school is relatively pure, and is one of the few buildings in the area which can be considered a "high style" work of architecture.

9. Major Bibliographical References

Ouachita Lion, 1941-1942, Ouachita Parish High School Yearbook.
 Research Report/Statistical Compilation Prepared by Roy Johns, Architect, located in
 Ouachita Parish High School National Register file, La. State Historic Preservation
 Office, Baton Rouge. (CONTINUED)

10. Geographical Data

UMT NOT VERIFIED
ACREAGE NOT VERIFIED

Acreeage of nominated property approx. 1 acre
 Quadrangle name Monroe South

Quadrangle scale 1:24,000

UMT References

A

1	5
---	---

5	8	13	1	0	10
---	---	----	---	---	----

3	15	9	14	7	10	10
---	----	---	----	---	----	----

 Zone Easting Northing

B

--	--

--	--	--	--

--	--	--	--	--	--

 Zone Easting Northing

C

--	--

--	--	--	--

--	--	--	--	--	--

D

--	--

--	--	--	--

--	--	--	--	--	--

E

--	--

--	--	--	--

--	--	--	--	--	--

F

--	--

--	--	--	--

--	--	--	--	--	--

G

--	--

--	--	--	--

--	--	--	--	--	--

H

--	--

--	--	--	--

--	--	--	--	--	--

Verbal boundary description and justification

See attached sketch map.

List all states and counties for properties overlapping state or county boundaries

state	code	county	code

11. Form Prepared By

name/title See continuation sheet *See phone report of 4/8/81*
 organization _____ date _____
 street & number _____ telephone _____
 city or town _____ state _____

12. State Historic Preservation Officer Certification

The evaluated significance of this property within the state is:
 national state local

As the designated State Historic Preservation Officer for the National Historic Preservation Act of 1966 (Public Law 89-665), I hereby nominate this property for inclusion in the National Register and certify that it has been evaluated according to the criteria and procedures set forth by the Heritage Conservation and Recreation Service.

State Historic Preservation Officer signature *Chris B. Roberts*
 title State Historic Pres Officer date 2/16/81

For HCRS use only
 I hereby certify that this property is included in the National Register
 for *Chris B. Roberts* date 4/9/81
 Keeper of the National Register
 Attest: *Patrick Andrews* date 4/8/81
 Chief of Registration

FHR-8-300A
(11/78)

UNITED STATES DEPARTMENT OF THE INTERIOR
HERITAGE CONSERVATION AND RECREATION SERVICE

**NATIONAL REGISTER OF HISTORIC PLACES
INVENTORY -- NOMINATION FORM**

FOR HCRS USE ONLY

RECEIVED 4-13-81

DATE ENTERED 4-9-81

CONTINUATION SHEET

ITEM NUMBER 9 PAGE 2

BIBLIOGRAPHY (Continued)

Sanborn Company Insurance Map of Monroe, 1926.

FHR-8-300A
(11/78)

UNITED STATES DEPARTMENT OF THE INTERIOR
HERITAGE CONSERVATION AND RECREATION SERVICE

**NATIONAL REGISTER OF HISTORIC PLACES
INVENTORY -- NOMINATION FORM**

FOR HCRS USE ONLY

RECEIVED

DATE ENTERED

4-13-81

4-9-81

CONTINUATION SHEET

ITEM NUMBER

11

PAGE

2

FORM PREPARED BY:

Mac Ward, Director, Division of Historic Preservation
North Delta Regional Planning and Development District, Inc.
2115 Justice Street
Monroe, Louisiana 71201 318-387-2572 December 1980

Roy Johns, A.I.A.
1220 North 18th Street
Monroe, Louisiana 71201 318-387-2800 December 1980

Ouachita Parish High School

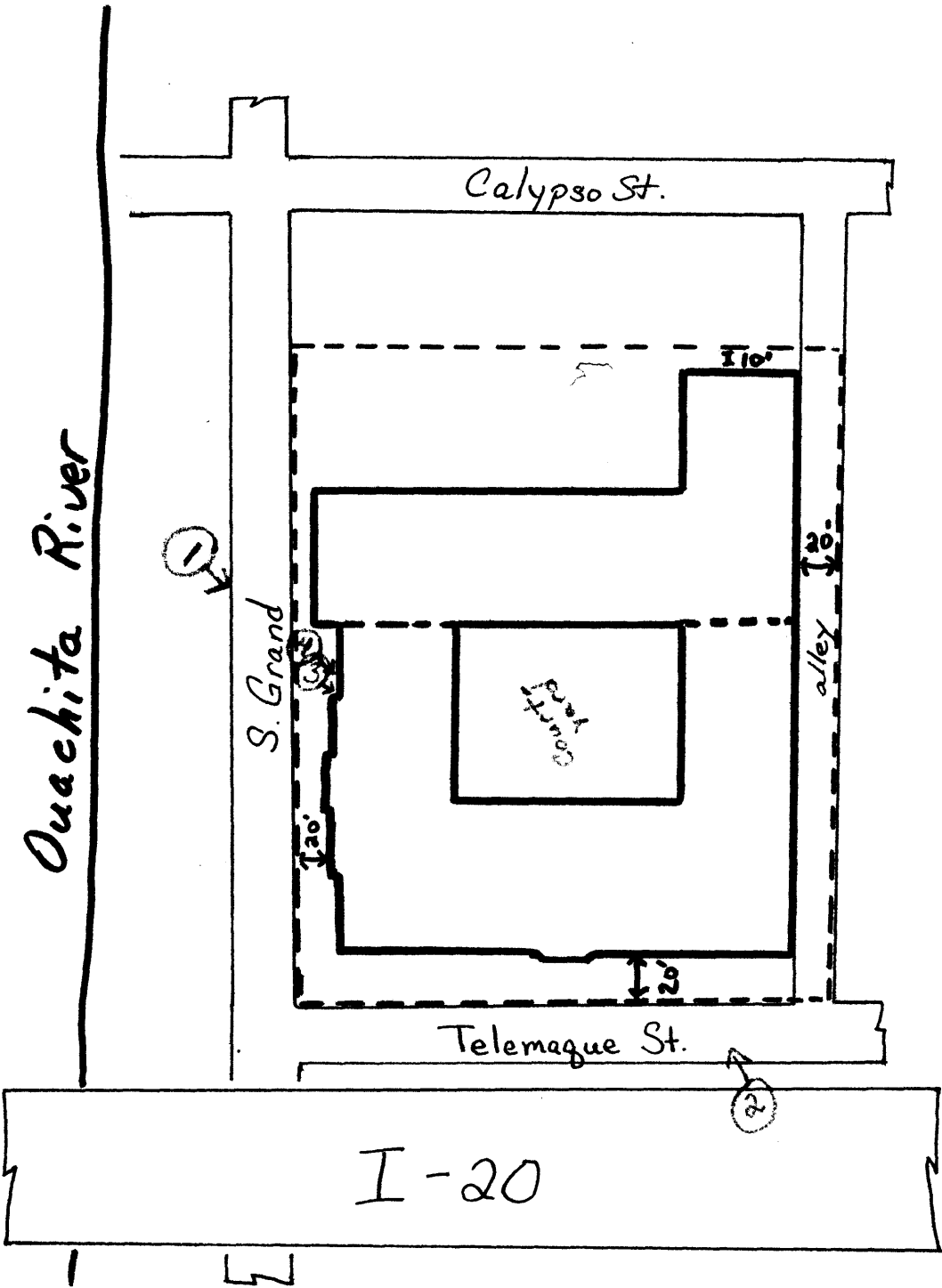

APR 19 1981

FEB 25 1981